

**Step 1:** Plumb U-channel and BuilderBrackets.

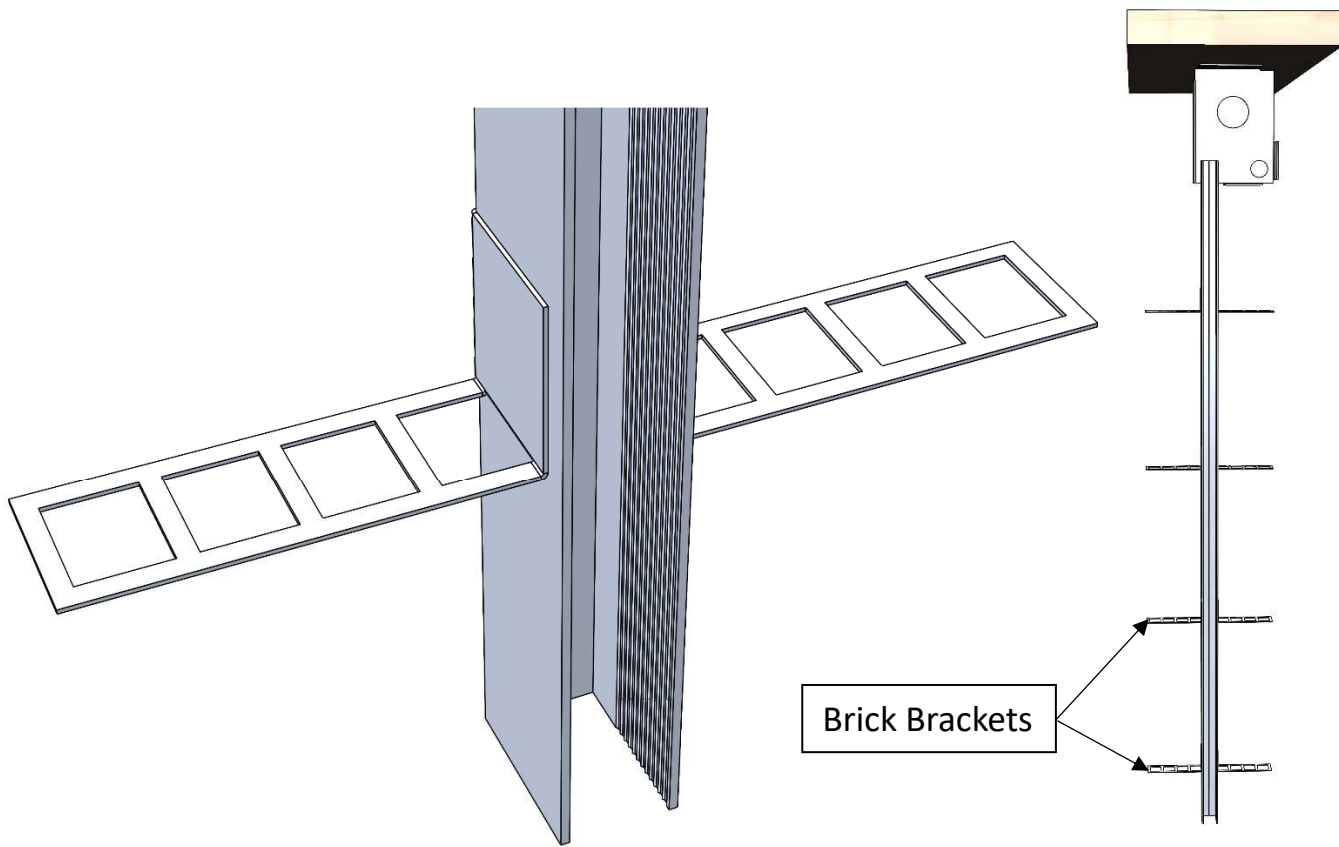

**Step 2:** Slide 3-4 Brick Brackets on to U-channel.

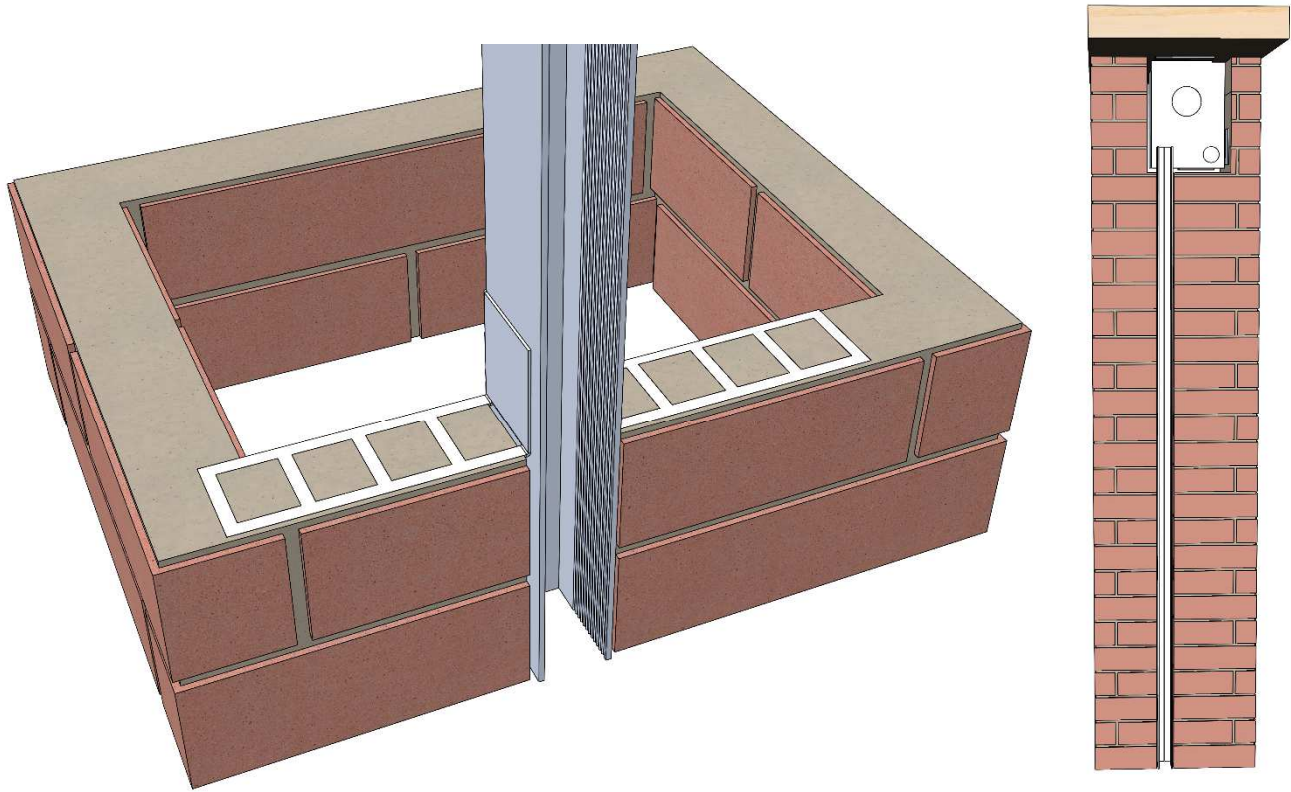

**Step 3:** Mortar brick brackets into columns. Repeat as needed.

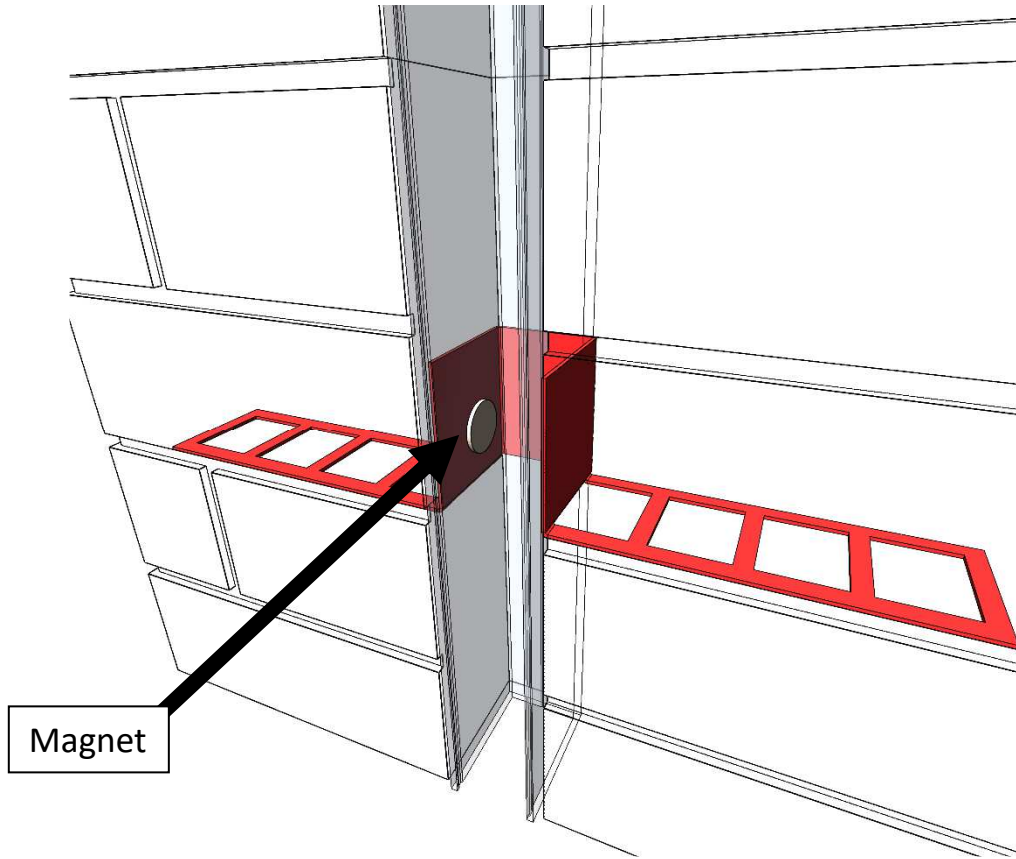

**Step 4:** Locate brick brackets in finished columns with stud finder or magnet.

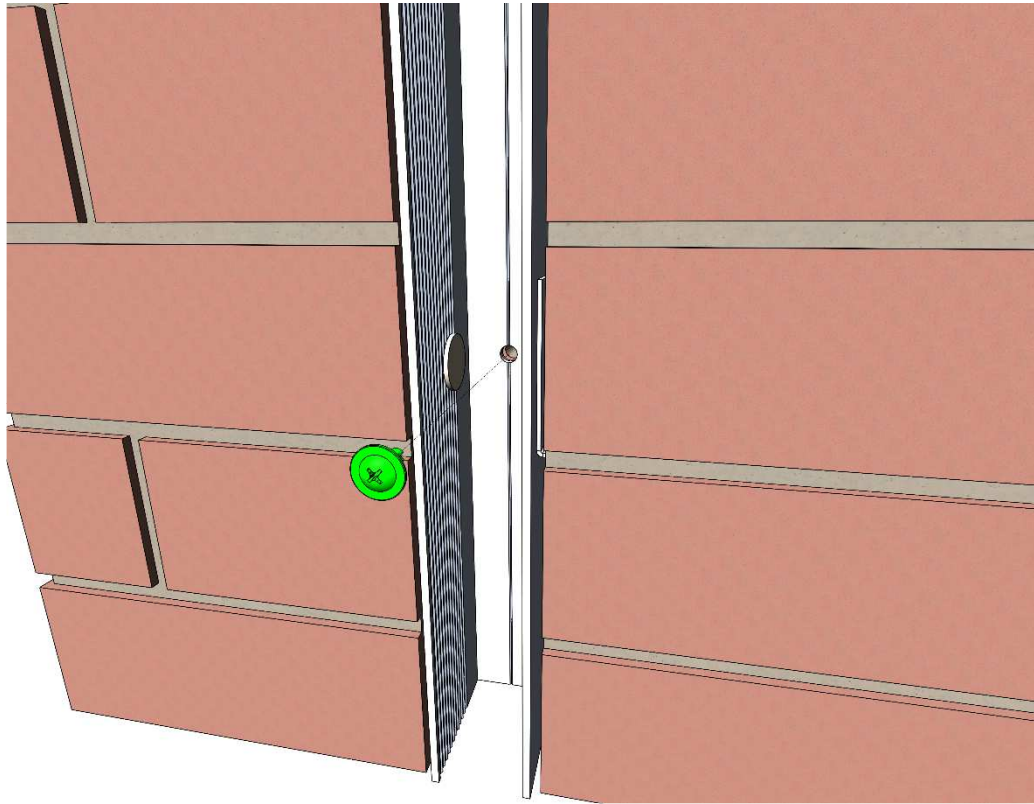

**Step 5:** Screw through back of U-channel to secure. Repeat per brick bracket used.