



Consulting Office for Infrastructure Designs and Utilities Engineering
Since 1984

Maadi, **Cairo**- Osman Towers Kornish Al Nile
Tel 002-02 25257562, Fax.002-02 25240448
Mail: [Infra.engineering @ yahoo.com](mailto:Infra.engineering@yahoo.com)



• Introduction & Background

Infra Engineering Office is one of the leading environmental and infrastructure consulting firms in Egypt.

Infra Engineering core team is a group of the highly experienced engineers and university professors with more than 25 years of expertise in planning, feasibility studies, preliminary and detailed designs, workshop drawings preparation, project management and construction supervision in water and wastewater sector.

Beside the core team, **INFRA Engineering** has its wide pole of supporting experts and scientific centers that can strength the company capabilities and insures full control on quality satisfying the client needs and covering his requirement in all Engineering disciplines.

Over the last 30 years, the major shareholder of the firm has been involved in more than 150 successful water, wastewater, irrigation, industrial and environmental projects covering most of the Egyptian Governorates as well as participation in several projects at the Middle East and Mina regen.

It should be also clearly mentioned that our firm **INFRA Engineering** is the historical continuation of a long participation in the Egyptian water and wastewater field under the name of UTILITIES consulting engineering bureau that was founded and managed by the Ashmawy family since 1982 till it was fully acquired by ENOIA in 2011.



ENG. Mohamed Ashmawy



Dr. Mostafa Ashmawy
Chairman

- **Mission**

INFRA Engineering is also dedicated to utilize its resources, Knowledge and experience base to serve the community in which it is engaged. This is achieved by providing **premium quality consulting services at fair cost**, being responsive to customers, merging market mandates in a responsible and efficacious manner, and producing a sustained growth posture that will secure its dominant position in the consulting services industry for years to come,

INFRA Engineering is also devoted to maintaining high quality standards & upholds work **ethics** that empower employees and ensure better working conditions requisite for top quality, and customer satisfaction.

- **Vision**

To be a Premiere Global Consulting Services Firm balancing the individual values of its empowered staff with a central Knowledge base derive from its diverse experience in order to provide continuous and uniform high quality service to its customers.

- **Objectives**

1. Ensure long – term Growth and increase market share.
2. Guarantee client satisfaction through continuous quality improvement.
3. To strive for higher standards of living for the employees as well as better working environment.



- **Fields of Activities**

FEASIBILITY STUDIES

Data collection, survey client's needs, establishment of the financial requirements of the project, master plane preparation, preliminary designs, economic & financial analysis, alternative solutions study and assessment of the most technical and economical proposal.

DESIGN AND ENGINEERING

Including the preliminary investigations required for the assessment of the design such as environmental studies, field survey, data collection, statistics information, water demand and population forecasting.

Detailed design, Process, Hydraulic, Electromechanical, Architectural and Civil Designs, preparation of bill of quantities (BOQ) and cost Estimates of the projects, in addition to preparation of workshop drawings for installations and civil constructions.

CONSTRUCTION MANAGEMENT AND SUPERVISION

Resident Engineers to inspect activities, follow up applying contract conditions and specifications, design review, review of workmanship, and materials, construction time scheduling, coordination, preparation of project status reporting in daily/weekly and monthly bases, cost control and value engineering.

OPERATIONS AND MAINTENANCE CONTROL

Operation and maintenance (O&M) manual preparation, O&M cost estimate, supervision on the O&M activities, training, preventive maintenance and inspection program development, and determination of operational compliance with governmental regulation and codes.

List of Professional staff

no	Name	Position	Experience	Field	Responsibilities
1.	Eng.Mohamed Maged	General Manager	17	Sanitry, process & Hydraulics	Ensure the creation and implementation of a strategy designed to grow the business. Coordinate design and construction supervision team, contract negotiations, business development review of technical- financial reports and provide direct management of key functional managers or executives in the engineering and business unit.
2.	Dr. Eng. Khaled Hassan	Technical manger	13	Civil	Conducting quality and document control, engineering review, all necessary tasks related to office systems including troubleshooting management. Involved in decision making for technical and operation management.
3.	Eng. Samir Badr Aldean AlFarghaly	Wastewater expert	40	Mech -process- Hydraulics	Management of Electromechanical design review team & technical advisor

4.	Eng .mahmoud moukhtar	Hydraulic expert	35	Civil-Sanitary-Environmental &Hydraulics	Hydraulic design and water/wastewater expert
5.	Prof. Dr. Ragie Lasheen	Research &Development advisor	32	Chemical-Process	Water &Waste Water Process Expert
6.	Eng. Mohamed salah	Electrical team leader engineer	10	Electrical	Electrical design and review
7.	Eng. Lamiaa Ibrahim	Hydraulic Engineer	13	Civil	detailed design for water supply and waste water collection/treatment projects
8.	Eng. Amal Muawad	Hydraulic Engineer	13	Civil	detailed design for water supply and waste water collection/treatment projects
9.	Eng. Dalia El Masry	Hydraulic Engineer	13	Civil	detailed design for water supply and waste water collection/treatment projects
10.	Eng. Mina Danial	Hydraulic design engineer	9	Civil	Process design, master plan preparation and detailed design for water supply and waste water collection/treatment projects

11.	Eng. Abdulrahman Shawqi	Hydraulic Engineer	2	Civil	Design engineer
12.	Eng. Omar Alaa	Hydraulic Engineer	1	Civil	Design engineer
13.	Eng. Kareem Mohamed Abdou	Civil Design Engineer	2	Civil	Design engineer
14.	Eng. Randa	Design Engineer	5	Civil	Design engineer
15.	Eng. Norhan	Design Engineer	3	Civil	Design engineer
16.	Eng. Omar Ahmed	Design Engineer	1	Civil	Design engineer
17.	Eng. Radwa Mohamed	Design Engineer	1	Civil	Design engineer
18.	Eng. Mannal	Head of Architectural department	20	Architecture	Preparation, review, design, management of Architectural team
19.	Eng. Walaa Mohamed	Architectural engineer	8	Architecture	Preparation, review, design, management of Architectural team
20.	Eng. Marwa	Architect	5	Architecture	Architecture design engineer

Construction Supervision Team					
21.	Eng. Atef Mohamed	Head of construction supervision	30	Civil	Control on construction sites and managers, review monthly reports, company representatives with clients
22.	Eng. Sayed Hamed	Project Manager	35	Civil	Full activity of construction supervision, project Management, technical and financial Administration, in addition to preparation of daily, weekly and monthly progress reports
23.	Eng. mahmoud Sergany	Project Manager	25	Civil	Full activity of construction supervision, project Management, technical and financial Administration, in addition to preparation of daily, weekly and monthly progress reports

24.	Eng. Osama farouk	Construction Supervision	15	Civil	Construction supervision, control on quality, invoices, claims and contract management
25.	Eng. Abdel hafiz Mahmoud	Construction Supervision	10	Civil	Construction supervision, control on quality, invoices, claims and contract management
26.	Eng. Montaser Herek	Construction Supervision	40	Electro-mechanical	Review of electromechanical submittals, technical evaluation, inspection, material take off review and construction / installation supervision as well as operation/ maintenance supervision.
27.	Eng. Hani Amer	Construction Supervision	22	Civil	Construction supervision, control on quality, invoices, claims and contract management



28.	Eng. Ahmed Tarek	Construction Supervision	10	civil	Construction supervision, control on quality, invoices, claims and contract management
Financial and legal department					
29.	Acc. Ramy Takla	Financial Manager & Tax advisor	35	Accountant	
30.	Prof. Dr.Hosam Lofty	Legal Advisor	35	Legal Advisor	Contractual aspects
31.	Ahmed Mohamed	Accountant	2	Accounting	Day to Day accounting
Drafting Team					
32.	Osama Mabrok	Draftsman	17	Draftsman	Preparing Hydraulic, Mechanical Drawings.
33.	Abd El Aziz	Draftsman	2	Draftsman	Preparing Hydraulic, Mechanical Drawings.

Administrative department					
34.	Mahmoud Adel	Administrator	3	lawyer	Document control and archive
35.	Amira Montser	secretary	13	secretary	General secretarial works maintaining diaries, managing meetings and conducting staff appointments, Typing, preparing and assist in preparation of reports.
36.	Yasmin	archiving	4	Information Systems	archive system
37.	Mohamed Fathy Amin	representative	13	Administrative	Representative

List of Consultant & Permanent part time staff

No	Name	Status
1	Prof. Dr. Amr Radwan Prof. Dr.Mohamed Alkholy	Soil Consultant
2	Dr. Tarek ALSayed Dr. Moh.Ezz Eldeen	Hydraulic & Irrigation
3	Prof. Dr.Ali Abdel Razek Prof. Dr. Reda Aly	Surveying Consultant
4	Prof. Dr. Nader Mattar Prof. Dr. Abd Al Zaher Ezz Eldeen	Road Design
5	Prof. Dr. Ahmed Mousa Dr. Eng. Hesham Haggag	Structure Consultant
6	Dr. Eng. Mohamed Kandeel	Environmental Studies
7	Eng. Mohamed Sadek	Project Management Expert

List of Cooperated Scientific & Research Centers

No	Center	Field of Cooperation
1	National Center for Researches NCR	Water & Wastewater Quality monitoring and analysis 
2	Center of Engineering Consultation, Training & Production CECTP	Different Engineering Specializations
3	Nile Research Institute NRI 	Water Quality & Hydraulic Modeling in Marine Structures and Nile Related Engineering
4	Faculty of Engineering Mattaria, Helwan University (Material Labs)	Quality Control, Material Assessment, Core Test,..etc.

**Organization chart / Dynamic
Activities & Activity flow chart**

ORGANIZATION CHART

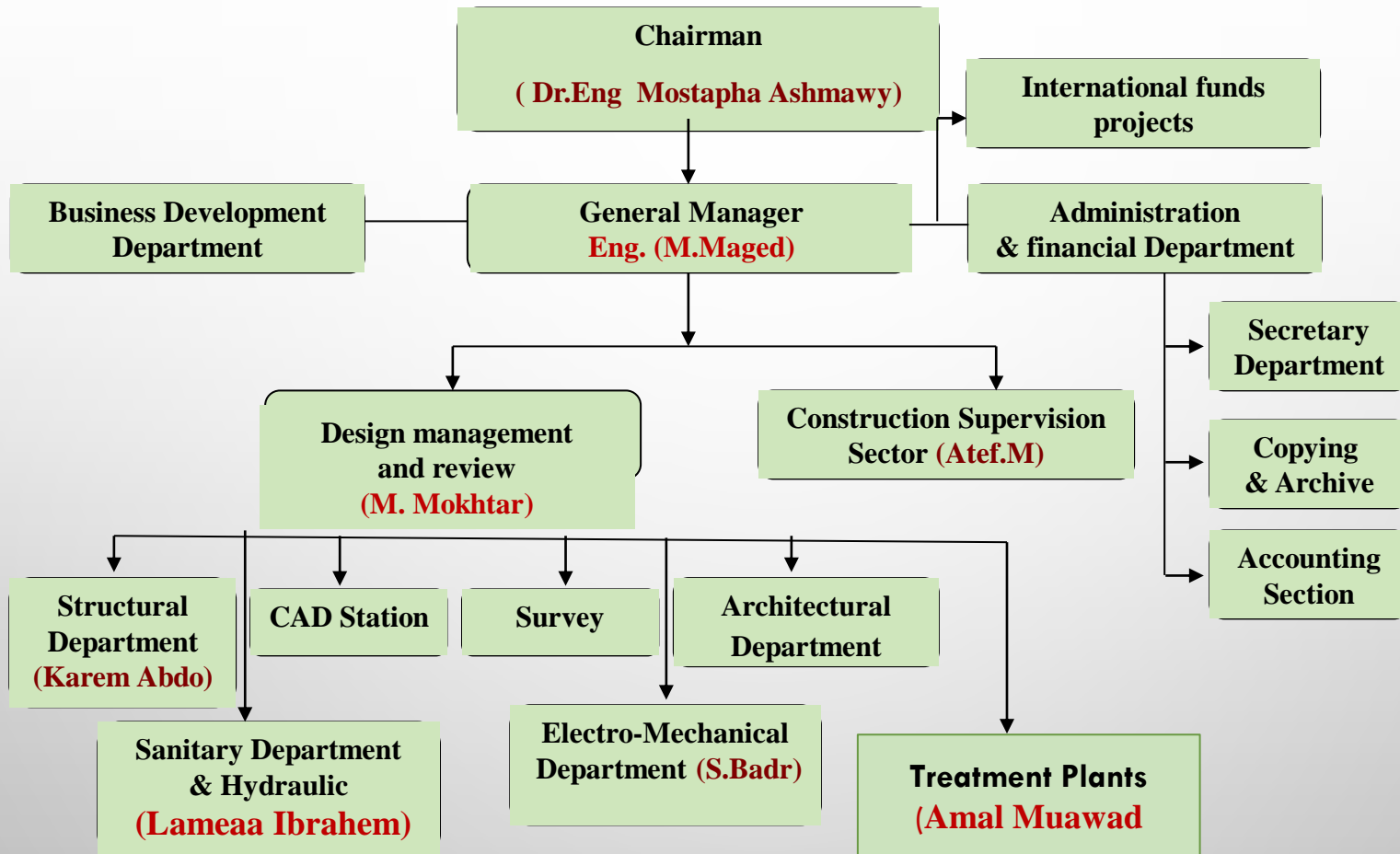

Dynamic Activities-Company Relations & Associated bodies

Feasibility Studies	Conceptual Designs	Detailed Designs
T.o.R Preparation	Workshop Drawings	Technical Support
Contracts & Project Management	Construction Supervision	R & D support Training

Flow Measurement / Water- wastewater quality monitoring and analyses- Topographical surveying and Marine Studies

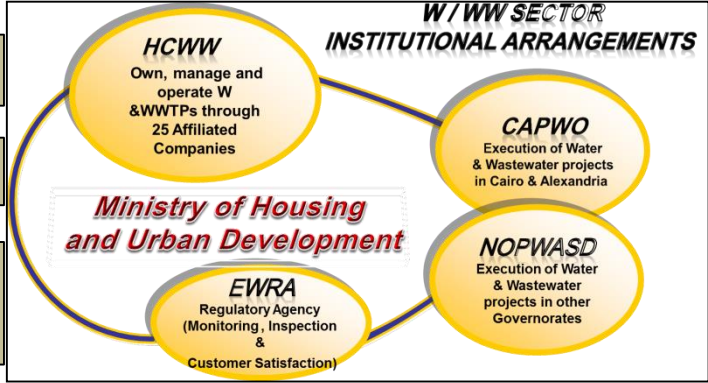

Relations with:
Ministries of : Housing & Utilities,
Irrigation, Environmental Affairs,
Agriculture & Health

Research Centers	Cooperating Universities	International & Local Consultants
------------------	--------------------------	-----------------------------------

Industrial Sector and Developers

Activities Flow Chart

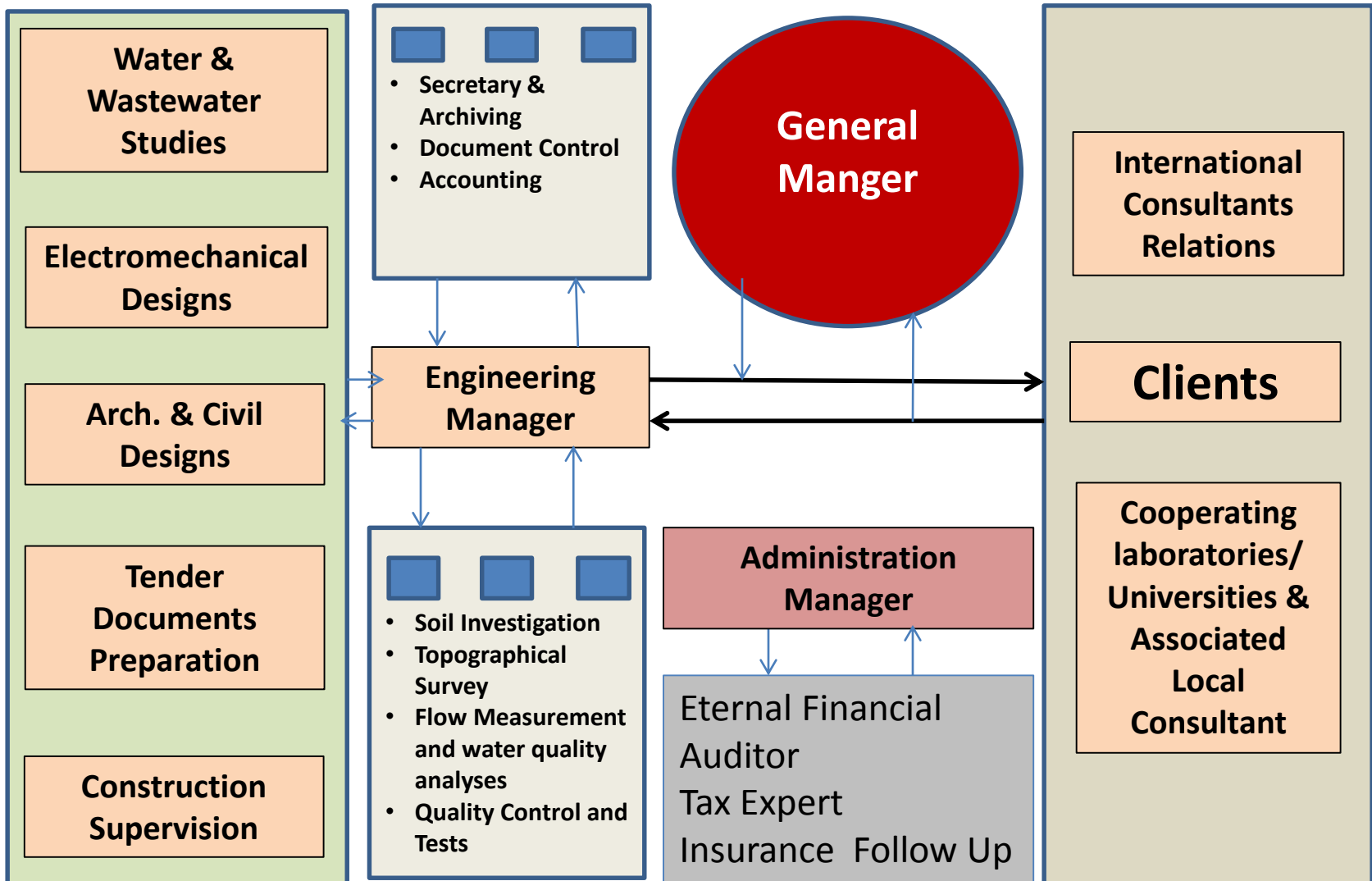

List of projects

Project List:

Note: It should be noted that the following list of projects is divided into two parts:

<u>Part (1): INFRA ENGINEERING projects</u>					
No.	Date	Project	Services	Client	LE million
1.	1995-2005	Helwan University water supply and waste water collection system.	Data collection, site visits and detailed design for water supply network including booster station and elevated reservoir cap 1000m ³ in addition to gravity sewers and pump station serving the university head quarter plot.	Helwan University	10
2.	1995-1997	Wastewater collection for the open theater, Helwan University	Detailed Design for sewage collection and pump station	Helwan University	1

3.	1995-2005	Plumbing Design for the Helwan University Buildings and territories: Conference Hall Examination Building Laboratories (Collage of Science)	Detailed water supply and sewage collection. <u>Services Included:</u> water supply, sewage collection, firefighting, irrigation, water boosters and sewage pump stations	Helwan University	3
4.	1997	Kafr AlRawageh and Al-Taref waste water Collection and Treatment, Luxor, Egypt.	Data collection, preliminary report, detailed design for gravity sewers and pump station serving the two big villages at upper Egypt in addition to Oxidation Ponds for sewage treatment	Helwan University	45
5.	1997-2003	Royal City Infra structure designs, 6 of October city	Detailed design for water distribution network and waste water collection system, pump station and force main, in addition to Roads network design for the residential compound	6 October Company for Real-Esitate Development, (Consultant Dr. Sameh AlShazly)	50

6.	2003	Irrigation Water Feed system for The Rare Plants Garden, Sharm El Shaikh	Data collection detailed design hydraulic, structure, electromechanical, in addition to preparation of workshop drawings, preparation of tender documents and B.O. Q	Environmental Agency EEAA	3
7.	2005	Urban Planning and Utilities Bolak Aldakroor, Giza (In association with Faculty of Engineering, Mattaria, Helwan Univ.)	Data collection, installation of bulk flow meters, monitoring and preparation of flow recording report for Utilities Consulting office	Utilities, Dorsch Consult.	8
8.	2005	Urban Planning and Utilities for 245 Villages distributed in Delta Egypt for development and satisfaction of water needs, roads and wastewater collection and treatment facilities.	Data collection, review on population statistics and forecast, determination of water needs and waste water collection and treatment requirement. Master plan for water supply and sewage treatment including budget estimation	Helwan University	١

9.	2006	Raswa Water Treatment Plant, Portsaied	Preparation of workshop drawings for piping & mechanical installations	Austrian Energy and Environment	2
10.	2007-2008	Beverly Hills Irrigation Pump station and networks	Preparation of the hydraulic and mechanical design for the irrigation pump station with 10 pumps in horizontal alignment and the plant is of capacity 0.6 m3/sec. In addition to irrigation network for the residential compound of Beverly Hills	Shaker Consulting & Utilities Consulting Bureau for SODECO Development.	20
11.	2010-2013	Rehana Compound, 6 of October city	Water, sewage, irrigation and roads networks designs in addition to water boosters, reservoirs and wastewater treatment plant	Egyptian Swiss Company	10
12.	2010-2014	Conrad Hotel, Marsa Allam infrastructure design, Huregada	Detailed design, water and sewage networks, water and sewage treatment plants	Investment Group - Touristic project	5
13.	2012	Evaluation of the contracting contract for the High Counsel for Universities	Technical and financial Evaluation for eight civil contractor contract applying point system methodology.	High Counsel for Universities	25

14.	2012	<p>Infra-structure water supply /wastewater collection systems and plumbing Design for Helwan University Buildings and territories: Badr Hospital, Examination Building Laboratories of Science College, Sports Hall,...etc.</p>	<p>Detailed water supply and sewage collection in side structures and site layout services including: water supply, sewage collection, firefighting, irrigation, water boosters and sewage pump stations</p>	<p>Helwan University</p>	3
15.	2014-2015	<p>Abd El Nasser Social housing, Ismaillia P. S</p>	<p>Sewage pump station electromechanical, Arch. And Structural detailed design</p>	<p>AC consulting engineer & technical services-sector to The National Organization for Potable Water & Sanitary Drainage NOPWAS</p>	12

16.	2014-2015	Ras Al Bar new community P. S	Preparation of design documents specification, detailed, design Process, B.O.Q Hydraulic, structural, Architectural, Electro mechanical details and technical assistance during constructions Sewage pump station	AC consulting engineer & technical services-sector to The National Organization for Potable Water & Sanitary Drainage NOPWAS	12
17.	2014	Miet Ghamer Waste Water collection system	Technical assistant for construction of the un completed sewers, dewatering system, side supports and connection of the old existing sewers /pump stations to the new wastewater project.	AC consulting engineer & technical services-sector to center of engineering consultation training production CECTP to The National Organization for Potable Water & Sanitary Drainage NOPWASD	35
18.	2014	Marine design for Sea Shell Hotel	Data collection, hydrographical survey, tide and wind studies, environmental protection reports and detailed design for a new Marine for the resort.	Kawait Investment & Real-Estate Co.	25

19.	2014-2017	Abnoub social housing sewage project, Assuit Governorate - Egypt	Preparation of design documents specification, detailed, design Process, B.O.Q Hydraulic, structural, Architectural, Electro mechanical details and technical assistance during constructions	Arab Contractors Asuit branch For the National Organization for Potable Water & Sanitary Drainage NOPWASD	17
20.	2015	Menia P. S	Sewage pump station electromechanical, Arch. And Structural detailed design.	AC consulting engineer & technical services-sector to The National Organization for Potable Water & Sanitary Drainage NOPWASD	10
21.	2015	Technology Valley wastewater treatment of Cap.10000m3/day	Design review and work shop drawings preparation for P.s, Rising main and WWTP of capacity 10000m3/day	Arab Contractors consulting engineer & technical services-sector. To Sinai Reconstruction Authority and Canal Cities	50

22.	2015	Mostaqbal water treatment plant & Intake	Preparation of full hydraulic, mechanical & civil design for the water treatment plant & intake including preparation of technical specification, workshop Drawings and bill of quantities.	AC consulting engineer & technical services-sector to The National Organization for Potable Water & Sanitary Drainage NOPWASD	120
23.	2015	Ghazy Gardens Residential Compound and Mall	Water supply, sewage collection and firefighting networks for 1000 housing unit and mall, design and construction supervision	Private sector Kuwait Investment Company, 5th settlement, New Cairo	30
24.	2014	Bostan WTP Extension from 1200 l/sec. to 1800 l/sec.	Detailed hydraulic, process, Arch. & civil design including preparation of tech. specs. & workshop Drawings	AC consulting engineer & technical services-sector to center of engineering consultation training production CECTP to The National Organization for Potable Water & Sanitary Drainage N.O.P.W.A.S. D	120
25.	2015	Manazel Residential Compound and Mall.	Water supply, sewage collection and firefighting networks for 1200 housing unit and mall, design and construction supervision	Private sector Kawit Investment Company, 5th settlement, New Cairo	20

26.	2016	Mahalla WTP (800L/Sec)	Mechanical /process design assessment and Detailed structural design for the treatment units including shore intake, raw water pipe line 1000 mm diameter, pulsator clarifier, filter building, chlorine building, diesel generator building, workshop, chemical building, treated water pump station thickeners. -Tech. review for the mechanical and hydraulic design -Hydraulic design of the shore intake, raw water pump station and force main	Mitito electromechanical company for water purification. For the Holding Company for Water & Wastewater (H.C.W.W)	80
27.	2016	Sella WWTP 20000 m3/day	Tender Study, Detailed B.o.Q followed by detailed Arch. And structural design.	Egyptian contractors (Mokhtar Ibrahim) To the National Organization to Potable Water & Sanitary Drainage (N.O.P.W.A.S.D).	48

28.	2016	Water supply boosters for the new Administrative Capital of Egypt (New Capital)	Preparation of hydraulic, mech, electrical, Arch. & Structural detailed workshop drawings for 3 booster pump station	AC consulting engineer & technical services-sector TO the Construction Authority for Potable Water & Wastewater. (C.A.P.W)	100
29.	2016	Gabal Asfar Stage III Inception Chamber and Screw pump station of capacity 1.3 million m ³ /day	Detailed design and tender document preparation for transmission of 1.3 million m ³ /day from the inception chamber through Screw pumps and Culverts to feed the third stage (III) treatment line. Activities included data collection, surveying, boreholes, conceptual design report, preliminary design report, alternatives assessment and detailed design and tender documents	The Construction Authority for Potable Water & Wastewater. C.A.P. W	150

30.	2016	Participatory urban Development for Random Areas in Cairo, Giza & Qalubia	Data collection and detailed design/ tender document, evaluation, procurement and construction supervision for multi discipline projects including water supply wastewater collection, Roads, Lighting and solid waste collection. Activities in association with DORSCH Consult, Germany- Enviro-Consult & Adapt Egypt	The German International Organization for Funding of development projects in developing Countries GIZ, For Caro, Giza and Qalubia governorates	80
31.	2017	Alexandria West. WWTP feasibility study & upgrading extension in Association with Dorsch consult - Enviroconsult	Data collection field studies wastewater analysis flow measurement assessment of wastewater Treatment Technologies assessment of sludge Treatment Technologies detailed design economic studies in addition to assessment and upgrading of the existing facilities	European Investment Bank EIB + Stake holders (CAPW – HCWW-MHUNC- ASDSCO)	2000 000

32.	2017	New Aswan WTP Extension (25000m ³ /day)	Preparation of extension drawings & specifications for the civil / Hydraulic & electromechanical equipment's	AC consulting engineer & technical services-sector TO Aswan Reconstruction Authority MHUNC	100
33.	2017	6 October West WWTP extension capacity 150.000 m ³ /day stage 2	The project is the second phase of sewage water treatment in west 6th of October city, with the capacity of ١٥٠,000 m ³ /day (secondary and tertiary treatment) Design review tender document, preparation technical evaluation procurement & Preparation of work shop drawing	AC consulting engineer & technical services-sector TO the Construction Authority for Potable Water & Wastewater. CAPW	700
34.	2017	10 th of Ramadan intake and boosters pump stations (second stage)	Preparation of electro mechanical specifications electromechanical equipment's & drawings	AC consulting engineer & technical services-sector TO the Construction Authority for Potable Water & Wastewater. CAPW	680

35.	2017	Gabal Asfar Stage III Inception Chamber and Screw pump station of capacity 1.3 million m3/day	Construction Supervision on the daily activities of the main contractor (tallaat mostafa)	The Construction Authority for Potable Water & Wastewater. CAPW	150
36.	2017	Abu Ramad & shalateen fishing ports.	Preparation of electromechanical equipment's specifications & evaluation of Technical and financial of contractors. The project consist of compact unites for waste water treatment system,	AC consulting engineer & technical services-sector	
37.	2017	Kafer al medawer pump station	Preparation of Detailed hydraulic, Arch.& civil design including preparation of Technical specification.	AC consulting engineer & technical services-sector TO the National Organization for Potable Water & Sanitary Drainage NOPWASD	

38.	2018	Osim WTP capacity (60.000-120.000m3/day)	Detailed civil design (structural, architecture and electrical works) for the treatment units including shore intake, raw water 2 pipe line 700 mm diameter, In addition to Tech. review & support for the mechanical and hydraulic design	Arab contractor – Helwan branch for The Construction Authority for Potable Water & Wastewater. CAPW	
39.	2018	Ras Albar ground tanks.	Structural design of 2 ground reservoirs capacity 5000 m3	Arab Contractors, North delta Branch to the National Organization for Potable Water & Sanitary Drainage NOPWASD	20
40.	2018	Kafer shoker W.T.P capacity 45.000 m3/day	Detailed civil design (structural & architecture) for the treatment units including shore intake, raw water 2 pipe line 700 mm diameter, In addition to Technical review & Technical support for the mechanical and hydraulic design	Arab contractor –east & middle delta branch for The Construction Authority for Potable Water & Wastewater. CAPW	

41.	2018	Kom ashfeen W.T.P extension 52000 m3/day	Preparation of shop drawing of structural and architecture drawing for the planet units	Samcrete for Construction Authority for Potable Water & Wastewater. CAPW	190
42.	2018	Barakta W.W.T.P capacity 7.500 m3/day	Construction Supervision on the daily activities of the main contractor Arab authority for manufactory (Army sector)	The Construction Authority for Potable Water & Wastewater. CAPW	100
43.	2018	AL alameen infrastructure Zone B3	Preparation of shop drawings of infrastructure networks (Potable water, waste water, storm drainage, irrigation) In addition to infrastructure of university	PETROJET (Contractor for Ur loan New / Communities Authority NUCA	100

44.	2018	Meet Ghamer Waste water Collection Master Plan Updating & Desired Projects	Preparation of Updated Macter Plan and Peroration of design drawings of sewege networks & P.S. of six villages at Meet Ghamer city and extension of EIEmam EIShafeey p.s. (Main P.S)	Arab contractor – north delta branch for NOPWASD	60
45.	2019	Shebin El Kanater W.W.T.P. capacity 65000 m3/day	Preparation design of internal networks & sewage line to supernatant pump station	Nasr City Company For CAPW	100
46.	2019	Emyay W.W.T.P. capacity 20000 m3/day	Preparation of Layout - Detailed civil design (structural & architecture) - mechanical design) for the treatment units and design of internal networks	Nasr City Company For CAPW	134
47.	2020	Integrated sewege of Dafriya village - Kafr Elsheikh	Preparation of preliminary deaign report and design drawings, technical specification of sewege network, P.S. and forcemain line of Dafriya village.	Al Mohandes Company for General Contracting For NOPWASD	34

48.	2020	Integrated sewege of Khadmiya village – Kafr Elsheikh	Preparation of preliminary design report and design drawings and technical specification of sewege network, P.S. and forcemain line of Dafriya village.	Al Mohandes Company for General Contracting For NOPWASD	21
49.	2019	New El Mansoura W.W.T.P. capacity 120.000 m3/day	Preparation of preliminary report, hydraulic & mechanical calculation and detailed design drawings (hydraulic – mechanical – civil - electric) in addition To T.OR & Civil / Mech B.O.Q	Arab Contractor Campany - For NUCA	150
50.	2020	Integrated sewege of Bani Soliman village – Bani Suief	Preparation of shop drawings of sewege network, P.S. and forcemain line of Bani Soliman village.	EL Nasr Company (Egico) For NOPWASD	21

51.	2021	Hyaat Karimah- Alfayuw Governorale Villages (Allocatedat ITSA, Yosef ALSEDEEK Centers) 47 villages	Preparation of Master – Klustering, Inception preliminary design report in addition to preparation of design drawings and technical specification of sewage network, Preparation of (Layout – connection pipes between units - Detailed civil design (structural & architecture) - mechanical design for the treatment units and design of internal networks, All forestine The Project	The Construction Authority for Potable Water & Wastewater. CAPW	500
52.	2021	Hyaat Karimah- Qary Qalyubia 4 Village	Deasign review & Construction Supervision on the daily construction activities of sewage network, & Pump station & Force Mains For No. of four villages	The Construction Authority for Potable Water & Wastewater. CAPW	250

53.	2022	Hyaat Karimah- Kafr AL Shaik Governorale Villages (Allocatedat ITSA, Yosef ALSEDEEK Centers) 47 villages	Preparation of Master – Klustering, Inception preliminary design report in addition to preparation of design drawings and technical specification of sewage network, Preparation of (Layout – connection pipes between units - Detailed civil design (structural & architecture) - mechanical design for the treatment units and design of internal networks, All forestine The Project	The Construction Authority for Potable Water & Wastewater. CAPW	500
54.	2021	Extension of Fowa WWTP Cap. 20000 m3/day	Detailed design of Hydraulic Civil & Mechanical Works for Activated shandy WWTP	NOPWASD	70

Part (2)

Part (2) Represents the personnel experience of the founder as he was completely responsible for the data collection, design , management of design activities, technical support, meetings, discussions and contracting through being one of the founders and the main designer and General Manager for UTILITIES Consulting Engineering Bureau.

The CV of the projects itself is considered to be UTILITIES projects

No	Date	Project	Service	Client	Value (M.L.E)
1	1992	Extension of Banha WWTP, Benha City, Qalubia Governorate, Egypt	Detailed design for extension of treatment plant of cap 60000 m ³ /d	Arab Contractors Company for National Organization for Potable Water and Sanitary Drainage (NOPWASD)	50
2	1989-1992	Zafta Water Treatment Plant Gharbia, generating set for the plant of capacity 200 - 400 lit/sec	Detailed hydraulic design of WTP of capacity 200 - 400 lit/sec.	Arab Contractors Company for NOPWASD	20
3	1989-1992	Massarett Nassan Water Treatment Plant, Beni Suef Governorate, Egypt	Hydraulic design for WTP of capacity 200 - 400 lit/sec.	The Industrial and Engineering Enterprises Co. for NOPWASD	15
4	1989-1992	Beba Water Treatment Plant, Beni Suef Governorate, Egypt	Data collection, hydraulic, mech., elec., architectural, and civil design of capacity 200 - 400 lit/sec.	Arab Contractors Company for NOPWASD	15

5	1989-1992	El-Fashan Water Treatment Plant, Beni Suef Governorate, Egypt	Data collection, hydraulic, mech., elect., architectural, and civil design of WTP of capacity 200 - 400 lit/sec.	Arab Contractors Company for National Organization for Potable Water and Sanitary Drainage (NOPWASD)	15
6	1989-1992	Irrigation Pumping Station Project for land reclamation in Upper Egypt	Design of civil works of 7 irrigation pumping stations with delivery pipelines and ground reservoirs.	Egyptian Contractors Companies (Mokhtar Ibrahim & Nasr General Company for Contracting)- Ministry of Reconstruction	50
7	1989-1996	Raw Water Pipeline from Kantara West - Port Said , Egypt	Detailed design for new raw water intake and pumping station with a capacity of 400000m ³ /day. Two delivery mains with a diameter of 1500 mm and a length of 50 km. in addition to massive storage open ground reservoir of capacity 50000m ³ at Raswa Water Treatment Plant in Port Said.	Societe Egyptienne d'Entreprise for National Organization for Potable Water and Sanitary Drainage (NOPWASD)	150

8	1989-1997	Kafr El-Sheikh Wastewater Project (J.V. with others), Kafr El-Sheikh Governorate, Egypt (Partial Activities for <u>Dr.M.Ashmawy</u> to complete the project by the J.V))	Master plan and feasibility study for the sewerage project at Kafr El-Sheikh Governorate in association with KESCON	NOPWASD financed by KFW	350 EU
9	1989-1990	Lowering ground water level of the Islamic monuments & Mosques , Cairo, Egypt	Studies, design for means of lowering the underground water level. The project consists of gravity sewers, pump station and force mains (16 monuments).	The Center of the Islamic Buildings, Dr. Saleh Lamie for the General Organization of Monuments.	5
10	1992-1994	Water supply project for Assuit Cement Company , Assiut, Egypt	Detailed design of civil, mechanical and electrical works.	Assuit Cement Company	50
14	1994-1999	Tanta W.W.T.P , extension from 90000 m ³ /day to 150000m ³ /day Gharbia Governorate, Egypt	Preparation of tender specification, detailed design Process, Hydraulic, structural, Architectural, Electromechanical details and technical assistance during construction (Activated sludge process)	Nasr General company For Contracting, NOPWASD	150

15	1995-1997	Quena- Safaga Water supply Project	Data collection, surveying works technical studies, design of Mech. Elect. and civil works and specifications for more than 47 Km of pipe lines and boosters with diameters from 400 to 600 mm.	Industrial Project and Engineering Company for NOPWASD	44
16	1995-1999	Asuit water treatment plant.	Complete hydraulic, Electrical-Mechanical, Arch. & Structural design for WTP of cap. 600/200 l/sec. in addition to water distribution network analysis and detailed pipe network design.	Arab contractors Asuit Branch - NOPWASD	160
17	1995-2000	Armant water treatment plant.	Complete hydraulic, Electrical-Mechanical, Arch. & Structural design for WTP of cap. 600/200 l/sec. in addition to water distribution network analysis and detailed pipe network design.	Arab Contractors South Delta Branch for NOPWASD	80

18	1995-1996	CAIRO East Bank Waste Water Master Plan Upgrading & Gabal El Asfar WWTP Extension. Full coordination, contract negotiations, consortium management activities conducted by Dr. Ashmawy	Data collection, Master plan upgrading and tender document preparation in association with the main consultant SOGREAH . Including production preparation of conceptual reports, design reports, updated master plan, culverts extension and tender documents including full details of 500000 m3/day WWTP at Gabal Alasfar.	Greater Cairo for Construction of Waste Water Project – CWO financed by the FRENSH Loans	900
	1996-2000	Gohayna water treatment plant.	Complete hydraulic, Electrical, Mechanical Structural design for water treatment plant 400/800, in addition to network and detailed pipe network design. Technical assistant during construction and periodical supervision was provided	Arab Contractor Asuit Branch for NOPWASD	140

20	1997-2000	Extension of Zakazik Waste Water treatment & master plan of collection networks, pump stations and WWTP of capacity 60000 to 80000)	Master plan for sewage collection system, pump station and treatment plant for Zagazik city Sharkia Governorate including population and wastewater forecasting, Hydraulic calculations- Preparation of conceptual and final design reports, full Hydraulic, civil & electromechanical detailed drawings	Arab Contractors East Delta Branch for NOPWASD	240
21	1997-2004	West Asuit Sewerage System and Extension of Asuit WWTP from 30000 to 100000m ³ /day	Design of sewage collection system, and pump in addition to WWTP Extension. including: Preparation of conceptual and final design reports, full Hydraulic, civil & electromechanical detailed drawings and B.O.Q and site technical support	Nasr General Company for Contraction for NOPWASD	130
22	1997-1998	Police Academy Sewerage Design for Training Zones.	Interior sewerage system design for 3 separate individual training sites located at Katamia, Khayalaa and Haggana zones.	POLICE ACADEMY	3

23	1998-2009	Sewage project for 15 villages at Kafr elsheakh governorate (In association with GITEC consult - Germany)	Master plan for sewage collection systems, pump stations, rising mains and treatment plant for 15 villages at Kafr Elshaikh Governorait	NOPWASD (funded by KFW Germany)	350
24	2000-2009	Urban development of Manshit Naser (EZBET BEKHET) – CAIRO. <u>IN ASSOCIATION WITH</u> <u>DORSH Consultant & GITEC</u>	Upgrading of water networks, Design of firefighting system water feeding system, Sewerage system, pumping station, Rising mains and Roads design.	Manshet Naser District Cairo Governorate (Funded by KFW)	20
25	2000-2004	Esna waste water project (Aswan governorate)	Waste water collection system consisting of 6 pump station, gravity sewers, pressure lines in addition to WWTP of capacity 30000 m3 /day – oxidation ponds process	The National Organization for Potable Water and Sanitary Drainage NOPWASD	120
26	2001-2003	Extension of Zefta water plant of capacity 200/400 l/sec	Full detailed hydraulic, mechanical, structural, architectural design of Clari-floculators, filter house, underground reservoir, raw and treated water pump stations	The National Organization for Potable Water and Sanitary Drainage NOPWASD	120

31	2001-2005	Extension of El Fashn water plant of capacity 200/400 l/sec	Full detailed hydraulic, mechanical, structural, architectural design of Clarifloculators, filter house underground reservoir, raw and treated pump stations	The National Organization for Potable Water and Sanitary Drainage NOPWASD	25
32	2000-2002	Al Remaya housing area giza governorate	Complete design of infra strucure utilities (water network, water tanks, sewage system, pumping stations, rising means,in addition to electrical and lighting/telephone networks and roads design	Giza Governorate	17
33	2002-2007	Extension of ElAbbassa water treatment plant from 1250l/sec up to 1750l/sec (Sharkia governorate) and the distribution networks.	Full detailed hydraulic, mechanical, structural, architectural design of extension units including: Clarifloculators, filter house underground reservoir, raw and treated pump stations	The National Organization for Potable Water and Sanitary Drainage NOPWASD	160
34	2003-2005	Extension of AlReswa, Portsaied , water treatment plant capacity of 125000m ³ /day (port said governorate)	Full detailed structural, architectural design of Clarifloculators, filter house underground reservoir, raw and treated pump stations	Suiz canal Authority	80

35	2003-2008	Extension of Damanhour WWTP From 90000m ³ /day to 160000m ³ /day (Behaira governorate)	Updating of master plan of waste water collection systems, pump station, rising mains and WWTP extension from 90000 to 150000 m ³ /day including Full detailed hydraulic, mechanical, structural, architectural design and specification (Activated sludge process) in addition to construction supervision and technical assistance	The National Organization for Potable Water and Sanitary Drainage NOPWASD	150
36	2003-2008	Alkap –Aoum Khalaf waste water project-port said governorate	Sewerage system, pump stations, force main and WWTP of capacity 6000 m ³ /day	Port said governorate	37
37	2003-2008	Extension of Kantara Raw water line (200000 m ³ /day) (port said governorate) (AS built Drawings is completed by Enoia Utilities)	Raw water feeding line dim 1500 mm of 46 km including surveying, profile preparation, crossing, valve chambers, water hummer, calculation & pump station extension (turbine pumps)	Arab Contractors Canal Branch for NOPWASD	200

39	2004-2007	Extension of Elkantara water treatment plant with capacity of 400-800 l/sec	Assessment of the current situation of the existing plant, Preliminary report, detailed hydraulic, mechanical, structural, architectural design of the proposed extension units and coordination with the plant operation requirement.	Arab Contractors Canal Branch for NOPWASD	40
40	2004-2008	Water treatment plant of Kelein and its networks with capacity of 400-800 l/sec	Process, Hydraulic, Structural & Arch designs of treatment and operation units including raw and treated pump stations.	NOPWASD	50
41	2004-2013 Only	Water treatment plant of Dar Elsalam with capacity of 700/1400 l/sec and the water distribution networks of 120 Km with diameters ranging from 300 to 1400 mm. (<u>The project is completed by Enoia Utilities</u>)	Process, Hydraulic, Structural & Arch designs of treatment and operation units for the intake and the treatment plant including preparation of civil and electromechanical specifications, tender documents and B.O. Q	Arab Contractors Asuit Branch for NOPWASD	70

42	2005-2013 Only	Dayroot Water Treatment Plant Cap. 600-1200 l/sec. (project is completed by Enoia-Utilities)	Process, Hydraulic, Structural & Arch designs of water treatment facilities in addition to preparation of Tech. specifications.	Nasr General Company for Contracting-NOPWASD	200
43	2005	Extension of Hamoul WTP from 600-1200 l/sec	Process, Hydraulic, Structural & Arch designs of water treatment facilities in addition to preparation of Tech. specifications and construction tech. assistant	Societe Egyptienne d'Entreprise for NOPWASD	50
44	2005	Extension of Fayed WTP 600-1400l/sec	Full detailed hydraulic, mechanical, structural, architectural design of treatment facilities including intake, Clarifloculators, filter house underground reservoir, raw and treated pump stations, sludge tanks and sludge pump station.	Arab Contractors Canal Branch-NOPWASD	60
45	2005 up to 2013 only	Extension of Fakous WTP of capacity 600/1200sec and distribution networks (project is completed by Enoia-Utilities)	Detailed design of water treatment plant including coordination with the existing facilities	Arab Contractors East Delta Branch-NOPWASD	75

46	1993-2002	Adliya– Port Said Water Line of 800/600 mm -46 KM	Main line from Adliya WTP to Port Said city as a strategic water feed line including Elmanasra Booster Station, design of electrical control and the anti-hummer system	Arab Contractors North Delta Branch- NOPWASD	140
47	2002	Updating of the Master plan for water distribution pipe lines and WTPs of El Sharkia Governate	Data collection of the existing conditions and requirements of water demand followed by determination of the required treatment plants, detailed design of water distribution networks, elevated tanks, Boosters.	Arab Contractors East Delta Branch- NOPWASD	300
48	2007	El Marg water treatment plant of capacity 600000 m3/day	Architectural & structural design of treatment units.	Arab Contractors- Bridges Branch- CAPW	600
49	2007	Covering of El khosoos Drain - Cairo	Design of the irrigation structures and multi vent culvert required for Covering of El Khosos Drain of 2 km long capacity of 2.6 million m3/day in addition to construction supervision	Construction Authority for water and Waste Water (CAPOW)	90

50	2007	Water treatment plant of Geziret Edahab-Giza	Design review and site supervision for extension of Geziret Edahab water treatment plant, capacity of 150000 m3/day	Construction Authority for water and Waste Water (CAPOW)	90
51	2007	Master plan for Water supply and Waste Water collection and Treatment for Kafr Eshaikh Governorate	Full management of the activities of the contract including establishment of branch office, Data collection, evaluation of current services and facilities conditions, land use applications, High priority projects & complete master plan up to 2050 for water and waste water projects including financial programs and economic studies.	The Holding Company for Water & Wastewater HCWW	4000

52	2008	Construction Supervision for water and waste water projects at five centers at Behaira Governate (pop 4000000 cop)	Management of the contract, recruitment establishment of branch office, follow up visits, coordination meetings and presentation for over 15 water & waste water projects including all activities, water supply, water treatment, waste water collection, pump station, and rehabilitation of several wastewater treatment plants.	The National Organization for Potable Water & Sanitary Drainage NOPWASD	3000
53	2009 up to 2013 only	Helwan Master Plan (Design and construction supervision) (project is completed by Enoia –Utilities)	Master Plan Preparation for wastewater collection systems, pump station and treatment plant of capacity 500000 m³/day	Construction Authority for water and Waste Water (CAPOW)	750
54	2009	Construction Supervision for water and waste water projects at Kafr EL Shaikh Governate	Management of the contract, recruitment establishment of branch office, follow up visits, coordination meetings and presentation for more than 25 water & wasteWater projects.	The National Organization for Potable Water & Sanitary Drainage NOPWASD	1000

55	2009	ALKasaseen Waste Water Project	Waste Water Collection, Pump Station, force main & WWTP 10000 m ³ /day	The National Organization for Potable Water & Sanitary Drainage NOPWASD	40
56	2009 up to 2013 only	10th of Ramadan Raw water pipe lines (project is completed by Enioia –Utilities)	Design and Intake Boosters & 2 pipelines each od diameters 2500m to carry 1.2 million m ³ /day (Hydraulic, Mechanic, Structure, Control , Monitoring- water hummer, ... etc)	Construction Authority for water and Waste Water (CAPOW)	1300
57	2009-2013	Extension of Zakazik WWTP from 80000m ³ /day to 171000m ³ /day (Sharkya governorate)	Updating of master plan for waste water collection systems, pump station, rising mains and WWTP extension from 80000 to 171000 m ³ /day including Full detailed hydraulic, mechanical, structural, architectural design and specification (Activated sludge process) in addition to construction supervision and technical assistance	Arab Contractors East Delta Branch- NOPWASD	300

Gabal Asfar Stage III Emergency Pump Station of Capacity 1,3 Million M3/day & Conveying Canal Stage III Treatment Plants (Design Contract- Supervision contract)

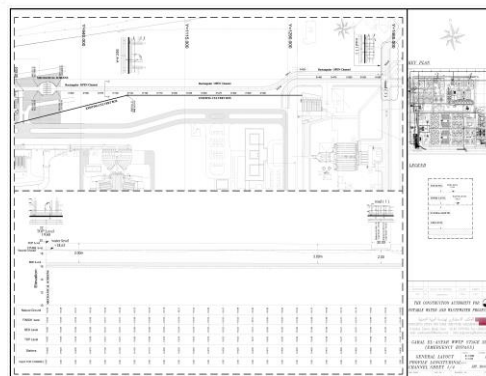

Project Name	Gabal Asfar Stage III Emergency Pump Station of Capacity 1,3 Million M3/day
Client	CAPW
Project Duration	2017-2019
Nominated Team Members Involved	All departments were involved: Hydraulic & process, electromechanical, structural, Arch. and administrations.
Client Contact	CAPW – Head of project Department
Project Highlights	This project includes design of lifting pump station of capacity 1,300,000 m ³ /day as well as the conveying canal 2.5 km at Gabal Asfar WWTP. The project aims at transferring the additional untreated wastewater from the main inlet chamber at Gabal WWTP to the new areas for treatment as well as an emergency outfall to Gaba Asfar Drain
Key Project Issues	<ul style="list-style-type: none"> ➤ Data collection, Master plan of the project, preliminary design, detailed design and tender document preparation ➤ Production of conceptual reports, design reports, updated master plan, screw pump station details, power supple station, transformers and open channel of 5.00 m width, 3 m depth and 2.5 km length with stepped out fall to Gabal Asfar Drain
Introduction	Additional capacities are received at the inlet chamber of Gabal Asfar WWTP. The current capacity of treatment lines is 2.3 million m ³ /day while total received capacities are exceeding 3.7 million m ³ /day. The additional flow had to be transferred to the new location proposed for construction of Stage III with facility of emergency outfall to Gabal Asfar Drain.
Design/ Design review	Full design activities were carried out including surveying the existing layout, Data collection on operational parameters and Hydraulic design, preparation of design report, cost assessment, full design documents and specifications, BOQ in addition to full tender documents preparation as well as tender's evaluation
Tender Documentation	Tender document preparation and conceptual designs for civil and electromechanical works
Construction Supervision	Supervision team of 6 Engineers covering different engineering specializations including project management, civil, mechanical, electrical, control and surveying. (24months)
O&M Supervision	Starts 2020 for 18 months

AlMostakbal Water Treatment Plant, Ismalia Governorate, Cap. 800 L/sec. (Design Contract)



Project Name	AlMostakbal WTP of capacity 800L/sec. -68000m3/day (Ismalia governorate)
Client	Arab Contractors for NOPWASD
Project Duration	(2015 – 2018)
Nominated Team Members Involved	All departments were involved: Hydraulic & process, electromechanical, structural and Architectural.
Client Contact	NOPWASD Head of Design department – 02-33023045
Project Highlights	This project included full design of water treatment plant of capacity 68000m3/day on two phases where the common facilities were constructed to serve the full capacity while the treatment units only were sized to serve the first phase.
Key Project Issues	<ul style="list-style-type: none"> ➤ Data collection on service areas and population, preliminary report including determination of the plant capacity, surveying of the natural water resources and location of the raw water intake, detailed process and mechanical calculation as well as hydraulic details including design of the raw water pump station, raw water rising main of 4300 m length and 1000mm diam. In addition to full design of the water treatment plant units. ➤ Full detailed hydraulic, mechanical, structural, architectural design and preparation of electromechanical tender documents and specification. ➤ Detailed construction drawings for Mech., Elec., Arch., and structural designs. ➤ Evaluation of Electromechanical contractors, review of submittals and approval of materials. ➤ Technical support during construction phase
Introduction	Al Mostakbal new city nearby Ismalia City was suffering from potable water supply problems. The served area is also surrounded by different consumers such as the Investment City and several Army/ Police shelters. A decision was made to construct a new water treatment plant to serve the area, INFRA Engineering was responsible to conduct all relevant design activities.
Design/ Design review	Full design activities were carried out including surveying water resources, data collection, preparation of the plant layout and full detailed Hydraulic design, preparation of design report, cost assessments full design documents and specifications.
Tender Documentation	Full tender document preparation and detailed designs for civil and electromechanical works
Construction Supervision	Technical assistance was given to contractor, approval of materials, review on submittals and catalogues, modifications to design according to equipments, verification of electromechanical specs according to actual submittals periodic site visits, discussion and solving site problems
O&M Supervision	Problems raised during the handing over of the plant were completely handled by INFRA Engineering

Mahalla Water Treatment Plant, Gharbia Governorate, Cap. 800 L/sec. (Design Contract)



Project Name	Mahlla WTP of capacity 800L/sec. -68000m3/day (Gharbia governorate)
Client	Mettito for HCWW
Project Duration	(2015 – 2018)
Nominated Team Members Involved	The following departments were involved: Hydraulic & process, structural and Architectural.
Client Contact	Mettito Design department – 010-00620323
Project Highlights	This project included process and Hydraulic design review, Arch./structural design of water treatment plant of capacity 68000m3/day in addition to full design of the shore intake, raw water pump station and raw water line of diameter 1000 mm and 4500 lm length.
Key Project Issues	<ul style="list-style-type: none"> ➤ Process design review as well as hydraulic calculation verification for Mettito. Preparation of different alternatives for raw water intake and pump station. preliminary report including determination of the plant capacity, surveying of the natural water resources and location of the raw water intake, detailed process and mechanical calculation as well as hydraulic details including design of the raw water pump station, raw water rising main of 4500 m length and 1000mm diam. as well as the full design of the water treatment plant units. ➤ Full detailed Architectural and structural design in addition to preparation of detailed B.o.Q for construction purposes. ➤ Detailed Hydraulic and structural drawings for the raw water intake. ➤ Technical support during construction phase
Introduction	Old Mahala city was suffering from potable water supply problems. The existing old water treatment plant reached to a complete failure stage. Existing units has to be demolished and to be replaced by new facilities of the desired capacity.
Design/ Design review	Full design activities were carried out including surveying water resources, data collection, preparation of the plant layout and full detailed Hydraulic design, preparation of design report, cost assessments full design documents and specifications.
Tender Documentation	Full tender document preparation and detailed designs for civil and electromechanical works
Construction Supervision	Technical assistance during construction as well as attendance of site meetings.

Alexandria West WWTP Extension and Upgrading- (Feasibility Study Contract In association with Dorsch Consult, Germany / Enviro-consult, Egypt)



Project Name	Alexandria West WWTP Extension and Upgrading (400000 m3/day primary treatment to 600000 m3/day secondary treatment)
Client	EIB (European Investment Bank) -CAPW
Project Duration	2017 - 2018
Nominated Team Members Involved	Deputy team leader, data collection team, samples collection, wastewater analyses, flow measurement team, inception report preparation, mechanical experts, civil design experts, ESIA study, coordination of activities and presentation to stake holders as well as donors.
Client Contact	EIB commission at Egypt, CAPW Head of project department – 002-01001183362
Project Highlights	This project included feasibility study to extend an existing primary wastewater treatment plant from 400000 m3/day up to 600000 m3/day secondary treatment including sludge digestion and dewatering facilities.
Key Project Issues	To conduct an accurate feasibility study allowing for financing program and agreement, data collection about the exact expected served population, water demand, water availability wastewater collection system, assessment of the existing facilities, wastewater samples collection, wastewater analyses, flow measurement , boreholes /soil report management inception report preparation, mechanical experts, civil design experts, ESIA study, as well as coordination of activities and presentation to stake holders as well as donors were jointly performed by INFRA Engineering .
Introduction	An existing primary treatment of capacity 40000 m3/day was requested to be extended up to the desired capacity (to be determined by the study) with full assessment of the different treatment processes and sludge handling options together with full assessment of the financial requirements for upgrading of the existing facilities as well as the extension units.
Design/ Design review	Review of master plan for wastewater collection, design of the required extension facilities after selection of the treatment process, boreholes and soil report management as sub consultancy, full detailed priced mechanical and civil B.o.Q preparation
Tender Documentation	Feasibility Study prior to Tender documents preparation
Construction Supervision	Feasibility Study prior to Tender documents preparation
O&M Supervision	Feasibility Study prior to Tender documents preparation

Katamia Club Swimming Pool Re- construction.

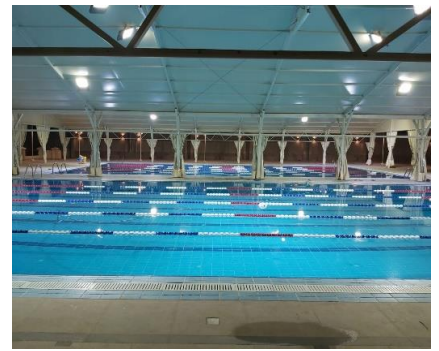

Project Name	Katamia Club (Syndicate of Applied Arts graduates) Swimming Pool Re- Construction.
Client	Syndicate of Applied Arts graduates.
Project Duration	2015-2018
Nominated Team Members Involved	Electromechanical, Structural, Arch.
Project Highlights	This project includes evaluation of an existing swimming pool that suffer from differential schmeat conditions, soil studies, material testing, evaluation of structural element, decision making, complete redesign for construction of new swimming pool of dimension 30×50M separated into tow compartments (training – competition) with new innovative foundation system to avoid settlement and seepage of ground water under the new pool.
	Complete structural details, method of statement for construction, technical support & addition to electromechanical specs, were produced
Tender Documentation	Tender document preparation and detailed designs for civil and electromechanical works
Construction Supervision	Technical support covering different engineering specializations including project management, civil, mechanical, electrical, control and surveying.
O&M Supervision	2015 - 2018

New Sohag -735 Acres , New Sohag City

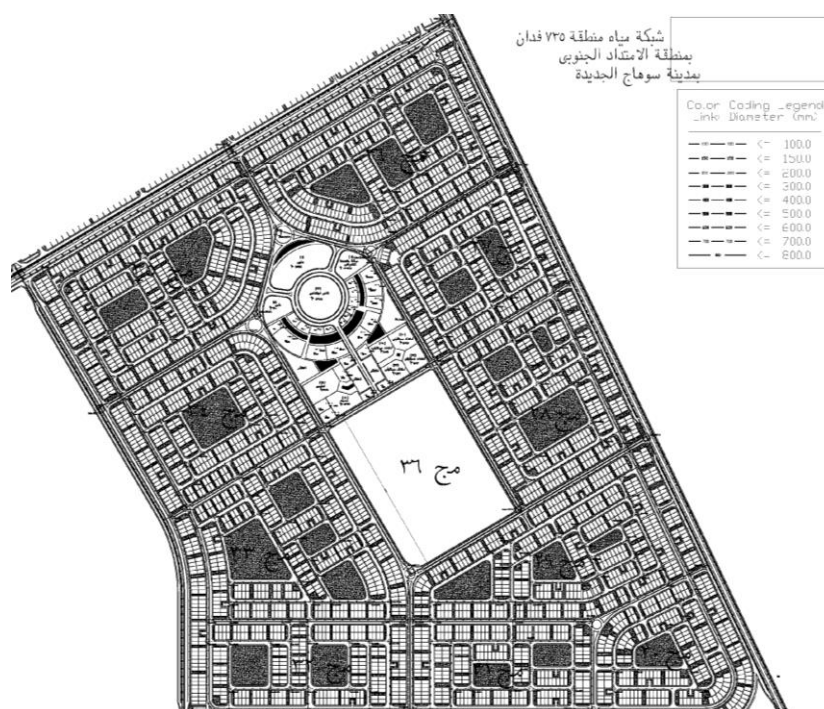

Project Name	735 Acres New Sohag
Client	AL Nasr Company for construction (egyco) (24010602)
Project Duration	
Nominated Team Members Involved	All departments were involved: Hydraulic & structural.
Client Contact	Manager Sohag projects
Project Highlights	This project includes full design of puttable water and fire networks
Key Project Issues	<ul style="list-style-type: none"> ➤ Data collection, on service area, surveying of the project area .In addition to full design of water and fire networks. ➤ Full detailed Hydraulic design of puttable water and fire networks and street clural design
Introduction	<p>Sohag new city not serviced by infra structure networks.</p> <p>A decision was made to construct in fracture networks to serve the area, infra engineering was responsible to conduct all relevant design activities.</p>
Design/ Design review	Full design activities were carried out including surveying, data collection, preparation Hydraulic design of networks with full details.

New Sohag -51 Acres ,(service area)New Sohag City

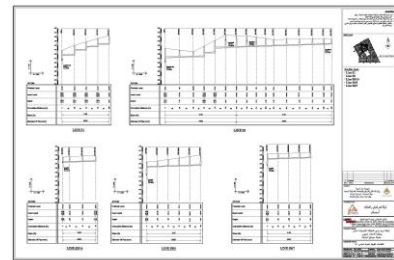
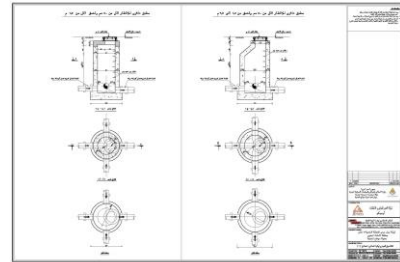
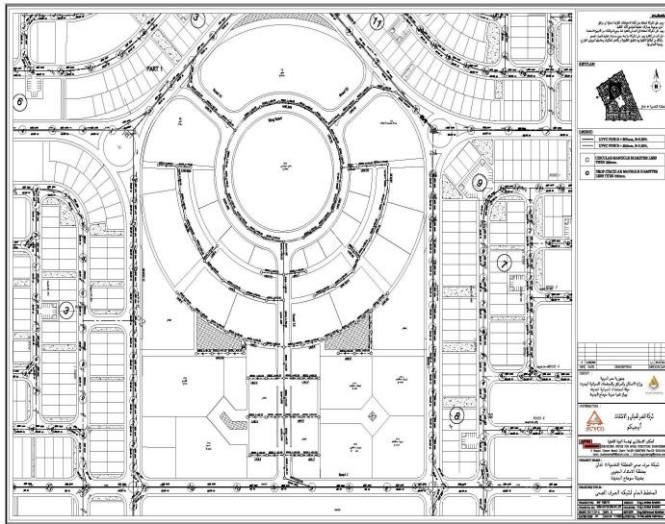

Project Name	51 Acres New Sohag
Client	AL Nasr Company for construction (egyco) (24010602)
Project Duration	
Nominated Team Members Involved	All departments were involved: Hydraulic & structural.
Client Contact	Manager Sohag projects
Project Highlights	This project includes full design of puttable water , fire, sewer and irrigation networks
Key Project Issues	<ul style="list-style-type: none"> ➤ Data collection, on service area, surveying of the project area .In addition to full design of water and fire networks. ➤ Full detailed Hydraulic design of puttable water , fire, sewer and irrigation networks and street clural design
Introduction	<p>Sohag new city not serviced by infra structure networks.</p> <p>A decision was made to construct in fracture networks to serve the area, infra engineering was responsible to conduct all relevant design activities.</p>
Design/ Design review	Full design activities were carried out including surveying, data collection, preparation Hydraulic design of networks with full details.

Al Allamein Networks , New AL Allamein City

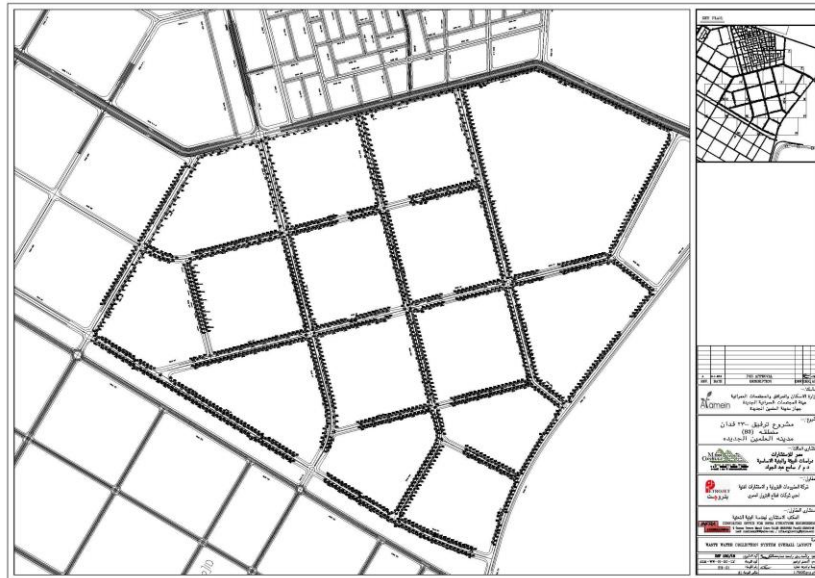

Project Name	2.300 acres of New AL Allamein City Companion project
Client	Petrojet Company
Project Duration	
Nominated Team Members Involved	departments were involved: Hydraulic , structural .
Client Contact	Engineering director - ٠١٠٠٠٨٢٨٥٩٤
Project Highlights	This project includes full design of puttable water , sewer, storm and irrigation networks .
Key Project Issues	<ul style="list-style-type: none"> ➤ Data collection, on service area, preparation report surveying of the project area .In addition to full design of in restructure networks. ➤ Full detailed Hydraulic design of puttable water , sewer, storm and irrigation networks and structural design i.
Introduction	<p>AL Allamein New City not serviced by infra structure networks.</p> <p>A decision was made to construct in fracture networks to serve the area, infra engineering was responsible to conduct all relevant design activities.</p>
Design/ Design review	Full design activities were carried out including surveying, data collection, preparation Hydraulic proportion technical , BOQ

Supervision of Construction Projects

INFRA Engineering has conducted several supervision of construction projects for various infrastructure facilities. These facilities including:

- Gravity Sewer Networks.
- Pumping Station.
- Force Main Pipelines.
- Wastewater Treatment Plants (WWTPs).

Example of Supervision of Construction Projects:

- Gabal Asfar Stage III Emergency Pump Station of Capacity 1,3 Million m³/day & Conveying Canal Stage III Treatment Plants.
- Construction of Baraqta WWTP with Capacity 7500 m³/day.
- Construction of Sewer Networks and Pumping Stations with Force mains for Four Villages in Qaliubya under Haya Karyma project.

Groupe Photos of Supervision Projects:

Sewer Network and Force main Lines:





Pumping Stations:



Wastewater Treatment Plants:



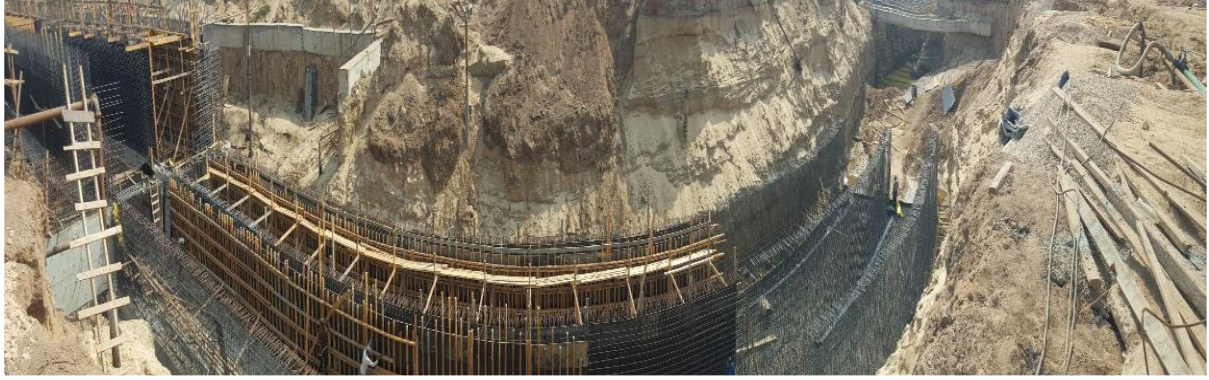

مستندات المكتب

Permitting Special Consultant Engineering

Office

Where as the Decree of the Minister of Irrigation No. 1684/1972 providing for the establishment of the Consultant Engineers Registration Book and the establishment of the Consultant engineering Offices pursuant to the approval of the Supreme Consulting Engineering Committee on 9/11/2016 and Council Supreme on 29/11/2016 of the works carried out by the Engineer, holder of the present Certificate, according to articles 4 & 5 of the above mentioned Ministerial Decision and its other items ,the present Certificate has been delivered to Consultant Engineer:-

Moustafa Mohamed Abd El Moniem Hassan Ashmawy

member of the syndicate Sub No : 618/17 Consultant

Engineer No: 6236/1 consultant Engineering Branch : **CIVIL** He has the consultant engineering office in the field of:

(HYDRAULICS DESIGN OF POTABLE WATER & SEWERAGE NETWORKS & PLANTS)

Under Number (863)

For a period of five years starting from 29/11/2016

Head of the Supreme Consultative Committee

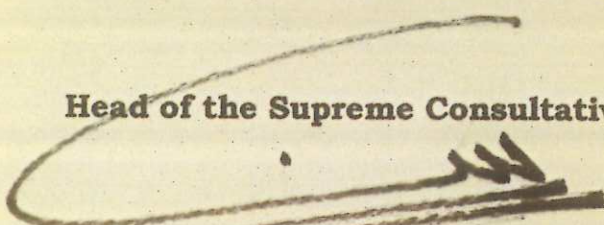
Cons.Eng/ Mohamed Al Nemr

Cairo in: 20/12/2016



ترخيص مكتب هندسي استشاري نوعي

بعد الإطلاع على قرار السيد المهندس وزير الري رقم ١٦٨٤ لسنة ١٩٧٢ في شأن إنشاء سجل المهندسين الاستشاريين والترخيص في تأسيس المكاتب الهندسية الاستشارية وعلي اعتماد اللجنة العليا للهندسة الاستشارية بتاريخ ٢٠١٦/١١/٩ والاعتماد الفني بتاريخ ٢٠١٦/١١/٢٩ وذلك للأعمال المقدمة من السيد المهندس المعطاة له هذه الشهادة وفقا لما جاء بالمادتين ٤ ، ٥ من القرار الوزاري المشار إليه وما تضمنه من بنود أخرى فقد أعطيت هذه الشهادة إلى :

الي المهندس الاستشاري: مصطفى محمد عبد المنعم حسن عشاوي

عضو النقابة رقم : ١٧/٦١٨ واستشاري رقم: ١/٦٢٣٦

شعبة الهندسة المدنية . لذلك يكون من حق سيادته ترخيص مكتب هندسي استشاري نوعي في مجال :

(التصميم الهيدروليكي لشبكات ومحطات مياه الشرب والصرف الصحي)

لمدة خمس سنوات اعتبارا من ٢٠١٦/١١/٢٩

تحت رقم (٨٦٣)

رئيس اللجنة العليا

للهندسة الاستشارية

محمد النمر
م. أ / محمد النمر



القاهرة في ٢٠١٦/١٢/٢٠



CERTIFICATE OF A CONSULTANT ENGINEER

Where as the Degree of the Minister of Irrigation No. 1684/1972 providing for the establishment of the Consultant Engineers Registration Book and the establishment of the Consultant engineering Offices pursuant to the approval of the Supreme Consulting Engineering Supreme Consulting Engineering Committee on 11/9/2012 and Syndicate Council on 29/9/2012 of the works carried out by the Engineer, holder of the present Certificate, according to articles 4 & 5 of the above mentioned Ministerial Decision and its other items ,the present Certificate has been delivered to Engineer:-

Mustafa Mohamed Abdel Moneim Hassan Ashmawy

Member of the syndicate **No: 618/17**

Engineering Branch: CIVIL in His capacity as Consultant Engineer in the Field of:-

(HYDRAULICS DESIGN OF POTABLE WATER & SEWERAGE NETWORKS & PLANTS)

2017
2017

Secretary - General

Amrully

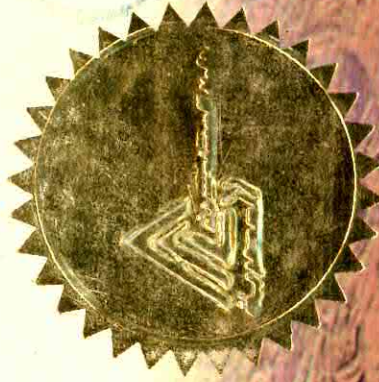

Dr.Eng/ Ali Abd-Elraheem

6236/1



جمهورية مصر العربية
وزارة المالية
مصلحة الضرائب المصرية
المهن الحرة اول/ ٢٠٠٠
المكتب الاستشاري الهندسي انفرا انجنييرنج
فردى
مصطفى محمد عبدالمنعم حنين ششماوى
٩ عمارات المقاولون العرب المعادي حلوان القاهرة
استشارات هندسية



٢٠٢٤/٠٩/٢٩ ٢٠١٩/٠٩/٣٠ ٤٧٤-٢١٢-٨٥٨

2132406241388250

جمهورية مصر العربية وزارة المالية مصلحة الضرائب المصرية

البطاقة الضريبية

يحظر استخدام هذه البطاقة إلا بمعرفة الممول أو وكيله القانوني.
وفي حالة العثور عليها، يرجى تسليمها إلى أقرب مأمورية ضريبية.

This card should be used by the tax payer or his legal agent.
If found, please hand it to the nearest tax office.

In case of losing or stealing please
call 19897 / (02) 27929911

في حالة فقد أو السرقة يرجى الاتصال
بمصلحة الضرائب المصرية على رقم
(02)27929911/19897



النقابة العامة للمهندسين

١٩١٩

إسم المهندس : محمد عبد الله حيدر

رقم القيد : ١٧/٦١٨

إسم المكتب : انفرا الجفري

التخصص : التصميم الهيدروليكي لشبكات مياه الشرب والصرف الصحي

رقم إشاري : ١/٦٣٦

الشعبة : مدني

رقم السجل : ٩١٩١٠١٤١٦

تاريخ إستخراجه : ٢٠١٩

عدد النسخ : ١٩١٩



نموذج (٣) ض.ق.م

تتساهدة تسجیل الضريبة على القيمة المضافة

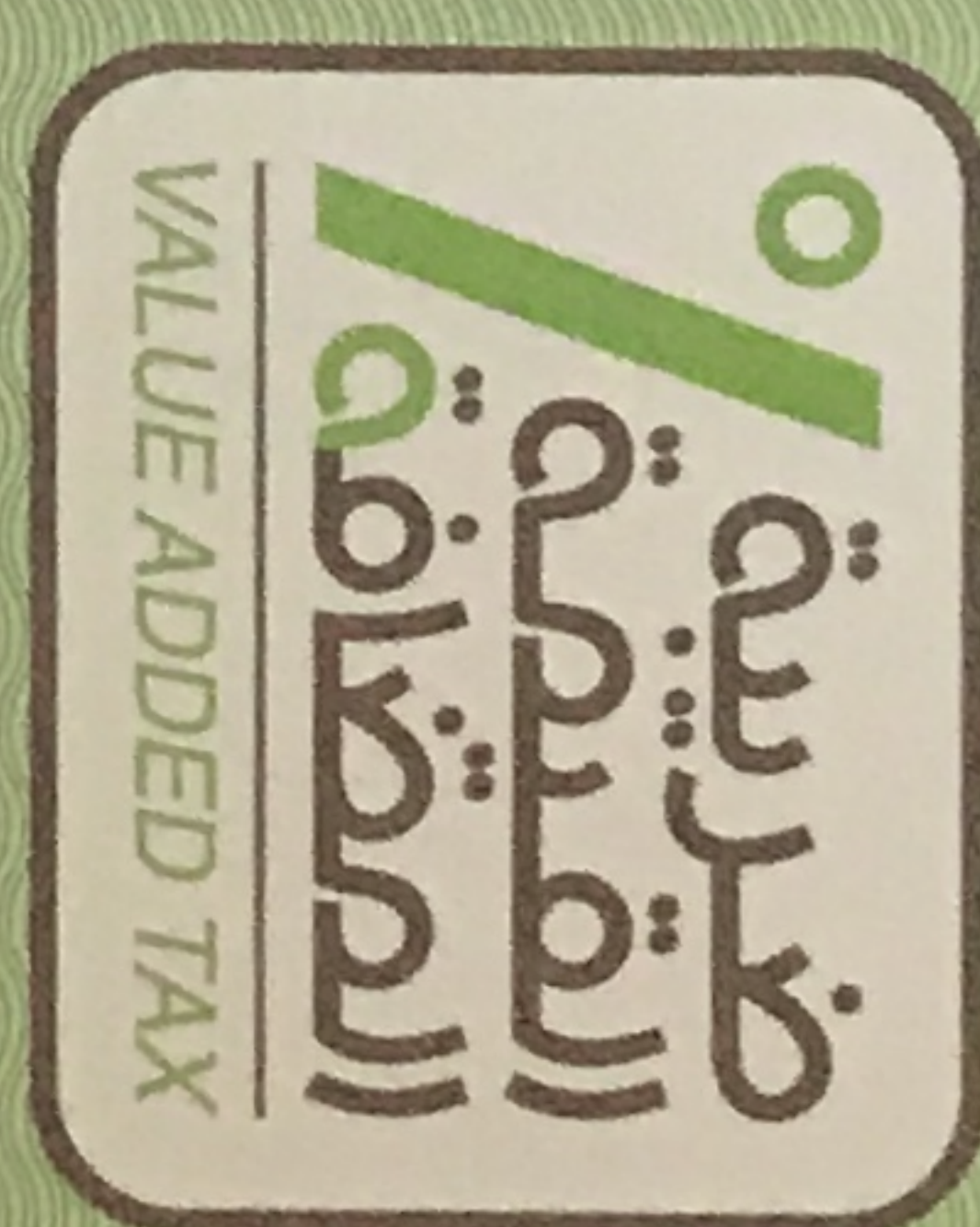

منطقة : جنوب القاهرة
مأمورية : المعادي
العنوان : ١ شارع المبتیان - السيده زينب

هذه شهادة منابان : مصطفى محمد عبد المنعم عثمانوى - المكتب الاستشارى انفرا انجيز لبح

العنوان : ٩ عمارات المقاولون العرب المعادى حلوان القاهرة

قد تم تسجيله وفقاً لنصوص قانون الضريبة على القيمة المضافة

تحت رقم : 858 - 212 - 474

وذلك اعتباراً من : 2017-11-01

تحريراً فى : 2017-11-01

سأمر
٢٠١٧/١١/١١



رئيس المأمورية

عبد الهادي
فاهري
١١/١١/٢٠١٧

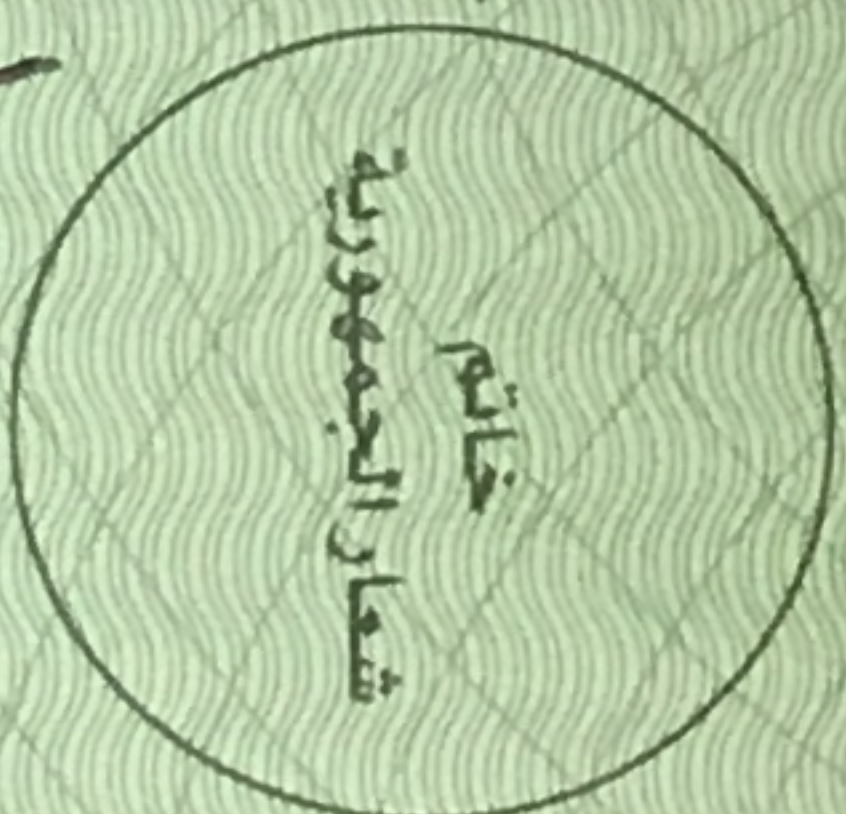

روت سورال بحى



نموذج
بيانات سداد مستحقات ضريبية نقدا

مصلحة الضرائب المصرية
قطاع المعلومات

..... فرع / مكتب بينك / بريد

د. مصطفى محمد عبد الحليم السيد شكري

اسم الممول / المنشأه / جهة الالتزام

بيانات السداد * قبل ملء النموذج اقرأ التعليمات أسفل الصفحة بشأه

لفظ وفترة مائة وأربعة آلاف وستمائة وأربعين
شهرين فقط

القيمة المراد سدادها بالأرقام :

جنية مصرى ١-٤٧-٤١-

ضرائب عامة (دخل)

٤٧٤	٢١٢	٨٥٨	٢١٢	٨٥٨	٢١٢	٨٥٨	٢١٢	٨٥٨	٢١٢	٨٥٨
كود المأمورية	يوم الصداقة	المعامل داخل النشاط	كود النشاط	الشباغة	كود الشرطة	شهر	يوم	شهر	يوم	شهر
١-١٠٠٠	١-١٠	١-١٠	١-١٠	١-١٠	١-١٠	١-١٠	١-١٠	١-١٠	١-١٠	١-١٠
رقم التسجيل الضريبي (٩ رقم) :-	رقم الملف الضريبي (١٦ رقم) بدون فواصل :-	فترة السداد :-	من : شهر / سنة	إلى : شهر / سنة	سداد عن :-	<input checked="" type="checkbox"/> إقرار	<input type="checkbox"/> متأخرات	<input type="checkbox"/> دفعات مقدمة	<input type="checkbox"/> خدمات مادة ٥٦	<input type="checkbox"/> إتاحة مادة ٥٦
<input type="checkbox"/> تحت الحساب	<input type="checkbox"/> أقساط	<input type="checkbox"/> مقابل تأخير	<input type="checkbox"/> رسم تنمية	<input type="checkbox"/> ضريبة دمغة	<input type="checkbox"/> غرامات وتعويضات	<input type="checkbox"/> إقرار مرتبات واجور	<input type="checkbox"/> تصرفات عقارية	<input type="checkbox"/> ض مرتبات واجور	<input type="checkbox"/> ثروة عقارية	<input type="checkbox"/> مدفوعة مأمورية
يتم قبول ضريبة أرباح تجارية وضريبة المهن الحرة تحت بند (تحت الحساب)										

ضرائب مبيعات

رقم التسجيل الضريبي (٩ رقم) :-	فترة السداد :-	من : شهر / سنة	إلى : شهر / سنة	سداد عن :-
<input type="checkbox"/> ضريبة أقرار	<input type="checkbox"/> فروق فحص	<input type="checkbox"/> غرامات وتعويضات	<input type="checkbox"/> بدل مصادرة	<input type="checkbox"/> رسم تنمية
<input type="checkbox"/> رسوم توفيق	<input type="checkbox"/> ض. إضافية	<input type="checkbox"/> مدفوعة مأمورية		

خصم من المنيع (الخصم والاضافة سابقا)

رقم جهة التعامل أو الخصم من المنيع (٩ رقم) (ليس رقم التسجيل) :-	فترة السداد :-	من : شهر / سنة	إلى : شهر / سنة	سداد عن :-
<input type="checkbox"/> ضريبة خصم من المنيع	<input type="checkbox"/> مدفوعة إدارة خصم من المنيع			

الاسم :-	رقم ت المحمول :-	التوقيع :-
الصفة :-		

* تعليمات ملء النموذج :-

- تحدد القيمة المراد سدادها في خاتمة بيانات السداد لكل أنواع الضرائب
- يتم اختيار الضريبة المراد السداد عنها (ضرائب عامة - ضرائب مبيعات - خصم من المنيع) بوضع علامة ✓ بجوار نوع الضريبة
- يتم ملئ خاتمة رقم التسجيل الضريبي ورقم الملف من واقع البطاقة الضريبية.
- يتم تحديد الفترة المراد السداد عنها (وبالنسبة لضريبة المبيعات تكون فترة السداد (شهر- سنة)) ، يتم اختيار نوع واحد فقط من سداد عن بوضع علامة ✓ بجوار نوع السداد .
- يتم ملء نموذج منفصل ببيانات كل مدفوعة في حالة الرغبة في سداد أكثر من نوع (ضرائب عامة أو مبيعات أو خصم من المنيع).
- إذا نكرت رقمك كممول (رقم التسجيل) في خاتمة رقمك كجهة سيتم توجيه المدفوعة لصالح المأمورية التي تحاسب أمامها وليس لصالح إدارة الخصم من المنيع التي تريد السداد لها لذا يجب التأكد من كتابة رقمك كجهة خصم من المنيع .
- يتم توقيع النموذج بواسطة الممول أو من ينوب عنه بعد مراجعة البيانات التي ذكرها بالنموذج .

فئات المبالغ المستلمة من العميل:

الفئة	١ جم	٥ جم	١٠ جم	٢٠ جم	٥٠ جم	١٠٠ جم	٢٠٠ جم	الاجمالي
العدد								
القيمة								

تفاصيل المورد

اسم الشركة: انفرانجينيرينج
 نوع المورد: مورد / مقدم خدمة / استشاري
 رقم السجل التجاري: 919101416
 رقم سجل ضريبة المبيعات: 474-212-858
 رقم السجل الضريبي:

الأنشطة: استشارات هندسية
 البريد الإلكتروني: mashmawy95@yahoo.com
 الاسم الأول: INFRA
 الاسم الثاني: ENGINEERING
 الاسم الثالث:
 العنوان: maadi Cairo egypt
 فاكس: 0225240448
 تليفون: 01222101320
 حالة المورد: يمكن التعامل معه

حالة المورد

رجوع



يمكنكم متابعتنا علي

© حقوق النشر محفوظة لوزارة التخطيط و المتابعة و الاصلاح الاداري 2019

مركز معلومات الجيز

مؤرخة ١١/١٩/٢٠١٩

٠١٩/١١/١٤

المورد مسند على بوابة المقاداة العامة

شهادات اتمام اعمال

شهادة

يشهد الجهاز التنفيذي لمياه الشرب والصرف الصحي بأن المكتب الاستشاري لهندسة البنية التحتية ("إنفرا إنجينيرينج" د. مصطفى عشاوي) قد أتم أعمال الخدمات الاستشارية الخاصة بإعداد الدراسات التصميمية ومستندات الطرح لمشروع محطة رفع مياه الصرف الصحي "الحل العاجل" طاقة متوسطة مليون م³/يوم بالمرحلة الثالثة لمحطة معالجة الجبل الأصفر وذلك طبقاً للتعاقد المبرم بين الجهاز التنفيذي والمكتب الاستشاري على أكمل وجه

وهذه الشهادة دون أدنى مسؤولية على الجهاز التنفيذي

القائم بالإشراف على أعمال التخطيط

وإعداد المشروعات

مهندس / كمال صلاح كمال



إلى من يهمه الامر

يشهد مركز الاستشارات الهندسية والتدريب والإنتاج – كلية الهندسة بالمطرية جامعة حلوان

بأن المكتب الأستشارى لهندسة البنية التحتية (**Infra engineering**) – د.م/ **مصطفى عبد المنعم عشماوى** قد قام من خلال المركز باعداد الدراسات والتصميمات التفصيلية ومستندات المشروع المدنية والميكانيكية وذلك لمشروع توسعات محطة مياه البستان من ١٢٠٠ ل ١٨٠٠ ل ا ث فى الفتره من فبراير ٢٠١٤ وحتى مايو ٢٠١٦ وتكلفة هذا المشروع التقديرية هى ١٣٠ مليون جنية فقط لا غير .

كما قام من خلال المركز ايضا باعداد الدراسات الخاصة بتنفيذ الفرعات الرئيسية لمشروع صرف صحى ميت غمر لامكان الاستفادة من المشروع واجراء المعاينات على الطبيعة بالمشاركة مع استشاريو ابحاث التربه واعداد التقارير والدراسات الهيدروليكية والميكانيكية لربط خطوط الانحدار وخطوط طرد المحطات القائمة على المشروع الجديد وذلك فى الفترة من فبراير ٢٠١٤ حتى ديسمبر ٢٠١٤ وقيمة هذا المشروع ٤٥ مليون جنية مصرى .
وقد اعطيت له هذه الشهادة دون ادنى مسئولية على المركز الأستشارى .

وتفضلوا بقبول وافر التحية والاحترام،،،،

مدير مركز

الإستشارات الهندسية والتدريب والإنتاج





File No / 1 / 100 رقم القيد Dept إدارة :
Date التاريخ Address العنوان : ٢٦ شارع الجمهورية - القاهرة

شهادة خبرة لمن يهمه الأمر

يشهد قطاع الاستشارات الهندسية والخدمات الفنية (بيت خبرة) بشركة المقاولون العرب "عثمان أحمد عثمان وشركاه" بأن المكتب الاستشاري الهندسي (INFRA ENGINEERING - أ.د.م / مصطفى عشاوي) قد قام بالعمل في العديد من مشاريع المياه والصرف الصحي مع قطاع الاستشارات الهندسية، ومنها على سبيل المثال:

- ١- محطة معالجة غرب مدينة ٦ أكتوبر (١٥٠,٠٠٠ م^٣/يوم) - محافظة الجيزة.
- ٢- محطة مياه المستقبل (٤٠٠ - ٨٠٠ ل/ث) محافظة الإسماعيلية.
- ٣- محطة تنقية مياه أسوان الجديدة "المرحلة الثانية" (٢٥,٠٠٠ م^٣/يوم) - محافظة أسوان.
- ٤- محطة تنقية مياه البستان "التطوير السادس" (٦٠٠ ل/ث) - محافظة دمياط.
- ٥- محطة رفع مشروع مرافق الامتداد العمراني بمدينة رأس البر - محافظة دمياط.
- ٦- محطة رفع مشروع الإسكان الاجتماعي بمنطقة عبد الناصر - مركز فايد - محافظة الإسماعيلية.
- ٧- محطة رفع مشروع الصرف الصحي لقريّة كفر المداوير - مركز مغاغة - محافظة المنيا.
- ٨- روافع المياه المغذية لآعمال الإنشاءات بالعاصمة الإدارية الجديدة (العاشر من رمضان - التكديس - الخزانات الاستراتيجية).

وقد قام سيادته بإتمام هذه الاعمال على الوجه الأكمل وفق للأسس والمعايير الهندسية السليمة، وقد تحررت هذه الشهادة بناءً على طلب سيادته دونى أدنى مسئولية على الشركة.

وتفضلوا سيادتكم بقبول فائق الاحترام

رئيس قطاع الاستشارات
الهندسية والخدمات الفنية
مهندس /
عبد المصطفى

مدير إدارة الشؤون
الفنية والمناخية
مهندس /
أشرف القيسي

بيان العاملين المؤمن عليهم

بيان بأسماء السادة العاملين بالمكتب الاستشاري

لهندسة البنية التحتية ورقم التأمين الخاص بكل منهم ووظيفته
رقم التأمين للمنشأة: ٢٨٠٩٣٨٢ (المعادي)
اسم المنشأة: المكتب الاستشاري لهندسة البنية التحتية
انفرا انجنييرينج

م	الاسم	الوظيفة
١	كريم محمد عبده	مهندس مدني
٢	لمياء إبراهيم	مهندس هيدروليكي
٣	أمل معوض	مهندس هيدروليكي
٤	مروه عبد الظاهر	مهندس معماري
٥	رندا إسماعيل	مهندس مدني
٦	نورهان محمد	مهندس مدني
٧	أسامة مبروك	رسام
٨	أميره منتصر	سكرتارية
٩	محمد فتحي	مندوب
١٠	رضوى محمد صفاء الدين	مهندس
١١	عمر احمد محمد بدر	مهندس

List of office facilities

SL	IT Equipment	Number	model	Description
1	Server	1		Capacity 1 tira
2	Pc	15	lenovo	Core i7, i5 and i3 configuration
3	Personal computer's	5	hp	Core i7, i5 and i3 configuration
4	Plotter	1	HP	Design jet800 A1&A0 paper production
5	Printer	2	canon	IR 2870NE
6	Photocopiers	2	Epson	L382
7	Fax	1	Panasonic	KX –FT503
8	Backup hard desk	2	WD	Capacity 1 tira
9	Presentation LCD	2	Panasonic	32 inch

SL	Topographical & surveying equipment	Number	model
1	Total station	1	Topcon
2	GPS	2	RTK topcon
	Level device	1	Sokia

SL	Transportation facilities	Number
1	Sidan car	1 Opel Astra
2	4 * 4 car	1 GLK