

STATE OF FLORIDA
DEPARTMENT OF TRANSPORTATION

CONTRACT PLANS

FINANCIAL PROJECT ID 196058-1-52-01
(FEDERAL FUNDS)
MANATEE COUNTY (13160)
STATE ROAD NO. 70

LANDSCAPE PLANS

INDEX OF LANDSCAPE PLANS

SHEET NO.	SHEET DESCRIPTION
LD-1	KEY SHEET
LD-2 and LD-3	TABULATION OF QUANTITIES
LD-4	LANDSCAPE NOTES
LD-5 thru LD-11	LANDSCAPE PLANS

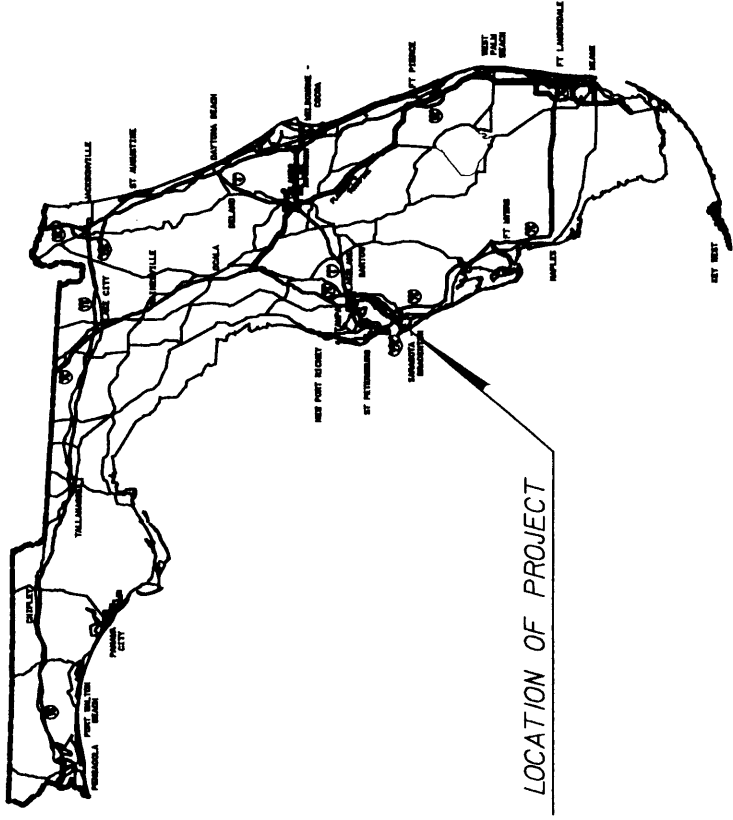

PLANS PREPARED BY:
McDULL LANDSCAPE ARCHITECTURE, INC.
13455 S.W. 137th St. SUITE 100
MIAMI, FLORIDA 33166
CONTRACT NO. C-3089
VENDOR NO. 88

NOTE: THE SCALE OF THESE PLANS MAY
HAVE CHANGED DUE TO REPRODUCTION.

GOVERNING STANDARDS AND SPECIFICATIONS:
FLORIDA DEPARTMENT OF TRANSPORTATION,
DESIGN STANDARDS DATED JANUARY 2002, AND
STANDARDS SPECIFICATIONS FOR ROAD AND BRIDGE
CONSTRUCTION DATED 2000, AS AMENDED BY
CONTRACT DOCUMENTS.

EXHIBIT EX-LD-KS
Date: 1/1/03

KEY SHEET REVISIONS	
DATE	BY DESCRIPTION

LANDSCAPE PLANS
LANDSCAPE ARCHITECT OF RECORD: HELENE McDULL, ASLA

RLA NO.: 06654

FISCAL YEAR	SHEET NO.
01	LD-1

FDOT PROJECT MANAGER: ALBERT M. SIMPSON

Sample Plans

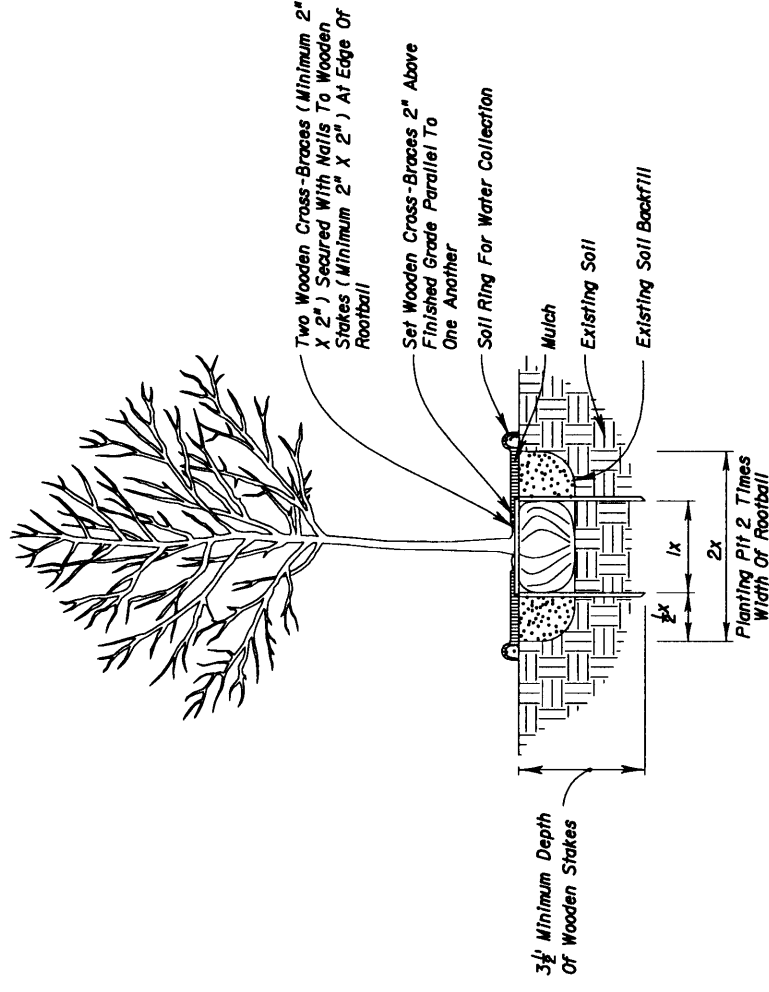
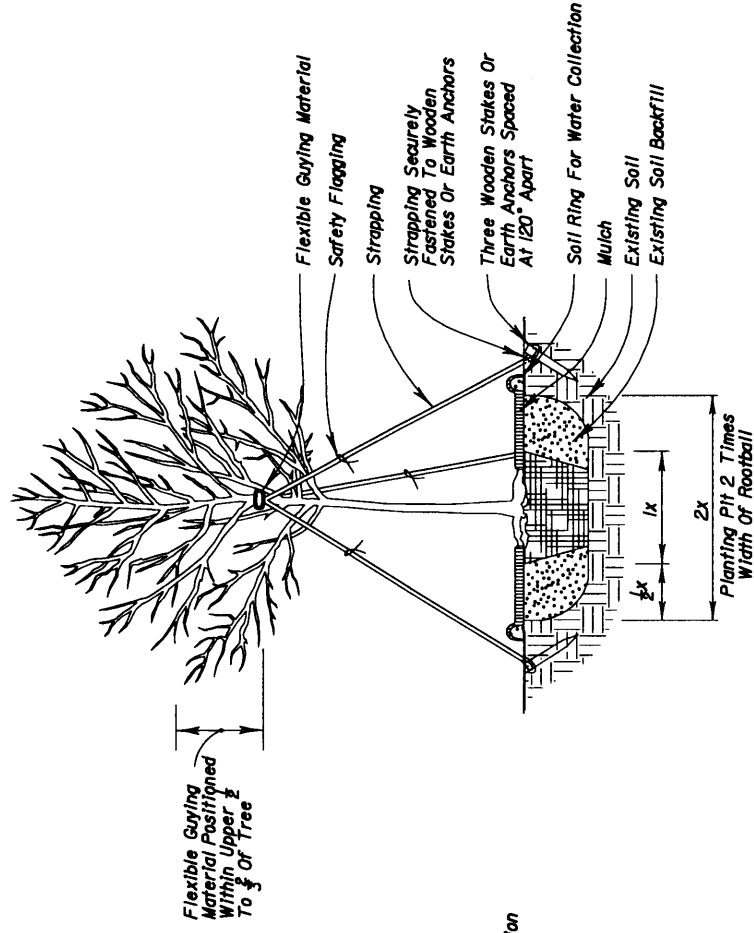
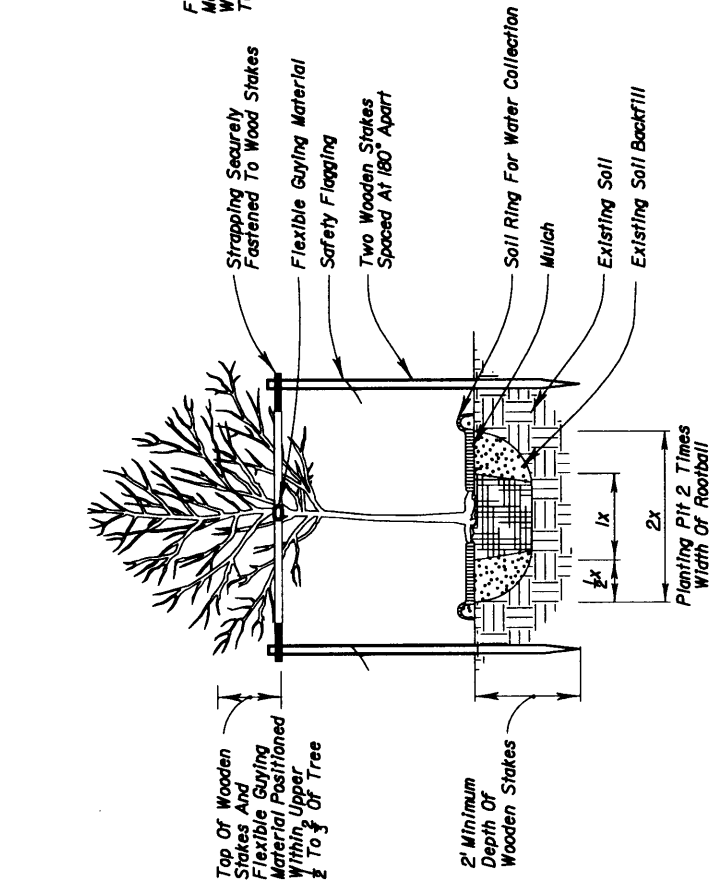
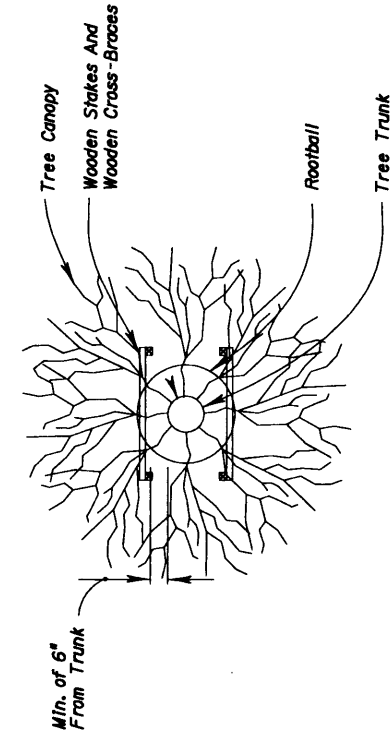
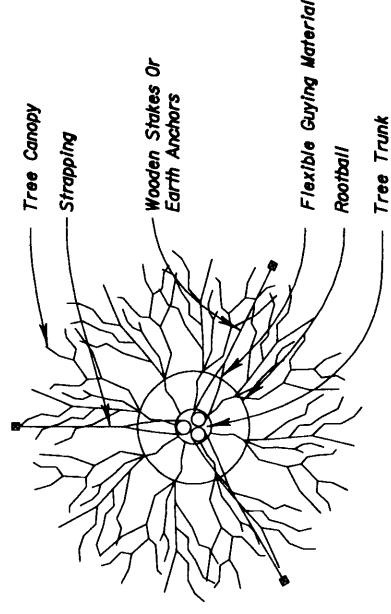
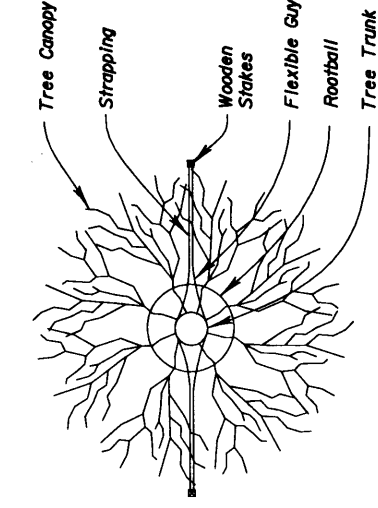

1" - 3 1/2" Caliper Tree Planting

4" and Larger Caliper Tree Planting

Tree Planting With Wooden Stakes

General Notes:

1. All dimensions 6" and less are exaggerated for illustrative purposes only.
 2. Plant containers shall be removed prior to planting. If plants are not container grown, remove a minimum of the top 1/3 of burrap, fabric, or wire mesh.
 3. Rootballs shall be set 1"-2" above finished grade and set plumb to the horizon.
 4. Backfill shall be loosened existing soil. Remove rocks, sticks, or other deleterious material greater than 1" in any direction prior to backfilling. Water and tamp to remove air pockets. If existing soils contain excessive sand, clay, or other material not conducive to proper plant growth contact Engineer prior to planting.
 5. Soil rings shall be constructed of existing soil at the outer edge of the planting pit with a height and width of 6".
 6. Mulch shall be a 3" deep layer placed to the edge of the trunk flare, around the base of shrub, or solidly around groundcover.
 7. Strapping shall be minimum 1" wide nylon or polypropylene. Guying material in contact with tree shall be soft, pliable, and flexible plastic or rubber. securely fastened to wooden stakes. All wooden stakes or earth anchors shall be located beyond the edge of soil ring and located below finished grade.
 8. Sabal Palms may be hurricane cut. All other palms must have fronds tied with biodegradable strap. Palm trunks shall have no burn marks, scars, or sanding.
 9. All dimensions provided for wooden materials are nominal.
 10. When a permanent, subsurface, or drip irrigation system is provided a soil ring is not required. Mulch to edge of planting pit.
11. Commercial tree bracing systems approved by the Engineer may be used in lieu of the tree bracing methods detailed on the Index.



2006 FDOT Design Standards

LANDSCAPE INSTALLATION

Last Revision
07/01/05

Sheet No.
1 of 3
Index No.
544

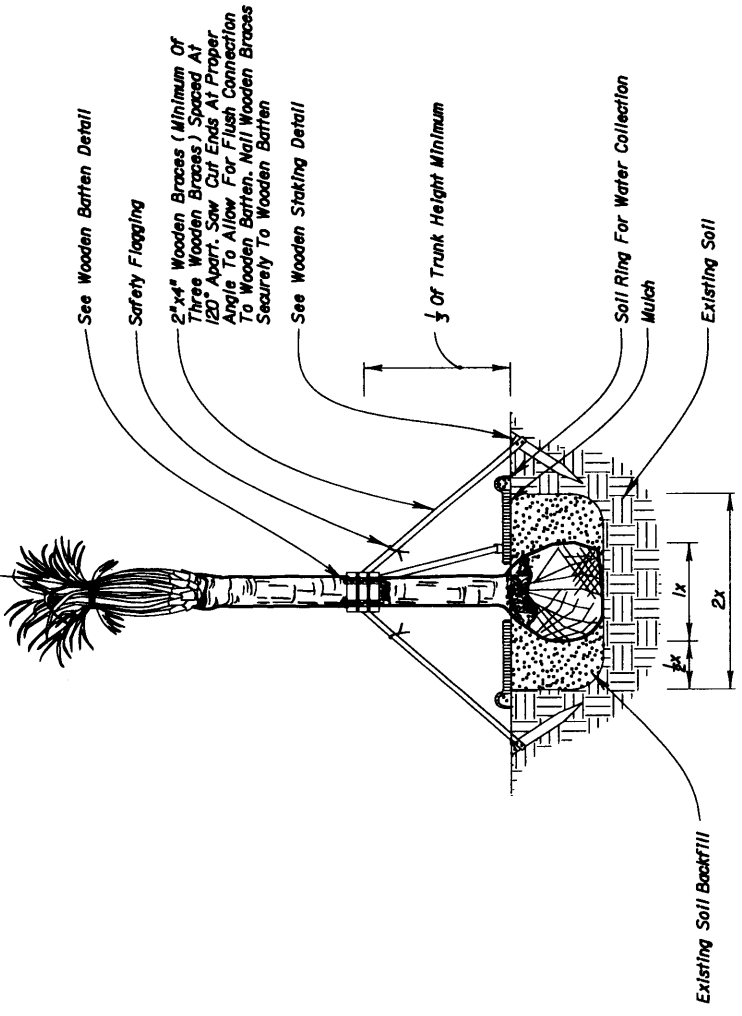

Palm Planting For Up To 10' Clear Trunk
 NOTE: For All Palms Over 10' Clear Trunk, Use Installation Detail Provided By Landscape Architect In Contract Plans.

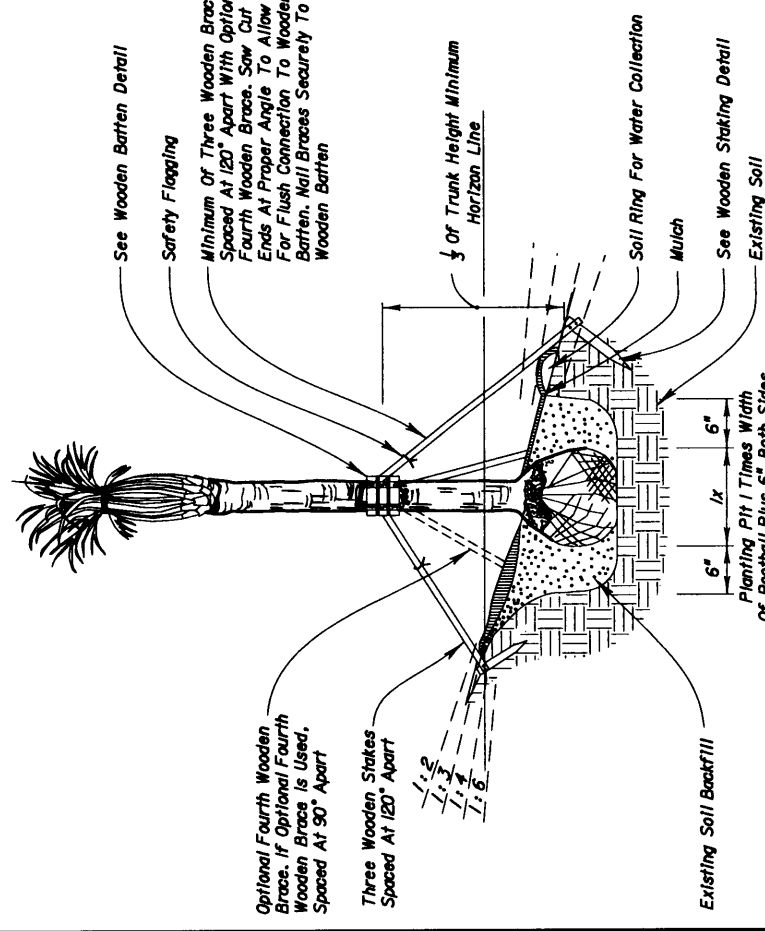

Palm Planting On Slope For Up To 10' Clear Trunk
 NOTES: Slope Provided As Rise:Run. For All Palms Over 10' Clear Trunk, Use Installation Detail Provided By Landscape Architect In Contract Plans.

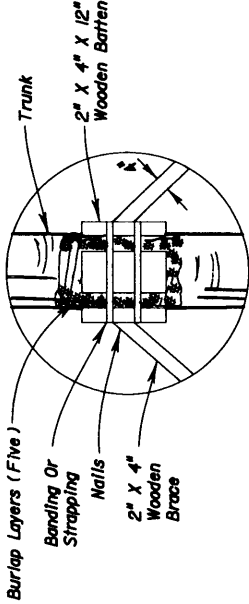

Wooden Batten Detail

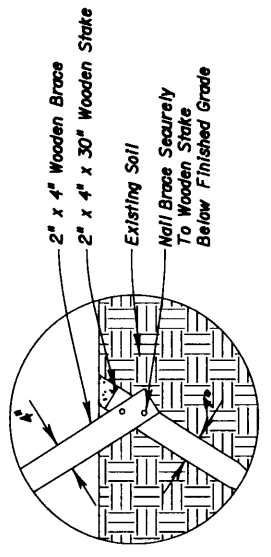

Wooden Staking Detail
 NOTE: Stake Into Firm, Existing Soil.

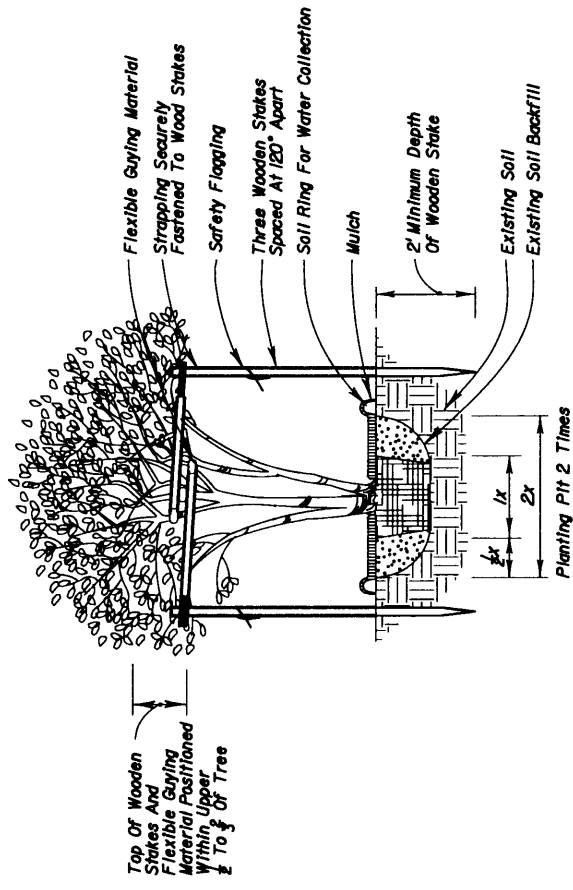
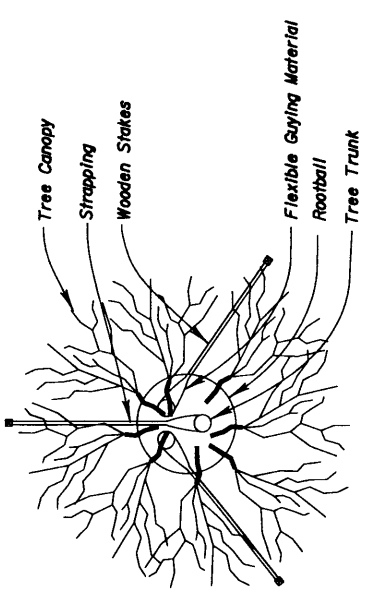

Multi-Trunk Tree Planting

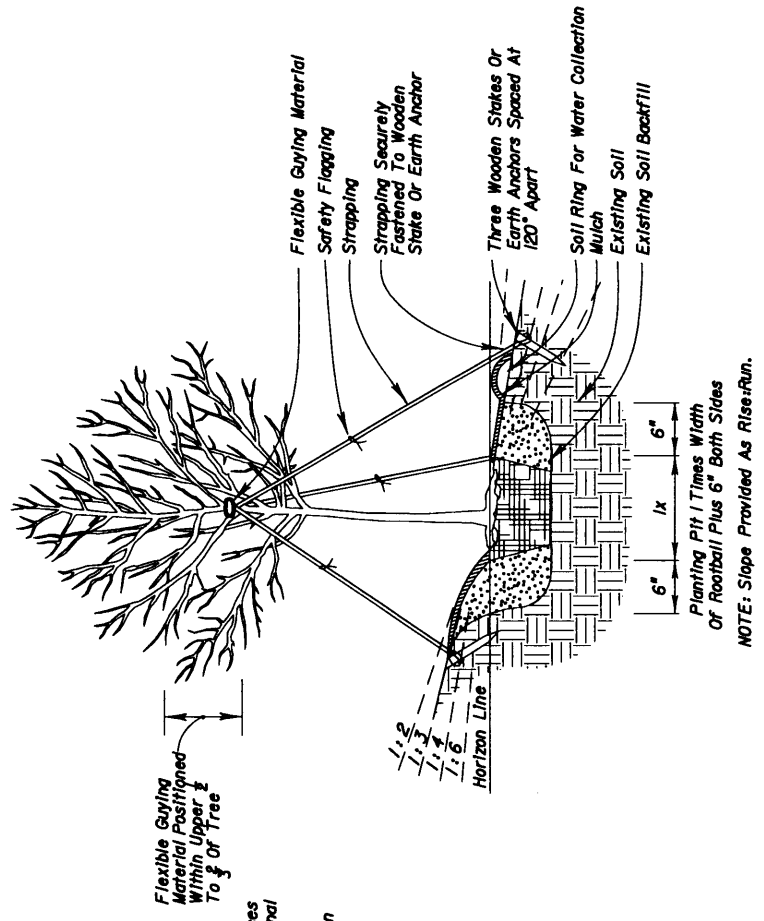

4\"/>

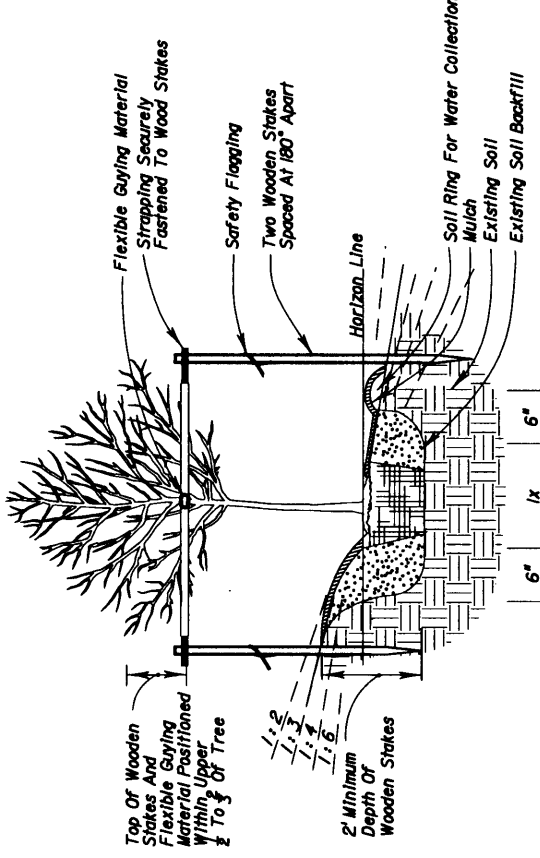

1\"/>



##STANDARD YEAR##

LANDSCAPE INSTALLATION

Index No. **544**

Sheet No. 2 of 3

07/01/05

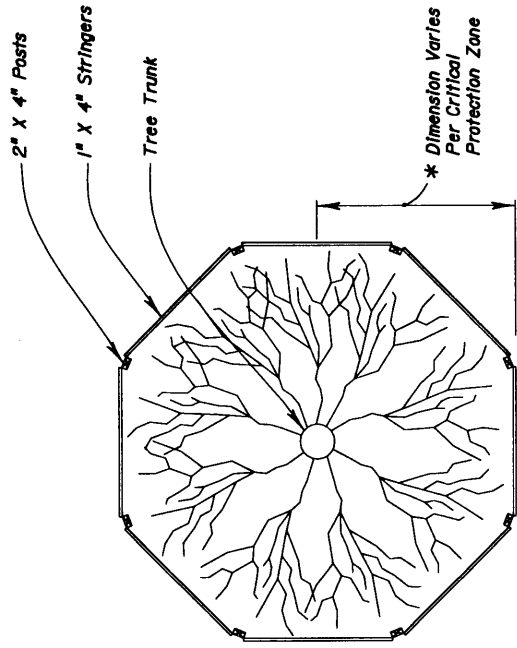

NOTE: For Groups Of Trees, Place Barricades Between Trees And Construction Activity.

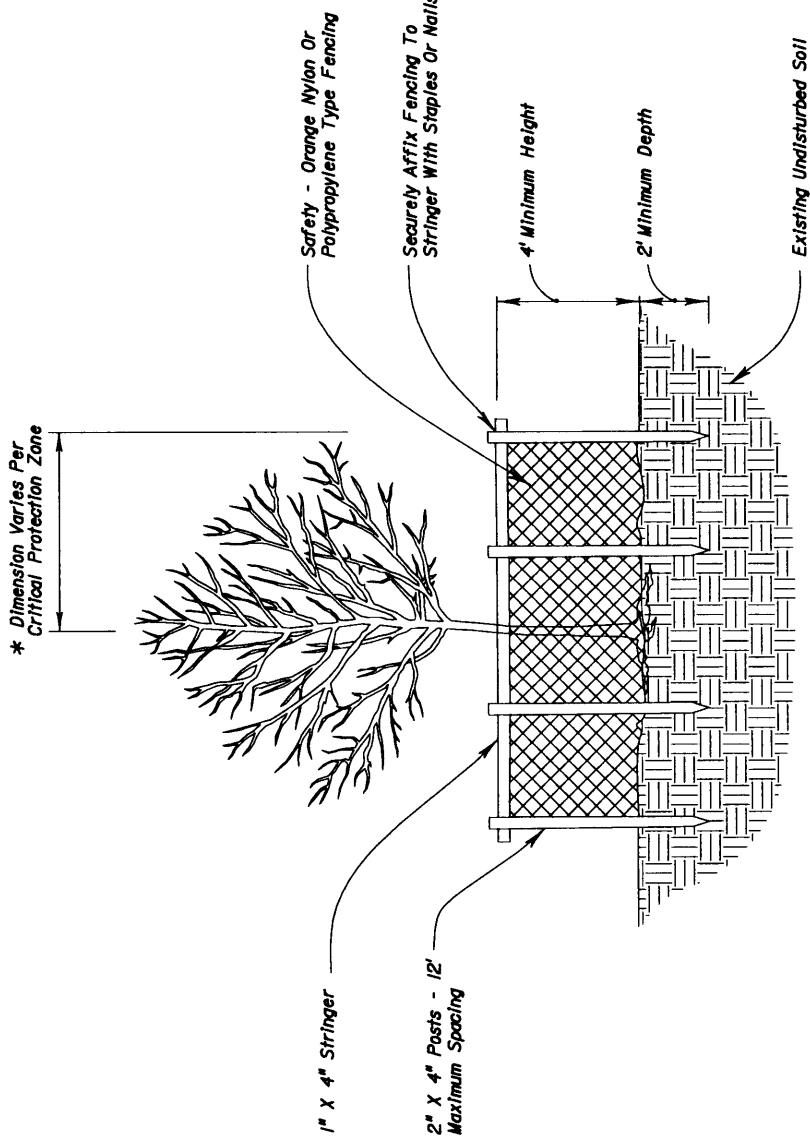

NOTES: Critical Protection Zone: The Area Surrounding A Tree Within A Circle Described By A Radius Of One Foot For Each Inch Of The Tree Trunk Diameter At 54\"/>

* Tree Protection Barricades Shall Be Located To Protect A Minimum Of 75% Of The Critical Protection Zone.

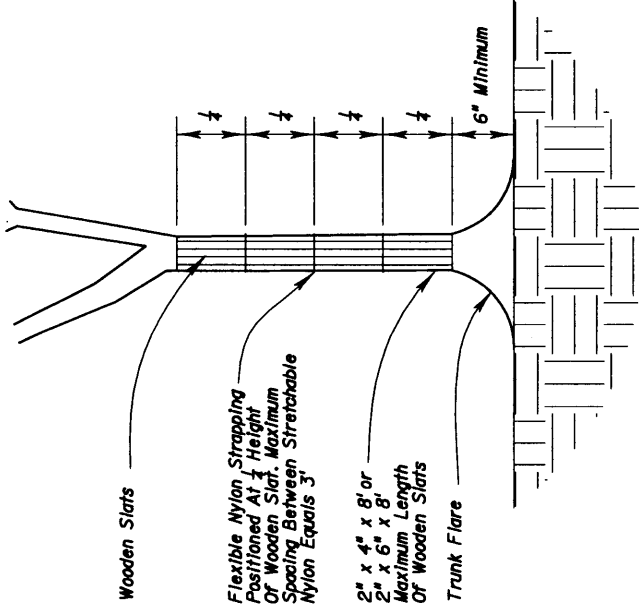

Tree Protection

NOTE: To Be Used When Tree Protection Barricade Can Not Be Provided Due To Roadway Construction, Project Limits, Or Other Existing Constraints.

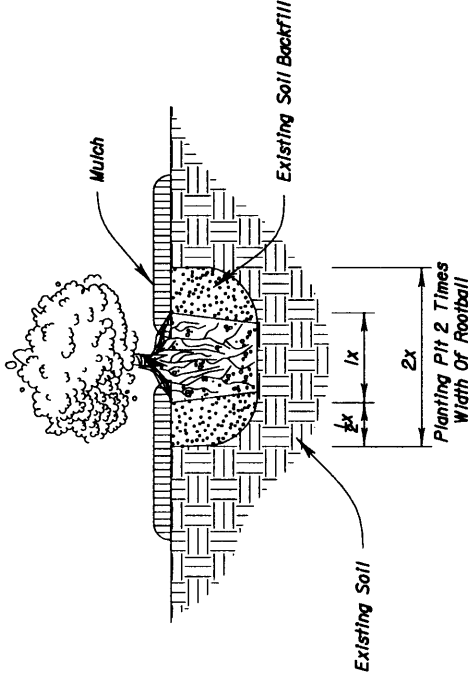

Ground Cover/Shrub Planting

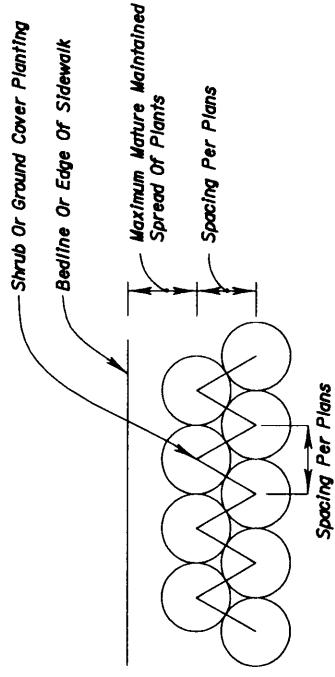

Ground Cover/Shrub Layout Detail

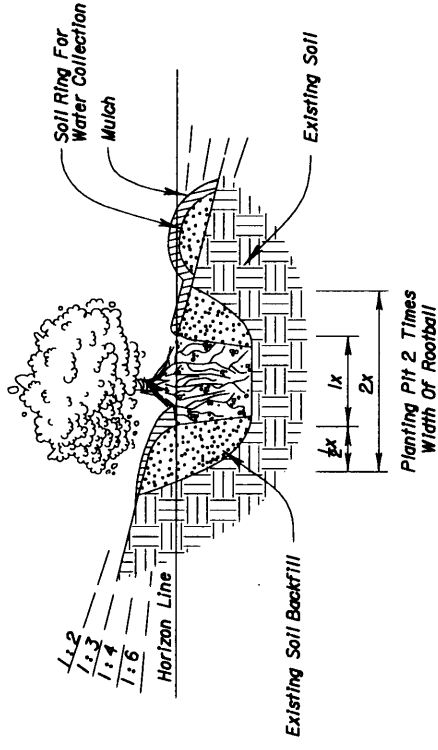

NOTE: Slope Provided As Rise:Run.

Ground Cover/Shrub Planting On Slope



2006 FDOT Design Standards

LANDSCAPE INSTALLATION

Last Revision 07/01/05

Sheet No. 3 of 3

Index No.

544

GENERAL NOTES

1. All plantings shall be installed per Index Nos. 544 and 546, as well as Section 580 of the Standard Specifications for Road and Bridge Construction.
2. The Contractor shall avoid, directly or indirectly, any mitigation areas or jurisdictional wetlands as noted while performing specified work.
3. All palms shall be de-booted and hurricane cut prior to planting. Any palm with boots remaining on trunk below the bud will be rejected.
4. All planting areas adjacent to pavement shall have a finish grade of soil no less than 2 1/2" below the top pavement/curb per Standard Index No. 105.

PAY ITEM NOTES

1. 580-173 Bed Preparation - Payment for this item includes the cost for mowing, debris removal, herbicides, application of finish soil layer and mulch. Bed preparation shall be performed as follows:
 - A. Mow existing vegetation to 1" height maximum.
 - B. Apply two (2) applications of Post-emergent herbicide within a 14-day period. Post-emergent shall be: XXX or approved equal applied as per manufacturer's recommended application rate and application requirements. Sod root structure shall remain in place.
 - C. Apply (1) one application of an approved granular pre-emergent herbicide.
 - D. Install plantings and backfill pits per Index No. 544 and Specification 580-4.4. Refer to manufacturer's specifications for additional requirements of all herbicides.
2. 580-326-1 Mulch - Payment for this item included the mulch around trees not included in planting beds estimated at 1 SY per free standing tree.
3. 581 and 582 Groundcovers and Shrubs - payment for these items includes an approved fertilizer for all planting beds applied at the rate of 3 pounds per 10 SY of bed area.

EXHIBIT EX-LD-N
 Date: 1/1/03

REVISIONS		STATE OF FLORIDA		DEPARTMENT OF TRANSPORTATION		SHEET NO.
DATE	BY	ROAD NO.	COUNTY	FINANCIAL PROJECT ID	LANDSCAPE NOTES	
		70	MANATEE	196058-1-52-01		
		HELENE MCDULL RLA NO. 06654 MCDULL LANDSCAPE ARCHITECTURE, INC. 13455 S.W. 137th St. SUITE 100 MIAMI, FLORIDA 33166				

MATCH LINE STA. 123+20 CONST.

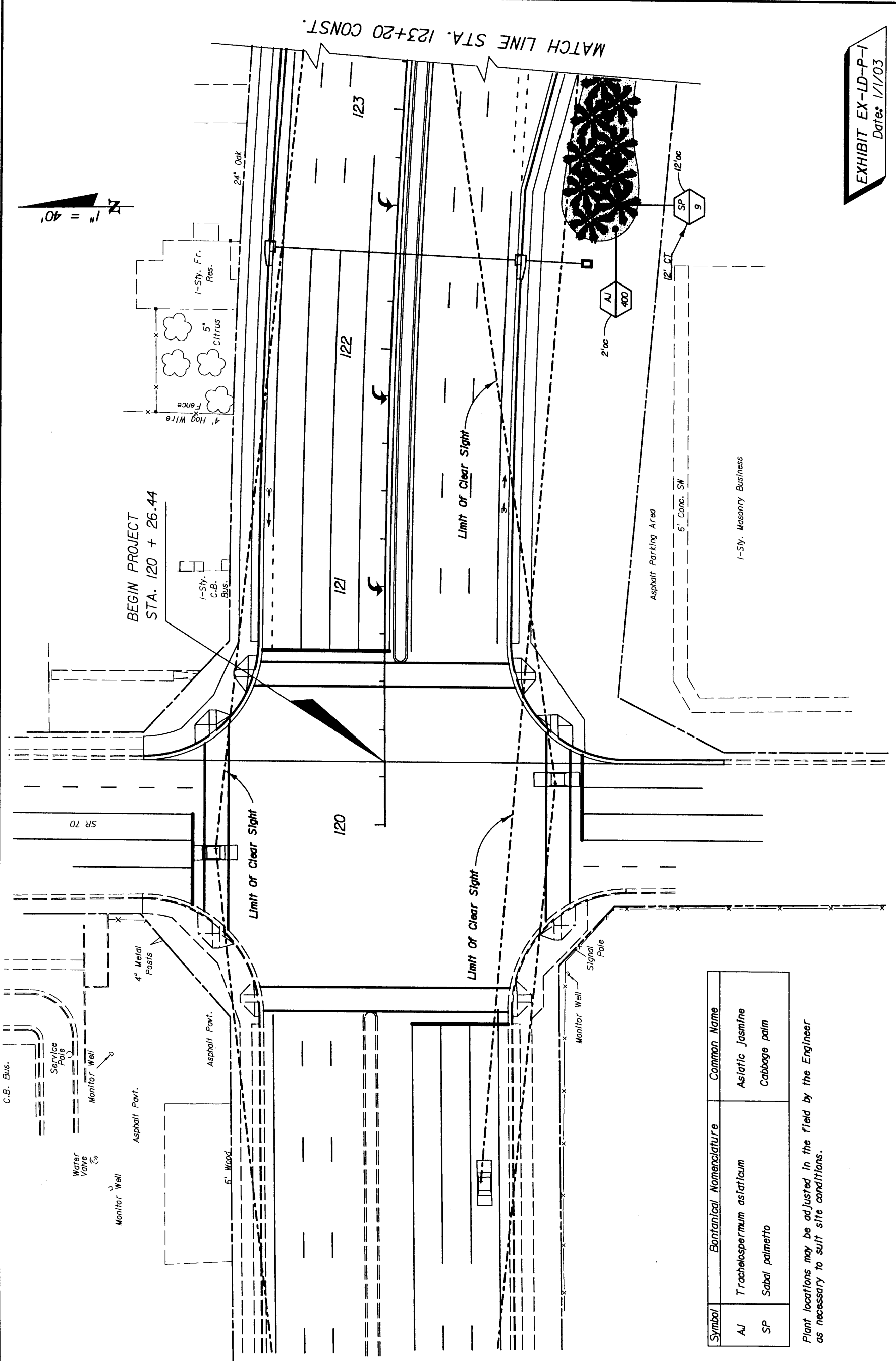
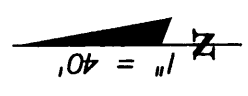

BEGIN PROJECT
STA. 120 + 26.44

Limit of Clear Sight

Limit of Clear Sight

Symbol	Botanical Nomenclature	Common Name
AJ	<i>Trachelospermum asiaticum</i>	Asiatic Jasmine
SP	<i>Sabal palmetto</i>	Cabbage palm

Plant locations may be adjusted in the field by the Engineer as necessary to suit site conditions.

EXHIBIT EX-LD-P-1
Date: 1/1/03

REVISIONS		STATE OF FLORIDA		DEPARTMENT OF TRANSPORTATION		LANDSCAPE PLAN		
DATE	BY	DESCRIPTION	ROAD NO.	COUNTY	FINANCIAL PROJECT ID	SHEET NO.		
			70	MANATEE	196058-1-52-01		LD-5	
HELENE McDULL RLA NO. 06654 McDULL LANDSCAPE ARCHITECTURE, INC. 13455 S.W. 137th St. SUITE 100 MIAMI, FLORIDA 33166								

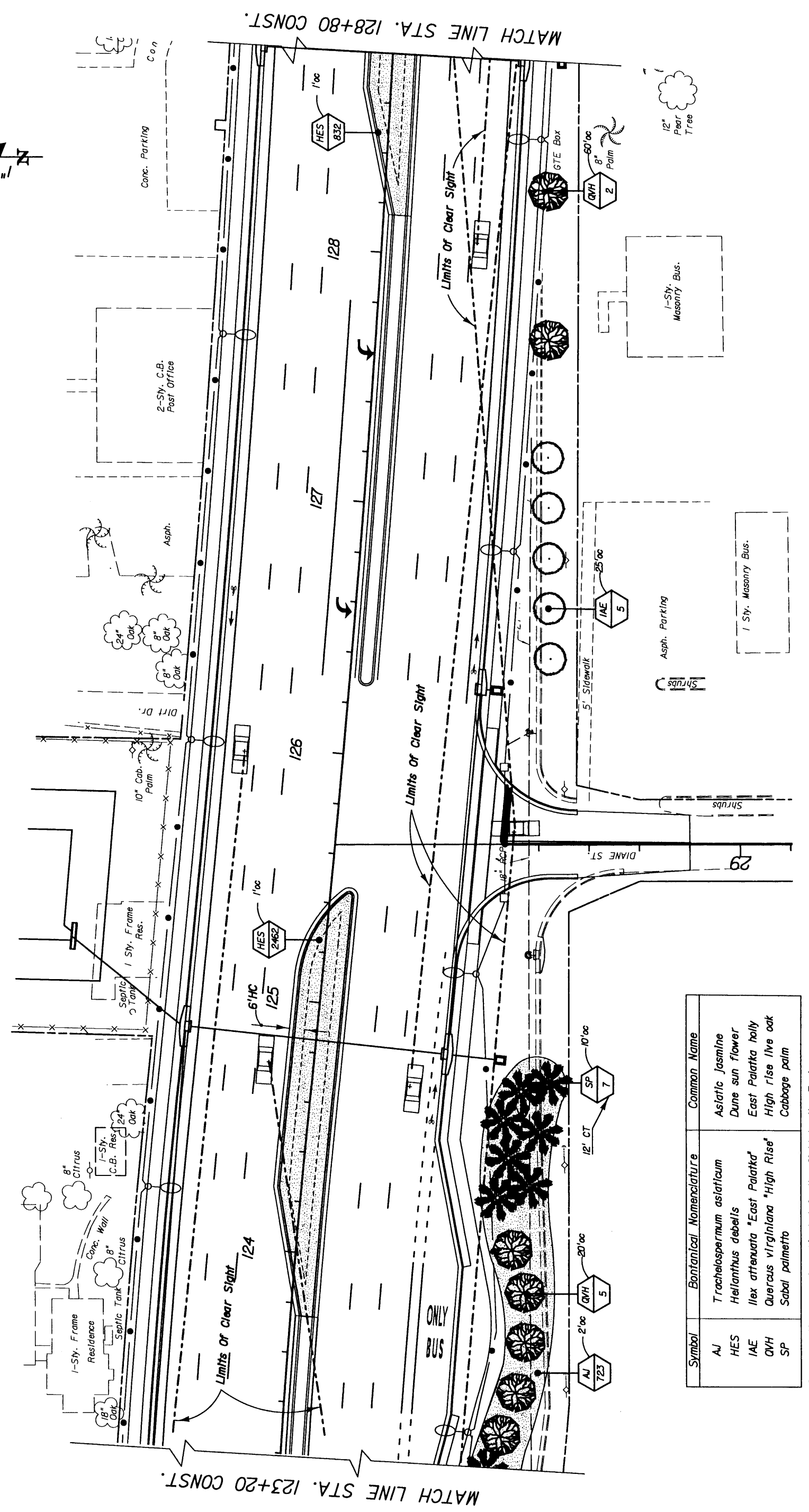
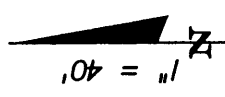

Symbol	Botanical Nomenclature	Common Name
AJ	<i>Trachelospermum asiaticum</i>	Asiatic Jasmine
HES	<i>Helianthus debelis</i>	Dune sun flower
IAE	<i>Ilex attenuata</i> "East Palatka"	East Palatka holly
QVH	<i>Quercus virginiana</i> "High Rise"	High rise live oak
SP	<i>Sabal palmetto</i>	Cabbage palm

Plant locations may be adjusted in the field by the Engineer as necessary to suit site conditions.

EXHIBIT EX-LD-P-2
Date: 1/1/03

REVISIONS		STATE OF FLORIDA		DEPARTMENT OF TRANSPORTATION		FINANCIAL PROJECT ID	
DATE	BY	DESCRIPTION	ROAD NO.	COUNTY	MANATEE	196058-1-52-01	SHEET NO.
			70	MANATEE			LD-6
HELENE MCDULL FLA NO. 06654 MCDULL LANDSCAPE ARCHITECTURE, INC. 13455 S.W. 137th St. SUITE 100 MIAMI, FLORIDA 33166			LANDSCAPE PLAN				

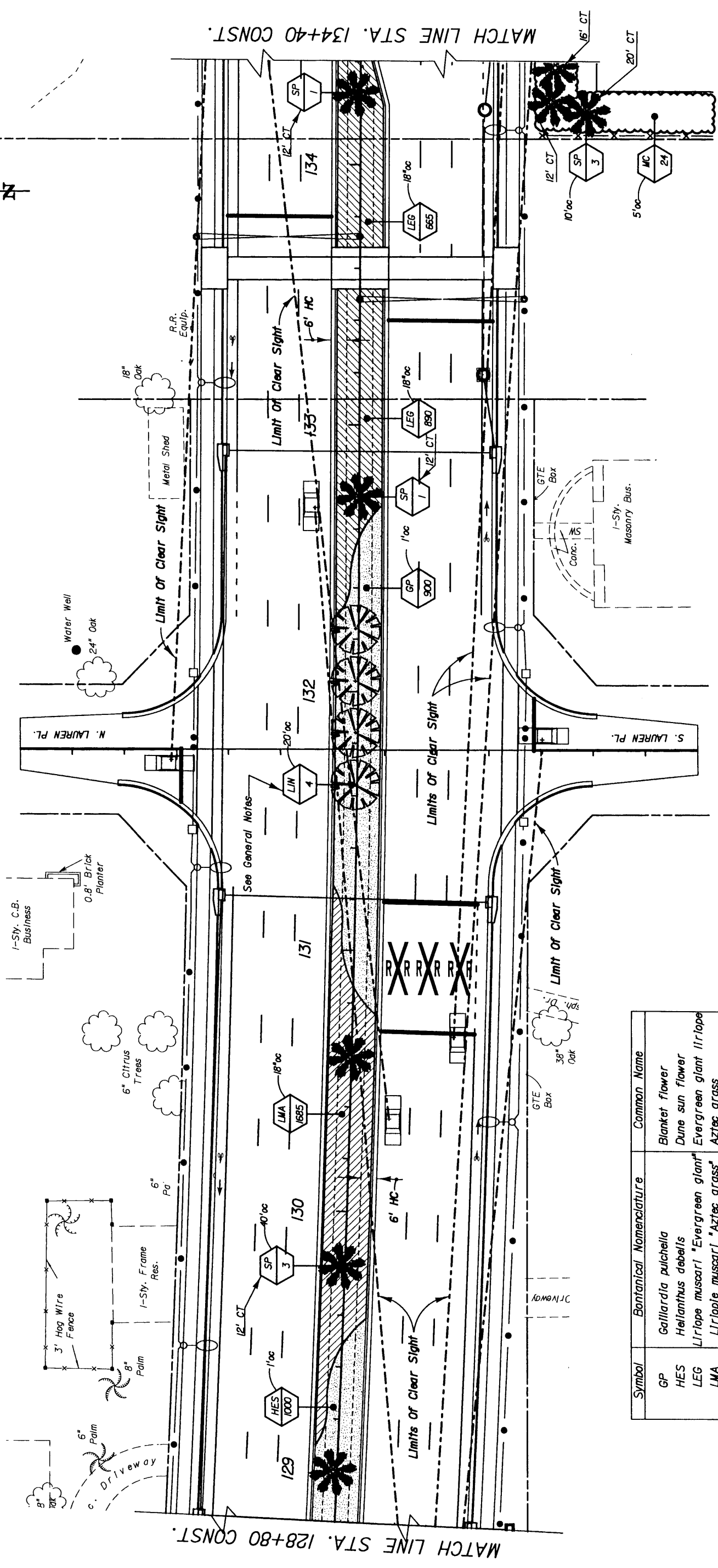
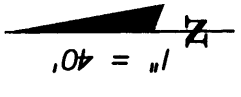

MATCH LINE STA. 134+40 CONST.

MATCH LINE STA. 128+80 CONST.

See General Notes

Plant locations may be adjusted in the field by the Engineer as necessary to suit site conditions.

Symbol	Botanical Nomenclature	Common Name
GP	<i>Gaillardia puchella</i>	Blanket flower
HES	<i>Helianthus debilis</i>	Dune sun flower
LEG	<i>Liriope muscari</i> "Evergreen glant"	Evergreen giant liriope
LMA	<i>Liriope muscari</i> "Aztec grass"	Aztec grass
MC	<i>Myrica cerifera</i>	Wax myrtle
LIN	<i>Lagerstroemia indica</i> "Natchez"	Crape myrtle
SP	<i>Sabal palmetto</i>	Cabbage palm

EXHIBIT EX-LD-P-3
Date: 1/1/03

REVISIONS		DESCRIPTION	
DATE	BY	DATE	BY

HELENE MCDULL RLA NO. 06654 MCDULL LANDSCAPE ARCHITECTURE, INC. 13455 S.W. 137th St. SUITE 100 MIAMI, FLORIDA 33166		STATE OF FLORIDA DEPARTMENT OF TRANSPORTATION	SHEET NO.
ROAD NO. 70	COUNTY MANATEE	FINANCIAL PROJECT ID 196056-1-52-01	LD-7

LANDSCAPE PLAN

Symbol	Botanical Nomenclature	Common Name
LEG	<i>Liriodendron tulipifera</i> "Evergreen giant"	Evergreen giant liriodendron
MC	<i>Myrica caribaea</i>	Wax myrtle
NO	<i>Nerium oleander</i>	Oleander
QVH	<i>Quercus virginiana</i> "Heritage"	Heritage live oak
IH	<i>Iris hexagona</i> "Iridaceae"	Iris
PP	<i>Pinus palustris</i>	Long leaf pine
TD	<i>Taxodium distichum</i>	Bald Cypress

Plant locations may be adjusted in the field by the Engineer as necessary to suit site conditions.

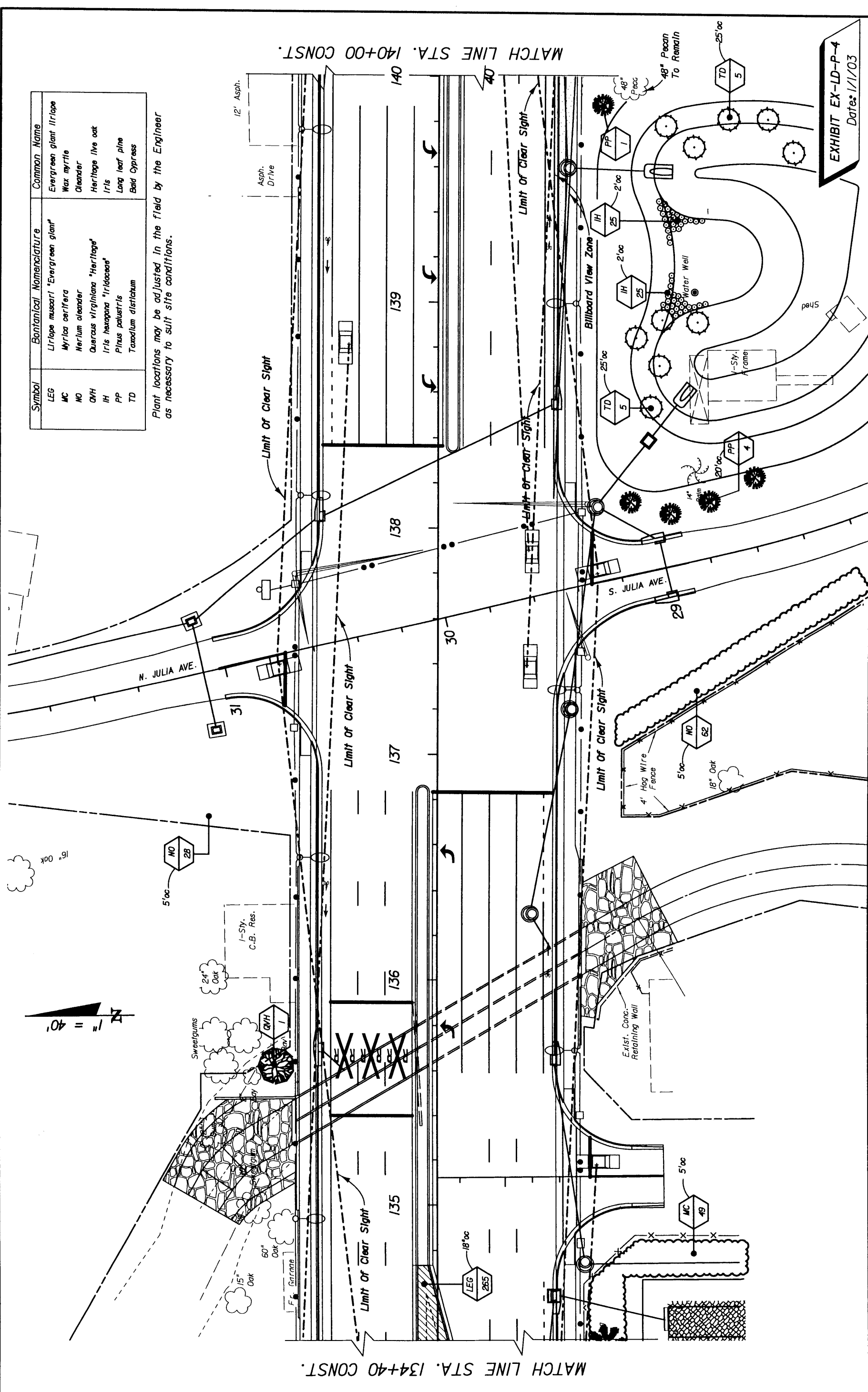
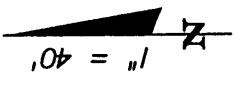

EXHIBIT EX-LD-P-4
Date: 1/1/03

REVISIONS		DESCRIPTION	
DATE	BY	DATE	BY

HELENE MCDULL R/LA NO. 06654 MCDULL LANDSCAPE ARCHITECTURE, INC. 13455 S.W. 137th St. SUITE 100 MIAMI, FLORIDA 33166		STATE OF FLORIDA DEPARTMENT OF TRANSPORTATION	SHEET NO.
ROAD NO. 70	COUNTY MANATEE	FINANCIAL PROJECT ID 196058-1-52-01	LD-8



Symbol	Botanical Nomenclature	Common Name
LEG	<i>Liriope muscari</i> "Evergreen giant"	Evergreen giant liriope
LIN	<i>Lagerstroemia indica</i> "Natchez"	Crape myrtle
PP	<i>Pinus palustris</i>	Long leaf pine

Plant locations may be adjusted in the field by the Engineer as necessary to suit site conditions.

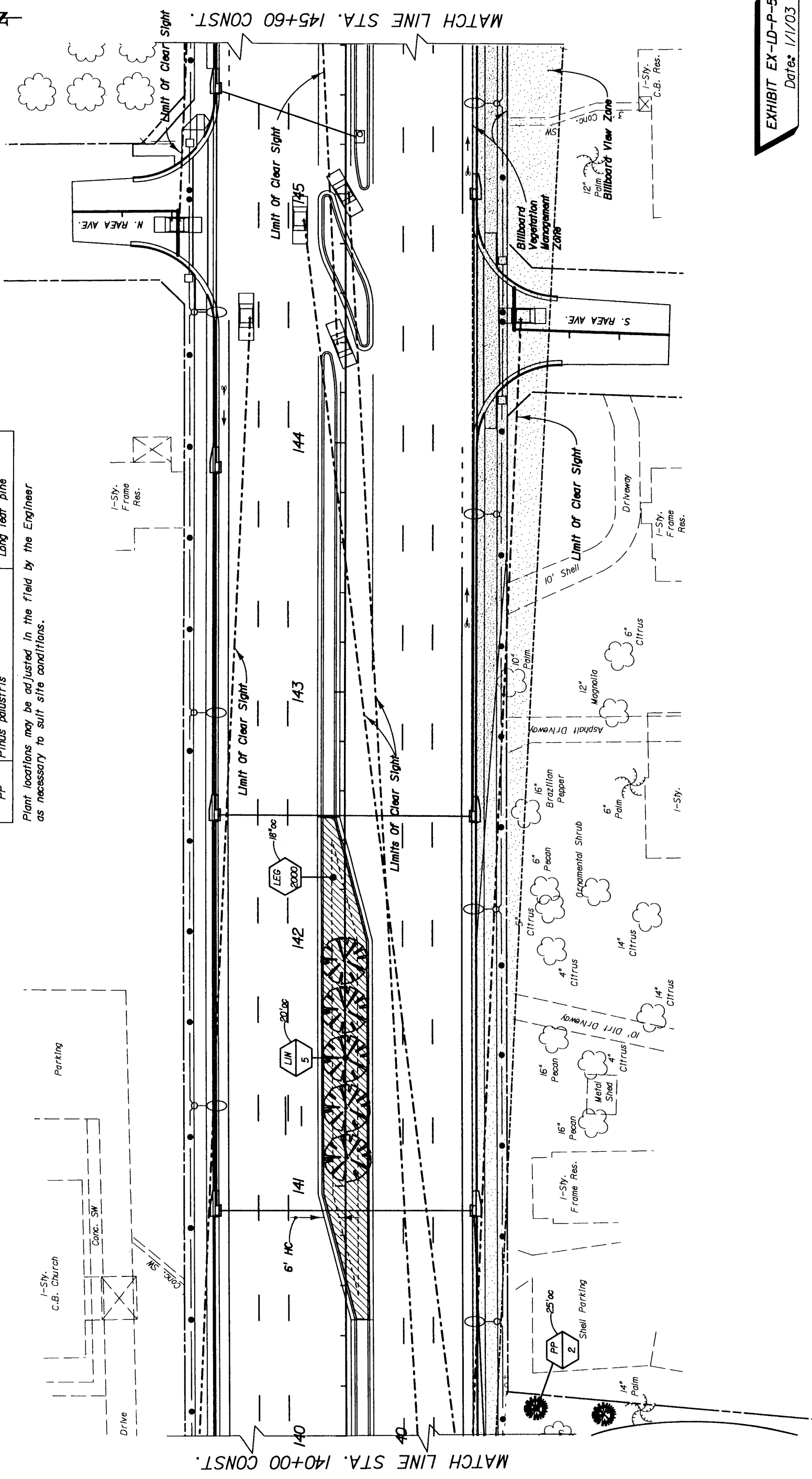
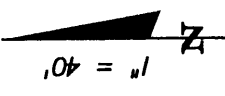

EXHIBIT EX-LD-P-5
Date: 1/1/03

REVISIONS		STATE OF FLORIDA			
DATE	BY	DEPARTMENT OF TRANSPORTATION	SHEET NO.		
		ROAD NO. 70	LD-9		
		COUNTY MANATEE			
		FINANCIAL PROJECT ID 196058-1-52-01			
		LANDSCAPE PLAN			
		HELENE MCGULL RLA NO. 06654 MCGULL LANDSCAPE ARCHITECTURE, INC. 13455 S.W. 137th St. SUITE 100 MIAMI, FLORIDA 33166			
DATE	BY	DESCRIPTION	DATE	BY	DESCRIPTION



WES CARSON ELEMENTARY SCHOOL

Symbol	Botanical Nomenclature	Common Name
LEG	Liriope muscari "Evergreen giant"	Evergreen giant liriope
RI	Rapheolepis indica	Dwarf India hawthorn
LN	Lagerstroemia indica "Natchez"	Crape myrtle

Plant locations may be adjusted in the field by the Engineer as necessary to suit site conditions.

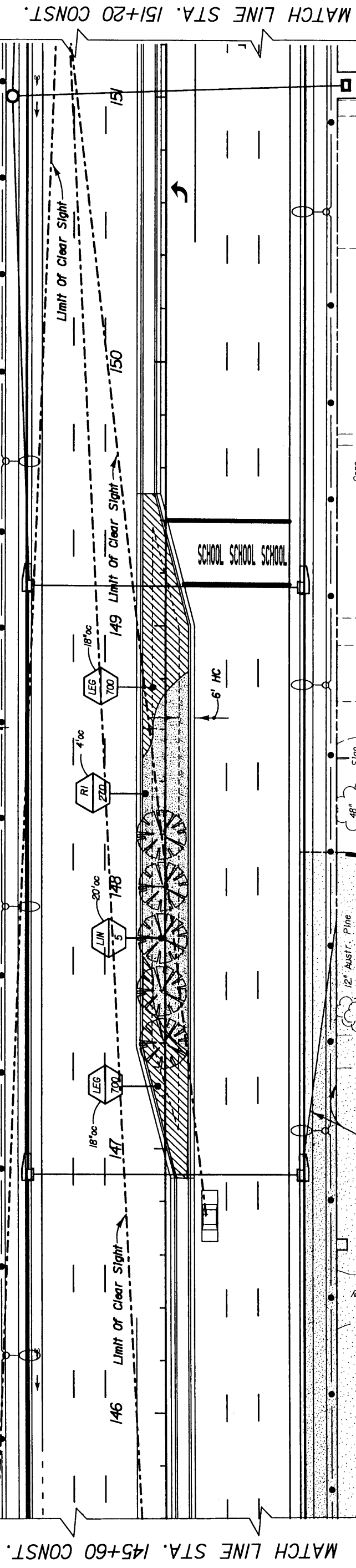
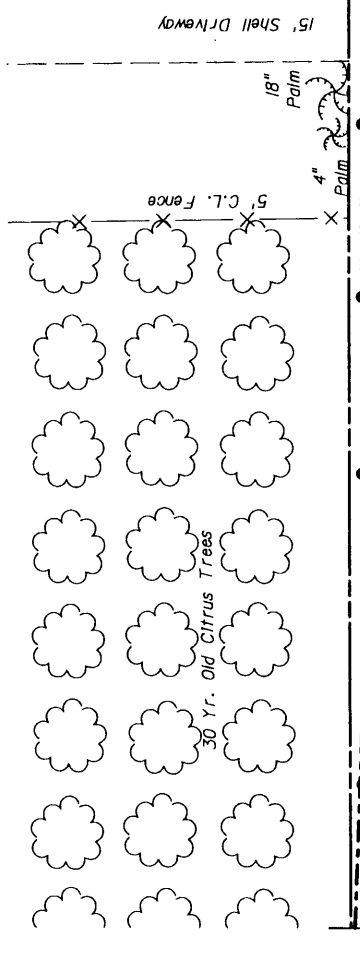

EXHIBIT EX-LD-P-6
Date: 1/1/03

SHEET NO.
LD-10

LANDSCAPE PLAN

STATES OF FLORIDA
DEPARTMENT OF TRANSPORTATION
ROAD NO. 70
COUNTY MANATEE
FINANCIAL PROJECT ID 196058-1-52-01

HELENE MCGULL
RLA NO. 06654
MCGULL LANDSCAPE ARCHITECTURE, INC.
13455 S.W. 137th St. SUITE 100
MIAMI, FLORIDA 33166

REVISIONS		DATE	BY	DESCRIPTION

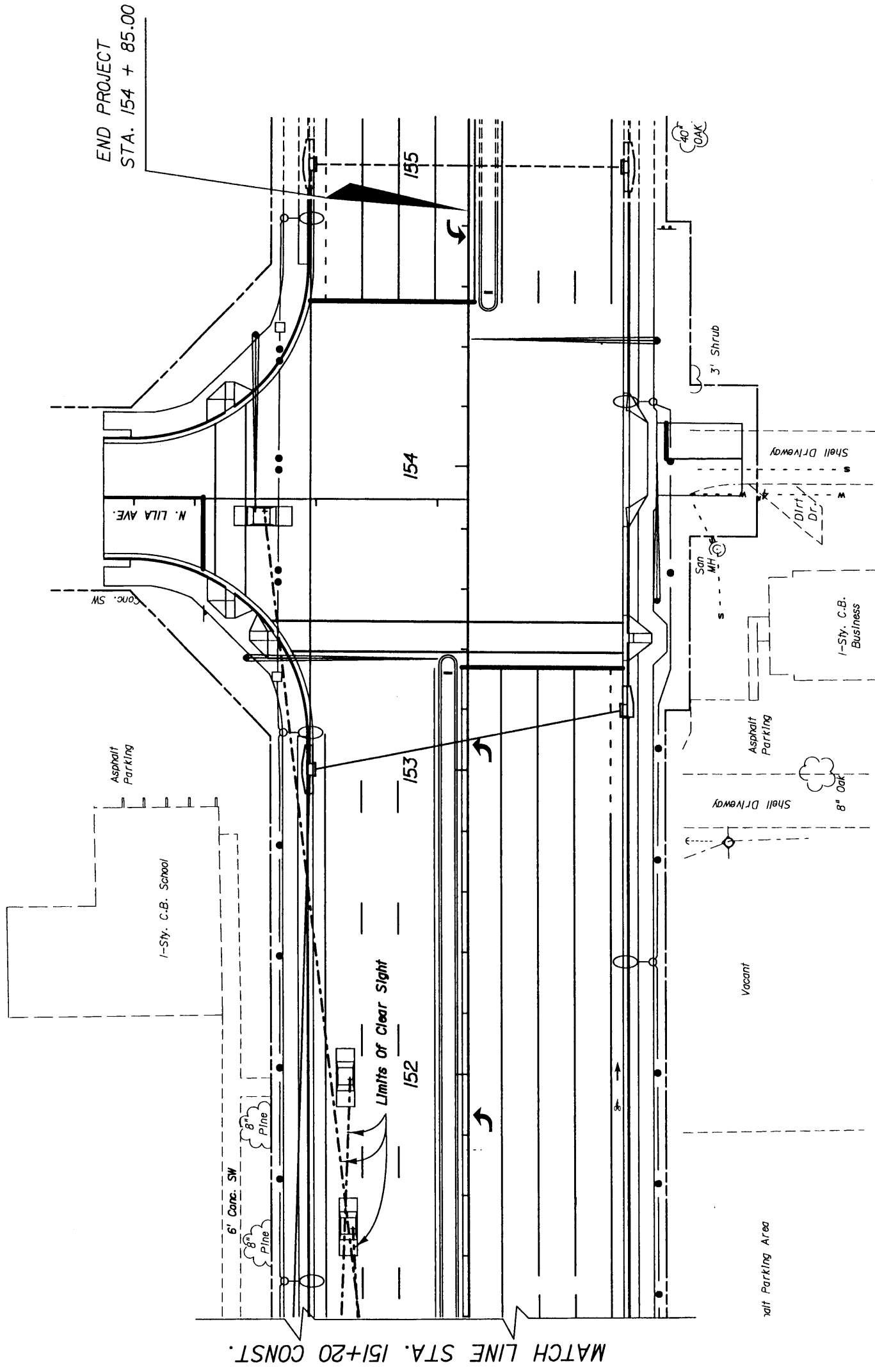
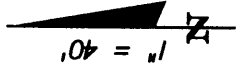

EXHIBIT EX-LD-P-7
Date: 1/1/03

SHEET NO.
LD-II

LANDSCAPE PLAN

STATES OF FLORIDA
DEPARTMENT OF TRANSPORTATION
ROAD NO. 70 COUNTY MANATEE FINANCIAL PROJECT ID 196058-1-52-01

HELENE MCDULL
RLA NO. 06654
MCDULL LANDSCAPE ARCHITECTURE, INC.
13455 S.W. 157th St. SUITE 100
MIAMI, FLORIDA 33166

REVISIONS		DATE	BY	DESCRIPTION