



- Application Site Boundary
- Species-rich Marshy Grassland
- Marshy/Marshy Grassland
- Broadleaved Woodland
- Dense Continuous Scrub
- Scattered Scrub
- Tall Ruderal
- SI Poor Semi-improved Grassland
- SI Semi-improved Neutral Grassland
- Ephemeral/Short Perennial
- Bare Ground
- Buildings
- Allotment Sheds
- Hardstanding
- Hardstanding/Bare Ground
- Scattered Rushes
- Intact Species-rich Hedgerow and Trees
- Intact Species-rich Hedgerow
- Intact Species-poor Hedgerow and Trees
- Defunct Species-rich Hedgerow
- Defunct Species-poor Hedgerow
- Scattered Broadleaved Trees
- Running Water and Direction of Water Flow
- Dry Ditch
- Wall
- Fence
- Japanese Knotweed

client
Lewis Homes Ltd

project title
Land at Mill Street, Tonyrefail

drawing title
Plan EDP 3: Extended Phase 1 Habitat Plan

date	11 NOVEMBER 2020	drawn by	AG
drawing number	edp5669_d012a	checked	LL
scale	1:1,500 @ A3	QA	RB



Registered office: 01285 740427 - www.edp-uk.co.uk - info@edp-uk.co.uk

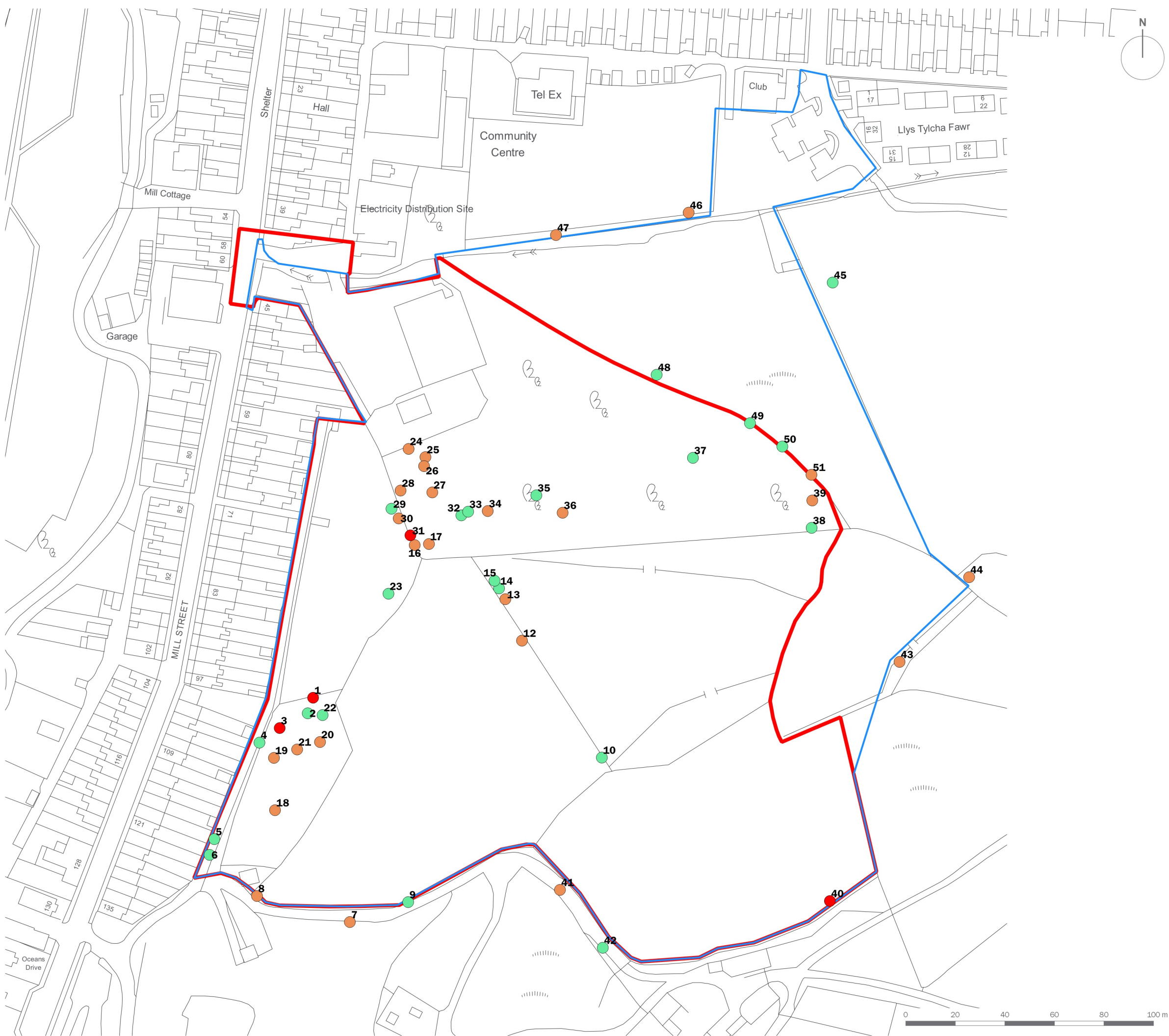

Application Site Boundary

Study Area

Bat Roost Potential

- High Tree Roost Potential
- Moderate Tree Roost Potential
- Low Tree Roost Potential

client

Lewis Homes Ltd

project title

Land at Mill Street, Tonyrefail

drawing title

Plan EDP 4a: Ground Level Bat Tree Assessment, August 2019

date	11 NOVEMBER 2020	drawn by	MC
drawing number	edp5669_d006	checked	LL
scale	1:1,500 @ A3	QA	RB



Registered office: 01285 740427 - www.edp-uk.co.uk - info@edp-uk.co.uk

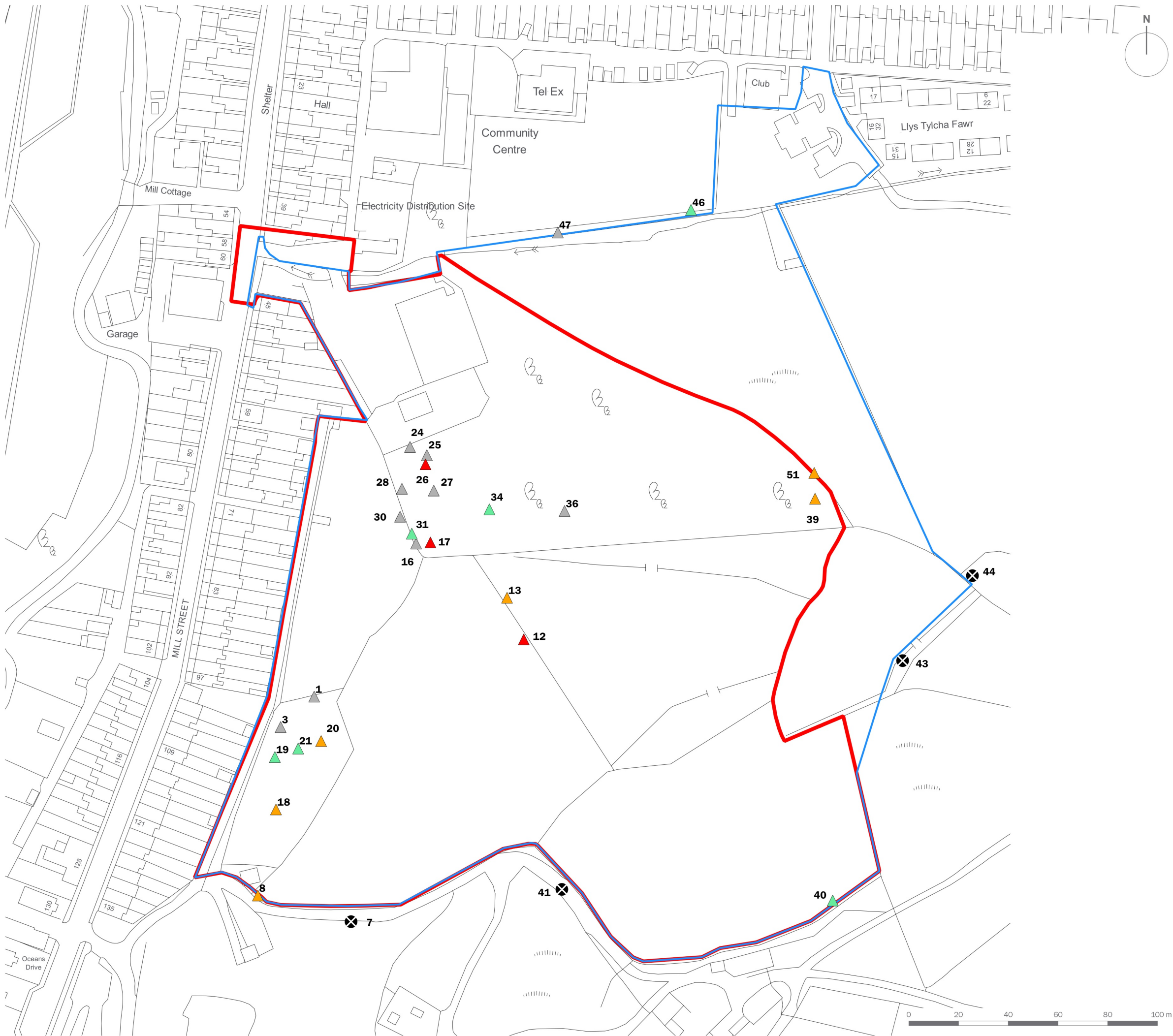

- Application Site Boundary
- Study Area

- Bat Roost Potential**
- ▲ High Tree Roost Potential
 - ▲ Moderate Tree Roost Potential
 - ▲ Low Tree Roost Potential
 - ▲ Negligible Tree Roost Potential
 - ⊗ Scoped Out

client
Lewis Homes Ltd

project title
Land at Mill Street, Tonyrefail

drawing title **Plan EDP 4b: Aerial Bat Tree Assessment (Undertaken September 2019, October 2019 & January 2020)**

date	11 NOVEMBER 2020	drawn by	AG
drawing number	edp5669_d007	checked	LL
scale	1:1,500 @ A3	QA	RB



Registered office: 01285 740427 - www.edp-uk.co.uk - info@edp-uk.co.uk



- Application Site Boundary
- Study Area
- 1 Transect 1
- 1 Transect 2
- A Anabat ID

Anabat Locations

- A August 2019
- C September 2019
- E October 2019
- G April 2020
- I May 2020

client	Lewis Homes Ltd	
project title	Land at Mill Street, Tonyrefail	
drawing title	Plan EDP 5: Automatic Detector Locations and Transect Routes	
date	11 NOVEMBER 2020	drawn by AG
drawing number	edp5669_d008b	checked EMC
scale	1:1,500 @ A3	QA RB



Registered office: 01285 740427 - www.edp-uk.co.uk - info@edp-uk.co.uk



- Application Site Boundary
- Study Area
- 1 Dormouse Tube ID
- Dormouse Tube Locations

client
Lewis Homes Ltd

project title
Land at Mill Street, Tonyrefail

drawing title
Plan EDP 6: Dormouse Tube Locations

date	11 NOVEMBER 2020	drawn by	AG
drawing number	edp5669_d005	checked	EMc
scale	1:1,500 @ A3	QA	RB



Registered office: 01285 740427 - www.edp-uk.co.uk - info@edp-uk.co.uk

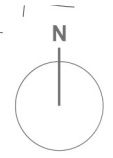
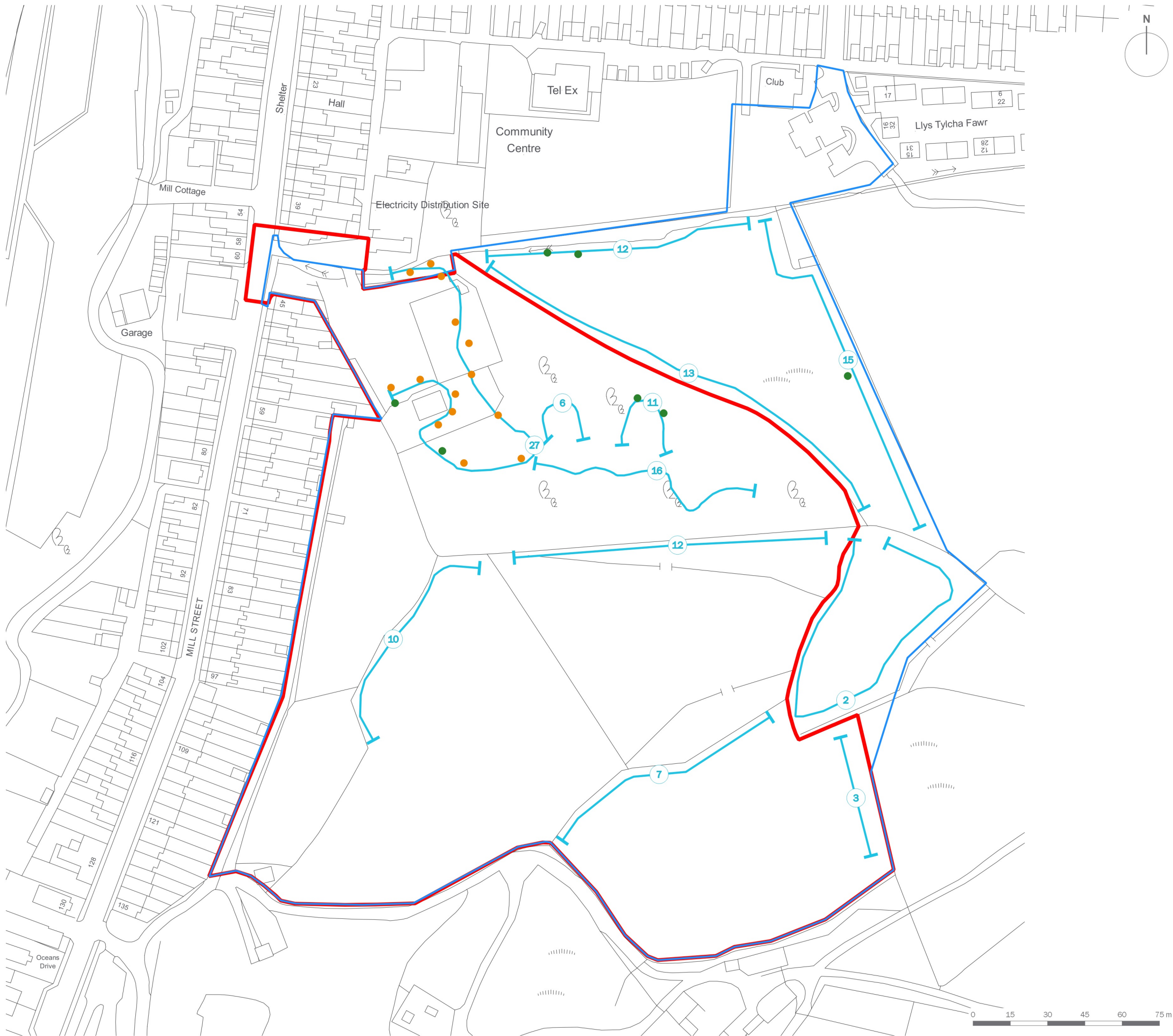

- Application Site Boundary
- Study Area
- 27 Reptile Refugia Locations and Number of Refugia
- Common Lizard Found
- Slow-worm Found

client
Lewis Homes Ltd

project title
Land at Mill Street, Tonyrefail

drawing title
Plan EDP 7: Reptile Survey Results 2019

date	11 NOVEMBER 2020	drawn by	AG
drawing number	edp5669_d004	checked	EMc
scale	1:1,500 @ A3	QA	RB



Registered office: 01285 740427 - www.edp-uk.co.uk - info@edp-uk.co.uk



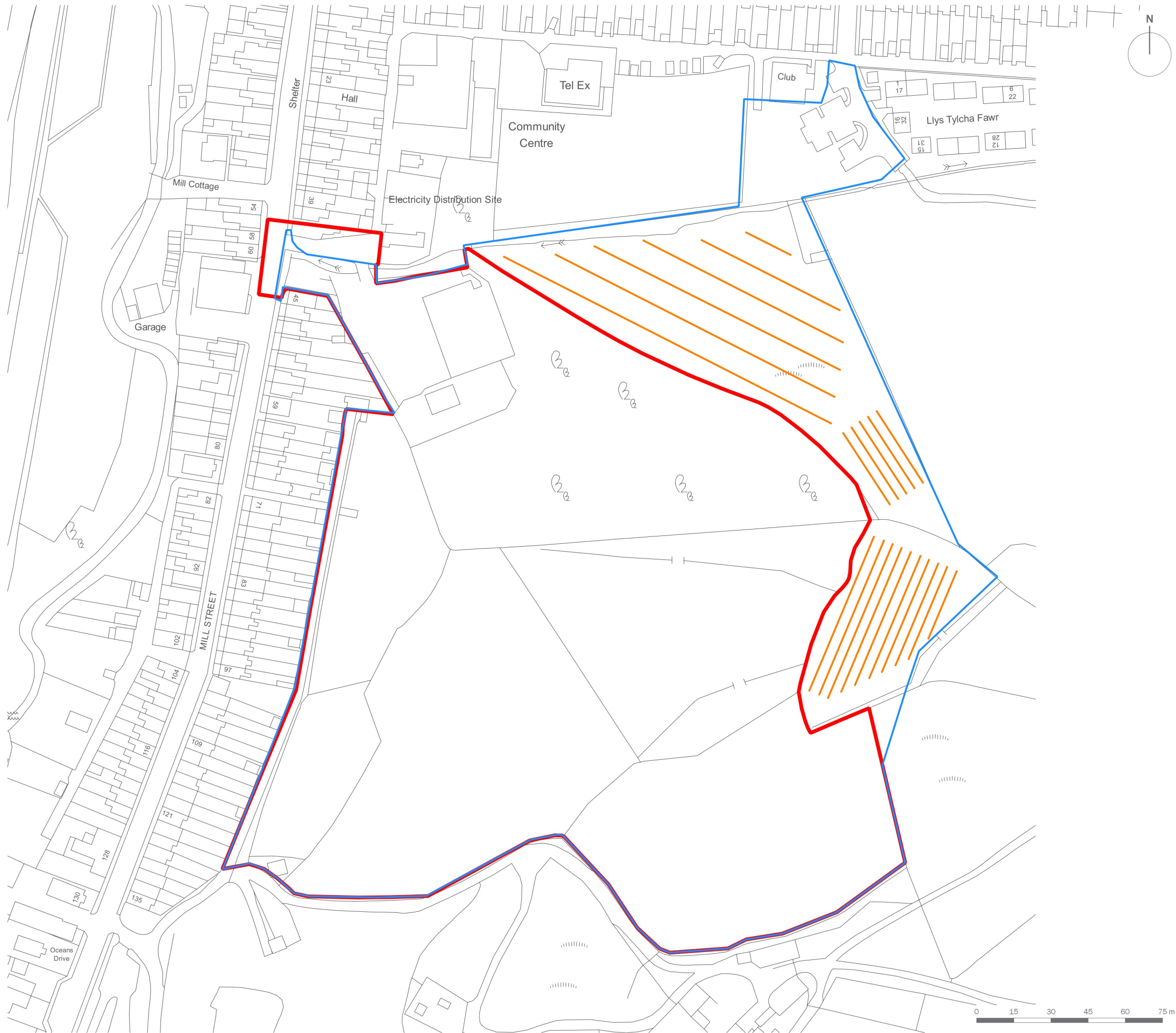

- Application Site Boundary
- Study Area
- Marsh Fritillary Survey Transects

client
Lewis Homes Ltd

project title
Land at Mill Street, Tonyrefail

drawing title
Plan EDP 8: Marsh Fritillary Butterfly Survey Transects

date	11 NOVEMBER 2020	drawn by	MJC
drawing number	edp5669_d017	checked	KH
scale	1:1,500 @ A3	QA	RB



Registered office: 01285 740427 - www.edp-uk.co.uk - info@edp-uk.co.uk

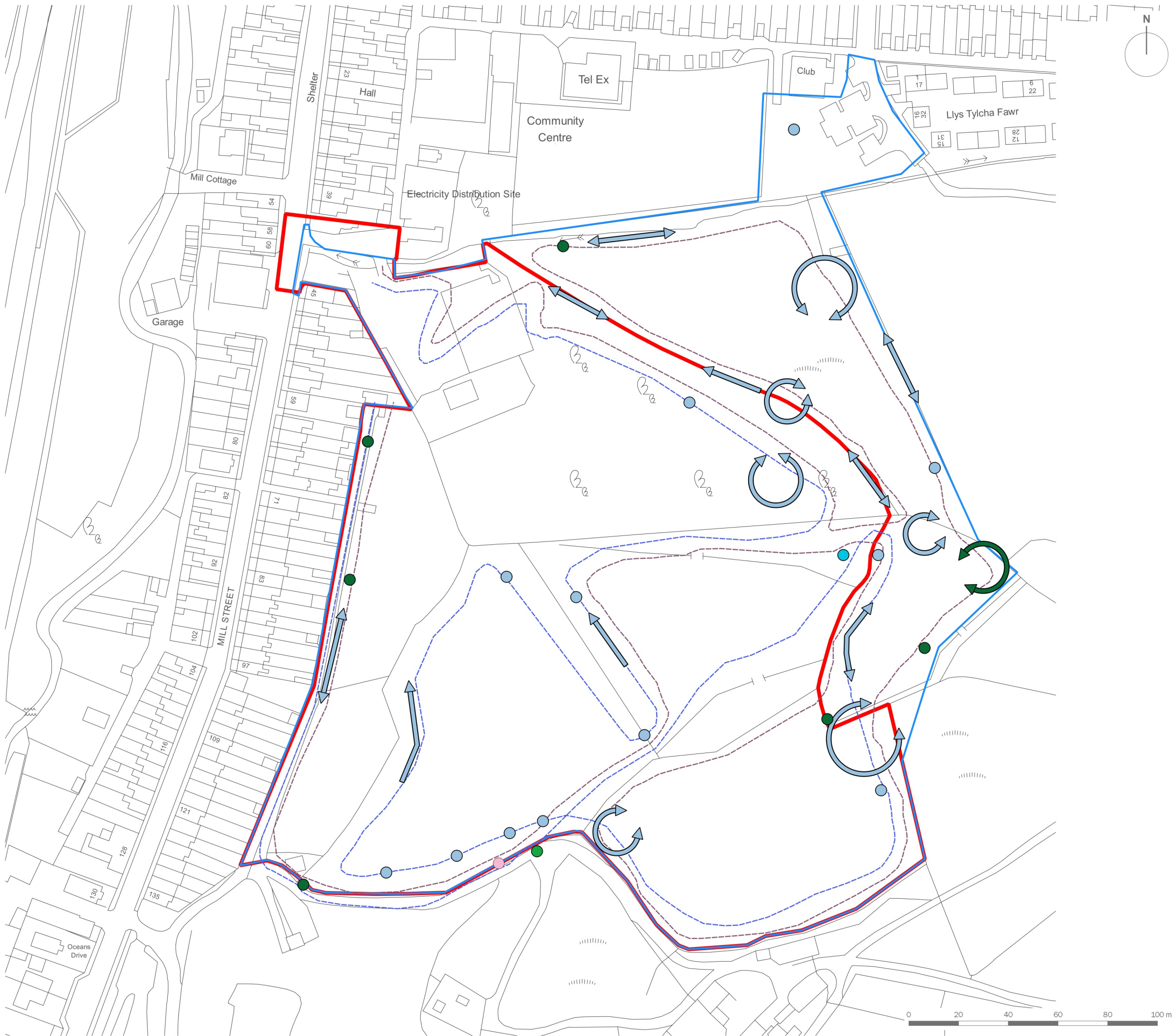

Application Site Boundary

Study Area

Transect Routes

Transect 1

Transect 2

Bat Activity

Commuting Behaviour

Foraging Behaviour

Heard Not Seen

Bat Species

Common Pipistrelle

Soprano Pipistrelle

Lesser Horseshoe Bat

Myotis sp.

Brown Long-eared Bat

client

Lewis Homes Ltd

project title

Land at Mill Street, Tonyrefail

drawing title

Plan EDP 9a: Bat Survey Results – August 2019

date	11 NOVEMBER 2020	drawn by	MJC
drawing number	edp5669_d009	checked	LL
scale	1:1,500 @ A3	QA	RB



Registered office: 01285 740427 - www.edp-uk.co.uk - info@edp-uk.co.uk



- Application Site Boundary
- Study Area
- Transect Routes**
- Transect 1
- Transect 2
- Bat Activity**
- Commuting Behaviour
- Foraging Behaviour
- Heard Not Seen
- Bat Species**
- Common Pipistrelle
- Soprano Pipistrelle
- Myotis sp.

client
Lewis Homes Ltd

project title
Land at Mill Street, Tonyrefail

drawing title
Plan EDP 9b: Bat Survey Results – September 2019

date	11 NOVEMBER 2020	drawn by	MJC
drawing number	edp5669_d010	checked	LL
scale	1:1,500 @ A3	QA	RB



Registered office: 01285 740427 - www.edp-uk.co.uk - info@edp-uk.co.uk

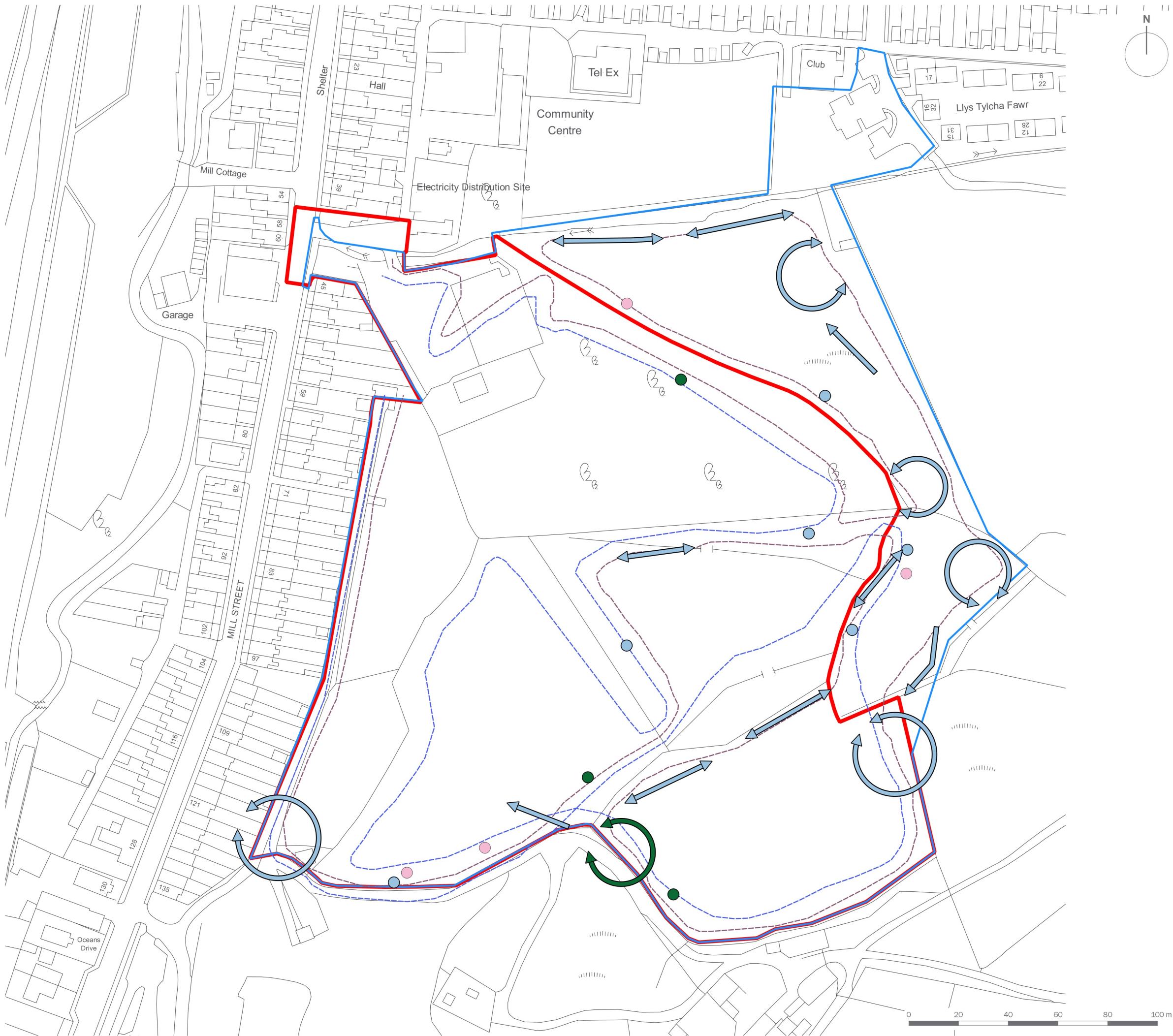

- Application Site Boundary
- Study Area
- Transect Routes**
- Transect 1
- Transect 2
- Bat Activity**
- Commuting Behaviour
- Foraging Behaviour
- Heard Not Seen
- Bat Species**
- Common Pipistrelle
- Soprano Pipistrelle
- Myotis sp.

client
Lewis Homes Ltd

project title
Land at Mill Street, Tonyrefail

drawing title
Plan EDP 9c: Bat Survey Results – October 2019

date	11 NOVEMBER 2020	drawn by	MJC
drawing number	edp5669_d011	checked	LL
scale	1:1,500 @ A3	QA	RB



Registered office: 01285 740427 - www.edp-uk.co.uk - info@edp-uk.co.uk

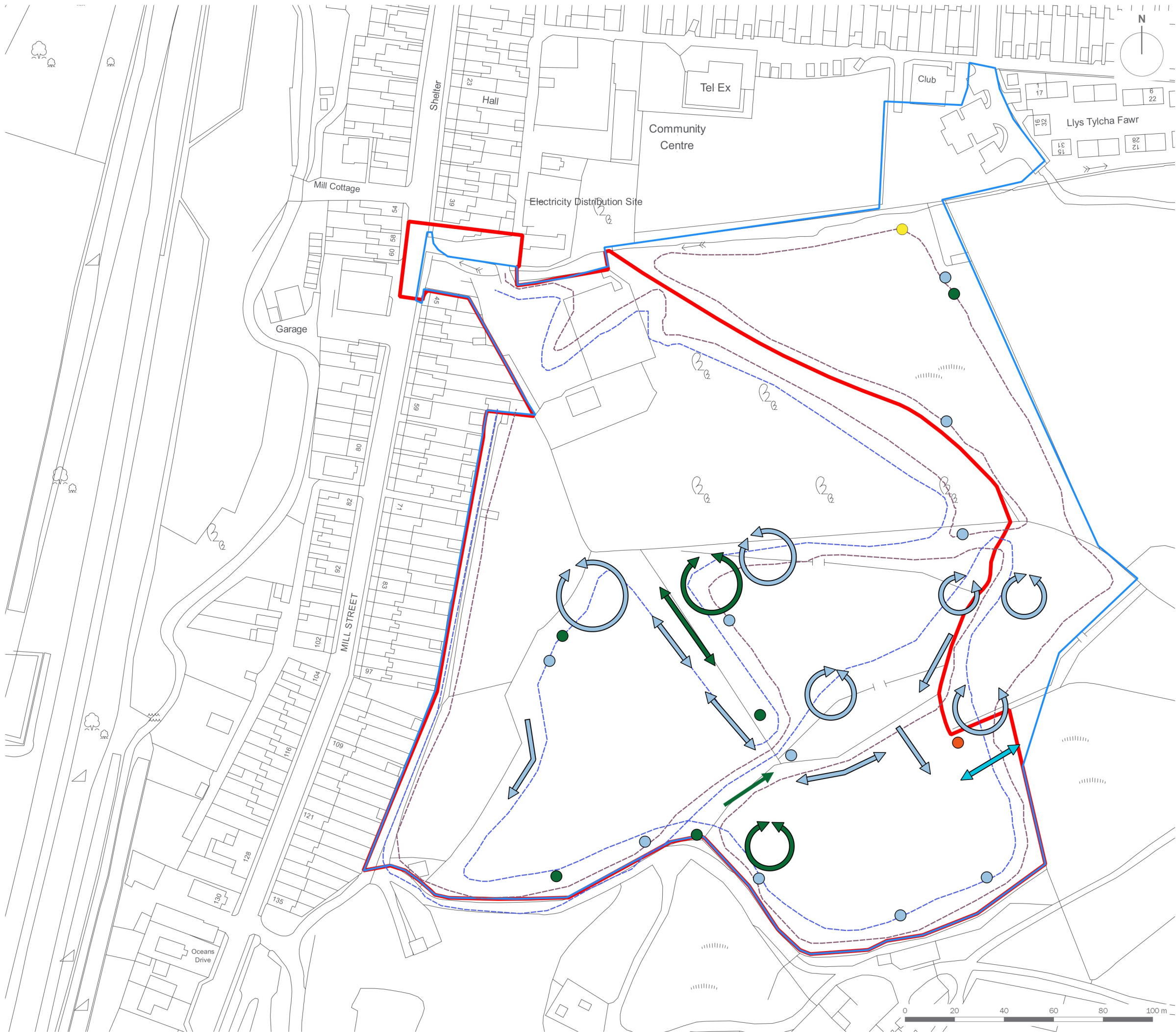

Application Site Boundary

Study Area

Transect Routes

Transect 1

Transect 2

Bat Activity

Commuting Behaviour

Foraging Behaviour

Heard Not Seen

Bat Species

Common Pipistrelle

Soprano Pipistrelle

Lesser Horseshoe Bat

Noctule

Nathusius' Pipistrelle

client

Lewis Homes Ltd

project title

Land at Mill Street, Tonyrefail

drawing title

Plan EDP 9d: Bat Survey Results – April 2020

date	11 NOVEMBER 2020	drawn by	MJC
drawing number	edp5669_d015	checked	LL
scale	1:1,500 @ A3	QA	RB



Registered office: 01285 740427 - www.edp-uk.co.uk - info@edp-uk.co.uk

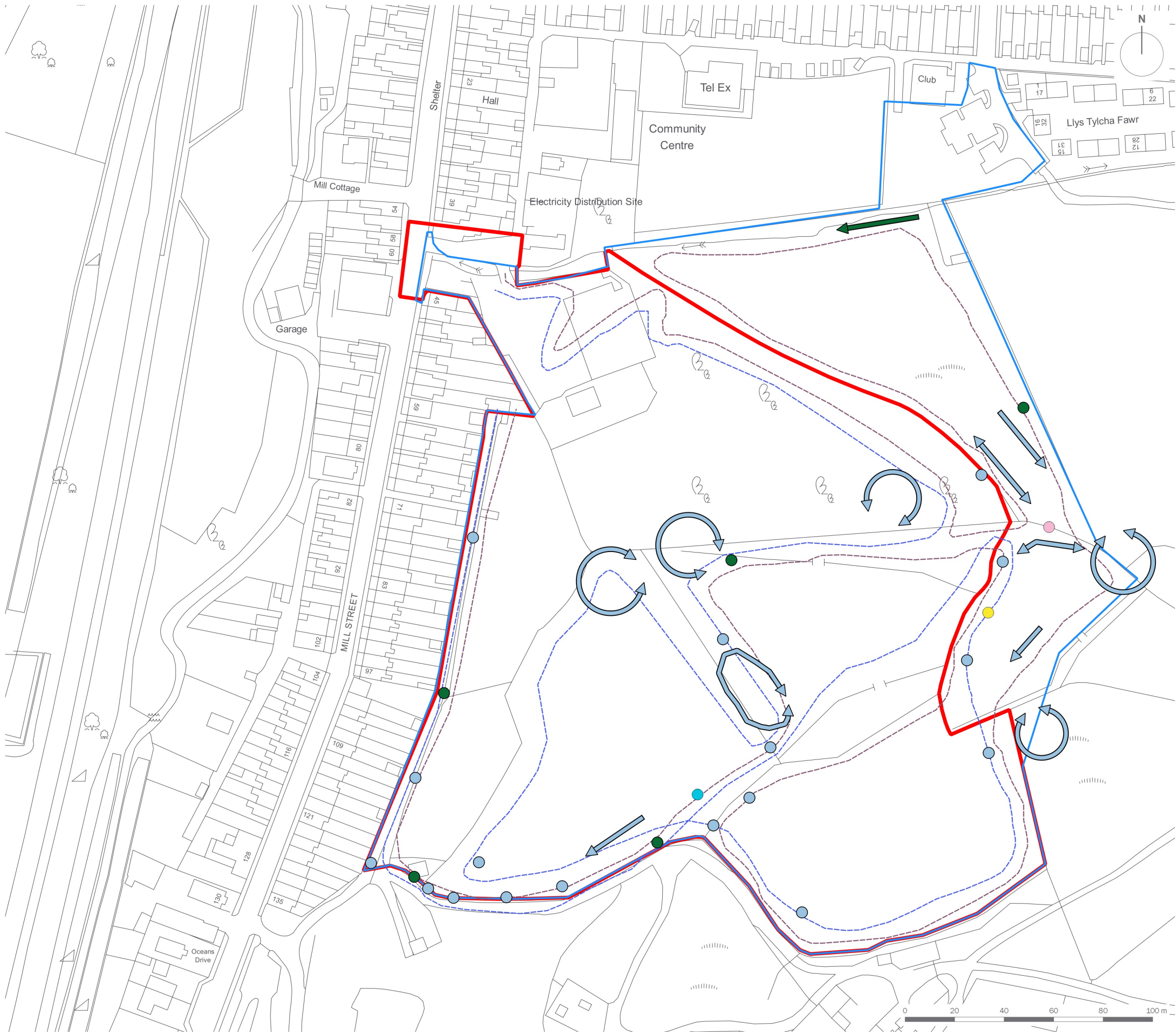

Application Site Boundary

Study Area

Transect Routes

Transect 1

Transect 2

Bat Activity

Commuting Behaviour

Foraging Behaviour

Heard Not Seen

Bat Species

Common Pipistrelle

Soprano Pipistrelle

Lesser Horseshoe Bat

Myotis sp.

Nathusius' Pipistrelle

client

Lewis Homes Ltd

project title

Land at Mill Street, Tonyrefail

drawing title

Plan EDP 9e: Bat Survey Results – May 2020

date	11 NOVEMBER 2020	drawn by	MJC
drawing number	edp5669_d016	checked	LL
scale	1:1,500 @ A3	QA	RB



Registered office: 01285 740427 - www.edp-uk.co.uk - info@edp-uk.co.uk



the environmental
dimension partnership

CARDIFF
02921 671900

CHELtenham
01242 903110

CIRENCESTER
01285 740427

SHREWSBURY
01939 211190

info@edp-uk.co.uk
www.edp-uk.co.uk

The Environmental Dimension Partnership Ltd. Registered as a Limited Company in England and Wales. Company No. 09102431. Registered Office: Tithe Barn, Barnsley Park Estate, Barnsley, Cirencester, Gloucestershire GL7 5EG



Landscape Institute
Registered practice

IEMA Transforming the world to sustainability

URBAN DESIGN GROUP
REGISTERED PRACTICE