

41-13

Project

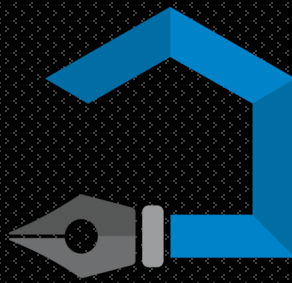

SIGNER DESIGNER

... more than cabinets

6735 Conroy Rd. Unit 209. Orlando, FL. 32835
(407) 435-5380 • mdebarros@signerdesigner.com



Client:

Adele Mirbey

Hull Island Drive

Oakland FL. 34787



About our brand



The company's history begins in 1927 with the joinery set up by Albert Nothdurft. Just a few years saw the wood-working business turn into a successful furniture producer.

In 1958, Nothdurft took the step from tradesman's business to industrial undertaking - ALNO Möbelwerke GmbH + Co. KG in Pfullendorf.

The ground had been prepared for practical innovations, first-class quality and award-winning design. But this wasn't only to the delight of consumers in Germany.

The kitchens "Made in Germany" soon became popular internationally too. This is why, in 1969, ALNO started to expand into other European countries, and later on even world-wide. Since 2018, production has been continued at the Pfullendorf site by the Neue Alno GmbH.

ALNO – certified quality

ALNO branded kitchens stand for high quality and exceptional durability. This is where it is all about first-class material, craftsmanship and, above all, precision.

From the product idea to developing it for production and from order processing to production and assembly, the ALNO QM system assures the standards that our customers can rightly expect from an international kitchen brand.

ALNO branded kitchens may only be fitted by properly trained personnel.

All our materials and components undergo an extensive programme of laboratory testing. The GS mark awarded by TÜV Rheinland LGA Products GmbH means maximum safety and reliability for our customers.



Your kitchen design Please note that the images are a 3D reference



Your kitchen design Please note that the images are a 3D reference



Your kitchen design Please note that the images are a 3D reference



Your kitchen design Please note that the images are a 3D reference



Your door style.

PLAIN STARLINE (1010)

A simple front that functions as the ideal basis for any kitchen architecture.

The handleless kitchen is convincing in its clear, timeless design: uncompromising in quality, form and functionality.

The horizontal recessed grip as a small engagement in the carcass emphasizes the beauty of the simple line.

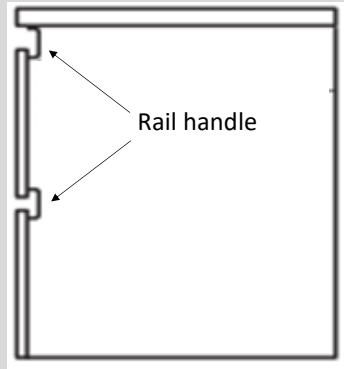

Door finish 1

Lacquer high-gloss smooth
(1110)

High-gloss white
(2201)

MDF core board with small radius all around.
High-gloss lacquered surface.
Rounded edge. Interior in matching matt colour.
Material thickness
PLAIN: 19.5 mm*



Door finish 2

Melamine
(1700)

Walnut horizontal
(1122)

Melamine coated core board.
All-round with color matched, slightly rounded thick edges.
Same décor inside and out.
Material thickness
PLAIN: 19 mm*

Panel to cover walls

finish

Lacklaminat Matt Glatt *Laminate matt smooth*
(1100)

MDF core board. All-round with colour-matched, slightly rounded matt thick edges. White inside.
Metallic surfaces: Matt metallic brushed lacquer laminate surface, vertical structure direction. Same decor inside and out.
Material thickness PLAIN: 19 mm*

color

Grafit matt *Graphite matt*
(2012)



Drawers

Deep **drawers** Slender closed drawer and deep-drawer system with metal sides and base in anthracite grey.
Dynamic load capacity and synchronized running action.



Hardware made in Germany, premium in Europe.

Hinges system

- ◆ The **Hinges** with cushioned closing
- ◆ The all-metal clip hinges combine efficiency and design and allow toolless unhinging of the doors.
- ◆ The door can be adjusted in 3 directions via the adjusting screws on the hinges without having to remove the door.
- ◆ The design is enhanced by a cover for the hinge cup .
- ◆ Dynamic load capacity and synchronized running action.



Adele Mirbey ◦ Hull Island Drive, Oakland FL, 34787

Cabinet details

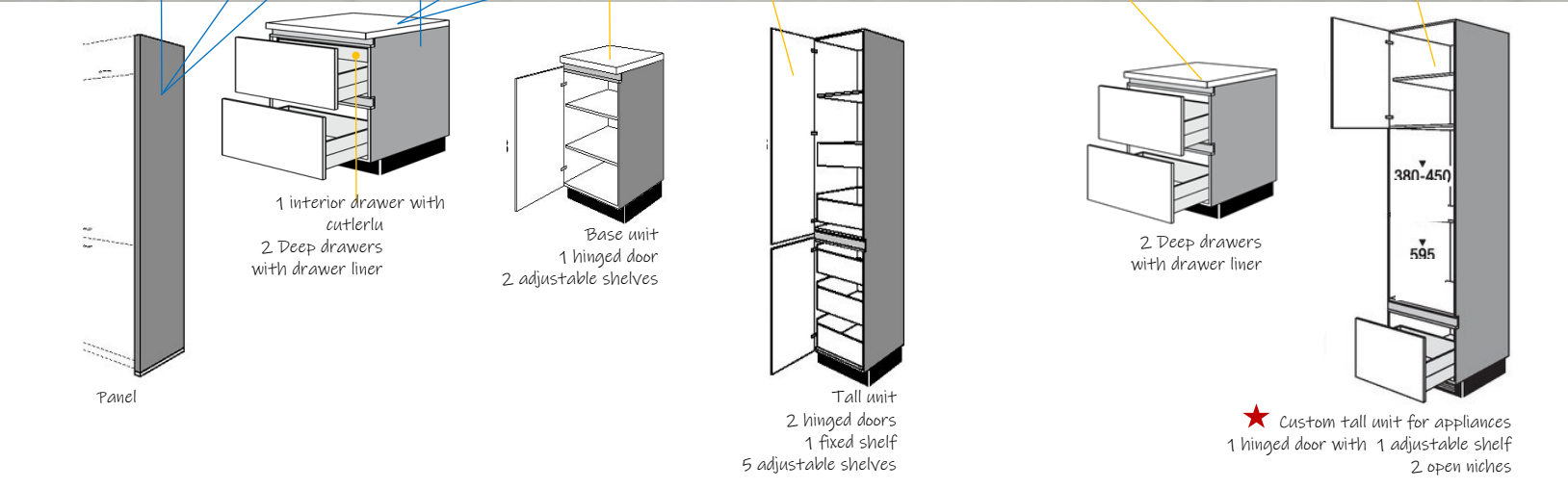
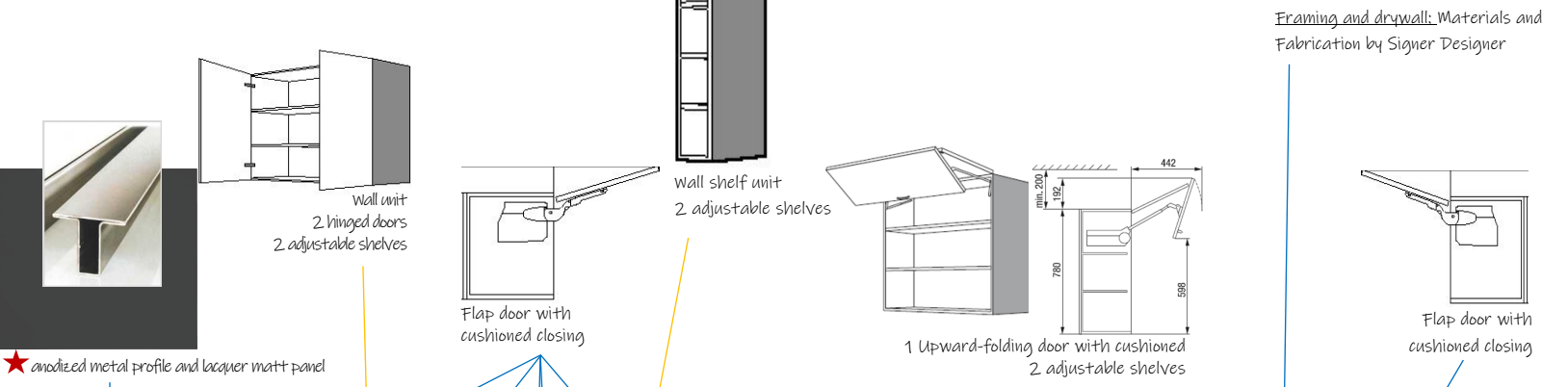

★ Possible changes in this cabinet, defined by the ALNO Technical department or depending on the appliance approved by the client

Island cabinet details

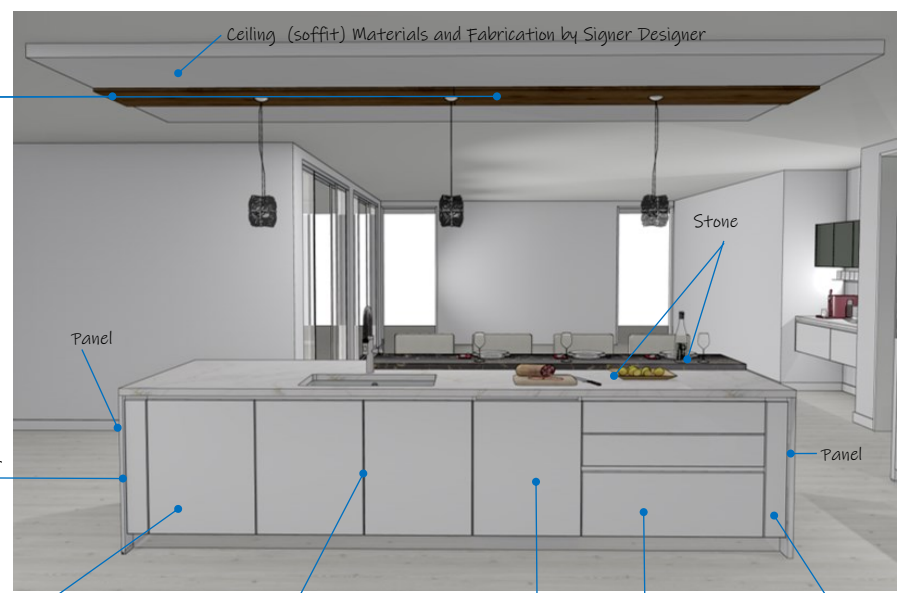

2 panels

Panel

Stone

Panel

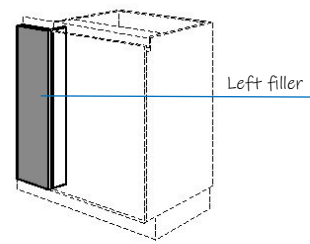

Left filler

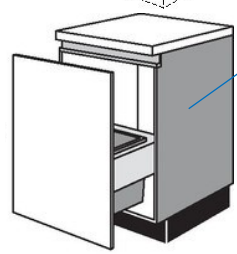
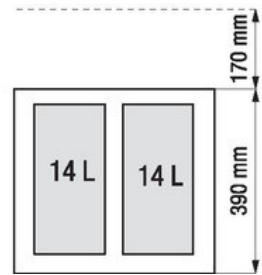

base unit with waste separation and deep drawer
 1 cover shelf
 waste separation system consisting of:
 2 containers 10 litres
 1 container lid
 1 container 20 litres

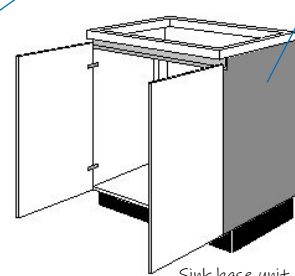

Sink base unit
 2 hinged doors



Dishwasher panels

Right filler

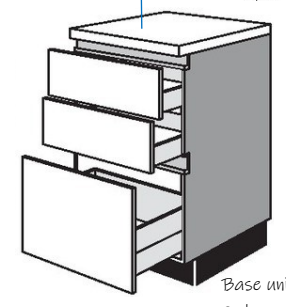
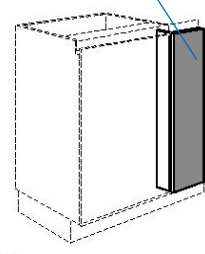

Base unit
 2 drawers
 1 deep drawer

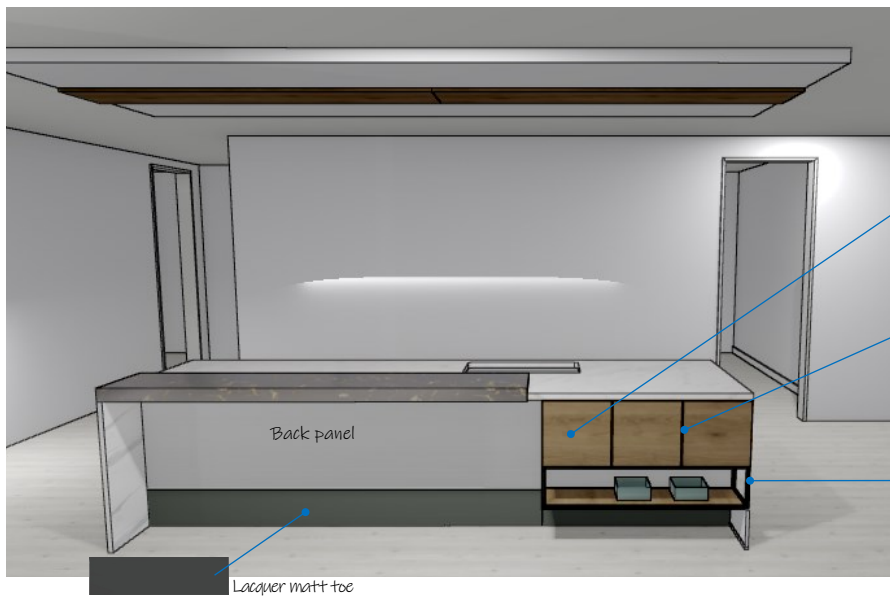

Back panel

Lacquer matt toe

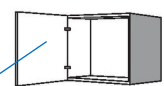

Wall unit without shelf
 1 hinged door

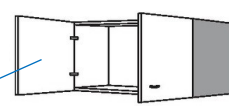

Wall unit without shelf
 2 hinged doors

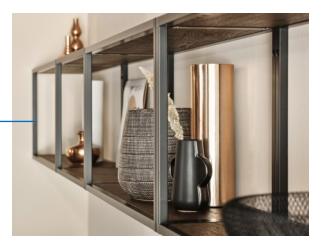

Metal frame shelf for units
 260 mm high
 without hanging mounting
 with 2 adjustable shelves top

Island cabinet details

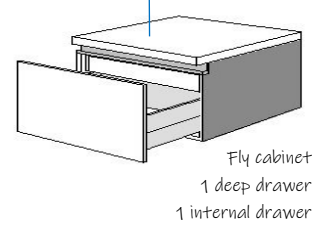
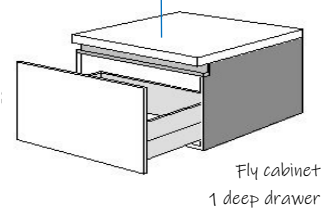
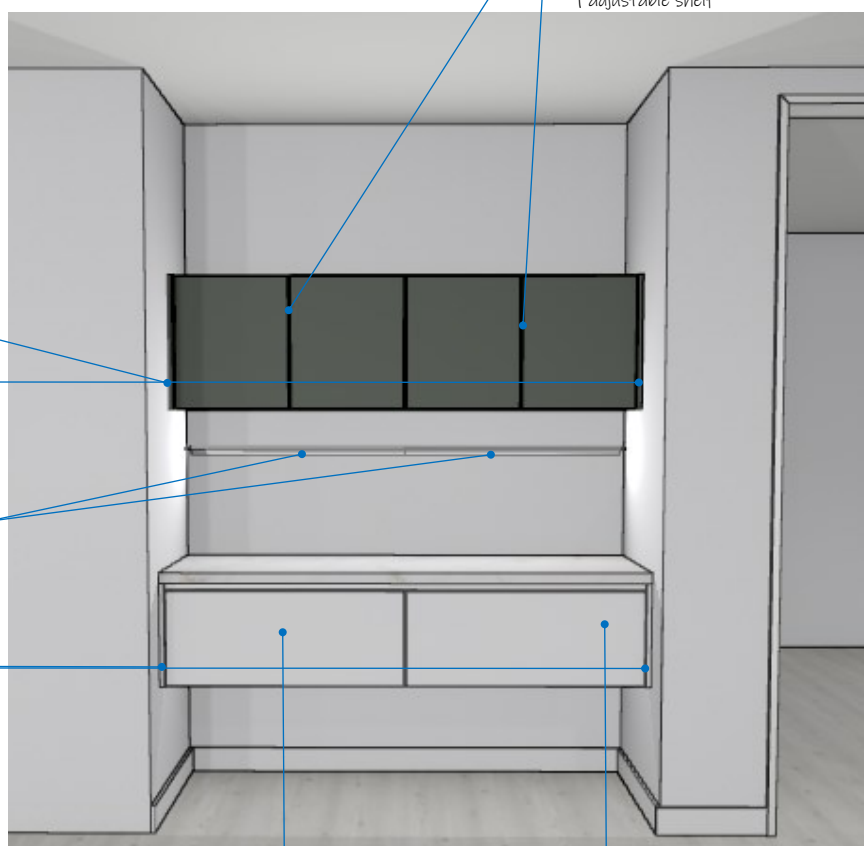
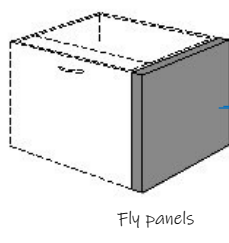
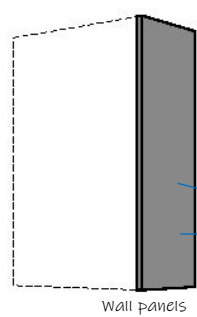
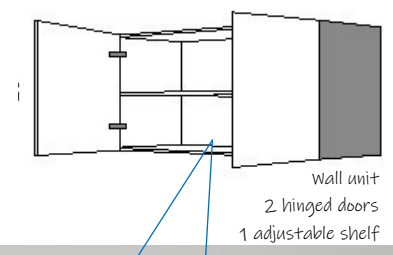

Your project includes the following accessories and system:



Drip tray into sink cabinet

aluminium tray, textured, 518 mm deep, factory-fitted in sink unit. back and side edges raised, front edge lowered, to cover front carcase edge. if required, cut out front corner for waste bin bearing.



Multipurpose insert Anthracite

High resistance plastic in anthracite grey color. Included in all interior drawers.

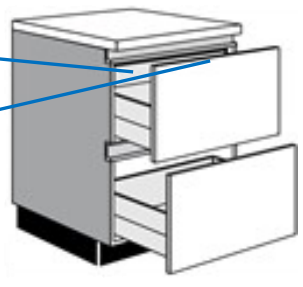

Driver Internal drawer

Connects the interior drawer with the external drawer and with a simple pressure it disconnects and gently slides back.

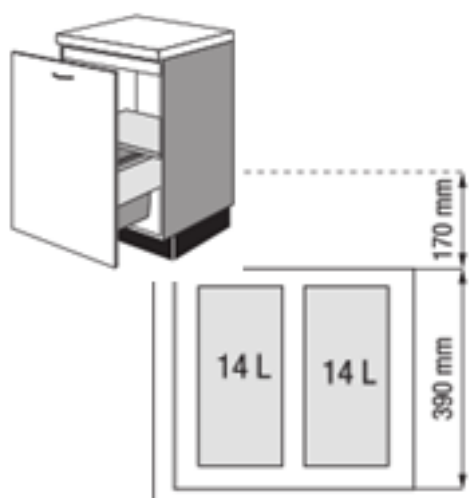

Waste bin

1 plastic container, Capacity 40 litres
1 container lid two-door cabinets two-door cabinets container on

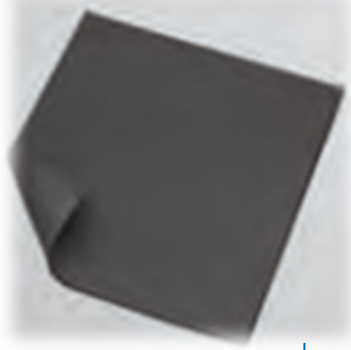

Matt

Anti-slip mat for all drawer In anthracite grey. Included in all drawers.

A Handle for sink Cabinet



590 s/m
Stangengriff Edelstahl-Optik
Bar handle stainless steel look



Designer: Maria De Barros
Document prepared by : Maria De Barros
Marketed and Imported by: Signer Designer LLC
Cabinets manufactured and assembled by: Neue ALNO GmbH
Installation by: Signer Designer LLC



Thank you for contacting us

... we are something more than a cabinet, we are technology, quality and perfection