

Stacy & Floyd	(321) 663-9661	Maria De Barros.CEO.Designer
stacys@cfl.rr.com,	1213 Thornbury Ct, Winter Garden, FL 34787	mdebarros@signerdesigner.com
Kitchen cabinets		Project No. 5008-7

Your Doors and Handle are:



No. 279/283
oak effect cashmere grey,
Horizontal grain direction



No. 333/333
Katthult pine-effect
(end-grained wood edge)

Melamine Door

Robust, unbreakable.
Furniture makers have long been using this synthetic material, which is extracted from melamine resin. It is so durable that it is also used as a coating on table tennis tables.
Door thickness: 3/4"



No. 216 w/s/m
Metal D-handle stainless steel effect
drilling distance: 192 mm



TIP-ON

The flap doors installed in upper positions, in your project, open simply and ergonomically by tapping the TIP-ON fitting.

Your Project is a **ALNO** Kitchen

92 years of experience and quality

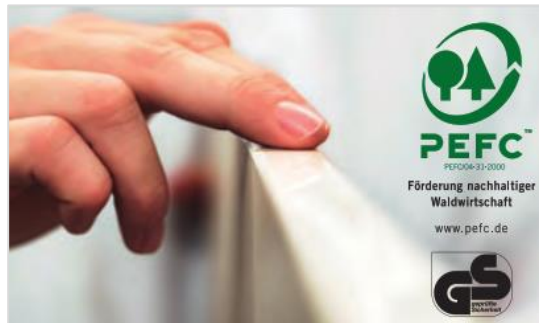

ALNO – certified quality

ALNO branded kitchens stand for high quality and exceptional durability. This is where it is all about first-class material, craftsmanship and, above all, precision.
From the product idea to developing it for production and from order processing to production and assembly, the ALNO QM system assures the standards that our customers can rightly expect from an international kitchen brand.
ALNO branded kitchens may only be fitted by properly trained personnel. All our materials and components undergo an extensive programme of laboratory testing. The GS mark awarded by TÜV Rheinland LGA Products GmbH means maximum safety and reliability for our customers.

Your drawer & hinges system are Blum brand



Deep **drawers** with a rectangular railing and an anthracite grey drawer side profile are the new standard.



- The **Hinges** with cushioned closing
- The all-metal clip hinges combine efficiency and design and allow toolless unhooking of the doors.
- The door can be adjusted in 3 directions via the adjusting screws on the hinges without having to remove the door.
- The design is enhanced by a cover for the hinge cup.

Stacy & Floyd	(321) 663-9661	Maria De Barros.CEO.Designer
stacys@cfl.rr.com,	1213 Thornbury Ct, Winter Garden, FL 34787	mdebarros@signerdesigner.com
Kitchen cabinets		Project No. 5008-7

Your project includes the following accessories:



Multipurpose insert Anthracite
for PREMIUM and ALPHA
474 mm Deep for 560 mm deep units

(2) Units:
- 900mm / 36"
- 450mm / 18"



Matt
Anti-slip mat for all drawer

(11) Units:



Base unid spice rack
1 front pull-out
with 2 fixed pull-out trays
300 mm width



Drip tray
aluminium tray, textured, 518 mm deep, factory-fitted in sink unit. back and side edges raised, front edge lowered, to cover front carcass edge. if required, cut out front corner for waste bin bearing.



Driver Internal drawer
To place on interior drawers behind drawers. Drill a hole Ø 25 mm on the inside of the fronts The trailing stop can be unlocked manually.
The game is composed of a handle and a drag stop White gray

(1) Unit:

*All accessories are German made

Client



CEO - Owner

Stacy & Floyd	(321) 663-9661	Maria De Barros.CEO.Designer
stacys@cfl.rr.com,	1213 Thornbury Ct, Winter Garden, FL 34787	mdebarros@signerdesigner.com
Kitchen cabinets		Project No. 5008-7

Cabinet details:



Cornice
Magnolia color

*Panel 50mm

* Cut on the site to place to the left of refrigerator.



Pull-out Base spice rack

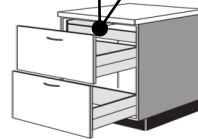

Small interior drawer with cutlery

Clear glass wall cabinet No. 550.
The interior color: Katlhult pine-effect
Door and carcass Oxide
Concrete color



drawer
Panel 16mm

Waste bin

Panel 16mm
Install plinth in front of dishwasher (removable)

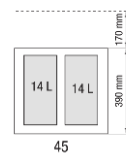
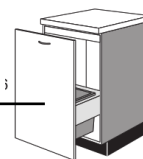

Base unit with waste separation System.
400mm Deep
2 containers, 14 litres

Client

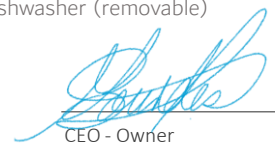

CEO - Owner

Stacy & Floyd

stacys@cfl.rr.com,

Kitchen cabinets

(321) 663-9661

1213 Thornbury Ct, Winter Garden, FL 34787

Maria De Barros.CEO.Designer

mdebarros@signerdesigner.com

Project No.

5008-7

Drawing plan:

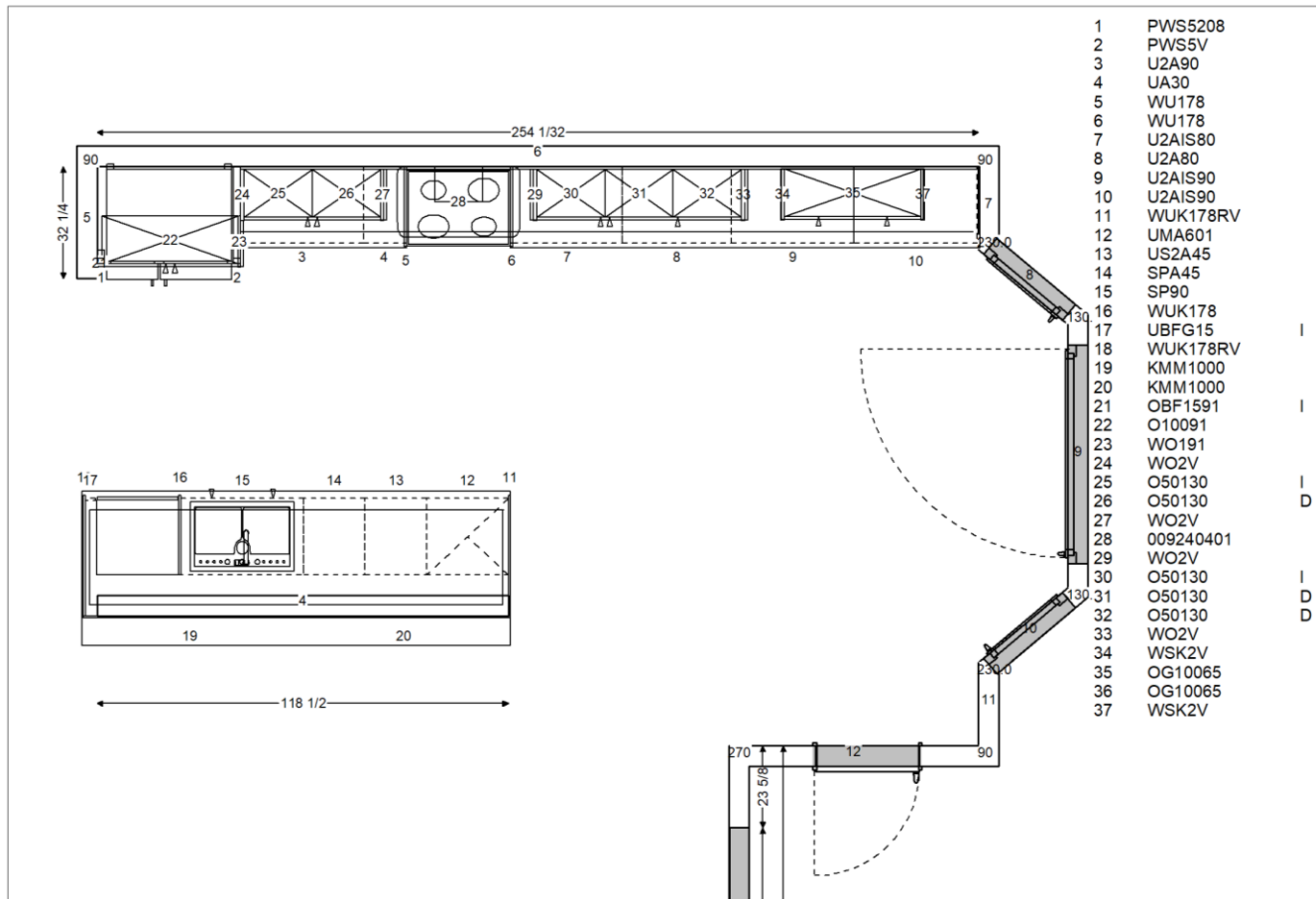

Client



CEO - Owner

Stacy & Floyd

stacys@cfl.rr.com,

Kitchen cabinets

(321) 663-9661

1213 Thornbury Ct, Winter Garden, FL 34787

Maria De Barros.CEO.Designer

mdebarros@signerdesigner.com

Project No.

5008-7

Elevation plan:

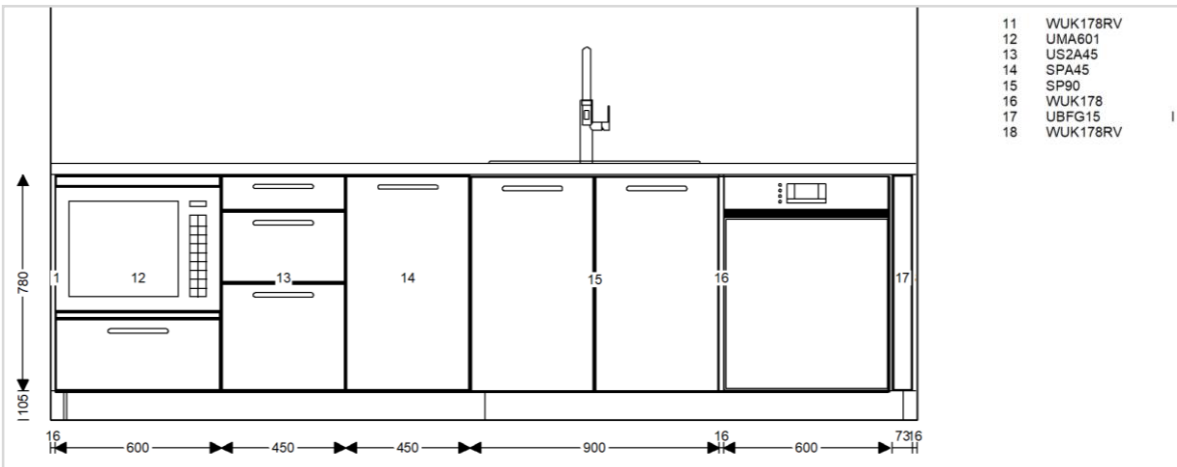
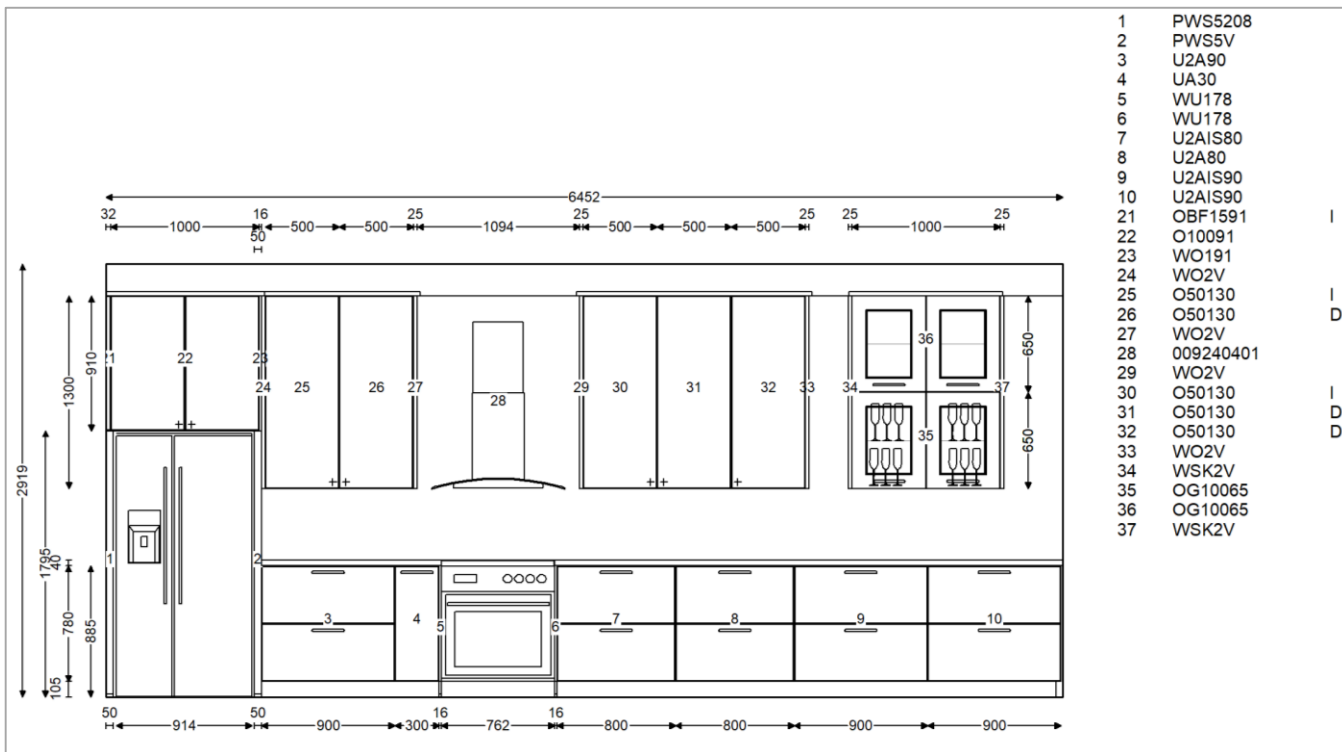

Client



CEO - Owner



Modern, Urban & Classic Inspiration

544 W Fairbanks Ave, Winter Park, FL, 32789

www.signerdesignerllc.com

03/31/2019

Stacy & Floyd	(321) 663-9661	Maria De Barros.CEO.Designer
stacys@cfl.rr.com,	1213 Thornbury Ct, Winter Garden, FL 34787	mdebarros@signerdesigner.com
Kitchen cabinets		Project No. 5008-7

Countertop:

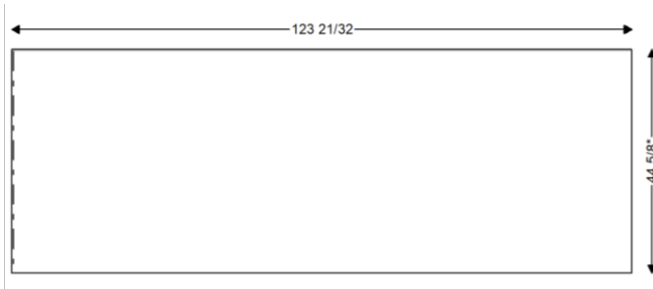
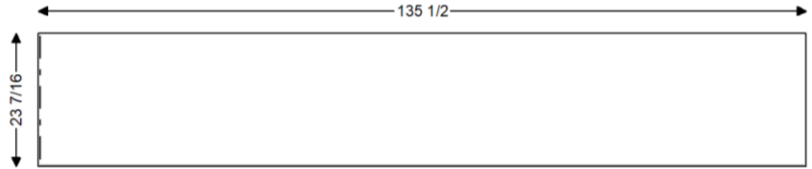
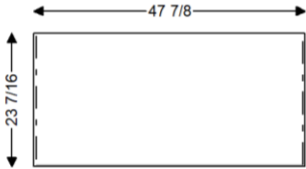

*The countertop is not included in this project. Images only reference for our client

Client

CEO - Owner