

20005-08

Project

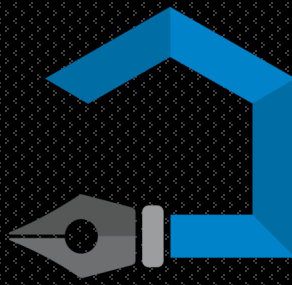

SIGNER  
DESIGNER

*... more than cabinets*

6735 Conroy Rd. Unit 209. Orlando, FL. 32835  
(407) 435-5380 • mdebarros@signerdesigner.com



*Made in Germany*

Omar & Victoria JeBaile

Kevin Ave. Orlando, 32819

**BEECK  
KÜCHEN**

echt | ehrlich | einzigartig

[www.signerdesigner.com](http://www.signerdesigner.com)

## About our brand



**BEECK**  
KÜCHEN

*88 years  
of experience and  
quality*

One company!

One team!

A 4th generation family business, they work with highly qualified employees to develop and produce top-quality Made in Germany kitchen furniture with passion, creativity, and the highest standards of quality. Ultimately, they want people to be happy with our kitchens from the moment they set eyes on them, and for many years afterward – after all, cooking should be enjoyable.

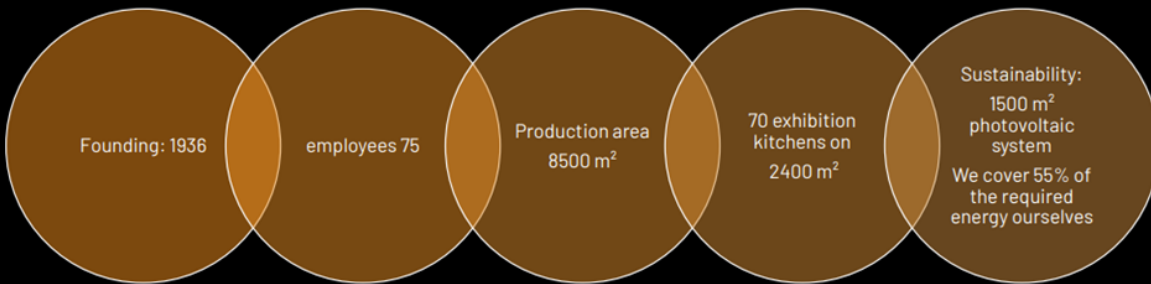

PEFC guarantees that wood and paper products come from only sustainably managed forests.

PEFC is the largest institution for ensuring and marketing sustainable forest management, through an independent certification system.



All cabinets comply with the high US standards CARB2 and TSCA Title 6.

Wood products made from CARB2 panels are sustainable, environmentally friendly and ensure a healthy indoor climate



### Solidity perfected!

The quality of Beeck Küchen craftsmanship never fails to impress. Sides and bases are 19 mm thick and back walls 8 mm thick. This guarantees good durability and many years of enjoyment in a unique, high-quality kitchen.

## Your kitchen design Please note that the images are a 3D reference



**Your kitchen design** Please note that the images are a 3D reference

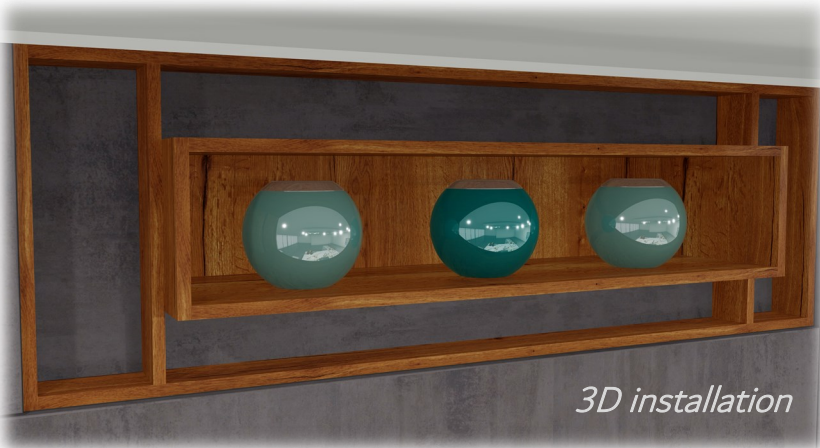

**Your kitchen design** Please note that the images are a 3D reference



*Double trim frame for  
the refrigerator*



**Your kitchen design** Please note that the images are a 3D reference



*Recessed niche details*

## Your door style.

### DOOR WITHOUT HANDLES

A simple front that functions as the ideal basis for any kitchen architecture.

The handleless kitchen is convincing in its clear, timeless design: uncompromising in quality, form and functionality.

The horizontal recessed grip as a small engagement in the carcass emphasizes the beauty of the simple line.

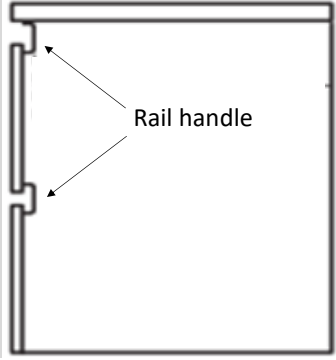

## 2100 Trend Struktur

*Finish: 108 Melamine struktur*

*Color: K186 Concrete anthracit*

Melamine resin coated front, concrete texture, surrounding edge in same colour



## 3090 Colora

*Finish: 113 high gloss melamine*

*Color: Y127 Xeno arctic white*

Melamine resin coated front, wood grain, surrounding edge

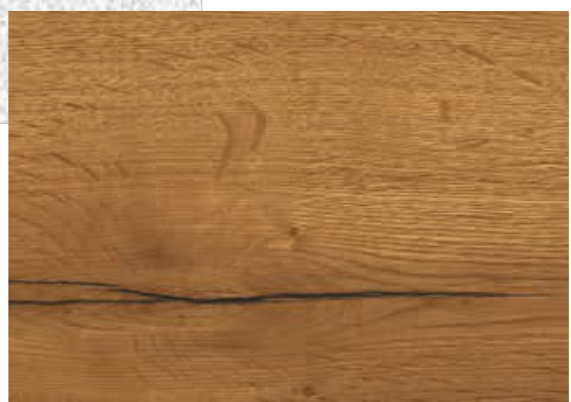

## 2150 Trend Holz

*Finish: 103 Melamine wood*

*Color: K036 Halifax oak cognac*

Melamine resin coated front, wood grain, surrounding edge

## You get more than a kitchen cabinet ... you get quality, engineering, invention and elegance

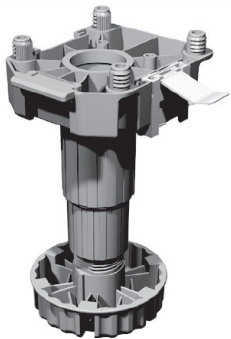

**Base** and tall units are supplied with height adjustable feet. The adjustment range from + 20 to - 10 mm guarantees millimetre accuracy. The plinth panel is protected against moisture by a sealing or U-profile.

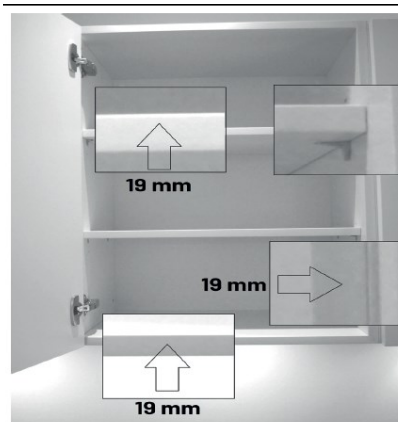

**The carcass** is made of a high-quality derived timber material board in 19 mm thickness. All wood-based materials used are made of sustainably cultivated PEFC-certified material that meets the new CARB2 standard. Only material coated on both sides with melamine is used in the carcass to prevent moisture from penetrating the wood-based material.



The all-metal clip hinges used are self-closing and are mounted / dismantled by clipping them in / out without tools.

They are also equipped with integrated soft close.

The hinges are 3-dimensionally adjustable and have an opening angle of 110° or 165°.

The opening angle can be limited by optional limiters.

The carcass parts are glued permanently for stability with solid wood dowels.

The front edge consists of 1.2 mm thick ABS edge. The safety edge is glued with PUR glue (polyurethane). The strong and thermally resistant connection between the edge and the wood material ensures optimum protection against the penetration of moisture.



**The AvanTech system** offers you a modern and straightforward design without sacrificing any storage. It is particularly impressive due to the following points:

- 13 mm narrow frame thickness without cover caps.
- A unique running comfort.
- 3-fold adjustment possibilities, which are not visibly integrated in the frame.
- Powder-coated metal frames in color Carbon.
- Upper cover profile in stainless steel look.
- Load capacity 40/70 Kg.
- Integrated pull-in soft close..



### Cupboard suspension

Wall units are supplied with rear top and bottom recess to allow for ventilation,

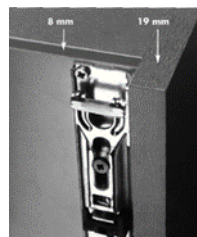

★ All the information provided authentically corresponds to our supplier (Beeck Kuchen).



Victoria & Omar JeBailey ◦ 5739 Kevin Ave. Orlando, FL. 32819

# Cabinet de-



**Hood** ★  
Suggestion:  
Choose a hood less than  
15" tall

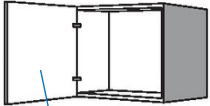

Wall unit  
1 shelf  
1 hinged door

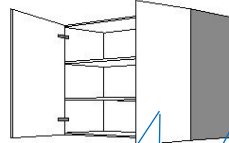

Wall unit  
2 hinged doors

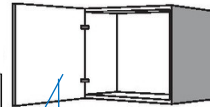

Wall unit 1 shelf  
1 hinged door

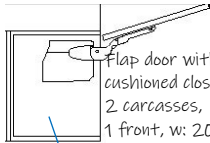

Flap door with  
cushioned closing  
2 carcasses,  
1 front, w: 2000mm

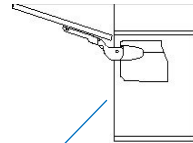

Flap door with  
cushioned closing



Wall unit 160cm  
1 flap door,  
2 carcasses,  
1 front of 2400mm  
accessory is not included ★

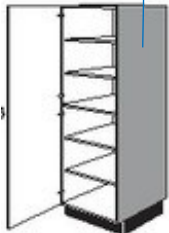
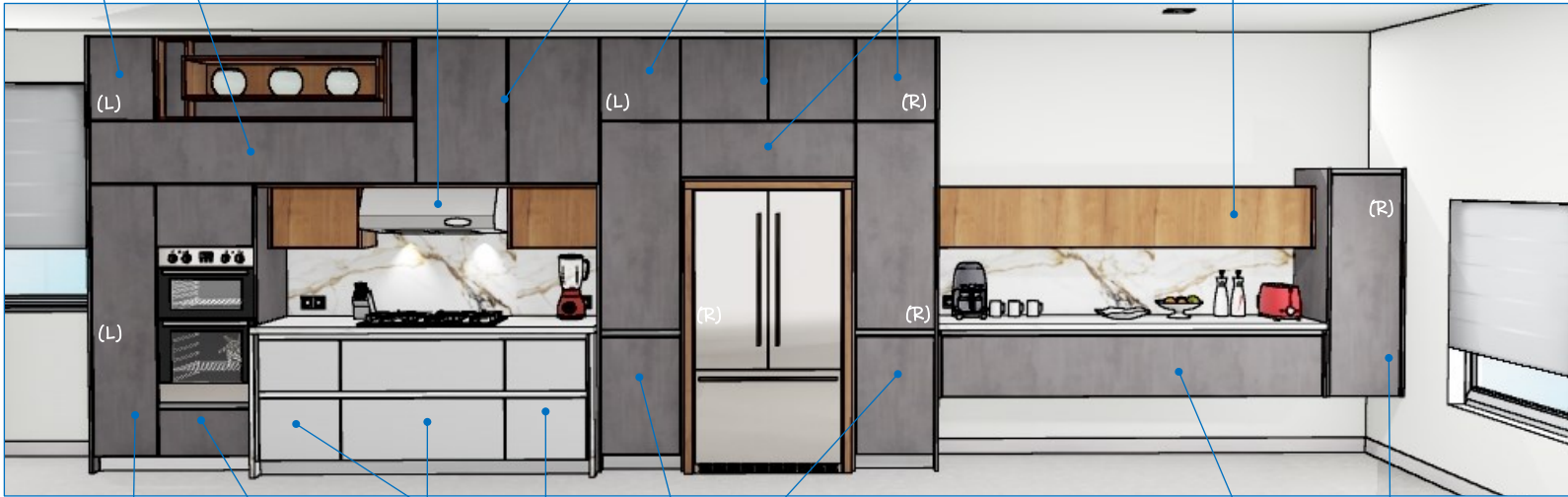

Crockery cupboard 40 cm  
1 door, 4 shelves  
1 shelf rigid,

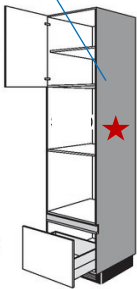

Custom tall unit for appliances  
1 hinged door with 1 adjustable shelf  
2 pen niches  
1 deep drawer

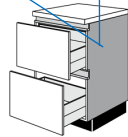

1 interior drawer with  
cutlerlu  
2 Deep drawers

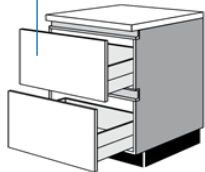

2 Deep drawers  
with drawer liner

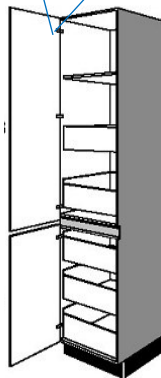

Cupboard  
1 fixed shelf,  
Interior drawer  
★ waiting to define

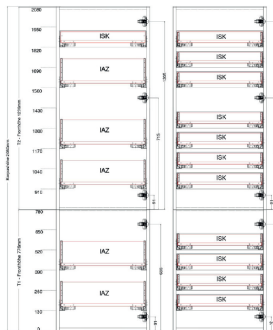

Options

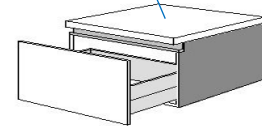

Suspended base cabinet  
2 extracts  
2 bodies with one front 2000mm

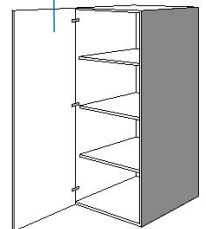

Suspended Cupboard  
4 shelves

(L) door opening to the left, (R) door opening to the right

★ Possible changes in this cabinet, defined by the BEECK Technical department or depending on the appliance approved by the client

# Island cabinet details

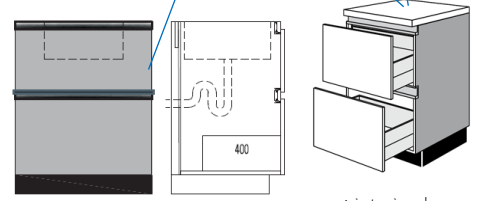
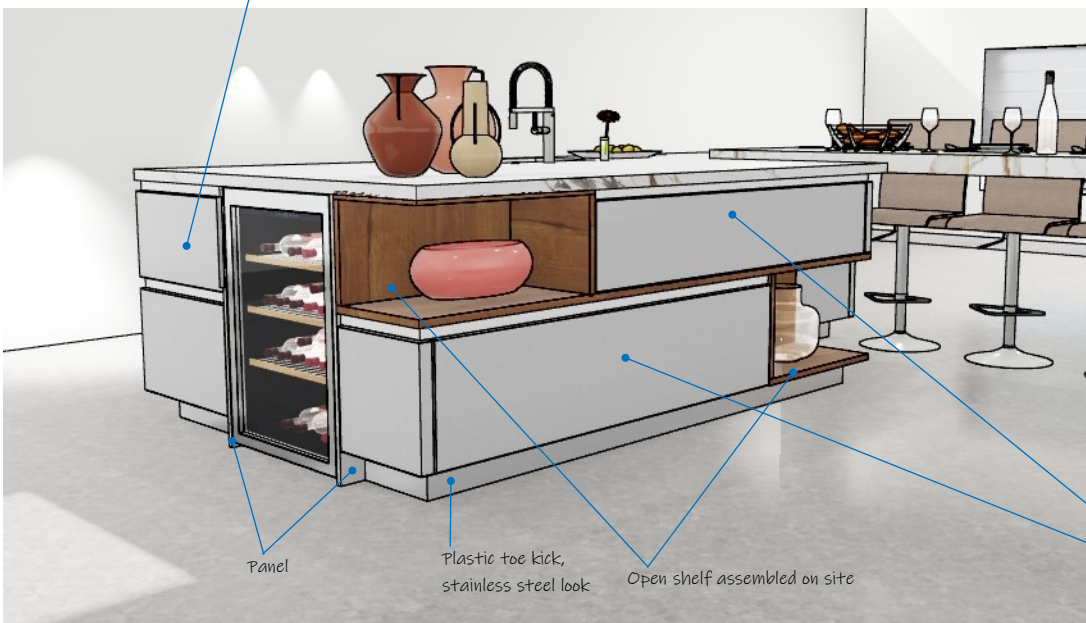
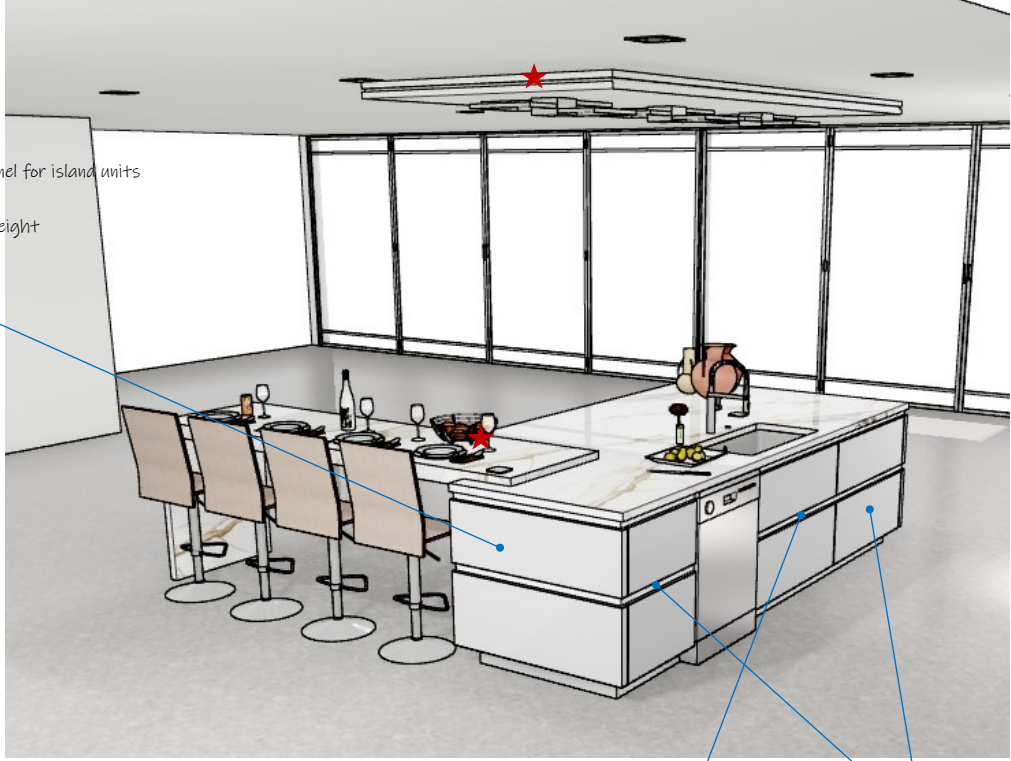
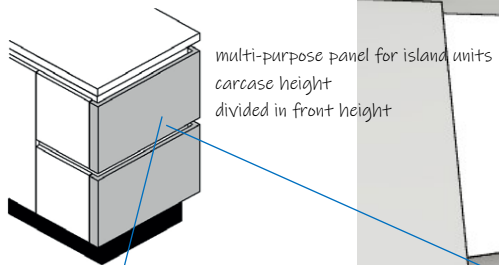

1 interior drawer with cutleria  
2 Deep drawers

Sink base unit  
1 extension 400 mm deep with siphon cutout  
1 extension 400 mm deep

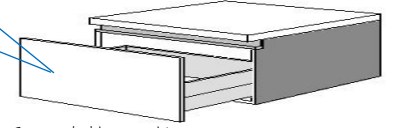

Suspended base cabinet  
2 extracts  
2 bodies with one front 1600mm

★ Countertop, and ceiling soffit are not included

## Your project includes the following accessories and system:



### Multipurpose insert Anthracite

High resistance plastic in anthracite grey color. Included in **all** interior drawers.

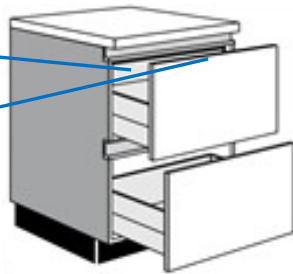

### Driver Internal drawer

Connects the interior drawer with the external drawer and with a simple pressure it disconnects and gently slides back.

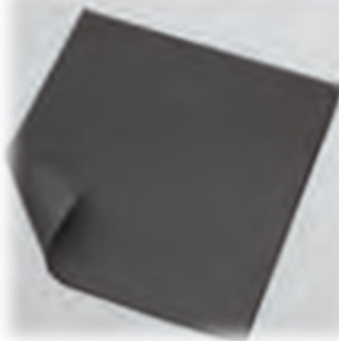
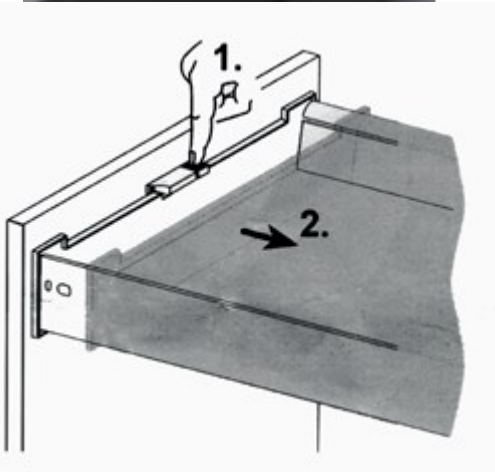

### Matt

Anti-slip mat for all drawer In anthracite grey. Included in all drawers.

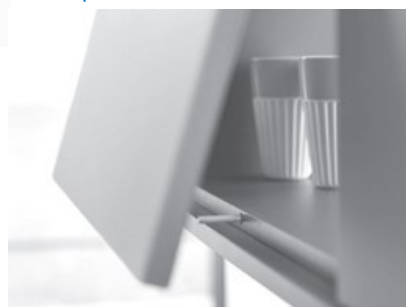

### Door opening fitting



Designer: Maria De Barros  
Document prepared by : Maria De Barros  
Marketed and Imported by: Signer Designe LLCr  
Cabinets manufactured and assembled by: Neue ALNO GmbH  
Installation by: Signer Designer LLC



Thank you for contacting us

*... we are something more than a cabinet, we are technology, quality and perfection*

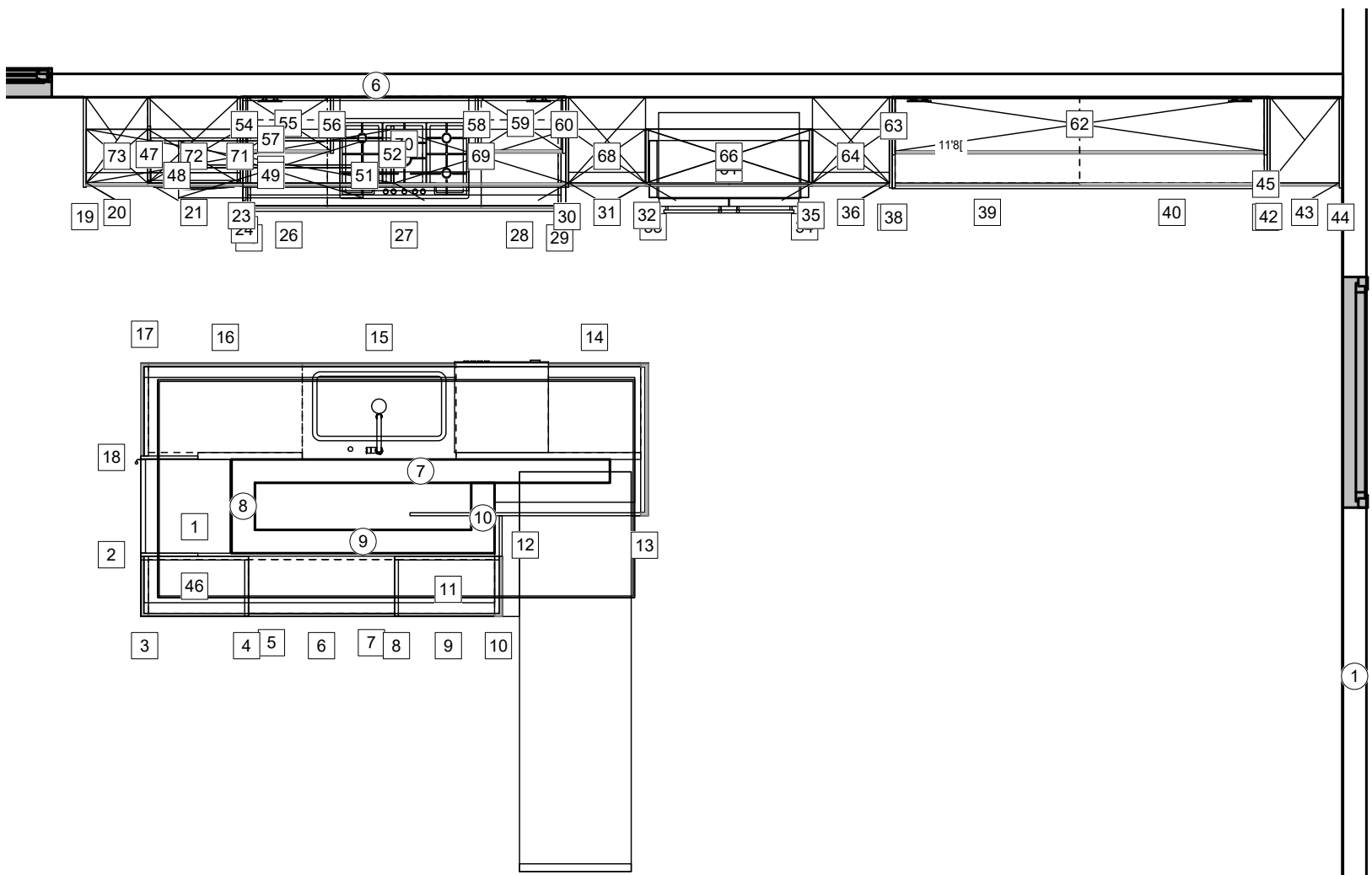

- 1 B25F
- 2 BWH7837
- 3 GFWG7839
- 4 B25E
- 5 GLG16042
- 6 B25E
- 7 GLG16042
- 8 B25E
- 9 B25E
- 10 GFWG15637
- 11 B25E
- 12 B19BH
- 13 GFIVGD7899
- 14 GLUSPMM6078
- 15 GLUSP2G10078
- 16 GLU2GI10078
- 17 GFWGD7860
- 18 BWH7837
- 19 B19BH
- 20 GS40169D I
- 21 GLG6042
- 22 GSX60169 I
- 23 B19BH
- 24 WSE19125
- 25 BWS7837
- 26 GLU2GI5078
- 27 GLUKMB2G10078
- 28 GLU2GI5078
- 29 BWS7837
- 30 B19BH
- 31 GLGS50208 D
- 32 B19BH
- 33 HSH19537
- 34 HSH19537
- 35 B19BH
- 36 GLGS50208 D
- 37 B19BH
- 38 B19BE
- 39 GLG12042
- 40 GLG12042
- 41 B19BE
- 42 B19BE
- 43 GLGS45143 D
- 44 B19BE
- 45 B19BE
- 46 B25E
- 47 OBS52
- 48 B19BE
- 49 B19BE
- 50 B19BE
- 51 B19BE
- 52 OBS52
- 53 HR12026
- 54 OBS39
- 55 GHD5539
- 56 OBS39
- 57 B19BH
- 58 OBS39
- 59 GHD5539
- 60 OBS39
- 61 HSS13037
- 62 GHD24039
- 63 B19BE
- 64 H5052 D
- 65 GHD11039
- 66 H11052
- 67 B19BH
- 68 H5052 I
- 69 H12091
- 70 B19BH
- 71 GHD20039
- 72 H6039 I
- 73 H4052 I

Victoria&Omar\_Kichen & Buffet\_APPROVED

VICTORIA Y OMAR JEBAILEY

Designed by Maria De Barros



SIGNER DESIGNER LLC  
 6375 Conroy Rd, Unit.209, Orlando, FL. 32835  
 www.signerdesignerllc.com  
 mdebarros@signerdesigner.com  
 (407) 435-5380

**DRAWING PLAN**  
**Proyecto 20015/8**

04.10.2021

Omar & Victoria Jebailey

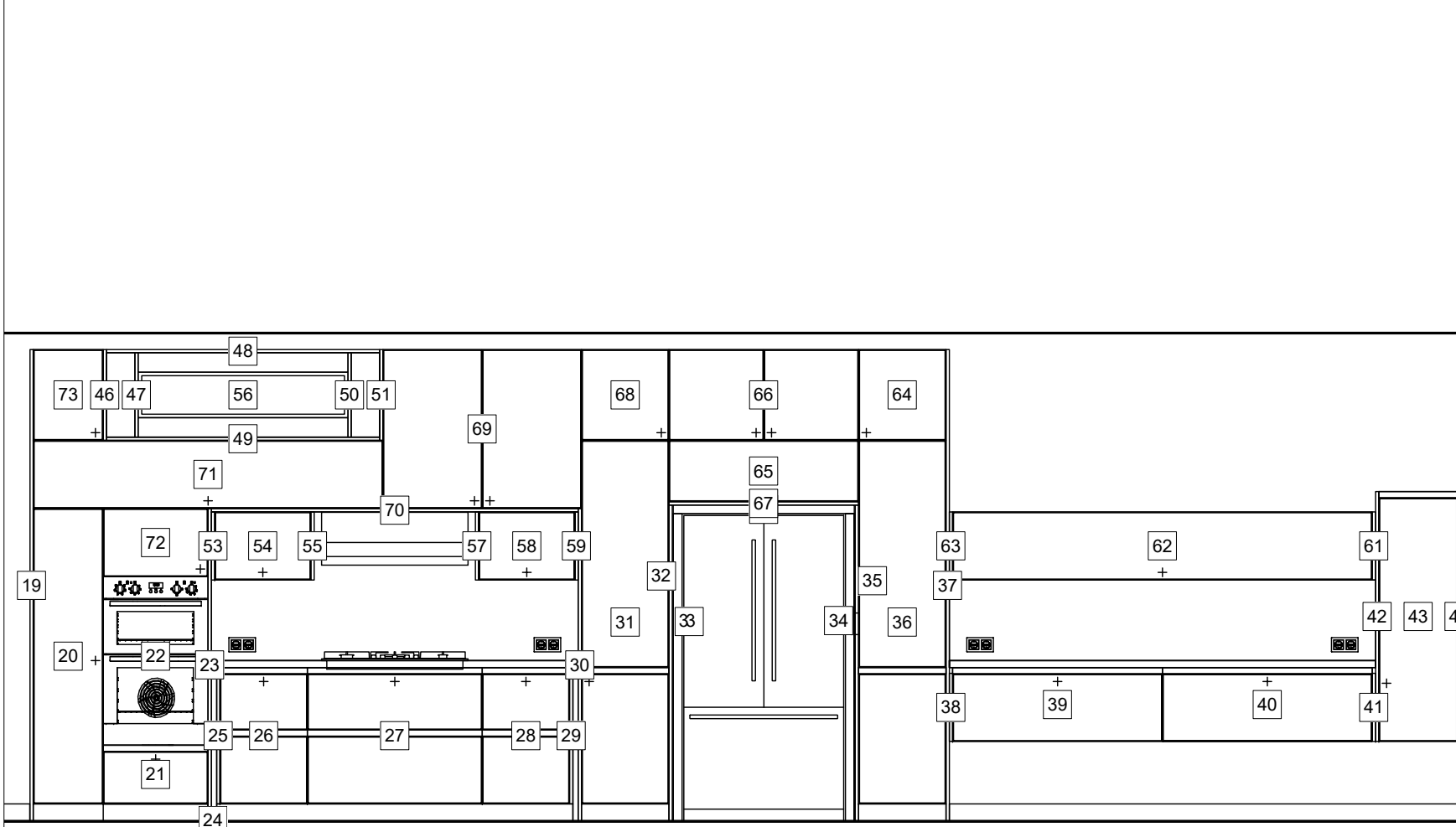

- 19 B19BH
- 20 GS40169D I
- 21 GLG6042
- 22 GSX60169 I
- 23 B19BH
- 24 WSE19125
- 25 BWS7837
- 26 GLU2GI5078
- 27 GLUKMB2G10078
- 28 GLU2GI5078
- 29 BWS7837
- 30 B19BH
- 31 GLGS50208 D
- 32 B19BH
- 33 HSH19537
- 34 HSH19537
- 35 B19BH
- 36 GLGS50208 D
- 37 B19BH
- 38 B19BE
- 39 GLG12042
- 40 GLG12042
- 41 B19BE
- 42 B19BE
- 43 GLGS45143 D
- 44 B19BE
- 46 OBS52
- 47 B19BE
- 48 B19BE
- 49 B19BE
- 50 B19BE
- 51 OBS52
- 52 HR12026
- 53 OBS39
- 54 GHD5539
- 55 OBS39
- 56 B19BH
- 57 OBS39
- 58 GHD5539
- 59 OBS39
- 60 HSS13037
- 61 B19BE
- 62 GHD24039
- 63 B19BE
- 64 H5052 D
- 65 GHD11039
- 66 H11052
- 67 B19BH
- 68 H5052 I
- 69 H12091
- 70 B19BH
- 71 GHD20039
- 72 H6039 I
- 73 H4052 I



SIGNER DESIGNER LLC  
 6375 Conroy Rd, Unit.209, Orlando, FL. 32835  
 www.signerdesignerllc.com  
 mdebarros@signerdesigner.com  
 (407) 435-5380

Vista frontal 6  
 Proyecto 20015/8

04.10.2021

Omar & Victoria Jebailey

- 14 GLUSPMM6078
- 15 GLUSP2G10078
- 16 GLU2GI10078
- 17 GFWGD7860
- 18 BWH7837

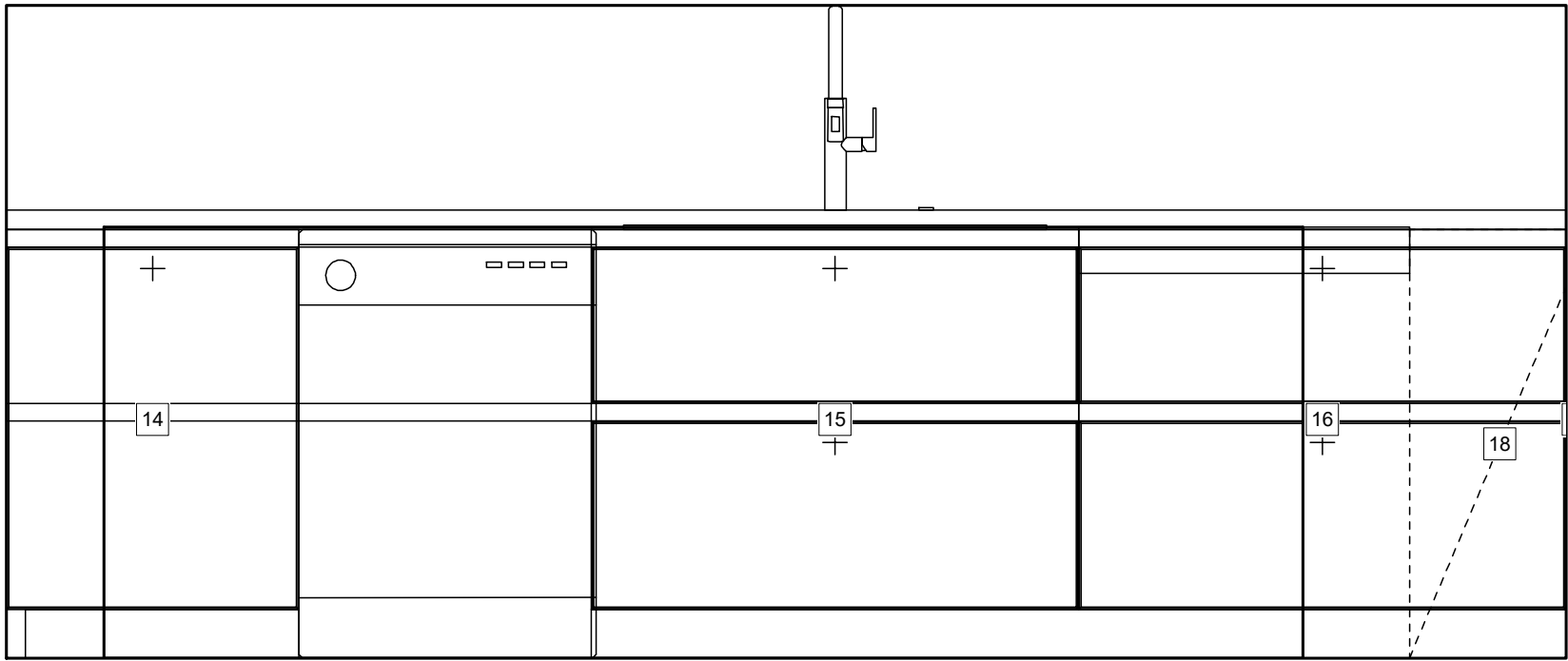

SIGNER DESIGNER LLC  
 6375 Conroy Rd, Unit.209, Orlando, FL. 32835  
 www.signerdesignerllc.com  
 mdebarros@signerdesigner.com  
 (407) 435-5380

Interior elevation of the island  
**Proyecto 20015/8**

04.10.2021

Omar & Victoria Jebailey

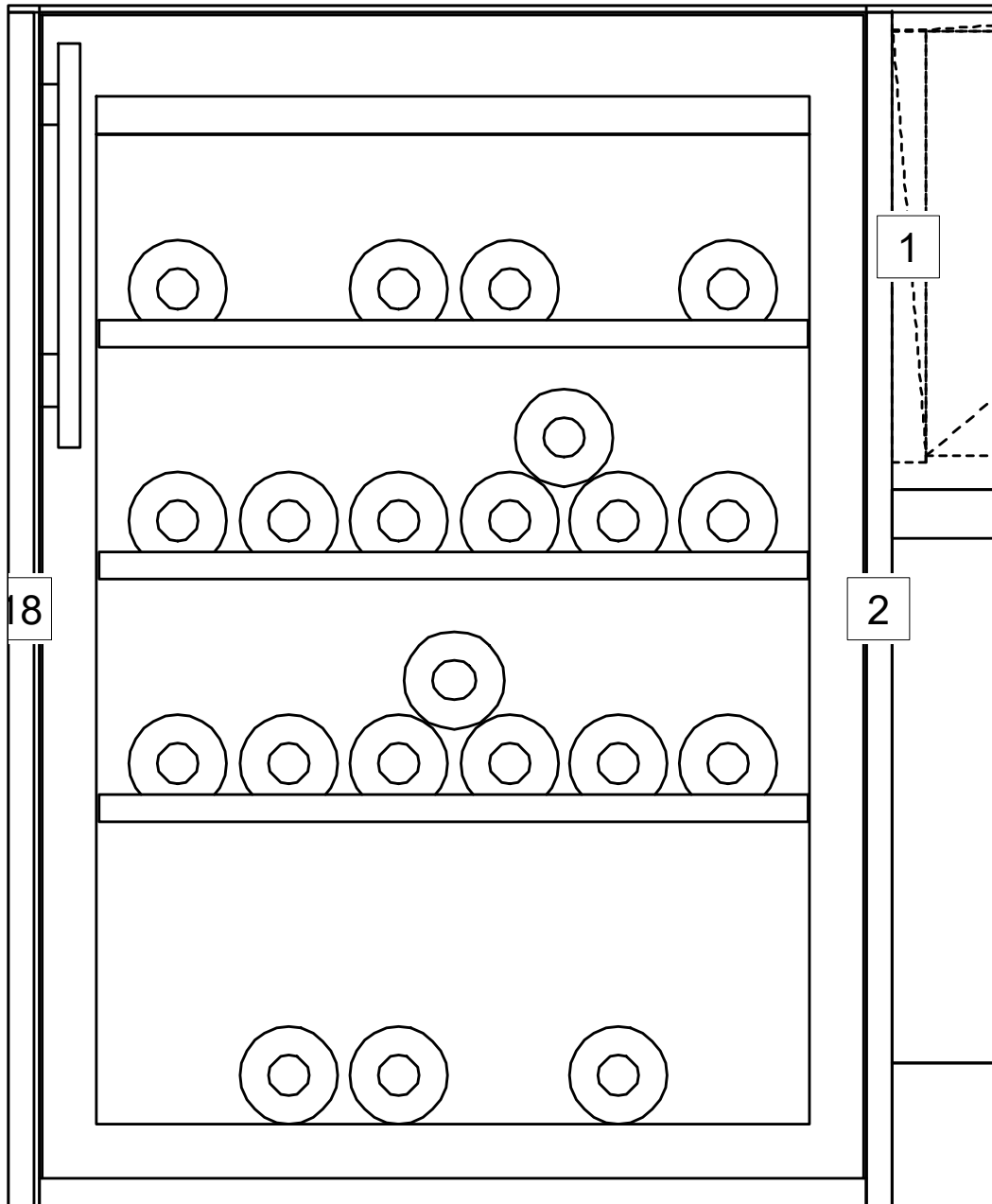

- 1 B25F
- 2 BWH7837
- 3 GFWG7839
- 4 B25E
- 18 BWH7837
- 45 B25E

Kitchen Pro  
 4247 SW 71st Ave  
 33155 Miami, FL  
 ADMIN

Side island (wine machine)  
 Proyecto 20015/8  
 04.10.2021

Omar & Victoria Jebailey



- 1 B25E
- 3 GFWG7839
- 4 B25E
- 5 GLG16042
- 6 B25E
- 7 GLG16042
- 8 B25E
- 9 B25E
- 10 GFWG15637
- 11 B25E
- 45 B25E

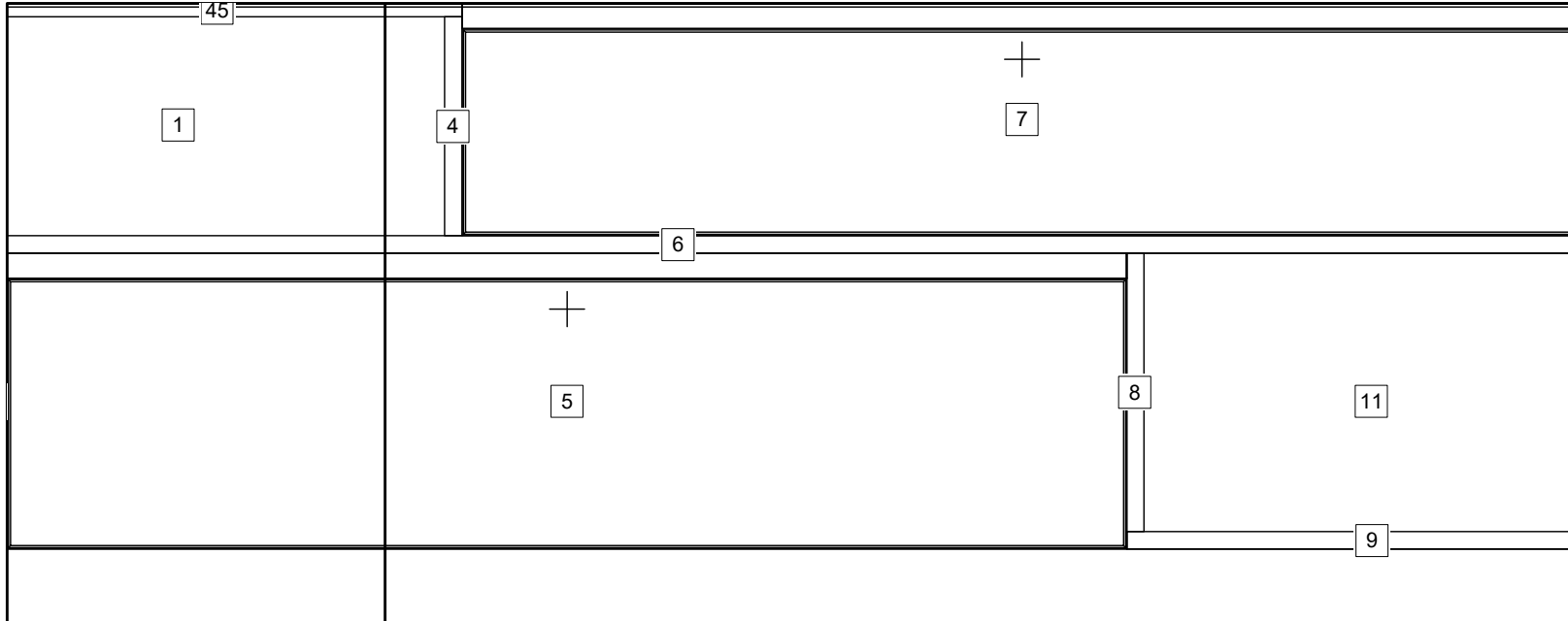

SIGNER DESIGNER LLC  
 6375 Conroy Rd, Unit.209, Orlando, FL. 32835  
 www.signerdesignerllc.com  
 mdebarros@signerdesigner.com  
 (407) 435-5380

elevation of the  
 outer island

04.10.2021

Omar & Victoria Jebailey

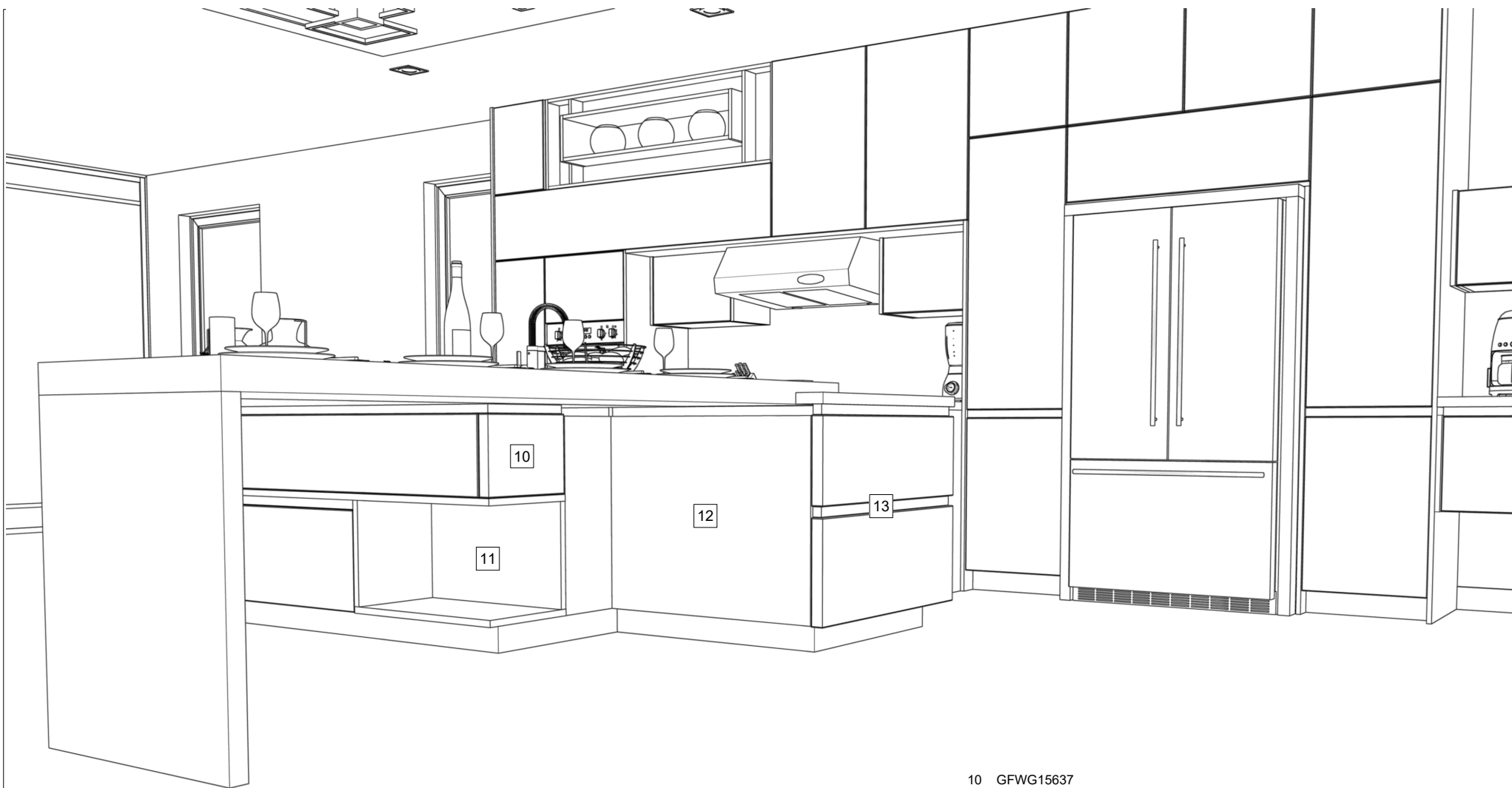

- 10 GFWG15637
- 11 B25E
- 12 B19BH
- 13 GFIWGD7899

No asumimos ninguna responsabilidad en la presentación fiel al original de los artículos. Son posibles variaciones en diseño y color.



SIGNER DESIGNER LLC  
 6375 Conroy Rd, Unit.209, Orlando, FL. 32835  
 www.signerdesignerllc.com  
 mdebarros@signerdesigner.com  
 (407) 435-5380

island side  
 Proyecto 20015/8  
 04.10.2021

Omar & Victoria Jebailey





