

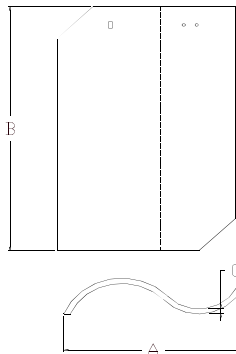

CLAY ROOF TILES

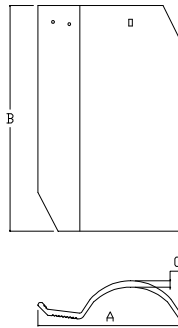

"S" TILE



GREEK

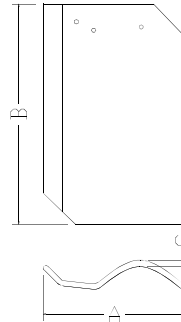

SPARTA

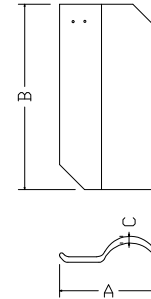

SANTORINI

DIMENSIONS	"S" TILE	GREEK TILE	SPARTA TILE	SANTORINI TILE	
A	13" 3/4	11" 3/4	10" 1/4	6"	
B	19" 3/4	18" 1/8	15" 3/4	12"	
C	3/8"	1/2"	1/2"	7/16"	
Pcs. per 100 square ft.	80,0	89,0	135,0	298,0	
Nominal Weight (lb)	7,5 lb	7,7 lb	5,3 lb	1,98 lb	
Weight per 100 sq. ft.	600 lb	716 lb	715.5 lb	590 lb	
Barrel height (in)	2" 1/2	3" 1/4	2" 3/8	1" 1/2	
Water Absortion (%)	Less than 5%				
Accesories	Ridge, Gable				
Pieces/Pallet	246	240	504	918	
100 sq. ft./pallet	3,07	2,58	3,73	3,08	
Colors	Terracotta Finisterre New Albany Lovett San Jacinto Oakville Catarina San Miguel Legend	Terracotta Tulum Catarina Tamarindo Riviera Mora Portofino Niza Napoli	Barcelona Kalahari Madera Sandstone Tundra Dune Miami Acapulco Santa Fe	Terracotta Madera Colorada	Terracotta Madera Oakville
Material	100% clay tile, extruded and fired at 1832°F				

* All weights and dimensions are approximate. Variations may occur.

REVIEW

ISO COORDINATOR

AUTHORIZE

QUALITY DIRECTOR

AUTHORIZE

OPERATIONS DIRECTOR