

LIST OF STANDARD ALUMINIUM WINDOW CONFIGURATIONS UNDER P05/2020

BLOCK TYPE	BLOCK TYPE CODE		DRAWING NO.
SINGLE TOWER	SINGLE TOWER BLOCK	SGT	SCU/EMDI/P05/2020/01
TWIN TOWER	TWIN TOWER BLOCK	TWT	SCU/EMDI/P05/2020/02
OLD SLAB	OLD SLAB BLOCK	OSL	SCU/EMDI/P05/2020/03
H-BLOCK	SINGLE 'H' BLOCK DOUBLE 'H' BLOCK TRIPLE 'H' BLOCK	SGH DBH TPH	SCU/EMDI/P05/2020/04 SCU/EMDI/P05/2020/05 SCU/EMDI/P05/2020/06 SCU/EMDI/P05/2020/07 SCU/EMDI/P05/2020/08
I-BLOCK	SINGLE 'I' BLOCK DOUBLE 'I' BLOCK TRIPLE 'I' BLOCK	SGI DBI TPI	SCU/EMDI/P05/2020/09
LINEAR BLOCK	LINEAR L1 BLOCK LINEAR L3 BLOCK LINEAR LL BLOCK	LR1 LR3 LL	SCU/EMDI/P05/2020/10 SCU/EMDI/P05/2020/11
NEWSLAB	NEW SLAB BLOCK	NSL	SCU/EMDI/P05/2020/12
TRIDENT I	TRIDENT TYPE 1 BLOCK	TR1	SCU/EMDI/P05/2020/13
TRIDENT II	TRIDENT TYPE 2 BLOCK	TR2	SCU/EMDI/P05/2020/14 SCU/EMDI/P05/2020/15 SCU/EMDI/P05/2020/16
TRIDENT III	TRIDENT TYPE 3 BLOCK	TR3	SCU/EMDI/P05/2020/17 SCU/EMDI/P05/2020/18 SCU/EMDI/P05/2020/19 SCU/EMDI/P05/2020/20
TRIDENT IV	TRIDENT TYPE 4 BLOCK	TR4	SCU/EMDI/P05/2020/21 SCU/EMDI/P05/2020/22 SCU/EMDI/P05/2020/23
HARMONY	HARMONY 1 HARMONY 2 HARMONY 3	H1 H2 H3	SCU/EMDI/P05/2020/24 SCU/EMDI/P05/2020/25 SCU/EMDI/P05/2020/26 SCU/EMDI/P05/2020/27
RURAL	LINEAR PROFILE	RH-1	SCU/EMDI/P05/2020/28
	BUTTERFLY PROFILE	RH-2	SCU/EMDI/P05/2020/29 SCU/EMDI/P05/2020/30
CRUCIFORM	CRUCIFORM BLOCK	CRF	SCU/EMDI/P05/2020/31



W1

原有正面的面貌 Original Elevation



圖 'A'



平面圖 Floor Plan

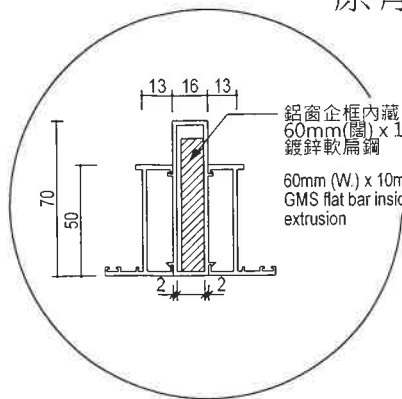
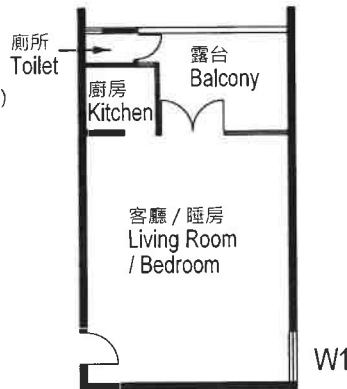

圖 'B'



正面圖 Elevation

備註:

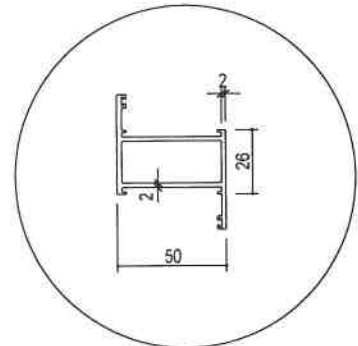
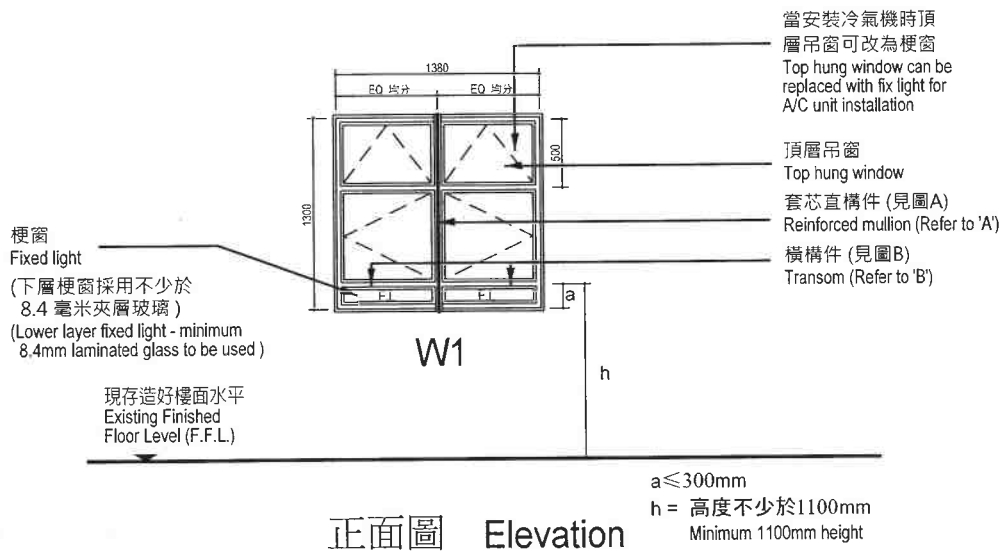
1. 所有標示的尺寸單位為毫米。
2. 玻璃厚度最少為6毫米或指定規格及厚度。
3. 鋁窗構件須按指定尺寸或不少於38毫米如沒有指定。
4. 鋁窗安裝工程須遵守房屋署安裝鋁窗之標準排列格式圖則及技術規格指引。鋁窗排列格式可改動但必須遵守屋宇署之技術規格要求。

Notes:

1. All dimensions are in millimeters.
2. All glass panes shall be of minimum 6mm thick or otherwise stated.
3. The dimensions of all window members shall be as specified or not less than 38mm if not specified.
4. Aluminium window works shall comply with Housing Department's standard aluminium window configurations and technical guidelines. Modifications may be made to the standard window configurations but should comply with the Buildings Department's technical guidelines and requirements.

工程項目 PROJECT

安裝鋁窗之標準排列格式

Standard Aluminium Window Configuration

圖則標題 DRAWING TITLE

單塔型

Single Tower Block

圖則編號 DRG NO.

SCU / EMDI / P05 / 2020 / 01

比例 SCALE

NTS

日期 DATE

3/2020



房屋署 屋邨辦事處
ESTATE OFFICE

HOUSING DEPARTMENT

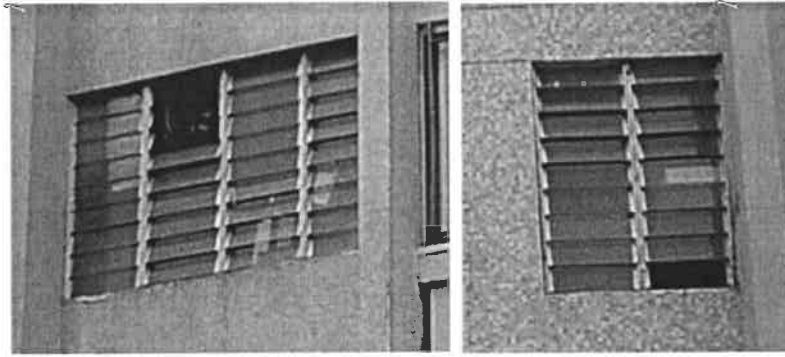

W2

W3

原有正面的面貌 Original Elevation

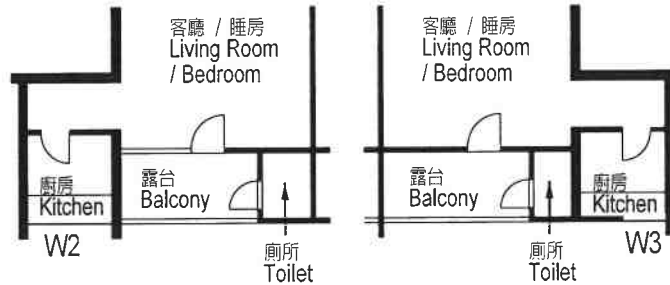

平面圖 Floor Plan

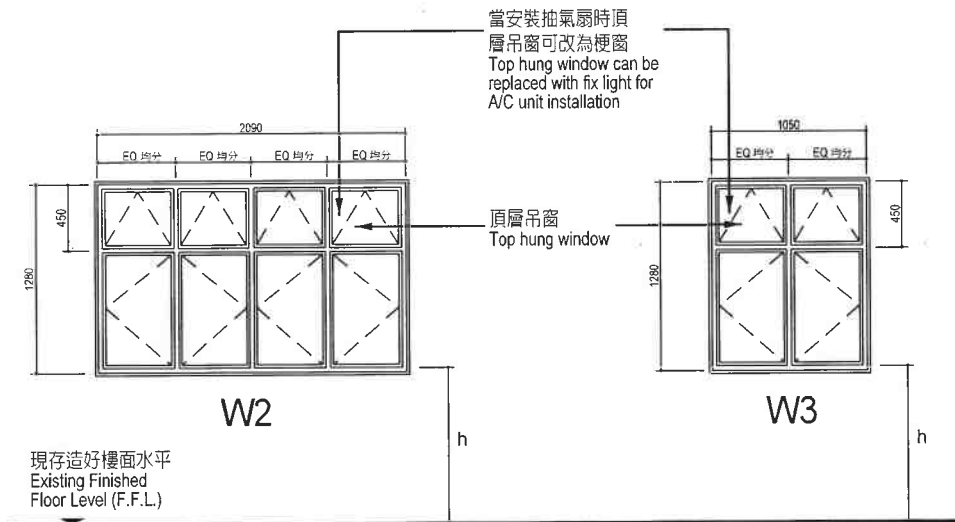

正面圖 Elevation

h = 高度不少於1100mm
Minimum 1100mm height

備註:

1. 所有標示的尺寸單位為毫米。
2. 玻璃厚度最少為6毫米或指定規格及厚度。
3. 鋁窗構件須按指定尺寸或不少於38毫米如沒有指定。
4. 鋁窗安裝工程須遵守房屋署安裝鋁窗之標準排列格式圖則及技術規格指引。鋁窗排列格式可改動但必須遵守屋宇署之技術規格要求。

Notes:

1. All dimensions are in millimeters.
2. All glass panes shall be of minimum 6mm thick or otherwise stated.
3. The dimensions of all window members shall be as specified or not less than 38mm if not specified.
4. Aluminium window works shall comply with Housing Department's standard aluminium window configurations and technical guidelines. Modifications may be made to the standard window configurations but should comply with the Buildings Department's technical guidelines and requirements.

郵 : (FA4C)164 (hu)

<p>工程項目 PROJECT 安裝鋁窗之標準排列格式 Standard Aluminium Window Configuration</p>	<p>圖則標題 DRAWING TITLE 雙塔型 Twin Tower Block</p> <p>比例 SCALE NTS 日期 DATE 3/2020</p>	<p>圖則編號 DRG NO. SCU / EMDI / P05 / 2020 / 02</p>  <p>房屋署 屋邨辦事處 ESTATE OFFICE HOUSING DEPARTMENT</p>
--	---	---



W4

原有正面的面貌 Original Elevation



平面圖 Floor Plan



圖 'B'



正面圖 Elevation

$a \leq 300\text{mm}$
 $h =$ 高度不少於1100mm
 Minimum 1100mm height

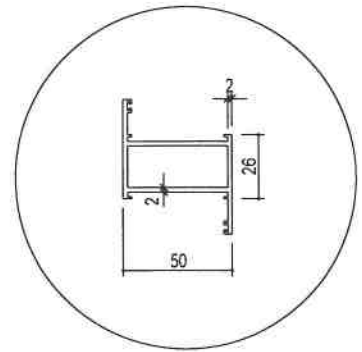
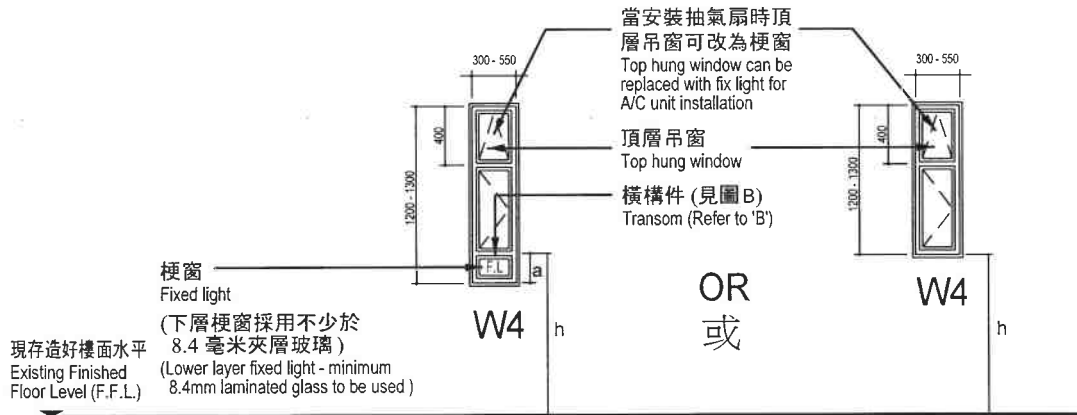
備註:

1. 所有標示的尺寸單位為毫米。
2. 玻璃厚度最少為6毫米或指定規格及厚度。
3. 鋁窗構件須按指定尺寸或不少於38毫米如沒有指定。
4. 鋁窗安裝工程須遵守房屋署安裝鋁窗之標準排列格式圖則及技術規格指引。鋁窗排列格式可改動但必須遵守屋宇署之技術規格要求。

Notes:

1. All dimensions are in millimeters.
2. All glass panes shall be of minimum 6mm thick or otherwise stated.
3. The dimensions of all window members shall be as specified or not less than 38mm if not specified.
4. Aluminium window works shall comply with Housing Department's standard aluminium window configurations and technical guidelines. Modifications may be made to the standard window configurations but should comply with the Buildings Department's technical guidelines and requirements.

工程項目 PROJECT

安裝鋁窗之標準排列格式

Standard Aluminium Window Configuration

圖則標題 DRAWING TITLE

舊長型或其他在廁所 / 廚房設有百葉玻璃的大廈
Old Slab Block Or Other Buildings Where Toilets / Kitchens Are Equipped With Glass Louvers

圖則編號 DRG NO.

SCU / EMDI / P05 / 2020 / 03

比例 SCALE

NTS

H期 DATE

3/2020

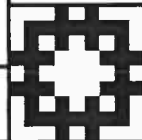

房屋署 屋邨辦事處
 ESTATE OFFICE

HOUSING DEPARTMENT



W5

原有正面的面貌 Original Elevation



圖 'A'



平面圖 Floor Plan

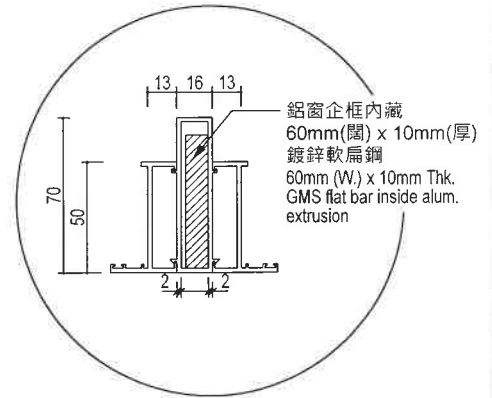
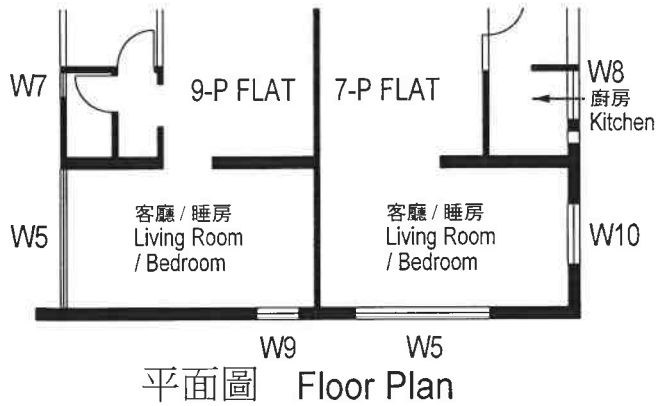

圖 'B'

當安裝冷氣機時頂層吊窗可改為梗窗
Top hung window can be replaced with fix light for A/C unit installation

頂層吊窗
Top hung window

梗窗
Fixed light

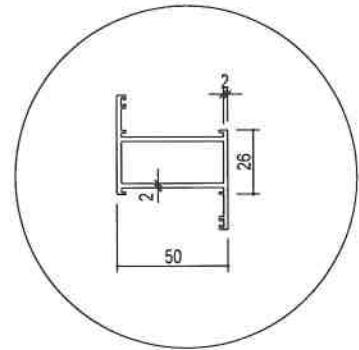
(下層梗窗採用不少於 8.4 毫米夾層玻璃)
(Lower layer fixed light - minimum 8.4mm laminated glass to be used)

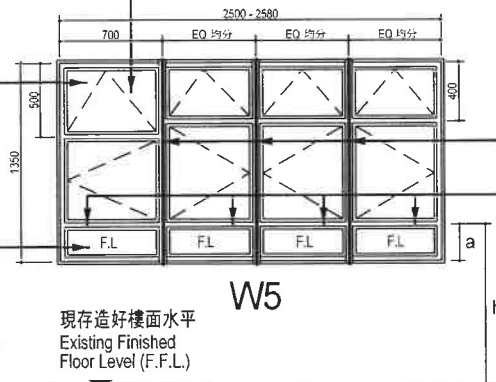

正面圖 Elevation

$a \leq 300\text{mm}$
 $h =$ 高度不少於1100mm
Minimum 1100mm height

套芯直構件 (見圖A)
Reinforced mullion (Refer to 'A')

橫構件 (見圖B)
Transom (Refer to 'B')

備註:

1. 所有標示的尺寸單位為毫米。
2. 玻璃厚度最少為6毫米或指定規格及厚度。
3. 鋁窗構件須按指定尺寸或不少於38毫米如沒有指定。
4. 鋁窗安裝工程須遵守房屋署安裝鋁窗之標準排列格式圖則及技術規格指引。鋁窗排列格式可改動但必須遵守屋宇署之技術規格要求。

Notes:

1. All dimensions are in millimeters.
2. All glass panes shall be of minimum 6mm thick or otherwise stated.
3. The dimensions of all window members shall be as specified or not less than 38mm if not specified.
4. Aluminium window works shall comply with Housing Department's standard aluminium window configurations and technical guidelines. Modifications may be made to the standard window configurations but should comply with the Buildings Department's technical guidelines and requirements.

工程項目 PROJECT

安裝鋁窗之標準排列格式

Standard Aluminium Window Configuration

圖則標題 DRAWING TITLE

工字型 (第一頁)

H Block (Sheet 1 of 5)

圖則編號 DRG NO.

SCU / EMDI / P05 / 2020 / 04

比例 SCALE NTS

日期 DATE 3/2020



房屋署 屋邨辦事處
ESTATE OFFICE

HOUSING DEPARTMENT

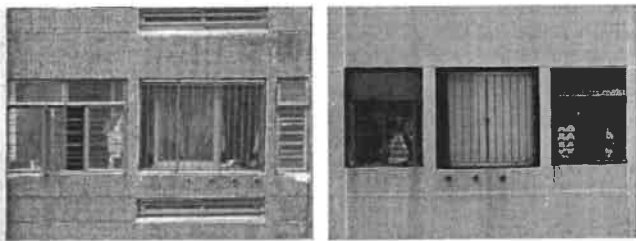

W6 W7 W8 W8
原有正面的面貌 Original Elevation



圖 'A'

鋁窗企框內藏
60mm(闊) x 10mm(厚)
鍍鋅軟扁鋼
60mm (W.) x 10mm Thk.
GMS flat bar inside alum.
extrusion



圖 'B'

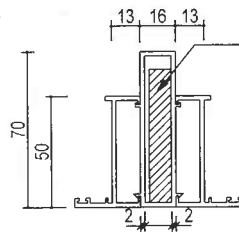

平面圖 Floor Plan

當安裝抽氣扇時頂層吊窗可改為梗窗
Top hung window can be replaced with fix light for exhaust fan installation

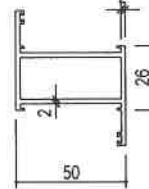
套芯直構件(見圖A)
Reinforced mullion(Refer to 'A')
橫構件(見圖B)
Transom(Refer to 'B')

梗窗
Fixed light
(下層梗窗採用不少於
8.4 毫米夾層玻璃)
(Lower layer fixed light - minimum
8.4mm laminated glass to be used)

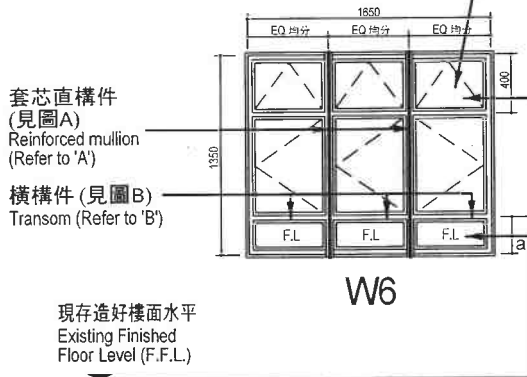
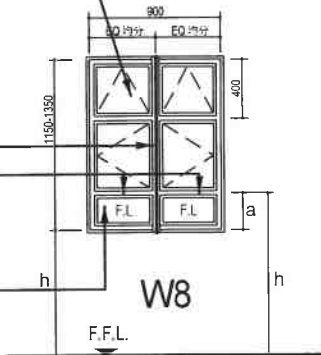

現存造好樓面水平
Existing Finished
Floor Level (F.F.L.)

當安裝抽氣扇時頂層吊窗可改為梗窗
Top hung window can be replaced with fix light for exhaust fan installation

頂層吊窗
Top hung window

橫構件(見圖B)
Transom(Refer to 'B')

梗窗
Fixed light
(下層梗窗採用不少於
8.4 毫米夾層玻璃)
(Lower layer fixed light - minimum
8.4mm laminated glass to be used)

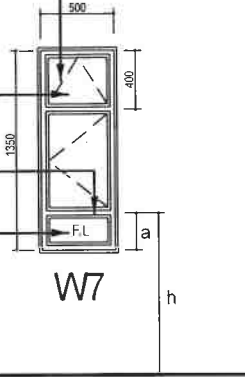

$a \leq 300\text{mm}$
 $h = \text{高度不少於} 1100\text{mm}$
Minimum 1100mm height

正面圖 Elevation

備註:

1. 所有標示的尺寸單位為毫米。
2. 玻璃厚度最少為6毫米或指定規格及厚度。
3. 鋁窗構件須按指定尺寸或不少於38毫米如沒有指定。
4. 鋁窗安裝工程須遵守房屋署安裝鋁窗之標準排列格式圖則及技術規格指引。鋁窗排列格式可改動但必須遵守屋宇署之技術規格要求。

Notes:

1. All dimensions are in millimeters.
2. All glass panes shall be of minimum 6mm thick or otherwise stated.
3. The dimensions of all window members shall be as specified or not less than 38mm if not specified.
4. Aluminium window works shall comply with Housing Department's standard aluminium window configurations and technical guidelines. Modifications may be made to the standard window configurations but should comply with the Buildings Department's technical guidelines and requirements.

工程項目 PROJECT

安裝鋁窗之標準排列格式

Standard Aluminium Window Configuration

圖則標題 DRAWING TITLE

工字型(第二頁)

H Block (Sheet 2 of 5)

圖則編號 DRG NO.

SCU / EMDI / P05 / 2020 / 05

比例 SCALE NTS

日期 DATE 3/2020



房屋署 屋邨辦事處
ESTATE OFFICE

HOUSING DEPARTMENT



W9

W10

原有正面的面貌 Original Elevation



圖 'A'



平面圖 Floor Plan

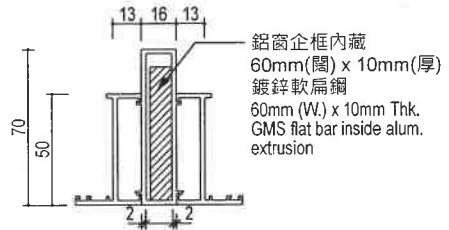
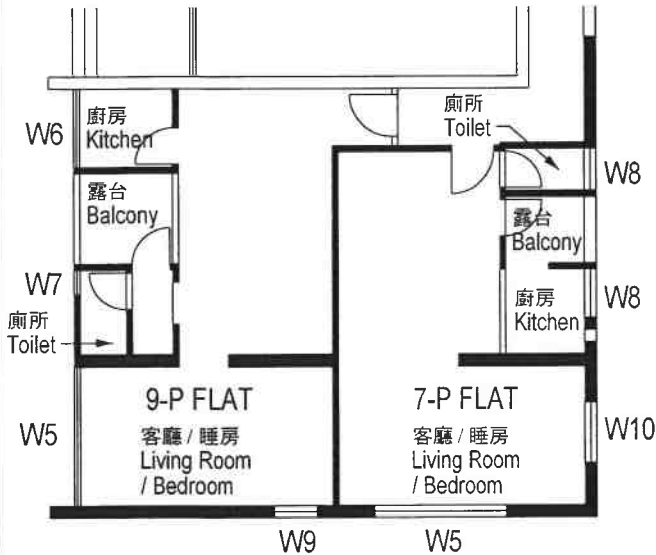

圖 'B'



圖 'C'

鋁窗橫樑內藏
40mm(闊) x 12mm(厚)
鍍鋅軟扁鋼
40mm (W.) x 12mm Thk. GMS
flat bar inside alum. extrusion

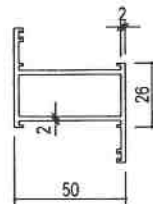
當安裝冷氣機時頂層吊窗可改為橫窗
Top hung window can be replaced with fix light for A/C unit installation

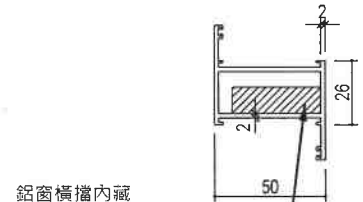
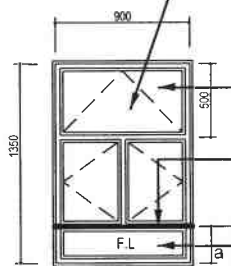

W9

頂層吊窗
Top hung window
套芯橫構件(見圖C)
Reinforced transom (Refer to 'C')
橫構件(見圖B)
Transom (Refer to 'B')
橫窗
Fixed light

(下層橫窗採用不少於
8.4 毫米夾層玻璃)
(Lower layer fixed light - minimum
8.4mm laminated glass to be used)

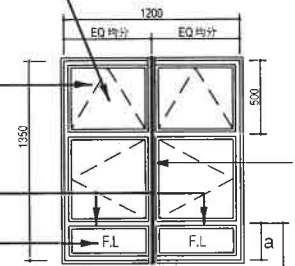

W10

套芯直構件(見圖A)
Reinforced mullion
(Refer to 'A')

現存造好樓面水平
Existing Finished
Floor Level (F.F.L.)

$a \leq 300\text{mm}$
 $h =$ 高度不少於1100mm
Minimum 1100mm height

正面圖 Elevation

備註:

1. 所有標示的尺寸單位為毫米。
2. 玻璃厚度最少為6毫米或指定規格及厚度。
3. 鋁窗構件須按指定尺寸或不少於38毫米如沒有指定。
4. 鋁窗安裝工程須遵守房屋署安裝鋁窗之標準排列格式圖則及技術規格指引。鋁窗排列格式可改動但必須遵守屋宇署之技術規格要求。

Notes:

1. All dimensions are in millimeters.
2. All glass panes shall be of minimum 6mm thick or otherwise stated.
3. The dimensions of all window members shall be as specified or not less than 38mm if not specified.
4. Aluminium window works shall comply with Housing Department's standard aluminium window configurations and technical guidelines. Modifications may be made to the standard window configurations but should comply with the Buildings Department's technical guidelines and requirements.

工程項目 PROJECT

安裝鋁窗之標準排列格式

Standard Aluminium Window Configuration

圖則標題 DRAWING TITLE

工字型 (第三頁)

H Block (Sheet 3 of 5)

圖則編號 DRG NO.

SCU / EMDI / P05 / 2020 / 06

比例 SCALE NTS

日期 DATE 3/2020

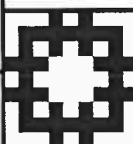

房屋署 屋邨辦事處
ESTATE OFFICE

HOUSING DEPARTMENT

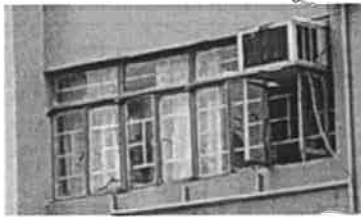

W11

原有正面的面貌 Original Elevation

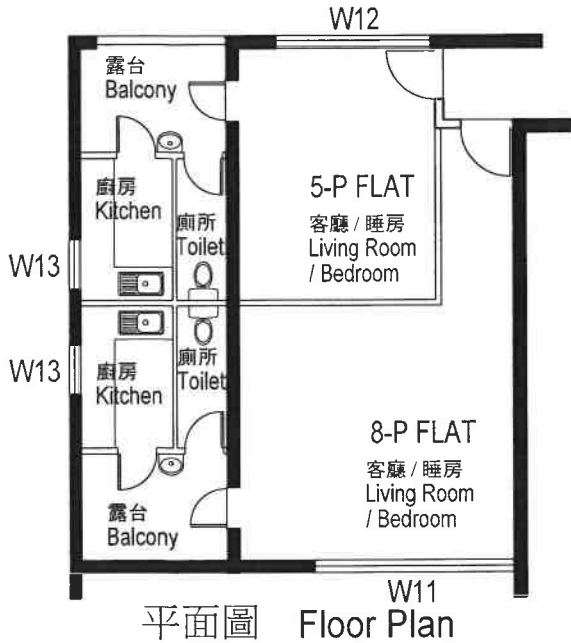

平面圖 Floor Plan



圖 'A'



圖 'B'

當安裝冷氣機時頂層吊窗可改為梗窗
Top hung window can be replaced with fix light for A/C unit installation

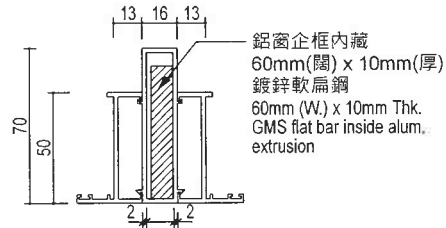
梗窗
Fixed light

(下層梗窗採用不少於 8.4 毫米夾層玻璃)
(Lower layer fixed light - minimum 8.4mm laminated glass to be used)

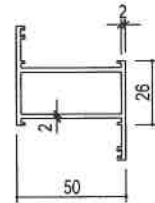
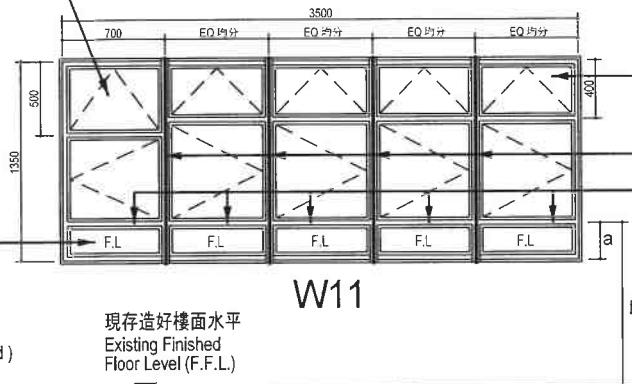

W11

現存造好樓面水平
Existing Finished Floor Level (F.F.L.)

頂層吊窗
Top hung window
套芯直構件 (見圖 A)
Reinforced mullion (Refer to 'A')
橫構件 (見圖 B)
Transom (Refer to 'B')

正面圖 Elevation

$a \leq 300\text{mm}$
 $h =$ 高度不少於 1100mm
Minimum 1100mm height

備註:

1. 所有標示的尺寸單位為毫米。
2. 玻璃厚度最少為 6 毫米或指定規格及厚度。
3. 鋁窗構件須按指定尺寸或不少於 38 毫米如沒有指定。
4. 鋁窗安裝工程須遵守房屋署安裝鋁窗之標準排列格式圖則及技術規格指引。鋁窗排列格式可改動但必須遵守屋宇署之技術規格要求。

Notes:

1. All dimensions are in millimeters.
2. All glass panes shall be of minimum 6mm thick or otherwise stated.
3. The dimensions of all window members shall be as specified or not less than 38mm if not specified.
4. Aluminium window works shall comply with Housing Department's standard aluminium window configurations and technical guidelines. Modifications may be made to the standard window configurations but should comply with the Buildings Department's technical guidelines and requirements.

工程項目 PROJECT

安裝鋁窗之標準排列格式

Standard Aluminium Window Configuration

圖則標題 DRAWING TITLE

工字型 (第四頁)

H Block (Sheet 4 of 5)

圖則編號 DRG NO.

SCU / EMDI / P05 / 2020 / 07

比例 SCALE NTS

H 期 DATE 3/2020



房屋署 屋邨辦事處
ESTATE OFFICE

HOUSING DEPARTMENT



W12



W13

原有正面的面貌 Original Elevation

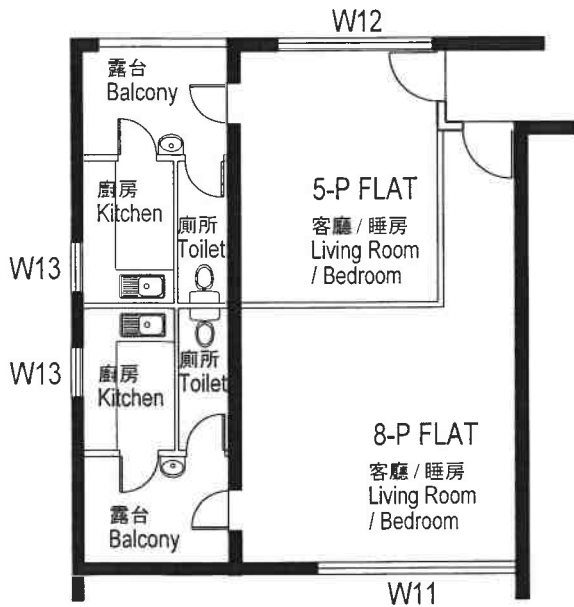

平面圖 Floor Plan



圖 'A'



圖 'B'

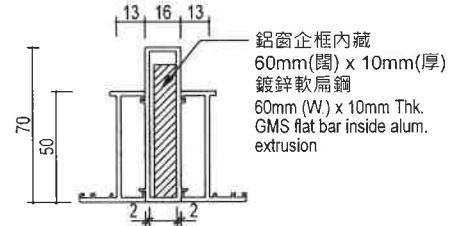
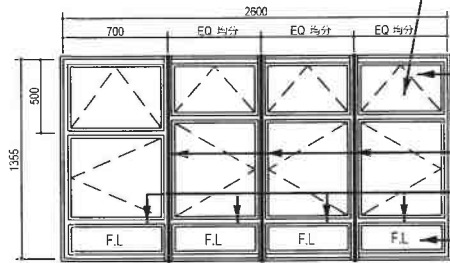

W12

現存造好樓面水平
Existing Finished
Floor Level (F.F.L.)

當安裝冷氣機時頂層吊窗可改為梗窗
Top hung window can be replaced with fix light for A/C unit installation

當安裝抽氣扇時頂層吊窗可改為梗窗
Top hung window can be replaced with fix light when exhaust fans are installed

頂層吊窗
Top hung window
套芯直構件 (見圖A)
Reinforced mullion (Refer to 'A')
橫構件 (見圖B)
Transom (Refer to 'B')
梗窗
Fixed light
(下層梗窗採用不少於
8.4 毫米夾層玻璃)
(Lower layer fixed light - minimum
8.4mm laminated glass to be used)

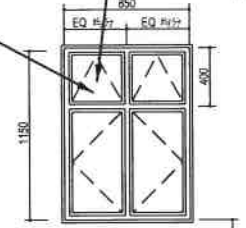

W13

$a \leq 300\text{mm}$
 $h = \text{高度不少於} 1100\text{mm}$
Minimum 1100mm height

正面圖 Elevation

備註:

1. 所有標示的尺寸單位為毫米。
2. 玻璃厚度最少為6毫米或指定規格及厚度。
3. 鋁窗構件須按指定尺寸或不少於38毫米如沒有指定。
4. 鋁窗安裝工程須遵守房屋署安裝鋁窗之標準排列格式圖則及技術規格指引。鋁窗排列格式可改動但必須遵守屋宇署之技術規格要求。

Notes:

1. All dimensions are in millimeters.
2. All glass panes shall be of minimum 6mm thick or otherwise stated.
3. The dimensions of all window members shall be as specified or not less than 38mm if not specified.
4. Aluminium window works shall comply with Housing Department's standard aluminium window configurations and technical guidelines. Modifications may be made to the standard window configurations but should comply with the Buildings Department's technical guidelines and requirements.

工程項目 PROJECT
安裝鋁窗之標準排列格式

Standard Aluminium Window Configuration

圖則標題 DRAWING TITLE

工字型 (第五頁)
H Block (Sheet 5 of 5)

圖則編號 DRG NO.

SCU / EMDI / P05 / 2020 / 08

比例 SCALE NTS

日期 DATE 3/2020

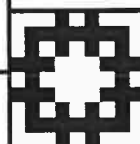

房屋署 屋邨辦事處
ESTATE OFFICE

HOUSING DEPARTMENT



W14

原有正面的面貌 Original Elevation



圖 'A'



平面圖 Floor Plan

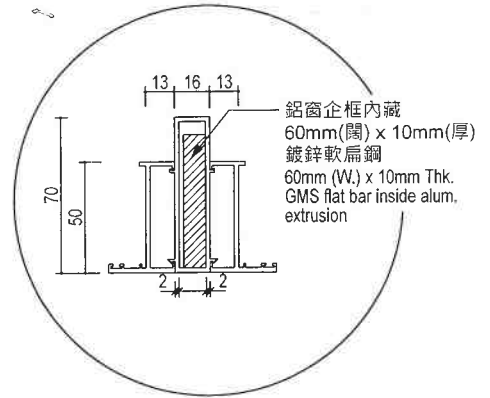

圖 'B'



正面圖 Elevation

備註:

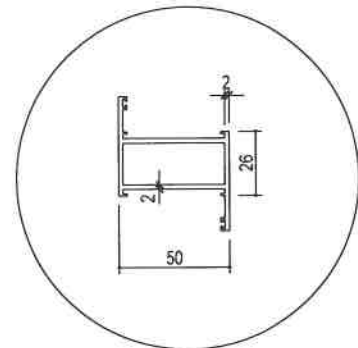
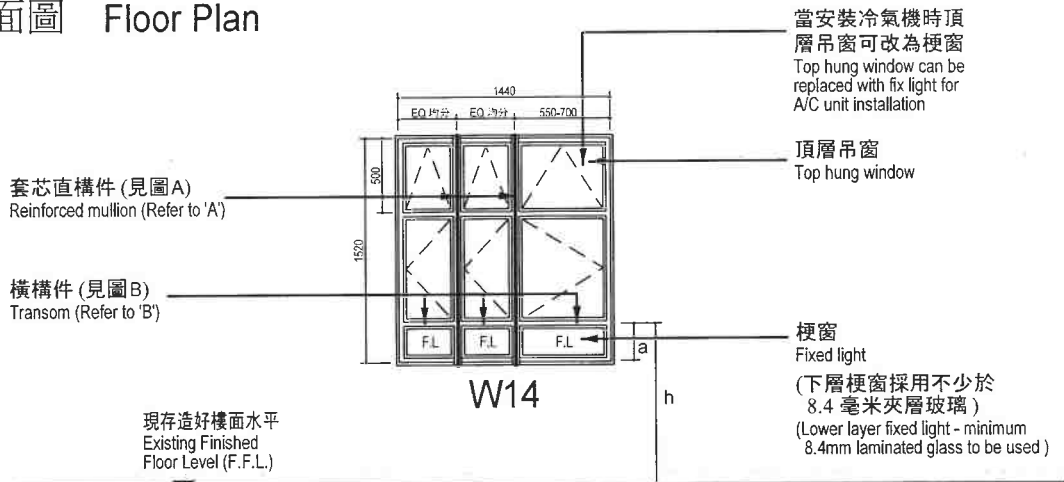
1. 所有標示的尺寸單位為毫米。
2. 玻璃厚度最少為6毫米或指定規格及厚度。
3. 鋁窗構件須按指定尺寸或不少於38毫米如沒有指定。
4. 鋁窗安裝工程須遵守房屋署安裝鋁窗之標準排列格式圖則及技術規格指引。鋁窗排列格式可改動但必須遵守屋宇署之技術規格要求。

Notes:

1. All dimensions are in millimeters.
2. All glass panes shall be of minimum 6mm thick or otherwise stated.
3. The dimensions of all window members shall be as specified or not less than 38mm if not specified.
4. Aluminium window works shall comply with Housing Department's standard aluminium window configurations and technical guidelines. Modifications may be made to the standard window configurations but should comply with the Buildings Department's technical guidelines and requirements.

工程項目 PROJECT 安裝鋁窗之標準排列格式 Standard Aluminium Window Configuration	圖則標題 DRAWING TITLE I 型 I Block 比例 SCALE NTS 日期 DATE 3/2020	圖則編號 DRG NO. SCU / EMDI / P05 / 2020 / 09  房屋署 屋邨辦事處 ESTATE OFFICE HOUSING DEPARTMENT
---	---	---



W15

W16

原有正面的面貌 Original Elevation

W15 W15 W15 W17

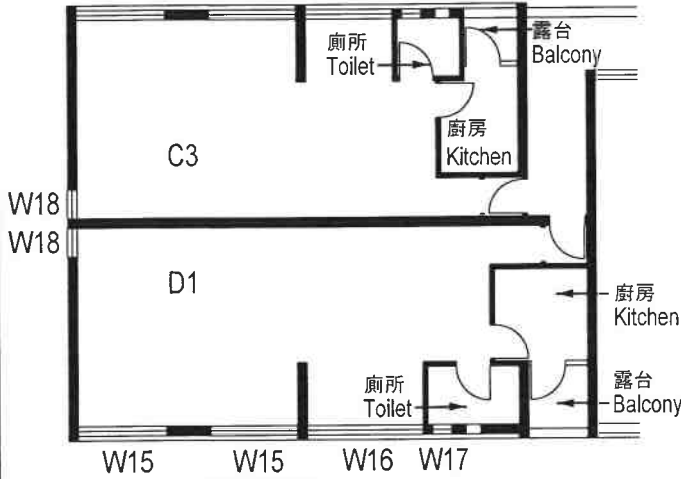

平面圖 Floor Plan



圖 'A'



圖 'B'

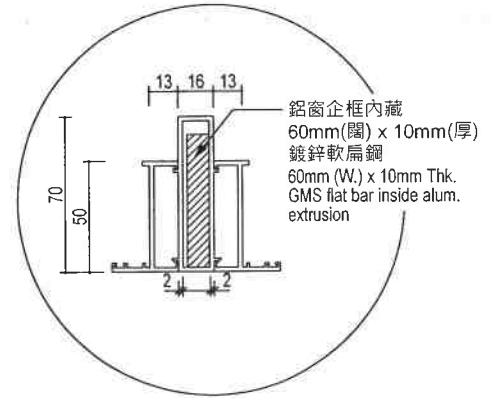

現存造好樓面水平
Existing Finished
Floor Level (F.F.L.)

W15

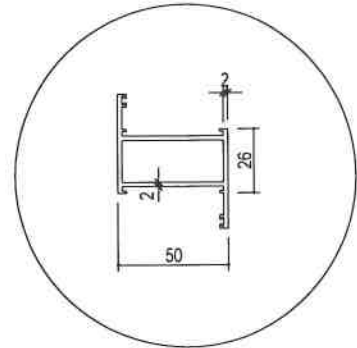
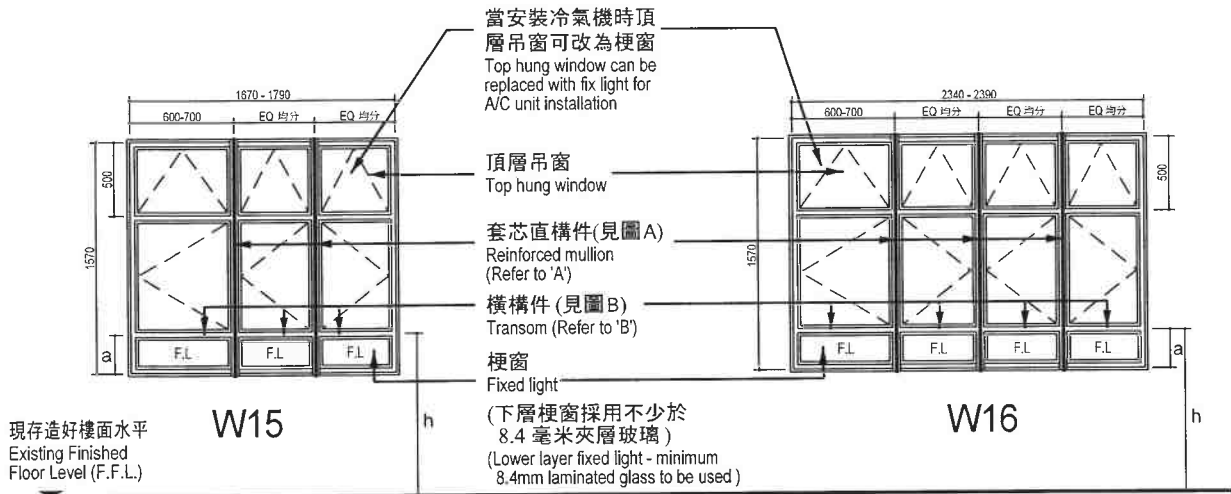
W16

正面圖 Elevation

$a \leq 300\text{mm}$

$h =$ 高度不少於1100mm
Minimum 1100mm height

備註:

- 所有標示的尺寸單位為毫米。
- 玻璃厚度最少為6毫米或指定規格及厚度。
- 鋁窗構件須按指定尺寸或不少於38毫米如沒有指定。
- 鋁窗安裝工程須遵守房屋署安裝鋁窗之標準排列格式圖則及技術規格指引。鋁窗排列格式可改動但必須遵守屋宇署之技術規格要求。

Notes:

- All dimensions are in millimeters.
- All glass panes shall be of minimum 6mm thick or otherwise stated.
- The dimensions of all window members shall be as specified or not less than 38mm if not specified.
- Aluminium window works shall comply with Housing Department's standard aluminium window configurations and technical guidelines. Modifications may be made to the standard window configurations but should comply with the Buildings Department's technical guidelines and requirements.

工程項目 PROJECT

安裝鋁窗之標準排列格式

Standard Aluminium Window Configuration

圖則標題 DRAWING TITLE

相連長型 (第一頁)

Linear Block (Sheet 1 of 2)

圖則編號 DRG NO.

SCU / EMDI / P05 / 2020 / 10

比例 SCALE NTS

日期 DATE 3/2020

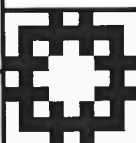

房屋署 屋邨辦事處
ESTATE OFFICE

HOUSING DEPARTMENT



W17



W18



W19

原有正面的面貌 Original Elevation



圖 'A'



平面圖 Floor Plan

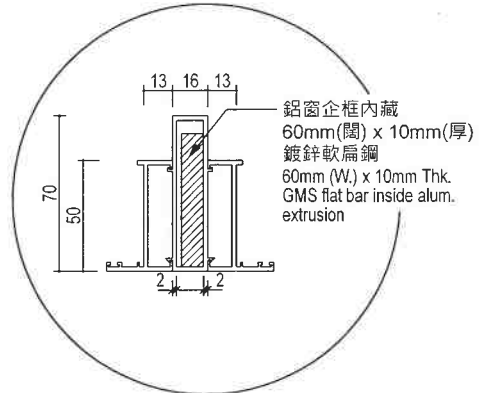
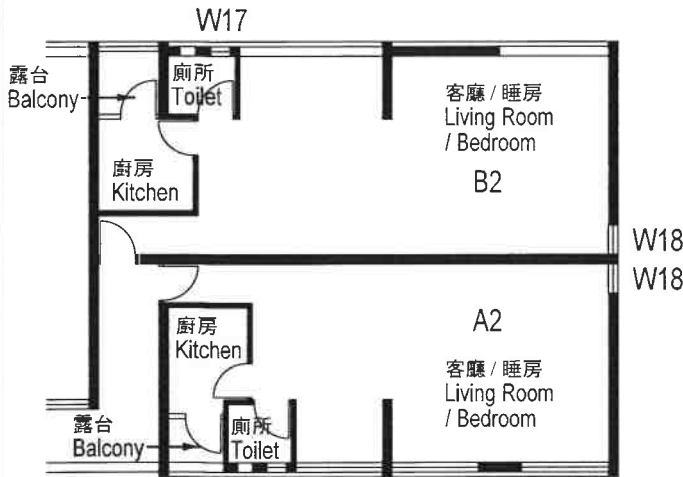

圖 'B'



正面圖 Elevation

a ≤ 300mm
h = 高度不少於1100mm
Minimum 1100mm height

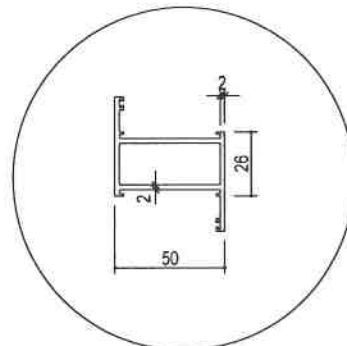
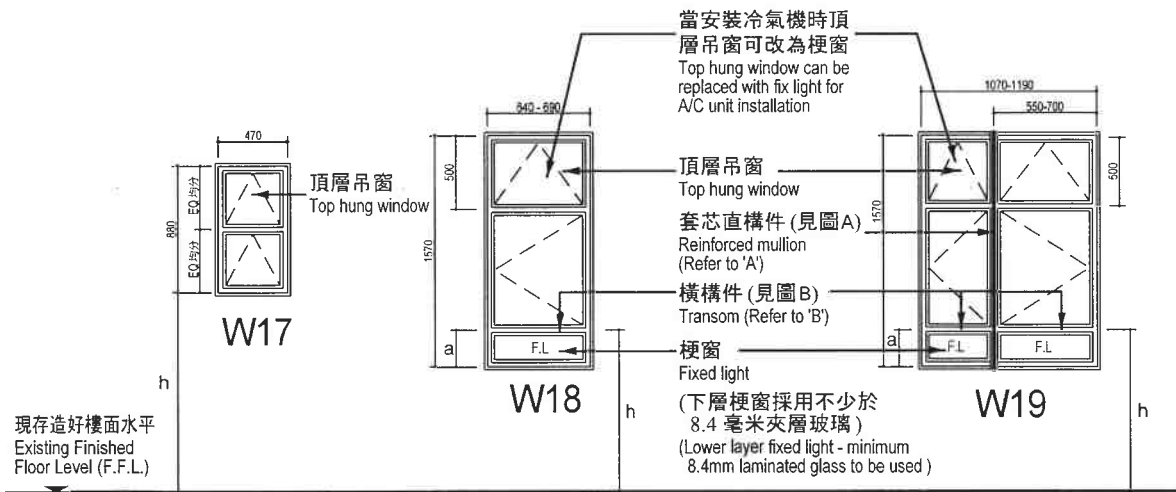
備註:

1. 所有標示的尺寸單位為毫米。
2. 玻璃厚度最少為6毫米或指定規格及厚度。
3. 鋁窗構件須按指定尺寸或不少於38毫米如沒有指定。
4. 鋁窗安裝工程須遵守房屋署安裝鋁窗之標準排列格式圖則及技術規格指引。鋁窗排列格式可改動但必須遵守屋宇署之技術規格要求。

Notes:

1. All dimensions are in millimeters.
2. All glass panes shall be of minimum 6mm thick or otherwise stated.
3. The dimensions of all window members shall be as specified or not less than 38mm if not specified.
4. Aluminium window works shall comply with Housing Department's standard aluminium window configurations and technical guidelines. Modifications may be made to the standard window configurations but should comply with the Buildings Department's technical guidelines and requirements.

工程項目 PROJECT

安裝鋁窗之標準排列格式

Standard Aluminium Window Configuration

圖則標題 DRAWING TITLE

相連長型(第二頁)

Linear Block (Sheet 2 of 2)

圖則編號 DRG NO.

SCU / EMDI / P05 / 2020 / 11

比例 SCALE

NTS

日期 DATE

3/2020

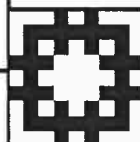

房屋署 屋邨辦事處
ESTATE OFFICE

HOUSING DEPARTMENT



W20 W21
原有正面的面貌 Original Elevation



圖 'A'

鋁窗企框內藏
60mm(闊) x 10mm(厚)
鍍鋅軟扁鋼
60mm (W.) x 10mm Thk.
GMS flat bar inside alum.
extrusion



W20 W21
平面圖 Floor Plan

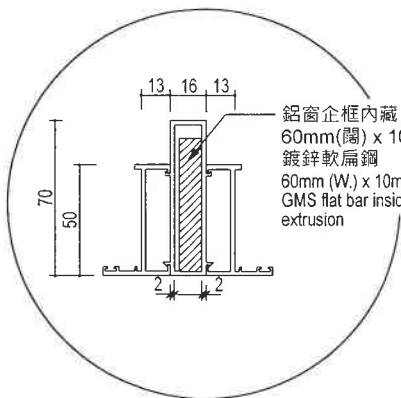

圖 'B'



正面圖 Elevation

$a \leq 300\text{mm}$
 $h =$ 高度不少於1100mm
Minimum 1100mm height

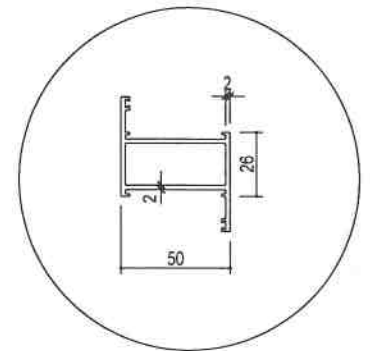
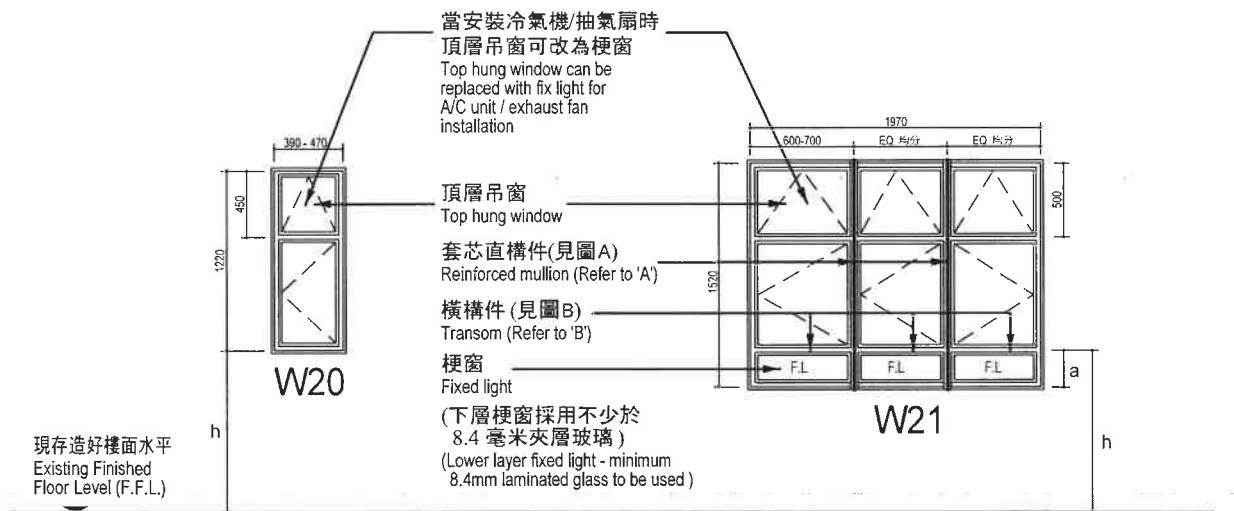
備註:

1. 所有標示的尺寸單位為毫米。
2. 玻璃厚度最少為6毫米或指定規格及厚度。
3. 鋁窗構件須按指定尺寸或不少於38毫米如沒有指定。
4. 鋁窗安裝工程須遵守房屋署安裝鋁窗之標準排列格式圖則及技術規格指引。鋁窗排列格式可改動但必須遵守屋宇署之技術規格要求。

Notes:

1. All dimensions are in millimeters.
2. All glass panes shall be of minimum 6mm thick or otherwise stated.
3. The dimensions of all window members shall be as specified or not less than 38mm if not specified.
4. Aluminium window works shall comply with Housing Department's standard aluminium window configurations and technical guidelines. Modifications may be made to the standard window configurations but should comply with the Buildings Department's technical guidelines and requirements.

工程項目 PROJECT

安裝鋁窗之標準排列格式

Standard Aluminium Window Configuration

圖則標題 DRAWING TITLE

新長型

New Slab Block

圖則編號 DRG NO.

SCU / EMDI / P05 / 2020 / 12

比例 SCALE

NTS

日期 DATE

3/2020

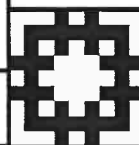

房屋署 屋邨辦事處
ESTATE OFFICE

HOUSING DEPARTMENT

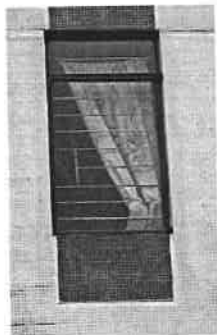

W22

原有正面的面貌 Original Elevation



平面圖 Floor Plan

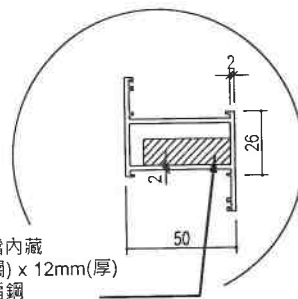

鋁窗橫擋內藏
40mm(闊) x 12mm(厚)
鍍鋅軟扁鐵
40mm (W.) x 12mm Thk. GMS
flat bar inside alum. extrusion

圖 'C'

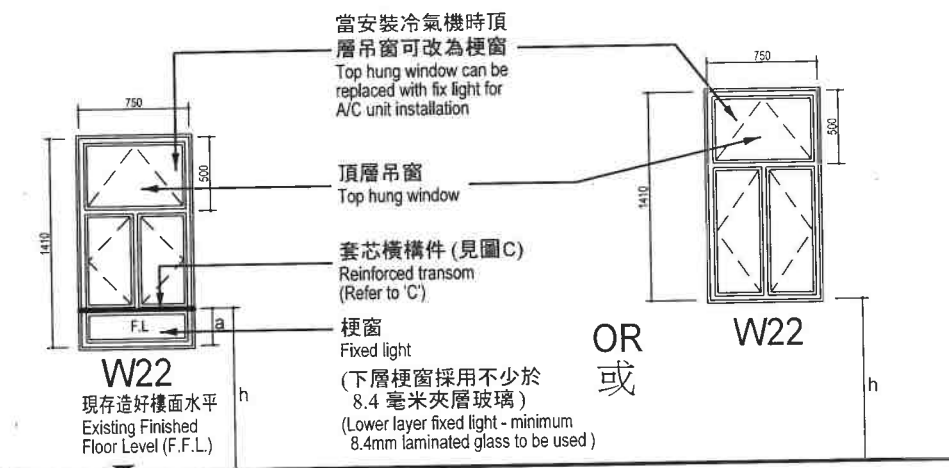

正面圖 Elevation

$a \leq 300\text{mm}$
 $h = \text{高度不少於}1100\text{mm}$
Minimum 1100mm height

備註:

1. 所有標示的尺寸單位為毫米。
2. 玻璃厚度最少為6毫米或指定規格及厚度。
3. 鋁窗構件須按指定尺寸或不少於38毫米如沒有指定。
4. 鋁窗安裝工程須遵守房屋署安裝鋁窗之標準排列格式圖則及技術規格指引。鋁窗排列格式可改動但必須遵守屋宇署之技術規格要求。

Notes:

1. All dimensions are in millimeters.
2. All glass panes shall be of minimum 6mm thick or otherwise stated.
3. The dimensions of all window members shall be as specified or not less than 38mm if not specified.
4. Aluminium window works shall comply with Housing Department's standard aluminium window configurations and technical guidelines. Modifications may be made to the standard window configurations but should comply with the Buildings Department's technical guidelines and requirements.

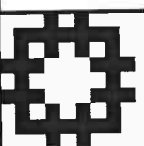
工程項目 PROJECT 安裝鋁窗之標準排列格式 Standard Aluminium Window Configuration	圖則標題 DRAWING TITLE Y-型 Trident I Block 比例 SCALE NTS 日期 DATE 3/2020	圖則編號 DRG NO. SCU / EMDI / P05 / 2020 / 13  房屋署 屋邨辦事處 ESTATE OFFICE HOUSING DEPARTMENT
---	---	---



W23
原有正面的面貌

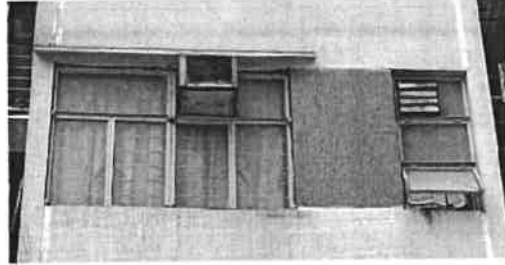

W24
Original Elevation

W25



圖 'A'



平面圖 Floor Plan

當安裝抽氣扇時頂層吊窗可改為梗窗
Top hung window can be replaced with fix light for exhaust fan installation

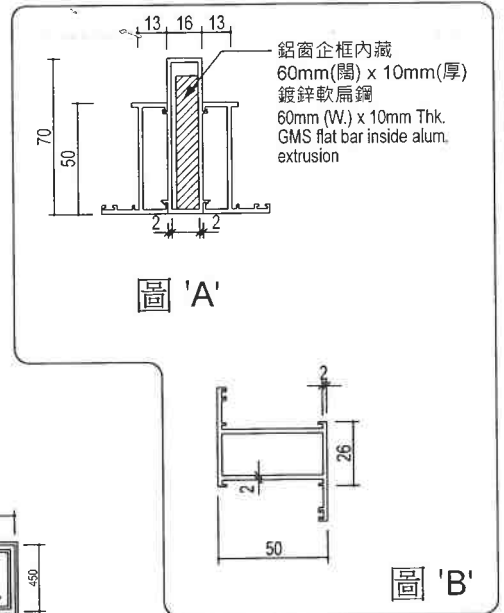
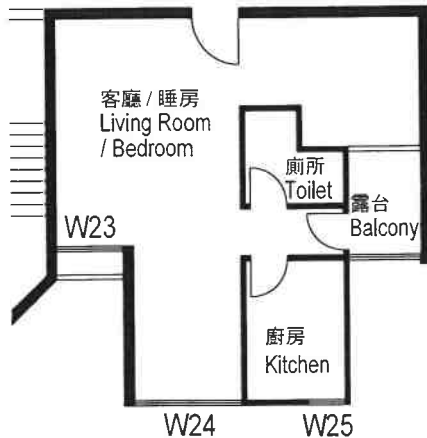
橫構件 (見圖B)
Transom (Refer to 'B')

梗窗
Fixed light

(下層梗窗採用不少於 8.4 毫米夾層玻璃)
(Lower layer fixed light - minimum 8.4mm laminated glass to be used)



圖 'B'

當安裝冷氣機時頂層吊窗可改為梗窗
Top hung window can be replaced with fix light for A/C unit installation

頂層吊窗
Top hung window

套芯直構件(見圖A)
Reinforced mullion (Refer to 'A')

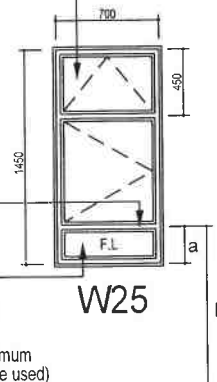
橫構件 (見圖B)
Transom (Refer to 'B')

梗窗
Fixed light

(下層梗窗採用不少於 8.4 毫米夾層玻璃)
(Lower layer fixed light - minimum 8.4mm laminated glass to be used)

現存造好樓面水平
Existing Finished Floor Level (F.F.L.)

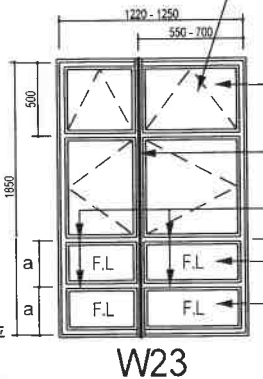

W23

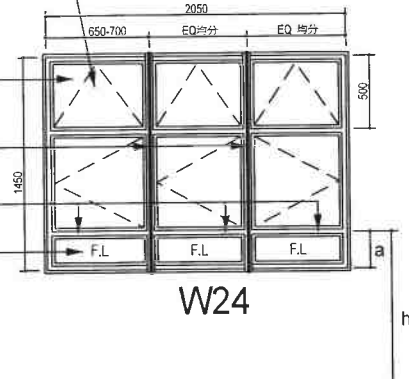

W24

正面圖 Elevation

$a \leq 300\text{mm}$
 $h = \text{高度不少於} 1100\text{mm}$
Minimum 1100mm height

備註:

- 所有標示的尺寸單位為毫米。
- 玻璃厚度最少為6毫米或指定規格及厚度。
- 鋁窗構件須按指定尺寸或不少於38毫米如沒有指定。
- 鋁窗安裝工程須遵守房屋署安裝鋁窗之標準排列格式圖則及技術規格指引。鋁窗排列格式可改動但必須遵守屋宇署之技術規格要求。

Notes:

- All dimensions are in millimeters.
- All glass panes shall be of minimum 6mm thick or otherwise stated.
- The dimensions of all window members shall be as specified or not less than 38mm if not specified.
- Aluminium window works shall comply with Housing Department's standard aluminium window configurations and technical guidelines. Modifications may be made to the standard window configurations but should comply with the Buildings Department's technical guidelines and requirements.

工程項目 PROJECT

安裝鋁窗之標準排列格式

Standard Aluminium Window Configuration

圖則標題 DRAWING TITLE

Y二型 (第一頁)

Trident II Block (Sheet 1 of 3)

圖則編號 DRG NO.

SCU / EMDI / P05 / 2020 / 14

比例 SCALE NTS

日期 DATE 3/2020

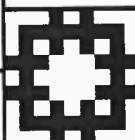

房屋署 屋邨辦事處
ESTATE OFFICE

HOUSING DEPARTMENT

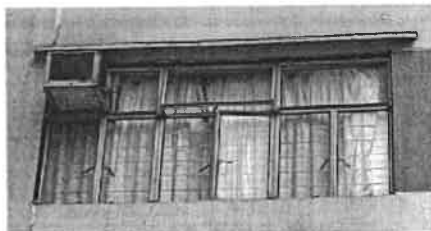

W26
原有正面的面貌 Original Elevation

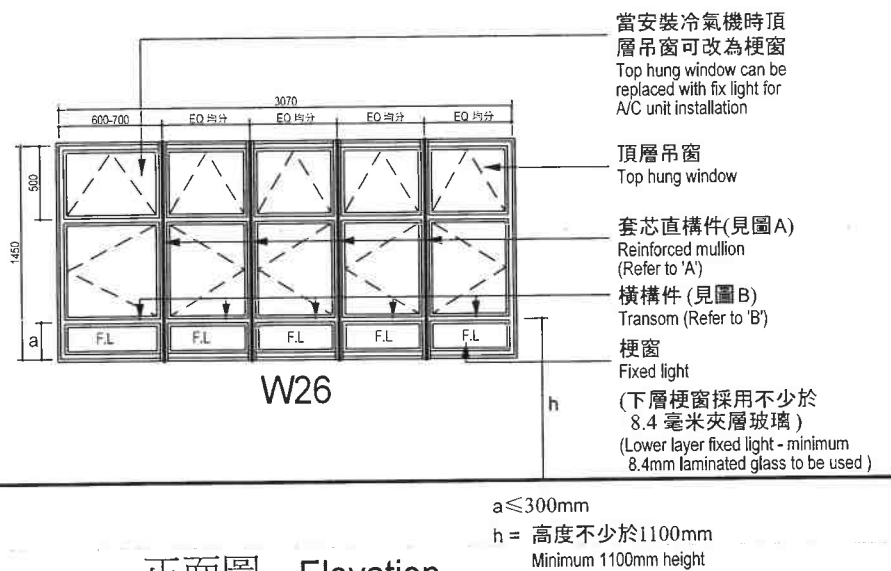
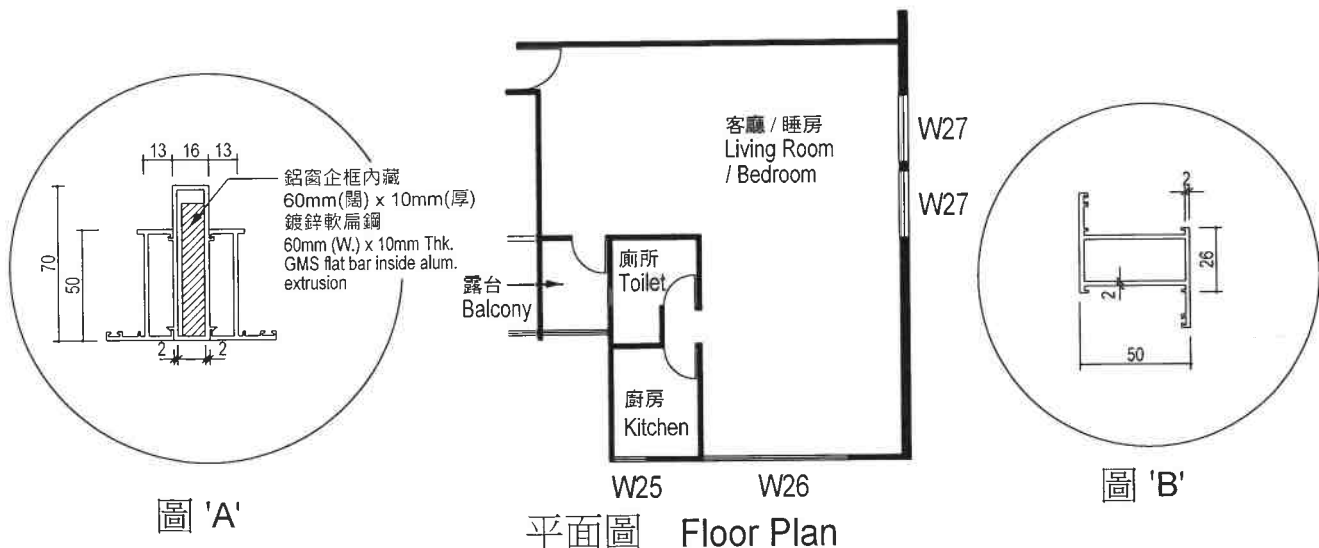

備註:

1. 所有標示的尺寸單位為毫米。
2. 玻璃厚度最少為6毫米或指定規格及厚度。
3. 鋁窗構件須按指定尺寸或不少於38毫米如沒有指定。
4. 鋁窗安裝工程須遵守房屋署安裝鋁窗之標準排列格式圖則及技術規格指引。鋁窗排列格式可改動但必須遵守屋宇署之技術規格要求。

Notes:

1. All dimensions are in millimeters.
2. All glass panes shall be of minimum 6mm thick or otherwise stated.
3. The dimensions of all window members shall be as specified or not less than 38mm if not specified.
4. Aluminium window works shall comply with Housing Department's standard aluminium window configurations and technical guidelines. Modifications may be made to the standard window configurations but should comply with the Buildings Department's technical guidelines and requirements.

工程項目 PROJECT

安裝鋁窗之標準排列格式

Standard Aluminium Window Configuration

圖則標題 DRAWING TITLE

Y二型 (第二頁)

Trident II Block (Sheet 2 of 3)

圖則編號 DRG NO.

SCU / EMDI / P05 / 2020 / 15

房屋署 屋邨辦事處
ESTATE OFFICE

HOUSING DEPARTMENT

比例 SCALE NTS

日期 DATE 3/2020



W27 W27
原有正面的面貌 Original Elevation



圖 'A'

鋁窗企框內藏
60mm(闊) x 10mm(厚)
鍍鋅軟扁鋼
60mm (W.) x 10mm Thk.
GMS flat bar inside alum.
extrusion



平面圖 Floor Plan

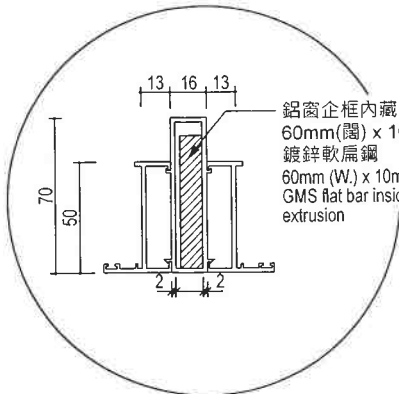

圖 'B'



現存造好樓面水平
Existing Finished
Floor Level (F.F.L.)

當安裝冷氣機時頂
層吊窗可改為梗窗
Top hung window can be
replaced with fix light for
A/C unit installation

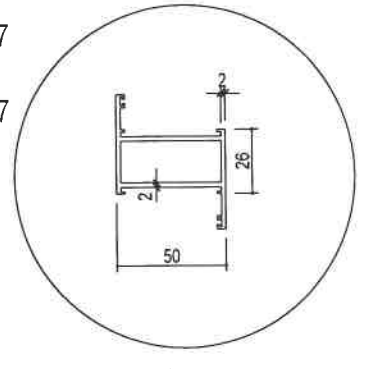
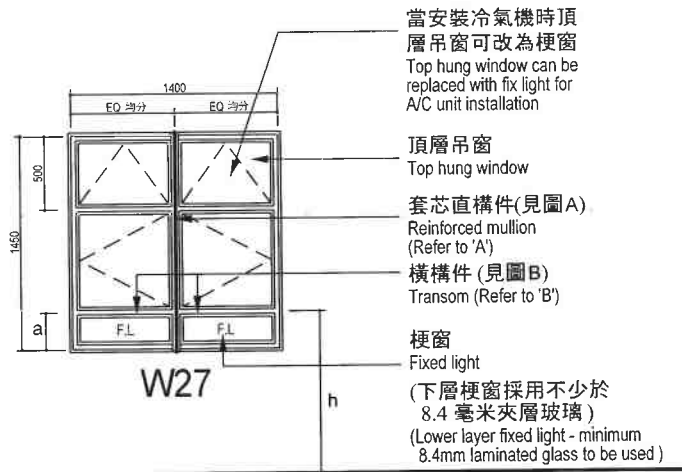
頂層吊窗
Top hung window

套芯直構件(見圖A)
Reinforced mullion
(Refer to 'A')

橫構件(見圖B)
Transom (Refer to 'B')

梗窗
Fixed light

(下層梗窗採用不少於
8.4 毫米夾層玻璃)
(Lower layer fixed light - minimum
8.4mm laminated glass to be used)

$a \leq 300\text{mm}$

$h =$ 高度不少於1100mm
Minimum 1100mm height

正面圖 Elevation

備註:

1. 所有標示的尺寸單位為毫米。
2. 玻璃厚度最少為6毫米或指定規格及厚度。
3. 鋁窗構件須按指定尺寸或不少於38毫米如沒有指定。
4. 鋁窗安裝工程須遵守房屋署安裝鋁窗之標準排列格式圖則及技術規格指引。鋁窗排列格式可改動但必須遵守屋宇署之技術規格要求。

Notes:

1. All dimensions are in millimeters.
2. All glass panes shall be of minimum 6mm thick or otherwise stated.
3. The dimensions of all window members shall be as specified or not less than 38mm if not specified.
4. Aluminium window works shall comply with Housing Department's standard aluminium window configurations and technical guidelines. Modifications may be made to the standard window configurations but should comply with the Buildings Department's technical guidelines and requirements.

工程項目 PROJECT

安裝鋁窗之標準排列格式

**Standard Aluminium Window
Configuration**

圖則標題 DRAWING TITLE

Y二型 (第三頁)

Trident II Block (Sheet 3 of 3)

圖則編號 DRG NO.

SCU / EMDI / P05 / 2020 / 16

比例 SCALE

NTS

H期 DATE

3/2020



房屋署 屋邨辦事處
ESTATE OFFICE

HOUSING DEPARTMENT



W28

原有正面的面貌 Original Elevation



平面圖 Floor Plan



圖 'A'



圖 'B'

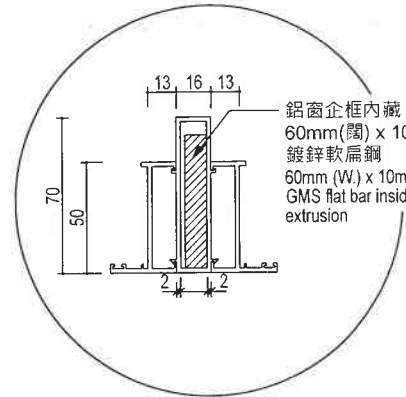

現存造好樓面水平
Existing Finished
Floor Level (F.F.L.)

正面圖 Elevation

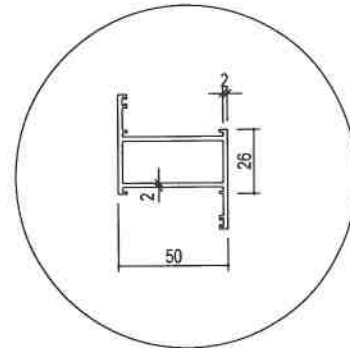
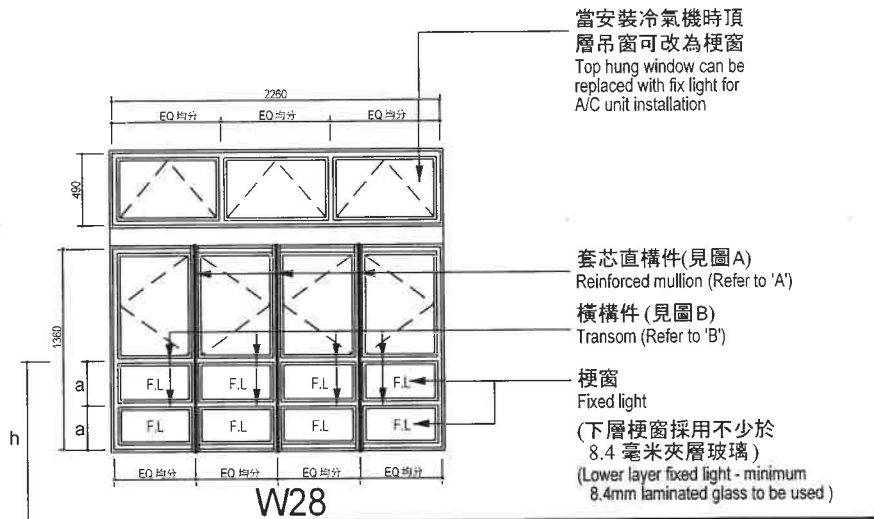
$a \leq 300\text{mm}$

$h =$ 高度不少於1100mm
Minimum 1100mm height

備註:

1. 所有標示的尺寸單位為毫米。
2. 玻璃厚度最少為6毫米或指定規格及厚度。
3. 鋁窗構件須按指定尺寸或不少於38毫米如沒有指定。
4. 鋁窗安裝工程須遵守房屋署安裝鋁窗之標準排列格式圖則及技術規格指引。鋁窗排列格式可改動但必須遵守屋宇署之技術規格要求。

Notes:

1. All dimensions are in millimeters.
2. All glass panes shall be of minimum 6mm thick or otherwise stated.
3. The dimensions of all window members shall be as specified or not less than 38mm if not specified.
4. Aluminium window works shall comply with Housing Department's standard aluminium window configurations and technical guidelines. Modifications may be made to the standard window configurations but should comply with the Buildings Department's technical guidelines and requirements.

工程項目 PROJECT

安裝鋁窗之標準排列格式

Standard Aluminium Window Configuration

圖則標題 DRAWING TITLE

Y三型 (第一頁)

Trident III Block (Sheet 1 of 4)

圖則編號 DRG NO.

SCU / EMDI / P05 / 2020 / 17

比例 SCALE NTS

日期 DATE 3/2020

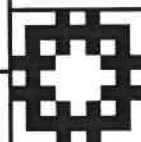

房屋署 屋邨辦事處
ESTATE OFFICE

HOUSING DEPARTMENT



W29

原有正面的面貌 Original Elevation



圖 'A'



平面圖 Floor Plan

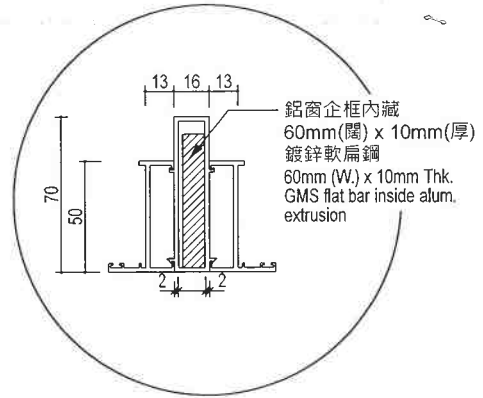

圖 'B'



正面圖 Elevation

當安裝冷氣機時頂層吊窗可改為梗窗
Top hung window can be replaced with fix light for A/C unit installation

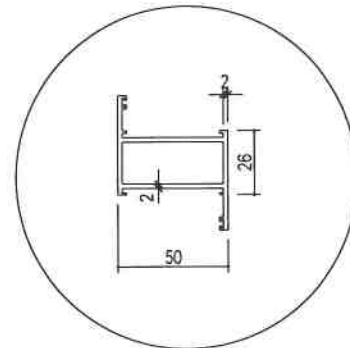
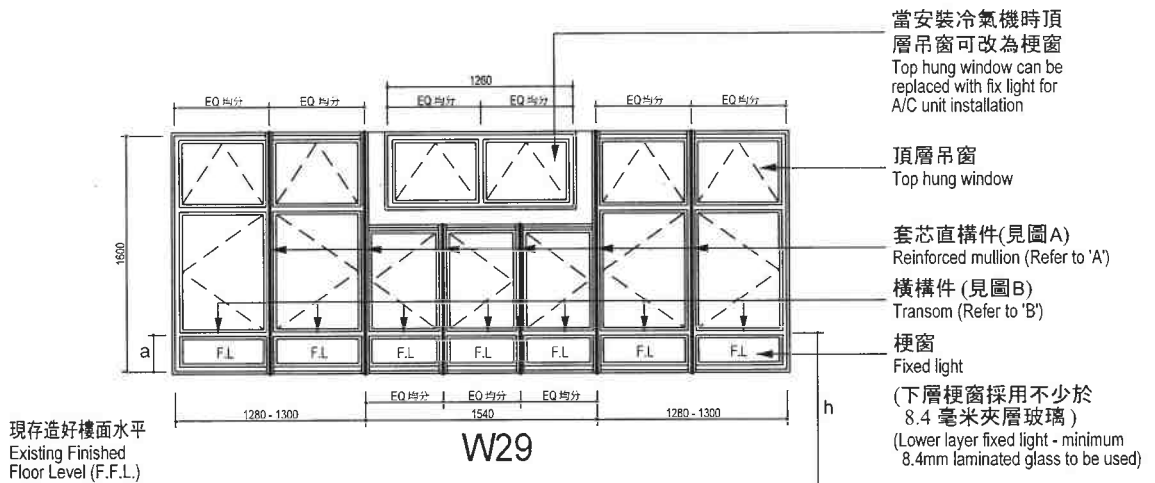
頂層吊窗
Top hung window

套芯直構件(見圖A)
Reinforced mullion (Refer to 'A')

橫構件(見圖B)
Transom (Refer to 'B')

梗窗
Fixed light
(下層梗窗採用不少於8.4毫米夾層玻璃)
(Lower layer fixed light - minimum 8.4mm laminated glass to be used)

$a \leq 300\text{mm}$
 $h =$ 高度不少於1100mm
Minimum 1100mm height

備註:

1. 所有標示的尺寸單位為毫米。
2. 玻璃厚度最少為6毫米或指定規格及厚度。
3. 鋁窗構件須按指定尺寸或不少於38毫米如沒有指定。
4. 鋁窗安裝工程須遵守房屋署安裝鋁窗之標準排列格式圖則及技術規格指引。鋁窗排列格式可改動但必須遵守屋宇署之技術規格要求。

Notes:

1. All dimensions are in millimeters.
2. All glass panes shall be of minimum 6mm thick or otherwise stated.
3. The dimensions of all window members shall be as specified or not less than 38mm if not specified.
4. Aluminium window works shall comply with Housing Department's standard aluminium window configurations and technical guidelines. Modifications may be made to the standard window configurations but should comply with the Buildings Department's technical guidelines and requirements.

工程項目 PROJECT

安裝鋁窗之標準排列格式

Standard Aluminium Window Configuration

圖則標題 DRAWING TITLE

Y三型(第二頁)

Trident III Block (Sheet 2 of 4)

圖則編號 DRG NO.

SCU / EMDI / P05 / 2020 / 18

比例 SCALE NTS

日期 DATE 3/2020

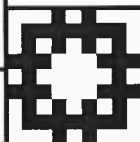

房屋署 屋邨辦事處
ESTATE OFFICE

HOUSING DEPARTMENT



W30

W31

原有正面的面貌

Original Elevation



圖 'A'



平面圖 Floor Plan

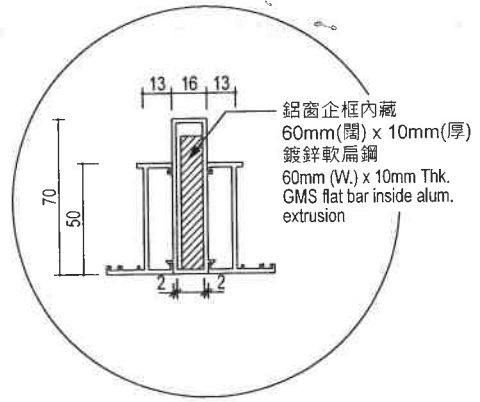

圖 'B'



正面圖 Elevation

$a \leq 300\text{mm}$

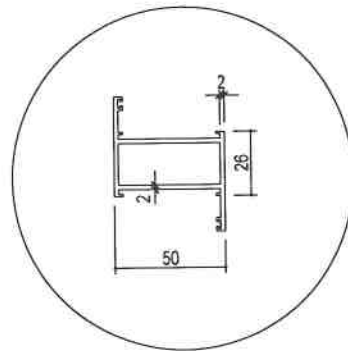
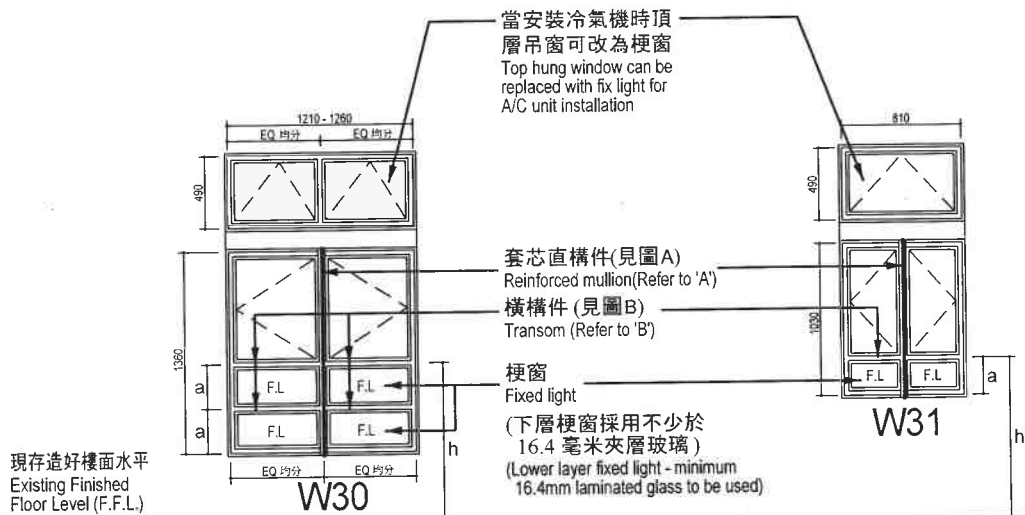
$h = \text{高度不少於} 1100\text{mm}$
Minimum 1100mm height

備註:

1. 所有標示的尺寸單位為毫米。
2. 玻璃厚度最少為6毫米或指定規格及厚度。
3. 鋁窗構件須按指定尺寸或不少於38毫米如沒有指定。
4. 鋁窗安裝工程須遵守房屋署安裝鋁窗之標準排列格式圖則及技術規格指引。鋁窗排列格式可改動但必須遵守屋宇署之技術規格要求。

Notes:

1. All dimensions are in millimeters.
2. All glass panes shall be of minimum 6mm thick or otherwise stated.
3. The dimensions of all window members shall be as specified or not less than 38mm if not specified.
4. Aluminium window works shall comply with Housing Department's standard aluminium window configurations and technical guidelines. Modifications may be made to the standard window configurations but should comply with the Buildings Department's technical guidelines and requirements.

工程項目 PROJECT

安裝鋁窗之標準排列格式

Standard Aluminium Window Configuration

圖則標題 DRAWING TITLE

Y三型 (第三頁)

Trident III Block (Sheet 3 of 4)

圖則編號 DRG NO.

SCU / EMDI / P05 / 2020 / 19

比例 SCALE

NTS

日期 DATE

3/2020

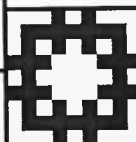

房屋署 屋邨辦事處
ESTATE OFFICE

HOUSING DEPARTMENT



W32 原有正面的面貌
W33 Original Elevation
W34

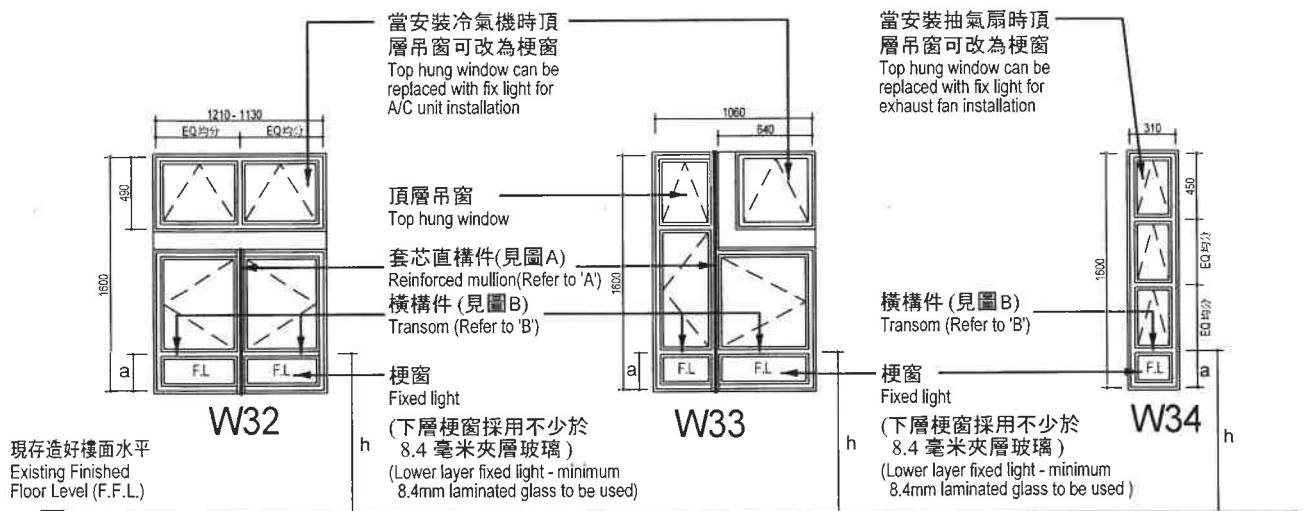
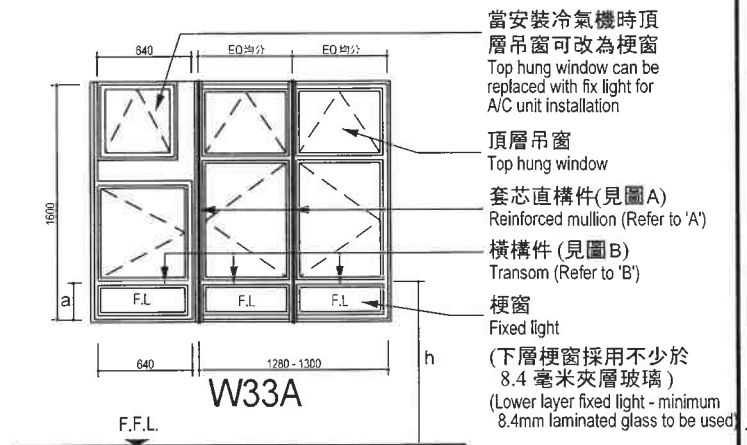
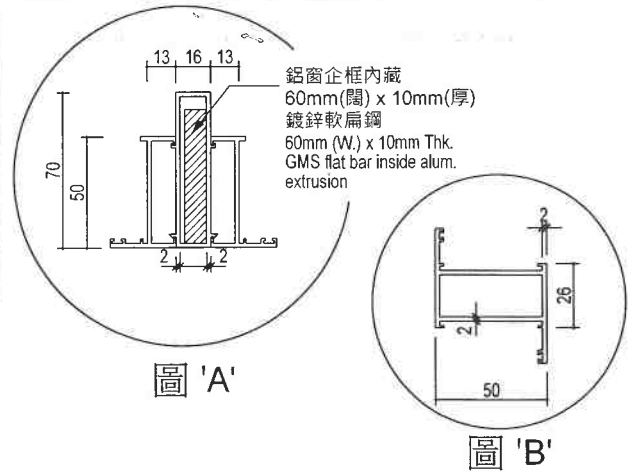

正面圖 Elevation

$a \leq 300\text{mm}$
 $h =$ 高度不少於1100mm
Minimum 1100mm height

備註:

- 所有標示的尺寸單位為毫米。
- 玻璃厚度最少為6毫米或指定規格及厚度。
- 鋁窗構件須按指定尺寸或不少於38毫米如沒有指定。
- 鋁窗安裝工程須遵守房屋署安裝鋁窗之標準排列格式圖則及技術規格指引。鋁窗排列格式可改動但必須遵守屋宇署之技術規格要求。

Notes:

- All dimensions are in millimeters.
- All glass panes shall be of minimum 6mm thick or otherwise stated.
- The dimensions of all window members shall be as specified or not less than 38mm if not specified.
- Aluminium window works shall comply with Housing Department's standard aluminium window configurations and technical guidelines. Modifications may be made to the standard window configurations but should comply with the Buildings Department's technical guidelines and requirements.

工程項目 PROJECT
安裝鋁窗之標準排列格式
Standard Aluminium Window Configuration

圖則標題 DRAWING TITLE
Y三型(第四頁)
Trident III Block (Sheet 4 of 4)

圖則編號 DRG NO.
SCU / EMDI / P05 / 2020 / 20

比例 SCALE NTS 日期 DATE 3/2020

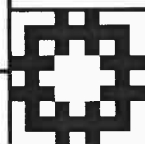

房屋署 屋邨辦事處
ESTATE OFFICE
HOUSING DEPARTMENT



W35

原有正面的面貌 Original Elevation



圖 'A'



平面圖 Floor Plan

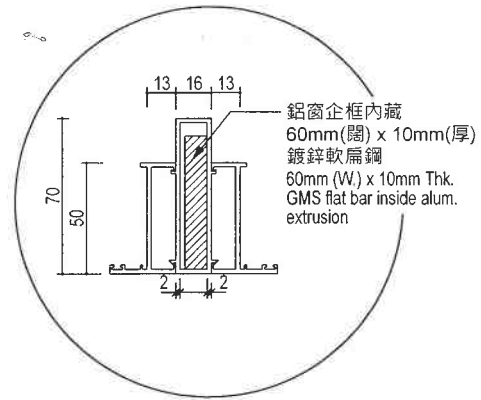
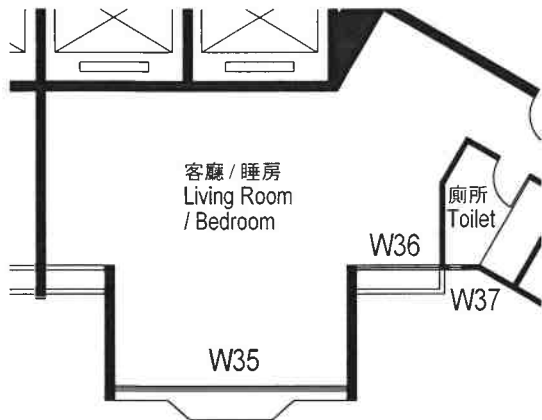

圖 'B'



正面圖 Elevation

備註:

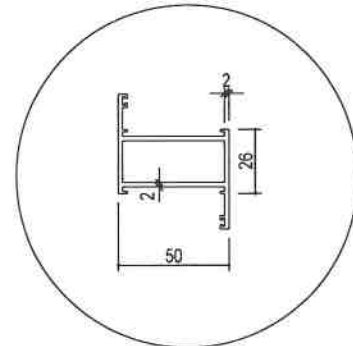
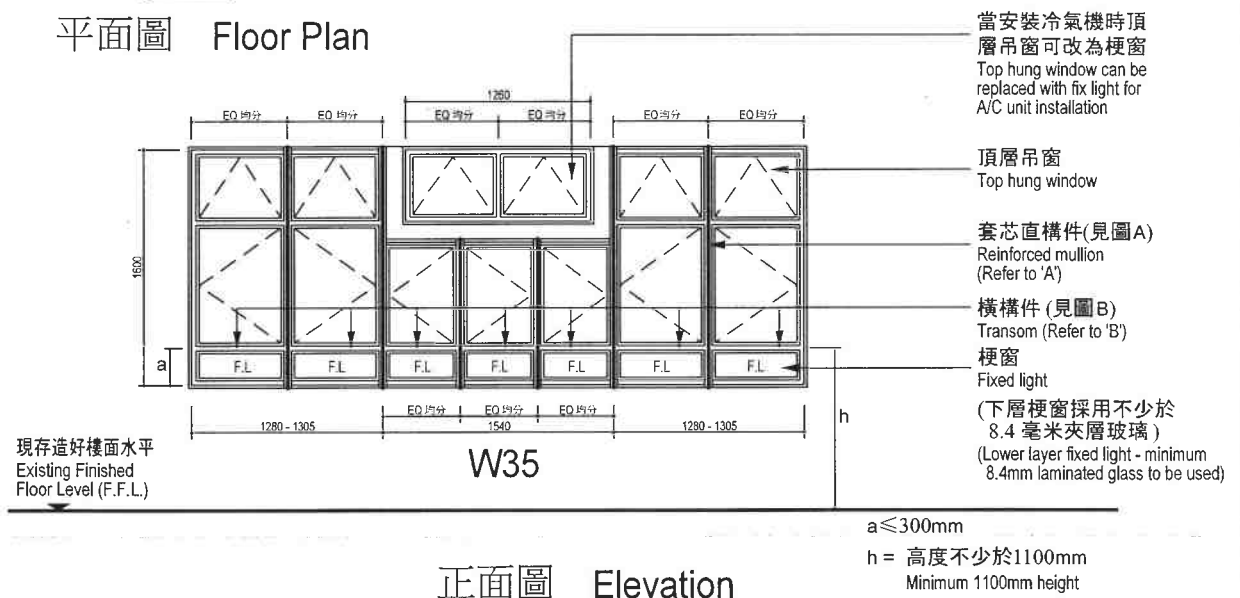
1. 所有標示的尺寸單位為毫米。
2. 玻璃厚度最少為6毫米或指定規格及厚度。
3. 鋁窗構件須按指定尺寸或不少於38毫米如沒有指定。
4. 鋁窗安裝工程須遵守房屋署安裝鋁窗之標準排列格式圖則及技術規格指引。鋁窗排列格式可改動但必須遵守屋宇署之技術規格要求。

Notes:

1. All dimensions are in millimeters.
2. All glass panes shall be of minimum 6mm thick or otherwise stated.
3. The dimensions of all window members shall be as specified or not less than 38mm if not specified.
4. Aluminium window works shall comply with Housing Department's standard aluminium window configurations and technical guidelines. Modifications may be made to the standard window configurations but should comply with the Buildings Department's technical guidelines and requirements.

工程項目 PROJECT

安裝鋁窗之標準排列格式

Standard Aluminium Window Configuration

圖則標題 DRAWING TITLE

Y四型 (第一頁)

Trident IV Block (Sheet 1 of 3)

圖則編號 DRG NO.

SCU / EMDI / P05 / 2020 / 21

比例 SCALE NTS

日期 DATE 3/2020

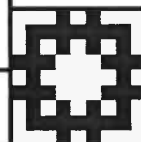

房屋署 屋邨辦事處
ESTATE OFFICE

HOUSING DEPARTMENT



W36 W37

原有正面的面貌 Original Elevation



圖 'A'



平面圖 Floor Plan

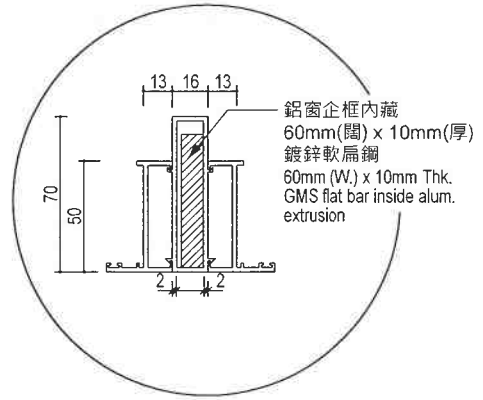
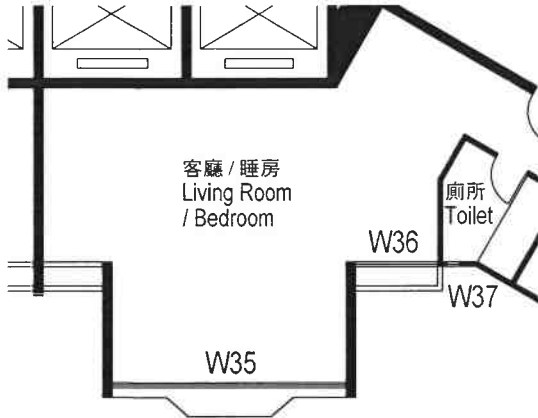

圖 'B'



正面圖 Elevation

$a \leq 300\text{mm}$
 $h =$ 高度不少於1100mm
Minimum 1100mm height

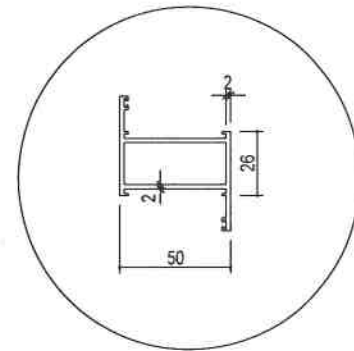
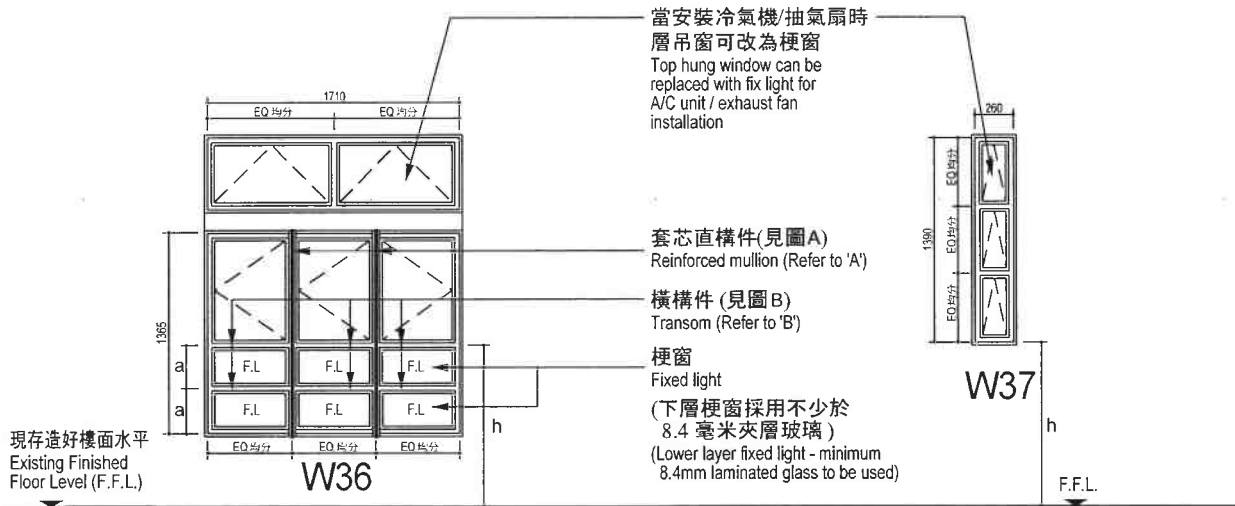
備註:

1. 所有標示的尺寸單位為毫米。
2. 玻璃厚度最少為6毫米或指定規格及厚度。
3. 鋁窗構件須按指定尺寸或不少於38毫米如沒有指定。
4. 鋁窗安裝工程須遵守房屋署安裝鋁窗之標準排列格式圖則及技術規格指引。鋁窗排列格式可改動但必須遵守屋宇署之技術規格要求。

Notes:

1. All dimensions are in millimeters.
2. All glass panes shall be of minimum 6mm thick or otherwise stated.
3. The dimensions of all window members shall be as specified or not less than 38mm if not specified.
4. Aluminium window works shall comply with Housing Department's standard aluminium window configurations and technical guidelines. Modifications may be made to the standard window configurations but should comply with the Buildings Department's technical guidelines and requirements.

工程項目 PROJECT

安裝鋁窗之標準排列格式

**Standard Aluminium Window
Configuration**

圖則標題 DRAWING TITLE

Y四型 (第二頁)

Trident IV Block (Sheet 2 of 3)

圖則編號 DRG. NO.

SCU / EMDI / P05 / 2020 / 22

比例 SCALE

NTS

日期 DATE

3/2020

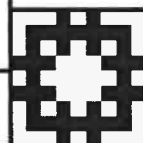

房屋署 屋邨辦事處
ESTATE OFFICE

HOUSING DEPARTMENT

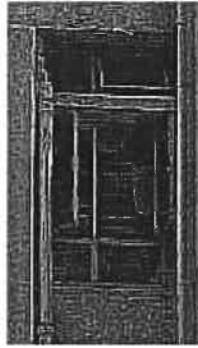

W38 W39
原有正面的面貌 Original Elevation



圖 'A'



平面圖 Floor Plan

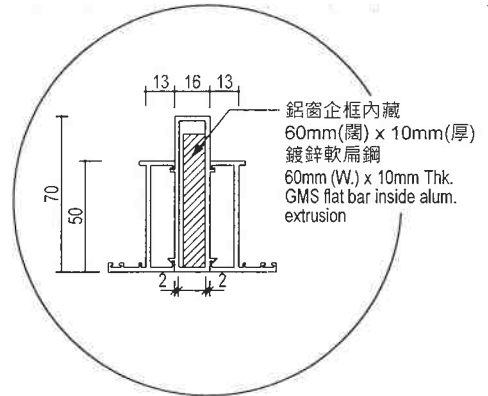
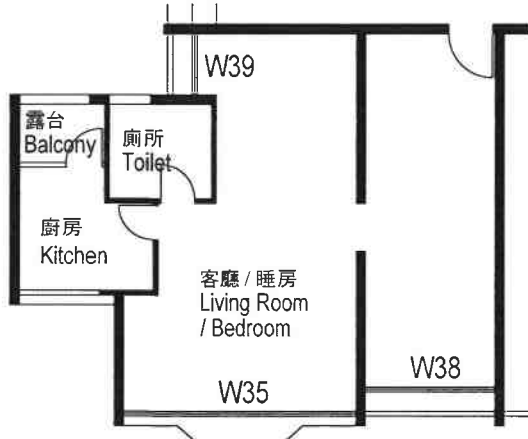

圖 'B'



正面圖 Elevation

$a \leq 300\text{mm}$
 $h = \text{高度不少於} 1100\text{mm}$
Minimum 1100mm height

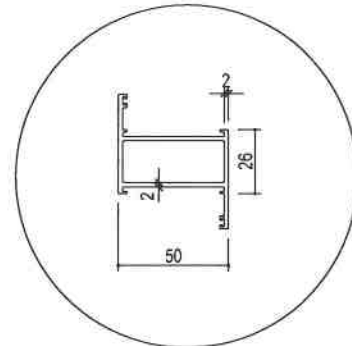
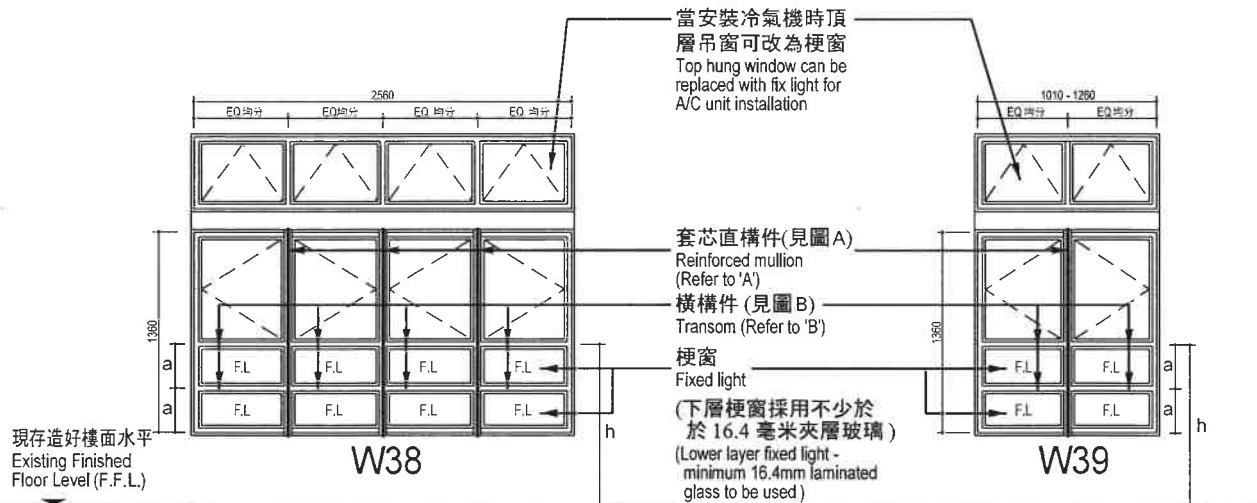
備註:

1. 所有標示的尺寸單位為毫米。
2. 玻璃厚度最少為6毫米或指定規格及厚度。
3. 鋁窗構件須按指定尺寸或不少於38毫米如沒有指定。
4. 鋁窗安裝工程須遵守房屋署安裝鋁窗之標準排列格式圖則及技術規格指引。鋁窗排列格式可改動但必須遵守屋宇署之技術規格要求。

Notes:

1. All dimensions are in millimeters.
2. All glass panes shall be of minimum 6mm thick or otherwise stated.
3. The dimensions of all window members shall be as specified or not less than 38mm if not specified.
4. Aluminium window works shall comply with Housing Department's standard aluminium window configurations and technical guidelines. Modifications may be made to the standard window configurations but should comply with the Buildings Department's technical guidelines and requirements.

工程項目 PROJECT
安裝鋁窗之標準排列格式
Standard Aluminium Window Configuration

圖則標題 DRAWING TITLE
Y四型 (第三頁)
Trident IV Block (Sheet 3 of 3)

圖則編號 DRG NO.
SCU / EMDI / P05 / 2020 / 23

房屋署 屋邨辦事處
ESTATE OFFICE

HOUSING DEPARTMENT

比例 SCALE NTS 日期 DATE 3/2020



W40 W41
原有正面的面貌 Original Elevation



圖 'A'



平面圖 Floor Plan

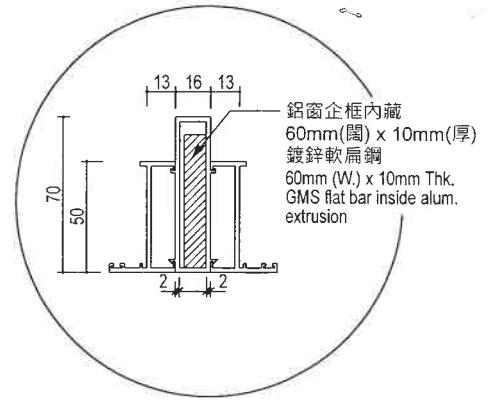
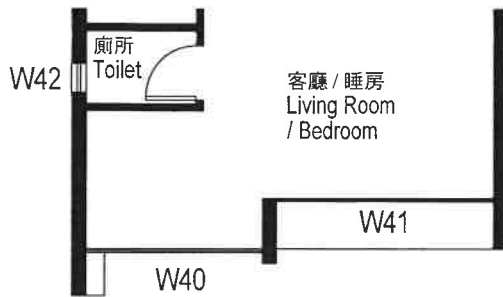

圖 'B'



正面圖 Elevation

備註:

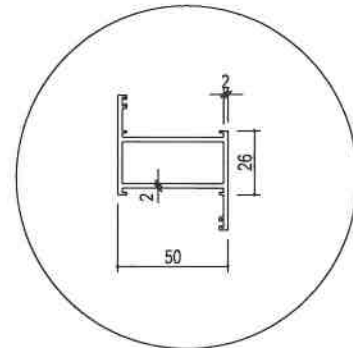
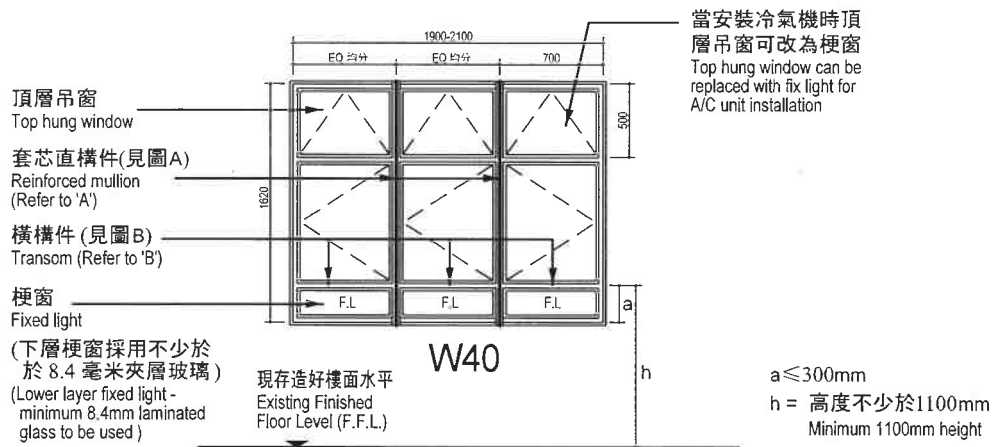
1. 所有標示的尺寸單位為毫米。
2. 玻璃厚度最少為6毫米或指定規格及厚度。
3. 鋁窗構件須按指定尺寸或不少於38毫米如沒有指定。
4. 鋁窗安裝工程須遵守房屋署安裝鋁窗之標準排列格式圖則及技術規格指引。鋁窗排列格式可改動但必須遵守屋宇署之技術規格要求。

Notes:

1. All dimensions are in millimeters.
2. All glass panes shall be of minimum 6mm thick or otherwise stated.
3. The dimensions of all window members shall be as specified or not less than 38mm if not specified.
4. Aluminium window works shall comply with Housing Department's standard aluminium window configurations and technical guidelines. Modifications may be made to the standard window configurations but should comply with the Buildings Department's technical guidelines and requirements.

工程項目 PROJECT
安裝鋁窗之標準排列格式

Standard Aluminium Window Configuration

圖則標題 DRAWING TITLE

和諧一, 二, 三型 (第一頁)
Harmony Block 1, 2, 3 (Sheet 1 of 4)

圖則編號 DRG NO.

SCU / EMDI / P05 / 2020 / 24

房屋署 屋邨辦事處
ESTATE OFFICE

HOUSING DEPARTMENT

比例 SCALE NTS

日期 DATE 3/2020



W40 W41
原有正面的面貌 Original Elevation



圖 'A'



平面圖 Floor Plan

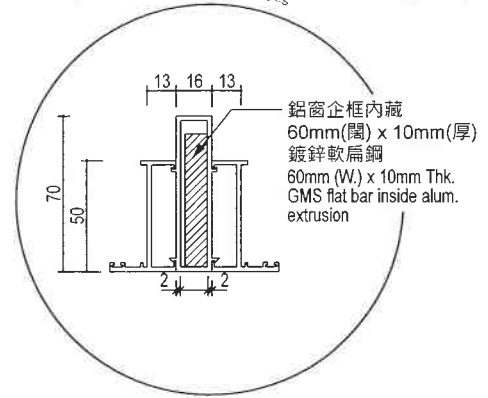
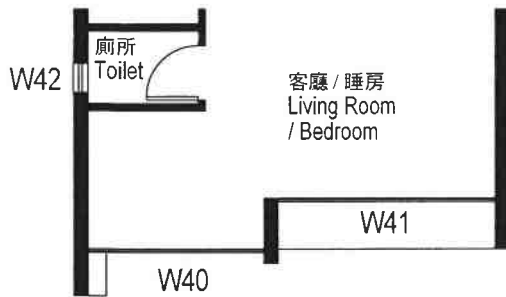

圖 'B'

當安裝冷氣機時頂層吊窗可改為梗窗
Top hung window can be replaced with fix light for A/C unit installation

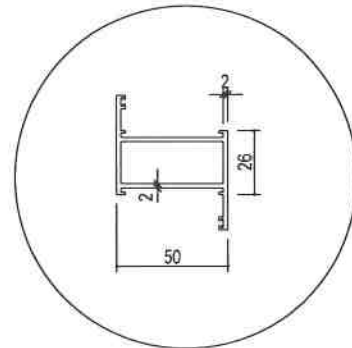
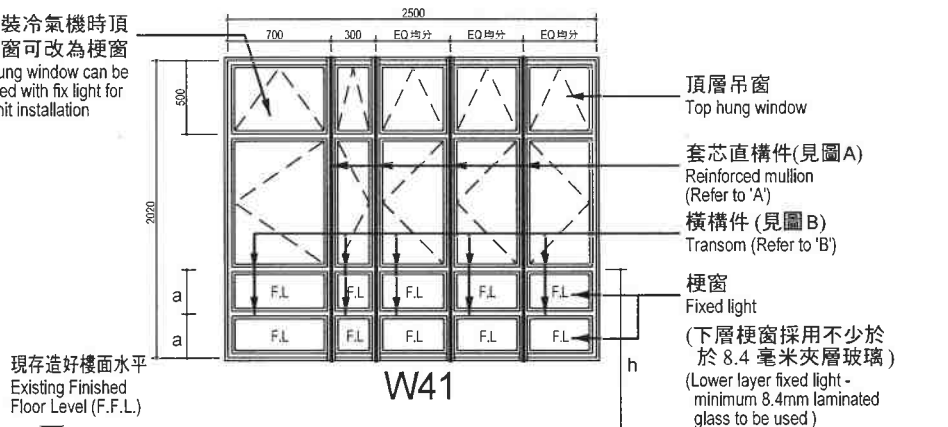

現存造好樓面水平
Existing Finished Floor Level (F.F.L.)

W41

正面圖 Elevation

$a \leq 300\text{mm}$
 $h = \text{高度不少於}1100\text{mm}$
Minimum 1100mm height

備註:

1. 所有標示的尺寸單位為毫米。
2. 玻璃厚度最少為6毫米或指定規格及厚度。
3. 鋁窗構件須按指定尺寸或不少於38毫米如沒有指定。
4. 鋁窗安裝工程須遵守房屋署安裝鋁窗之標準排列格式圖則及技術規格指引。鋁窗排列格式可改動但必須遵守屋宇署之技術規格要求。

Notes:

1. All dimensions are in millimeters.
2. All glass panes shall be of minimum 6mm thick or otherwise stated.
3. The dimensions of all window members shall be as specified or not less than 38mm if not specified.
4. Aluminium window works shall comply with Housing Department's standard aluminium window configurations and technical guidelines. Modifications may be made to the standard window configurations but should comply with the Buildings Department's technical guidelines and requirements.

工程項目 PROJECT

安裝鋁窗之標準排列格式

Standard Aluminium Window Configuration

圖則標題 DRAWING TITLE

和諧一, 二, 三型 (第二頁)

Harmony Block 1, 2, 3 (Sheet 2 of 4)

圖則編號 DRG. NO.

SCU / EMDI / P05 / 2020 / 25

比例 SCALE

NTS

日期 DATE

3/2020

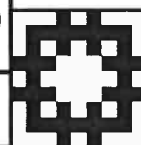

房屋署 屋邨辦事處
ESTATE OFFICE

HOUSING DEPARTMENT



W42

W43

原有正面的面貌 Original Elevation



圖 'A'



平面圖 Floor Plan

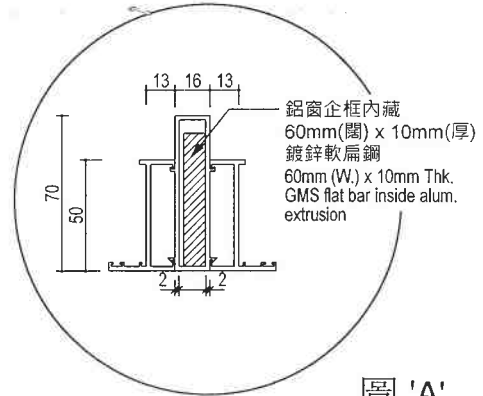

圖 'B'



正面圖 Elevation

備註:

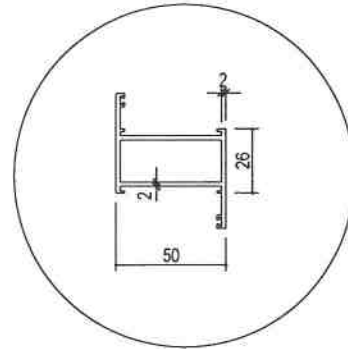
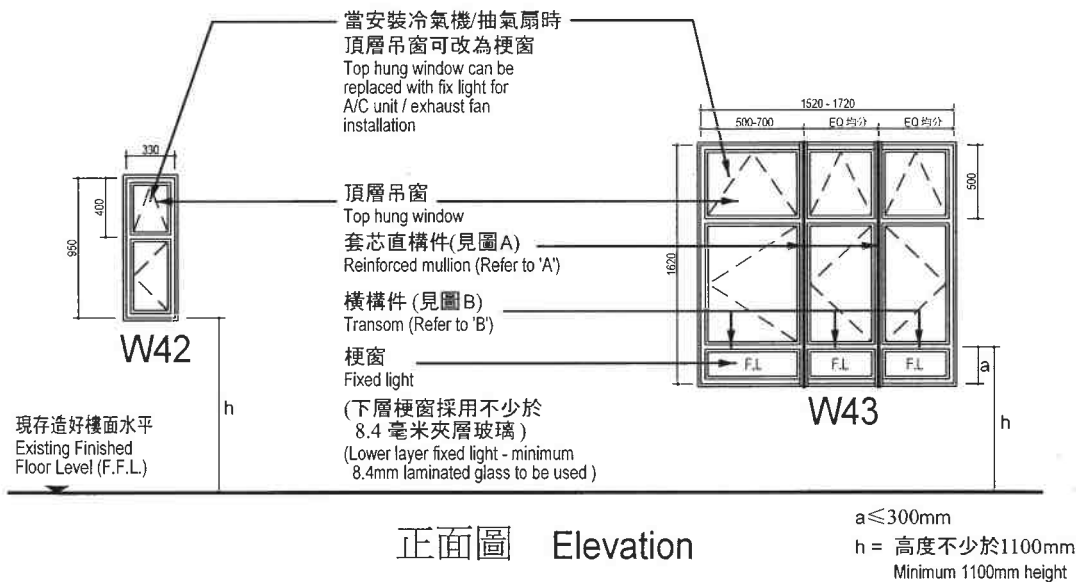
1. 所有標示的尺寸單位為毫米。
2. 玻璃厚度最少為6毫米或指定規格及厚度。
3. 鋁窗構件須按指定尺寸或不少於38毫米如沒有指定。
4. 鋁窗安裝工程須遵守房屋署安裝鋁窗之標準排列格式圖則及技術規格指引。鋁窗排列格式可改動但必須遵守屋宇署之技術規格要求。

Notes:

1. All dimensions are in millimeters.
2. All glass panes shall be of minimum 6mm thick or otherwise stated.
3. The dimensions of all window members shall be as specified or not less than 38mm if not specified.
4. Aluminium window works shall comply with Housing Department's standard aluminium window configurations and technical guidelines. Modifications may be made to the standard window configurations but should comply with the Buildings Department's technical guidelines and requirements.

工程項目 PROJECT

安裝鋁窗之標準排列格式

Standard Aluminium Window Configuration

圖則標題 DRAWING TITLE

和諧一, 二, 三型 (第三頁)

Harmony Block 1, 2, 3 (Sheet 3 of 4)

圖則編號 DRG. NO.

SCU / EMDI / P05 / 2020 / 26

比例 SCALE NTS

日期 DATE 3/2020

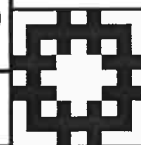

房屋署 屋邨辦事處
ESTATE OFFICE

HOUSING DEPARTMENT



W44



W45



W46

原有正面的面貌 Original Elevation



圖 'A'



平面圖 Floor Plan

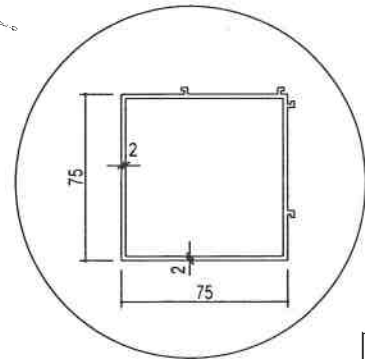
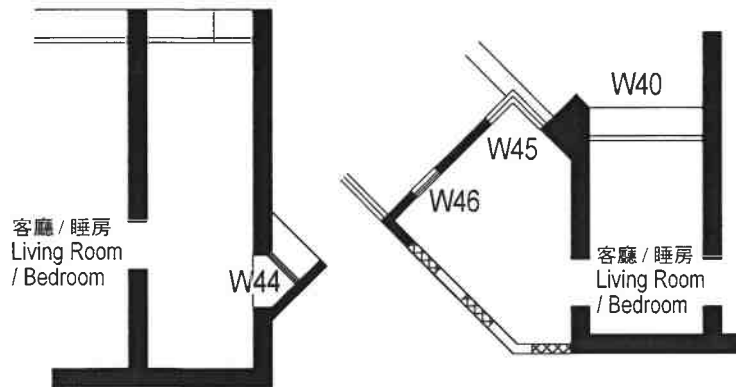
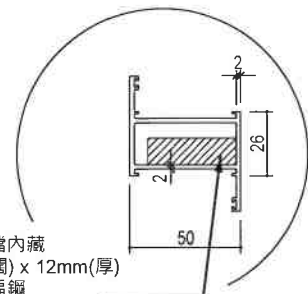

鋁窗橫檔內藏
40mm(闊) x 12mm(厚)
鍍鋅軟扁鋼
40mm (W.) x 12mm Thk. GMS
flat bar inside alum. extrusion

圖 'C'

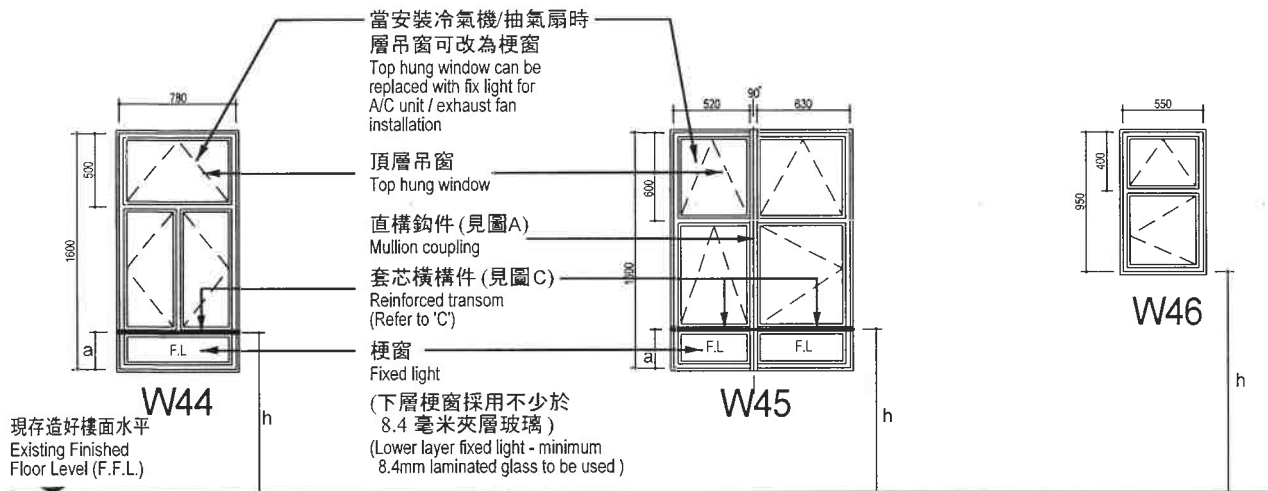

正面圖 Elevation

a ≤ 300mm
h = 高度不少於1100mm
Minimum 1100mm height

備註:

1. 所有標示的尺寸單位為毫米。
2. 玻璃厚度最少為6毫米或指定規格及厚度。
3. 鋁窗構件須按指定尺寸或不少於38毫米如沒有指定。
4. 鋁窗安裝工程須遵守房屋署安裝鋁窗之標準排列格式圖則及技術規格指引。鋁窗排列格式可改動但必須遵守屋宇署之技術規格要求。

Notes:

1. All dimensions are in millimeters.
2. All glass panes shall be of minimum 6mm thick or otherwise stated.
3. The dimensions of all window members shall be as specified or not less than 38mm if not specified.
4. Aluminium window works shall comply with Housing Department's standard aluminium window configurations and technical guidelines. Modifications may be made to the standard window configurations but should comply with the Buildings Department's technical guidelines and requirements.

<p>工程項目 PROJECT 安裝鋁窗之標準排列格式 Standard Aluminium Window Configuration</p>	<p>圖則標題 DRAWING TITLE 和諧一, 二, 三型 (第四頁) Harmony Block 1, 2, 3 (Sheet 4 of 4)</p>	<p>圖則編號 DRG NO. SCU / EMDI / P05 / 2020 / 27</p> <p>房屋署 屋邨辦事處 ESTATE OFFICE HOUSING DEPARTMENT</p>
<p>比例 SCALE NTS</p>	<p>日期 DATE 3/2020</p>	



W47

W48

W49

原有正面的面貌

Original Elevation

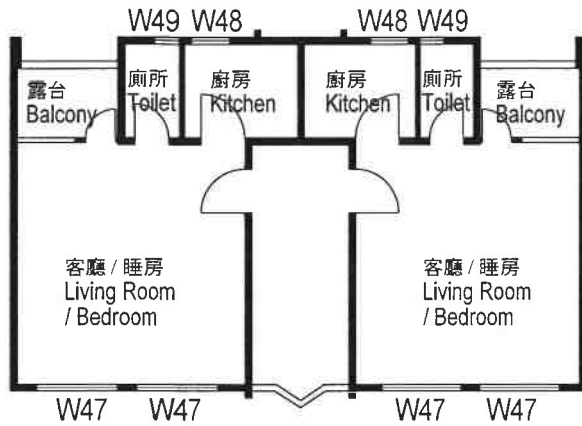

平面圖 Floor Plan



圖 'A'

鋁窗企框內藏
60mm(闊) x 10mm(厚)
鍍鋅軟扁鋼
60mm (W.V.) x 10mm Thk.
GMS flat bar inside alum.
extrusion



圖 'B'

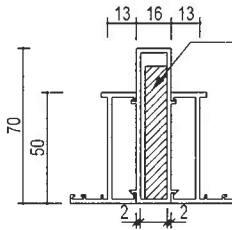

W47

現存造好樓面水平
Existing Finished
Floor Level (F.F.L.)

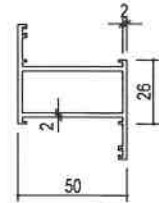
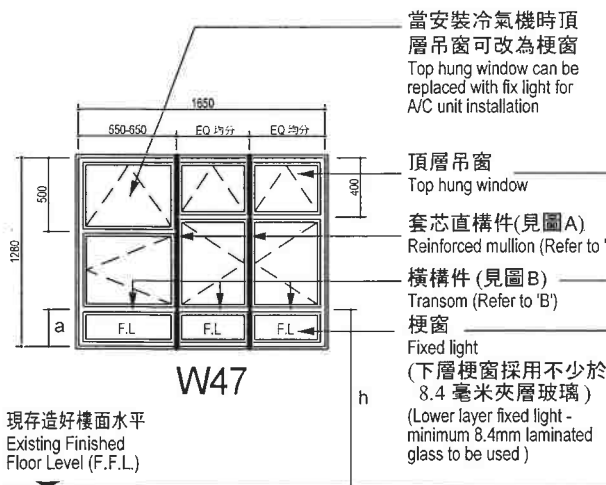
當安裝冷氣機時頂層吊窗可改為梗窗
Top hung window can be replaced with fix light for A/C unit installation

頂層吊窗
Top hung window
套芯直構件(見圖A)
Reinforced mullion (Refer to 'A')
橫構件(見圖B)
Transom (Refer to 'B')
梗窗
Fixed light
(下層梗窗採用不少於
8.4 毫米夾層玻璃)
(Lower layer fixed light -
minimum 8.4mm laminated
glass to be used)

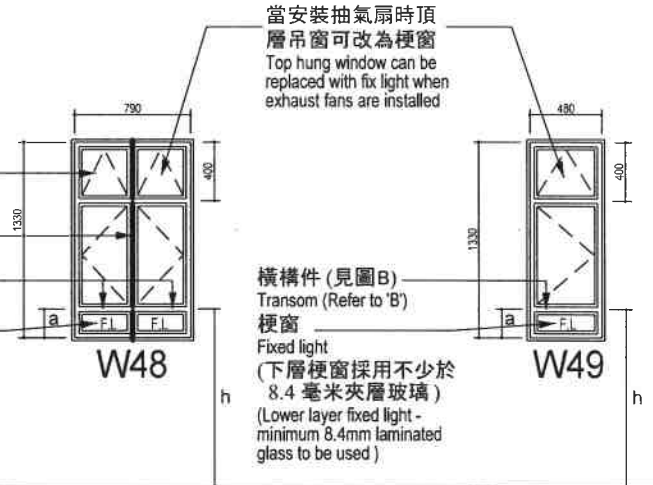

W48

W49

當安裝抽氣扇時頂層吊窗可改為梗窗
Top hung window can be replaced with fix light when exhaust fans are installed

橫構件(見圖B)
Transom (Refer to 'B')
梗窗
Fixed light
(下層梗窗採用不少於
8.4 毫米夾層玻璃)
(Lower layer fixed light -
minimum 8.4mm laminated
glass to be used)

正面圖 Elevation

$a \leq 300\text{mm}$

$h =$ 高度不少於1100mm
Minimum 1100mm height

備註:

1. 所有標示的尺寸單位為毫米。
2. 玻璃厚度最少為6毫米或指定規格及厚度。
3. 鋁窗構件須按指定尺寸或不少於38毫米如沒有指定。
4. 鋁窗安裝工程須遵守房屋署安裝鋁窗之標準排列格式圖則及技術規格指引。鋁窗排列格式可改動但必須遵守屋宇署之技術規格要求。

Notes:

1. All dimensions are in millimeters.
2. All glass panes shall be of minimum 6mm thick or otherwise stated.
3. The dimensions of all window members shall be as specified or not less than 38mm if not specified.
4. Aluminium window works shall comply with Housing Department's standard aluminium window configurations and technical guidelines. Modifications may be made to the standard window configurations but should comply with the Buildings Department's technical guidelines and requirements.

工程項目 PROJECT

安裝鋁窗之標準排列格式

Standard Aluminium Window Configuration

圖則標題 DRAWING TITLE

鄉村型 - 相連長型

Rural Housing - Linear Profile Block

圖則編號 DRG NO.

SCU / EMDI / P05 / 2020 / 28

比例 SCALE

NTS

日期 DATE

3/2020

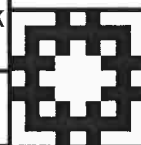

房屋署 屋邨辦事處
ESTATE OFFICE

HOUSING DEPARTMENT



W50



W51



圖 'A'

原有正面的面貌 Original Elevation

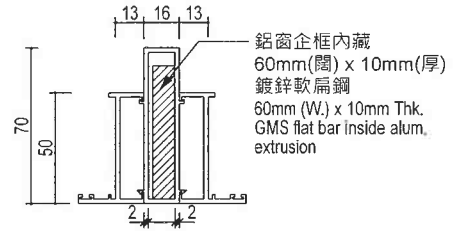

圖 'B'

平面圖 Floor Plan

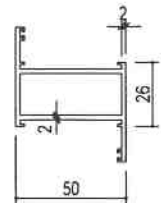
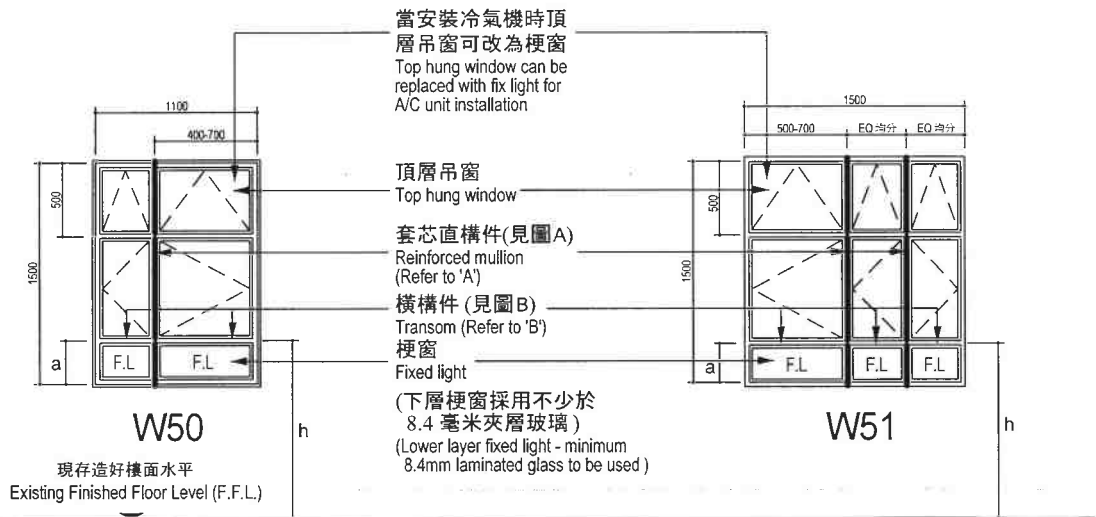

正面圖 Elevation

$a \leq 300\text{mm}$
 $h = \text{高度不少於}1100\text{mm}$
 Minimum 1100mm height

備註:

1. 所有標示的尺寸單位為毫米。
2. 玻璃厚度最少為6毫米或指定規格及厚度。
3. 鋁窗構件須按指定尺寸或不少於38毫米如沒有指定。
4. 鋁窗安裝工程須遵守房屋署安裝鋁窗之標準排列格式圖則及技術規格指引。鋁窗排列格式可改動但必須遵守屋宇署之技術規格要求。

Notes:

1. All dimensions are in millimeters.
2. All glass panes shall be of minimum 6mm thick or otherwise stated.
3. The dimensions of all window members shall be as specified or not less than 38mm if not specified.
4. Aluminium window works shall comply with Housing Department's standard aluminium window configurations and technical guidelines. Modifications may be made to the standard window configurations but should comply with the Buildings Department's technical guidelines and requirements.

工程項目 PROJECT 安裝鋁窗之標準排列格式 Standard Aluminium Window Configuration	圖則標題 DRAWING TITLE 鄉村型 - 蝴蝶型 (第一頁) Rural Housing - Butterfly Profile Block (Sheet 1 of 2) 比例 SCALE NTS 日期 DATE 3/2020	圖則編號 DRG. NO. SCU / EMDI / P05 / 2020 / 29  房屋署 屋邨辦事處 ESTATE OFFICE HOUSING DEPARTMENT
---	--	--



W52 W53

原有正面的面貌 Original Elevation



平面圖 Floor Plan

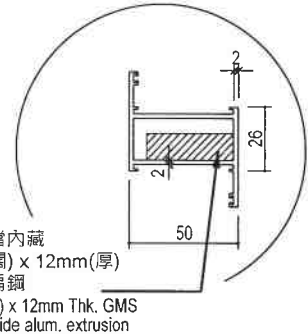

鋁窗橫樑內藏
40mm(闊) x 12mm(厚)
鍍鋅軟扁鋼
40mm (VV.) x 12mm Thk. GMS
flat bar inside alum. extrusion

圖 'C'

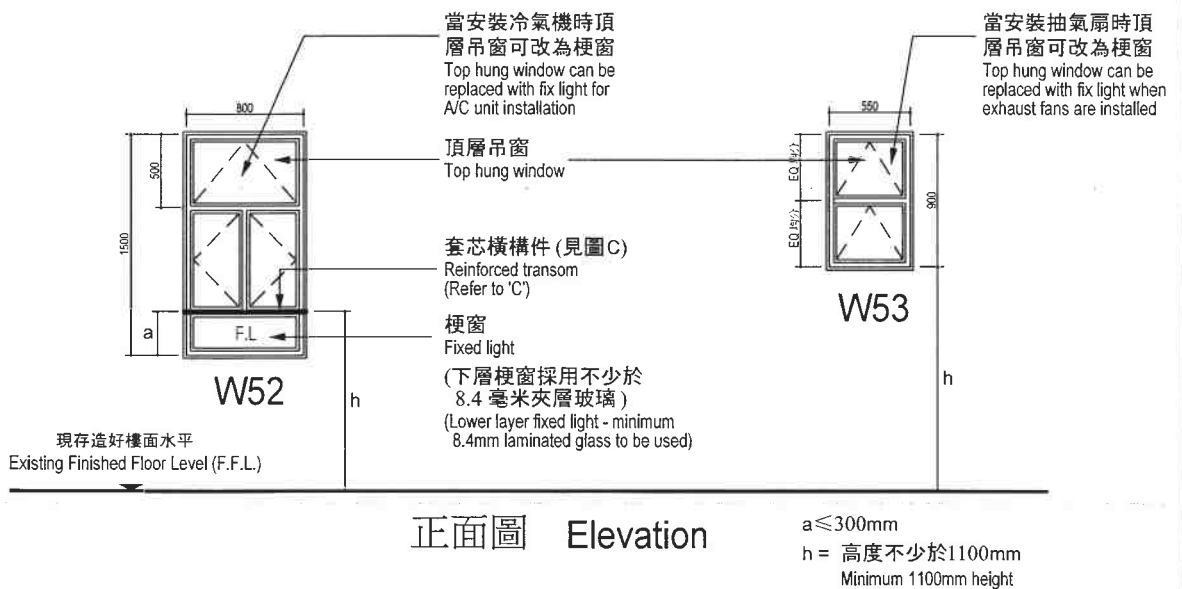

正面圖 Elevation

備註:

1. 所有標示的尺寸單位為毫米。
2. 玻璃厚度最少為6毫米或指定規格及厚度。
3. 鋁窗構件須按指定尺寸或不少於38毫米如沒有指定。
4. 鋁窗安裝工程須遵守房屋署安裝鋁窗之標準排列格式圖則及技術規格指引。鋁窗排列格式可改動但必須遵守屋宇署之技術規格要求。

Notes:

1. All dimensions are in millimeters.
2. All glass panes shall be of minimum 6mm thick or otherwise stated.
3. The dimensions of all window members shall be as specified or not less than 38mm if not specified.
4. Aluminium window works shall comply with Housing Department's standard aluminium window configurations and technical guidelines. Modifications may be made to the standard window configurations but should comply with the Buildings Department's technical guidelines and requirements.

工程項目 PROJECT

安裝鋁窗之標準排列格式

Standard Aluminium Window Configuration

圖則標題 DRAWING TITLE

鄉村型 - 蝴蝶型 (第二頁)

Rural Housing - Butterfly Profile Block
(Sheet 2 of 2)

比例 SCALE

NTS

日期 DATE

3/2020

圖則編號 DRG. NO.

SCU / EMDI / P05 / 2020 / 30

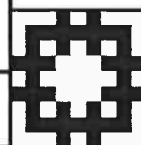

房屋署 屋邨辦事處
ESTATE OFFICE

HOUSING DEPARTMENT



W54



W55



W56

原有正面的面貌 Original Elevation

鋁窗橫擋內藏
40mm(闊) x 12mm(厚)
鍍鋅軟扁鋼
40mm (W.) x 12mm Thk. GMS
flat bar inside alum. extrusion



圖 'C'



鋁窗企框內藏
60mm(闊) x 10mm(厚)
鍍鋅軟扁鋼
60mm (W.) x 10mm Thk.
GMS flat bar inside alum.
extrusion

圖 'A'

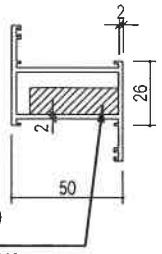
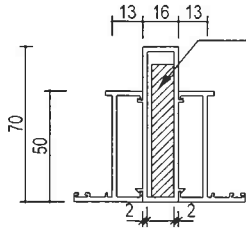

圖 'B'



平面圖 Floor Plan

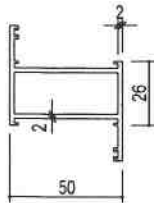
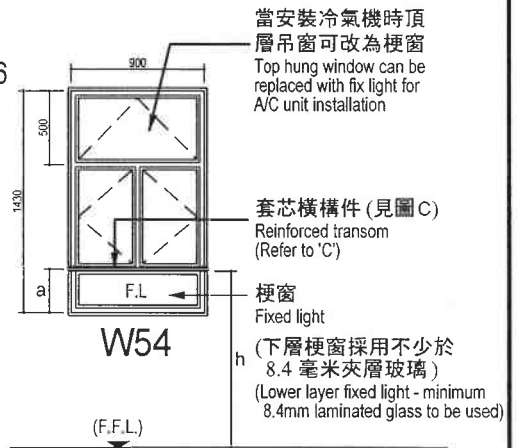

當安裝冷氣機時頂層吊窗可改為梗窗
Top hung window can be replaced with fix light for A/C unit installation

牆身加高100毫米石屎以更換鋼窗。
Parapet wall to be raised by 100mm concrete for replacement of steel window.

現存造好樓面水平
Existing Finished Floor Level (F.F.L.)

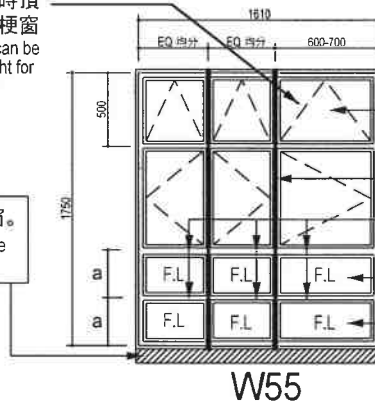

當安裝抽氣扇時頂層吊窗可改為梗窗
Top hung window can be replaced with fix light when exhaust fans are installed

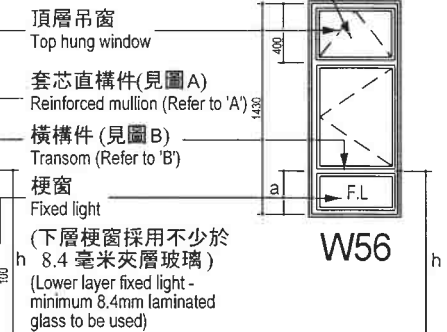

正面圖 Elevation

$a \leq 300\text{mm}$
 $h = \text{高度不少於} 1100\text{mm}$
Minimum 1100mm height

備註:

1. 所有標示的尺寸單位為毫米。
2. 玻璃厚度最少為6毫米或指定規格及厚度。
3. 鋁窗構件須按指定尺寸或不少於38毫米如沒有指定。
4. 鋁窗安裝工程須遵守房屋署安裝鋁窗之標準排列格式圖則及技術規格指引。鋁窗排列格式可改動但必須遵守屋宇署之技術規格要求。

Notes:

1. All dimensions are in millimeters.
2. All glass panes shall be of minimum 6mm thick or otherwise stated.
3. The dimensions of all window members shall be as specified or not less than 38mm if not specified.
4. Aluminium window works shall comply with Housing Department's standard aluminium window configurations and technical guidelines. Modifications may be made to the standard window configurations but should comply with the Buildings Department's technical guidelines and requirements.

工程項目 PROJECT

安裝鋁窗之標準排列格式

Standard Aluminium Window Configuration

圖則標題 DRAWING TITLE

十字型

Cruciform Block

圖則編號 DRG. NO.

SCU / EMDI / P05 / 2020 / 31

比例 SCALE

NTS

日期 DATE

3/2020

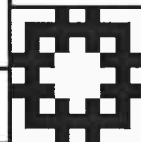

房屋署 屋邨辦事處
ESTATE OFFICE

HOUSING DEPARTMENT