

soluCLEAN

by Plus-h2o.com
Sustainably Derived



All Purpose Cleaner

Product code
SCWS750APP



1 FILL to the waterline



2 ADD the sachet



3 SHAKE, screw the spray head back on and shake the bottle



4 GO, once the sachet has dissolved, spray onto the cloth and use as needed.



Daily Toilet Cleaner

Product code
SCSP100TCP

DAILY DESCALING



1 FILL half way with warm water



2 ADD sachet to the bottle



3 SHAKE until the sachet has dissolved and leave for 15 minutes



4 GO, fill the bottle with water, shake and go.



Surface Sanitiser

Product code
SCWS750FSP

FOOD SAFE, EN1276

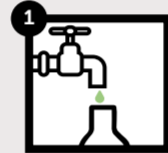
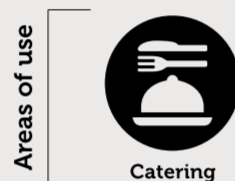

1 FILL to the waterline



2 ADD the sachet



3 SHAKE, screw the spray head back on and shake the bottle



4 GO, once the sachet has dissolved, spray onto the surface and use as needed.



Hard Surface Floor Cleaner

Product code
SCFS50HSP-5L

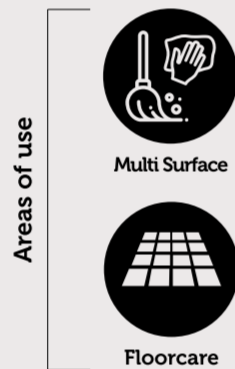

1 FILL, Add water to the tank fill line.



2 ADD, Add required number of sachets as per dilution instructions.



3 SWIRL / Agitate the water



4 GO, ready to use.



Neutral Scrubber Drier Cleaner

Product code
SCFS30NCP

LOW FOAM

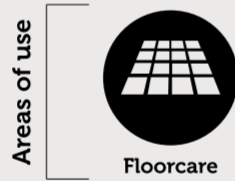

1 FILL, Add water to the tank fill line.

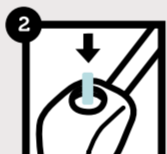

2 ADD, Add required number of sachets as per dilution instructions or for some machines premix solution.



3 SWIRL / Agitate the water



4 GO, ready to use.



Laundry Bio

Product code
SCSP100LBP

3 IN 1



1 ADD sachet to drum



2 FILL washer with load



3 Select programme



4 GO, ready to use.

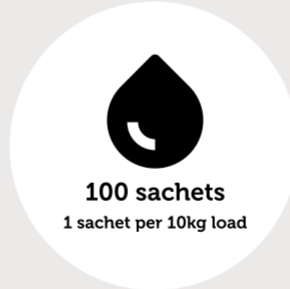

Washroom Disinfectant

Product code
SCWS750WDP

EN13697

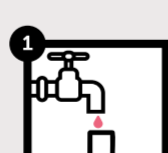
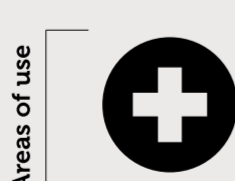

1 FILL to the waterline



2 ADD the sachet



3 SHAKE, screw the spray head back on and shake the bottle



4 GO, once the sachet has dissolved, spray onto the surface and use as needed.



Glass Cleaner

Product code
SCWS750GSP

STAINLESS STEEL AND UPVC CLEANER

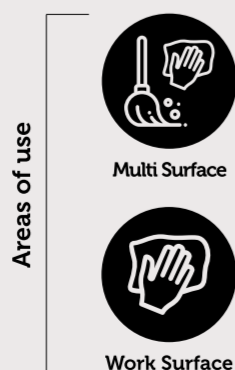

1 FILL to the waterline



2 ADD the sachet



3 SHAKE, screw the spray head back on and shake the bottle



4 GO, once the sachet has dissolved, spray onto the cloth and use as needed.



bottle4LIFE

Our bottles are made to last and last so keep on refilling them, our packaging can be re-used or recycled and everything else dissolves.

We offer a fully #ZeroWaste system, please return your old bottles to us and we'll make sure they never end up as waste.

#MoreOceanLessPlastic

Stay Safe

We don't like harming people or the environment so our products are not hazardous when they are diluted.

When you are handling the concentrate please make sure you:

- Store them in a dry area with the tabs inside the packets
- Only handle the tabs with dry hands
- Don't handle any damaged tabs
- Follow the safety data sheet
- Keep them out of the reach of children
- Avoid the concentrated powder making contact with your eyes or skin
- Follow the colour code

Always match the bottle to the packet to make sure you have the correct tab type and colour.

Ethically Produced

The SoluClean range is accredited by:



For further information
Scan the QR code, call us on 07932 904094 or email sales@plus-h2o.com



soluCLEAN by Plus-h2o.com

Sustainably Derived

Housekeeping Plan



Bio washroom cleaner

Product code
SCSP750BWCP-10

FAST ACTING ENZYMES

Areas of use: Washroom

- FILL** to the waterline
- ADD** the sachet
- SHAKE**, screw the spray head back on and shake the bottle
- GO**, once the sachet has dissolved, spray onto the cloth and use as needed.

10 bottles
One sachet per 750ml trigger bottle

Daily Toilet Cleaner

Product code
SCSP1000TCP-10

DAILY DESCALING

Areas of use: Washroom

- FILL** half way with warm water
- ADD** the sachet to the bottle
- SHAKE** until the sachet has dissolved and leave for 15 minutes
- GO**, fill the bottle with water, shake and go.

10 bottles
One sachet per 1l bottle

Limescale Remover

Product code
SCSP1000LSP-10

Areas of use: Multi Surface, Washroom

- FILL** half way with warm water
- ADD** the sachet to the bottle
- SHAKE** until the sachet has dissolved and leave for 15 minutes
- GO**, fill the bottle with water, shake and go.

10 bottles
One sachet per 1l bottle

Glass Cleaner

Product code
SCWS750GSP-10

STAINLESS STEEL AND UPVC CLEANER

Areas of use: Multi Surface, Work Surface

- FILL** to the waterline
- ADD** the sachet
- SHAKE**, screw the spray head back on and shake the bottle
- GO**, once the sachet has dissolved, spray onto the cloth and use as needed.

10 bottles
One sachet per 750ml trigger bottle

Anti Viral Cleaner

Product code
SCWS750GSP-10

EN14476

Areas of use: Catering, Germ Kill, Work Surface

- FILL** to the waterline
- ADD** the sachet
- SHAKE**, screw the spray head back on and shake the bottle
- GO**, once the sachet has dissolved, spray onto the surface and use as needed.

10 bottles
One sachet per 750ml trigger bottle

All Purpose Cleaner

Product code
SCWS750APP-10

Areas of use: Work Surface

- FILL** to the waterline
- ADD** the sachet
- SHAKE**, screw the spray head back on and shake the bottle
- GO**, once the sachet has dissolved, spray onto the cloth and use as needed.

10 bottles
One sachet per 750ml trigger bottle

Washroom Floor Cleaner

Product code
SCWS750WCP-10

EN13697

Areas of use: Washroom, Germ Kill, Floorcare

- FILL** water to the fill line
- ADD** the sachet in the bucket
- SWIRL** / Agitate the water until the sachet is completely dissolved
- GO**, ready to use.

30 sachets
1 sachet per 10l bucket

bottle4LIFE

Our bottles are made to last and last so keep on refilling them, our packaging can be re-used or recycled and everything else dissolves.

We offer a fully #ZeroWaste system, please return your old bottles to us and we'll make sure they never end up as waste.

#MoreOceanLessPlastic

Stay Safe

We don't like harming people or the environment so our products are not hazardous when they are diluted.

When you are handling the concentrate please make sure you:

- Store them in a dry area with the tabs inside the packets
- Only handle the tabs with dry hands
- Don't handle any damaged tabs
- Follow the safety data sheet
- Keep them out of the reach of children
- Avoid the concentrated powder making contact with your eyes or skin
- Follow the colour code

Always match the bottle to the packet to make sure you have the correct tab type and colour.

Ethically Produced

The SoluClean range is accredited by:



For further information
Scan the QR code, call us on 07932 904094 or email sales@plus-h2o.com



soluCLEAN by Plus-h2o.com

Sustainably Derived

Kitchen Plan



Degreaser Cleaner

Product code
SCWS750DCPF-10

FOOD SAFE

Areas of use



Catering



1 FILL to the waterline



2 ADD the sachet



3 SHAKE, screw the spray head back on and shake the bottle



4 GO, once the sachet has dissolved, spray onto the cloth and use as needed.



10 bottles
One sachet per
750ml trigger bottle

Surface Sanitiser

Product code
SCWS750FSP-10

FOOD SAFE EN1276

Areas of use



Catering



1 FILL to the waterline



2 ADD the sachet



3 SHAKE, screw the spray head back on and shake the bottle



4 GO, once the sachet has dissolved, spray onto the surface and use as needed.



10 bottles
One sachet per
750ml trigger bottle

Auto Dishwash

Product code
SCSP50DWP

ALL IN 1

Areas of use



Dishwasher



1 FILL machine with load



2 ADD the sachet

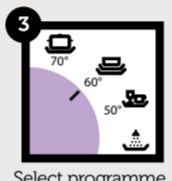

3 Select programme



4 GO, ready to use.



50 sachets
1 sachet per
load

Degreaser Floor Cleaner

Product code
SCFS30DCP-10L

GREASE CUTTING

Areas of use



Multi Surface

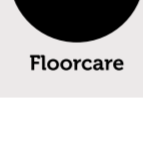

Floorcare



1 FILL water to the fill line



2 ADD the sachet in the bucket



3 SWIRL / Agitate the water until the sachet is completely dissolved



4 GO, ready to use.



30 sachets
1 sachet per
10l bucket

bottle4LIFE

Our bottles are made to last and last so keep on refilling them, our packaging can be re-used or recycled and everything else dissolves.

We offer a fully #ZeroWaste system, please return your old bottles to us and we'll make sure they never end up as waste.

#MoreOceanLessPlastic

Stay Safe

We don't like harming people or the environment so our products are not hazardous when they are diluted.

When you are handling the concentrate please make sure you:

- Store them in a dry area with the tabs inside the packets
- Only handle the tabs with dry hands
- Don't handle any damaged tabs
- Follow the safety data sheet
- Keep them out of the reach of children
- Avoid the concentrated powder making contact with your eyes or skin
- Follow the colour code

Always match the bottle to the packet to make sure you have the correct tab type and colour.

Ethically Produced

The SoluClean range is accredited by:



For further information
Scan the QR code, call us on 07932 904094 or email sales@plus-h2o.com



soluCLEAN

by Plus-h2o.com

Sustainably Derived



Hard Surface Floor Cleaner

Product code
SCFS50HSP-5L

Areas of use

- Multi Surface
- Floorcare

- FILL** water to the fill line
- ADD** the sachet in the bucket
- SWIRL** / Agitate the water until the sachet is completely dissolved
- GO**, ready to use.

50 sachets
1 sachet per 5L bucket

Surface Sanitiser

Product code
SCWS750FSP-10

FOOD SAFE EN1276

Areas of use

- Catering

- FILL** to the waterline
- ADD** the sachet
- SHAKE**, screw the spray head back on and shake the bottle
- GO**, once the sachet has dissolved, spray onto the surface and use as needed.

10 bottles
One sachet per 750ml trigger bottle

Glass Cleaner

Product code
SCWS750GSP-10

STAINLESS STEEL AND UPVC CLEANER

Areas of use

- Multi Surface
- Work Surface

- FILL** to the waterline
- ADD** the sachet
- SHAKE**, screw the spray head back on and shake the bottle
- GO**, once the sachet has dissolved, spray onto the cloth and use as needed.

10 bottles
One sachet per 750ml trigger bottle

Heavy-Duty Degreaser

Product code
SCWS750HDD-10

FOOD SAFE

Areas of use

- Catering

- FILL** to the waterline
- ADD** the sachet
- SHAKE**, screw the spray head back on and shake the bottle
- GO**, once the sachet has dissolved, spray onto the cloth and use as needed.

10 bottles
One sachet per 750ml trigger bottle

Auto Dishwash

Product code
SCSP50DWP

ALL IN 1

Areas of use

- Dishwasher

- FILL** machine with load
- ADD** the sachet
- Select programme
- GO**, ready to use.

50 sachets
1 sachet per load

Washroom Disinfectant

Product code
SCWS750WDP

EN13697

Areas of use

- Germ Kill

- FILL** to the waterline
- ADD** the sachet
- SHAKE**, screw the spray head back on and shake the bottle
- GO**, once the sachet has dissolved, spray onto the surface and use as needed.

10 bottles
One sachet per 750ml trigger bottle

All Purpose Cleaner

Product code
SCWS750APP-10

Areas of use

- Work Surface

- FILL** to the waterline
- ADD** the sachet
- SHAKE**, screw the spray head back on and shake the bottle
- GO**, once the sachet has dissolved, spray onto the cloth and use as needed.

10 bottles
One sachet per 750ml trigger bottle

Daily Toilet Cleaner

Product code
SCSP1000TCP-10

DAILY DESCALING

Areas of use

- Washroom

- FILL** half way with warm water
- ADD** the sachet to the bottle
- SHAKE** until the sachet has dissolved and leave for 15 minutes
- GO**, fill the bottle with water, shake and go.

10 bottles
One sachet per 1l bottle

bottle4LIFE

Our bottles are made to last and last so keep on refilling them, our packaging can be re-used or recycled and everything else dissolves.

We offer a fully #ZeroWaste system, please return your old bottles to us and we'll make sure they never end up as waste.

#MoreOceanLessPlastic

Stay Safe

We don't like harming people or the environment so our products are not hazardous when they are diluted.

When you are handling the concentrate please make sure you:

- Store them in a dry area with the tabs inside the packets
- Only handle the tabs with dry hands
- Don't handle any damaged tabs
- Follow the safety data sheet
- Keep them out of the reach of children
- Avoid the concentrated powder making contact with your eyes or skin
- Follow the colour code

Always match the bottle to the packet to make sure you have the correct tab type and colour.

Ethically Produced

The SoluClean range is accredited by:



For further information
Scan the QR code, call us on 07932 904094 or email sales@plus-h2o.com

