

BLUEFIRE®

BLUEFIRE®

MRAS-8350

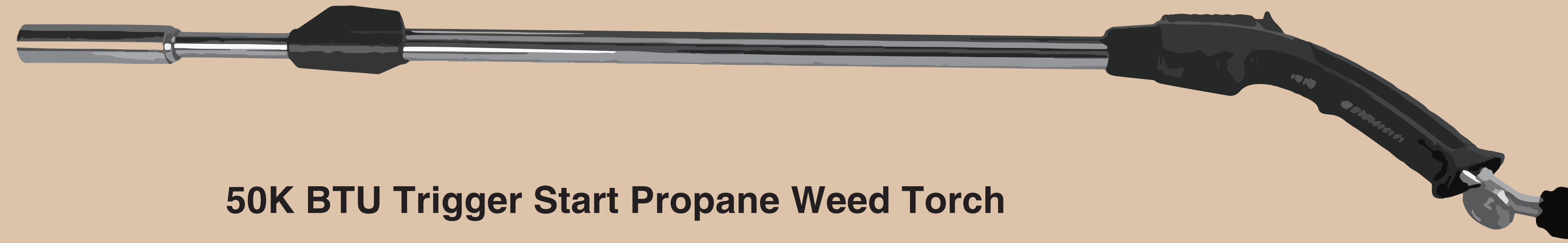

50K BTU Trigger Start Propane Weed Torch

Features

- 50,000BTU/hr
- Use only high quality propane gas cylinder
- Self ignition
- Adjustable flame
- 38 inch reach
- Heavy-Duty Stainless Steel arm
- Rubber wrapped handle for easy grip

Ideal for:

- Weed Killing
- Ice Melting
- Camp Fire Starter
- Lighting charcoal
- Driveway crack & joints filler use



BLUEFIRE®

BLUEFIRE®

MRAS-8350

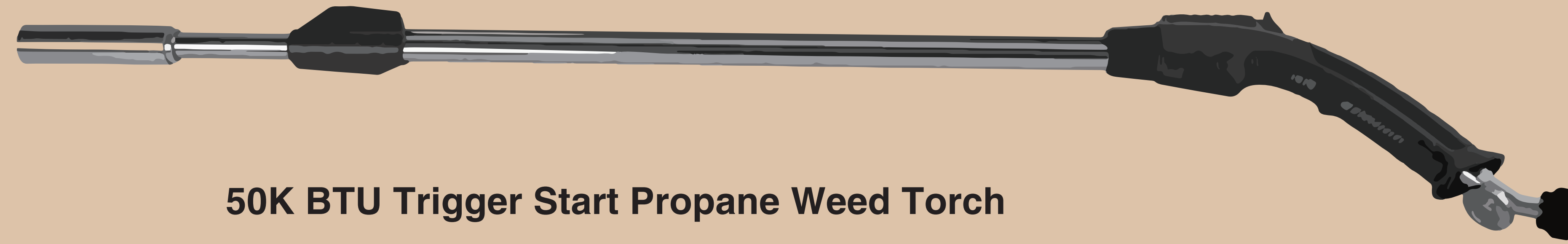

50K BTU Trigger Start Propane Weed Torch

Features

- 50,000BTU/hr
- Use only high quality propane gas cylinder
- Self ignition
- Adjustable flame
- 38 inch reach
- Heavy-Duty Stainless Steel arm
- Rubber wrapped handle for easy grip

Ideal for:

- Weed Killing
- Ice Melting
- Camp Fire Starter
- Lighting charcoal
- Driveway crack & joints filler use



160x35x940mm

READ ALL INSTRUCTIONS

IMPORTANT INFORMATION:

The instructions outlined below should be read carefully before using the appliance, and then keep it for further reference. All the instructions given are needed to use the appliance properly, to keep it in good order, and to avoid risks. We accept no responsibility for any damage occurred as a result of improper use of the torch or any modifications made to it.

Use only high quality propane gas cylinder.

1. PREPARING FOR USE

1.1 FITTING THE GAS CONTAINER

Turn the regulating control (3) in clockwise. Hold the gas container in vertical position and screw it in counter-clockwise onto the torch (fig.1) Screw the gas cylinder connection (4) in clockwise onto the gas cylinder Check for a good sealing

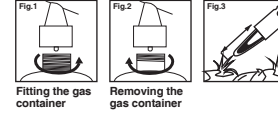

1.2 REMOVING THE GAS CONTAINER

Make sure the gas supply is shut-off by turning the regulating control (3) to the right. Unscrew the gas cylinder locking (4) in counter-clockwise to separate it from the gas cylinder. Then hold the gas container in vertical position and unscrew it in clockwise to detach it from the torch (fig.2) Safety measures Gas containers should be fitted or removed in well-ventilated areas, preferably in the open air, away from flammable substances or materials and incandescent sources of heat (such as flames, lighted cigarettes, hotplates, etc.), and AWAY FROM OTHER PERSONS OR ANIMALS. The appliance must not be used if the sealing o-ring or grommet is not in perfect condition or missing. Do not perforate or burn the gas container even when empty. For environmental reasons these containers should be disposed in designated fumaces or, preferably, be left in specific containers for subsequent recycling.

2. OPERATING INSTRUCTIONS

2.1 LIGHTING

Turn the regulating control (3) 1/4 to 1/2 round in counter-clockwise to ignite first before adjusting the flame. Push the ignition button (7) and the flame will lit instantly. If turn all the way to the maximum, will cause flame out and difficult to ignite. Cautions The appliance must be pointed downward (max 45°) all the time and away from people or animals.

2.2 ADJUSTMENT

Flame intensity may be adjusted by turning the regulating control (3) in clockwise or counter-clockwise.

2.3 WEED KILLING

Applying heat is a non-toxic and environmentally friendly way of destroying unwanted plants on pathways. This appliance is not suitable for use on flower beds or lawns. The weeds are heated from above and then dry out. The burner should be moved around gently. The aim is not to burn the plants, but to heat them up with the tip of the flame, and for this reason the appliance must be kept at an appropriate distance from the plants (fig.3) Stronger or woody weeds (wild grass, roots, etc.) must be exposed to heat for a longer period of time than common garden weeds. The process may have to be repeated after a few days.

Cautions

This torch must be used in the open air, away from flammable substances and materials. USE OUTDOORS ONLY.

Always point the appliance downwards to avoid the flame flaring. If flaring occurs, move the gas container to the upright position for a few seconds. Do not work on wet ground. Important! If the ground is excessively dry, there is a risk of cracking the surface. Do not leave the Torch unattended at any time. The use of defective or damaged appliances is dangerous.

2.4 TURNING OFF

Turn the regulating control (3) in clockwise until the flame is completely distinguished. Cautions Certain parts of the appliance may reach high temperatures. Let the appliance cool down for some time after turning off and before putting it away. Important! The burning flame will stay lit for a short time after turning the appliance off until the rem extension tube is out.

3. STORAGE

Separate the torch from gas container when not in use (fig.2). Keep the appliance and gas cylinder in a cool, dry and well-ventilated place.

Cautions

Keep the gas container away from direct sunlight. Never expose the container to a temperature of over 50°C. Keep it out of reach of children

4. TROUBLE SHOOTING

Do not carry out any maintenance or repair work. Take the appliance to a specialized store for attention if a problem arises. Tampering with the appliance can result in serious outcomes.

4.1 GAS LEAKS

In the event of a gas leak (smell of gas), take the appliance outside or to a well-ventilated place immediately, where the leak may be checked.

4.2 CHECK SEALING

The appliance must be checked for sealing outside, well away from any flame, using soapy water or a special leak detection spray. Spray the area to be checked. Bubbles or foam will form if there is a leak.

4.3 CHECK GAS CONTENT LEVEL

Unscrew the gas container from the appliance (fig.2). Shake it to see whether the sound of the liquefied gas can still be heard.

Note: Some of the illustrations shown in this instruction manual may not correspond exactly with the appliance supplied. The manufacturer reserves the rights to make modifications without prior notice.

Specification

| | |
|------------------|-------------------|
| Size : | 235x40x970mm |
| Torch Weight : | 1600g |
| Heat temp. : | Max.1100°C |
| Consumption rate | 1083g/hr(14.65KW) |
| BTU : | 50,000BTU/hr |

IMPORTANT!

1. Maintain a 5" gap between tip of Weed Torch and weed. Having Torch too close can cause flame to go out.
2. When igniting your Weed Torch, slightly open the valve. Once lit, you can adjust the flame as needed.
3. After each use, remove the torch head from the fuel canister for safety

WARNING: This product contains chemicals, including lead and lead compounds in brass fittings. It also produces combustion by-products when used. These substances are known to the State of California to cause cancer, birth defects or other reproductive harm

Wash your hands after using this product.

Contains lead. May be harmful if eaten or chewed. Complies with federal standards

WARNING: Keep out of children's reach

For more information go to www.p65warnings.ca.gov

SAVE THESE INSTRUCTIONS

172x160mm