



FGM
CABINETRY LLC

Specification Guide

January 2024

Dear Customer:

Thank you very much for choosing FGM Cabinetry LLC, a company that puts the well-being of its customers first. We have 100% confidence in the quality of our product, and we have built a strong customer service team to assist you with all questions, orders, and re-orders. The core value of FGM Cabinetry is SHARING. Based on that, we have three basic promises to our customers:

- We will be very disciplined with our profit percentage.
- We will only do wholesale.
- We will always be honest with our customers.

We Believe FGM Cabinetry will be your friend in the cabinetry industry.

Sincerely,

Your FGM Cabinetry Team

ORDERING INSTRUCTIONS

Placing Orders

FGM Cabinetry recommend our customers to use the order forms sent from us. Our order forms are specially designed and easy to use, using it to place orders will significantly reduce the chance of the miscommunication. Please contact us at info@fgmcabinetry.com with your company information to apply for the order form and multiplier. We do accept other order forms but the Cabinet code in those order forms needs to be FGM's so that our service team could easily understand it and place the order for you. To place orders, please contact us via fax to 908-583-6240 or via email to order@fgmcabinetry.com.

Confirming Orders

After we receive the orders, we will check our inventory, once we confirmed we have everything on the order list, a confirmation letter will be sent to the customer via email or fax. This procedure normally takes 2 – 4 hours. The order will not be processed until the confirmation letter is **confirmed, signed by the customer, and returned** to us via email or fax. If you have any preference on the shipping date or picking up date, please feel free to add on the confirmation letter. If no indication is made, the shipment or pick up will be scheduled according to our lead - time which is 5 – 7 business days (RTA orders' lead - time is usually 1 – 2 business days). FGM reserves the rights to extend lead time on special occasions.

Delivery and Pick up

FGM Cabinetry offers delivery service to the tri -state area for a reasonable charge. Please contact your sale rep. to obtain your shipping rate. A second delivery charge will be applied if the first delivery does not succeed, however this fee will be waived if a mistake was made by us. (item damaged during delivery, wrong items assembled etc.)

Customers will be asked to confirm the correctness of the delivered items and sign on the delivered item list. Any claim of missing items after signing the paper **will not be accepted**. If there is shipping damage, a clear image needs to be sent to our customer service team for us to verify and to arrange replacement **within 7 days** of the delivery.

For pick up, our customer service team will call our customers once the order is ready. We recommend you give us a call before picking up any orders to confirm, and so we may begin preparing your pickup.

Auto Cancellation

Orders that are not picked up within two weeks after the original scheduled pickup date will be automatically cancelled. Any special requests for holding an order must be made prior to confirmation.

WARRANTY INFORMATION

Warranty Information

FGM Cabinetry offers our customer a limited lifetime warranty on manufacturing defects for all of our door styles. This warranty does not cover products that have been misused, mishandled, abused, improperly stored or installed, modified or subject to excesses of moisture or extreme temperatures, accidents, negligence, on-site alterations, improper storage, defective installation, or normal wear and tear. The product must be used exclusively for its intended purpose in order to be covered by this warranty. This warranty shall become void if the cabinets are in any way modified, improperly installed or damaged prior to or during installation, or installed or utilized in other than normal residential applications.

This warranty does not include or cover the cost of installation, removal, subsequent damage or transportation of the defective product, regardless of whether work was performed by a contractor, service company, or homeowner. This warranty does not apply to any products used in conjunction with the cabinetry, such as countertops, appliances, or plumbing fixtures. The obligation of FGM Cabinetry under this warranty shall be limited to the repair or exchange of any part or parts that FGM Cabinetry deems proven defective under normal use and service within the warranty period.

FGM Cabinetry is constructed from several pieces of solid wood and wood veneers on plywood. Differences in grain pattern and color should be expected. Wood characteristics naturally occurring such as variations in color, grain, mineral streaks and knots are not considered defects. Color variations and color softening in cabinets are a natural occurrence due to species, age, character of cabinets, and exposure to UV light and sunlight. For these reasons, new and/or replacement cabinets may not match display samples and/or existing cabinets. Such variations and changes are not considered defects. This warranty applies only to defects and does not apply to the yellowing and aging of any wood product. FGM Cabinetry products are wood products. Extreme conditions will cause any wood product to respond adversely (high/low humidity, temperature, etc.) and this warranty does not apply to cabinetry exposed to extreme conditions. Mitered doors joints in particular are more likely to react to conditions of its environment. Gaps that may develop in door joints due to conditions of its environment are not subject to replacement under this warranty. Painted finishes react differently than stained finish with normal wood movement and climatic conditions may result in breaks in finish, recesses, and joint and panel lines. These are considered a normal occurrence and not covered under warranty. Cabinet doors that are warped must be allowed to hang through one seasonal heating cycle. (i.e. through a full summer) before replacement will be considered under this limited warranty. Doors that are warped in either direction not exceeding one-quarter inch (1/4") do not exceed normal material expectation and are not covered under the terms of this warranty.

FGM Cabinetry periodically makes changes to its product line and specifications. If a warranty claim is filed for a discontinued or unavailable item, FGM Cabinetry will replace the part(s) under warranty with a new part of the same style or with a similar style currently offered. Some replacement parts are subject to availability, and may differ from those originally supplied. FGM Cabinetry cannot be held responsible for replacement product that may not exactly match installed product.

Warranty claims cannot be made directly to FGM Cabinetry LLC by the consumer purchaser. The consumer must contact the dealer or distributor from whom the products were purchased and report the nature of the defect. To submit a warranty claim, the original consumer purchaser must contact the FGM Cabinetry LLC distributor where the product was purchased. The independent dealer or distributor will obtain the information necessary to make a claim decision and forward such information in writing to FGM Cabinetry LLC for action on the claim. If the dealer or distributor is no longer functioning as a business entity, please submit your claim in writing with a proof of purchase to:

FGM Cabinetry, 1819 W Edgar Road, Linden, NJ, 07036

This writing is the complete and exclusive statement of the express warranties provided herein and is in lieu of all other express and/or statutory warranties by the manufacturer, to the extent provided by law. There are no implied warranties extending beyond the terms of this warranty. FGM Cabinetry LLC shall not be liable for any incidental or consequential costs, expenses or damages.

If a manufacturing defect does occur within the terms and conditions of this warranty, FGM Cabinetry will replace the defective part and ship it to you via ground shipper or freight carrier, at our discretion.

Please do not send the defective item unless and until the item is expressly requested by our claims department. Pictures of item(s) may be requested. Making a fraudulent claim may be a crime, and violators may be prosecuted.

Defect or item missing Claims

After the delivery of the cabinets, the customers will be asked to sign a delivered cabinets list. If there is anything missing, the customers should contact FGM's customer service immediately and should not sign the paperwork until the missing part is delivered. Any missing item claims will NOT BE HORNED once a delivery is signed.

For shipping or assembling damage, **we strongly recommend our customers to open all the boxes within 7 days of delivery** to check all the delivered cabinets. Any shipping or assembling damage claim filed after 7 days of the delivery date will not be horned and the damaged part will not be replaced. The Damaged item claims must be made prior to assembly and/or installation. Any damaged item that is installed or assembled will not be replaced.

CABINET CONSTRUCTION SPECIFICATION

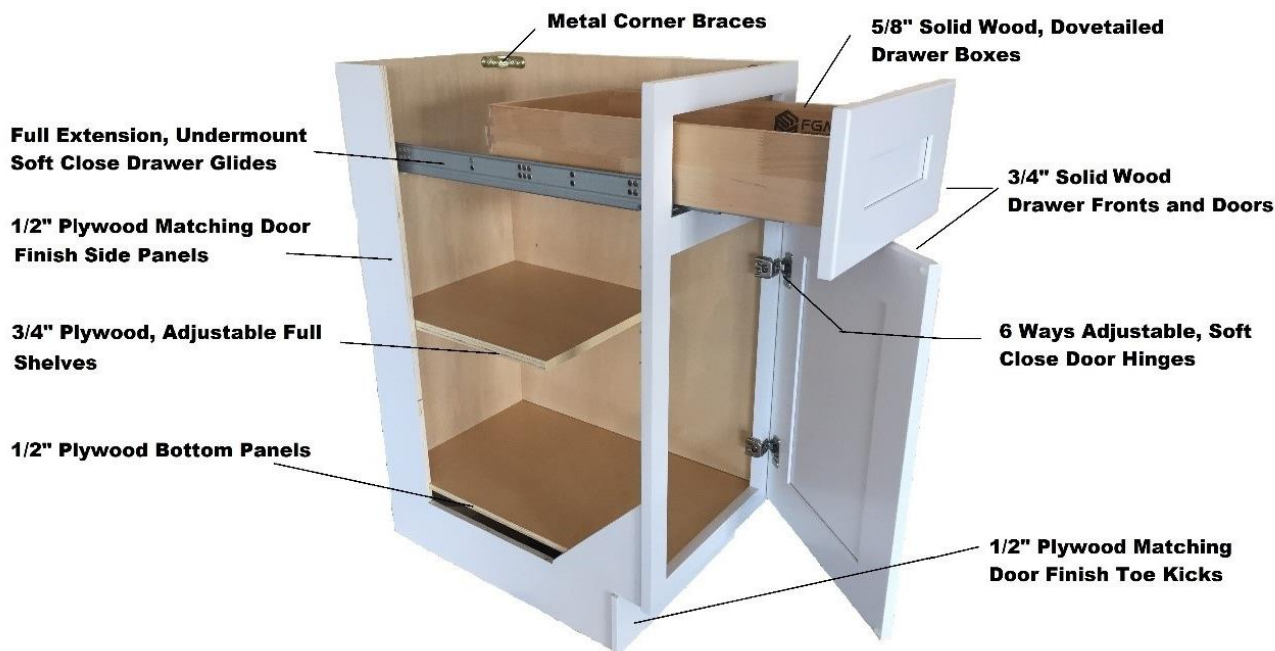

- 3/4" thick Solid Wood Drawer Fronts and Doors
- 5/8" Solid Wood, Dovetailed Drawer Boxes
- Solid Wood 5-piece Drawer Fronts
- Full-Extension, Soft Close Undermount Drawer Glides
- 6 Ways Adjustable, Soft Close Door Hinges
- 3" Wide Door Rail
- 1/2" Plywood Side Panels, Matching Door Finished Exterior
- 3/4" Plywood, Adjustable Shelves
- ALL Door & Drawer Fronts are Full Overlay
- Metal Corner Braces
- Originally made in Thailand and assembled in the USA
- All products have TPC-44 certification and comply with the USA environment safety standard (CARB and EPA Recognized)

CABINET LINES – CURRENT DOOR STYLES

MERCURY SERIES (SHAKER STYLE)



Grey (MG)



White (MW)



Cherry (MC)

VENUS SERIES (RAISED PANEL DOOR STYLE)



Ivory (VI)

Note: Actual colors may be different than the pictures, please check our sample doors for the color

CABINET LINES – CURRENT DOOR STYLES

JUPITER SERIES (RECESSED PANEL DOOR STYLE)



Ice (JI)



Gani (JG)

NEPTUNE SERIES (SLIM SHAKER DOOR STYLE)



Triton (NT)

Note: Actual colors may be different than the pictures, please check our sample doors for the color



FGM
CABINETRY LLC

PRICES AND SPECS

12" Deep Wall Cabinets - 1 door	MERCURY	JUPITER	VENUS	NEPTUNE
---------------------------------	---------	---------	-------	---------

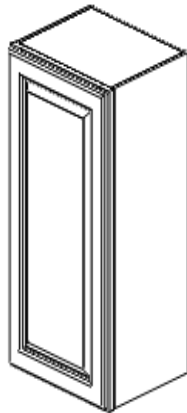

W0930	9" W 30" T 12" D	212	218	225	201
W1230	12" W 30" T 12" D	224	231	237	213
W1530	15" W 30" T 12" D	260	268	276	247
W1830	18" W 30" T 12" D	288	297	305	274
W2130	21" W 30" T 12" D	312	321	331	296
W0936	9" W 36" T 12" D	240	247	254	228
W1236	12" W 36" T 12" D	272	280	288	258
W1536	15" W 36" T 12" D	292	301	310	277
W1836	18" W 36" T 12" D	344	354	365	327
W2136	21" W 36" T 12" D	368	379	390	350
W0942	9" W 42" T 12" D	272	280	288	258
W1242	12" W 42" T 12" D	298	307	316	283
W1542	15" W 42" T 12" D	344	354	365	327
W1842	18" W 42" T 12" D	388	400	411	369
W2142	21" W 42" T 12" D	412	424	437	391

Note: Glass doors are available for 12", 15" and 18" wide cabinets

12" Deep Wall Cabinets - 2 door	MERCURY	JUPITER	VENUS	NEPTUNE
---------------------------------	---------	---------	-------	---------

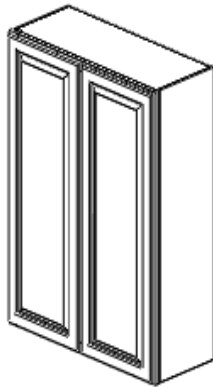

W2430	24" W 30" T 12" D	352	363	373	334
W2730	27" W 30" T 12" D	396	408	420	376
W3030	30" W 30" T 12" D	424	437	449	403
W3330	33" W 30" T 12" D	452	466	479	429
W3630	36" W 30" T 12" D	480	494	509	456
W2436	24" W 36" T 12" D	420	433	445	399
W2736	27" W 36" T 12" D	448	461	475	426
W3036	30" W 36" T 12" D	476	490	505	452
W3336	33" W 36" T 12" D	504	519	534	479
W3636	36" W 36" T 12" D	532	548	564	505
W2442	24" W 42" T 12" D	508	523	538	483
W2742	27" W 42" T 12" D	552	569	585	524
W3042	30" W 42" T 12" D	596	614	632	566
W3342	33" W 42" T 12" D	640	659	678	608
W3642	36" W 42" T 12" D	676	696	717	642

Note: Glass doors are available for 24" 30" and 36" wide cabinets

BRIDGE CABINETS

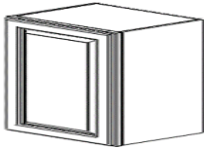
12" Deep Stack Wall Cabinet		MERCURY	JUPITER	VENUS	NEPTUNE	
	W1212	12"W 12"T 12"D	185	N/A	N/A	176
	W1512	15"W 12"T 12"D	206	N/A	N/A	196
	W1812	18"W 12"T 12"D	230	N/A	N/A	219
	W2112	21"W 12"T 12"D	247	N/A	N/A	235
	W1215	12"W 15"T 12"D	200	N/A	N/A	190
	W1515	15"W 15"T 12"D	223	N/A	N/A	212
	W1815	18"W 15"T 12"D	245	N/A	N/A	233
	W2115	21"W 15"T 12"D	265	N/A	N/A	252
	W1218	12"W 18"T 12"D	230	N/A	N/A	219
	W1518	15"W 18"T 12"D	248	N/A	N/A	236
	W1818	18"W 18"T 12"D	265	N/A	N/A	252
	W2118	21"W 18"T 12"D	286	N/A	N/A	272

Note: Only Available in MW and MG and NT Currently

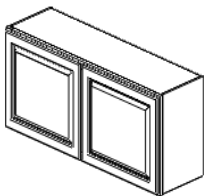
12" Deep Bridge Cabinet - 2 doors		MERCURY	JUPITER	VENUS	NEPTUNE	
	W2412	24"W 12"T 12"D	255	263	270	242
	W2418	24"W 18"T 12"D	313	322	322	297
	W2424	24"W 24"T 12"D	350	361	371	333
	W3012	30"W 12"T 12"D	256	264	271	243
	W3015	30"W 15"T 12"D	268	276	284	255
	W3018	30"W 18"T 12"D	308	317	326	293
	W3021	30"W 21"T 12"D	344	354	365	327
	W3024	30"W 24"T 12"D	364	375	386	346
	W3312	33"W 12"T 12"D	265	273	281	252
	W3315	33"W 15"T 12"D	292	301	310	277
	W3318	33"W 18"T 12"D	324	334	343	308
	W3321	33"W 21"T 12"D	360	371	382	342
	W3324	33"W 24"T 12"D	384	396	407	365
	W3612	36"W 12"T 12"D	308	317	326	293
	W3615	36"W 15"T 12"D	320	330	339	304
	W3618	36"W 18"T 12"D	348	358	369	331
	W3621	36"W 21"T 12"D	378	389	401	359
	W3624	36"W 24"T 12"D	412	424	433	391

Note: All bridge cabinets can be increased up to 24" deep

W3324 currently are not available in Mercury Cherry

24" Deep Bridge Cabinet - 2 doors	MERCURY	JUPITER	VENUS	NEPTUNE
-----------------------------------	---------	---------	-------	---------

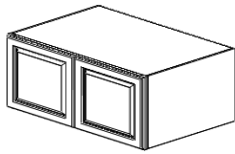

W361224 36" W 12" T 24" D	332	342	352	315
W361824 36" W 18" T 24" D	396	408	420	376
W362124 36" W 21" T 24" D	440	453	466	418
W362424 36" W 24" T 24" D	476	490	505	452

WALL CORNER & END CABINETS

24" Wall Diagonal Corner	MERCURY	JUPITER	VENUS	NEPTUNE
--------------------------	---------	---------	-------	---------

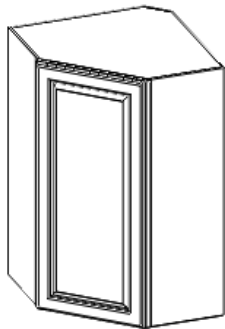

WDC2412 24" W 12" T 12" D	215	N/A	N/A	N/A
WDC2430 24" W 30" T 12" D	476	490	505	452
WDC2436 24" W 36" T 12" D	544	560	577	517
WDC2442 24" W 42" T 12" D	624	643	661	593

Note: WDC2412 are currently only available in MW and MG

27" (Stack) Wall Diagonal Corner	MERCURY	JUPITER	VENUS	NEPTUNE
----------------------------------	---------	---------	-------	---------

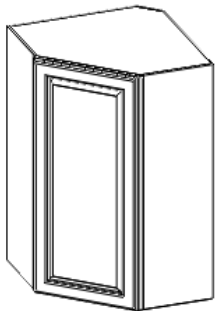

WDC2736 27" W 36" T 15" D	624	643	661	593
WDC2742 27" W 42" T 15" D	698	719	740	663

Note: Glass doors are available

Wall Blind Cabinet	MERCURY	JUPITER	VENUS	NEPTUNE
--------------------	---------	---------	-------	---------

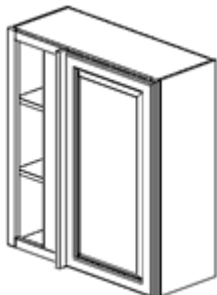

WBC2430 24" W 30" T 12" D	396	408	420	376
WBC2436 24" W 36" T 12" D	448	461	475	426
WBC2442 24" W 42" T 12" D	520	536	551	494

Act.	Min.	Max	Door	Stile	Open
24"	26"	28"	12"	6"	5"

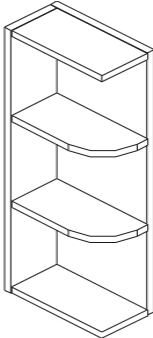
Wall End Shelf		MERCURY	JUPITER	VENUS	NEPTUNE
	WES0630 06" W 30" T 12" D	180	185	191	171
	WES0636 06" W 36" T 12" D	220	227	233	209
	WES0642 06" W 42" T 12" D	268	276	284	255
	WES0930 09" W 30" T 12" D	228	235	242	217
	WES0936 09" W 36" T 12" D	288	297	305	274
	WES0942 09" W 42" T 12" D	336	346	356	319
	WES1230 12" W 30" T 12" D	276	284	293	262
	WES1236 12" W 36" T 12" D	380	391	403	361
WES1242 12" W 42" T 12" D	420	433	445	399	

Wall End Cabinet		MERCURY	JUPITER	VENUS	NEPTUNE
	WEC1230 12" W 30" T 12" D	336	346	356	319
	WEC1236 12" W 36" T 12" D	372	383	394	353
	WEC1242 12" W 42" T 12" D	416	428	441	395

Wall Angle End Cabinet		MERCURY	JUPITER	VENUS	NEPTUNE
	WAE1230 12" W 30" T 12" D	280	288	297	266
	WAE1236 12" W 36" T 12" D	352	363	373	334
	WAE1242 12" W 42" T 12" D	392	404	416	372

BASE & SINK BASE CABINETS

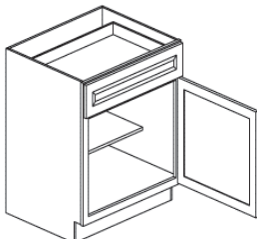
Single Drawer Single Door Base Cabinet		MERCURY	JUPITER	VENUS	NEPTUNE
	BSR09 09" W 34 1/2" T 24" D	540	556	572	513
	B09 09" W 34 1/2" T 24" D	260	268	276	247
	B12 12" W 34 1/2" T 24" D	352	363	373	334
	B15 15" W 34 1/2" T 24" D	372	383	394	353
	B18 18" W 34 1/2" T 24" D	388	400	411	369
	B21 21" W 34 1/2" T 24" D	440	453	466	418
	Note: B15 can hold single trashcan				
	B18 and B21 can hold double trashcan				

Single Drawer Double Door Base Cabinet

MERCURY JUPITER VENUS NEPTUNE

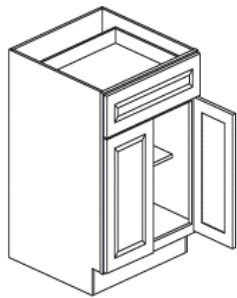

B24	24" W 34 1/2" T 24" D	472	486	500	448
B27	27" W 34 1/2" T 24" D	528	544	560	502
B30	30" W 34 1/2" T 24" D	556	573	589	528
B33	33" W 34 1/2" T 24" D	636	655	674	604

Double Drawer Double Door Base Cabinet

MERCURY JUPITER VENUS NEPTUNE

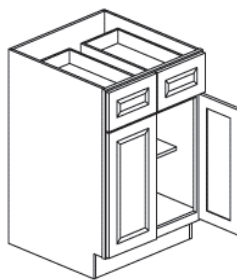

B36	36" W 34 1/2" T 24" D	660	680	700	627
------------	-----------------------	-----	-----	-----	-----

Single Drawer Double Door Sink Base Cabinet

MERCURY JUPITER VENUS NEPTUNE

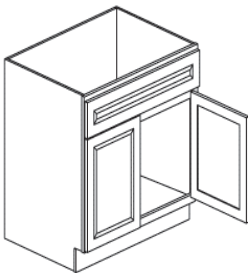

SB24	24" W 34 1/2" T 24" D	436	449	462	414
SB27	27" W 34 1/2" T 24" D	460	474	488	437
SB30	30" W 34 1/2" T 24" D	484	499	513	460
SB33	33" W 34 1/2" T 24" D	504	519	534	479

Double Drawer Double Door Sink Base Cabinet

MERCURY JUPITER VENUS NEPTUNE

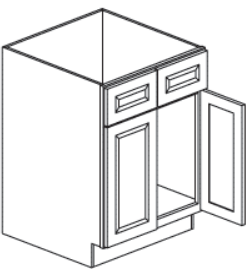

SB36	36" W 34 1/2" T 24" D	524	540	555	498
-------------	-----------------------	-----	-----	-----	-----

Base Microwave

MERCURY JUPITER VENUS NEPTUNE

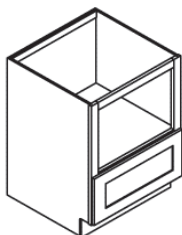

BMW30	30" W 34 1/2" T 24" D	750	773	795	713
--------------	-----------------------	-----	-----	-----	-----

Note: Maximum opening: 26 3/4"W x 17"H

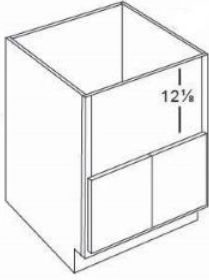
Farm Sink Base		MERCURY	JUPITER	VENUS	NEPTUNE	
	FSB30	30" W 34 1/2" T 24" D	804	828	844	764
	FSB36	36" W 34 1/2" T 24" D	844	869	886	802
<p>Note: Full panel in front, can be cut on the job site</p>						

DRAWER BASE CABINETS

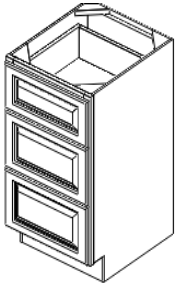
Drawer Base - (3) Drawer		MERCURY	JUPITER	VENUS	NEPTUNE	
	3DB12	12" W 34 1/2" T 24" D	543	559	576	516
	3DB15	15" W 34 1/2" T 24" D	564	581	598	536
	3DB18	18" W 34 1/2" T 24" D	598	616	634	568
	3DB21	21" W 34 1/2" T 24" D	645	664	684	613
	3DB24	24" W 34 1/2" T 24" D	696	717	738	661
	3DB30	30" W 34 1/2" T 24" D	812	836	861	771
	3DB36	36" W 34 1/2" T 24" D	960	989	1018	912

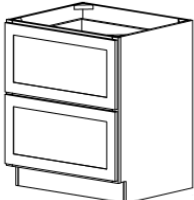
Drawer Base - (2) Drawer		MERCURY	JUPITER	VENUS	NEPTUNE	
	2DB30	30" W 34 1/2" T 24" D	752	775	797	714
	2DB36	36" W 34 1/2" T 24" D	852	878	903	809

BASE CORNER & END CABINETS

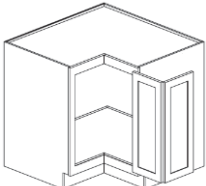
Easy Reach Corner Base		MERCURY	JUPITER	VENUS	NEPTUNE	
	EZ33	12" doors, 33" backs, 24" sides	720	742	763	684
	EZ36	12" doors, 36" backs, 24" sides	795	819	843	755

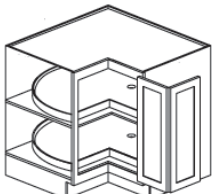
Lazy Susan		MERCURY	JUPITER	VENUS	NEPTUNE	
	LS33	12" doors, 33" backs, 24" sides	956	985	1013	908
	LS36	12" doors, 36" backs, 24" sides	1047	1078	1110	995

Blind Corner Base	MERCURY	JUPITER	VENUS	NEPTUNE
-------------------	---------	---------	-------	---------

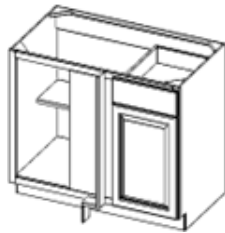

BBC39-42	33"W 34 1/2"T 24"D	550	567	583	523
BBC42-45	36"W 34 1/2"T 24"D	564	581	598	536
	Act. Min. Max Door Stile Open				
BBC39-42	33" 39" 42" 12" 9.8" 9.3"				
BBC42-45	36" 42" 45" 14.6" 7.7" 11.9"				

Corner Sink Base 36	MERCURY	JUPITER	VENUS	NEPTUNE
---------------------	---------	---------	-------	---------

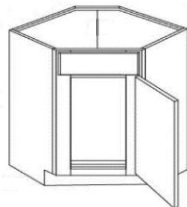

DSB36	36"W 34 1/2"T 24"D	695	716	737	660
--------------	--------------------	-----	-----	-----	-----

Transitional Angle Base	MERCURY	JUPITER	VENUS	NEPTUNE
-------------------------	---------	---------	-------	---------

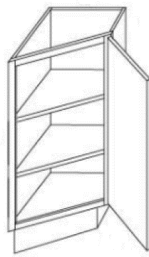

TAB12HDL	12" W, 34 1/2" T, 24" D	364	375	386	346
TAB12HDR	12" W, 34 1/2" T, 24" D	364	375	386	346

UTILITY PANTRY CABINETS

24" Depth (2) Door Pantry (15 & 18"W)	MERCURY	JUPITER	VENUS	NEPTUNE
---------------------------------------	---------	---------	-------	---------



UP1584	15" W 84" T 24" D	995	1025	1055	945
UP1590	15" W 90" T 24" D	1065	1097	1129	1012
UP1596	15" W 96" T 24" D	1135	1169	1203	1078
UP1884	18" W 84" T 24" D	1112	1145	1179	1056
UP1890	18" W 90" T 24" D	1180	1215	1251	1121
UP1896	18" W 96" T 24" D	1244	1281	1319	1182

24" Depth (4) Door Pantry (24"W)

MERCURY JUPITER VENUS NEPTUNE

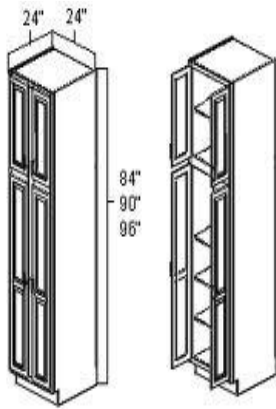

UP2484	24" W 84" T 24" D	1232	1269	1306	1170
UP2490	24" W 90" T 24" D	1297	1336	1375	1232
UP2496	24" W 96" T 24" D	1376	1417	1459	1307

OVEN CABINETS

Regular Oven Cabinet

MERCURY JUPITER VENUS NEPTUNE

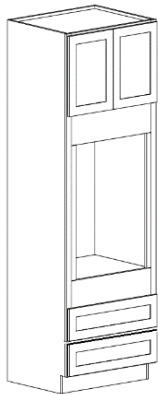

OC3084D	30" W 84" T 24" D	1656	1706	1739	1573
OC3090D	30" W 90" T 24" D	1748	1800	1853	1661
OC3096D	30" W 96" T 24" D	1820	1875	1929	1729
OC3384D	33" W 84" T 24" D	1796	1850	1886	1706
OC3390D	33" W 90" T 24" D	1832	1887	1942	1740
OC3396D	33" W 96" T 24" D	1895	1952	2009	1800

Note:

- 1.) 30" Regular Oven Opening = 21"W x 42 1/2"T
Max cut out = 28"W x 56"T (Remove One Drawer)
- 2.) 33" Regular Oven Opening = 24"W x 42 1/2"T
Max cut out = 31"W x 56"T (Remove One Drawer)

Double Oven Cabinet

MERCURY JUPITER VENUS NEPTUNE

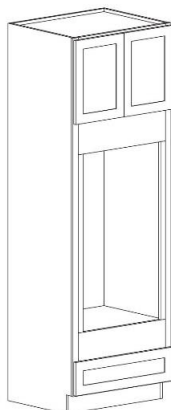

DOC3084	30" W 84" T 24" D	1656	1706	1739	1573
DOC3090	30" W 90" T 24" D	1748	1800	1853	1661
DOC3096	30" W 96" T 24" D	1820	1875	1929	1729
DOC3384	33" W 84" T 24" D	1796	1850	1886	1706
DOC3390	33" W 90" T 24" D	1832	1887	1942	1740
DOC3396	33" W 96" T 24" D	1895	1952	2009	1800

Note:

- 1.) 30" Double Oven Opening = 21"W x 49"T
- 2.) 33" Double Oven Opening = 24"W x 49"T

VANITY BASE & SINK BASE CABINETS

Sink Base - (2) Door (1) False Drawer

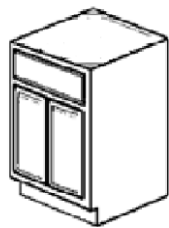

		MERCURY	JUPITER	VENUS	NEPTUNE
V2421	24" W 34 1/2" T 21" D	412	424	437	391
V3021	30" W 34 1/2" T 21" D	464	478	492	441
V3621	36" W 34 1/2" T 21" D	515	530	606	489

VANITY DRAWER BASE CABINETS

Vanity Drawer Base - (3) Drawer

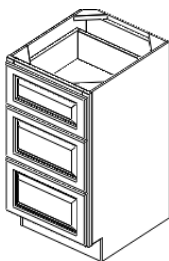

		MERCURY	JUPITER	VENUS	NEPTUNE
VDB1221	12" W 34 1/2" T 21" D	504	519	534	479
VDB1521	15" W 34 1/2" T 21" D	536	552	568	509
VDB1821	18" W 34 1/2" T 21" D	568	585	602	540

VANITY COMBINATION CABINETS

30" (2) Drawer Vanity Combination Cabinets

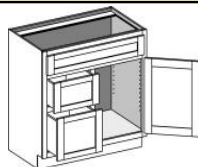

		MERCURY	JUPITER	VENUS	NEPTUNE
VSDL3021	30" W 34 1/2" T 21" D	644	663	683	612
VSDR3021	30" W 34 1/2" T 21" D				

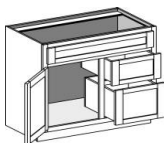

36" (2) Drawer Vanity Combination Cabinets

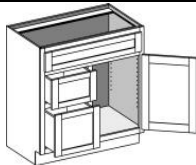

		MERCURY	JUPITER	VENUS	NEPTUNE
VSDL3621	36" W 34 1/2" T 21" D	716	737	759	680
VSDR3621	36" W 34 1/2" T 21" D				

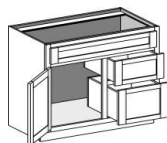

48" (4) Drawer Vanity Combination Cabinets

MERCURY

JUPITER

VENUS

NEPTUNE

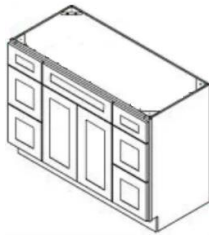

VSD4821	48"W 34 1/2"T 21"D	1072	1104	1136	1018
----------------	--------------------	------	------	------	------

VANITY LINEN CABINETS

21" Depth Vanity Pantry (15 & 18"W)

MERCURY

JUPITER

VENUS

NEPTUNE



VUP1584	15" W 84" T 21" D	1275	1313	1352	1211
VUP1590	15" W 90" T 21" D	1345	1385	1426	1278
VUP1596	15" W 96" T 21" D	1415	1457	1500	1344
VUP1884	18" W 84" T 21" D	1392	1434	1476	1322
VUP1890	18" W 90" T 21" D	1460	1504	1548	1387
VUP1896	18" W 96" T 21" D	1524	1570	1615	1448

21" Depth Vanity Pantry (24"W)

MERCURY

JUPITER

VENUS

NEPTUNE

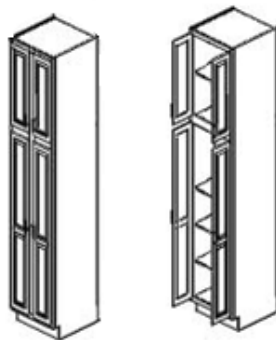

VUP2484	24" W 84" T 21" D	1512	1557	1603	1436
VUP2490	24" W 90" T 21" D	1580	1627	1675	1501
VUP2496	24" W 96" T 21" D	1656	1706	1755	1573

SPECIALTY CABINETS

Wine Rack

MERCURY

JUPITER

VENUS

NEPTUNE

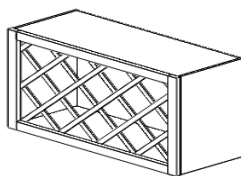

WR3015	30" W 15" T 12" D	340	350	360	323
WR3018	30" W 18" T 12" D	372	383	394	353

Microwave Shelf			MERCURY	JUPITER	VENUS	NEPTUNE
-----------------	--	--	---------	---------	-------	---------

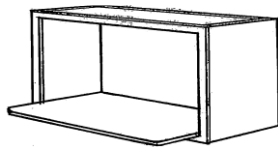

MC3018	30" W 18" T 18" D	236	243	250	224
---------------	-------------------	-----	-----	-----	-----

Plate Rack			MERCURY	JUPITER	VENUS	NEPTUNE
------------	--	--	---------	---------	-------	---------

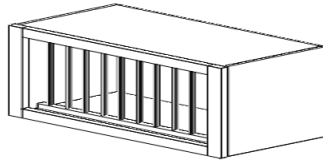

PR3015	30" W 15" T 12" D	328	338	348	312
---------------	-------------------	-----	-----	-----	-----

Stem Glass Holder			MERCURY	JUPITER	VENUS	NEPTUNE
-------------------	--	--	---------	---------	-------	---------



SGH30	30" W 1" T 12" D	220	227	233	209
--------------	------------------	-----	-----	-----	-----

Vanity Knee Drawer			MERCURY	JUPITER	VENUS	NEPTUNE
--------------------	--	--	---------	---------	-------	---------

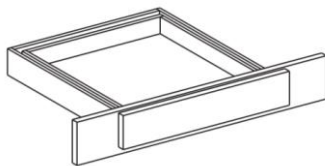



VKD36	36" W 6 1/4" H 21" D	326	336	N/A	N/A
--------------	----------------------	-----	-----	-----	-----

Note: Actual drawer width 30" with 3" cutable extension on each side

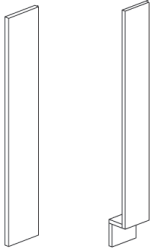
ACCESSORIES: FILLERS AND SKINS

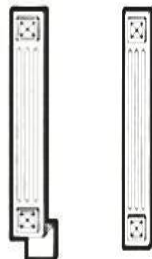
Straight Fillers		MERCURY	JUPITER	VENUS	NEPTUNE	
	WF330	3" W 30" T	32	33	34	30
	WF336	3" W 36" T	44	45	47	42
	WF342	3" W 42" T	48	49	51	46
	WF630	6" W 30" T	64	66	68	61
	WF636	6" W 36" T	72	75	77	68
	WF642	6" W 42" T	80	83	85	76
	F396	3" W 96" T	100	103	106	95
	F696	6" W 96" T	190	196	201	181
	BF3	3" W 34 1/2" T	44	45	47	42
	BF6	6" W 34 1/2" T	96	99	102	91

Fluted Fillers		MERCURY	JUPITER	VENUS	NEPTUNE	
	A30WF	3" W 30" T	48	49	51	46
	A36WF	3" W 36" T	72	74	76	68
	A42WF	3" W 42" T	80	82	85	76
	A3BF	3" W 34 1/2" T	52	54	55	49

Skin(s)		MERCURY	JUPITER	VENUS	NEPTUNE	
	BSK	24" X 34 1/2"	84	87	89	80
	WSK1230	12" X 30"	36	37	38	34
	WSK1236	12" X 36"	48	49	51	46
	WSK1242	12" X 42"	60	62	64	57
	WSK1260	12" X 60"	72	74	76	68
	TSK2496	24" X 96"	239	246	253	227
	BP4896	48" X 96"	372	383	394	353

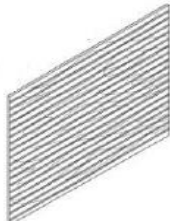
Beaded Skin(s)		MERCURY	JUPITER	VENUS	NEPTUNE	
	DBP4896	48" X 96"	390	402	413	371

Note: Not available in Mercury Cherry

ACCESSORIES: MOLDINGS

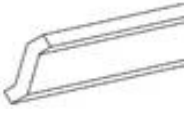
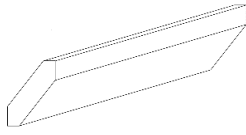
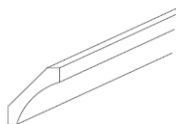
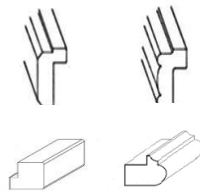
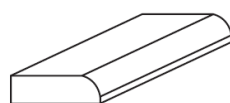
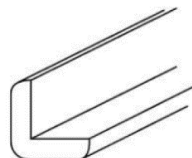
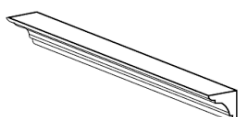
Crown Molding			MERCURY	JUPITER	VENUS	NEPTUNE
	CM8 2 7/8"	2 7/8"Tx 96"L	128	132	136	122
	CM8 4"	4"Tx 96"L	188	194	199	179
Shaker Crown Molding			MERCURY	JUPITER	VENUS	NEPTUNE
	ACM8	3 1/4"Tx 96"L	148	152	157	141
Curved Crown Molding			MERCURY	JUPITER	VENUS	NEPTUNE
	CM8-A	3 3/4"Tx 96"L	188	194	N/A	179
Note: Not available in MC and VI						
Light Rail			MERCURY	JUPITER	VENUS	NEPTUNE
	LRM8-SH	2 1/4"Tx 96"L	260	268	N/A	247
	LRM8	2"Tx 96"L	N/A	N/A	276	N/A
	LRM8-SH Small	1 1/2"Tx 3/4"W x 96"L	117	117	N/A	111
	LRM8 Small	1 1/2"Tx 3/4"W x 96"L	N/A	N/A	124	N/A
Scribe Molding			MERCURY	JUPITER	VENUS	NEPTUNE
	SM8	1/4" x 3/4" x 96"	44	45	47	42
Outside Corner Molding			MERCURY	JUPITER	VENUS	NEPTUNE
	OC8	3/4" x 3/4" x 96"	84	87	89	80
Inside Corner Molding			MERCURY	JUPITER	VENUS	NEPTUNE
	ICM8	3/4" x 3/4" x 96"	92	95	98	87

Quarter Round Molding			MERCURY	JUPITER	VENUS	NEPTUNE
-----------------------	--	--	---------	---------	-------	---------

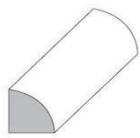

QR8	3/4" x 3/4" x 96"	92	95	98	87
-----	-------------------	----	----	----	----

Toe Kick			MERCURY	JUPITER	VENUS	NEPTUNE
----------	--	--	---------	---------	-------	---------

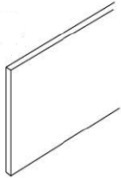

TK 1/4	1/4" x 4-1/2" x 96"	60	62	64	57
--------	---------------------	----	----	----	----

Furniture Base			MERCURY	JUPITER	VENUS	NEPTUNE
----------------	--	--	---------	---------	-------	---------

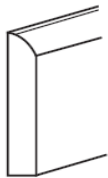

FBM	3/4" x 4-1/2" x 96"	216	222	229	205
-----	---------------------	-----	-----	-----	-----

ACCESSORIES: VALANCES AND PANELS

Arched Valance			MERCURY	JUPITER	VENUS	NEPTUNE
----------------	--	--	---------	---------	-------	---------



VAA31	6" W, 31" L	76	78	81	72
VAA37	6" W, 37" L	88	91	93	84
VAA49	8" W, 49" L	160	165	170	152

Scalloped Valance			MERCURY	JUPITER	VENUS	NEPTUNE
-------------------	--	--	---------	---------	-------	---------

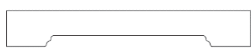

V37D	6" W 37" L	88	91	93	84
V43D	10" W 43" L	176	181	187	167

Dishwasher Panel			MERCURY	JUPITER	VENUS	NEPTUNE
------------------	--	--	---------	---------	-------	---------

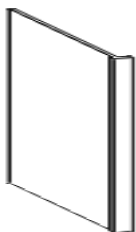

DWP	24" x 34 1/2" x 3" Filler	124	128	131	118
DWP6	24" x 34 1/2" x 6" Filler	170	N/A	N/A	N/A

Note: DWP6 is currently only available in MW

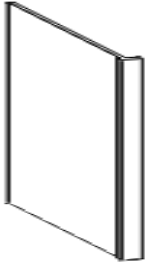
Refrigerator Panel			MERCURY	JUPITER	VENUS	NEPTUNE
	RP96	24" Width 96" Length 3/4" Filler 1.5" W	264	272	280	251

Refrigerator Panel 3/4"			MERCURY	JUPITER	VENUS	NEPTUNE
	RP96-3/4	24" Width 96" Length 3/4" Thickness	308	317	326	293
	RP 30*96-3/4	30" Width 96" Length 3/4" Thickness	388	400	411	369

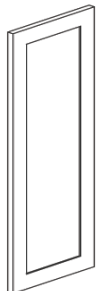
End Panels (Fake Door)			MERCURY	JUPITER	VENUS	NEPTUNE
	WEP1230	12" W 30" T	132	136	140	125
	WEP1236	12" W 36" T	140	144	148	133
	WEP1242	12" W 42" T	164	169	174	156
	BEP2430	24" W 30" T	220	227	233	209

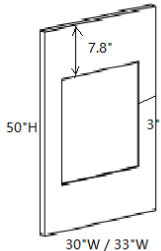
Cover Frame (For Oven Pantry)			MERCURY	JUPITER	VENUS	NEPTUNE
	OC30CF	30"x50"	264	272	280	264
	OC33CF	36"x50"	280	288	297	280

ACCESSORIES: POST, CORBEL & OTHER

Touch-Up Kit		MERCURY	JUPITER	VENUS	NEPTUNE
--------------	--	---------	---------	-------	---------



TUKIT

46

46

46

46

B15 Front Sample		MERCURY	JUPITER	VENUS	NEPTUNE
------------------	--	---------	---------	-------	---------

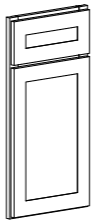

B15 Front Sample

156

156

156

156

Sample Door 15" x 12"		MERCURY	JUPITER	VENUS	NEPTUNE
-----------------------	--	---------	---------	-------	---------

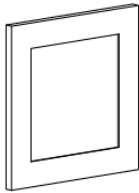

B15 Front Sample

28

28

28

28

LS Spinning Wood Disc		MERCURY	JUPITER	VENUS	NEPTUNE
-----------------------	--	---------	---------	-------	---------

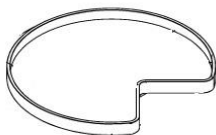

LS 36 Kit

252

252

252

252

LS 33 Kit

230

230

230

230

Post		MERCURY	JUPITER	VENUS	NEPTUNE
------	--	---------	---------	-------	---------

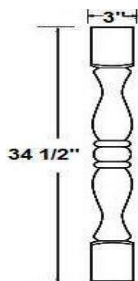

TP3

3" W
34 1/2" T

220

227

233

209

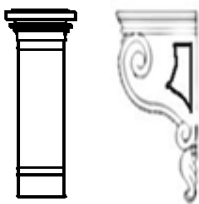
Corbel		MERCURY	JUPITER	VENUS	NEPTUNE	
						
	CBL - T3	4 3/4" W	280	288	297	266
		5 1/5" D 10 1/4" T				

GLASS DOOR CABINET

Glass Door Cabinets		MERCURY	JUPITER	VENUS	NEPTUNE	
	W1230MD	2"W X 30"T x 12"l	352	363	373	334
	W1236MD	2"W X 36"T x 12"l	410	422	435	390
	W1242MD	2"W X 42"T x 12"l	450	464	477	428
	W1530MD	5"W X 30"T x 12"l	412	424	437	391
	W1536MD	5"W X 36"T x 12"l	456	470	483	433
	W1542MD	5"W X 42"T x 12"l	540	556	572	513
	W1830MD	8"W X 30"T x 12"l	484	499	513	460
	W1836MD	8"W X 36"T x 12"l	560	577	594	532
	W1842MD	8"W X 42"T x 12"l	640	659	678	608
	W2430MD	4"W X 30"T x 12"l	576	593	611	547
	W2436MD	4"W X 36"T x 12"l	672	692	712	638
	W2442MD	4"W X 42"T x 12"l	812	836	861	771
	W3030MD	0"W X 30"T x 12"l	704	725	746	669
	W3036MD	0"W X 36"T x 12"l	816	840	865	775
	W3042MD	0"W X 42"T x 12"l	1000	1030	1060	950
	W3630MD	6"W X 30"T x 12"l	820	845	869	779
	W3636MD	6"W X 36"T x 12"l	960	989	1018	912
	W3642MD	6"W X 42"T x 12"l	1176	1211	1247	1117
WDC2430MD	4"W X 30"T x 12"l	648	667	687	616	
WDC2436MD	4"W X 36"T x 12"l	756	779	801	718	
WDC2442MD	4"W X 42"T x 12"l	848	873	899	806	

Note: Clear Glass with interior finished cabinet. Price includes glass door and cabinet

ROLL - OUT TRAYS

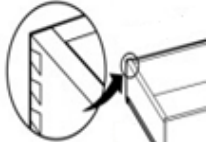
Roll - Out Trays	MERCURY	JUPITER	VENUS	NEPTUNE
 ROT-15	112	112	112	112
ROT-18	136	136	136	136
ROT-24	164	164	164	164
ROT-30	196	196	196	196

Note: Custom size ROT can be made, please call for more information

TRASHCAN

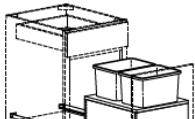
Trashcan	MERCURY	JUPITER	VENUS	NEPTUNE
 TRASHCAN-B15	360	360	360	360
TRASHCAN-B18	440	440	440	440
TRASHCAN-B21	440	440	440	440

Note: TRASHCAN-15= Single Trashcan

TRASHCAN-18&21= Double Trashcan

Price does not include cabinet

Modifications		
Items	Description	Net Price
Increase Depth on	Bridge Wall Cabinet up to 24"	\$75
	Regular Wall Cabibet	Call for Price
Cut Depth on	Base Cabinet with 0 Drawer	\$50
	Base Cabinet with 1 Drawer	\$120
	Base Cabinet with 2 Drawers	\$190
	Base Cabinet with 3 Drawers	\$260
	Drawer Box (Drawer Glides Included)	\$70
	Roll Out Tray (Glides Included)	\$70
	Wall Cabinet	\$50
	Pantry Cabinet	\$75
Farm Sink	Make SB33 to Farm Sink Base 33"	Call for Price
Base Microwave	Make Base Cabinet to Base Microwave Cabinet	\$100
Full Height Door	Make Base Cabinet to Base Full Hight Door Cabinet	Call for Price
Wood Shelf	Regular Cabinet Shelf Size	\$20/EACH



FGM
CABINETRY LLC

FGM Cabinetry LLC.
www.fgmcabinetry.com
908-583-5707
Info@fgmcabinetry.com
1819 W. Edgar Road,
Linden, NJ, 07036