

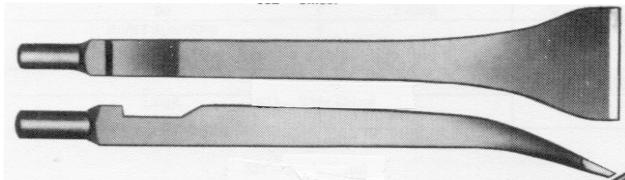

KIRBY SALES, INC.

www.kirbysalesinc.com

*Chipping Hammers, Paving
Breakers, Chisels and Accessories*

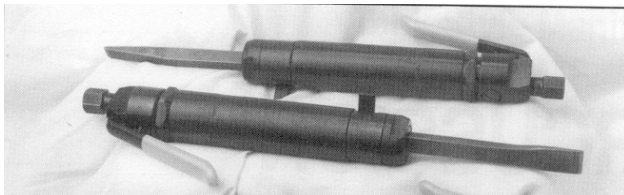

Main Office

P. O. Box 265

Pomona Park, Florida 32181

(386) 649-9532

Lori Kirby (386) 546-2109

sales.kirbysalesinc@gmail.com

www.kirbysalesinc.com

Quality Tools and Parts Competitively Priced!

Serving Our Customers Since 1980

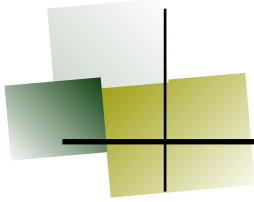

**TO ORDER CALL: (386) 649-9532
WWW.KIRBYSALESINC.COM**

**All shipments delivered via UPS
Ground unless otherwise requested.**

**Proudly serving our customers
since 1980.**

To Place an Order Call:

Lori Kirby

Sales (386) 649-9532

Cell (386) 546-2109

Gary Kirby

Cell (386) 983-0114

Email:

sales.kirbysalesinc@gmail.com

Visit Us On The Web:

www.kirbysalesinc.com

Call for Current Prices

**Master Card, Visa and Purchase orders
are Accepted**

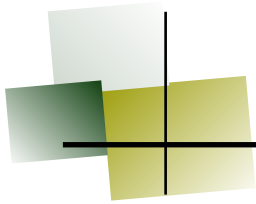

TO ORDER CALL: (386) 649-9532
WWW.KIRBYSALESINC.COM

Chipping Hammer



Three sizes: 2", 3" and 4"
stroke pistons.

Available with round
bushings.

High quality alloy steel
barrel.

SPECIFICATIONS:

Item #	Piston Diameter	Piston Stroke	# of Impacts Per Minute	Hose Size	Overall Length	Air Consumption	Weight
KSI1000-1	1-1/8"	2"	2100	1/2"	16-1/4"	32 CFM	15.7#
KSI1000-2	1-1/8"	3"	1650	1/2"	17-23/32"	33 CFM	16.7#
KSI1000-4	1-1/8"	4"	1375	1/2"	19-7/32"	34 CFM	18.1#

Chipping Hammer Parts

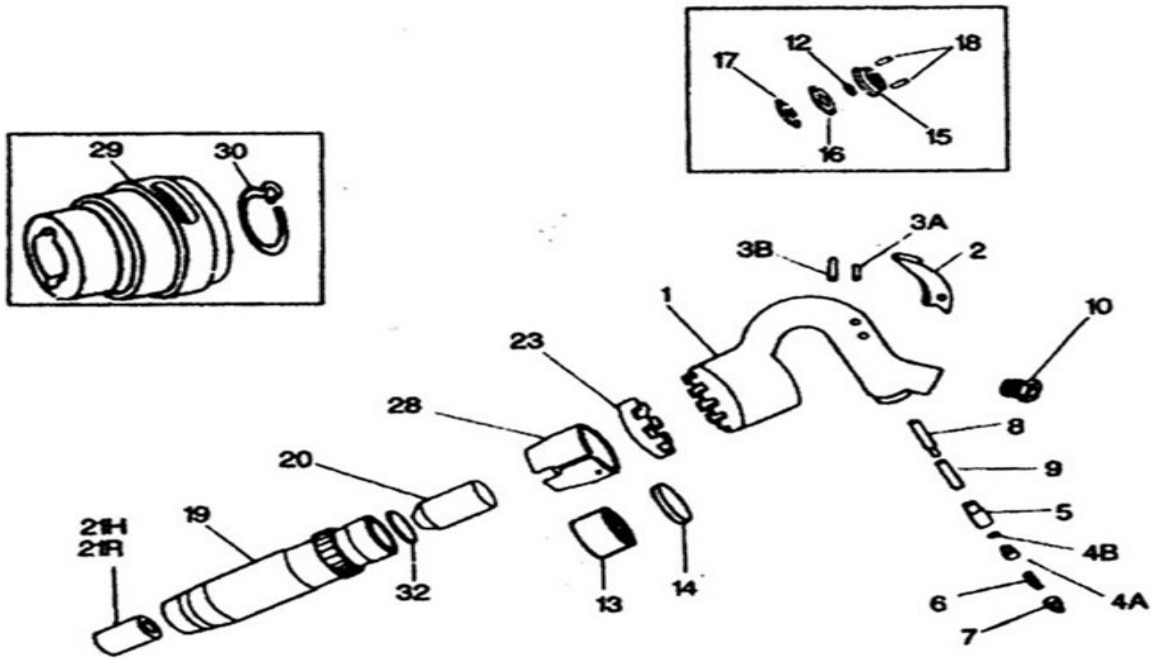

Ref#	Item #	Description	Ref#	Item #	Description
1	KSI1011	Handle for Ring Valve	15	KSI1013	Lid Upper Valve Case
2	KSI1010	Throttle Lever	16	KSI1015	Middle Valve Seat
3A	KSI1009	Throttle Lever Pin	17	KSI1016	Lid Lower Valve Case
3B	KSI1017	Pin Stop	18	KSI1018	Dowel Pin
4A	KSI1003	Throttle Valve	20	KSI1020	Piston 2"
4B	KSI1005	Throttle Valve O-Ring	20	KSI1021	Piston 3"
5	KSI1004	Throttle Valve Bushing	21R	KSI1030	Round Bushing
6	KSI1002	Throttle Valve Spring	23	KSI1027	Lock
7	KSI1001	Throttle Valve Plug	28	KSI1028	Shield Lock
8	KSI1006	Push Pin	29	KSI1029	Sleeve Retainer
9	KSI1007	Push Pin Bushing	30	KSI194-2-N	Spring Lock Coil
10	KSI1008	Permanent Bushing	32	KSI1088	Cylinder O-Ring
12	KSI1014	Valve		KSI1087	Swivel Connector

4-Bolt Chipping Hammer



Available with a 2", 3"
and 4" stroke piston.

Four bolt design for
longer life of handle.

High quality alloy steel
barrel.

Available with round
bushings.

SPECIFICATIONS:

Item #	Piston Diameter	Piston Stroke	# of Impacts Per Minute	Hose Size	Overall Length	Air Consumption	Weight
KSI1000-3-2	1-1/8"	2"	2100	1/2"	14-1/2"	32-34 CFM	18#
KSI1000-3	1-1/8"	3"	1650	1/2"	15-1/2"	33-35 CFM	19#
KSI100-3-4	1-1/8"	4"	1375	1/2"	16-1/2"	34-36 CFM	20#

Long Reach Heavy Hitter Chipping



This tool hits twice as hard as a regular scaler. It has a 2" stroke on the piston compared to 1-1/4" on the KSI-9000 scaler.

48" or 60" Extension lets the scaler get into tight places, not the employee.

Live Snap Handle for ease of use.

SPECIFICATIONS

Item #	Throttle Type	Bore	Stroke	Weight	Overall Length	Min. Hose Size	Inlet Size
KSI-20000	Lever	15/16"	2"	14 Lbs.	48" or 60"	1/2" sq.	1/2"

LR Heavy Hitter CH Parts

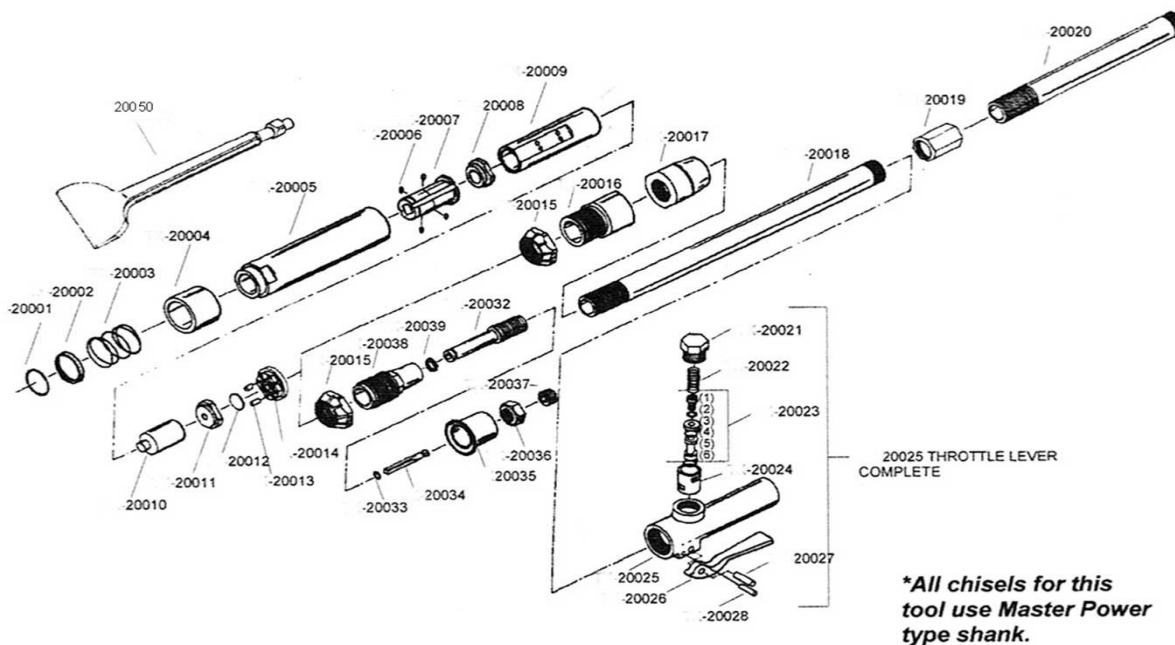

Part #	Description	Part #	Description
KSI20001	Retainer Clip	KSI20019	Extension Coupling
KSI20002	Retainer Washer	KSI20020	1' Pipe Extension
KSI20003	Retainer Spring	KSI20021	Throttle Valve Cap
KSI20004	Retainer	KSI20022	Throttle Valve Spring
KSI20005	Barrel	KSI20023	Throttle Valve Assembly Consisting of:
KSI20006	5/16" Steel Balls (4)		(1) Screw, (2) Lock washer,
KSI20007	Tools Nose		(3) TV Cap, (4) O Ring Face,
KSI20008	Sleeve Nose		(5) TV Body, (6) O Ring for Stem
KSI20009	Liner	KSI20024	Throttle Valve Bushing
KSI20010	Piston	KSI20025	Live Handle Complete
KSI20011	Lower Valve Block	KSI20026	Throttle Lever
KSI20012	Flutter Valve	KSI20027	Stop Pin
KSI20013	Dowel Pins 1/8" x 7/16" (2)	KSI20028	Lever Pin
KSI20014	Upper Valve Block	KSI00994	Screened Inlet Bushing 1/2" to 3/8"
KSI20015	Backhead Lock Ring		Chisels Available
KSI20016	Backhead Block	KSI20050	3" W x 7 1/2" L Flat Chisel
KSI20017	Backhead Locking Pipe Nut		
KSI20018	2' Pipe Extension		

Throttle Lever Chisel / Needle Scaler



Tools have been proven in thousands of applications.

Tens of thousands of these tools are in use.

Completely convertible from chisel to needle scaler and vice versa.

Chisel Scaler

Item #	Throttle Type	Bore	Stroke	Blows per Minute	Weight less Chisel	Overall Length	Shank Type	Inlet Size
KSI9000	Lever	1"	1-1/8"	4600	3 Lbs. 10 oz.	10 1/2"	1/2" sq.	1/4" NPT

Needle Scaler

KSI9000-2	Lever	1"	1-1/8"	4600	5 Lbs. 10 oz.	10 1/2"	1/2" sq.	1/4" NPT
------------------	-------	----	--------	------	---------------	---------	----------	----------

Long Reach TL Chisel / Needle Scaler



The same dependable Throttle Lever Needle / Chisel Scaler, but with a 36" Pipe Extension and a Live Snap Handle

36" Extension lets the scaler get into tight places, not the employee.

Live Snap Handle for ease of use.

Completely convertible from chisel to needle scaler and vice versa.

Item #	Throttle Type	Bore	Stroke	Blows per Minute	Weight less Chisel	Overall Length	Shank Type	Inlet Size
KS19000-1	Lever	1"	1-1/8"	4600	7 Lbs. 10 oz.	50 1/2"	1/2" sq.	1/4" NPT

TL Needle / Chisel Scaler Schematic

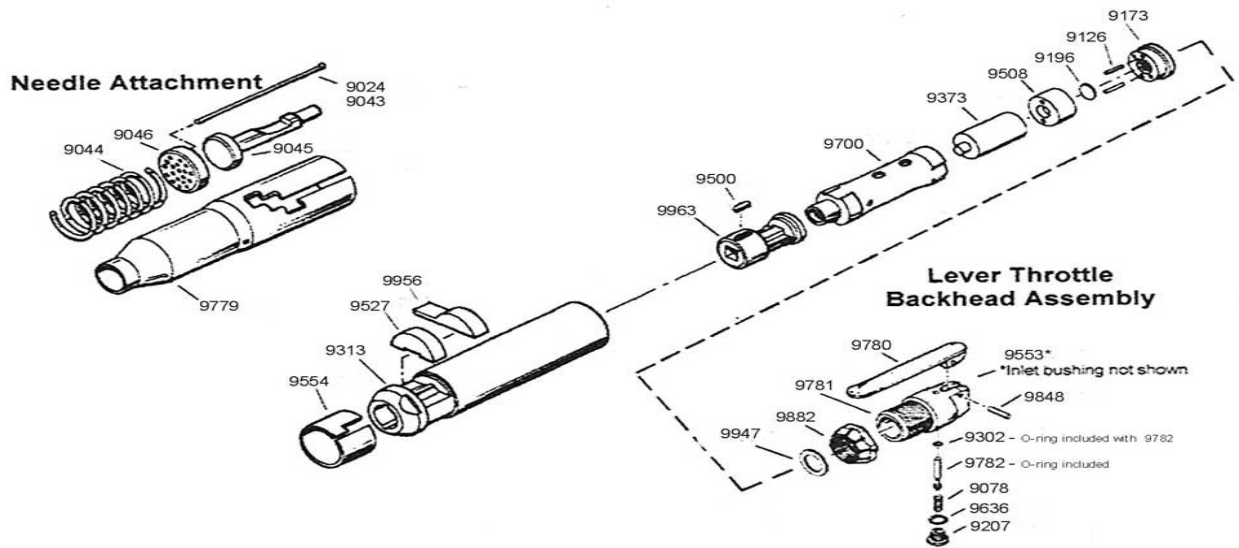

Ref#	Item #	Description	Ref#	Item #	Description
1	KSI9882	Backhead Locking Ring	28	KSI9500	Tool Nose Key
10	KSI9947	Backhead Spacer	29	KSI9963	Tool Nose
11	KSI9780	Throttle Lever (Thick)	30	KSI9700	Barrel Sleeve
13	KSI9781	Backhead Lever Type (Thick)	31	KSI9044	Needle Holder Spring
15	KSI9782	Throttle Valve	32	KSI9046	Needle Holder
16	KSI9078	Throttle Valve Spring	33	KSI9045	Needle Driver
17	KSI9636	Throttle Valve Cap Gasket	34	KSI9779	Needle Tube
18	KSI9207	Throttle Valve Cap	35	KSI9554	Clip
19	KSI9848	Throttle Lever Pin		KSI9024	Needle 7" (19)
20	KSI9527	Buffer		KSI9043	Needle 5" (19)
21	KSI9956	Retainer		KSI9322	Needle Attachment (Includes 31, 32, 33, 34, 36)
22	KSI9373	Plunger		KSI9109	Valve Block Complete (Includes 23, 24, 25, 26)
23	KSI9508	Valve Block		KSI9851	Backhead Complete (Includes 1, 5, 11, 13, 15, 16, 17)
24	KSI9196	Valve			
25	KSI9126	Valve Block Dowel Pin		KSI00159	Live Handle Complete (LR Only)
26	KSI9173	Valve Block Button		KSI00005	Blank Backhead (LR Only)
27	KSI9313	Barrel			

Scaler Chisels

Patco, AJAX, Cleco, Rotor, ARO-CP9356, Texas Pneumatic

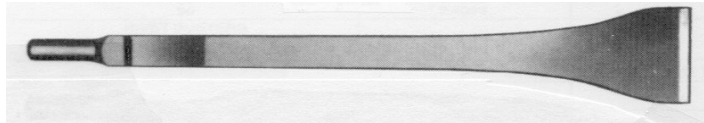

Item #	Description
KSI393-07	7" x 1 3/8" Wide Flat
KSI393-12	12" x 1 3/8" Wide Flat
KSI393-18	18" x 1 3/8" Wide Flat



Item #	Description
KSI394-07	7" x 1 3/8" Wide Angle
KSI394-12	12" x 1 3/8" Wide Angle
KSI394-18	18" x 1 3/8" Wide Angle

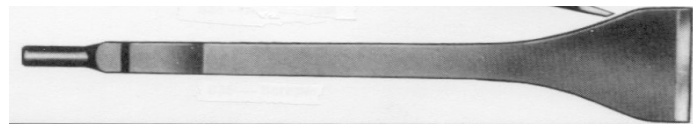

Item #	Description
KSI390-07	7" x 2 1/2" Wide Scraper
KSI390-12	12" x 2 1/2" Wide Scraper
KSI390-07HD	7" x 2 1/2" Wide Scraper with Heavy Duty Shank
KSI390-12HD	12" x 2 1/2" Wide Scraper with Heavy Duty Shank
KSI390-07W3	7" x 3" Wide Scraper
KSi390-12W3	12" x 3" Wide Scraper

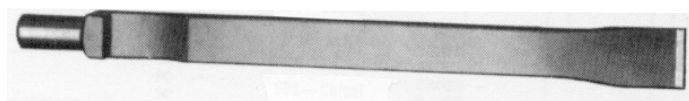

Item #	Description
KSI392-07	7" x 3/4" Wide Scraper
KSI392-12	12" x 3/4" Wide Scraper
KSI392-18	18" x 3/4" Wide Scraper

Other Chisel Lengths and Widths are available. Call us and we can discuss exactly what your needs are!

Scaler Chisels

Jet, Chicago Pneumatic, Keller, Thor, Rockwell, Ingersoll Rand (172 & 182)

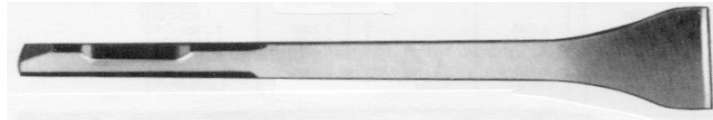

Item #	Description
KSI397-07	7" x 1 3/8" Wide Flat
KSI397-12	12" x 1 3/8" Wide Flat
KSI397-18	18" x 1 3/8" Wide Flat



Item #	Description
KSI398-07	7" x 1 3/8" Wide Angle
KSI398-12	12" x 1 3/8" Wide Angle
KSI398-18	18" x 1 3/8" Wide Angle

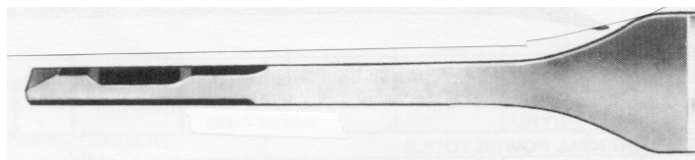

Item #	Description
KSI399-07	7" x 2 1/2" Wide Scraper

Chipping Hammer Chisels

Round Shank, Oval Collar 1 Inch Wide Blade

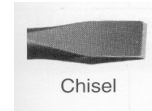

Item #	Description
KSI303-09	9" x 1" Wide 680 Flat
KSI303-12	12" x 1" Wide 680 Flat

Round Shank, Oval Collar 1 1/2 Inch Wide Blade



Item #	Description
KSI325-09	9" x 1 1/2" Wide 680 Flat
KSI325-12	12" x 1 1/2" Wide 680 Flat

Other Chisel Lengths and Widths are available. Call us and we can discuss exactly what your needs are!

Round Shank, Oval Collar 2 Inch Wide Blade



Item #	Description
KSI323-09	9" x 2" Wide 680 Flat
KSI323-12	12" x 2" Wide 680 Flat
KSI323-18	18" x 2" Wide 680 Flat

Long Reach Hammer Chisel

Master Power Shank, 3 Inch Wide Blade for Long Reach Chisel Hammer

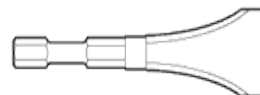

Item #	Description
KSI20050	9" x 3" Wide LR Chisel

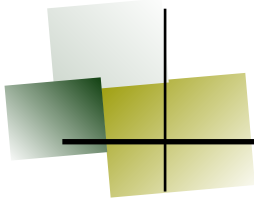

TO ORDER CALL: (386) 649-9532
WWW.KIRBYSALESINC.COM

**Round Shank, Oval Collar
1 Inch Wide Blade**

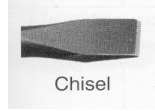

Chisel

Item #	Description
KSI303-18	18" x 1" Wide 680 Flat

**Round Shank, Oval Collar
1 1/2 Inch Wide Blade**



1.5" Wide Chisel

Item #	Description
KSI325-18	18" x 1 1/2" Wide 680 Flat

**Round Shank, Oval Collar
2 Inch Wide Blade**



2" Wide Chisel

Item #	Description
KSI323-36	36" x 2" Wide 680 Flat

**Round Shank, Oval Collar
Moil Point**

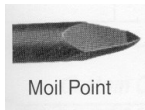

Moil Point

Item #	Description
KSI313-9	9" 680 Moil Point
KSI315-12	12" 680 Moil Point
KSI315-18	18" 680 Moil Point

**Round Shank, Round Collar
2 Inch Wide Blade**

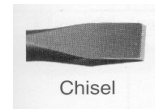

Chisel

Item #	Description
KSI405	9" x 1" Wide 680 Flat
KSI407	12" x 1" Wide 680 Flat

**Hex Shank, Oval Collar 1
Inch Wide Blade**

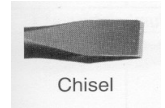

Chisel

Item #	Description
KSI304-09	9" x 1" Wide 580 Flat
KSI304-12	12" x 1" Wide 580 Flat
KSI304-18	18" X 1" Wide 580 Flat

**Hex Shank, Oval Collar 1 1/2
Inch Wide Blade**

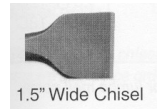

1.5" Wide Chisel

Item #	Description
KSI326-09	9" x 1 1/2" Wide 580 Flat
KSI326-12	12" x 1 1/2" Wide 580 Flat
KSI326-18	18" X 1 1/2" Wide 580 Flat

**Hex Shank, Oval Collar 2
Inch Wide Blade**

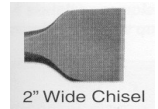

2" Wide Chisel

Item #	Description
KSI324-09	9" x 2" Wide 580 Flat
KSI324-12	12" x 2" Wide 580 Flat
KSI324-18	18" X 2" Wide 580 Flat

**Hex Shank, Oval Collar
Moil Point**

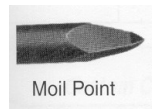

Moil Point

Item #	Description
KSI314-09	9" 580 Moil Point
KSI316-12	12" 580 Moil Point
KSI316-18	18" 580 Moil Point

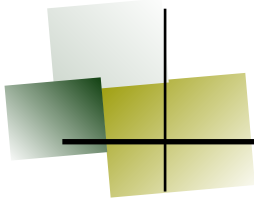

TO ORDER CALL: (386) 649-9532
WWW.KIRBYSALESINC.COM

Filter, Regulator and Lubricators

Mounted In-Line

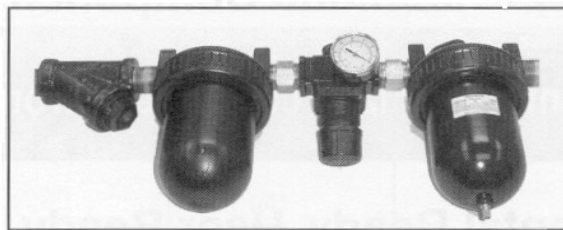

Assembled Part #	Particulate Filter #	Regulator #	Lubricator #	Max Flow	NPT
KSIFRL 1/2"	KSIF384-FW	KSIR374G	KSIL484W	165 CFM	1/2"
KSIFRL 3/4"	KSIF329-06-FW	KSIR376G	KSIL4106W	175 CFM	3/4"
KSIFRL 1"	KSIF329-08-FW	KSIR378G	KSIL4108W	175 CFM	1"
KSIFRL 1 1/2"	KSIF329-12-FW	KSIR3912G	KSIL4112W	175 CFM	1 1/2"

The above units come assembled with a Y strainer and metal bowls

FW—Internal Float Drain, G—with Gauge, W—with sight disk