

DESIGN PHASE

PRELIMINARY PLAN

BID SET PLAN 6/18/18

FINAL PLAN 10/19/22

REVISION 1

REVISION 2

REVISION 3



188 COUNTY ROAD U
RIVER FALLS, WI. 54022
715-425-1245

G.M.T.Z. LLC
SOUTH POINTE UNIT "C"

LOT 45 & 47

CONTRACTOR/OWNER

ARROW BUILDING CENTER OWNS ALL RIGHTS, INCLUDING, BUT NOT LIMITED TO, COPYRIGHTS OF THE BLUEPRINTS OR FLOOR PLANS CREATED UNDER THIS AGREEMENT. ARROW BUILDING CENTER LICENSES THE BLUEPRINT OR FLOOR PLAN TO THE CUSTOMER FOR PURPOSES OF CONSTRUCTING THE STRUCTURE DEPICTED IN THE BLUEPRINT OR FLOOR PLAN. THE CUSTOMER SHALL NOT DUPLICATE, DISTRIBUTE TO THE PUBLIC, OR DISPLAY THIS BLUEPRINT OR FLOOR PLAN. THIS BLUEPRINT OR FLOOR PLAN IS NOT A WORK MADE FOR HIRE AS DEFINED UNDER 17 U.S.C. SECTION 101.

ALTHOUGH EVERY EFFORT HAS BEEN MADE IN PREPARING THESE PLANS AND CHECKING THEM FOR ACCURACY, CONTRACTOR/HOMEOWNER MUST VERIFY GRADES, FOOTING SIZES, ELEVATIONS, ROUGH OPENINGS, HEADER AND BEAM SIZES AND ALL OTHER DIMENSIONS AND SPECS AND BE RESPONSIBLE FOR THE SAME.

SCALE

DRAWN BY
RKB

JOB NUMBER

SHEET NUMBER

A2

SHEET 2 OF 4

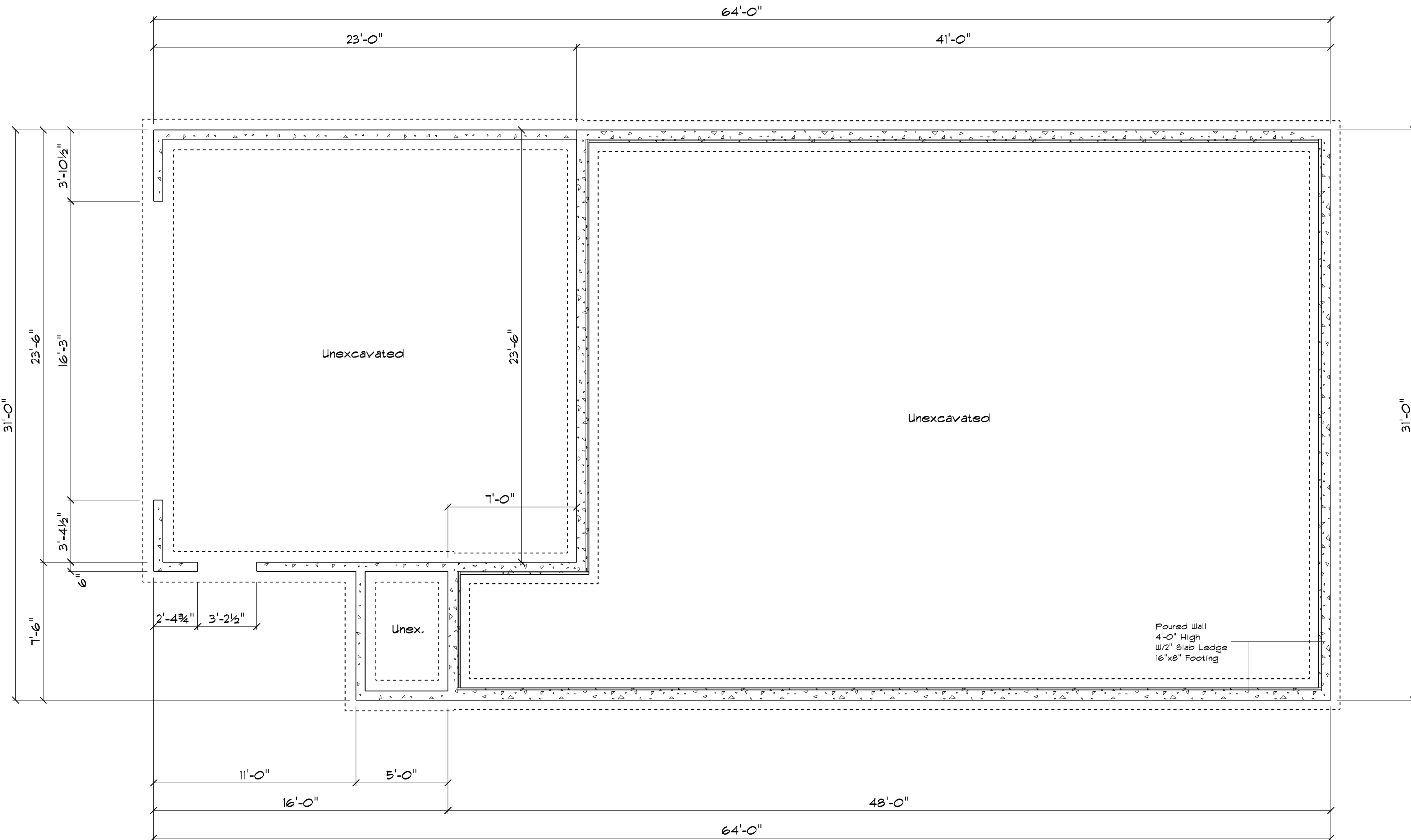

1 Foundation Plan
Scale 1/4" = 1'-0"