

DANMK INDUSTRY CO., LTD

KCT-E13series Opening and closing current transformer

一、Characteristics

- 1、 Split core design with low core loss and high precision;
- 2、 No need to disconnect the busbar, it is easy to install and does not affect the normal use of electricity by customers.;
- 3、 Beautiful appearance, small size and light weight;
- 4、 Buckle opening and closing structure, easy to open and close

二、typical application:

- 1、 Features: General measurement and protection in power systems for mobility or space-constrained or uninterrupted power systems。
- 2、 use: Power instrumentation, electronic multi-function energy meter and on-site calibrator, instrumentation measurement and protection。

三、Electrical characteristics:

- 1、 Device maximum voltage: 720V
- 2、 Power frequency withstand voltage: 4000V50Hz /1 min(1mA)
- 3、 Primary rated current: 0-1000A
- 4、 Secondary rated current: 5A 或 mA
- 5、 frequency: 50/60Hz

四、Size comparison table:

model	A	B	C	D	E	F
KCT- 10	10	26	23.5	14	17	23
KCT- 16	16	32	26	19	19	30
KCT- 24	24	36.5	41	18	29	44
KCT- 36	36	40	48.5	21.5	37	55.5
KCT- 48	48	46	54.5	21	42	66

五、Basic parameters (Secondary rated current : 5A):

Model	Primary rated current (A)	Secondary rated current (A)	load (VA)		
			0.5S level	0.5 level	1 level
KCT- 24	100	5	/	/	0.5
	150	5	/	/	0.5
	200	5	/	/	0.5
KCT- 36	200	5	/	2.5	5
	250	5	/	2.5	5
	300	5	0.5	2.5	5
	400	5	0.5	2.5	5
	500	5	0.5	2.5	5
KCT- 48	600	5	0.5	2.5	5
	800	5	2.5	5	10
	1000	5	2.5	5	10

Secondary rated current (mA level) :

model	Current range	Maximum continuous current	Load Resistance	Accuracy level
KCT- 10	0~60A	75A	RL=10Ω	1
KCT- 16	0~100 A	120A	RL=10Ω	0.5
KCT- 24	0~200 A	250A	RL=10Ω	0.5
KCT- 36	0~500	600A	RL=10Ω	0.5

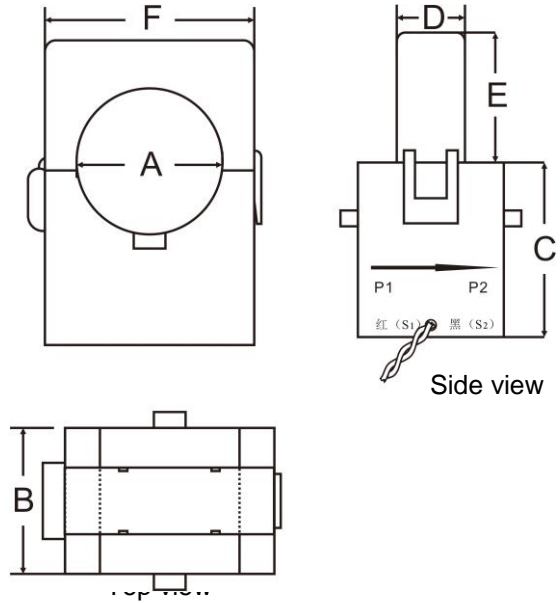

	A			
KCT- 48	0~1000A	1200A	RL=10Ω	0.2

Add: Rm.2610 Block B World Trade Building No. 66 Dongguan Zhengjie,Xian China Zip:710048
Tel:0086-29-82401929 , Fax:029-82293526 , whatsapp: 013572266768
e-mail:wping19@gmail.com, WFL89@163.com