

## SENSOR APPLICATIONS FOR SECURITY

In general, the most important parameter that determines the character of the machine, especially in process machines, is the physical and chemical properties of the material that will be processed on the machine. Materials with wood and its derivatives are processed in Yemmak wood pellet mills. Because of its chemical properties, Wood has hydrogen and carbon elements in its structure. For this reason, although the self-combustion temperature is around 270 °C, in the event of any flame or spark, this temperature comes to much lower degrees.

Therefore, the temperature in the pressing area must be kept under control. With special temperature sensors mounted in the eccentric shaft where the bearings are bearing, the machine protects itself when it controls the ambient temperature and rises above the set value.



## IMPROVED AUTOMATIC LUBRICATION SYSTEM

As the machine works with heavy vibration and under irregular loads, regular lubrication of bearing supports is essential. The automatic lubrication system in the machine eliminates the need for an operator and specially designed lubricant return grooves provide the appropriate amount of lubricant. The lubrication system can be controlled online via the operator panel.

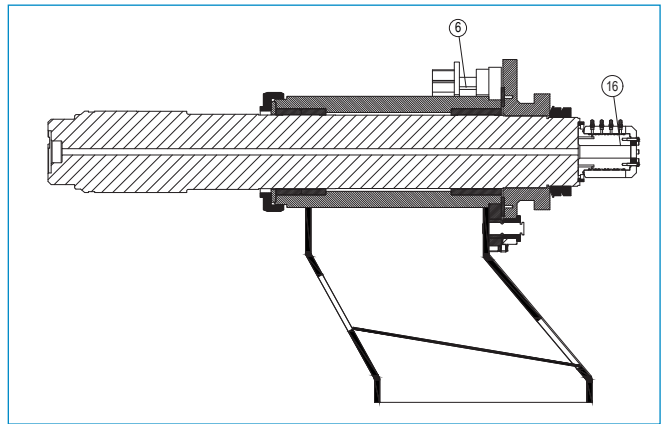
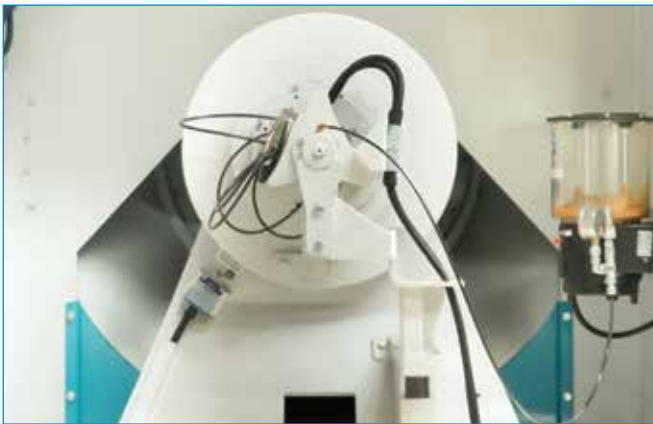

## DESIGN WITH INCREASED STRENGTH AND ROBUSTNESS

Wood and wood product pelleting can create complications such as irregular impact loads and heavy vibrational impacts on the machinery. The bearing supports and die connections, which generally malfunction due to mechanical deformations, are cast from forged steel and with high safety coefficients to meet strength enhancement targets.

