

# OVERALL UTILITY PLAN

AMHERST TOWNSHIP, COUNTY OF LORAIN, STATE OF OHIO

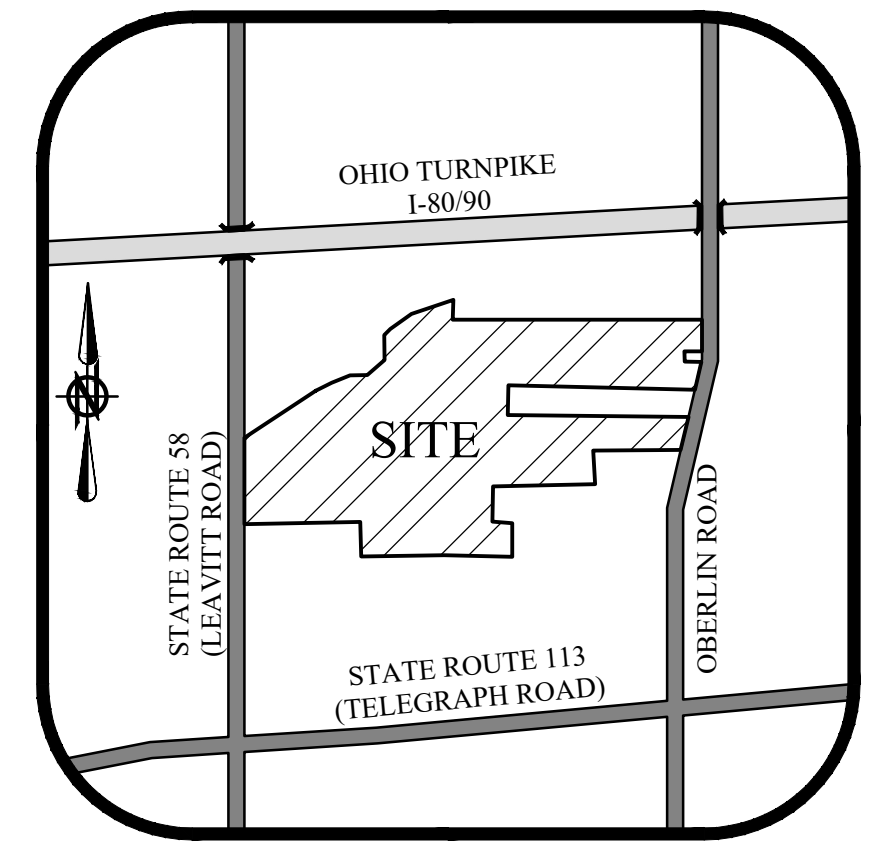

LOCATION MAP  
-NOT TO SCALE-

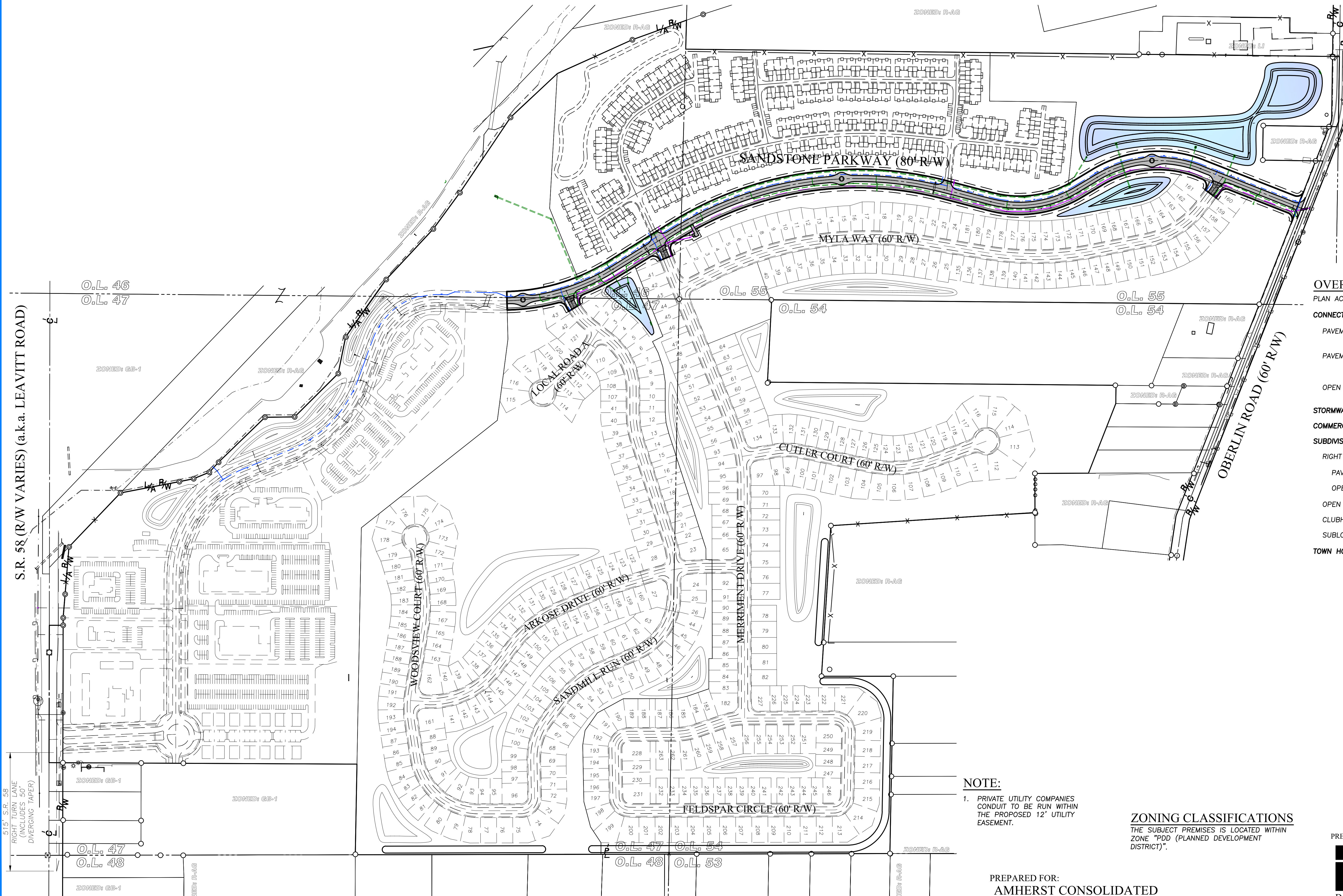

**OVERALL BREAKDOWN**

PLAN ACREAGE	260.6 ACRES
<b>CONNECTOR ROAD AREA (PHASE 1 &amp; 2)</b>	<b>13.5 ACRES</b>
PAVEMENT/PATH AREA (PHASE 1)	3.2 ACRES
ROADWAY LENGTH (PHASE 1)	3,655 L.F.
PAVEMENT/PATH AREA (PHASE 2)	3.1 ACRES
ROADWAY LENGTH (PHASE 2)	3,399 L.F.
OPEN SPACE AREA	7.2 ACRES
<b>STORMWATER MANAGEMENT BLOCK</b>	<b>13.4 ACRES</b>
<b>COMMERCIAL AREA</b>	<b>54.3 ACRES</b>
<b>SUBDIVISION AREAS</b>	<b>147.5 ACRES</b>
RIGHT OF WAY AREA	20.1 ACRES
PAVEMENT/WALK AREA	12.0 ACRES
OPEN SPACE AREA	8.1 ACRES
OPEN SPACE AREA (BLOCKS)	55.3 ACRES
CLUBHOUSE AREA	1.8 ACRES
SUBLOT AREA	70.3 ACRES
<b>TOWN HOMES AREA (REDWOOD)</b>	<b>31.9 ACRES</b>

**NOTE:**  
1. PRIVATE UTILITY COMPANIES CONDUIT TO BE RUN WITHIN THE PROPOSED 12' UTILITY EASEMENT.

**ZONING CLASSIFICATIONS**  
THE SUBJECT PREMISES IS LOCATED WITHIN ZONE "PDD (PLANNED DEVELOPMENT DISTRICT)".

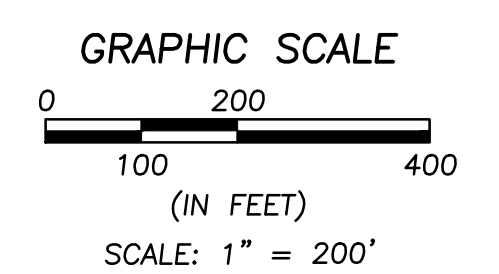

PREPARED FOR:  
AMHERST CONSOLIDATED  
PROPERTIES, LLC

PREPARED BY:  
**BRAMHALL**  
ENGINEERING AND SURVEYING COMPANY  
801 MOORE ROAD AVON, OHIO 44011  
(440) 934 - 7878 (440) 934 - 7879 FAX  
DATE PREPARED: 04-01-2022  
SHEET: 2 OF 4