

STANDARD INSTALL GUIDE

QUICK DEVICE

IMPORTANT NOTES

Before starting the Quick Device standard installation process please download the 'iGotcha GPS APP' from the Apple APP Store (for iPhones and iPads) or Google Play Store (for Android phones or tablets).

Login into your account and follow the 'APP instructions' (included in your box) to scan the GPS Device Bar-code and then scan the car VIN to register the device to the vehicle.

RECOMMENDED DEVICE PLACEMENT

Ideal locations are under the dash/near steering column, above the glove box area, center console (above gauge cluster).

iGotcha
Our Eye is Your Peace of Mind®

QUICK DEVICE STANDARD INSTALLATION

STEP 1

Remove the vehicle dash panel and locate the vehicle **OBDII** connector. Using a digital voltmeter, locate a 12V constant power output.

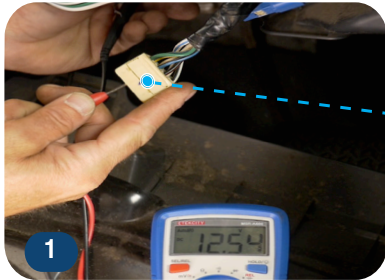

Voltmeter testing power output.

STEP 2

Locate the supplied power cable and identify the **RED** wire (power) and **BLACK** wire (ground). These are the only wires you will need for this install. You can trim the other wires to a shorter length.

Next install the **BLACK** ground wire, to do this strip the black wire and add a ring terminal. Attach this to the metal harness/frame of the car.

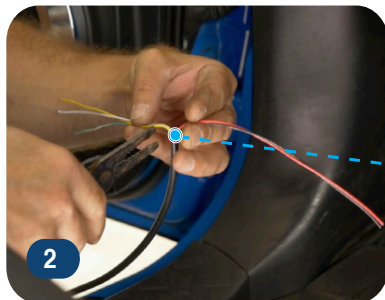

Trim the yellow, green and white wires down to the black protective wire cover.

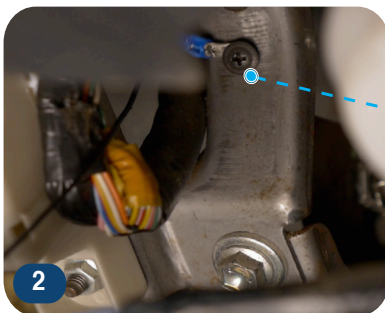

Ensure to attach black ground wire to metal.

STEP 3

Next connect the **RED** wire to the vehicle (12V) constant power wire. To ensure a valid connection we suggest that you solder the **RED** wire to the vehicle power (hot) wire. Then cover the connected wires with electrical tape.

Next plug the 14 pin power connection cable into the GPS tracker and connect the vehicle **OBDII** connector back into the vehicle.

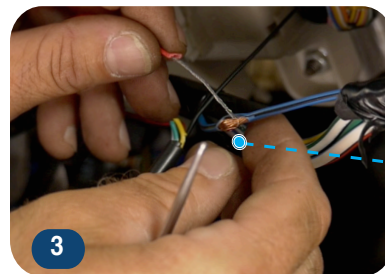

Connect the red wire to the vehicle constant power wire.

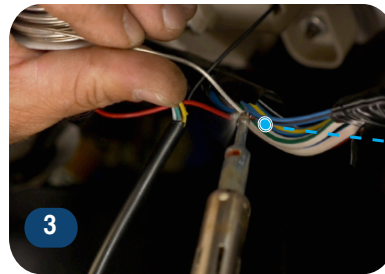

Solder wires to ensure a good connection.

Now that power is connected, the **GREEN LED** is solid and represents GPS. The **BLUE LED** begins blinking while searching for the Cellular signal. When acquired, the **BLUE LED** will pause then continue blinking in 3 second intervals while the **GREEN LED** blinks steadily.

At this point, return back to your phone or tablet and push the locate button. If the device responds with the correct location, mount the device **label side up** with a zip tie under the dash and replace any removed dash panels. Your installation is complete.

iGotcha
Our Eye is Your Peace of Mind®