

Tips to help you measure your room

- Draw a diagram of your room
- If your room isn't square, measure into any recesses, bay windows and include chimney breasts
 - If measuring for LVT flooring you will need the overall surface area
 - For carpet and vinyl flooring the longest width and length measurement is required
- Hallways, stairs and landing are a little bit more complicated. Pop into the store and select a carpet and we will happily arrange a measure for you.

Measuring for Carpets and Vinyls

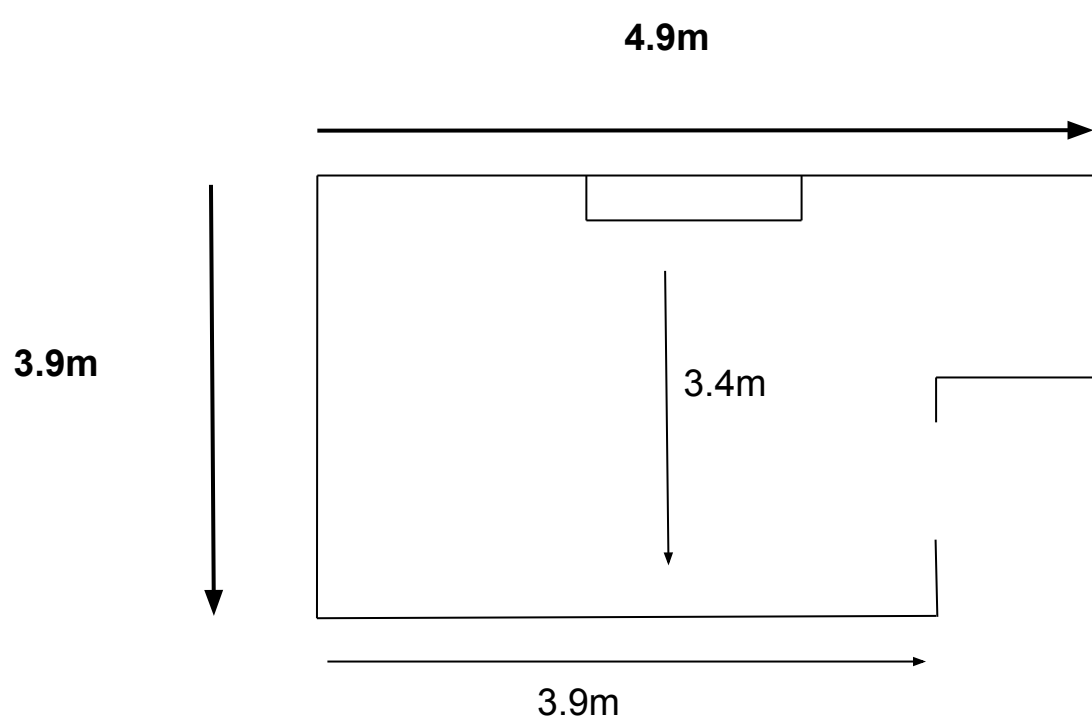

- When measuring your room for carpet and vinyl flooring make sure you measure the maximum width and length
- In the example shown the maximum width and length measurements are 3.5 x 4.9m.
- The standard width for carpets is 4m. However other widths may be available depending on the range. While vinyls widths start from 2m wide.
- The size of carpet required in the example would be 4.9 x 4m

Measuring for Luxury Vinyl Tiles

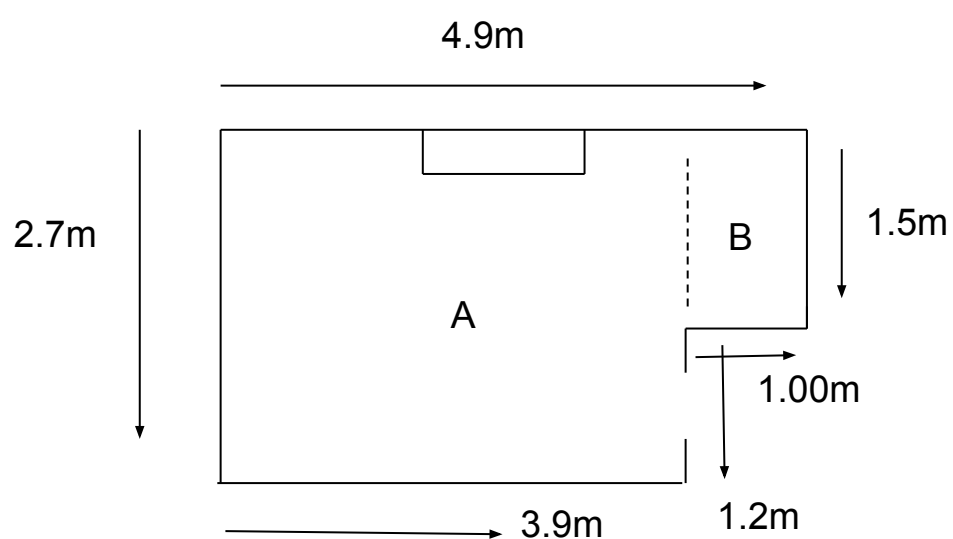

$$\begin{aligned} A &= 3.9 \times 2.7 \\ B &= 1 \times 1.5 \\ A+B &= 12.03 \text{ sqm} \end{aligned}$$

- When measuring a rectangular room for LVT flooring multiply the width and length to give you the square meterage of the room.
- Then add 10% to the size for wastage from cuts
- If the room is an awkward size measure the room in separate areas and then add them together to get the m²
- Add 10% to the size for wastage from cuts