

SECTION A-A

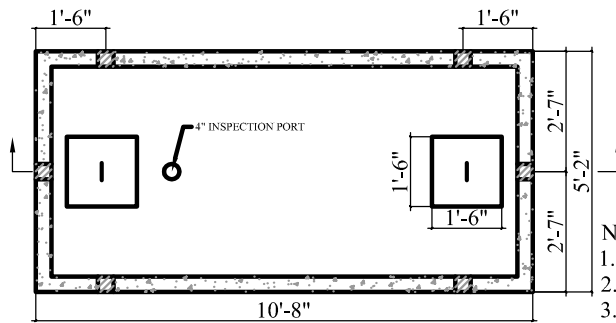

PLAN VIEW

NOTES:

1. CONCRETE STRENGTH = MIN. 4500 PSI
2. STRUCTURAL FIBER REINFORCEMENT
3. "POLYLOK" PIPE SEALS CAST IN TANK
4. MASTIC SEALANT IN TANK JOINT
5. TANKS CAN BE MODIFIED UPON REQUEST

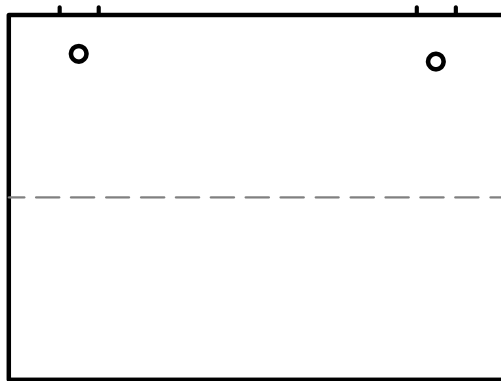

FRONT VIEW

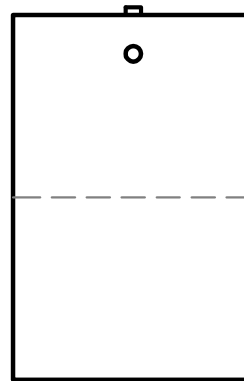

SIDE VIEW

APPROX. WEIGHT:

TOP = 7,500 lb  
 BOTTOM = 7,500 lb  
 TOTAL = 15,000 lb

GAL. PER IN = 28.31  
 ACTUAL GAL. TO OUTLET = 2,066  
 FULL CAPACITY = 2,406



CTJAMISON.COM

PH: 540-483-5944

2,000 Gal. Mid Seam Tank

Date

Feb 2016

Scale

Not To Scale