

AQUATOR 50ft FLYBRIDGE



MARINE



v-marine.com

AQUATOR 50ft FLYBRIDGE



MARINE



v-marine.com

AQUATOR 50ft FLYBRIDGE

MARINE



v-marine.com

AQUATOR 50ft FLYBRIDGE



MARINE



v-marine.com

AQUATOR 50ft FLYBRIDGE

MARINE

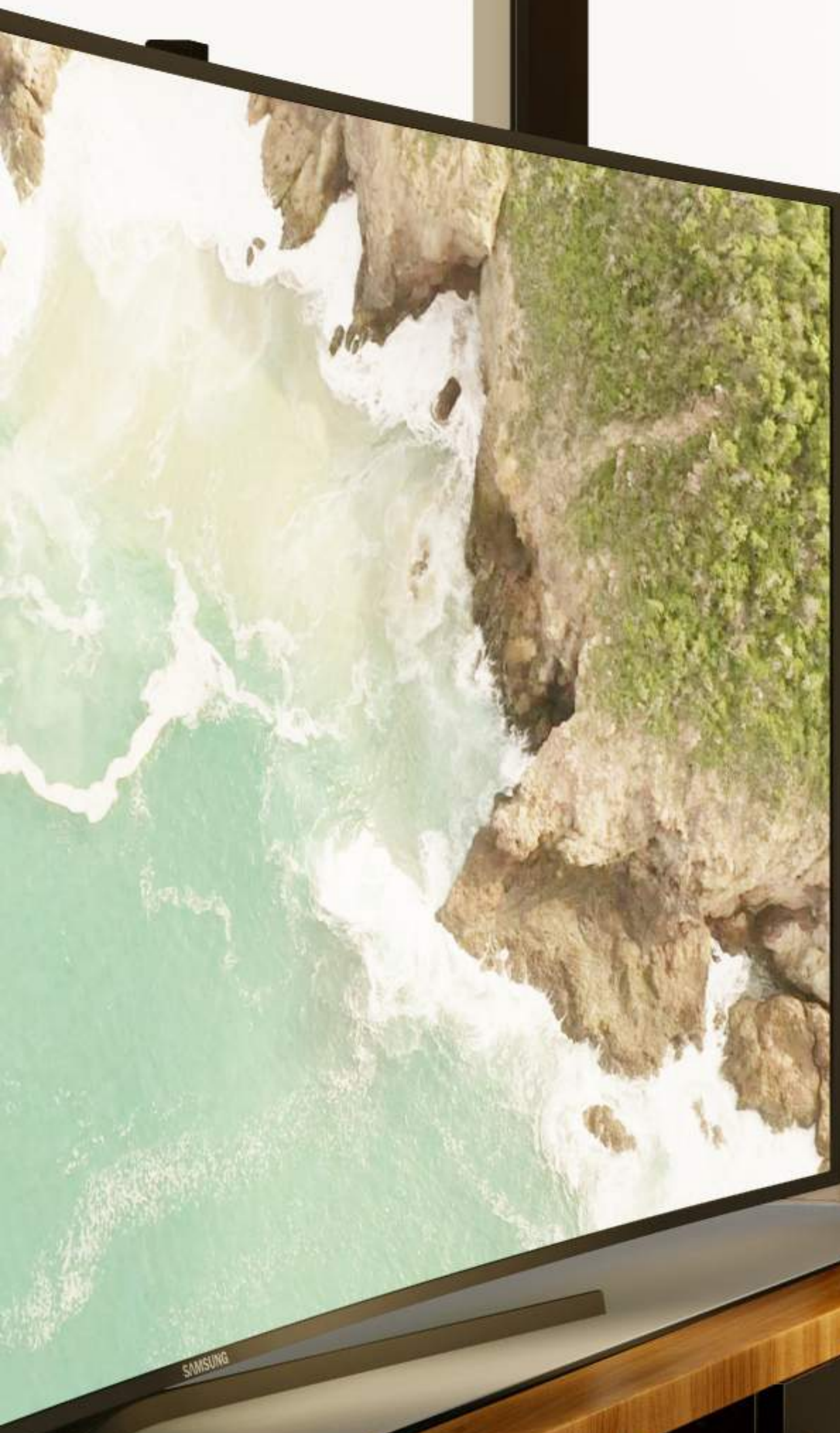

v-marine.com

aquator 50ft FLYBRIDGE



MARINE



v-marine.com

AQUADAC 50ft FLYBRIDGE

MARINE

v-marine.com

AQUATOR 50ft FLYBRIDGE

MARINE

v-marine.com

AQUATOR 50ft FLYBRIDGE

MARINE



v-marine.com

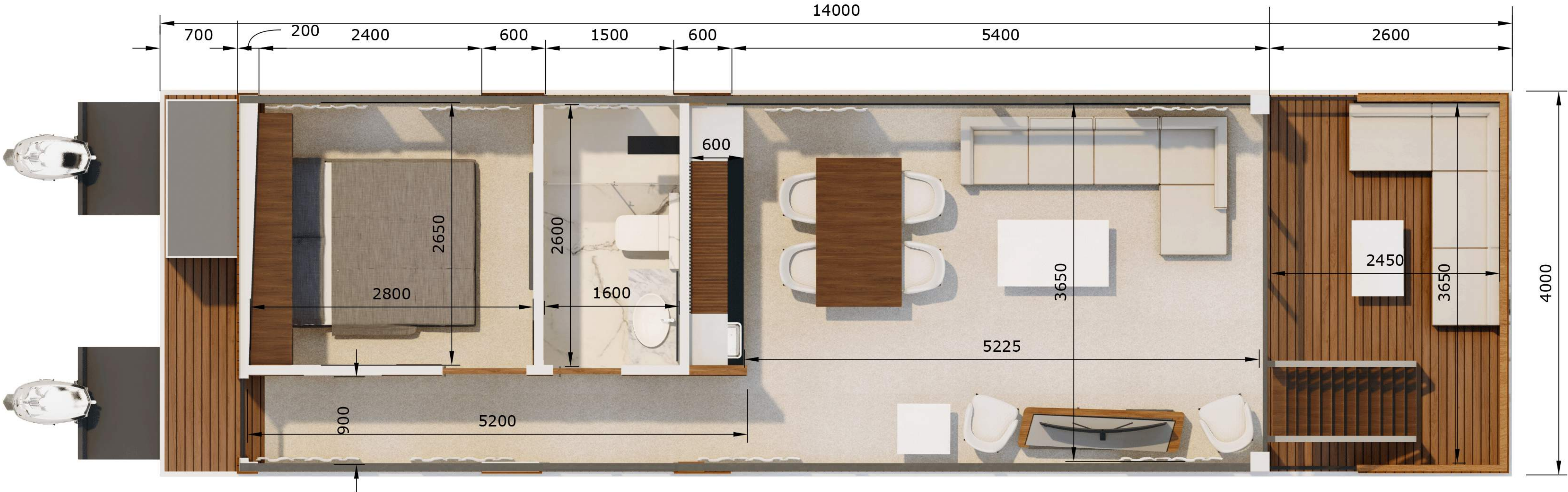

AQUATOR 50ft FLYBRIDGE



MARINE

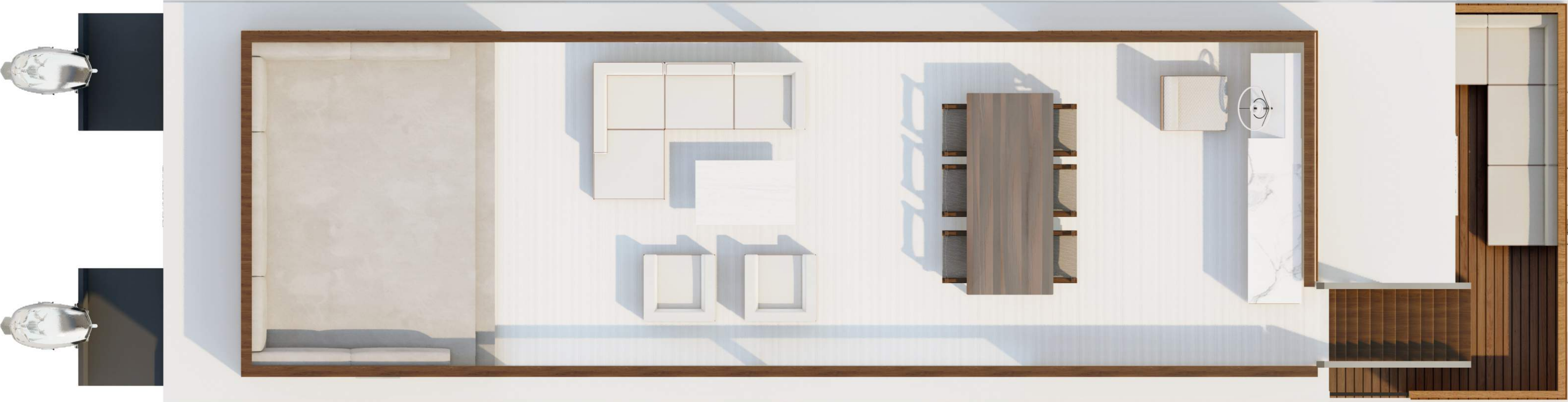

v-marine.com

AVIATOR 50ft FLYBRIDGE



MARINE

Length Overall	: 15.2 M / 50 Ft
Hull Length	: 14.5 M / 47.5Ft
Beam	: 4 M / 13.1 Ft
Draft	: 0.5 M / 1.6 Ft
Air Draft	: 4.2 M / 13.7 Ft
Air Draft Inc. T. Top	: 5.5 M / 18 Ft
Height Overall	: 4.7 M / 15.4 Ft
Displacement	: 15 Ton
Fuel tank	: 300 Litre
Water tank	: 300 Litre
Black Water tank	: 150 Litre
Recommended Power	: 2 x 200hp
Speed	: 4 to 8 Kn
Voltages	: 12VDC, 230VAC, 50Hz

v-marine.com