

BUSH[®] HOG INC.

AE - 40

LAWN AERATOR



The Bush Hog Aerator Is Easily Pulled By Small Garden Tractors And Attaches With a Simple Pin Attachment. Its Use Is Recommended Throughout The Growing Season For Home Lawns, And For Smaller Industrial, Institutional, And Public Turf Areas.

SPECIFICATIONS

WIDTH — OVER ALL 50"

LENGTH — OVER ALL 30"

AERATING WHEELS - 14 SPACED AT 2" INTERVALS ON AXLE. BRONZE BUSHINGS ON 1" AXLE. TINES — 10 PER WHEEL.

TRANSPORT WHEELS — ROLLER BEARING WHEELS WITH 2.75x10" SEMI-PNEUMATIC TIRES. A LIFT LEVER IS BUILT IN FOR RAISING AERATING WHEELS WHEN IN TRANSPORT.

WEIGHT — 150 LBS.

WIDTH — AERATING 38"

HITCH — 5/8 PIN TYPE

AE-40 ASSEMBLY INSTRUCTIONS

1. PLACE STOP A-S2575 AND STANDARD WELDED ASSEMBLY LEFT HAND C-S2581 ONTO ONE END OF AXLE ASSEMBLY B-S2672. INSERT KEY NO.258 IN AXLE SHAFT, PLACE AXLE PIVOT WELDED ASSEMBLY LEFT HAND B-S2556 ONTO END OF SHAFT, ADD FLATWASHER NO. 297 AND INSERT COTTER PIN NO.15977.
2. STAND THE ASSEMBLY THAT YOU COMPLETED IN STEP ONE ON END WITH AXLE UP. PLACE SPACER CUPS B-S2573, TIRE WELDED ASSEMBLIES D-2577, SPRINGS A-S2628 AND STOP A-S2575 ONTO AXLE IN SEQUENCE AS SHOWN.
3. PLACE STANDARD WELDED ASSEMBLY RIGHT HAND C-S2580 ONTO SHAFT AND PRESS DOWN UNTIL SPRINGS ARE COMPRESSED ENOUGH SO YOU CAN INSERT KEY NO. 258 IN SHAFT, PLACE LIFT ASSEMBLY D-S2634 ONTO SHAFT, ADD FLATWASHER NO.297 AND INSERT COTTER PIN NO. 15977.
4. PLACE AERATOR BOX WELDED ASSEMBLY D-S2595 BETWEEN STANDARDS AND FASTEN IN PLACE BY PUTTING TWO NO.19100 CAPSCREWS WITH LOCKWASHERS THROUGH THE TWO TOP HOLES IN STANDARDS AND INTO SPOT-WELD NUTS ON INSIDE OF AERATOR BOX.
5. FASTEN TONGUES C-S2602 TO INSIDE OF STANDARDS BY INSERTING IN EACH, TWO NO.19098 CAPSCREWS THROUGH HOLES IN THE STANDARDS AND PLACING LOCKWASHERS AND NUTS ON INSIDE.
6. PLACE HITCH WELDED ASSEMBLY B-S2560 BETWEEN THE TWO TONGUES AND FASTEN INTO PLACE WITH TWO NO.19055 CAPSCREWS WITH LOCKWASHERS AND NUTS.
7. PUT TIRES ON SPINDLES, ADD FLATWASHERS NO.922 AND INSERT COTTER PINS NO.15975. YOUR AE-40 IS NOW COMPLETELY ASSEMBLED AND READY FOR USE. WITH THE AID OF THE LIFT ASSEMBLY INSTALLED IN STEP 3 YOU CAN EASILY ADJUST YOUR AE-40 TO AERATE ANYWHERE FROM 1/2 TO 4 INCHES. TO OBTAIN SMOOTH, EVEN AERATING ON HARDENED OR ROUGH GROUND FILL THE AERATOR BOX WITH SAND OR WHAT EVER YOU DESIRE. HITCH PIN NO.7108 HAS BEEN FURNISHED WITH YOUR AE-40 FOR QUICK EASY FAST HITCHES.

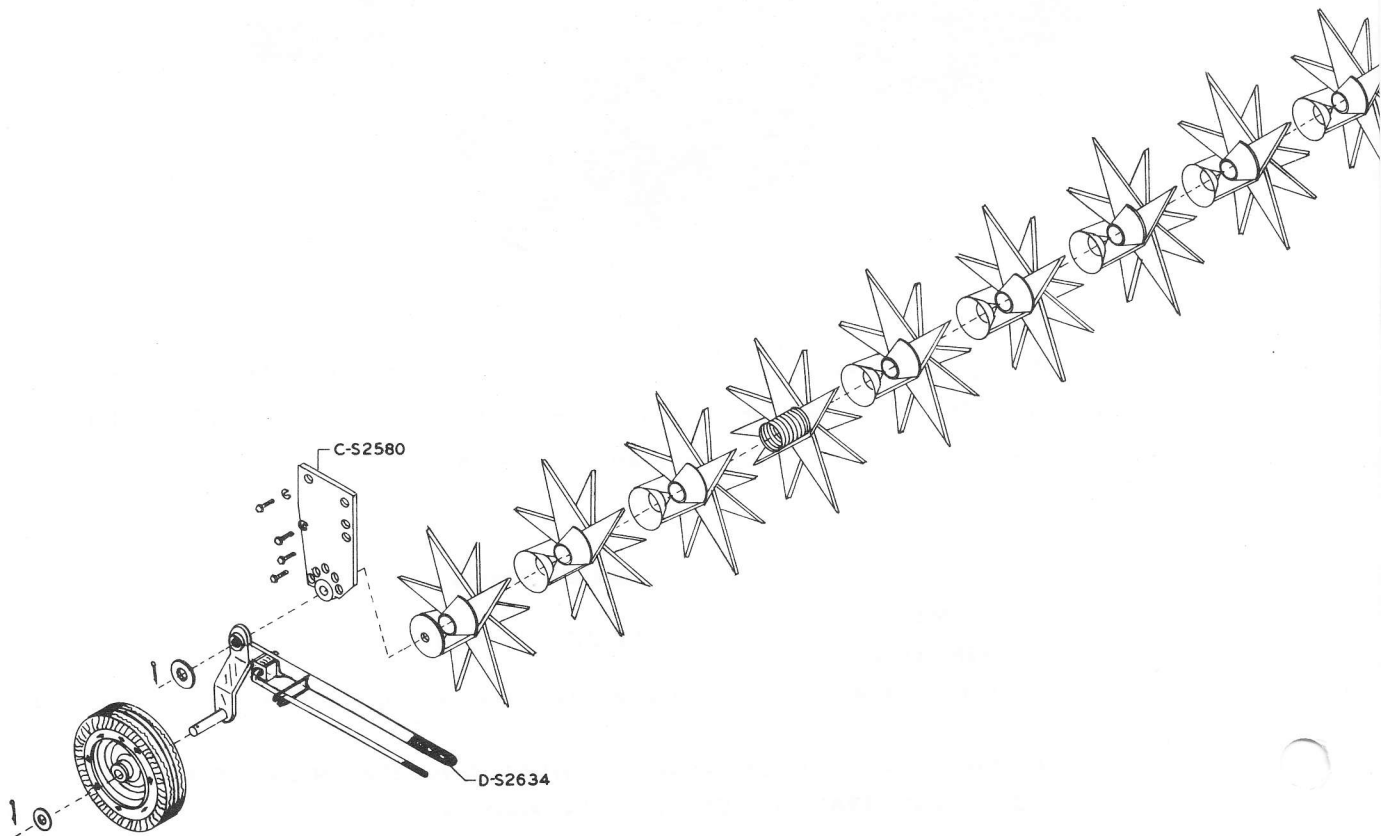

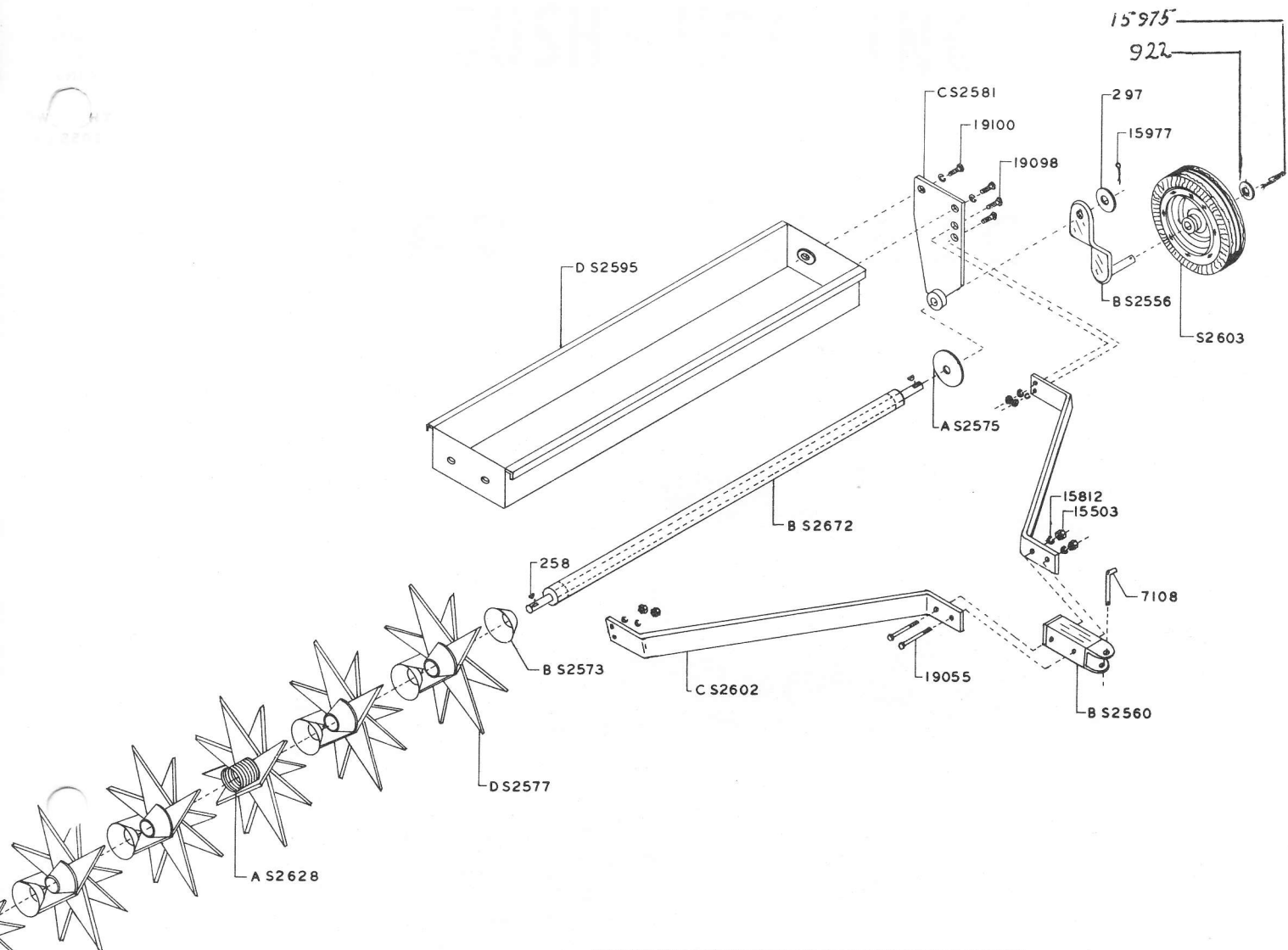

PARTS LIST

PART NO.	DESCRIPTION	QTY.
B-S2556	AXLE PIVOT WELDED ASSY. LEFT HAND	1
B-S2560	HITCH WELDED ASSY.	1
B-S2573	SPACER CUP	24
B-S2575	STOP	2
D-S2577	TINE WELDED ASSY.	14
C-S2580	STANDARD WELDED ASSY. RIGHT HAND	1
C-S2581	STANDARD WELDED ASSY. LEFT HAND	1
D-S2595	AERATOR BOX WELDED ASSY.	1
C-S2602	TONGUE	2
A-S2628	SPRING	2
D-S2634	LIFT ASSY.	1
B-S2672	AXLE ASSY.	1
-S2603	TIRE	2
258	KEY	2
922	FLATWASHER 5/8 STD.	2
297	FLATWASHER 1" STD.	2
7108	HITCH PIN	1
15503	NUT 3/8-16UNC	6
15812	LOCKWASHER 3/8 MED.	10
15975	COTTER PIN 5/32 X 1 1/2	2
15977	COTTER PIN 5/32 X 1	2
19055	CAPSCREW 3/8-16UNC X 3	2
19098	CAPSCREW 3/8-16UNC X 1 1/4	4
19180	CAPSCREW 3/8-16UNC X 3/4	4