



شركة مجموعة البسامي
AL-bassami Group Co.
للتجارة والمقاولات Trading & Contracting

CEO'S MESSAGE

Since 1982, Al Bassami Group Company started its entrepreneurship and leading the development of the contracting field to contribute effective growth of this sector by meeting the needs of economic growth with the highest

specifications, international standards and expertise in the Kingdom of Saudi Arabia



Organizational Chart



ENG ABDULLAH AL-BASSAMI
CHAIRMAN



ENG.SAAD AL-BASSAMI
Chief Executive Office



ENG.ABDULQADIR AL-BASSAMI
Chief Operations Office



ENG.ABDULMAGID AL-BASSAMI
chief operating officer Al-Rwaqan Coffee co



ABDULALI ALROBIAI
Human Resource Director



SAMEER AL-MAIMANI
Operation Manager travel leaders



ENG.SAMI KHALAF
Environmental Project Manager



ABDULLAH SHANNAN
Head of internal Audit



SAMER ALBAIK
Chief information technology officer



AHMAD ESSA
Chief Financial Officer



AL ANOUD AL-GHAMDI
Business Development Manager



MOHAMED SAMEER
Legal Affairs Officer

PROJECTS MAP



JEDDAH

RAYAN DIST
HAMDANIA DIST
DAHBAN
LAITH

RIYADH

Al Olaya



AL-BASSAMI HISTORY

Philosophy

From the time it was founded in 1982, Albassami has attempted to conduct its business in accordance with certain core principles. The most important of these principles begins with the manner in which we, as a company and as numerous individuals acting as the representatives of that company, treat those with whom we interact. To some degree, this most important principle is unsaid, as what we do is more important than what we say we will do.



Our Vision

The successful planning, perfect implementation credibility and high quality are our works criteria to enhance our leadership to become the best provider of integrated services in the field of contracting and trades.

Our Goals

Is the provide urban and suburban residential real estate schemes in the western region and across different kingdom infrastructure servies in required quality and price competition.

Acquisition of land areas to work in collaboration with residential cities aspiring inverstors, develop and provide it with all infrastructure services.



Safety

Safety is part of Albassami's culture. AL Bassami takes great pride in ensuring the safety of its employees, those working with them, and the surrounding community at all times. AL Bassami's safety program is continually evolving and includes formal leadership commitment, orientation and training, preconstruction planning, incident investigations, performance recognition, and more.

Safety is a way of life that AL-Bassami strives to improve upon every day and AL-Bassami's experience modification rate of



WORK WITH US

Al-Bassamifirmly believes that its employees are the cornerstone of its success, and Largo is always searching for the best and brightest to join its team. Whether you are a seasoned professional or about to graduate from college, if you are passionate about building and are looking for a career with a stable company.



SERVICES

AlBassami offering a complete constructral package to our clients. A skilled workforce combined with all related tools and equipment results in the ability to complete the scope of work without the need for subcontractors. Albassami's resources and capabilities means better control over budgets, schedules and safety resulting in a better product for our clients. A complete list of the services we offer together or individually include all type of infrastructure, Maintenance and operation, concrete and asphalt formwork.

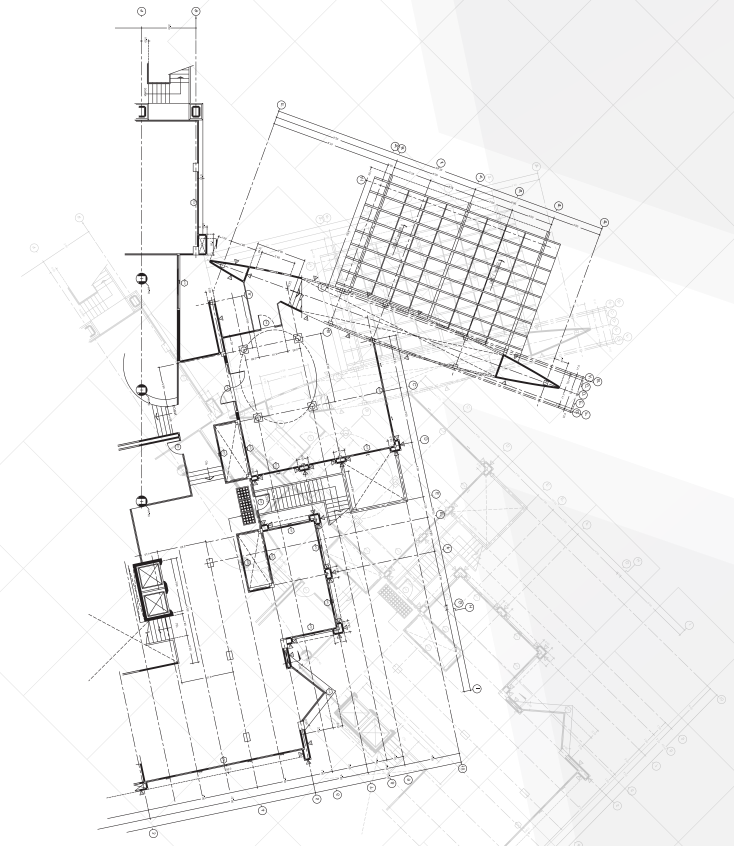



شركة رينو للمقاولات Rhino Contracting Company

The contracting sector is the economic development arm that contributes effectively to the renaissance and development of states in This sector plays an important role in building construction and accerlerates the growth of emerging encomies to provide a sound infrastructure for all services, where the contracting sector in saudi Arabia grew rapidly under a surge of government projects . And this growth is expected to continue in the coming years as future development plan and this kingdom's immediate following places agreat responsibity on the shoulders of contractors different to achieving this demand and keep up with growth based on quality and efficiency Came the founding of AL-Bassami Co. for Contracting & Mining was founded with its trademark RHINO in 1982 as a leading contracting company contribute to briding the gaps needs to local contractor qualification as one of the major Constraints to the sector SMB succeeded thanks to God then the cooperation with partners, employees, and the confidence of clients in developing special imprint on our projects and actions stemming from the corporate values and goals for which this entity was established.

The company aspires to work bigger and more distinct on the basis of operational efficiency quality through a clear vision and raising performance levels corresponding to local and international standards which allows us to obtain a higher rankings puts us in the rankings companies summit.





Infrastructure Works

Storm networks

Civil drainage is to collect rainfall runoff from all across the city and discharge it slowly to the downstream river or natural water catchments. Stormwater drainage systems frequently collaborate with the environment, channeling, attenuating, and discharging stormwater.





Infrastructure Works

Sewage networks

A sewerage system, or wastewater collection system, is a network of pipes, pumping stations, and appurtenances that convey sewage from its points of origin to a point of treatment and disposal.





Infrastructure Works

irrigation networks

the artificial application of water to the soil through various systems of tubes, pumps, and sprays. Irrigation is usually used when natural water sources and rain are not sufficient to provide plant water demand and in areas where rainfall is irregular or dry times or drought is expected.





Infrastructure Works

Excavation and filling projects

Excavation is essential for every building project because it establishes a solid foundation and offers a stable surface for the surrounding property. Backfilling is a critical step in the building process. Backfilling is the process of compacting earth back into a trench or foundation after it has been excavated.





Infrastructure Works

Asphalting projects

Road construction is the process of installing soil stabilisers, asphalt, concrete, and other materials on a defined path to create a smoothed or paved surface that vehicles can move on between two destinations. This is a complex venture that involves paving, rehabilitation, and/or reclamation of degraded pavements to create a motorable roadway. It can take months or years of planning before work can begin depending on the size and type of the envisioned road.





Infrastructure Works

Landscape projects

The activity that modifies the visible features of an area of land, including the following: Living elements, such as flora or fauna; or what is commonly called gardening, the art and craft of growing plants with a goal of creating a beauty within the landscape.

Natural abiotic elements, such as landforms, terrain shape and elevation, or bodies of water. Abstract elements, such as the weather and lighting conditions.





Electricity

It includes the installation of overhead and ground networks, installation of transformers, installation of transformers, installation of RMU, maintenance of existing networks and installation of meters.

Unified electricity contract and communications

Street light, light pole, lamp pole, lamppost, street lamp, light standard, or lamp standard is a raised source of light on the edge of a road or path.





Electricity

Street Lighting

street light, light pole, lamp pole, lamppost, street lamp, light standard, or lamp standard is a raised source of light on the edge of a road or path.

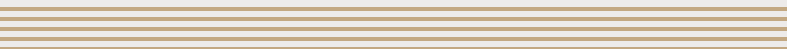

Electricity

Horizontal Directional Drilling Projects

Horizontal directional drilling (HDD) is a trenchless technology applied to install underground pipelines with minimal impacts on the environment or damage to existing infrastructure such as roadways and other surface structures.





Operation, maintenance and cleaning works

O&M which provides the facility to insure the right practice to manage the activity and to be implemented on a way that don't decay over time beside providing the support to help the achievement of goals .

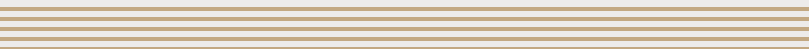



Enviomental projects



A large fleet of white Scania trucks is parked in a lot under a clear blue sky. In the center, a concrete pump truck with a long, articulated orange boom is positioned. The word "Projects" is overlaid in white text with a horizontal line underneath it. The background shows rolling green hills and a few flags.

Projects



A PROJECT TO MAINTAIN AND IMPROVE DAMS AND THEIR CANALS IN EASTERN JEDDAH

The project aims to clean all the dams and their canals so that they serve the purpose for which they were constructed and to ensure the safety of these elements and the safety of the residents in the nearby area, in addition to us completing all the required work related to improving the efficiency of these dams, which includes periodic maintenance of the dam and submitting daily reports to the Jeddah Municipality regarding these dams, the project was completed with the highest quality, specifications, and the company proved its ability to complete this project through a fleet of the company's equipment and a group of experienced workers.





Implementation of land and infrastructure settlement works for Salman Bay

The work of this project included excavation, leveling, and infrastructure work for the entire project area, in addition to all maintenance work. The project aims to raise the quality of life in Salman Bay through implementing infrastructure networks of the highest standards, along with the establishment of pumping stations and drainage facilities.

The total area of the project is 3 million square meters.

Owner: Jeddah Development and Urban Regeneration Company, Jeddah





IMPLEMENTATION OF FENCING WORKS ACCORDING TO THE SCRAP PLAN

The project aims to organize and plan activity of scrap by rehabilitating model sites for practicing the activity, which contributes to raising local content and developing the city of Jeddah. The project also features an area of up to 2.3 million square meters, and includes commercial service areas, green spaces, mosques and truck stops, in addition to government service offices and labor housing.





DEVELOPING THE LAND OF AL-MURJAN NEIGHBORHOOD

The project aims to implement all infrastructure networks for the Al-Marjan scheme, which includes site preparation works, leveling works, the network budget for the site, construction works for the sewage network, construction works for the water and lighting network, and construction of sidewalks and sidewalks. The owner of the project is Abdullah Ibrahim Al-Subaie Real Estate Development Company, and the project was completed with high quality and within the highest standards. Technical standards and specifications for all works subject to the contract.





A PROJECT TO IMPLEMENT INFRASTRUCTURE WORKS AI-MASAYAD SITE - SARAT UBAIDA

The project belongs to the Asir region. The purpose of the project is to level the general site, implement roads, and clear plots of land for the entire Al-Masayad site - Sarat Ubaidah in the Asir region. We have committed to implementing all infrastructure networks at the project site, which has an area of 760 thousand square meters, and we have committed to handing over the project to the National Company. For housing with the highest standards of quality and to achieve an increase in the quality of life for the citizens who benefited from the plots of land, a total of 400 plots of land were prepared with an area of approximately 500 square meters for each plot of land, and the project was delivered according to the highest levels of commitment and adherence to the work stages, timelines, and all conditions and specifications, as the project is considered One of the basic national projects.





Implementation project to complete the infrastructure works related to the work of increasing population densities in the southern Prince Fawaz housing project





ROAD AND INFRASTRUCTURE WORKS PROJECT FOR THE SUMOU SUBURB PLAN

The total area of the project is one million and six hundred square metres. The project is owned by Sumou District Real Estate Development Company. The project work consisted of implementing road and lighting networks and all infrastructure works, including lighting, electricity and communications networks, in addition to rainwater drainage networks.

The project was implemented in accordance with the highest levels of commitment and adherence to the work stages, timelines, and all conditions and specifications





List of Projects

Currently existing projects				
no	project name	owner	project location	scope of work
1	Implementing road and lighting works in the scrap and shed plan	Jeddah company	jeddah	Road and lighting works
2	Implementation of fencing works according to the scrap plan - Al-Laith	Jeddah company	jeddah	Implementation of precast fences
3	Implementing the works of the gate and the administrative building in the scrap plan	Jeddah company	jeddah	Implementing a gate and an administrative building with all accessories
4	Raising densities for the Prince Fawaz Southern Project	National Housing Company	jeddah	Increasing the density of infrastructure networks
5	Reducing the surface water level - the second stage	Jedah municipality	jeddah	Implementing a network to reduce the surface water level
6	Reducing the surface water level - the third stage	Jedah municipality	jeddah	Implementing a network to reduce the surface water level
7	Supporting the work of sub-municipalities in addressing visual distortion	Jedah municipality	jeddah	Operating and Maintenance
8	Treatment of construction and demolition waste	Jedah municipality	jeddah	Operating and Maintenance
9	Implementation of the Prince Fawaz irrigation network	National Housing Company	jeddah	Implementing an irrigation network



Previously implemented projects				
no	project	The owner	project location	scope of work
1	Asphalting grant schemes	Jeddah municipality	jeddah	Road works
2	Developing the land of Al-Murjan neighborhood	Abdullah Al-Subaie Real Estate Company	jeddah	Infrastructure (sewage, rain drainage, water works, and road works)
3	Earthworks project masharef-2	Dar Al Mashreq Real Estate Development Company	jeddah	Infrastructure (sewage, rain drainage, water works, and road works)
4	Ewan Al Fareed Residential Plan 1+2	Ewan Unique Company	jeddah	Infrastructure (sewage, rain drainage, water works, and road works)
5	Ewan Al Fareed residential plan 3+4	Ewan Unique Company	jeddah	Infrastructure (sewage, rain drainage, water works, and road works)
6	Implementing infrastructure works for the Al-Masayad site - Sarat Ubaida	National Housing Company	aseer	Road works and rainwater drainage
7	Maintaining and improving dams and their canals east of Jeddah	Jeddah municipality	jeddah	Improving dams and their canals + maintaining rainwater drainage works
8	Reducing surface water levels in damaged streets in Jeddah	Jeddah municipality	jeddah	Implementing a water level reduction network
9	Road and infrastructure works for Sumou District	Sumou Suburb Company	mekkah	Infrastructure (sewage, rain drainage, water works, and road works)
10	Unified electricity contract	Saudi Electricity Company	jeddah	Infrastructure (sewage, rain drainage, water works, and road works)
11	Implementation of Al Quoz water network	National Water Company	mekkah	Implementing a water network with all network accessories
12	Dirab project	air forces	riyadh	Infrastructure (sewage, rain drainage, water works, and road works)
13	Redevelopment of Kilo 7 market	Awj Holding Company	jeddah	Infrastructure (sewage, rain drainage, water works, and road works)



شركة ريد نو الصناعية
Rhino Industrial Company





RHINO INDUSTRIAL

The company's integrated vision, which was set as a business management strategy, required directing part of the investment towards integrating services provided by the company in the field of contracting, mainly in infrastructure.

Establishing an industrial environment that directly supports construction and roads sector was the key element to achieve this target, therefore we found that crushers, asphalt in addition to ready-mix concrete and precast plants will be the right support to ensure the high quality of inputs required for construction and roads sectors in all aspects.





Ready Max Concrete

The Company does its best to maintain a high level of quality to meet client requirements, through the use of plasticizers and cooled water in the production of concrete, then the Company began to use hard graded gravel with high resistance, extracted by rock blasting and crushing, as it was one of the first Saudi companies to use casting techniques by pumping pipes at high altitudes. When the Company has been established, the ultimate goal was to build a private national Company, characterized by high quality, distinguished and reliable service at all stages of production.

This goal has been adopted from the first day of production. The Company maintained its distinction and leadership in the local distinguished and reliable service market, the projects and facilities that we have contributed in by providing our services are the best proof on that, out of our belief in the goals set, where we are dedicated to providing modern technology in this field.

Our specialized laboratory is constantly working on research and development under the supervision of a technical team that has accumulated experience, to meet the requirements of the international standards. We also provide free consulting services to address any problem facing our clients in our sites, through a qualified team that holds technical quality certificates for concrete.





Blocks & Concrete Factories



CEMENT, VOLCANIC, HORDI & INSULATED BLOCKS & CURBSTONES

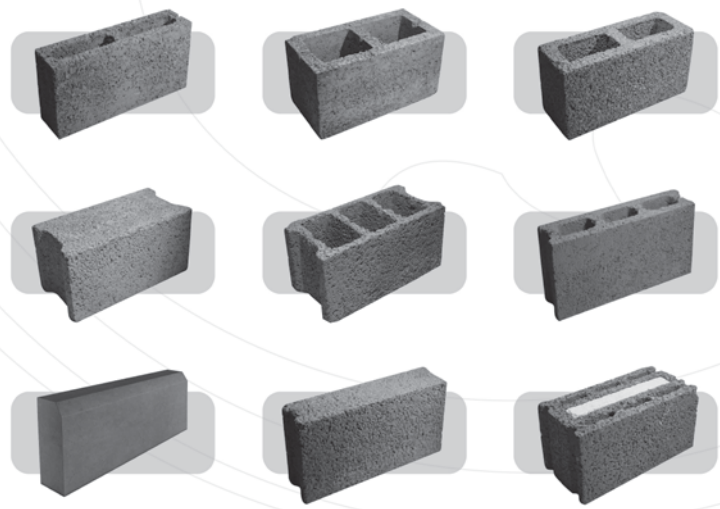



Asphalt Plants

Asphalt business started in 2003 to be one of the leader companies in producing asphalt in the western region, our investing on latest technology used in the industry we selected leader of manufacturing asphalt plants to be our partner in implementing and produce high quality based on high standard required in asphalt market. Our experience in the field and industry of asphalt has enabled us to enter into many important projects and enabled us to qualify for many government agencies such as municipalities and ministries. The asphalt plants were established to be a complementary element to the industrial aspect that the company achieved in the field of mining and crushers, two asphalt plants were established in both Al-AID and BRIMAN mountains in the western region, as these areas contain raw materials suitable for the production of a high quality of Asphalt





Precast

Precast concrete is a construction product produced by casting concrete in a reusable mold or "form" which is then cured in a controlled environment, transported to the construction site and maneuvered into place; examples include precast beams, and wall panels for tilt up construction.

Our Factory located in Jeddah industrial area (Dahban) lies in 20,000 Sqm land which producing different products (Columns, Beams, Walls ,...etc)

Factory was established based on European leading technology in the concrete supply chain and managed by high qualified and competent managers, Engineers, staff in this type of industry.



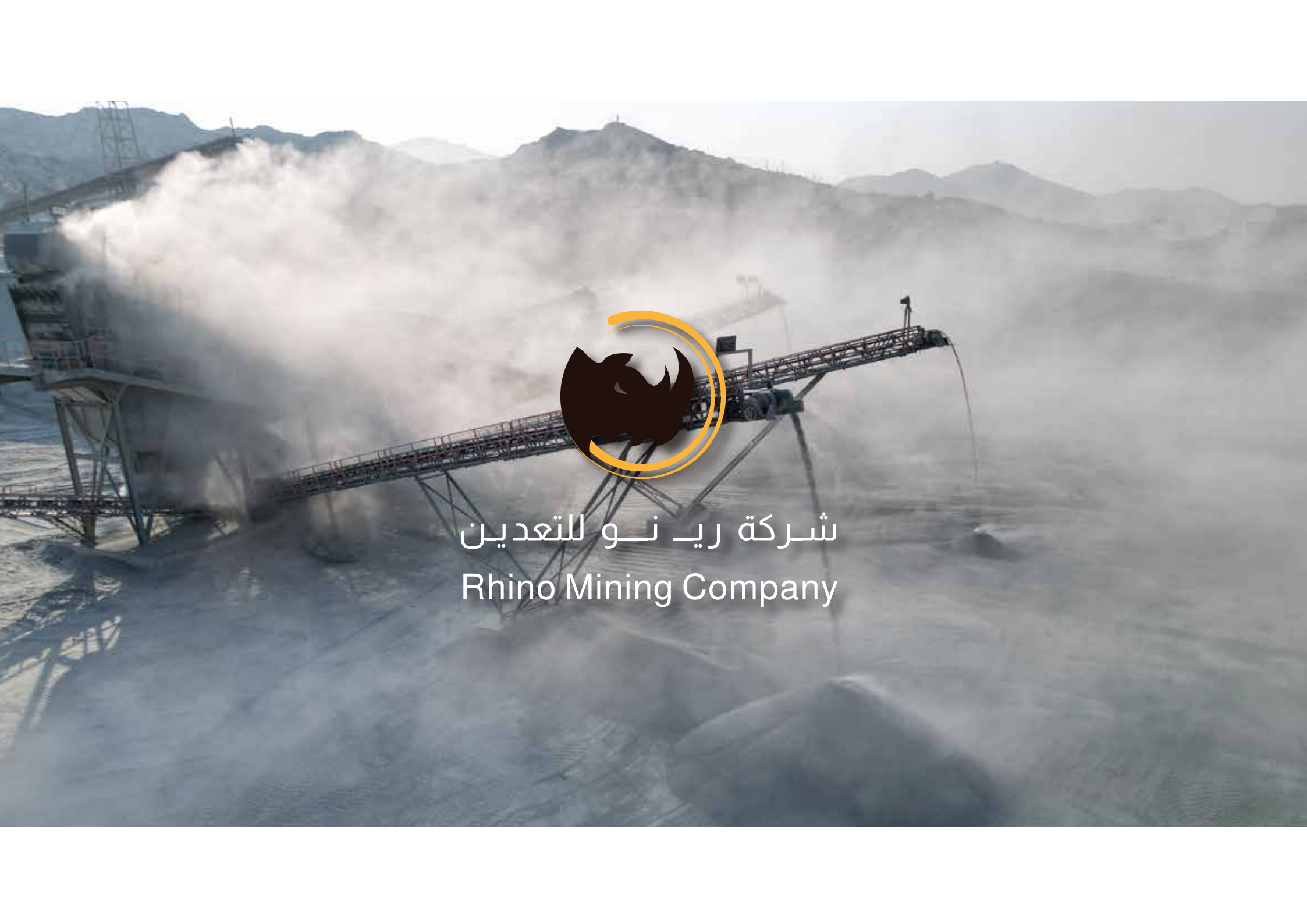

شركة رينو للتعدين
Rhino Mining Company

Mining

In line with the tremendous development witnessed by the mining sector in the Kingdom of Saudi Arabia, the Rhino mining Company. Invested its previous experiences in establishing a department that serves the mining sector by attracting national cadres with technical expertise in mining, and concluded agreements with international companies in mining and exploration services for technical and technology.





Crushers

Stone crushing Industry is an important industrial sector in the country engaged in producing crushed stone of various sizes depending upon the requirement which acts as raw material for various construction activities such as construction of Roads, Highways, Bridges, Buildings, Canals etc. the grow further of infrastructure of roads, canals and buildings that are required for overall development of the country. We started Crushing on 2003 in the western region of Saudi Arabia on Al EID Mountains and BRIMAN which produce all sizes of aggregate that meet the standard for building and construction approved by SASO

The use of advanced technology in the field of crushers was the primary goal in managing this type of investment in order to maintain the high quality required by this type of work and to comply with Saudi construction requirements and specifications.



Crushers



Sample of our Projects and Equipments





Sample of our Projects and Equipments





Sample of our Projects and Equipments





Sample of our Projects and Equipments





Sample of our Projects and Equipments





Sample of our Projects and Equipments





Quality and Safety

The Company produces building materials, through the application of the required tests and conformity, and any other specifications provided by the client, the required strength ranges from 15 to 100 cubic MPa – Megapascal, produced according to international standards and specifications.

The Company adopts the mechanism of deployment mobile laboratory teams at the sites of our clients' projects, where we issue complete reports and statistical analyzes, in addition to verifying specifications, as we work to organize and coordinate infusions in advance, as well as prescribing proven mixtures.

Temperature Control Procedures:

1. Chilled water up to 5 degrees Celsius.
2. Gradient gravel tinting.
3. Cooling the gravel upon request, and adding ice upon request at a reasonable cost.
4. Using balancing materials for the hydration process time upon request (Auto Transformer)

Raw Materials Used:

Re Nua Company relies on the best available materials, in the production of the ready-mixed concrete, as the material cost is not as influential as the quality and efficiency standard of the product.

Cement:

1. Ordinary Portland Cement, American specifications.
2. Portland Cement, salt resistant, American specifications.
3. Portland Pozzolana Cement, American specifications.

Water:

Clean, safe drinking water, free from any impurities, according to American specifications (chloride-sulfur).





Certifications



Certifications





Our Clients





Our Clients





شركة مجموعة البسامي
AL-bassami Group Co.
للتجارة والمقاولات Trading & Contracting

Tel:012-6176633- Fax:012-6173366 - P.O.Box:35350-Jeddah21488

info@albassami-group.com

w w w . a l b a s s a m i - g r o u p . c o m

