

Toddler Park Play Equipment Replacement

June 2023



Status of Current Toddler Park Play Structures

- Play equipment was removed from Toddler Park a few years ago.
- A single swing set remains.
- This once very used play area is not being utilized
 - 2,094 Sq Ft of empty space



Toddler Park Subcommittee

- Formed in 2021, by homeowner volunteers to address the need for replacement of removed Toddler Park play structures.
- Continues to meet on a monthly basis
- Members
 - Nathan Popovich – Board Member
 - Brian Schanz – Board Member
 - Anu Zangri – Subcommittee Member
 - Debbie Ramos – Subcommittee Member
 - Barbara Cowgill – Subcommittee Member
 - Molly Kitchell – Subcommittee Member
 - Katie Schneider – Subcommittee Member
- Actions to date:
 - Neighborhood-wide survey to play equipment options and conceptual designs received from 4 vendors in December of 2022
 - Highwire Play Equipment Selected



Replacement Playground Equipment

Two
Spinner
Bowls



Two Swing Sets

(Saddle & Toddler)



Supernova



Explorer Dome



Layout Footprint of New Play Equipment

- Existing upper play area
 - 2,094 Sq Ft
- Expansion
 - Adding to the upper play area (2,112 Sq Ft)
 - Additional 24' x 26' area near the lower play area for toddler swings near the existing 2-5-year-old play area at the front of the park (24' x 26')
- New Layout
 - 4,206 Sq Ft

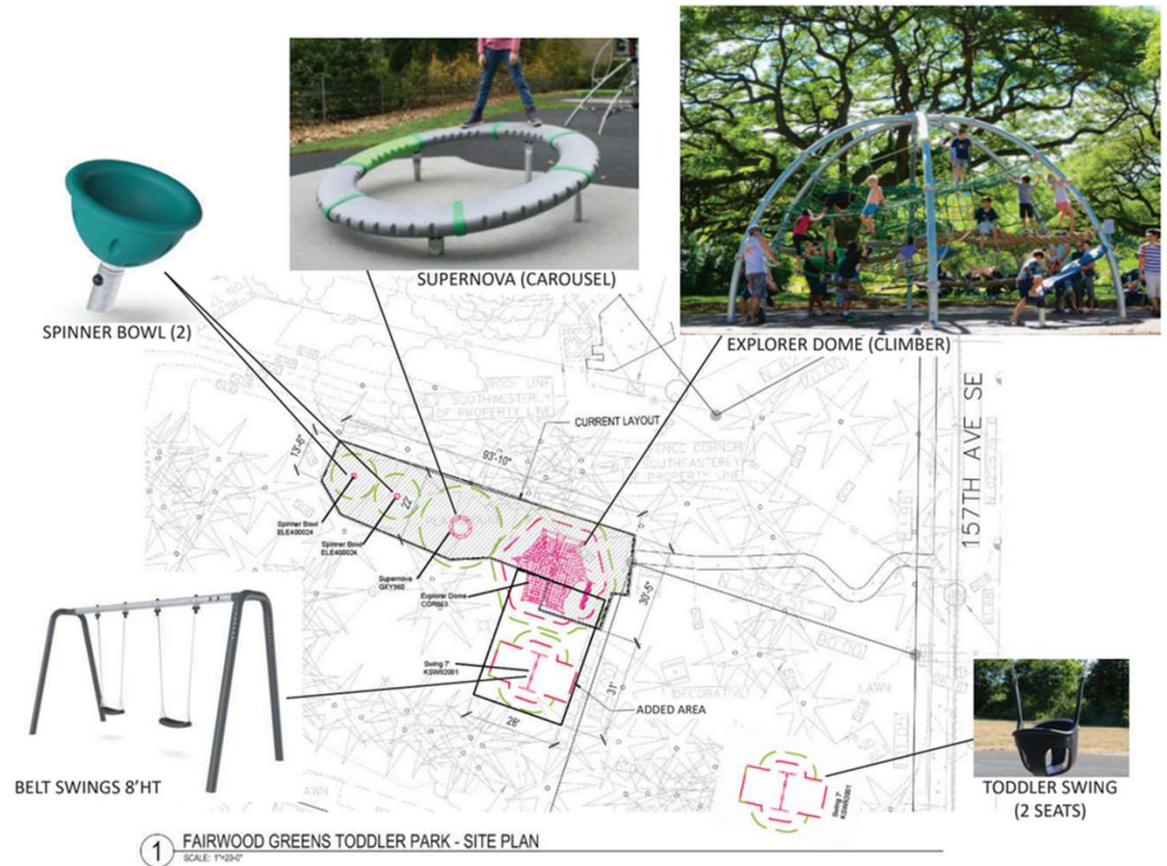

Financials

Financial Impact to the Association

- Highwire Play Equipment (\$128,096.95)
- Engineered Wood Fiber (EWF) Playchips (\$12,958)
- Construction (\$65,000)
 - Removal and disposal of existing swing set and tire swing
 - Installation of new equipment
 - Modification of border near the Explorer Dome
 - New bordered 24' x 26' area for toddler swings near the existing 2–5-year-old play area (624 Sq ft)
- Volunteer involvement can reduce these costs
- **Total Cost** - \$206,055

Preparation for Potential Inflationary Impact

As we all know, over the last few years we have seen costs increase.

- Equipment quotes may be subject to a slight increase between now and March of 2024, when funds will be available to put a 50% down payment on the equipment.
 - Some of the EFW should be reusable
- In preparation, an additional 10% will be added to the budget ensure completion with uncertain future economic conditions.
 - \$227,205
- **Impact/Homeowner** - \$151.47



Next Steps and Timeline

- **Communication**
 - Information will be included in the annual newsletter
- **Funding**
 - This project will be funded with a special assessment added as a separate line item to the 2023-2024 budget
 - Payment can be made in full with January dues
 - Two payments of $\frac{1}{2}$ the amount can be made with dues in January and July
 - Failure to pay special assessment and regular assessment payment on time will be subject to current FGHA payment policies
 - A 50% down payment is required to secure the equipment
 - Volunteer involvement could reduce the overall cost in removal and disposal of existing equipment
 - Any remaining funds will be placed in an account for future replacement of the 2–5-year-old play equipment
- **Replacement of Equipment**
 - Construction targeted for April of 2024