



FUNCTIONSMITH, INC.

MANILA • GUANGZHOU

Container Modular House

WWW.FUNCTIONSMITH.COM





We provide

All Class: A fire-resistant standard container house, flat pack container house, extension container house, folding container house, custom container house. Besides, we also sell sandwich wall panels, steel, doors, windows, bunk beds and other container parts and accessories.





Worker Camping House : 01

1K = 1820mm IP = 950mm

Materials: Steel structure and sandwich panel

Features:



Floor: Cement base, tiles floor

Frame: Steel structure

Roof and Walls: 50mm EPS sandwich panel

Storey: Usually 1-3 floors.

Application:

Temporary Office, Meeting Room, Command post, Dormitory, Temporary Shop, Temporary School, Temporary Hospital, etc.

- Reliable steel structure reliable
- Convenient installation
- Economic and environment-friendly



Installation: All the components of the house are prefabricated before leaving the factory, with the advantage of assembling and disassembling easily.

Worker Camping House : 02



FUNCTIONSMITH, INC.

MANILA • GUANGZHOU

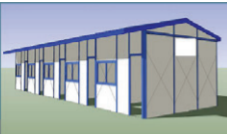

1. Life-span of Usage:8 to 10 years

2. Average net self-weight: 35kg/m²

3. 3-4times of installation and disassembly

4. Loadability of the a building board is 180kg/m²

5. Anti-wind level is grade II,capacity:200kg-400kg/m²;

6. Time of installation is 100m²/day

7. Aseismatic ability level is grade B

8. Abrasion rate of each remove is 6%

9. fireproofing level is grade I



**Technical
Parameter**

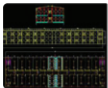

Design and detail confirmation



Production & Shipment



Making concrete foundation



Installation of steel structures



Installation of wall panels



Installation of floor & partition walls



Installation finished

Process



FUNCTIONSMITH, INC.

MANILA • GUANGZHOU



INSIDE VIEWS



FUNCTIONSMITH, INC.

MANILA • GUANGZHOU





Fiber Cement Board Housing



Fiber cement board housing is a good system with good heat & sound insulation which is famous to used now in the world.



Features:

- Reliable steel structure reliable
- Convenient installation
- Economic and environment-friendly
- 100% non-asbestos;
- Density: 1,000 - 1,400kg/cbm
- Coefficient of thermal expansion: 0.24W/MK(JC/T54)
- Bending strength: over 13MPa (GB/T7019-1997)
- Linear expansion rate: 0.1%



Fiber Cement Board Housing



Fiber cement board housing is a good system with good heat & sound insulation which is famous to used now in the world;



Features:

- Water absorption rate: less 0.19% (GB/T7019-1997)
- Water penetration rate: 0%
- Water content: 10%
- Incombustibility according to CNS 6532 and BS 476 standards
- Two point five-three hours of fire rating for 6mm wall system with W-CSP concrete
- Radioactivity: GB6566-2000 standards
- Characteristic: nonflammability A grade (GB-8624-1997)
- The wall is solid and firm inside, resistant to impact pressure
- Painting, tiling and nailing is possible.



Steel Structure workshop

Description 01:



FUNCTIONSMITH, INC.

---The Main steel structure materials include the H-section, I-section, square tube, circular tube, floor decking steel sheet, C-section, Z-section, angle iron, steel bar, sandwich panel, steel plate, etc;



H Section



I Section



Circular tube



Square tube



Z Section



Angle Iron



Floor decking steel sheet



C Section



Steel sheet



Fiber glass



Wall panel



Roof panel

EPS SANDWICH PANEL



Wall panel



Roof panel

ROCK WOOL SANDWICH PANEL



Wall panel



Roof panel

POLYURETHANE SANDWICH PANEL



Steel Structure workshop

Features:

- Fast and flexible to assemble,
- Safe, thermal and noise insulation,
- Water proof and fire prevention;
- Cost-effective: Fast and easy installation greatly shorten the construction time which reduce the costs;

Durability:

- The whole structure is easy in maintenance, which can be used for more than 50 years.
- Perfect design: Perfect design completely avoids leaks and water seepage. Meanwhile, it's also in line with the national level of fire prevention.
- Carrying capacity: Can resist the impact of strong wind and seismic performance and bears heavy snow loads.





FUNCTIONSMITH, INC.

MANILA • GUANGZHOU



Warehouse Project : 400 m²



FUNCTIONSMITH, INC.

MANILA • BANGALORE

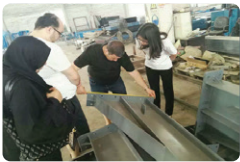

Prefab Container coming house



Quick Installation, Recyclable, Durable, Beautiful Design

Container house is assembled together by bolts and screws, so it can be installed quickly. Being able to be recyclable, relocated and with a life span of more than 25 years, container is widely used as offices, meeting rooms, dorms, etc.



Sizes: 20', 40' or customized

Frame: Galvanized steel structure

Wall: Sandwich panels are EPS/PU/ROCK WOOL/MGO, etc. Thickness: from 50mm to 100mm

Roof: 50mm polystyren foam panels.

Floor System And Covering: PVC covering 18mm building templates or 3mm corrugated steel sheets or customized.

Ceiling: EPS color steel sandwich panel ,rock wool,PU for the insulation

Window: PVC material or aluminium alloy

Door: Aluminum alloy door ,security door or compound wooden door.



FUNCTIONSMITH, INC.

MANILA • GUANGZHOU



Prefab Container Camping House



Prefab Container Camping House



Light Steel Keel System Villa

Description 01:



Light Steel Keel Villa housing which is based on Australia/New Zealand Standard AS/NZS4600 which is famous around the world.



Features:

- Strong steel structure reliable-with good earthquake proof and Hurricane Proof;
- Convenient installation: 5-8 technical persons can finish the structure installation in half days around 100sqm;
- Economic and environment-friendly-All the steel materials can be recycle and without materials wasted ;
- 100% non-asbestos

Light Steel Keel System Villa

Light Steel Keel Villa housing which is based on Australia/New Zealand Standard AS/NZS4600 which is famous around the world.



Description 01:



Features:

- Strong steel structure reliable-with good earthquake proof and Hurricane Proof;
- Convenient installation: 5-8 technical persons can finish the structure installation in half days around 100sqm;
- Economic and environment-friendly-All the steel materials can be recycle and without materials wasted ;
- 100% non-asbestos with all the electrical/piping installing inside the wall;

Exterior wall decoration



**PVC
Cladding**

**Fiber Cement
board**



Roof decoration



**Asphalt
Shingles**



**Stone coated
Alu-zinc roof tiles**





Manila Philippines Head Office

*#779 Acacia Street, Octagon Industrial Estate
Subdivision, Barangay Dela Paz, Pasig City, Philippines
Metro Manila, 1600*

+639 8941-2647 | +632 8645-4284
+632 7753-2285 | +632 7753-2359

WWW.FUNCTIONSMITH.COM



FUNCTIONSMITH, INC.

MANILA • GUANGZHOU