

Soils Map

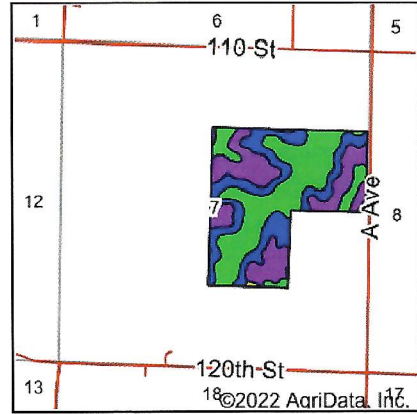
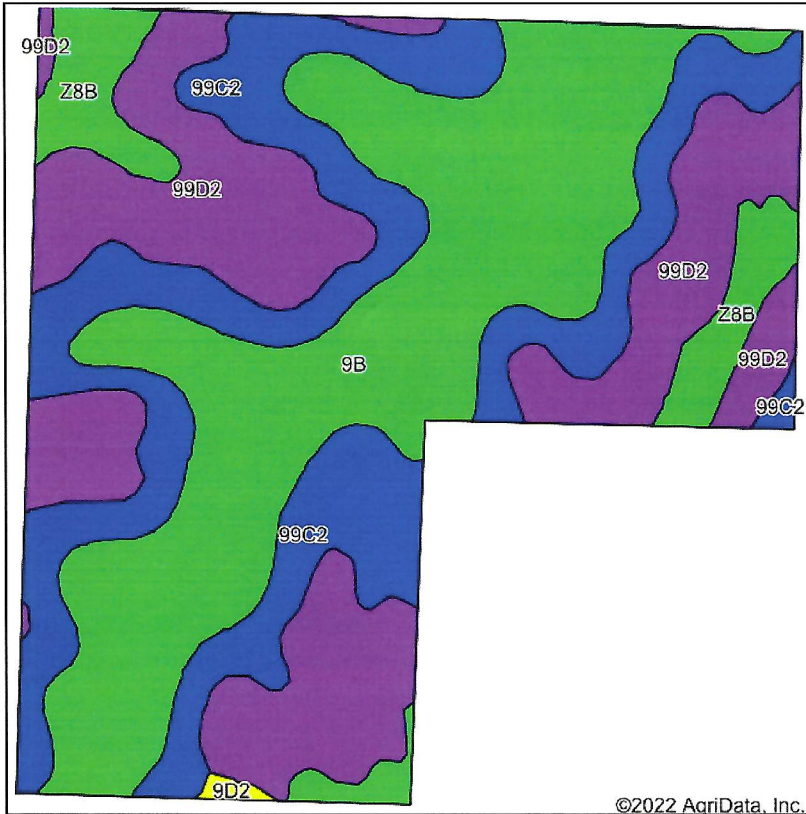

State: **Iowa**
 County: **Montgomery**
 Location: **7-73N-39W**
 Township: **Lincoln**
 Acres: **117.53**
 Date: **10/12/2022**

Soils data provided by USDA and NRCS.

©2022 AgriData, Inc.



Area Symbol: IA137, Soil Area Version: 29									
Code	Soil Description	Acres	Percent of field	CSR2 Legend	Non-Irr Class *c	CSR2**	CSR	*n NCCPI Soybeans	
9B	Marshall silty clay loam, 2 to 5 percent slopes	41.20	35.1%	■	Ile	95	85	77	
99D2	Exira silty clay loam, 9 to 14 percent slopes, eroded	34.99	29.8%	■	IIle	59	55	67	
99C2	Exira silty clay loam, 5 to 9 percent slopes, eroded	33.09	28.2%	■	IIIle	87	65	71	
Z8B	Judson silty clay loam, deep loess, 2 to 5 percent slopes	7.94	6.8%	■	Ile	92		81	
9D2	Marshall silty clay loam, 9 to 14 percent slopes, eroded	0.31	0.3%	■	IIle	61	58	65	
Weighted Average						2.58	81.7	*-	*n 72.6

**IA has updated the CSR values for each county to CSR2.
 *- CSR weighted average cannot be calculated on the current soils data, use prior data version for csr values.
 *n: The aggregation method is "Weighted Average using all components"
 *c: Using Capabilities Class Dominant Condition Aggregation Method

Parcel #1

Soils data provided by USDA and NRCS.

Soils Map

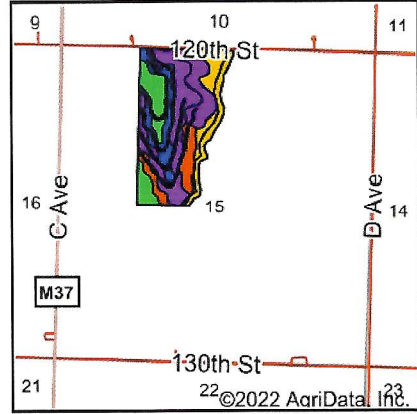
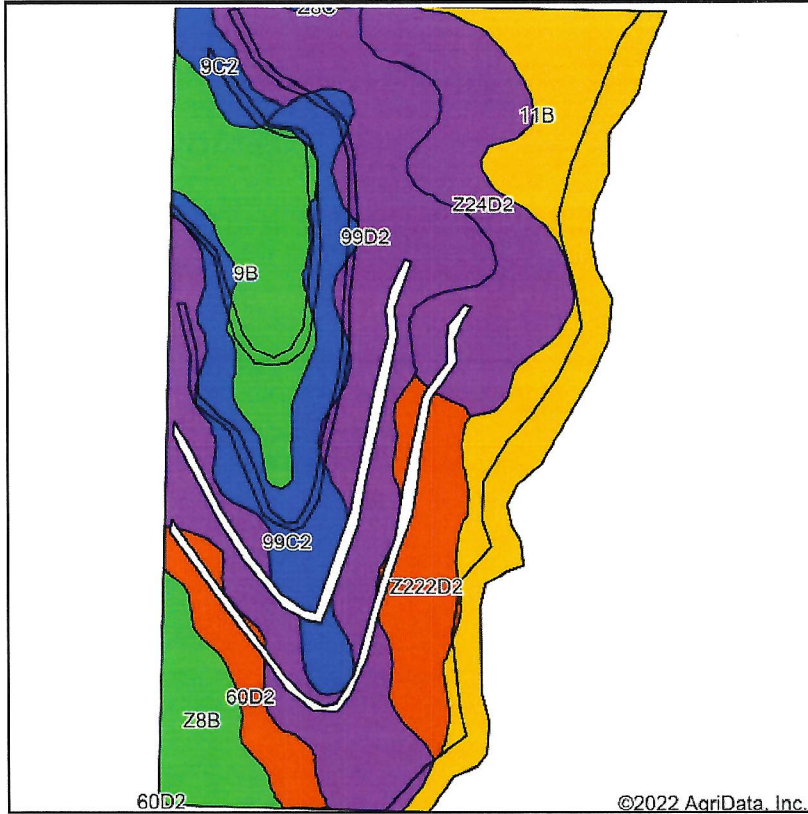

State: **Iowa**
 County: **Montgomery**
 Location: **15-73N-39W**
 Township: **Lincoln**
 Acres: **72.42**
 Date: **10/12/2022**



Soils data provided by USDA and NRCS.

©2022 AgriData, Inc.

Area Symbol: IA137, Soil Area Version: 29

Code	Soil Description	Acres	Percent of field	CSR2 Legend	Non-Irr Class *c	CSR2**	CSR	*n NCCPI Soybeans	
99D2	Exira silty clay loam, 9 to 14 percent slopes, eroded	20.60	28.4%		IIIe	59	55	67	
11B	Ackmore-Colo-Judson complex, 2 to 5 percent slopes	13.05	18.0%		IIw	79	68	82	
Z24D2	Shelby clay loam, deep loess, 9 to 14 percent slopes, eroded	9.13	12.6%		IIIe	52		56	
99C2	Exira silty clay loam, 5 to 9 percent slopes, eroded	8.88	12.3%		IIIe	87	65	71	
9B	Marshall silty clay loam, 2 to 5 percent slopes	7.61	10.5%		IIe	95	85	77	
Z222D2	Clarinda silty clay loam, deep loess, 9 to 14 percent slopes, eroded	5.03	6.9%		IVe	15		47	
Z8B	Judson silty clay loam, deep loess, 2 to 5 percent slopes	3.79	5.2%		IIe	92		81	
60D2	Malvern silty clay loam, 9 to 14 percent slopes, moderately eroded	2.80	3.9%		IVe	5	25	74	
9C2	Marshall silty clay loam, 5 to 9 percent slopes, eroded	1.42	2.0%		IIIe	87	68	70	
Z8C	Judson silty clay loam, deep loess, 5 to 9 percent slopes	0.11	0.2%		IIIe	87		78	
Weighted Average						2.77	66.1	*-	*n 69.5

**IA has updated the CSR values for each county to CSR2.
 *- CSR weighted average cannot be calculated on the current soils data, use prior data version for csr values.
 *n: The aggregation method is "Weighted Average using all components"
 *c: Using Capabilities Class Dominant Condition Aggregation Method

Parcel #2

Soils data provided by USDA and NRCS.

Soils Map

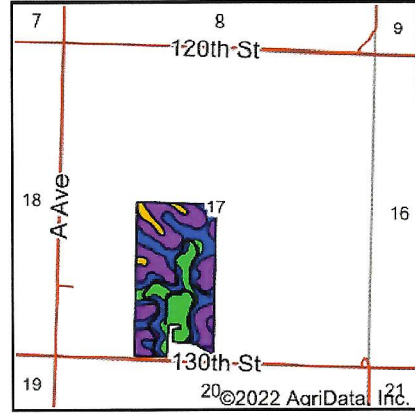
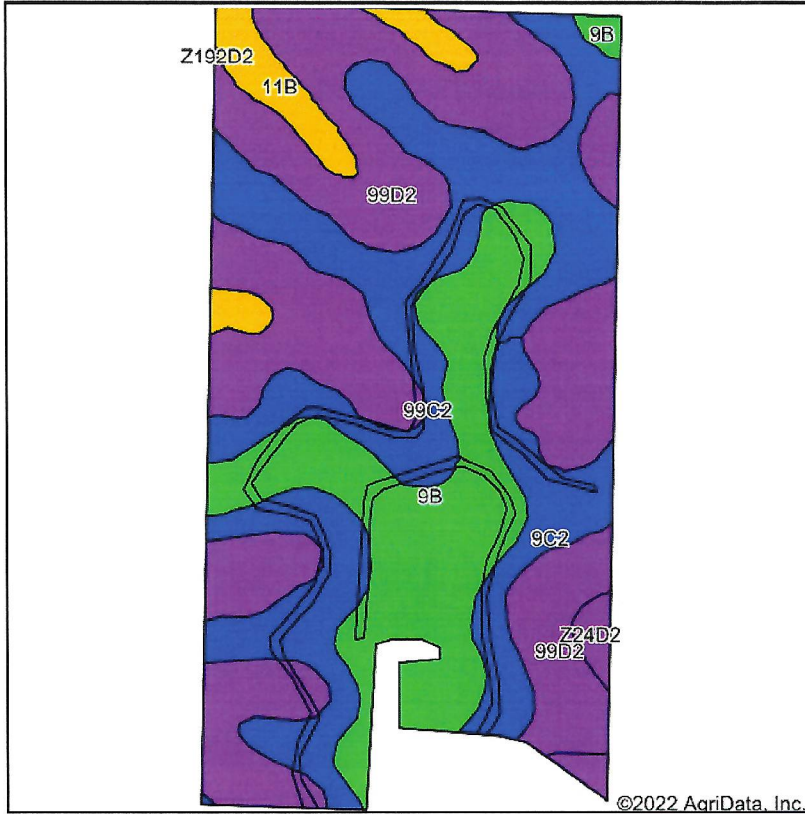

State: **Iowa**
 County: **Montgomery**
 Location: **17-73N-39W**
 Township: **Lincoln**
 Acres: **74.56**
 Date: **10/12/2022**

Maps Provided By: **surety**
 CUSTOMIZED ONLINE MAPPING
 © AgriData, Inc. 2021 www.AgriDataInc.com



Soils data provided by USDA and NRCS.

©2022 AgriData, Inc.

Area Symbol: IA137, Soil Area Version: 29									
Code	Soil Description	Acres	Percent of field	CSR2 Legend	Non-Irr Class *c	CSR2**	CSR	*n NCCPI Soybeans	
99D2	Exira silty clay loam, 9 to 14 percent slopes, eroded	30.10	40.4%			IIIe	59	55	67
99C2	Exira silty clay loam, 5 to 9 percent slopes, eroded	20.27	27.2%			IIIe	87	65	71
9B	Marshall silty clay loam, 2 to 5 percent slopes	15.01	20.1%			Ile	95	85	77
9C2	Marshall silty clay loam, 5 to 9 percent slopes, eroded	4.85	6.5%			IIIe	87	68	70
11B	Ackmore-Colo-Judson complex, 2 to 5 percent slopes	3.35	4.5%			IIw	79	68	82
Z24D2	Shelby clay loam, deep loess, 9 to 14 percent slopes, eroded	0.98	1.3%			IIIe	52		56
Weighted Average						2.75	76.5	*-	*n 70.8

**IA has updated the CSR values for each county to CSR2.
 *- CSR weighted average cannot be calculated on the current soils data, use prior data version for csr values.
 *n: The aggregation method is "Weighted Average using all components"
 *c: Using Capabilities Class Dominant Condition Aggregation Method

Parcel #3

Soils data provided by USDA and NRCS.

Soils Map

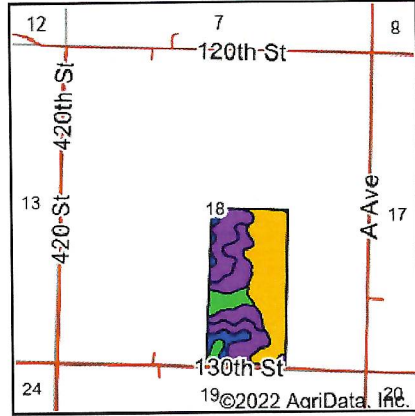
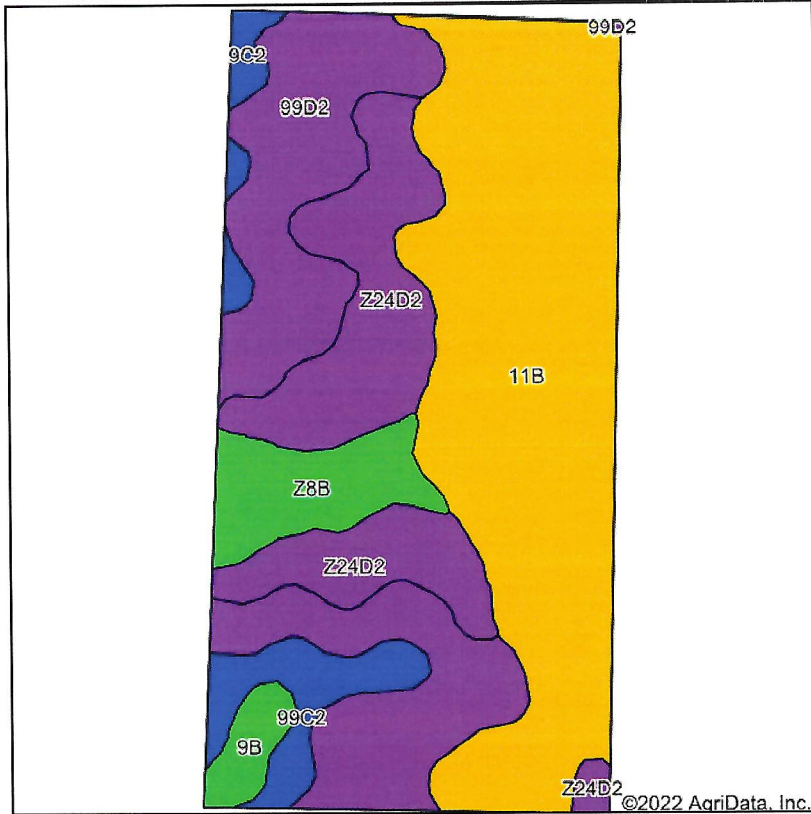

State: **Iowa**
 County: **Montgomery**
 Location: **18-73N-39W**
 Township: **Lincoln**
 Acres: **76.61**
 Date: **10/12/2022**



Soils data provided by USDA and NRCS.

Area Symbol: IA137, Soil Area Version: 29

Code	Soil Description	Acres	Percent of field	CSR2 Legend	Non-Irr Class *c	CSR2**	CSR	*n NCCPI Soybeans	
11B	Ackmore-Colo-Judson complex, 2 to 5 percent slopes	32.00	41.8%		llw	79	68	82	
99D2	Exira silty clay loam, 9 to 14 percent slopes, eroded	19.30	25.2%		llle	59	55	67	
Z24D2	Shelby clay loam, deep loess, 9 to 14 percent slopes, eroded	13.73	17.9%		llle	52		56	
Z8B	Judson silty clay loam, deep loess, 2 to 5 percent slopes	4.86	6.3%		lle	92		81	
99C2	Exira silty clay loam, 5 to 9 percent slopes, eroded	3.76	4.9%		llle	87	65	71	
9B	Marshall silty clay loam, 2 to 5 percent slopes	1.60	2.1%		lle	95	85	77	
9C2	Marshall silty clay loam, 5 to 9 percent slopes, eroded	1.36	1.8%		llle	87	68	70	
Weighted Average						2.50	70.8	*-	*n 72.6

**IA has updated the CSR values for each county to CSR2.

*- CSR weighted average cannot be calculated on the current soils data, use prior data version for csr values.

*n: The aggregation method is "Weighted Average using all components"

*c: Using Capabilities Class Dominant Condition Aggregation Method

Parcel #4

Soils data provided by USDA and NRCS.