

Quick-Release Case Cleaner Knob

Available for Vibratory Case Cleaners with

- 1/4"-20 Threaded Spindle (T1750-01)
- 5/16"-18 Threaded Spindle (T1750-02)
- 3/8"-16 Threaded Spindle (T1750-03)

(Item #T1750-xx)



Installation

- 1) Remove and set aside the original knob or wing nut that came with your case cleaner. If there is a metal flat washer under the knob or wing nut, please leave it in place.
- 2) Tilt the Quick-Release Case Cleaner Knob slightly and then slide it down over the threaded spindle. (see drawing at right)
- 3) Once in position, the knob is brought into a straight position ... mating the two threaded segments within the knob to the threads on the spindle.
- 4) Turn the knob clockwise until snug ... about 1-1/2 to 1-3/4 turns.

**Tilted for Quick
Removal / Installation**

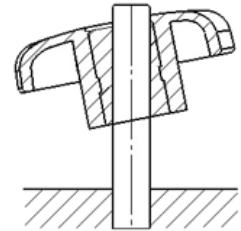

Straight for Tightening

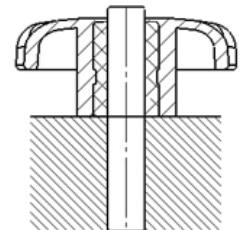

Removal

- 1) Loosen the knob ... again, about 1-1/2 to 1-3/4 turns.
- 2) Tilt the knob slightly to disengage it from the spindle threads.
- 3) Lift knob off the threaded spindle.

Note: Line drawings are for instructional purposes only and are not identical to actual product.

TIP: Some case cleaners have very thin or flexible covers that may not support the knob straight enough to ensure secure engagement with the spindle threads. If the knob loses engagement with the spindle threads, try adding a fender washer under the knob. This usually cures the problem.