

118X22

118X22

118X22

THIS PLAN IS THE PROPERTY OF THE ENGINEER AND ARCHITECT AND IS NOT TO BE REPRODUCED OR COPIED IN ANY MANNER WITHOUT THE WRITTEN CONSENT OF THE ENGINEER AND ARCHITECT. ANY REPRODUCTION OR COPIING OF THIS PLAN WITHOUT THE WRITTEN CONSENT OF THE ENGINEER AND ARCHITECT IS STRICTLY PROHIBITED AND WILL BE PROSECUTED TO THE FULL EXTENT OF THE LAW.

1. THE ENGINEER AND ARCHITECT SHALL BE RESPONSIBLE FOR THE ACCURACY OF THE INFORMATION PROVIDED TO THEM BY THE CLIENT AND FOR THE CORRECTNESS OF THE DESIGN AND CONSTRUCTION OF THE PROJECT.

2. THE ENGINEER AND ARCHITECT SHALL NOT BE RESPONSIBLE FOR THE ACCURACY OF THE INFORMATION PROVIDED TO THEM BY THE CLIENT OR FOR THE CORRECTNESS OF THE DESIGN AND CONSTRUCTION OF THE PROJECT.

3. THE ENGINEER AND ARCHITECT SHALL NOT BE RESPONSIBLE FOR THE ACCURACY OF THE INFORMATION PROVIDED TO THEM BY THE CLIENT OR FOR THE CORRECTNESS OF THE DESIGN AND CONSTRUCTION OF THE PROJECT.

3/15/16
 [Signature]
 12 12 12
 12 12 12

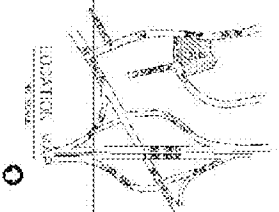
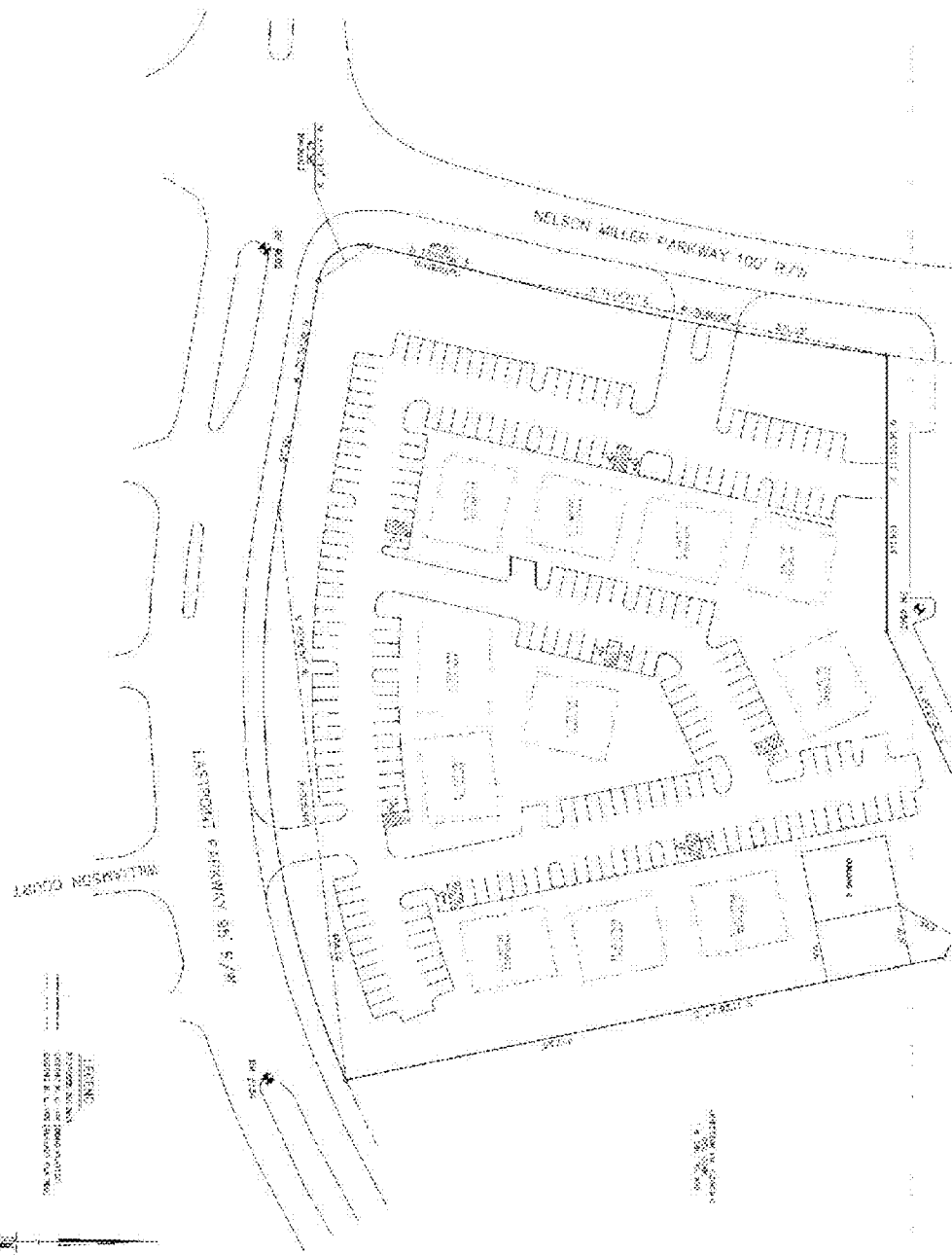

<p>1 12 12 12 12 12 12</p>	<p>EASTPOINT LOT 220 BUILDING 9 UNITS 101, 102 & 201 DEED BOOK 8643, PAGE 759 1801 EASTPOINT PARKWAY LOUISVILLE, KY.</p>	<p>OWNER PRINCIPLE PROPERTIES OF KIRKSWITH, LLC P.O. BOX 40637 LOUISVILLE, KY. 40263 (502) 248-0643</p>	<p>MSA Mindel, Seatt & Associates, Inc. 10000 Lakeside Drive, Suite 100 Louisville, KY 40228 (502) 248-1111</p>
--	---	---	--

118X22

118X23

12-15-04
 12:11 PM
 12/15/04
 12:11 PM
 12/15/04

BUILDING B
1ST FLOOR

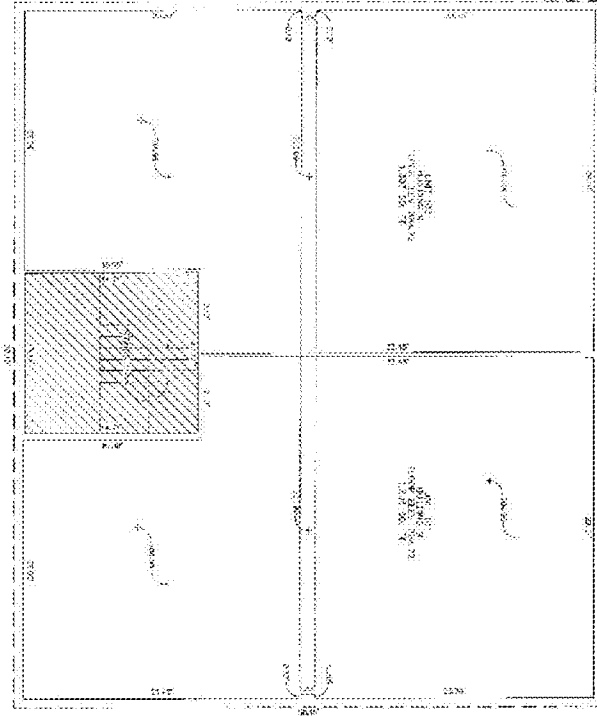
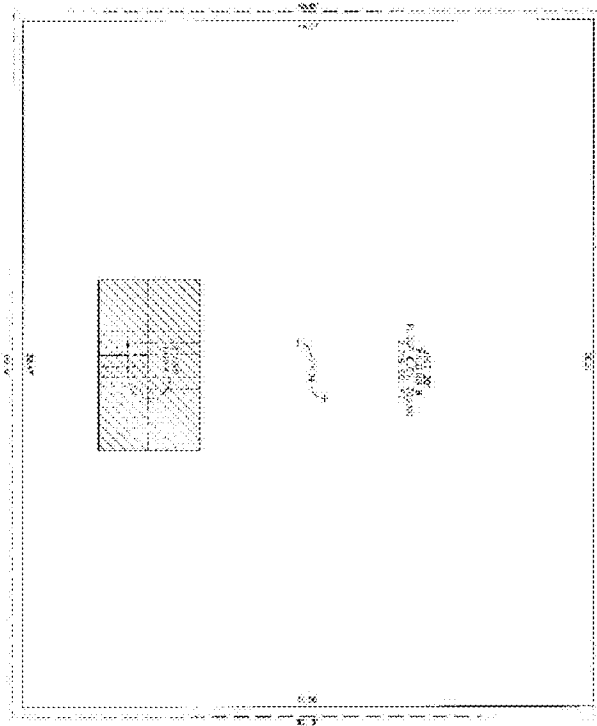

TABLE OF LEGEND

----- WINDOW
 ----- DOOR
 ----- PARTITION
 ----- WALL
 ----- FINISH LINE
 ----- CONSTRUCTION LINE
 ----- CENTERLINE
 ----- DIMENSION LINE
 ----- GRADE
 ----- FINISH GRADE
 ----- EXISTING GRADE
 ----- EXISTING CONCRETE AREA

BUILDING B
2ND FLOOR



118X21

118X23

118X23

118X23
 118X23
 118X23

2 118X23	<p> EASTPOINT LOT 220 BUILDING B, UNIT'S 101, 102 & 201 DEED 2004-8664, PAGE 759 1601 TASHBURN PARKWAY LOUISVILLE, KY. </p>	<p> OWNER: PRIMAQUE PROPERTIES OF LOUISVILLE, LLC. 1601 BOX 31257 LOUISVILLE, KY 40233 (502) 245-0543 </p>	<p> Mitchell, Scott & Associates, Inc. 2000 14th Avenue, Suite 100 Louisville, KY 40203 (502) 245-0543 </p>
-------------	--	---	--

118X23