

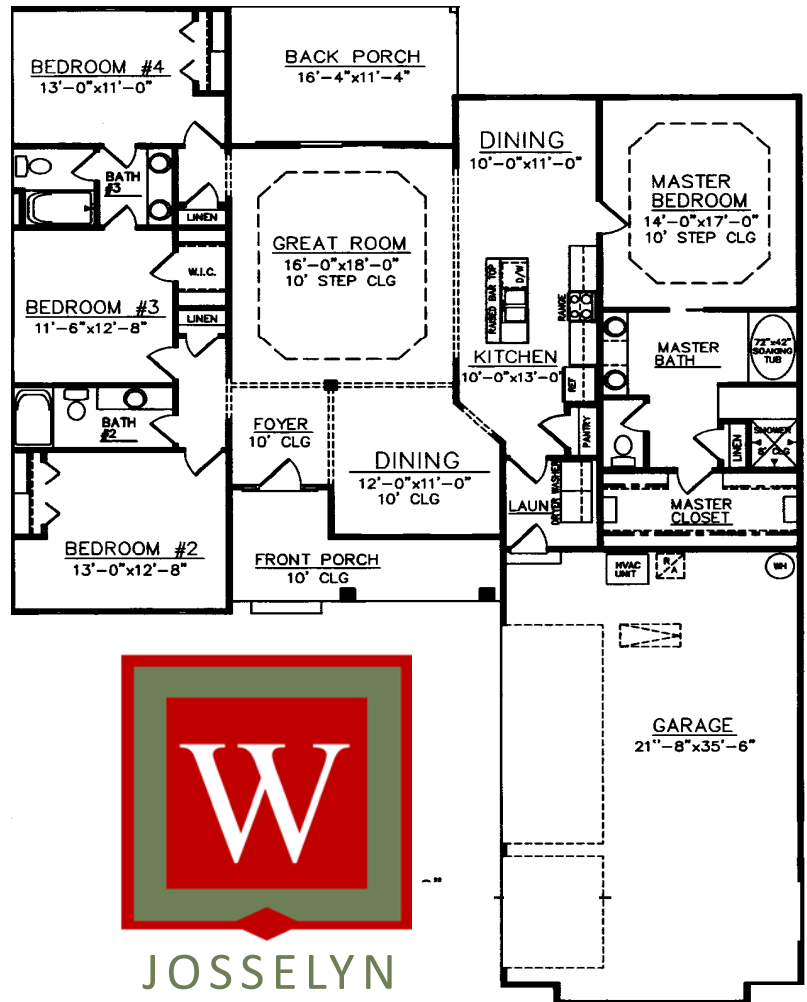

THE 2214 ISLAND PLAN OFFERED BY JOSSELYN HOMES SIGNATURE SERIES

- FOUR BEDROOM, THREE BATHROOM
- 2,214 SQFT, PER BUILDERS PLAN
- OPEN CONCEPT ISLAND KITCHEN
- SOLID SURFACE COUNTERTOPS THROUGHOUT
- PEX PLUMBING SYSTEM
- 9 FT+ CEILINGS
- CUSTOM CABINETRY
- STAINLESS STEEL APPLIANCE PACKAGE
- SQFT & PLAN ELEVATIONS MAY VARY, PER BUILDERS PLANS



**JOSSELYN
HOMES**

W.E. Josselyn III
 C: 912.222.5595
 Joss@JosselynHomes.com

P.O. Box 5793
 St. Mary's, Georgia 31558

Owner is a licensed Realtor



We can build in your neighborhood or ours. Ask us about our many floor plans or visit JosselynHomes.com for more information.

Voted Camden County's Best Builder/Contractor for 2013 and 2014.