

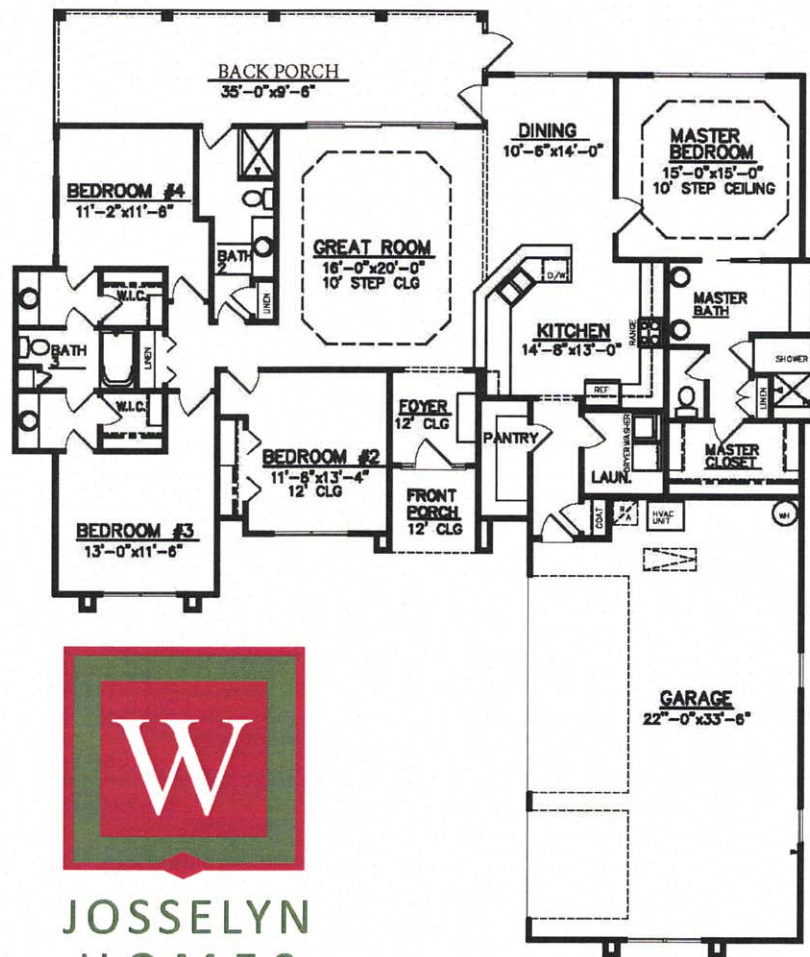

THE 2277 PLAN

JOSSELYN HOMES SIGNATURE SERIES

- FOUR BEDROOM, THREE BATH
- 2,277 SQFT, PER BUILDER'S PLANS
- OPEN CONCEPT KITCHEN
- SOLID SURFACE COUNTERTOPS THROUGHOUT
- PEX PLUMBING SYSTEM
- 9 FT.+ CEILINGS & CROWN MOULDING
- CUSTOM CABINETS
- STAINLESS STEEL APPLIANCE PACKAGE
- SQFT & PLAN ELEVATIONS MAY VARY, PER BUILDERS PLANS



JOSSELYN
HOMES

W.E. Josselyn III
C: 912.222.5595
joss@josselynhomes.com

P.O. Box 5793
St. Marys, Georgia 31558

Owner is a licensed Realtor



We can build in your neighborhood or ours. Ask us about our many floor plans or visit www.josselynhomes.com for more information.

Voted Camden County's Best Builder/Contractor for 2013 and 2014.