

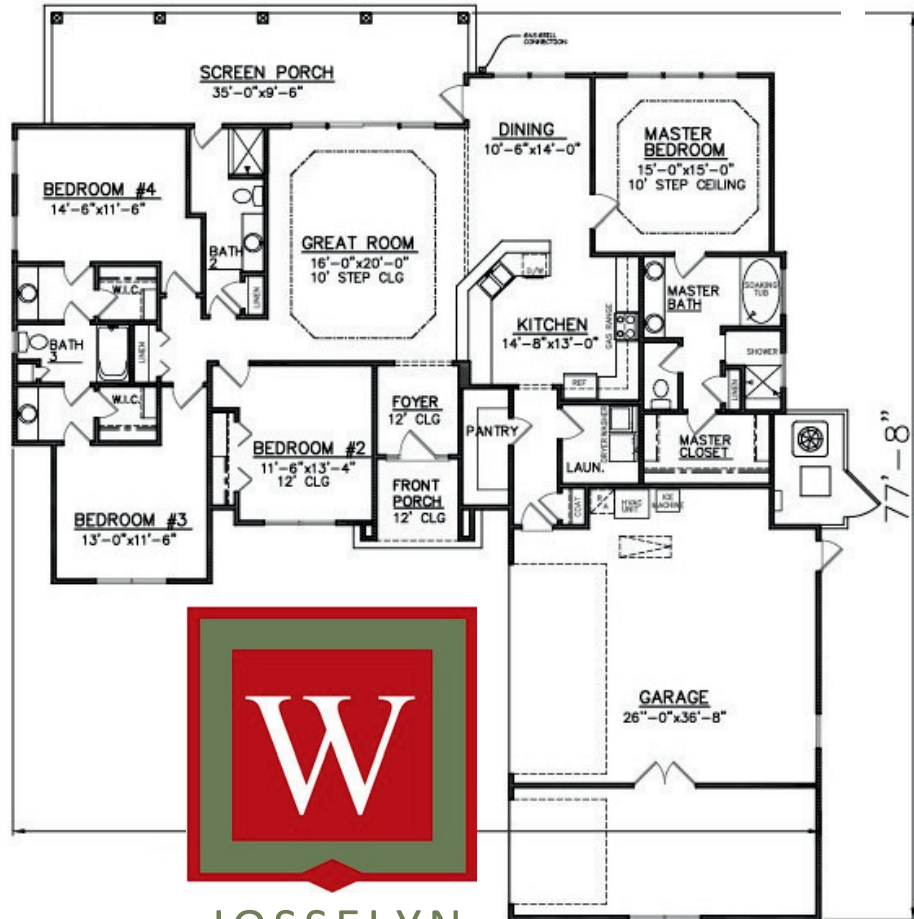

THE 2316 PLAN OFFERED BY JOSSELYN HOMES SIGNATURE SERIES

- FOUR BEDROOM, THREE BATHROOM
- 2,316 SQFT, PER BUILDERS PLAN
- OPEN CONCEPT PENINSULA KITCHEN
- SOLID SURFACE COUNTERTOPS THROUGHOUT
- PEX PLUMBING SYSTEM
- 9 FT+ CEILINGS
- CUSTOM CABINETS
- STAINLESS STEEL APPLIANCE PACKAGE
- SQFT & PLAN ELEVATIONS MAY VARY, PER BUILDERS PLANS



JOSSELYN
HOMES

W.E. Josselyn III
 C: 912.222.5595
 Joss@JosselynHomes.com
 P.O. Box 5793
 St. Mary's, Georgia 31558
 Owner is a licensed Realtor



We can build in your neighborhood or ours. Ask us about our many floor plans or visit JosselynHomes.com for more information.
 Voted Camden County's Best Builder/Contractor for 2013 and 2014.