

BMS Security Cable Installation Instructions

Tools and Components included in your package:

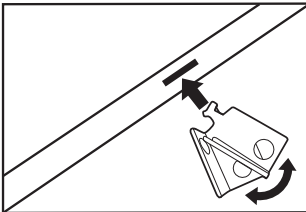

1. Insert the Micro Security Clip into the Security Slot found on your electronic device and fasten until the holes line up

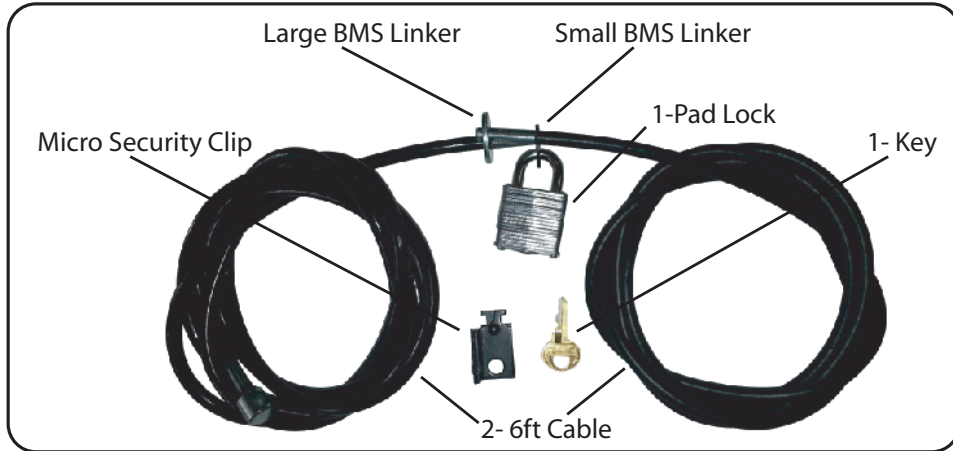
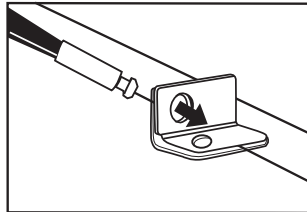

2. Thread the nipped end of the cable through the eyelet of the Security Clip

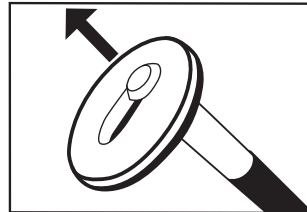

3. Slip nipped end of cable through the wider end of the Large Linker.

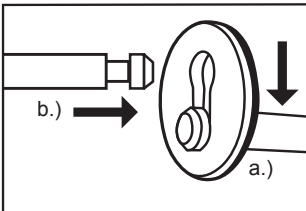

4. a.) Slide down to narrow end of keyhole. b.) Insert second cable through opened hole to interlock the cables together

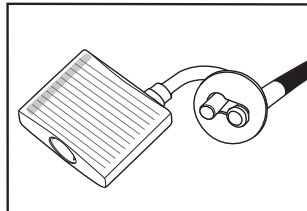

5. To complete the installation - insert the nipped end of the joined cable into Small Linker, slide down, place padlock shackle in opposite hole and fasten.

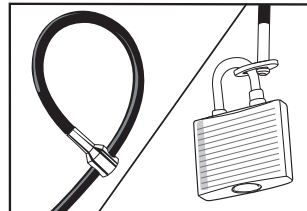

6. Note: The opposite end of the cable has a flange with a hole that will enable you to lasso the nipped end of the cable to form a loop.

BMS Security Cable Installation Instructions

Tools and Components included in your package:

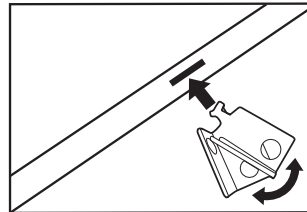
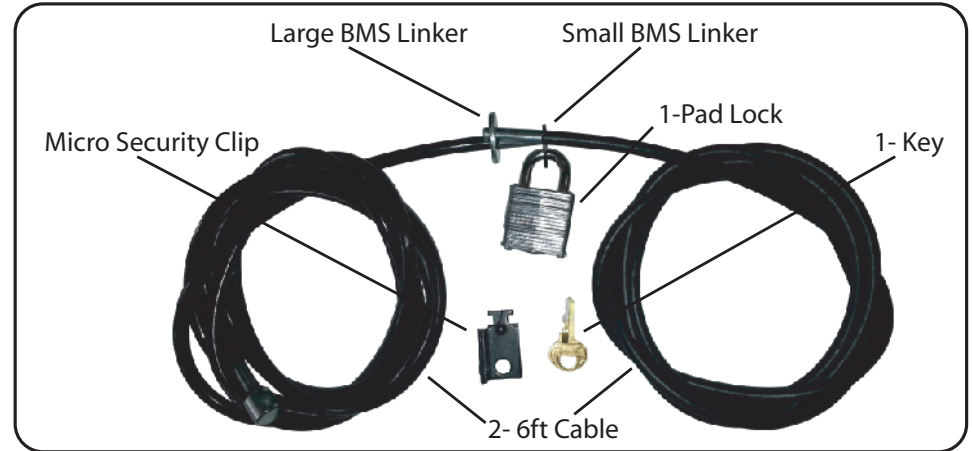

1. Insert the Micro Security Clip into the Security Slot found on your electronic device and fasten until the holes line up

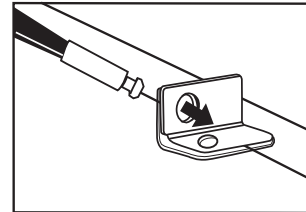

2. Thread the nipped end of the cable through the eyelet of the Security Clip

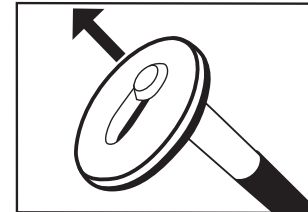

3. Slip nipped end of cable through the wider end of the Large Linker.

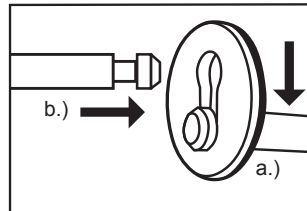

4. a.) Slide down to narrow end of keyhole. b.) Insert second cable through opened hole to interlock the cables together

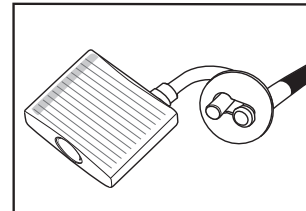

5. To complete the installation - insert the nipped end of the joined cable into Small Linker, slide down, place padlock shackle in opposite hole and fasten.

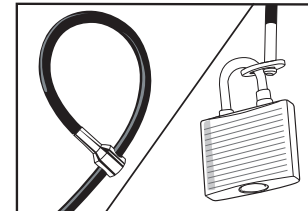

6. Note: The opposite end of the cable has a flange with a hole that will enable you to lasso the nipped end of the cable to form a loop.