



Specification Guide



May 2010

KOMATSU[®]

www.hensley-komatsu.com



15 Series Specifications

Teeth & Adapters Exclusively for Komatsu Dealers

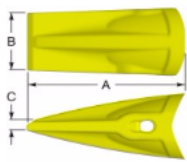

SYL
Sharp, Ribbed

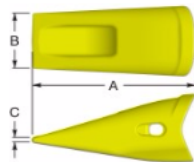

BPS
Loader

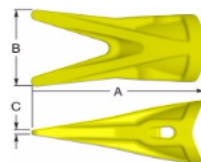

WT
Twin Tiger

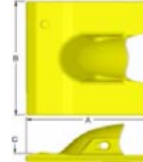

JFR
Flat, right hand

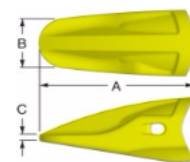

RP1 & 2
Rock Penetrator

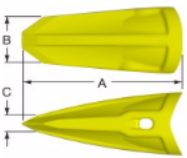

RC
Rock Chisel

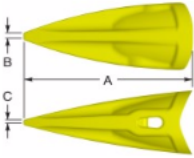

T
Tiger

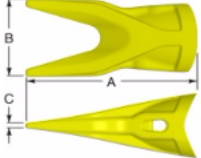

UT
Twin Tiger

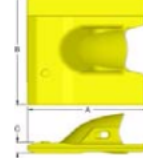

JFC
Flat, center

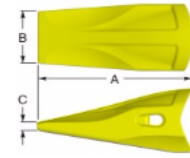

KG & KG2
General Loader

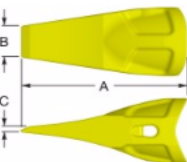

SD

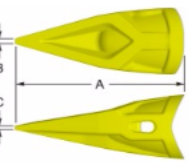

TV
Tiger

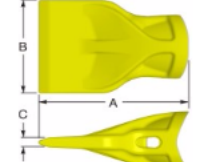

F
Flare

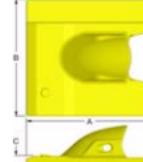

JFL
Flat, left hand

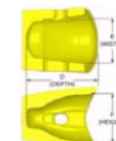

Tooth Pocket

TEETH			Dimension Inches (mm)						Weight (kg)
Kmax Series	Part Number	Pin Assembly	Overall Tooth			Tooth Pocket			
			A	B	C	D	E	F	
15	K15SYL	KP15C	8.16 (207)	3.25 (83)	0.49 (12)	3.85 (98)	2.79 (71)	2.92 (74)	7.3 (3.3)
	K15RC		8.56 (217)	2.72 (69)	0.97 (25)	3.85 (98)	2.79 (71)	2.92 (74)	8.0 (3.6)
	K15SD		8.56 (217)	1.76 (45)	0.22 (6)	3.85 (98)	2.79 (71)	2.92 (74)	7.6 (3.6)
	K15KG		8.16 (207)	3.00 (76)	0.50 (12)	3.85 (98)	2.79 (71)	2.92 (74)	9.6 (4.3)
	K15KG2		8.19 (208)	3.29 (83)	1.16 (29)	3.85 (98)	2.79 (71)	2.92 (74)	9.9 (4.5)
	K15T		8.94 (227)	0.40 (10)	0.29 (7)	3.85 (98)	2.79 (71)	2.92 (74)	6.6 (3.0)
	K15TV		8.94 (227)	0.33 (8)	0.22 (6)	3.85 (98)	2.79 (71)	2.92 (74)	6.4 (2.9)
	K15WT		8.94 (227)	4.35 (110)	0.21 (5)	3.85 (98)	2.79 (71)	2.92 (74)	6.8 (3.1)
	K15UT		8.94 (227)	4.35 (111)	0.29 (7)	3.85 (98)	2.79 (71)	2.92 (74)	7.1 (3.2)
	K15F		8.06 (204)	5.59 (142)	0.53 (13)	3.85 (98)	2.79 (71)	2.92 (74)	9.5 (4.3)
	K15BPS		8.24 (209)	3.04 (77)	0.28 (7)	3.85 (98)	2.79 (71)	2.92 (74)	10.12 (4.6)
	K15RP1		8.22 (209)	2.89 (73)	0.70 (18)	3.85 (98)	2.79 (71)	2.92 (74)	9.9 (4.5)
	K15RP2		8.50 (215)	2.85 (72)	0.37 (9)	3.85 (98)	2.79 (71)	2.92 (74)	11.4 (5.2)
	K15JFC		10.66 (271)	10.63 (270)	1.03 (26)	3.85 (98)	2.79 (71)	2.92 (74)	25.2 (11.4)
	K15JFR		10.66 (271)	10.63 (270)	1.03 (26)	3.85 (98)	2.79 (71)	2.92 (74)	27.8 (12.6)
K15JFL	10.66 (271)	10.63 (270)	1.03 (26)	3.85 (98)	2.79 (71)	2.92 (74)	27.8 (12.6)		

PIN ASSEMBLY

Duty Rating	Part Number	Dimensions Inches (mm)			Weight (kg)
		A	B	C	
Heavy Duty	KP15C	3.59 (91)	0.70 (18)	1.25 (32)	0.5 (.22)
Slag*	KP15S	3.59 (91)	0.70 (18)	1.25 (32)	0.5 (.22)

* Not reusable

Weld On Nose

Part Number	Dimensions Inches (mm)			Weight (kg)
	A	B	C	
K15WN	1.25 (32)	3.68 (94)	3.43 (87)	7.3 (3.3)

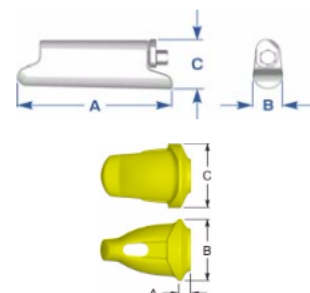

WELD-ON ADAPTERS

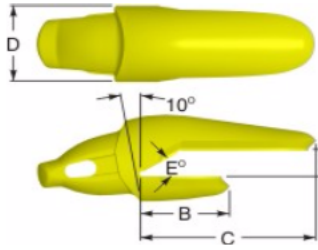

Type 1
1-1/2 Leg

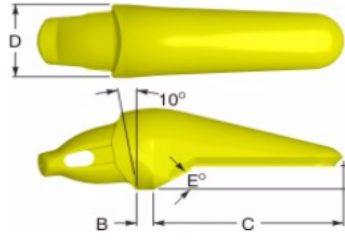

Type 2
Flush Mount

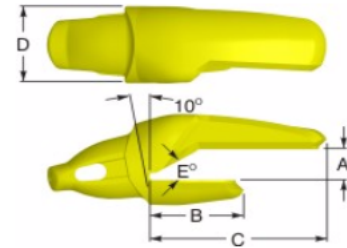

Type 3
Notched Corner

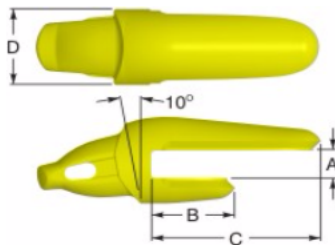

Type 5A
1-1/2 Leg Blunt

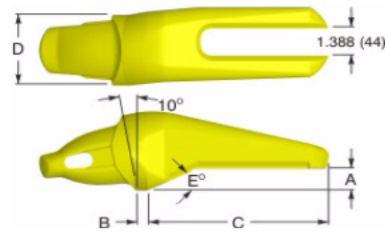

Type 9
Straddle Leg Flush Mount

ADAPTERS

Kmax Series	Part Number	Type	Dimension Inches (mm)						Weight (kg)
			A	B	C	D	E Bevel Degree	Lip Thickness	
15	K110015	1	1.06 (27)	3.88 (99)	7.32 (186)	3.43 (87)	30	1.00 (25.4)	13.1 (5.9)
	K112515	1	1.31 (33)	3.88 (99)	7.36 (187)	3.43 (87)	30	1.25 (31.7)	12.7 (5.8)
	K115015	1	1.56 (40)	3.94 (100)	7.42 (189)	3.43 (87)	30	1.50 (38.1)	12.9 (5.9)
	K1030M15	1	1.24 (31.6)	3.88 (99)	7.37 (187)	3.43 (87)	30	30mm	12.9 (5.9)
	K2025M15	2	1.04 (26.6)	0.50 (13)	8.12 (206)	3.43 (87)	30	25mm	17.5 (7.9)
	K9025M15	2	1.06 (27.0)	0.50 (13)	8.12 (206)	3.43 (87)	25	25mm	17.8 (8.1)
	K612515R	3	1.31 (33.3)	4.00 (101.6)	7.50 (191)	3.43 (87)	30	1.25 (31.7)	14.5 (6.6)
	K612515L	3	1.31(33.3)	4.00 (101.6)	7.50 (191)	3.43 (87)	30	1.25 (31.7)	14.5 (6.6)
	K8025M15	1	1.06 (27)	3.87 (98)	7.25 (184)	3.43 (87)	25	25mm	13.5 (6.1)
	K8030M15	1	1.27 (32)	3.78 (98)	7.37 (187)	3.43 (87)	25	30mm	13.6 (6.1)
	K9025M15CL	9	1.05 (26.6)	0.50 (13)	5.79 (147)	3.43 (87)	25	25mm	20.0 (9.1)
	K9025M15CR	9	1.05 (26.6)	0.50 (13)	5.79 (147)	3.43 (87)	25	25mm	20.0 (9.1)
K5036M15	5A	1.50 (38)	4.05 (102)	7.65 (194)	3.68 (94)	Blunt	36mm	13.6 (6.1)	



15 Series Specifications

BOLT-ON ADAPTERS - WA180

K3025M15

Center
1.0" Lip, 18.9 lb., (8.6 kg.)
Plow Bolt Assembly: AC78-312

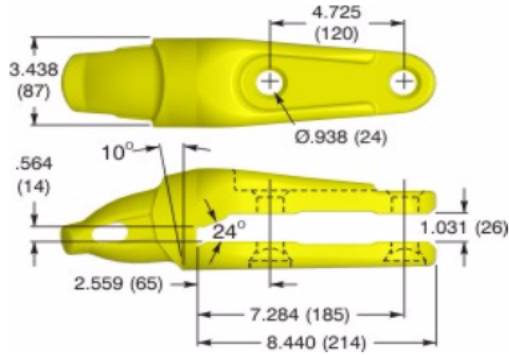

K3025M15R (L)

LH opposite
1.0" Lip, 17.3 lb., (7.8 kg.)
Plow Bolt Assembly: AC78-312 & AC78-200

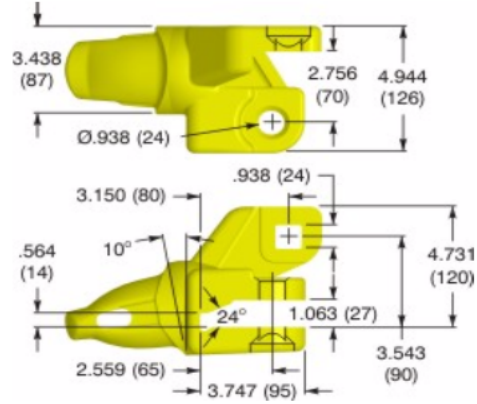

Hensley Industries, Inc.
2108 Joe Field Road . Dallas, Texas 75229 U.S.A.
Customer Service
(888) 406 - 6262 U.S./Canada . (972) 406 - 6262 all other locations
Hensley Attachments
A Division of Hensley Industries, Inc.
800 South Fifth . Mansfield, Texas 76063 U.S.A.
(800) 433 - 3144 . (817) 477 - 3167



Authorized Dealer

SAFETY FIRST: Hensley Industries, Inc. recommends that you use a soft-faced hammer and ANSI-approved (Z87.1) eye protection while using our products.
Copyright © 2010 Hensley Industries, Inc.
This publication is protected under the copyright laws of the United States. Unauthorized duplication or distribution is prohibited.



20 Series Specifications

Teeth & Adapters Exclusively for Komatsu Dealers

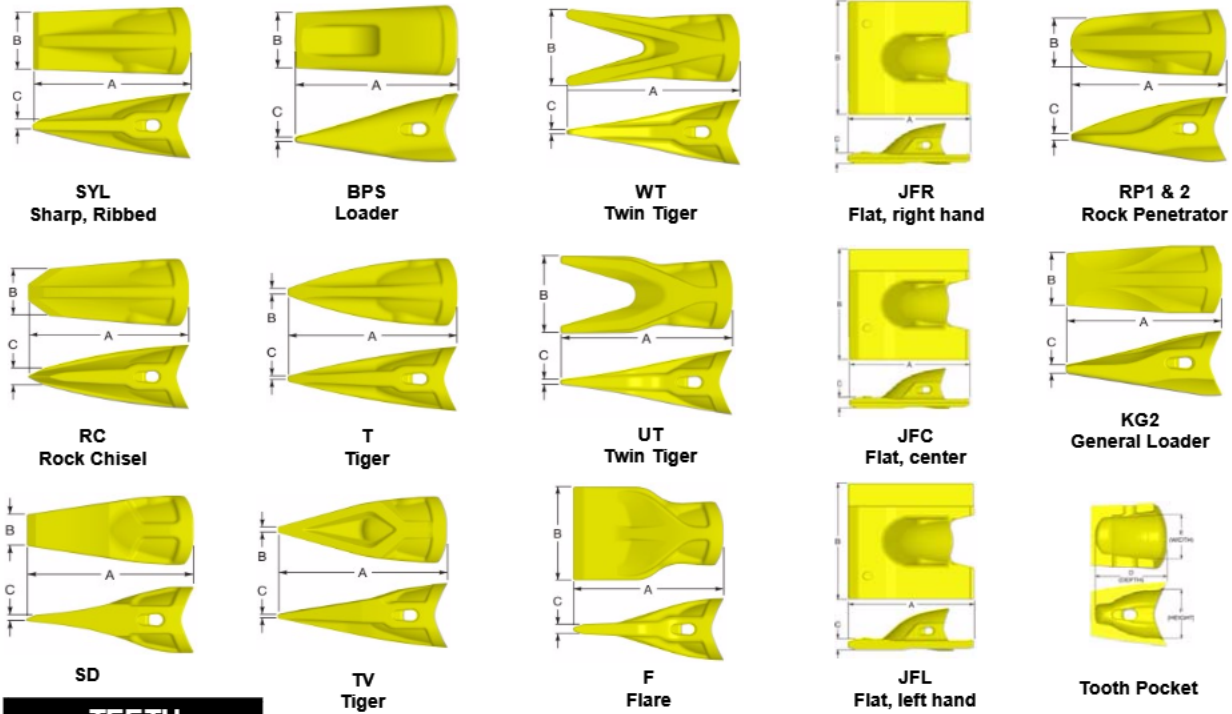

TEETH			Dimension Inches (mm)						Weight (kg)
Kmax Series	Part Number	Pin Assembly	Overall Tooth			Tooth Pocket			
			A	B	C	D	E	F	
20	K20SYL	KP20C	9.25 (235)	3.69 (94)	0.55 (14)	4.36 (111)	3.17 (81)	3.31 (84)	10.8 (4.9)
	K20RC		9.72 (247)	3.09 (79)	1.10 (28)	4.36 (111)	3.17 (81)	3.31 (84)	11.1 (5.0)
	K20SD		9.72 (247)	2.00 (51)	0.25 (6)	4.36 (111)	3.17 (81)	3.31 (84)	11.5 (5.2)
	K20T		10.15 (258)	0.45 (11)	0.33 (8)	4.36 (111)	3.17 (81)	3.31 (84)	10.2 (4.6)
	K20TV		10.15 (258)	0.37 (9)	0.25 (6)	4.36 (111)	3.17 (81)	3.31 (84)	9.6 (4.3)
	K20WT		10.15 (258)	4.94 (126)	0.24 (6)	4.36 (111)	3.17 (81)	3.31 (84)	10.9 (4.9)
	K20UT		10.15 (258)	4.94 (126)	0.33 (8)	4.36 (111)	3.17 (81)	3.31 (84)	10.9 (4.9)
	K20F		9.15 (233)	6.34 (161)	0.66 (17)	4.36 (111)	3.17 (81)	3.31 (84)	15.7 (7.1)
	K20BPS		9.34 (237)	3.45 (88)	0.32 (8)	4.36 (111)	3.17 (81)	3.31 (84)	15.0 (6.8)
	K20KG2		9.26 (235)	3.60 (91)	0.56 (14)	4.36 (111)	3.17 (81)	3.31 (84)	15.8 (7.2)
	K20RP1		9.31 (237)	3.28 (83)	0.42 (11)	4.36 (111)	3.17 (81)	3.31 (84)	14.0 (6.4)
	K20RP2		9.68 (246)	3.28 (83)	0.42 (11)	4.36 (111)	3.17 (81)	3.31 (84)	17.3 (7.8)
	K20JFC		11.78 (299)	10.59 (269)	10.14 (29)	4.36 (111)	3.17 (81)	3.31 (84)	31.1 (14.1)
	K20JFR		11.78 (299)	10.59 (269)	10.14 (29)	4.36 (111)	3.17 (81)	3.31 (84)	35.3 (16.0)
K20JFL	11.78 (299)	10.59 (269)	10.14 (29)	4.36 (111)	3.17 (81)	3.31 (84)	35.3 (16.0)		

PIN ASSEMBLY

Duty Rating	Part Number	Dimensions Inches (mm)			Weight (kg)
		A	B	C	
Heavy Duty	KP20C	4.06 (103)	0.80 (20)	1.43 (36)	0.8 (36)
Slag*	KP20S	4.06 (103)	0.80 (20)	1.43 (36)	0.8 (36)

* Not reusable

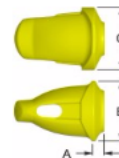
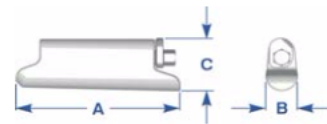

Weld On Nose

Part Number	Dimensions Inches (mm)			Weight (kg)
	A	B	C	
K20WN	1.37 (34)	4.19 (106)	1.43 (36)	8.5 (3.9)

WELD-ON ADAPTERS

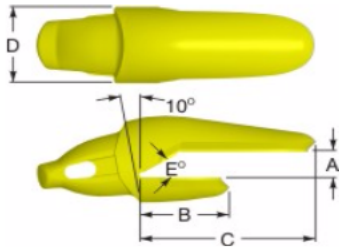

Type 1
1-1/2 Leg

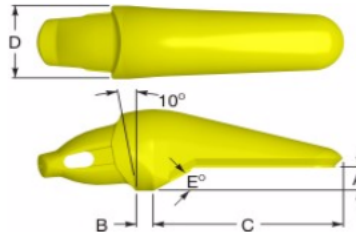

Type 2
Flush Mount

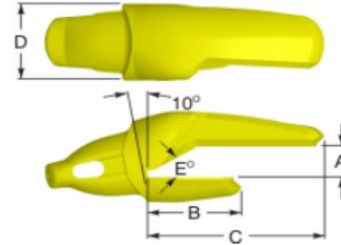

Type 3
Notched Corner

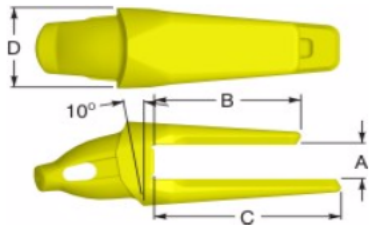

Type 5
1-1/2 Leg Blunt

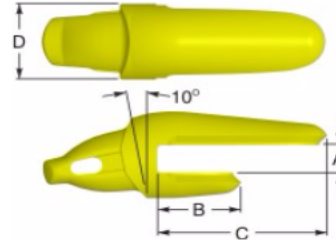

Type 5A
1-1/2 Leg Blunt

ADAPTERS

Kmax Series	Part Number	Type	Dimension Inches (mm)						Weight (kg)
			A	B	C	D	E Bevel Degree	Lip Thickness	
20	K112520	1	1.31 (33.4)	4.18 (106)	8.23 (209)	3.94 (100)	30	1.25 (31.7)	18.0 (8.2)
	K612520R	3	1.31 (33.4)	4.56 (116)	8.50 (216)	3.94 (100)	30	1.25 (31.7)	21.8 (9.9)
	K612520L	3	1.31 (33.4)	4.56 (116)	8.50 (216)	3.94 (100)	30	1.25 (31.7)	21.8 (9.9)
	K115020	1	1.56 (39.7)	4.27 (108)	8.22 (209)	3.94 (100)	30	1.50 (38.1)	17.8 (8.1)
	K615020R	3	1.56 (39.7)	4.41 (110)	8.38 (213)	3.94 (100)	30	1.50 (38.1)	20.8 (9.4)
	K615020L	3	1.56 (39.7)	4.41 (110)	8.38 (213)	3.94 (100)	30	1.50 (38.1)	20.8 (9.4)
	K1030M20	1	1.24 (31.6)	4.22 (107)	8.28 (210)	3.94 (100)	30	30mm	19.8 (9.0)
	K1040M20	1	1.63 (41.6)	4.28 (109)	8.22 (209)	3.94 (100)	30	40mm	17.7 (8.0)
	K2030M20	2	1.24 (31.6)	0.88 (22)	9.31 (237)	3.94 (100)	30	30mm	24.4 (11.1)
	K5035M20	5A	1.44 (36.6)	4.00 (102)	8.00 (203)	3.94 (100)	Blunt	35mm	19.6 (8.9)
	K5040M20	5	1.66 (42.3)	6.50 (165)	8.27 (210)	3.94 (100)	Blunt	40mm	19.3 (8.8)
	K9030M20	2	1.25 (31.8)	0.88 (22)	9.31 (237)	3.94 (100)	25	30mm	25.4 (11.5)
	K8030M20	1	1.27 (32.3)	4.22 (107)	8.28 (210)	3.94 (100)	25	30mm	18.0 (8.2)
	K8035M20	1	1.44 (36.6)	4.38 (111)	8.38 (213)	3.94 (100)	25	35mm	18.3 (8.3)
	K9030M20CL	2	1.24 (31.6)	0.88 (22)	9.14 (232)	3.94 (100)	25	30mm	29.0 (13.2)
K9030M20CR	2	1.24 (31.6)	0.88 (22)	9.14 (232)	3.94 (100)	25	30mm	29.0 (13.2)	



TM

20 Series Specifications

BOLT-ON ADAPTERS - WA250, WA320

K3028M20

Center
28mm Lip, 25.6 lb., (11.6kg.)
Plow Bolt Assembly: AC10-334

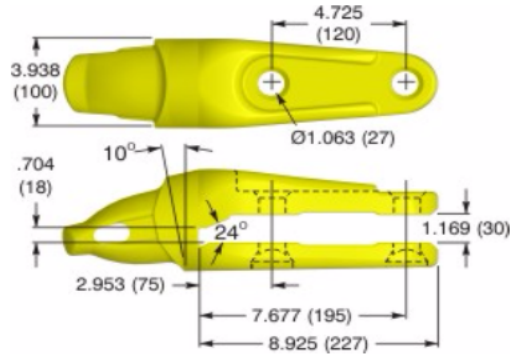

K3028M20R (L)

LH opposite
28mm Lip, 22.2 lb., (10.1kg.)
Plow Bolt Assembly: AC10-334 & AC10-200

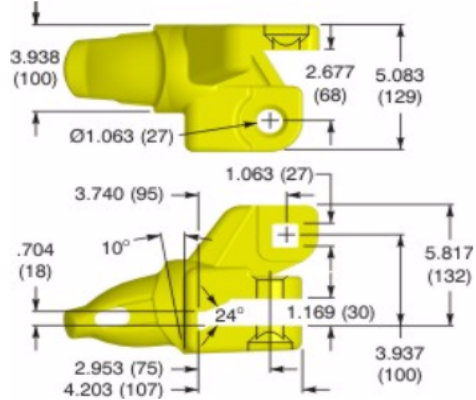

Authorized Dealer

Hensley Industries, Inc.
2108 Joe Field Road . Dallas, Texas 75229 U.S.A.
Customer Service
(888) 406 - 6262 U.S./Canada . (972) 406 - 6262 all other locations
Hensley Attachments
A Division of Hensley Industries, Inc.
800 South Fifth . Mansfield, Texas 76063 U.S.A.
(800) 433 - 3144 . (817) 477 - 3167



SAFETY FIRST: Hensley Industries, Inc. recommends that you use a soft-faced hammer and ANSI-approved (Z87.1) eye protection while using our products.
Copyright © 2010 Hensley Industries, Inc.
This publication is protected under the copyright laws of the United States. Unauthorized duplication or distribution is prohibited.



25 Series Specifications

Teeth & Adapters Exclusively for Komatsu Dealers

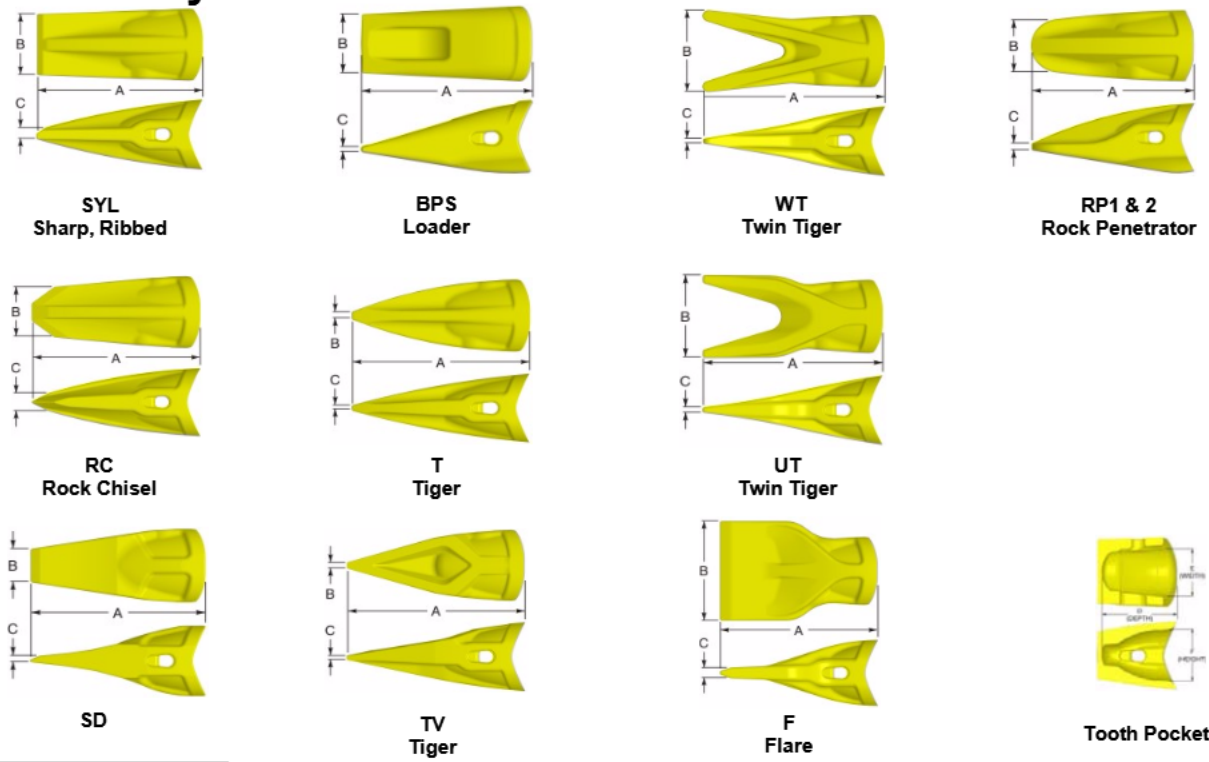

TEETH		Pin Assembly	Dimension Inches (mm)						Weight (kg)
Kmax Series	Part Number		Overall Tooth			Tooth Pocket			
			A	B	C	D	E	F	
25	K25SYL	KP25C	10.50 (267)	4.19 (106)	0.62 (16)	4.97 (126)	3.61 (92)	3.76 (96)	15.4 (7.0)
	K25RC		11.00 (279)	3.50 (89)	1.25 (31)	4.97 (126)	3.61 (92)	3.76 (96)	16.7 (7.6)
	K25SD		11.00 (279)	2.27 (58)	0.28 (7)	4.97 (126)	3.61 (92)	3.76 (96)	15.9 (7.2)
	K25T		11.50 (292)	0.52 (13)	0.38 (10)	4.97 (126)	3.61 (92)	3.76 (96)	14.4 (6.5)
	K25TV		11.50 (292)	0.42 (11)	0.29 (7)	4.97 (126)	3.61 (92)	3.76 (96)	13.9 (6.3)
	K25WT		11.50 (292)	5.60 (142)	0.27 (7)	4.97 (126)	3.61 (92)	3.76 (96)	15.2 (6.9)
	K25UT		11.50 (292)	5.60 (142)	0.37 (10)	4.97 (126)	3.61 (92)	3.76 (96)	15.3 (7.9)
	K25F		10.38 (264)	7.19 (183)	0.69 (17)	4.97 (126)	3.61 (92)	3.76 (96)	22.2 (10.1)
	K25BPS		10.50 (267)	3.92 (100)	0.37 (9)	4.97 (126)	3.61 (92)	3.76 (96)	21.9 (9.9)
	K25RP1		10.56 (268)	3.73 (95)	0.91 (23)	4.97 (126)	3.61 (92)	3.76 (96)	20.2 (9.2)
	K25RP2		11.00 (279)	3.72 (95)	0.48 (12)	4.97 (126)	3.61 (92)	3.76 (96)	25.8 (11.7)

PIN ASSEMBLY		Part Number	Dimensions Inches (mm)			Weight (kg)
Duty Rating			A	B	C	
Standard Duty		KP25C	4.62 (117)	0.91 (23)	1.60 (41)	1.1 (.5)
Slag*		KP25S	4.62 (117)	0.91 (23)	1.60 (41)	1.1 (.5)

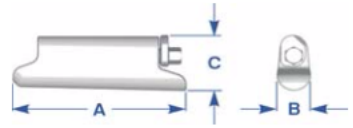

* Not reusable

Weld On Nose		K25WN	Dimensions Inches (mm)			Weight (kg)
			A	B	C	
			1.56 (40)	4.75 (121)	4.50 (114)	15.1 (6.9)

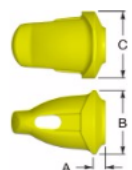



25 Series Specifications

BOLT-ON ADAPTERS - WA380,WA420, WA450

K3036M25

Center
36mm Lip, 31.8 lb., (14.4 kg.)
Plow Bolt Assembly: AC78-400

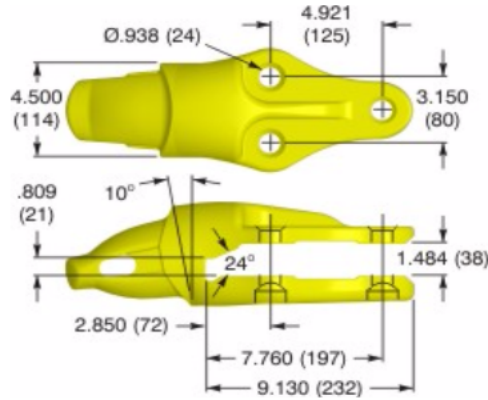

K3036M25R (L)

LH opposite
36mm Lip, 37.5 lb., (17.0kg.)
Plow Bolt Assembly: AC78-400

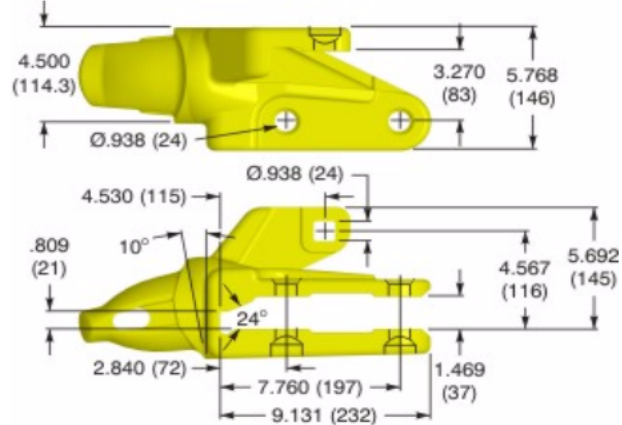

Hensley Industries, Inc.
2108 Joe Field Road . Dallas, Texas 75229 U.S.A.
Customer Service
(888) 406 - 6262 U.S./Canada . (972) 406 - 6262 all other locations
Hensley Attachments
A Division of Hensley Industries, Inc.
800 South Fifth . Mansfield, Texas 76063 U.S.A.
(800) 433 - 3144 . (817) 477 - 3167



Authorized Dealer

SAFETY FIRST: Hensley Industries, Inc. recommends that you use a soft-faced hammer and ANSI-approved (Z87.1) eye protection while using our products.
Copyright © 2010 Hensley Industries, Inc.

This publication is protected under the copyright laws of the United States. Unauthorized duplication or distribution is prohibited.



30 Series Specifications

Teeth & Adapters Exclusively for Komatsu Dealers

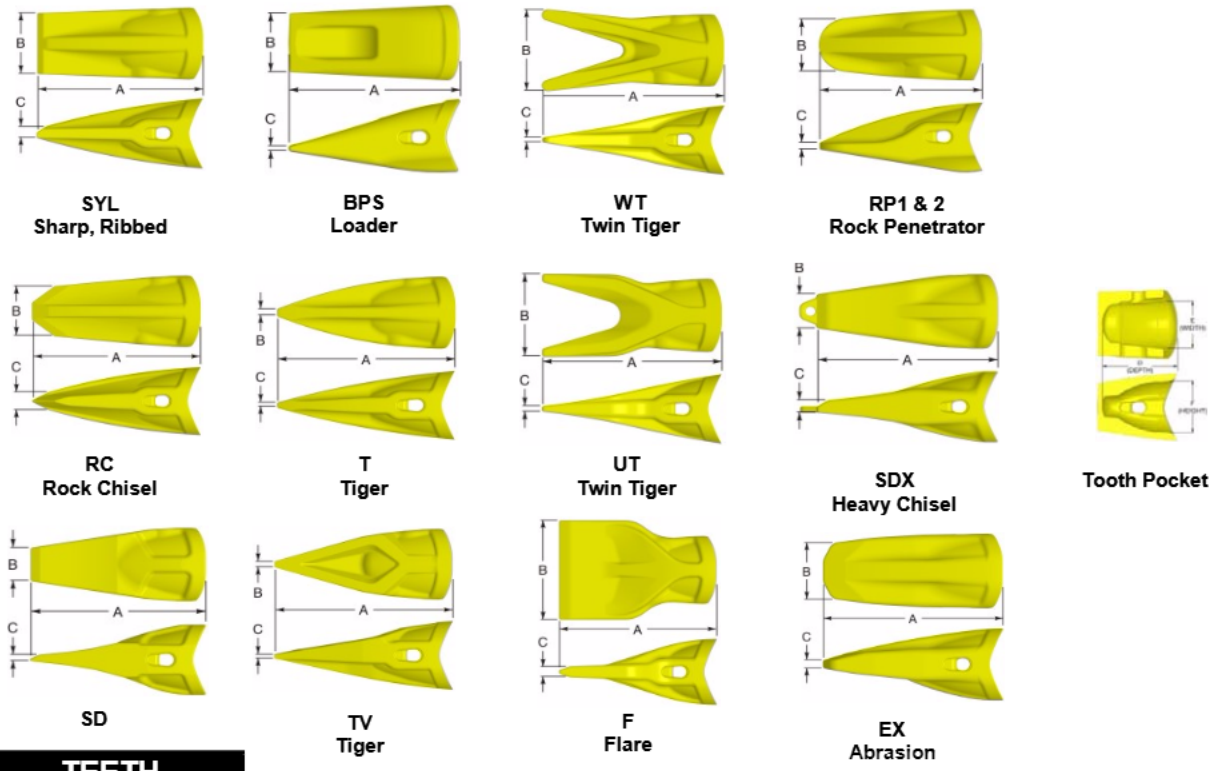

TEETH		Pin Assembly	Dimension Inches (mm)						Weight (kg)
Kmax Series	Part Number		Overall Tooth			Tooth Pocket			
			A	B	C	D	E	F	
30	K30SYL	KP30C	11.61 (295)	4.63 (118)	0.69 (18)	5.49 (140)	3.99 (101)	4.16 (106)	21.2 (9.6)
	K30RC		12.19 (310)	3.87 (98)	1.38 (35)	5.49 (140)	3.99 (101)	4.16 (106)	22.1 (10.0)
	K30SD		12.31 (313)	2.50 (64)	0.31 (8)	5.49 (140)	3.99 (101)	4.16 (106)	25.1 (11.4)
	K30T		12.71 (323)	0.57 (14)	0.41 (10)	5.49 (140)	3.99 (101)	4.16 (106)	19.4 (8.8)
	K30TV		12.71 (323)	0.47 (12)	0.31 (8)	5.49 (140)	3.99 (101)	4.16 (106)	18.8 (8.5)
	K30WT		12.71 (323)	6.20 (157)	0.30 (8)	5.49 (140)	3.99 (101)	4.16 (106)	19.2 (8.7)
	K30UT		12.70 (323)	6.20 (157)	0.41 (11)	5.49 (140)	3.99 (101)	4.16 (106)	20.5 (9.3)
	K30F		11.47 (291)	7.95 (202)	0.83 (21)	5.49 (140)	3.99 (101)	4.16 (106)	31.1 (14.3)
	K30BPS		11.60 (295)	4.33 (110)	0.40 (10)	5.49 (140)	3.99 (101)	4.16 (106)	29.1 (13.2)
	K30SDX		12.56 (319)	2.50 (63)	0.87 (22)	5.49 (140)	3.99 (101)	4.16 (106)	25.2 (11.4)
	K30EX		12.31 (312)	4.12 (105)	0.59 (15)	5.49 (140)	3.99 (101)	4.16 (106)	28.1 (12.8)
	K30RP1		11.69 (297)	4.11 (105)	1.00 (25)	5.49 (140)	3.99 (101)	4.16 (106)	27.3 (12.4)
	K30RP2		12.12 (308)	4.09 (104)	0.53 (13)	5.49 (140)	3.99 (101)	4.16 (106)	34.5 (15.6)

PIN ASSEMBLY		Part Number	Dimensions Inches (mm)			Weight (kg)
Duty Rating			A	B	C	
Heavy Duty		KP30C	5.12 (130)	1.00 (25)	1.77 (45)	1.5 (.68)
Slag*		KP30S	5.12 (130)	1.00 (25)	1.77 (45)	1.5 (.68)

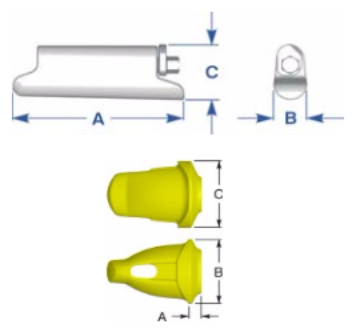

Weld On Nose		Part Number	Dimensions Inches (mm)			Weight (kg)
			A	B	C	
		K30WN	1.75 (44)	5.25 (133)	4.94 (125)	20.1 (9.1)

* Not reusable



30 Series Specifications

WELD-ON ADAPTERS

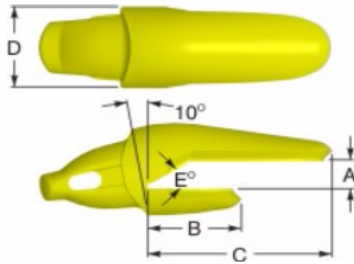

Type 1
1-1/2 Leg

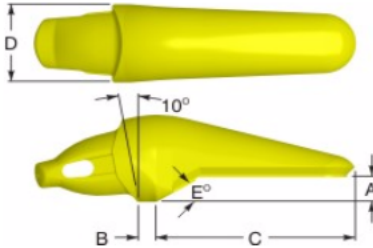

Type 2
Flush Mount

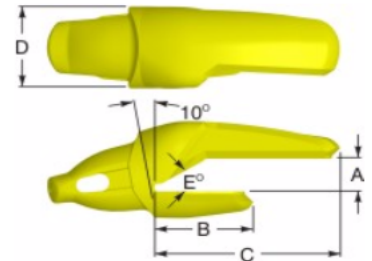

Type 3
Notched Corner

ADAPTERS									
Kmax Series	Part Number	Type	Dimension Inches (mm)						Weight (kg)
			A	B	C	D	E Bevel Degree	Lip Thickness	
30	K117530	1	1.81 (46)	5.03 (128)	10.16 (258)	4.94 (125)	30	1.75 (44.5)	35.3 (16.0)
	K120030	1	2.09 (53)	4.96 (126)	10.07 (256)	4.94 (125)	30	2.00 (50.8)	34.2 (15.5)
	K620030R	3	2.09 (53)	5.25 (133)	10.50 (267)	4.94 (125)	30	2.00 (50.8)	38.2 (17.3)
	K620030L	3	2.09 (53)	5.25 (133)	10.50 (267)	4.94 (125)	30	2.00 (50.8)	38.2 (17.3)
	K1040M30	1	1.64 (42)	5.04 (128)	10.16 (258)	4.94 (125)	30	40mm	38.6 (17.5)
	*K1040M30R	1	1.64 (42)	5.56 (141)	10.50 (267)	4.94 (125)	30	40mm	41.3 (18.7)
	*K1040M30L	1	1.64 (42)	5.56 (141)	10.50 (267)	4.94 (125)	30	40mm	41.3 (18.7)
	K1045M30	1	1.83 (47)	4.92 (125)	10.03 (254)	4.94 (125)	30	45mm	38.8 (17.6)
	K2040M30	2	1.64 (47)	0.69 (17)	11.56 (294)	4.94 (125)	30	40mm	46.4 (21.1)
	K1050M30	1	2.06 (52)	4.90 (125)	10.01 (254)	4.94 (125)	30	50mm	43.5 (19.7)
	K8040M30	2	1.64 (42)	5.04 (128)	10.16 (258)	4.94 (125)	25	40mm	38.9 (17.6)
	K8050M30	1	2.08 (53)	4.94 (125)	10.09 (256)	4.94 (125)	25	50mm	35.8 (16.2)
	K9040M30	2	1.67 (42)	0.69 (17)	11.56 (294)	4.94 (125)	25	40mm	47.6 (21.6)
	K9050M30	2	2.00 (51)	0.69 (17)	11.75 (298)	4.94 (125)	25	50mm	48.8 (22.1)
	-	-	-	-	-	-	-	-	-
	-	-	-	-	-	-	-	-	-
	-	-	-	-	-	-	-	-	-
-	-	-	-	-	-	-	-	-	

* Used On Spade Lip - 12° Angle

Hensley Industries, Inc.
2108 Joe Field Road . Dallas, Texas 75229 U.S.A.

Customer Service
(888) 406 - 6262 U.S./Canada . (972) 406 - 6262 all other locations

Hensley Attachments
A Division of Hensley Industries, Inc.
800 South Fifth . Mansfield, Texas 76063 U.S.A.
(800) 433 - 3144 . (817) 477 - 3167



Authorized Dealer

SAFETY FIRST: Hensley Industries, Inc. recommends that you use a soft-faced hammer and ANSI-approved (Z87.1) eye protection while using our products.
Copyright © 2010 Hensley Industries, Inc.

This publication is protected under the copyright laws of the United States. Unauthorized duplication or distribution is prohibited.



40 Series Specifications

Teeth & Adapters Exclusively for Komatsu Dealers

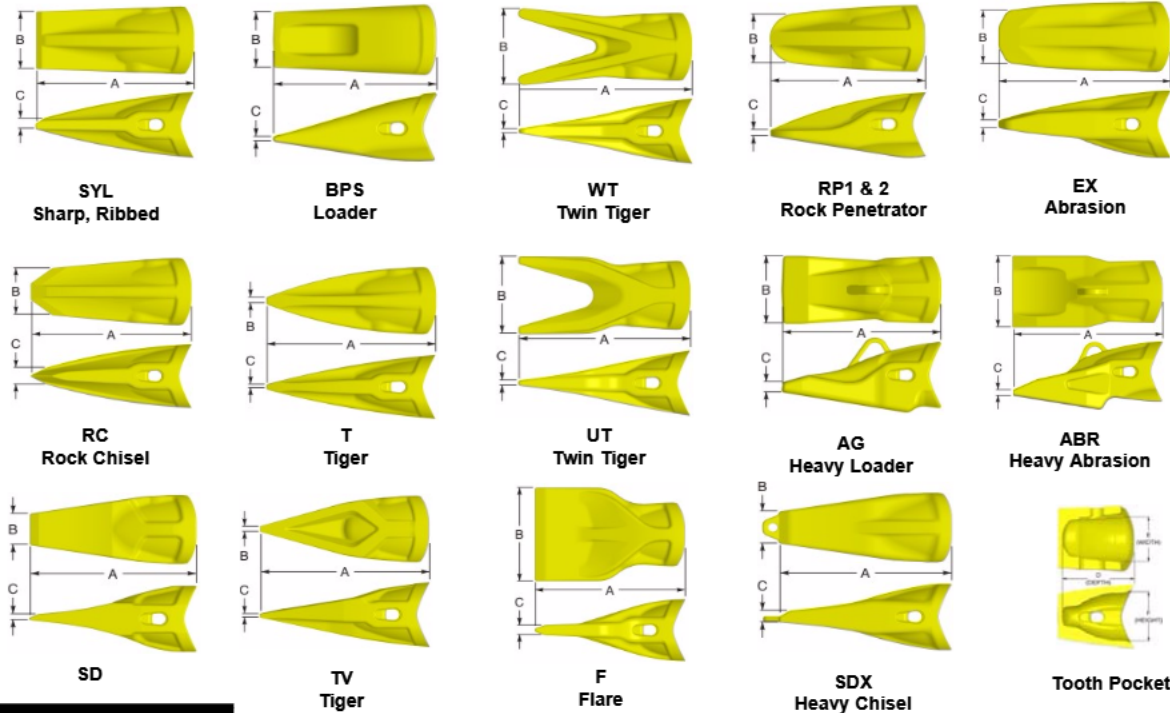

TEETH		Pin Assembly	Dimension Inches (mm)						Weight (kg)
Kmax Series	Part Number		Overall Tooth			Tooth Pocket			
			A	B	C	D	E	F	
40	K40SYL	KP40C	12.50 (318)	5.00 (127)	0.79 (20)	5.85 (149)	4.23 (108)	4.42 (112)	26.8 (12.2)
	K40RC		13.12 (333)	4.31 (110)	1.56 (40)	5.85 (149)	4.23 (108)	4.42 (112)	27.7 (12.6)
	K40SD		13.12 (333)	2.67 (68)	0.33 (8)	5.85 (149)	4.23 (108)	4.42 (112)	29.4 (13.3)
	K40T		13.56 (345)	0.61 (15)	0.44 (11)	5.85 (149)	4.23 (108)	4.42 (112)	24.4 (11.1)
	K40TV		13.58 (345)	0.50 (13)	0.34 (9)	5.85 (149)	4.23 (108)	4.42 (112)	23.1 (10.5)
	K40WT		13.56 (345)	6.60 (168)	0.32 (8)	5.85 (149)	4.23 (108)	4.42 (112)	23.2 (10.5)
	K40UT		13.56 (345)	6.60 (168)	0.44 (11)	5.85 (149)	4.23 (108)	4.42 (112)	25.8 (11.7)
	K40F		12.25 (311)	8.47 (215)	0.81 (21)	5.85 (149)	4.23 (108)	4.42 (112)	34.6 (15.7)
	K40AG		13.01 (330)	5.92 (150)	0.89 (22)	5.85 (149)	4.23 (108)	4.42 (112)	44.3 (20.1)
	K40BPS		12.44 (316)	4.62 (117)	0.41 (10)	5.85 (149)	4.23 (108)	4.42 (112)	32.9 (14.9)
	K40SDX		13.39 (340)	2.66 (68)	0.93 (24)	5.85 (149)	4.23 (108)	4.42 (112)	30.6 (13.9)
	K40RP1		12.48 (317)	4.38 (111)	0.56 (14)	5.85 (149)	4.23 (108)	4.42 (112)	33.5 (15.2)
	K40RP2		12.87 (327)	4.34 (110)	0.56 (14)	5.85 (149)	4.23 (108)	4.42 (112)	39.8 (18.1)
	K40EX		Future Development						
K40ABR	Future Development								

PIN ASSEMBLY

Duty Rating	Part Number	Dimensions Inches (mm)			Weight (kg)
		A	B	C	
Heavy Duty	KP40C	5.44 (138)	1.06 (27)	1.89 (48)	1.8 (.82)
Slag*	KP40S	5.44 (138)	1.06 (27)	1.89 (48)	1.8 (.82)

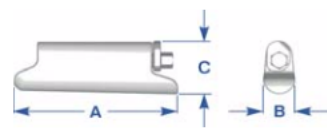

* Not reusable

Weld On Nose

Part Number	Dimensions Inches (mm)			Weight (kg)
	A	B	C	
K40WN	0.91 (23)	5.06 (129)	5.28 (134)	34.7 (15.7)

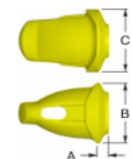



40 Series Specifications

BOLT-ON ADAPTERS - WA500

K3040M40

Center
40mm Lip, 56.0 lb., (25.4 kg.)
Plow Bolt Assembly: AC10-412

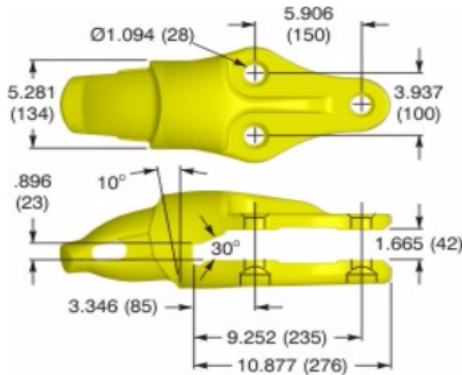

K3040M40R (L)

LH opposite
40mm Lip, 61.0 lb., (27.7 kg.)
Plow Bolt Assembly: (2) AC10-412 & (1) AC114-400

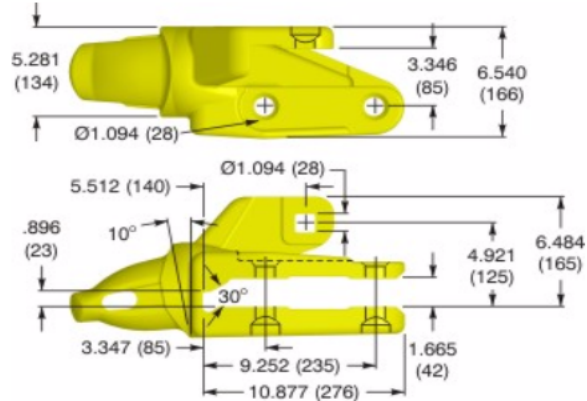

K317540

Center
1.75" Lip, 61.0 lb., (27.7 kg.)
Plow Bolt Assembly: AC10-475

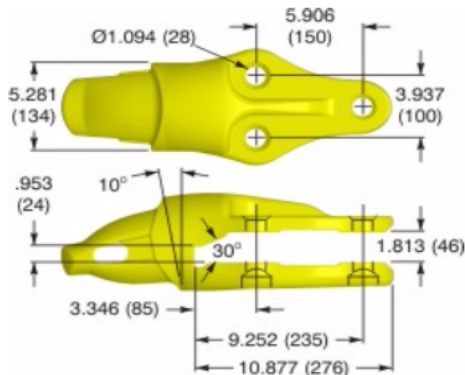

K317540R (L)

LH opposite
1.75" Lip, 63.0 lb., (28.9 kg.)
Plow Bolt Assembly: (2) AC10-475 & (1) AC10-450

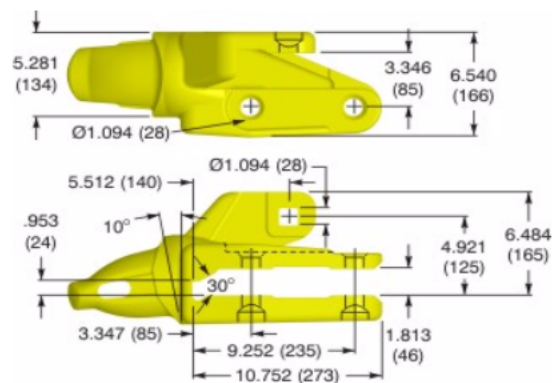

Authorized Dealer

Hensley Industries, Inc.
2108 Joe Field Road . Dallas, Texas 75229 U.S.A.
Customer Service
(888) 406 - 6262 U.S./Canada . (972) 406 - 6262 all other locations
Hensley Attachments
A Division of Hensley Industries, Inc.
800 South Fifth . Mansfield, Texas 76063 U.S.A.
(800) 433 - 3144 . (817) 477 - 3167



SAFETY FIRST: Hensley Industries, Inc. recommends that you use a soft-faced hammer and ANSI-approved (Z87.1) eye protection while using our products.
Copyright © 2010 Hensley Industries, Inc.
This publication is protected under the copyright laws of the United States. Unauthorized duplication or distribution is prohibited.



50 Series Specifications

Teeth & Adapters Exclusively for Komatsu Dealers

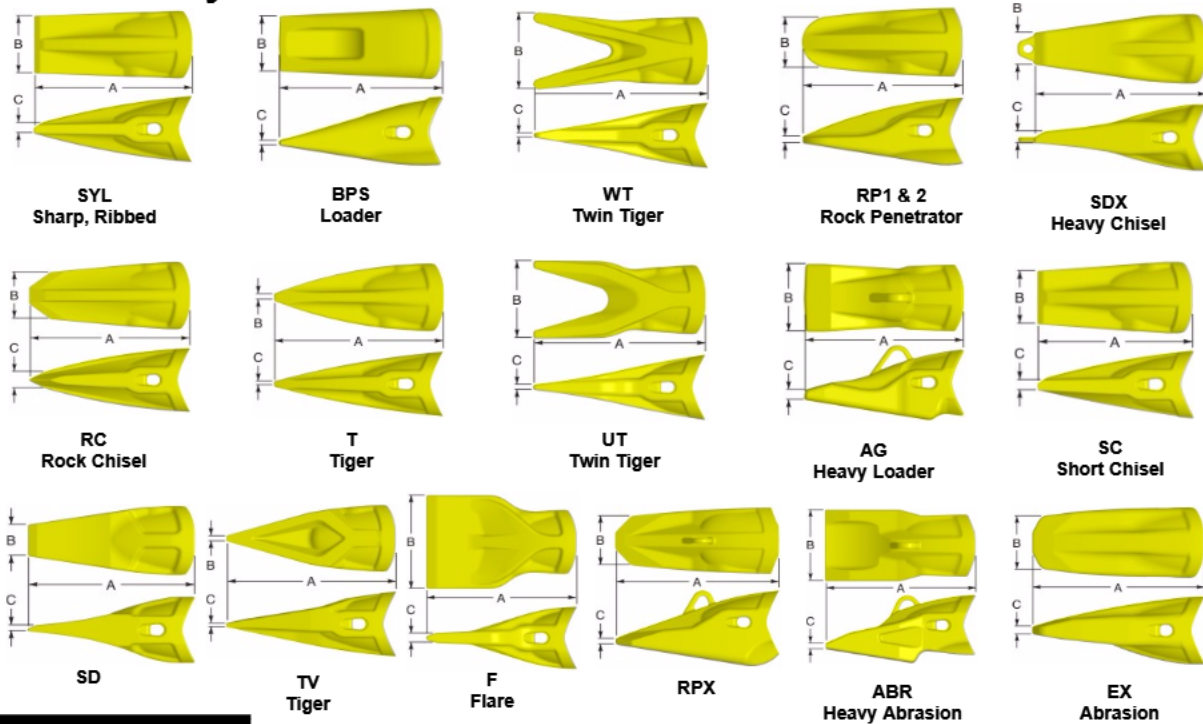

TEETH		Pin Assembly	Dimension Inches (mm)						Weight (kg)
Kmax Series	Part Number		Overall Tooth			Tooth Pocket			
			A	B	C	D	E	F	
50	K50SYL	KP50C	13.87 (352)	5.56 (141)	0.88 (22)	6.49 (165)	4.70 (119)	4.90 (125)	38.2 (17.3)
	K50RC		14.40 (366)	4.59 (117)	1.64 (42)	6.49 (165)	4.70 (119)	4.90 (125)	36.9 (16.8)
	K50SD		14.41 (366)	2.97 (75)	0.37 (9)	6.49 (165)	4.70 (119)	4.90 (125)	36.4 (16.5)
	K50SC		13.06 (331)	4.79 (121)	1.14 (29)	6.49 (165)	4.70 (119)	4.90 (125)	35.7 (16.2)
	K50T		15.09 (383)	0.68 (17)	0.49 (12)	6.49 (165)	4.70 (119)	4.90 (125)	32.7 (14.8)
	K50TV		15.09 (383)	0.55 (14)	0.38 (10)	6.49 (165)	4.70 (119)	4.90 (125)	31.4 (14.2)
	K50WT		15.09 (383)	7.34 (186)	0.36 (9)	6.49 (165)	4.70 (119)	4.90 (125)	34.2 (15.5)
	K50UT		15.10 (383)	7.30 (186)	0.49 (12)	6.49 (165)	4.70 (119)	4.90 (125)	36.2 (16.4)
	K50F		13.62 (346)	9.41 (239)	0.91 (23)	6.49 (165)	4.70 (119)	4.90 (125)	51.3 (23.3)
	K50BPS		12.44 (316)	5.10 (130)	0.48 (12)	6.49 (165)	4.70 (119)	4.90 (125)	47.9 (21.7)
	K50AG		14.50 (368)	6.57 (167)	1.00 (25)	6.49 (165)	4.70 (119)	4.90 (125)	61.0 (27.7)
	K50ABR		14.50 (368)	7.50 (190)	0.62 (16)	6.49 (165)	4.70 (119)	4.90 (125)	71.0 (32.2)
	K50SDX		14.88 (378)	2.96 (75)	1.03 (26)	6.49 (165)	4.70 (119)	4.90 (125)	43.0 (19.5)
	K50EX		14.44 (367)	4.88 (124)	0.69 (18)	6.49 (165)	4.70 (119)	4.90 (125)	46.8 (21.2)
	K50RP1		13.80 (351)	4.87 (124)	0.62 (16)	6.49 (165)	4.70 (119)	4.90 (125)	46.3 (21.1)
K50RP2	14.38 (365)	4.83 (123)	0.62 (16)	6.49 (165)	4.70 (119)	4.90 (125)	55.0 (24.9)		
K50RPX	14.81 (376)	4.84 (123)	0.58 (15)	6.49 (165)	4.70 (119)	4.90 (125)	70.0 (31.8)		

PIN ASSEMBLY

Duty Rating	Part Number	Dimensions Inches (mm)			Weight (kg)
		A	B	C	
Standard Duty	KP50C	6.12 (156)	1.20 (30)	2.08 (53)	2.5 (1.1)
Slag*	KP50S	6.12 (156)	1.20 (30)	2.08 (53)	2.5 (1.1)

* Not reusable

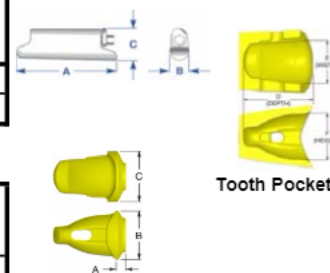

Weld On Nose

K50WN	Dimensions Inches (mm)			Weight (kg)
	A	B	C	
	1.00 (25)	5.62 (143)	5.84 (148)	28.8 (13.1)



50 Series Specifications

WELD-ON ADAPTERS

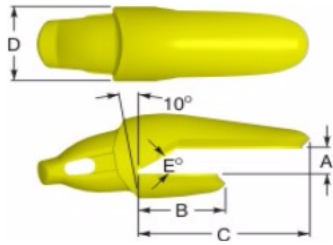

Type 1
1-1/2 Leg

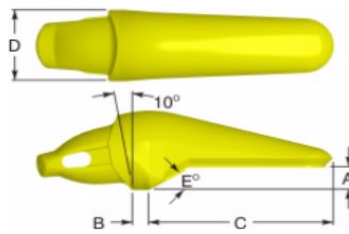

Type 2
Flush Mount

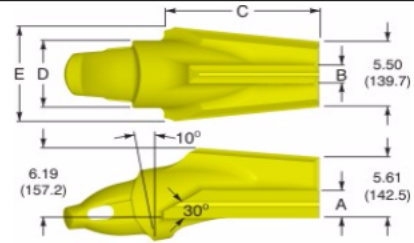

Type 4
"T" Style Corner

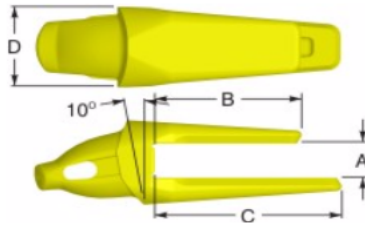

Type 5
1-1/2 Leg Blunt

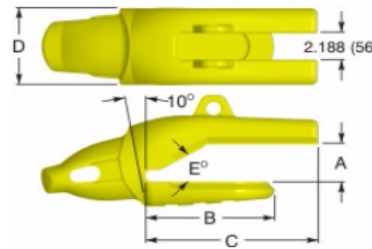

Type 8
Straddle Leg

ADAPTERS

Kmax Series	Part Number	Type	Dimension Inches (mm)					E Bevel Degree	Lip Thickness	Weight (kg)
			A	B	C	D				
50	K120050	1	2.09 (53)	6.26 (159)	11.84 (301)	5.84 (148)	30	2.00 (50.8)	60.0 (27.2)	
	K120050R	1	2.09 (53)	6.56 (166)	12.50 (317)	5.84 (148)	30	2.00 (50.8)	71.7 (32.5)	
	K120050L	1	2.09 (53)	6.56 (166)	12.50 (317)	5.84 (148)	30	2.00 (50.8)	71.7 (32.5)	
	K125050	1	2.59 (66)	6.26 (159)	11.82 (300)	5.84 (148)	30	2.50 (63.5)	60.0 (27.2)	
	*K125050R	1	2.59 (66)	6.69 (170)	12.44 (316)	5.84 (148)	30	2.50 (63.5)	67.0 (30.4)	
	*K125050L	1	2.59 (66)	6.69 (170)	12.44 (316)	5.84 (148)	30	2.50 (63.5)	67.0 (30.4)	
	K125050SL	8								
	K1060M50	1	2.45 (62)	6.27 (159)	11.83 (301)	5.84 (148)	30	60mm	60.0 (27.2)	
	K1060M50R	1	2.45 (62)	6.58 (167)	12.38 (314)	5.84 (148)	30	60mm	67.0 (30.4)	
	K1060M50L	1	2.45 (62)	6.58 (167)	12.38 (314)	5.84 (148)	30	60mm	67.0 (30.4)	
	K1060M50CC	4	2.37 (60)	1.58 (40)	9.00 (229)	5.84 (148)	30	60mm	89.0 (40.4)	
	K1060M50CS	8	2.45 (62)	6.13 (156)	12.00 (305)	5.84 (148)	30	60mm	63.0 (28.6)	
	K1065M50	1	2.65 (67)	6.25 (159)	11.81 (300)	5.84 (148)	30	65mm	59.0 (26.8)	
	K1070M50	1	2.84 (72)	6.21 (158)	11.75 (298)	5.84 (148)	30	70mm	60.0 (27.2)	
	K10060M50	5	2.45 (62)	7.81 (198)	9.39 (238)	5.84 (148)	Blunt	50mm	63.8 (28.9)	
	K2050M50	2	2.03 (51)	1.00 (25)	13.69 (348)	5.84 (148)	30	50mm	87.0 (39.5)	
K2060M50	2	2.37 (60)	1.00 (25)	13.87 (352)	5.84 (148)	30	60mm	83.0 (37.7)		
K5060M50	5	2.45 (62)	7.87 (200)	9.45 (240)	5.84 (148)	Blunt	60mm	65.0 (29.5)		

* Used On Spade Lip - 12° Angle

Hensley Industries, Inc.
2108 Joe Field Road . Dallas, Texas 75229 U.S.A.
Customer Service
(888) 406 - 6262 U.S./Canada . (972) 406 - 6262 all other locations
Hensley Attachments
A Division of Hensley Industries, Inc.
800 South Fifth . Mansfield, Texas 76063 U.S.A.
(800) 433 - 3144 . (817) 477 - 3167



U50HX
Universal
Wear Cap
3.7 lbs [1.7 kg]

SAFETY FIRST: Hensley Industries, Inc. recommends that you use a soft-faced hammer **and** ANSI-approved (Z87.1) eye protection while using our products.
Copyright © 2010 Hensley Industries, Inc.

This publication is protected under the copyright laws of the United States. Unauthorized duplication or distribution is prohibited.



70 Series Specifications

Teeth & Adapters Exclusively for Komatsu Dealers

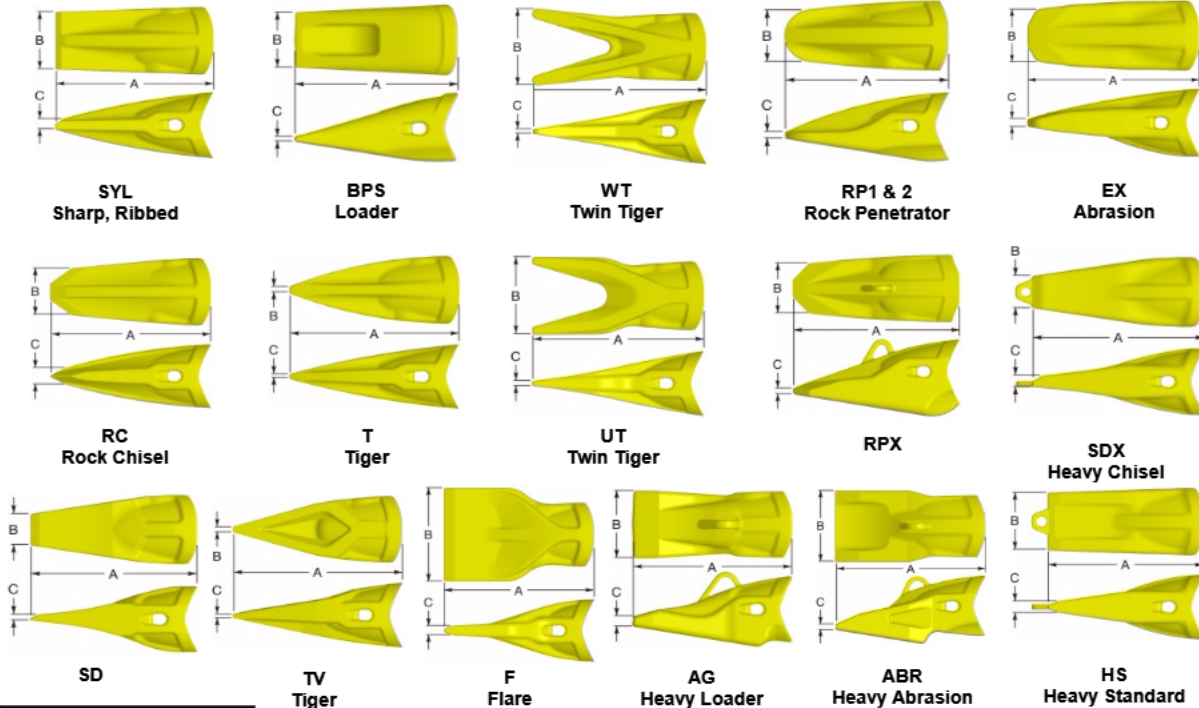

TEETH		Pin Assembly	Dimension Inches (mm)						Weight (kg)
Kmax Series	Part Number		Overall Tooth			Tooth Pocket			
			A	B	C	D	E	F	
70	K70SYL	KP70C	15.00 (381)	6.00 (152)	0.95 (24)	7.07 (180)	5.11 (130)	5.33 (135)	47.3 (21.5)
	K70RC		15.62 (397)	5.00 (127)	2.12 (54)	7.07 (180)	5.11 (130)	5.33 (135)	47.6 (21.6)
	K70SD		15.64 (397)	3.21 (81)	0.40 (10)	7.07 (180)	5.11 (130)	5.33 (135)	48.4 (22.0)
	K70SDX		16.08 (408)	3.20 (81)	1.12 (28)	7.07 (180)	5.11 (130)	5.33 (135)	56.0 (25.4)
	K70T		16.31 (414)	0.73 (19)	0.53 (13)	7.07 (180)	5.11 (130)	5.33 (135)	40.3 (18.3)
	K70TV		16.31 (414)	0.60 (15)	0.41 (10)	7.07 (180)	5.11 (130)	5.33 (135)	39.1 (17.7)
	K70WT		16.31 (414)	7.93 (201)	0.39 (10)	7.07 (180)	5.11 (130)	5.33 (135)	39.2 (17.8)
	K70UT		16.31 (414)	7.93 (201)	0.53 (13)	7.07 (180)	5.11 (130)	5.33 (135)	44.2 (20.0)
	K70F		14.75 (375)	10.19 (259)	0.97 (25)	7.07 (180)	5.11 (130)	5.33 (135)	57.5 (26.1)
	K70AG		15.77 (401)	7.14 (181)	1.81 (46)	7.07 (180)	5.11 (130)	5.33 (135)	80.0 (36.3)
	K70BPS		15.03 (382)	5.54 (141)	0.52 (13)	7.07 (180)	5.11 (130)	5.33 (135)	61.9 (28.1)
	K70ABR		15.66 (397)	8.10 (206)	0.67 (17)	7.07 (180)	5.11 (130)	5.33 (135)	94.0 (42.7)
	K70HS		15.00 (381)	6.00 (15.)	0.50 (13)	7.07 (180)	5.11 (130)	5.33 (135)	52.6 (23.8)
	K70EX		15.62 (397)	5.28 (134)	0.75 (19)	7.07 (180)	5.11 (130)	5.33 (135)	59.0 (26.8)
	K70RP1		15.00 (381)	5.07 (129)	0.64 (16)	7.07 (180)	5.11 (130)	5.33 (135)	57.0 (25.9)
	K70RP2		15.50 (394)	5.25 (133)	0.68 (17)	7.07 (180)	5.11 (130)	5.33 (135)	69.0 (31.3)
K70RPX	16.00 (406)	5.22 (133)	0.62 (16)	7.07 (180)	5.11 (130)	5.33 (135)	85.0 (38.6)		

PIN ASSEMBLY

Duty Rating	Part Number	Dimensions Inches (mm)			Weight (kg)
		A	B	C	
Standard Duty	KP70C	6.65 (169)	1.30 (33)	2.25 (57)	3.2 (1.5)
Slag*	KP70S	6.65 (169)	1.30 (33)	2.25 (57)	3.2 (1.5)

* Not reusable

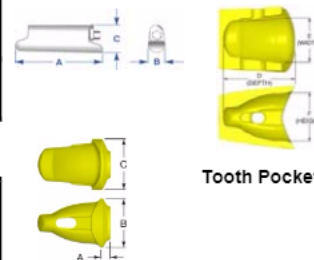

Weld On Nose

K70WN	Dimensions Inches (mm)			Weight (kg)
	A	B	C	
	1.10 (28)	6.12 (156)	6.34 (161)	37.3 (16.9)



70 Series Specifications

WELD-ON ADAPTERS

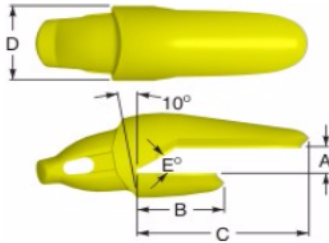

Type 1
1-1/2 Leg

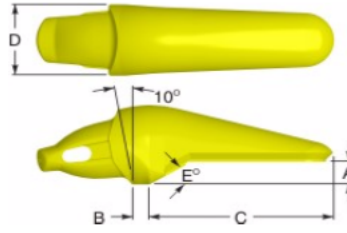

Type 2
Flush Mount

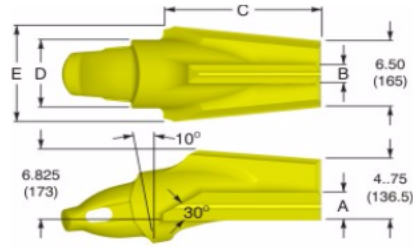

Type 4
"T" Style Corner

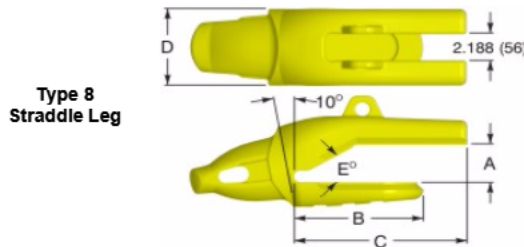

Type 8
Straddle Leg

ADAPTERS

Kmax Series	Part Number	Type	Dimension Inches (mm)						Weight (kg)
			A	B	C	D	E Bevel Degree	Lip Thickness	
70	K1070M70	1	2.84 (72)	7.25 (184)	13.50 (343)	6.34 (161)	30	70mm	81.0 (36.8)
	*K1070M70R	1	2.84 (72)	7.50 (191)	13.75 (349)	6.34 (161)	30	70mm	86.0 (39.0)
	*K1070M70L	1	2.84 (72)	7.50 (191)	13.75 (349)	6.34 (161)	30	70mm	86.0 (39.0)
	K1070M70CC	4	2.75 (70)	1.57 (40)	13.00 (330)	6.34 (161)	30	70mm	140 (63.5)
	K1080M70	1	3.24 (82)	7.25 (184)	13.47 (342)	6.34 (161)	30	80mm	78.0 (35.4)
	*K1080M70R	1	3.24 (82)	7.37 (187)	13.37 (340)	6.34 (161)	30	80mm	84.0 (38.1)
	*K1080M70L	1	3.24 (82)	7.37 (187)	13.37 (340)	6.34 (161)	30	80mm	84.0 (38.1)
	K125070	1	2.59 (65)	7.00 (178)	13.31 (338)	6.34 (161)	30	2.50 (63.5)	75.0 (34.1)
	K125070R	1	2.59 (65)	7.06 (179)	13.37 (340)	6.34 (161)	30	2.50 (63.5)	84.0 (38.1)
	K125070L	1	2.59 (65)	7.06 (179)	13.37 (340)	6.34 (161)	30	2.50 (63.5)	84.0 (38.1)
	K130070	1	3.09 (78)	7.25 (184)	13.50 (343)	6.34 (161)	30	3.00 (76.2)	72.0 (32.7)
	K130070SL	8	3.09 (78)		10.67 (271)	6.34 (161)	30	3.00 (76.2)	97.6 (44.3)
	K2065M70	2	2.65 (67)	1.09 (28)	15.00 (381)	6.34 (161)	30	65mm	106.0 (48.1)
	K120070	1	2.09 (53)	7.00 (178)	13.38 (340)	6.34 (161)	30	2.00 (50.8)	79.0 (35.8)
-	-	-	-	-	-	-	-	-	-

* Used On Spade Lip - 12° Angle

Hensley Industries, Inc.
2108 Joe Field Road . Dallas, Texas 75229 U.S.A.
Customer Service
(888) 406 - 6262 U.S./Canada . (972) 406 - 6262 all other locations
Hensley Attachments
A Division of Hensley Industries, Inc.
800 South Fifth . Mansfield, Texas 76063 U.S.A.
(800) 433 - 3144 . (817) 477 - 3167



U70HX
Universal
Wear Cap
5.9 lbs [2.7 kg]

SAFETY FIRST: Hensley Industries, Inc. recommends that you use a soft-faced hammer and ANSI-approved (Z87.1) eye protection while using our products.
Copyright © 2010 Hensley Industries, Inc.

This publication is protected under the copyright laws of the United States. Unauthorized duplication or distribution is prohibited.



85 Series Specifications

Teeth & Adapters Exclusively for Komatsu Dealers

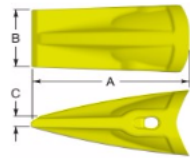

SYL
Sharp, Ribbed

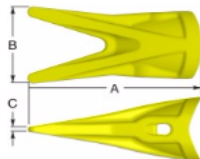

WT
Twin Tiger

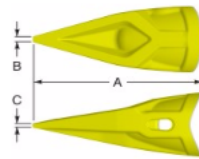

TV
Tiger

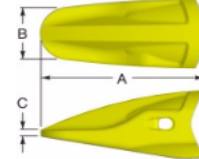

RP2 & 3
Rock Penetrator

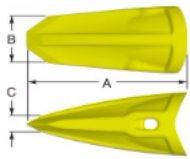

RC
Rock Chisel

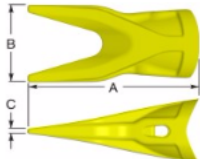

UT
Twin Tiger

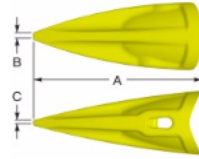

T
Tiger

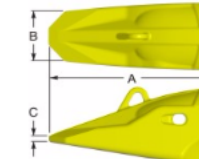

RPX

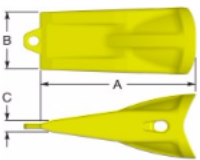

HS
Heavy Standard

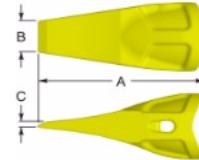

SD

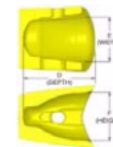

Tooth Pocket

TEETH		Pin Assembly	Dimension Inches (mm)						Weight (kg)
Kmax Series	Part Number		Overall Tooth			Tooth Pocket			
			A	B	C	D	E	F	
85	K85SYL	KP85X	15.85 (403)	6.32 (161)	1.22 (31)	7.50 (191)	5.52 (140)	5.68 (144)	57.0 (25.9)
	K85RC		16.50 (419)	5.28 (134)	1.89 (48)	7.50 (191)	5.52 (140)	5.68 (144)	59.0 (26.8)
	K85T		17.36 (441)	0.78 (20)	0.57 (14)	7.50 (191)	5.52 (140)	5.68 (144)	47.0 (21.3)
	K85TV		17.37 (441)	0.64 (16)	0.44 (11)	7.50 (191)	5.52 (140)	5.68 (144)	48.4 (22.0)
	K85WT		17.36 (441)	8.46 (215)	0.41 (11)	7.50 (191)	5.52 (140)	5.68 (144)	52.5 (23.8)
	K85UT		17.36 (441)	8.47 (215)	0.56 (14)	7.50 (191)	5.52 (140)	5.68 (144)	55.0 (25.0)
	K85RP2		17.12 (435)	5.97 (152)	0.75 (19)	7.50 (191)	5.52 (140)	5.68 (144)	93.0 (42.2)
	K85RP3		17.12 (435)	5.97 (152)	0.80 (20)	7.50 (191)	5.52 (140)	5.68 (144)	106.0 (48.1)
	K85RPX		17.11 (434)	5.59 (142)	0.75 (19)	7.50 (191)	5.52 (140)	5.68 (144)	112.0 (50.8)
	K85SD		16.60 (396)	2.25 (108)	1.96 (50)	7.50 (191)	5.52 (140)	5.68 (144)	55.0 (25.0)
K85HS			Future Development						

PIN ASSEMBLY

Duty Rating	Part Number	Dimensions Inches (mm)			Weight (kg)
		A	B	C	
Heavy Duty	KP85X	6.99 (177)	1.28 (32)	2.24 (57)	3.3 (1.5)
Slag*	KP85S	6.99 (177)	1.28 (32)	2.24 (57)	3.3 (1.5)

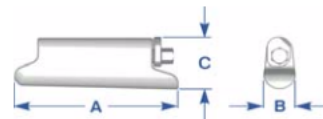

* Not reusable

Weld On Nose

Part Number	Dimensions Inches (mm)			Weight (kg)
	A	B	C	
K85WN	1.14 (28.9)	6.50 (165)	6.79 (173)	42.9 (19.5)

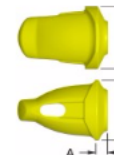

WELD-ON ADAPTERS

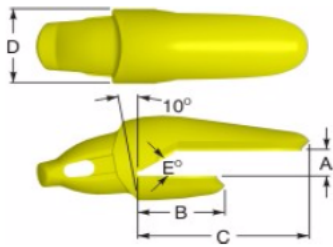

Type 1
1-1/2 Leg

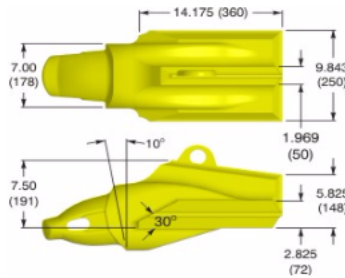

Type 4
"T" Style Corner

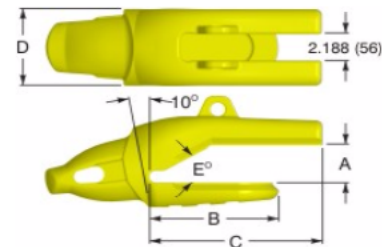

Type 8
Straddle Leg

Type 9
1-1/2 Leg
(uses WC85HX)

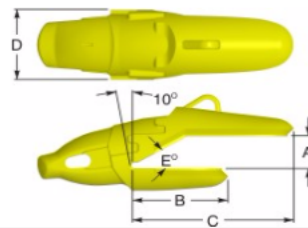

ADAPTERS

Kmax Series	Part Number	Type	Dimension Inches (mm)						Weight (kg)	
			A	B	C	D	E Bevel Degree	Lip Thickness		
85	K1070M85	1	2.84 (72)	7.41 (188)	14.26 (362)	6.79 (173)	30	70mm	97.0 (44.0)	
	*K1070M85R	1	2.84 (72)	7.42 (189)	14.16 (360)	6.79 (173)	30	70mm	103.0 (46.8)	
	*K1070M85L	1	2.84 (72)	7.42 (189)	14.16 (360)	6.79 (173)	30	70mm	103.0 (46.8)	
	K1080M85	1	3.24 (82)	7.50 (191)	14.22 (361)	6.79 (173)	30	80mm	99.0 (45.0)	
	*K1080M85R	1	3.24 (82)	8.00 (203)	14.50 (368)	6.79 (173)	30	80mm	99.0 (44.9)	
	*K1080M85L	1	3.24 (82)	8.00 (203)	14.50 (368)	6.79 (173)	30	80mm	99.0 (44.9)	
	K1090M85	1	3.63 (92)	7.33 (186)	14.06 (357)	6.79 (173)	30	90mm	99.0 (45.0)	
	K125085	1	2.59 (66)	7.50 (191)	14.34 (364)	6.79 (173)	30	2.50 (63.5)	98.0 (44.5)	
	K127585	1								
	K127585R	1								
	K127585L	1								
	K130085	1	3.09 (78)	7.44 (189)	14.22 (361)	6.79 (173)	30	3.00 (76.2)	97.0 (44.0)	
	*K130085R	1	3.09 (78)	7.41 (188)	14.19 (361)	6.79 (173)	30	3.00 (76.2)	108.0 (49.0)	
	*K130085L	1	3.09 (78)	7.41 (188)	14.19 (361)	6.79 (173)	30	3.00 (76.2)	108.0 (49.0)	
	K135085	1	3.59 (91)	7.44 (189)	14.18 (360)	6.79 (173)	30	3.50 (88.9)	95.0 (43.1)	
	*K135085R	1	3.594(91)	7.35 (187)	14.16 (360)	6.79 (173)	30	3.50 (88.9)	95.0 (43.1)	
	*K135085L	1	3.59 (91)	7.35 (187)	14.16 (360)	6.79 (173)	30	3.50 (88.9)	95.0 (43.1)	
	K130385CC	4	Shown Above							215.5 (97.8)
	K131085**	9	3.09 (78)	8.56 (217)	14.34 (364)	6.79 (173)	30	3.10 (78.7)	98.2 (44.5)	
	K131085R**	9	3.09 (78)	8.56 (217)	14.34 (364)	6.79 (173)	30	3.10 (78.7)	103.0 (46.7)	
K131085L**	9	3.09 (78)	8.56 (217)	14.34 (364)	6.79 (173)	30	3.10 (78.7)	103.0 (46.7)		
K131085SL	8	3.09 (78.6)	8.88 (225)	15.40 (391)	6.79 (173)	30	3.10 (78.7)	121.0 (54.8)		

* Used On Spade Lip - 12° Angle

**Uses WC85HX wear cap

Hensley Industries, Inc.
2108 Joe Field Road . Dallas, Texas 75229 U.S.A.
Customer Service
(888) 406 - 6262 U.S./Canada . (972) 406 - 6262 all other locations
Hensley Attachments

A Division of Hensley Industries, Inc.
800 South Fifth . Mansfield, Texas 76063 U.S.A.
(800) 433 - 3144 . (817) 477 - 3167

SAFETY FIRST: Hensley Industries, Inc. recommends that you use a soft-faced hammer and ANSI-approved (Z87.1) eye protection while using our products.
Copyright © 2010 Hensley Industries, Inc.

This publication is protected under the copyright laws of the United States. Unauthorized duplication or distribution is prohibited.



U85HX
Universal
Wear Cap
5.8 lbs [2.6 kg]

WC85HX
Wear Cap
10.7 lbs [4.8 kg]

Kmax

Tooth Removal/Installation Guide

(all drawings are typical and are for illustrative purposes only)

NOTE: Before starting removal or installation, read all instructions completely. Be sure to follow all standard safety procedures and wear appropriate protective equipment.

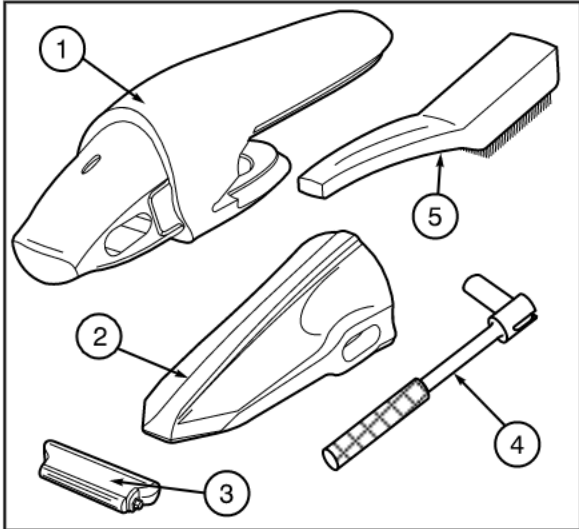

STEP 1

Parts list: (1) weld-on adapter [already installed on bucket]; (2) tooth; (3) pin; (4) socket wrench with appropriate sized socket; (5) wire brush.

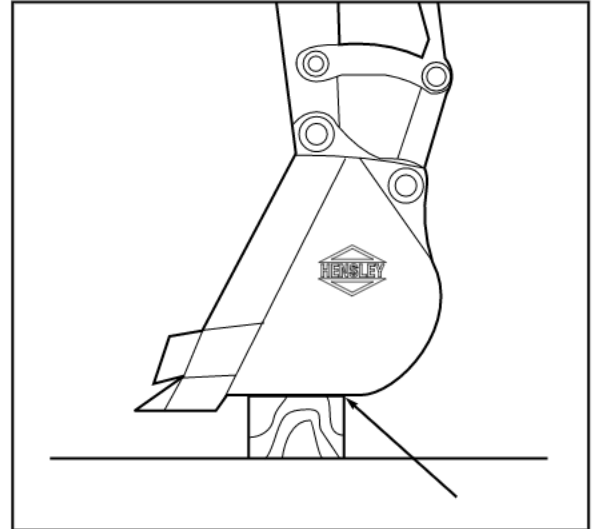

STEP 2

Before removal/installation of teeth, place the bucket on a block. After the engine is turned off, turn the key switch to the "ON" position and move the control levers with full strokes. Confirm the bucket and working equipment are stable and lock the control levers. Be sure to keep the bucket bottom horizontal.

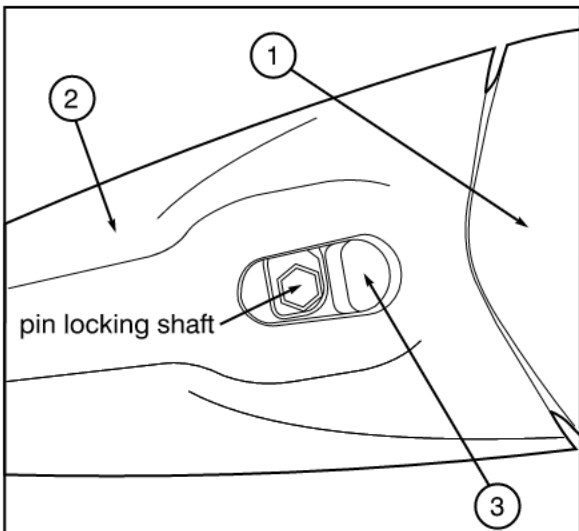

STEP 3

Remove compacted material from the pin hole if necessary to expose the pin (3). The pin (3) is shown in the 'locked' position and inserted into the tooth (2) and adapter (1).

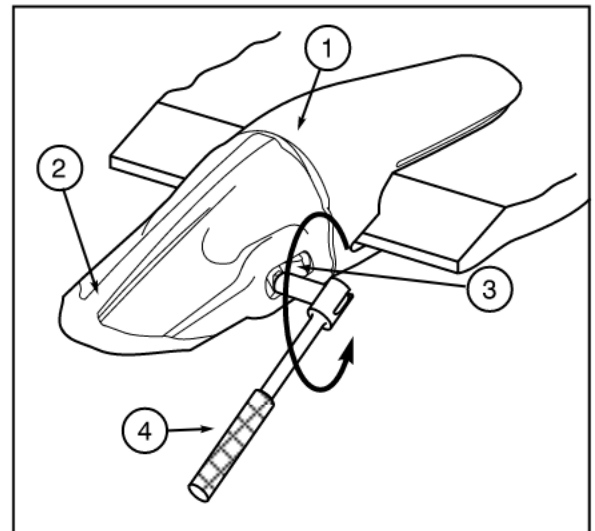

STEP 4

Insert socket wrench (4) into pin hole in tooth (2) and turn the pin locking shaft 90° counter-clockwise to unlock the pin (3).

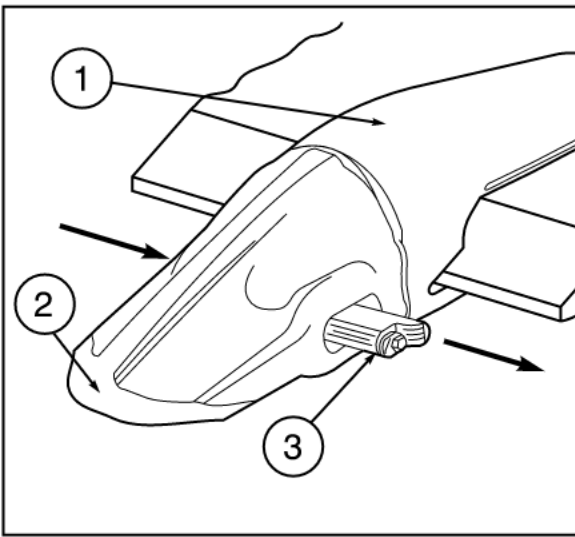

STEP 5

Slide the pin (3) out of the old tooth (2) and adapter (1).

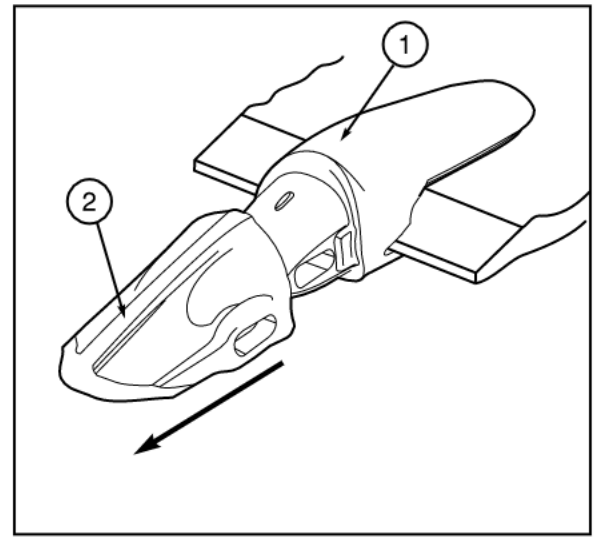

STEP 6

Slide the old tooth (2) off of the adapter (1).

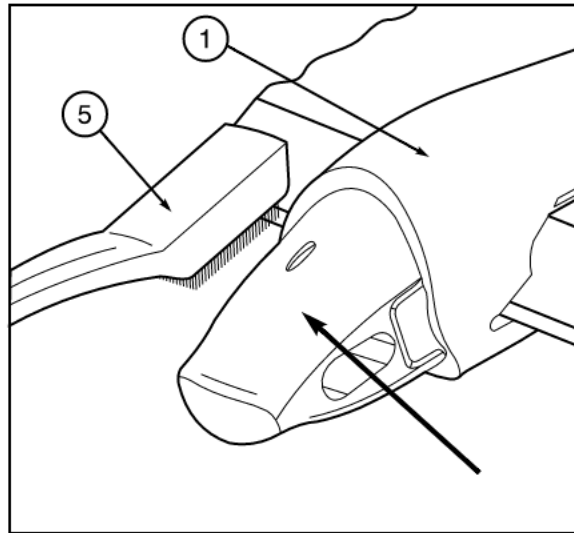

STEP 7

Use a wire brush (5) to clean the adapter (1) nose and pin hole of dirt and other material.

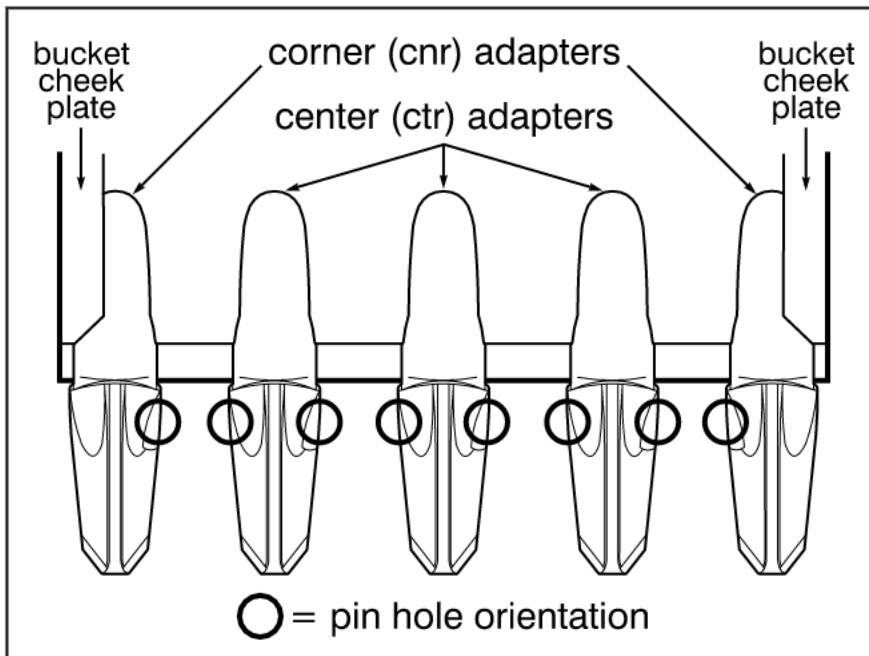

SPECIAL NOTE

Teeth should be installed on adapters so that the pin hole orientation is as shown at left. Teeth should be installed on corner adapters so as to have the pin hole orientation to the inside of the bucket. Center teeth may be installed with the pin hole orientation to either the inside or outside of the bucket.

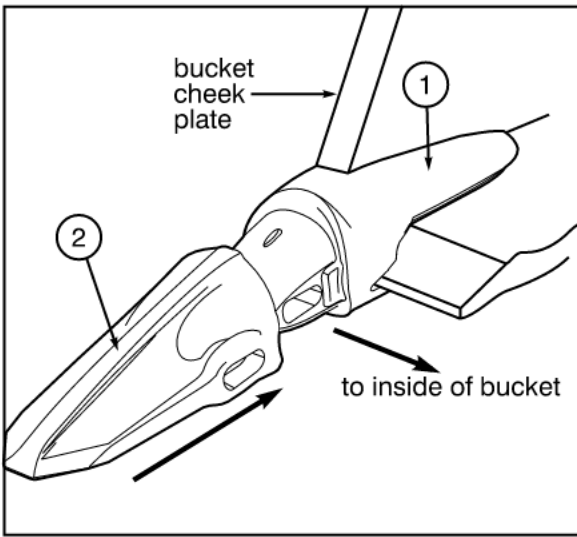

STEP 8A (LEFT CORNER ADAPTER)

Slide a new tooth (2) onto the adapter (1) making sure the pin hole is oriented to the inside of the bucket.

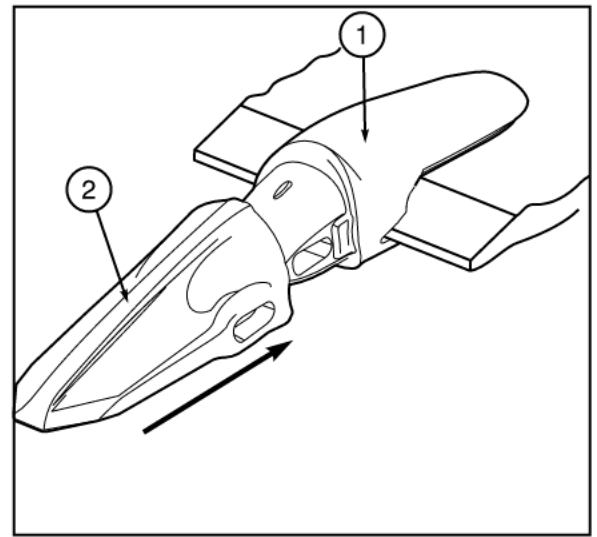

STEP 8B (CENTER ADAPTERS)

Slide a new tooth (2) onto the adapter (1). the pin hole can be oriented to either the inside or outside of the bucket.

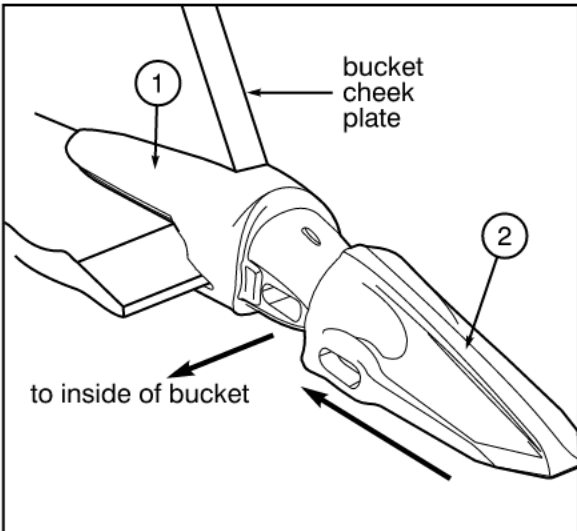

STEP 8C (RIGHT CORNER ADAPTER)

Slide a new tooth (2) onto the adapter (1) making sure the pin hole is oriented to the inside of the bucket.

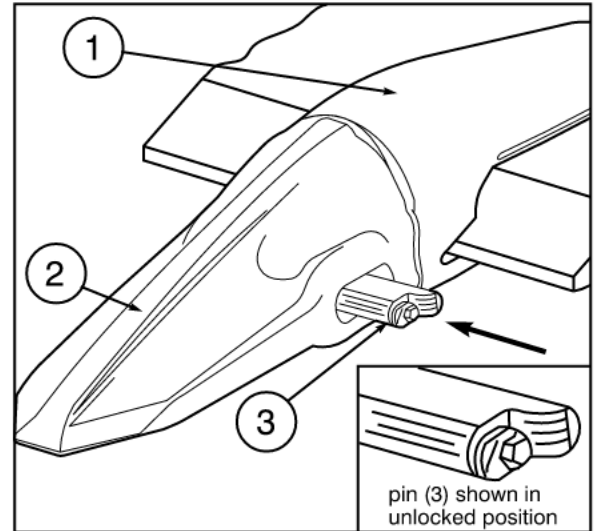

STEP 9

Insert the pin (3) making sure it is in the unlocked position (see inset) into the tooth (2) and adapter (1).

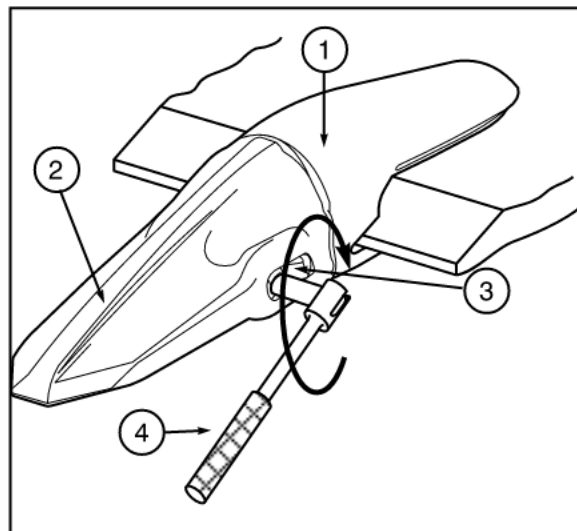

STEP 10

Insert socket wrench (4) into pin hole into tooth (2) and turn the pin locking shaft of the pin (3) 90° clockwise to lock the pin (3).

REVERSING OF TEETH

To promote more even wear and extended wear life, all XS/Kmax teeth are reversible.

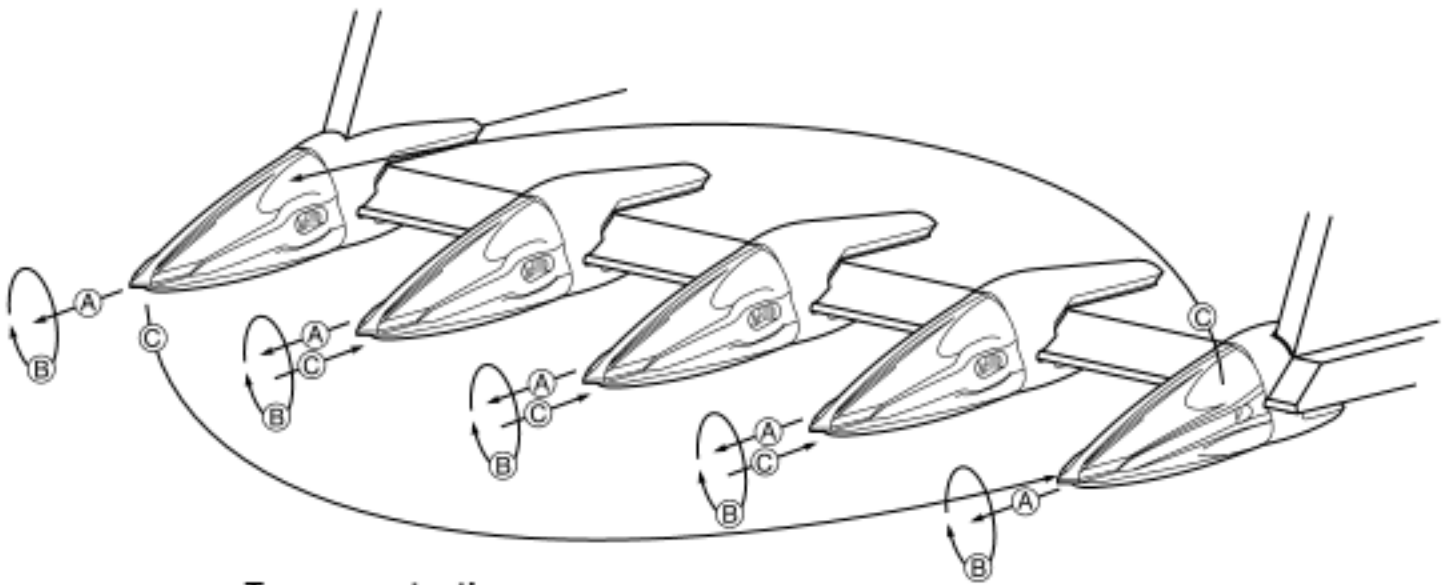

To reverse teeth:

For teeth on **CENTER ADAPTERS**

- A. Remove tooth as per instructions (steps 4 - 7).
- B. Rotate the tooth.
- C. Re-install the tooth as per instructions (steps 8B, 9 - 10).

For teeth on **CORNER ADAPTERS**

- A. Remove tooth as per instructions (steps 4 - 7).
- B. Rotate the tooth.
- C. Re-install the tooth on the opposite corner adapter (steps 8A or 8C, 9 - 10) making sure the pin hole orientation is to the inside of the bucket.

SAFETY FIRST: Hensley recommends that you use a soft-faced hammer and ANSI-approved (Z87.1) eye protection while using our products.

Kmax™ manufactured by

Hensley Industries, Inc.

2108 Joe Field Road • Dallas, Texas 75229

U.S.A.

Customer Service

(888) 406 - 6262 U.S./Canada

(972) 406 - 6262 all other locations

Hensley Attachments

A Division of Hensley Industries, Inc.

800 South Fifth Avenue • Mansfield, Texas 76063

U.S.A.

(800) 433 - 3144

(817) 477 - 3167

www.hensleyind.com



Copyright © 2010 Hensley Industries, Inc.

This publication protected under the copyright laws of the United States. Unauthorized duplication or distribution is prohibited.

Komatsu is a registered trademark of Komatsu, Ltd.