

# KIATRA VINEYARDS

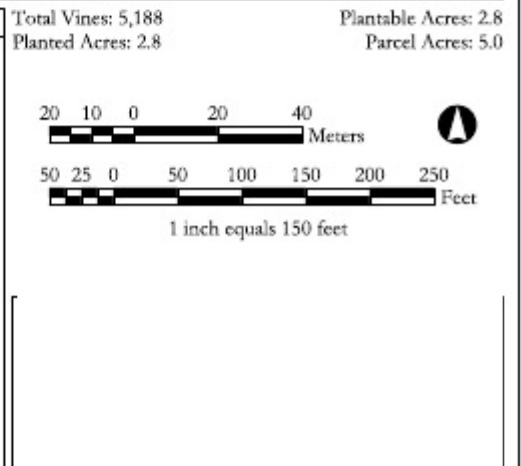

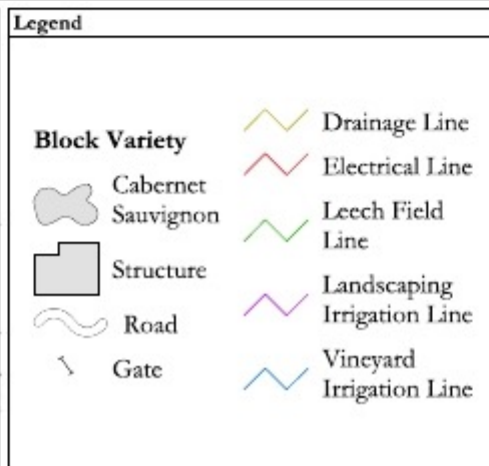
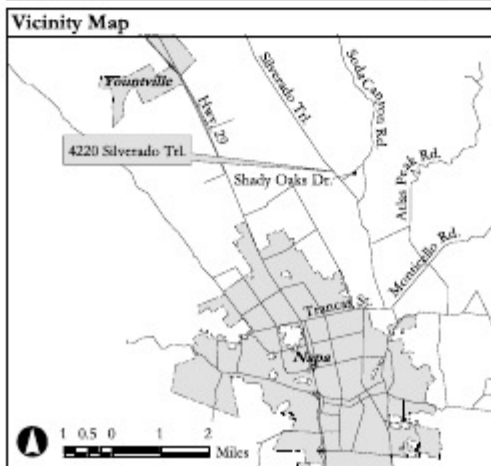

# KIATRA VINEYARDS

## BLOCK 1B

CABERNET SAUVIGNON  
 CLONE: 412 (1<sup>ST</sup> ROW IS 685)  
 RS: 1616-C (1<sup>ST</sup> ROW IS SCHWARTZMAN)  
 VINES: 973  
 ROWS: 16  
 VINES SPACING: 4FT  
 ROW SPACING: 6FT  
 ACRES: 0.5

## BLOCK 1A

CABERNET SAUVIGNON  
 CLONE: 412 (1<sup>ST</sup> ROW IS 685)  
 RS: 1616-C (1<sup>ST</sup> ROW IS SCHWARTZMAN)  
 VINES: 1,339  
 ROWS: 16  
 VINES SPACING: 4FT  
 ROW SPACING: 6FT  
 ACRES: 0.7

## BLOCK 2B

CABERNET SAUVIGNON  
 CLONE: 338  
 RS: SCHWARTZMAN  
 VINES: 58  
 ROWS: 4  
 VINES SPACING: 4FT  
 ROW SPACING: 6FT  
 ACRES: 0.03

## BLOCK 2A

CABERNET SAUVIGNON  
 CLONE: 338  
 RS: SCHWARTZMAN  
 VINES: 169  
 ROWS: 6  
 VINES SPACING: 4FT  
 ROW SPACING: 6FT  
 ACRES: 0.1

## BLOCK 3B

CABERNET SAUVIGNON  
 CLONE: 338  
 RS: SCHWARTZMAN  
 VINES: 1,217  
 ROWS: 15  
 VINES SPACING: 4FT  
 ROW SPACING: 6FT  
 ACRES: 0.7

## BLOCK 3A

CABERNET SAUVIGNON  
 CLONE: 685  
 RS: SCHWARTZMAN  
 VINES: 1,432  
 ROWS: 17  
 VINES SPACING: 4FT  
 ROW SPACING: 6FT  
 ACRES: 0.8

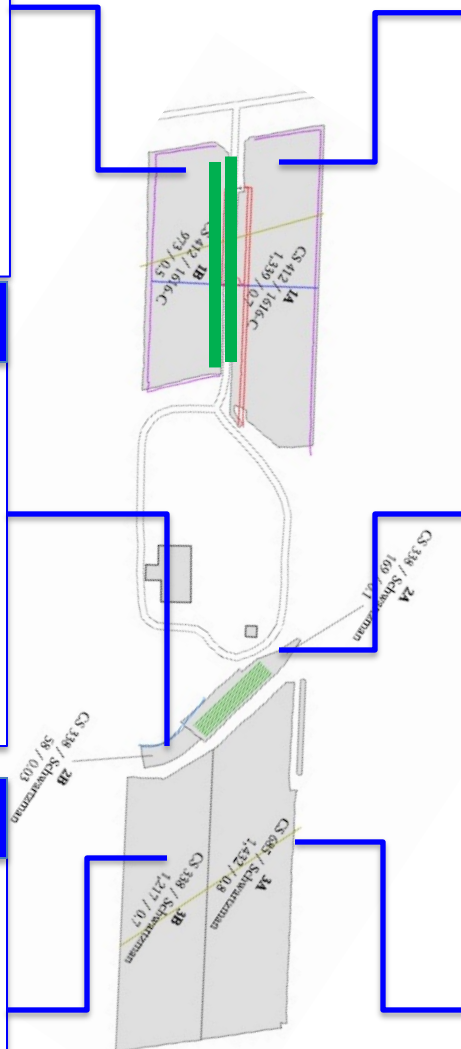

# VINE NAMING CONVENTION:

SITE.BLOCK.ROW.VINE

## EXAMPLES:

K.1A1.1.3

K.1A2.1.7

K.3A.2.4

# Block 1A

Note: there is a single row 1A2 which is designated as K.1A2.1.n

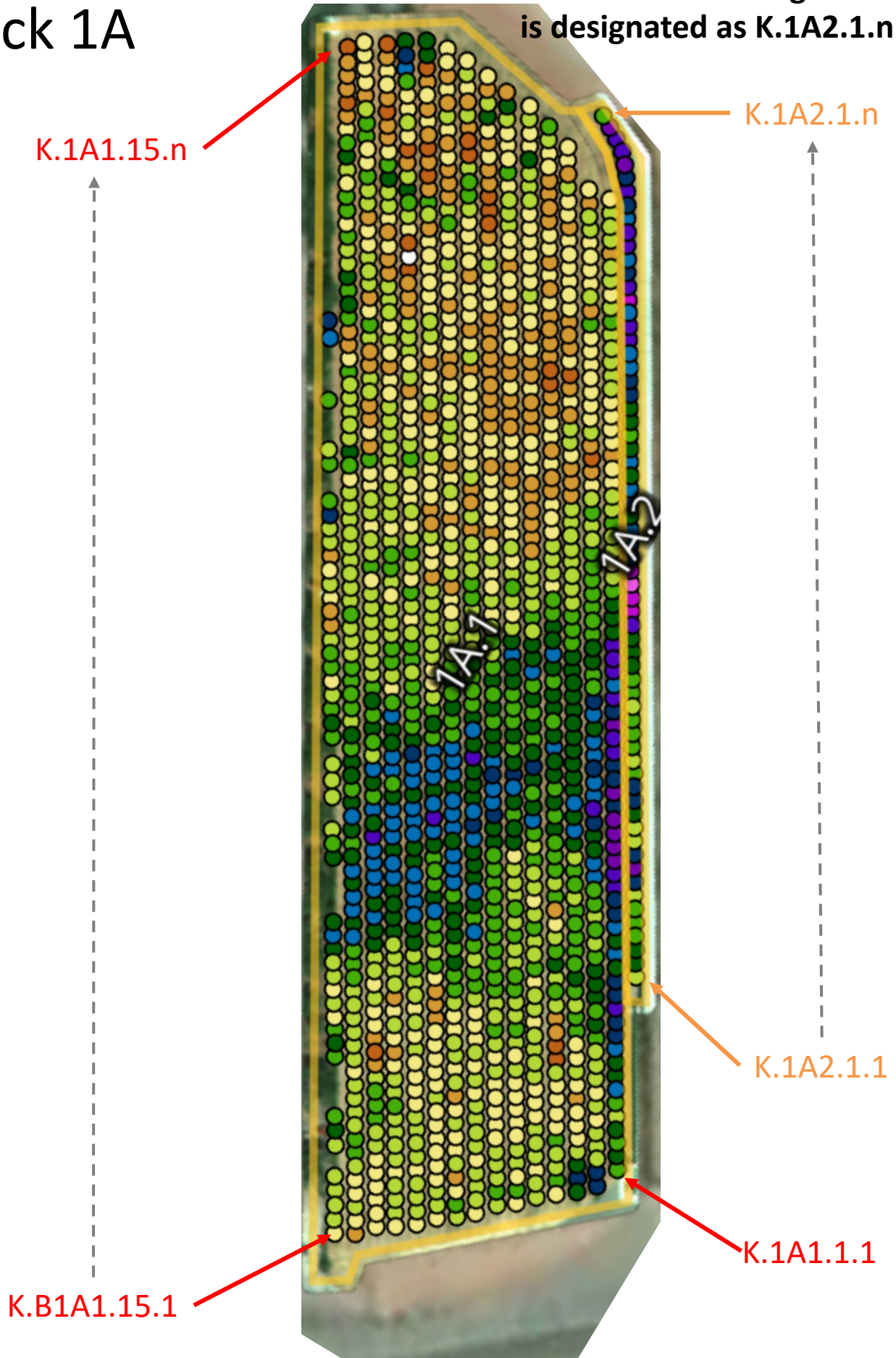

Silverado Trail

# Block 1B

Note: there is a single row 1B2 which is designated as K.1B2.1.n



Silverado Trail

# Block 2A

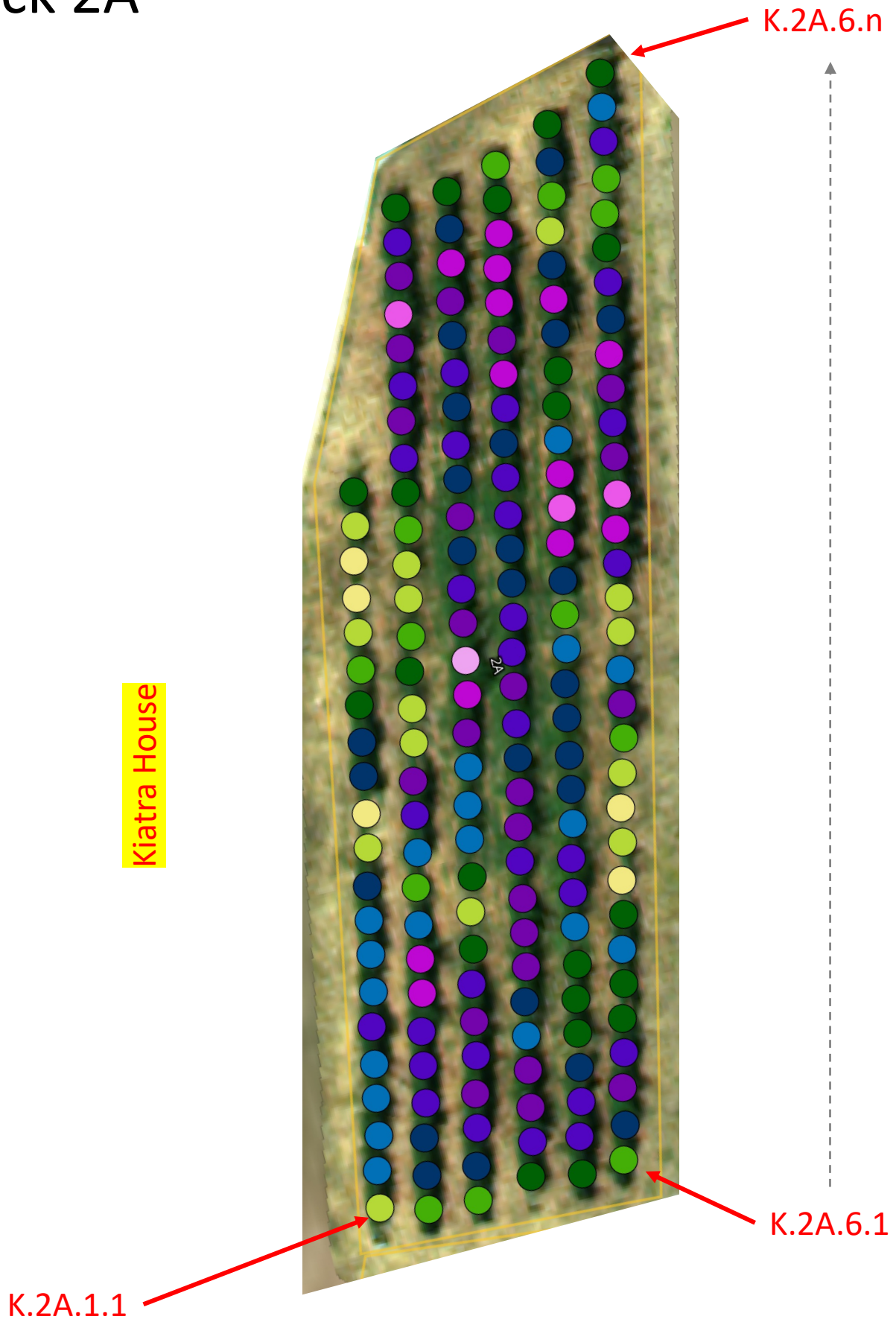

# Block 2B

Kiatra House



# Block 3A

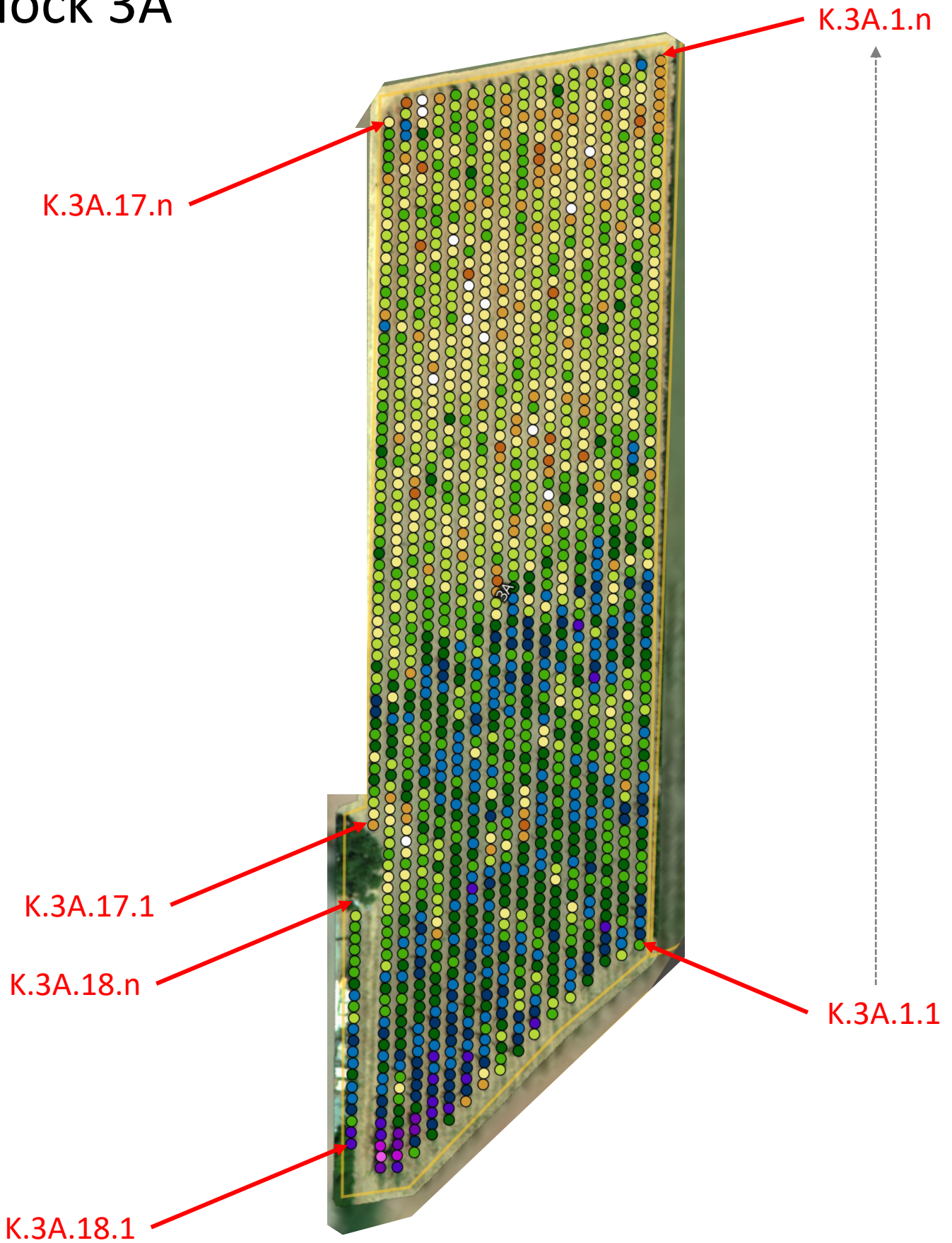

Kiatra House



# Block 3B

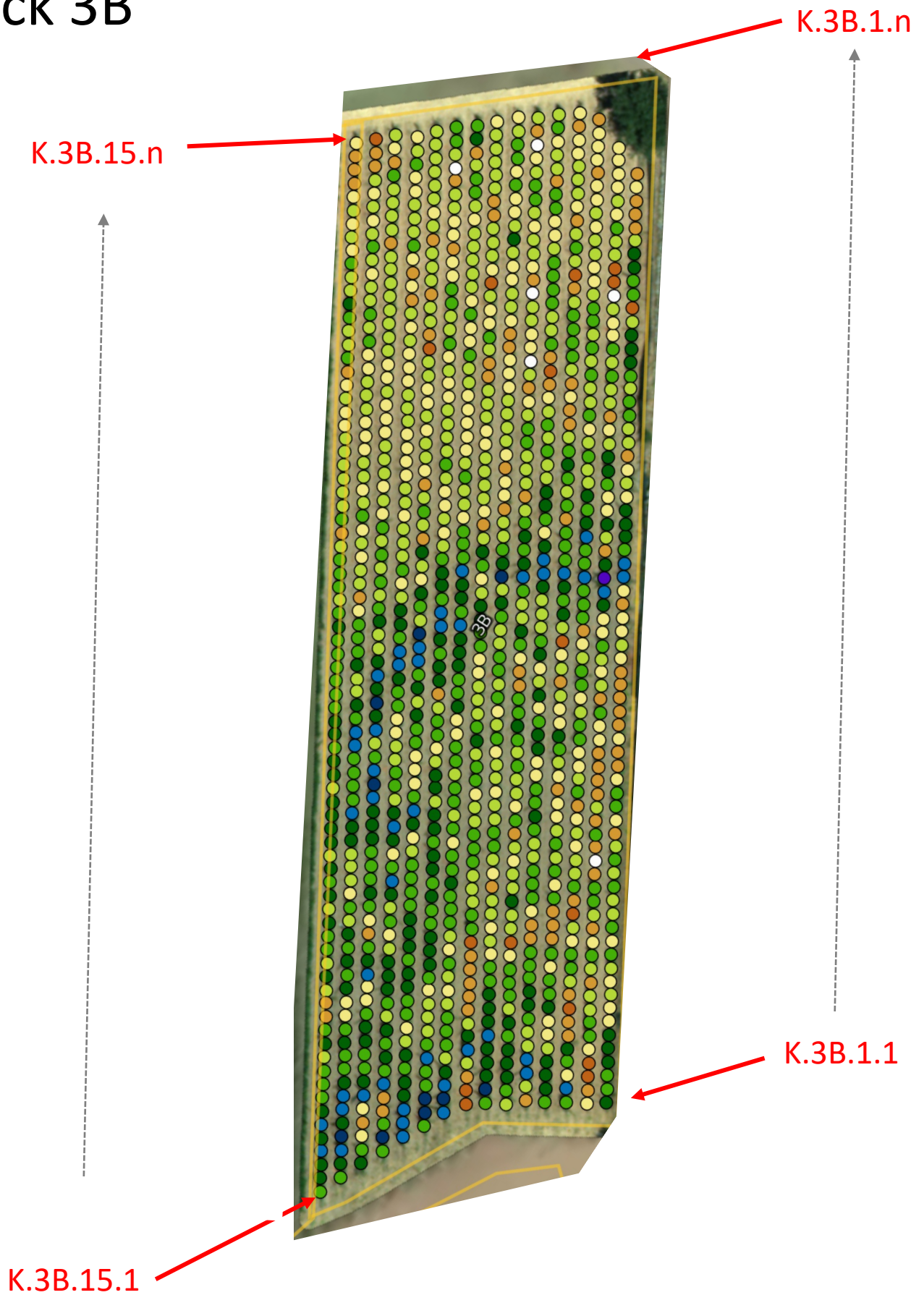

Kiatra House