

FD. 1" IP TAGGED LS 4449
DN 0.1" PER RS 83/77

ABBREVIATIONS

- | | | |
|------------------------|--------------------------------|----------------------------|
| A/C = AIR CONDITIONER | DS = DOWN SPOUT | PA = PLANTER AREA |
| AC = ASPHALT | EC = EDGE OF CONCRETE | SDMH = STORM DRAIN MANHOLE |
| BBS = BOTTOM OF STEP | EP = EDGE OF PAVEMENT | TC = TOP OF CURB |
| BLD = BUILDING | EPB = ELECTRICAL PULLBOX | TH = THRESHOLD |
| BRAMP = BOTTOM OF RAMP | EPIPE = ELECTRICAL PIPE | TRAMP = TOP OF RAMP |
| BS = BLUE STRIPE | EPNL = ELECTRICAL PANEL | TTS = TOP OF STEP |
| BWAL = BOTTOM OF WALL | EVault = ELECTRICAL VAULT | TWAL = TOP OF WALL |
| CC OR CONC = CONCRETE | FA = FIRE ALARM | UTIL = UTILITY |
| CDRAIN = CURB DRAIN | FF = FINISHED FLOOR | WIF = WROUGHT IRON FENCE |
| CLF = CHAIN LINK FENCE | FL = FLOWLINE | WH = WATER HEATER |
| COMM = COMMUNICATION | GB = GRADE BREAK | WM = WATER METER |
| CO = CLEANOUT | GRD = GROUND | WS = WHITE STRIPE |
| CSLAB = CONCRETE SLAB | ICV = IRRIGATION CONTROL VALVE | WV = WATER VALVE |
| DF = DRINKING FOUNTAIN | INV = INVERT | YS = YELLOW STRIPE |
| DI = DROP INLET | IPB = IRRIGATION PULLBOX | |

LEGENDS

- | | | | |
|------------------------|------------------------------|---------------------|-------------|
| BUILDING | BRICK WALL | CHAIN LINK FENCE | CONCRETE |
| RAIL | WOODEN OR WROUGHT IRON FENCE | POST | TREE |
| AIR CONDITIONER | FIRE ALARM | STORM DRAIN MANHOLE | UTILITY |
| CABINET | ELECTRICAL PANEL | VAULT | WATER METER |
| COMMUNICATION PULL BOX | ELECTRICAL PULLBOX | WATER VALVE | |
| DRINKING FOUNTAIN | ELECTRICAL VAULT | | |
| DRAINAGE INLET | IRRIGATION CONTROL VALVE | | |
| DOWNSPOUT | IRRIGATION PULLBOX | | |
| | PALM | | |
| | PULLBOX | | |

SURVEYOR'S NOTES:

1. THIS MAP REPRESENTS A TOPOGRAPHIC SURVEY OF VISIBLE FIELD CONDITIONS AT THE TIME OF THIS SURVEY. NO EASEMENTS, COVENANTS, CONDITIONS, OR RESTRICTIONS HAVE BEEN DETERMINED FOR THIS SURVEY.
2. THE HORIZONTAL BASIS OF BEARING IS THE CENTERLINE OF BELLE AVENUE, BEING N 07°19'54" E, AS SHOWN ON RECORD OF SURVEY, M.B. 154, PAGE 86, RECORDED IN THE OFFICE OF THE COUNTY RECORDER OF THE RIVERSIDE COUNTY.
3. THE VERTICAL BENCHMARK FOR THIS SURVEY IS A CITY OF CORONA BENCHMARK C-130, BEING A 2-1/2" BRASS DISK STAMPED "C-130" SET IN THE TOP OF CURB, LOCATED 5' EAST OF THE B.C.R. OF THE NORTHEASTERLY CURB RETURN OF THE INTERSECTION OF MAIN STREET AND OLIVE STREET.
DATUM: NGVD 1929 (1988 ADJUSTMENT)
ELEVATION = 756.643 FEET
4. CONTOUR INTERVAL = 0.50'

SURVEYOR'S STATEMENT:

I hereby state that I am a Professional Land Surveyor of the State of California, that this map, consisting of 1 sheet represents a survey made by me or under my supervision.

Florentino Ferrer
FLORENTINO FERRER L.S. 5775
DATE: 07/13/2022

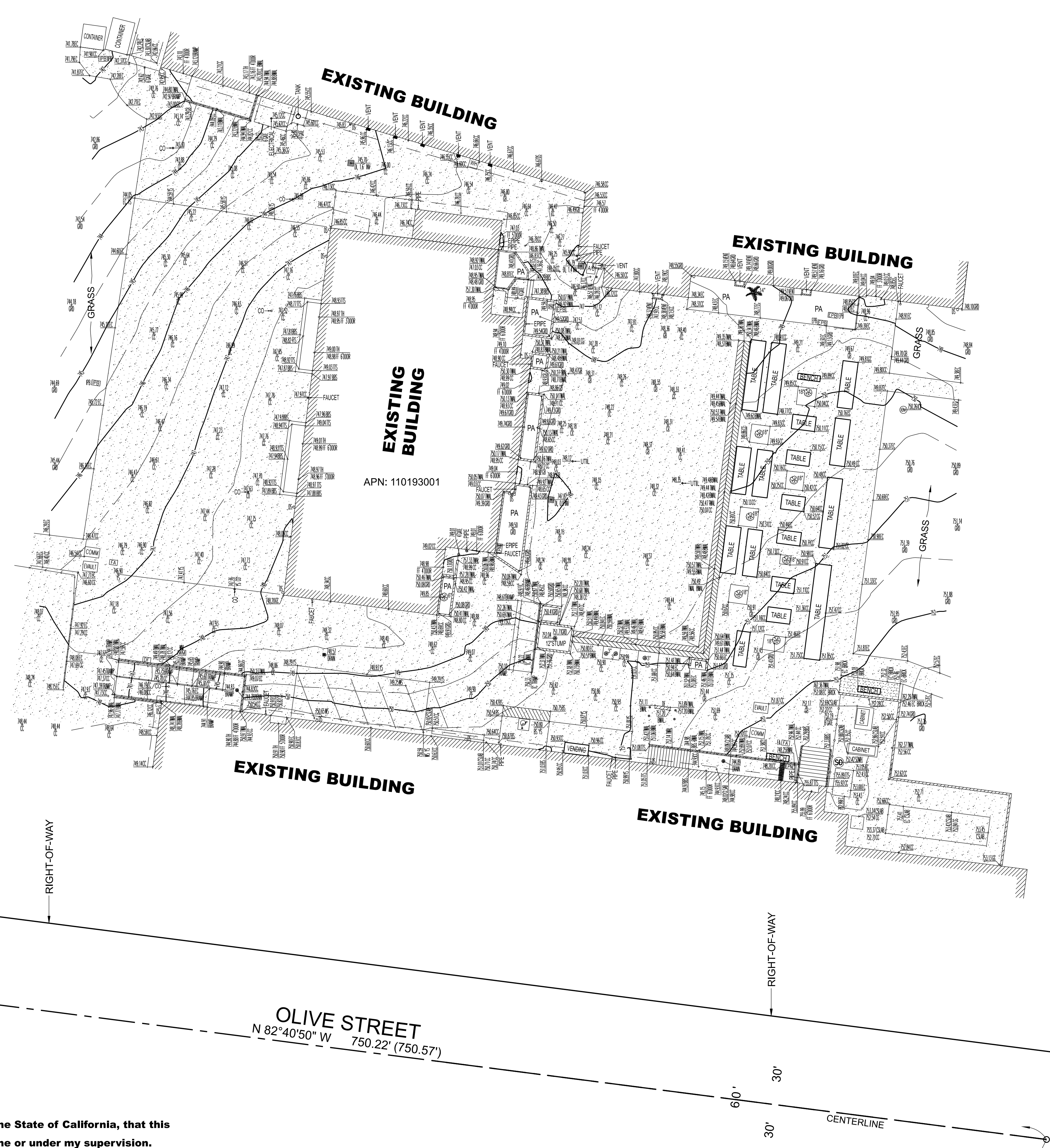
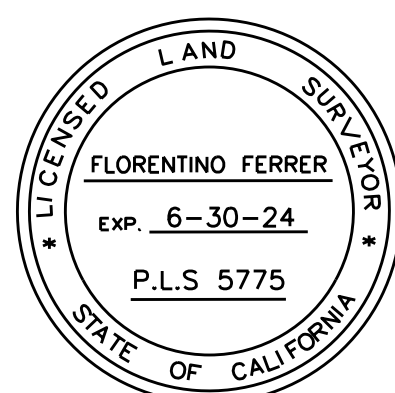

SCALE: 1" = 20'

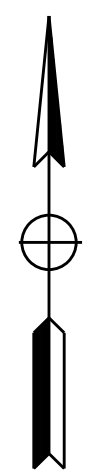

TOPOGRAPHIC SURVEY			
OWNER'S NAME: CORONA JUNIOR HIGH SCHOOL 1230 S MAIN STREET CORONA, CA 92882		Prepared By: Ferrer & Associates Land Surveying and Engineering 16388 Colima Rd. #206 Unit L Hacienda Heights, CA 91745 (626) 437-0038	
Job Location: 1230 S MAIN STREET CORONA, CA 92882	LEGAL DESCRIPTION: NONE APN: 110193001	SCALE: 1"=20' DATE: 07/13/22	DRAWN BY: P.D. REVISED: SHEET 1 OF 1 SHEETS