

Oak ES Construction Phasing

PHASE 1 Oct 10 - Mar 3 = 5 Months
Bldg. B, Classrooms 10 - 19

PHASE 2 Mar 6 - May 5 = 2 Months
Classrooms 4, 6, 7, 8, 9, & Library

PHASE 3A May 8 - Nov 31 = 6 Months

Admin. Rooms, Bldg. C, Corridors, Teacher Parking, Courtyard, Bungalows 22 & 23, Restroom 2, & Ramps

PHASE 3B Classrooms 1, 2, 3, & 5, and Perimeter Fencing

Total = 13 Months

SITE LEGEND

- PROPERTY LINE
- (E) BUILDING TO BE SOUND MITIGATED
- (E) COVERED ARCADE / WALKWAY

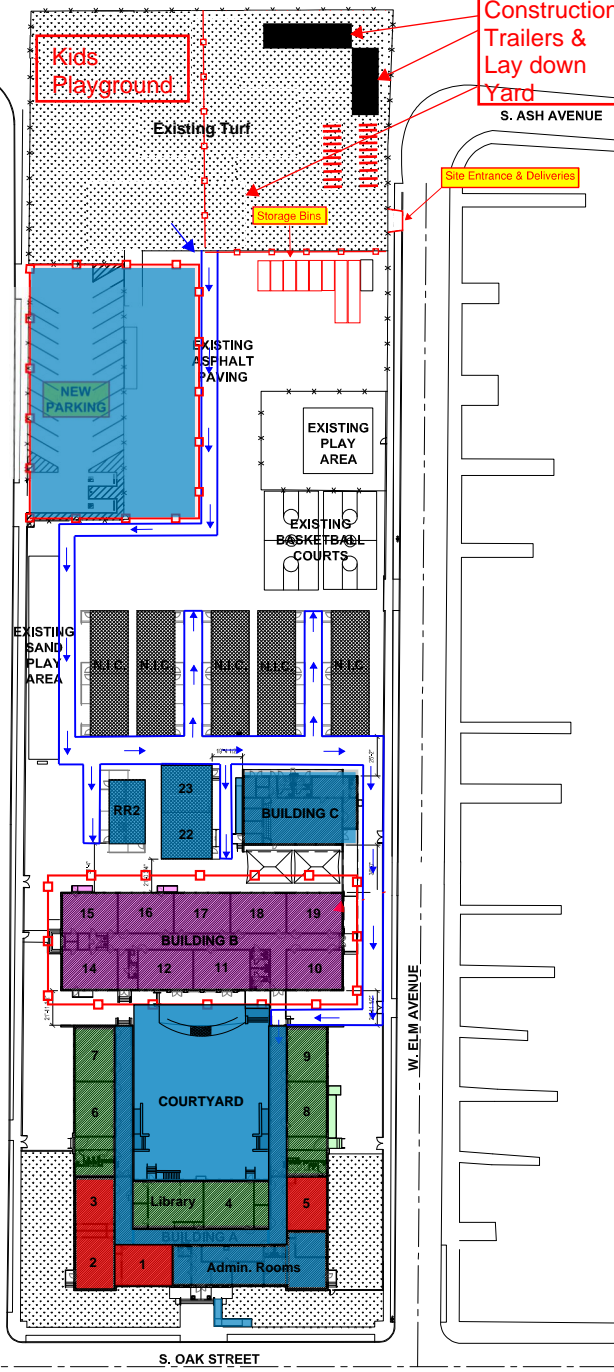

Construction Trailers & Lay down Yard

PROJECT DATA AND CODE ANALYSIS

1. OCCUPANCY AND CONSTRUCTION TYPE

1- OCCUPANCY GROUPS (PER CBC SECTION 302)

GROUP #2	ASSEMBLY * CAFETERIA / MULTISE AREA
GROUP #3	LIBRARY
GROUP 3	EDUCATIONAL AND ACCESSORY FUNCTIONS
GROUP E	EDUCATIONAL AND ACCESSORY FUNCTIONS

2- TYPE OF CONSTRUCTION

TYPE VB CONSTRUCTIBLE

3- BUILDING DATA

1- BUILDING A	(E) 1 STORY ADMINISTRATION, CLASSROOM AND BUNGALOW BUILDING	OCCUPANCY GROUP	A3 / B / E
		CONSTRUCTION TYPE	VB, NONSPRINKLERED
		BUILDING HEIGHT	(E) 10'0"
		GROSS BUILDING AREA	(E) 14,158 SF
		COVERED AREA	(E) 2,110 SF
		SUBTOTAL	(E) 12,048 SF
2- BUILDING B	(E) 1 STORY CLASSROOM BUILDING	OCCUPANCY GROUP	E
		CONSTRUCTION TYPE	VB, NONSPRINKLERED
		BUILDING HEIGHT	(E) 20'0"
		GROSS BUILDING AREA	(E) 11,246 SF
		COVERED AREA	(E) 482 SF
		SUBTOTAL	(E) 11,728 SF
3- BUILDING C	(E) 1 STORY MULTISE BUILDING	OCCUPANCY GROUP	A2
		CONSTRUCTION TYPE	VB, NONSPRINKLERED
		BUILDING HEIGHT	(E) 14'0"
		GROSS BUILDING AREA	(E) 3,154 SF
		COVERED AREA	(E) 791 SF
		SUBTOTAL	(E) 2,363 SF

4. ALLOWABLE AREA, NUMBER OF STORES AND BUILDING HEIGHT

* ALLOWABLE BUILDING HEIGHT, STORES, AREA (PER CBC CHAPTER 5)

OCCUPANCY TYPE	CONSTRUCTION TYPE	MAX ALLOWABLE STORES	MAX ALLOWABLE AREA PER STORY (SQ)	MAX ALLOWABLE AREA PER STORY (SF)
A2	TYPE VB	1	40	5,000 SF
A3	TYPE VB	1	40	5,000 SF
B	TYPE VB	2	40	5,000 SF
E	TYPE VB	1	40	5,000 SF

2- BUILDING AREA MODIFICATION CALCULATIONS

AUTOMATIC SPRINKLER INCREASE: NOT USED. ALL BUILDINGS HAVE OPEN SPACE > 30' FRONTAL PORCHES.

$A_{SP} = 0.028 \times 100$
 $A_{SP} = 2.8$
 $A_{SP} = 1 + 0.028 \times 100 = 3.8$

AREA INCREASE FOR BUILDING A, USE OCCUPANCY (A3)
 $A_{AI} = [5,000 - (5,000 \times 0.75)] \times 1.050 = 10,500 SF$
 $BL_{AI} = BL_{75} \times 1.190 + 2,881 = 9,771 SF \rightarrow (OK)$

AREA INCREASE FOR BUILDING B, USE OCCUPANCY (E)
 $A_{AI} = [5,000 - (5,000 \times 0.75)] \times 1.050 = 10,500 SF$
 $BL_{AI} = BL_{75} \times 1.190 + 2,881 = 9,771 SF \rightarrow (OK)$

AREA INCREASE FOR BUILDING C, USE OCCUPANCY (A2)
 $A_{AI} = [5,000 - (5,000 \times 0.75)] \times 1.050 = 10,500 SF$
 $BL_{AI} = BL_{75} \times 1.190 + 2,881 = 9,771 SF \rightarrow (OK)$

3- EXTERIOR WALL PROTECTION AND EXTERIOR OPENING PROTECTION

1- BUILDING ON SAME LOT (PER 502.2)

(E) HISTORY BUILDING "A" AS PORTION OF (E) HISTORY BUILDING "F"
 (E) HISTORY BUILDING "A" AS PORTION OF (E) HISTORY BUILDING "C"
 (E) HISTORY BUILDING "D" AS PORTION OF (E) HISTORY BUILDING "C"
 (E) HISTORY BUILDING "F" AS PORTION OF (E) HISTORY BUILDING "C"
 (E) HISTORY BUILDING "H" AS PORTION OF (E) HISTORY BUILDING "C"
 (E) HISTORY BUILDING "I" AS PORTION OF (E) HISTORY BUILDING "C"
 (E) HISTORY BUILDING "J" AS PORTION OF (E) HISTORY BUILDING "C"

2- FIRE RESISTIVE RATING REQUIREMENTS FOR BUILDING ELEMENTS (PER CBC TABLE 601.6, TABLE 602)
 * OCCUPANCY A, B, E
 * TYPE VB CONSTRUCTION

BUILDING ELEMENT	REQUIRED SEPARATION (HOURS)
PRIMARY STRUCTURAL FRAME	0
BUILDING WALLS	0
ROOF	0
NONFIRE-RATED WALLS AND PARTITIONS	0
SCREENER	0
NONFIRE-RATED WALLS AND PARTITIONS	0
FLOOR CONSTRUCTION AND ASSOCIATED SECONDARY MEMBERS	0
ROOF CONSTRUCTION AND ASSOCIATED SECONDARY MEMBERS	0

4- MEANS OF EGRESS ACCESS PROVISIONS

EXIT ACCESS TRAVEL DISTANCE (PER TABLE 1017.2)

OCCUPANCY	DISTANCE IN FEET IN NONSPRINKLERED BUILDING
A2 & A3	200
B	300
E	300

155 S. Fair Oaks, 2nd Floor, Pasadena, California 91105
 1 (626) 696-6906
 1 (626) 696-3440
 www.gkkworks.com

CANNON DESIGN

gkkworks

ARCHITECTURAL

AGENCY APPROVAL

SOUND MITIGATION PROGRAM

OAK STREET ELEMENTARY SCHOOL
 603 South Oak Street

PROJECT NUMBER: **10292**

DRAWN: _____
 CHECKED: _____
 DESIGNED: _____
 APPROVED: _____
 DATE: _____

CODE ANALYSIS

G101