

NEW ADDITION

Updated

Till 01-11-2021



**e-Price List
w.e.f. 10.11.2021**

The Propeller People



- ★ Gear Box Retainers
- ★ Brake Disc Rotor & Drum
- ★ Wheel Spanner & Jack Rods
- ★ Water Pump Assemblies
- ★ Fly Wheel Assemblies
- ★ Propeller Shaft Pipes
- ★ Shaft Components
- ★ Yoke Assemblies
- ★ Reverse Yoke & Bottles
- ★ Serrated Couplings, Holders
&
- ★ Dynamically Balanced
- ★ Propeller Shaft Assemblies

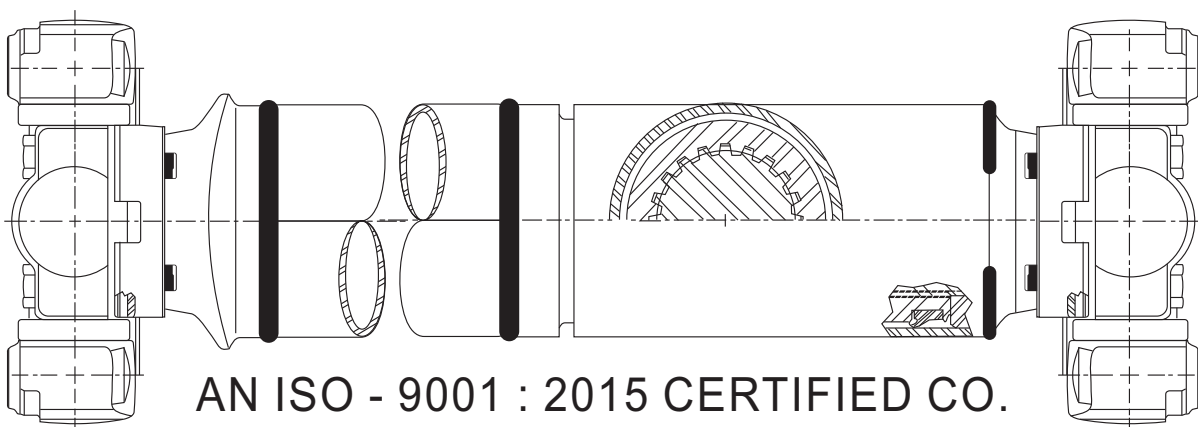

CENRON AUTO IMPEX, N. DELHI - 110005 (INDIA)

A Complete Range of Propeller Shaft Joint Parts & Assemblies
mantrycron@gmail.com

Welcome at www.cenron.org

for reasonable & reliable auto parts

Universal Joint Cross Kit - Inter Changeable Specification Chart

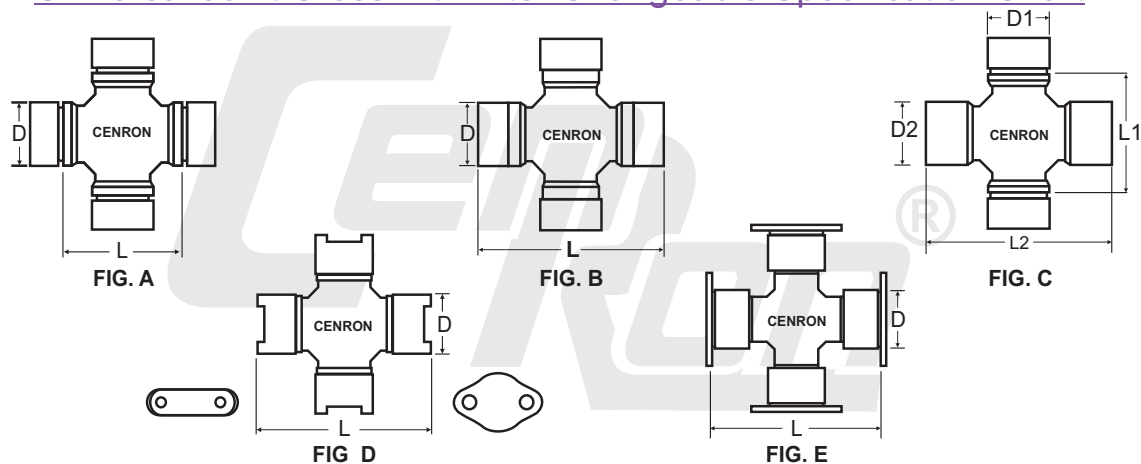

Part No.	Description	FIG.	D - Dia	L - Lock	Spicer Ref. No.	SRMT Ref. No.	GMB Ref No.
Cn-001	Tata 1210/Rotavator (With Double lock set)	A	38.04	57/102	5-1506X	RTB 490	GU 7300
Cn-002	Bedford, L/L 370	B	39.68	115.40	5-15X	RLL 493	GU 3500
Cn-003	L/L Viking	B	38.03	105.60	-	RLL 496	GU 7440
Cn-004	Tusker, Tata 1109 Ex- 1550 Series	B	34.94	126.20	5-155X	RLL 790	-
Cn-005	Tata - 407	B	30.04	81.80	-	RTB 830	GU 7420
Cn-006	Sumo Spicer	B	27.00	81.80	5-477X	RTB 820	GUM 73
Cn-007	Diesel Jeep	B	27.00	81.80	5-200X	RJP 155 D	GU 1000
Cn-007/1	Bolero Picup Front Axel	A	27.00	52.60	-	-	GU 1020
Cn-007/2	Terrex Earth Mover, Fiat	B	27.00	74.60	-	-	GU 1100
Cn-008	Trax N/M	B	30.04	81.80	-	RMD 563	-
Cn-009	Ambassador	B	23.82	61.30	5-111X	RHN 801	GU 500
Cn-010	Tata - 1312	A	46.05	68.70	INSKU-100233	RTB 690	-
Cn-011	Maruti Van / Eeco	A	25.00	40.00	5-1501X	-	GUN 27
Cn-012	Maruti Zypsy	B	25.02	63.80	5-1503X	-	GUM ZI
Cn-013	Steering 1210	A	28.00	48.70	-	RTB 505	-
Cn-014	Steering 407	B	18.00	42.20	-	-	-
Cn-015	Steering 1312	B	19.00	47	-	-	-
Cn-016	Cargo/Canter,Tata709 Turbo/Xylo	B	30.16	106.30	5-160X	RLL 500	GU 2050
Cn-017	DCM Toyota, Tata 410, 412, MF	B	30.16	92.10	5-178X	-	GU 2200
Cn-019	Taurus LT 1610 Series	B	47.62	134.90	15-701X	RLL 793	-
Cn-019/1	Bharat Benz 4928 2040 Series	B	47.68	135.11	2040 L 135	-	-
Cn-020	Taurus PT (with Patti kit)	D	47.62	134.90	-	-	GU 4000
Cn-022	2214 Spicer Spl. 90 Series	B	41.28	126.00	SPL-90X / 100X	RLL 796	-
Cn-024	JCB 3D,	C	D1-38.04 D2-35.00	L1 - 56.70 L2-106.30	-	-	-
Cn-024/1	JCB 3DX,407 Pick up 1480 Series	B	34.94	106.0	-	-	-
Cn-024/2	Tractor Mahindra PTO Shaft	B	34.94	92.7	-	-	-
Cn-024/3	Tractor Pushpak Rotovator	B	34.94	100.0	-	-	-
Cn-025	Toyota Qualls / Innova	A	29.00	47.30	5-1510X	-	GUT- 21
Cn-027	Tata ACE	A	23.82	34.90	5-170X	-	-
Cn-027/1	Tata ACE Super N/M, Ace Mega	B	23.82	59.00	-	-	-
Cn-027/2	Tata ACE Mint	B	26.00	87.00	-	-	-
Cn-027/3	Tata Intra	B	26.00	59.50	-	-	-
Cn-028	Rotavator / Tata 1210 (Grease less)	B	38.02	57/102	-	-	-
Cn-029	Tata 2518 cEx P RSB 325 Series	B	42.02	119.60	15-702X	-	-
Cn-030	Tata 4018, 4022 Weld Plate 1710 Series	E	49.20	154.90	5-280X	RTB 800	-
Cn-031	Hippo-LT	B	49.20	154.80	-	-	-
Cn-032	Hippo-PT	D	49.20	154.80	-	-	GU 5000
Cn-033	Tata 2518 Ex RSB 403 Series	B	42.02	129.35	15-703X	-	-
Cn-034	Tata 4018 RSB 470 Series	B	48.00	135.00	-	-	-
Cn-034/1	Tata RSB Shaft RSB 585 Series	B	48.02	152.50	-	-	-
Cn-034/2	Tata RSB Shaft	B	48.02	126.00	-	-	-
Cn-035	Tata ACE Magic	B	22.00	55.00	15-103X	-	GU 1700
Cn-035/1	Tata Nano	B	20.01	54.50	-	-	GUMZ 2
Cn-036	Chevrolet Tavera	A	29.00	49.30	-	-	-
Cn-037	Canter O/M	B	31.75	101.00	-	-	-
Cn-038	Tata 4928 Prima 590/2045 Series	B	52.04	147.00	2045 L147	-	-
Cn-039	Tata Hywa, AMW	B	52.04	133.00	-	-	GU 7560
Cn-040	Tata Hywa, AMW 1810 Series	B	57.02	144.00	-	-	GU 8130
Cn-041	Tata 4923, AMW, Volvo 620/2055 Series	B	57.02	152.00	2055 L152	-	GU 7630
Cn-043	AMW Machine Shaft (Patti Type)	D	59.02	167.70	-	-	-
Cn-043/1	AMW Big (Lock Type) 2060 Series	B	59.02	167.70	2060 L168	-	-

PART No.	DESCRIPTION			LIST	-	MRP
PROPELLER SHAFT PIPES & JOINT PARTS						
Cn-751	Prop. Shaft Pipe	ID-53mm, Length-32" , OD-59mm,	Tata 407	Shaft \varnothing -2 $\frac{3}{8}$ "	930-	Each 1210-
Cn-752	Prop. Shaft Pipe	ID-63mm, Length-52" , OD-70mm,	Tata 1210	Shaft \varnothing -2 $\frac{3}{4}$ "	1670-	Each 2170-
Cn-752/1	Prop. Shaft Pipe	ID-63mm, Length-60" , OD-70mm,	Tata 1210 LP	Shaft \varnothing -2 $\frac{3}{4}$ "	1890-	Each 2455-
Cn-753	Prop. Shaft Pipe	ID-68mm, Length-54" , OD-75mm,	Tata SE-Rear	Shaft \varnothing -3"	1850-	Each 2405-
Cn-753/1	Prop. Shaft Pipe	ID-68mm, Length-38" , OD-75mm,	Tata SE-Front	Shaft \varnothing -3"	1390-	Each 1805-
Cn-753/5	Prop. Shaft Pipe	ID-70mm, Length-54" , OD-77mm,	Leyland	Shaft \varnothing -3"	1970-	Each 2560-
Cn-754	Prop. Shaft Pipe	ID-82mm, Length-54" , OD-89mm,	Tata 1312 / L/L	Shaft \varnothing -3 $\frac{1}{2}$ "	2330-	Each 3030-
Cn-754/1	Prop. Shaft Pipe	ID-82mm, Length-64" , OD-89mm,	Tata 1613 TC	Shaft \varnothing -3 $\frac{1}{2}$ "	2690-	Each 3495-
Cn-754/2	Prop. Shaft Pipe	ID-82mm, Length-42" , OD-89mm,	L/L Tipper	Shaft \varnothing -3 $\frac{1}{2}$ "	1850-	Each 2405-
Cn-755	Prop. Shaft Pipe	ID-94mm, Length-60" , OD-101mm,	Leyland / Tata	Shaft \varnothing -4"	2830-	Each 3680-
Cn-755/1	Prop. Shaft Pipe	ID-94mm, Length-54" , OD-101mm,	Tipper / Trailer	Shaft \varnothing -4"	2650-	Each 3445-
Cn-755/2	Prop. Shaft Pipe	ID-94mm, Length-66" , OD-101mm,	Tipper / Trailer	Shaft \varnothing -4"	3090-	Each 4015-
Cn-755/3	Prop. Shaft Pipe	ID-94mm, Length-72" , OD-101mm,	Tata, L/L, AMW	Shaft \varnothing -4"	3390-	Each 4405-
Cn-755/4	Prop. Shaft Pipe	ID-94mm, Length-42" , OD-101mm,	Tata, L/L, AMW	Shaft \varnothing -4"	1990-	Each 2585-
CANTER N/M / L/L CARGO (1410 Series)			Cross - (Cn-016) - 30.16x106mm			
Cn-756	Cross Holder	Canter N/M	(4 H - Square - Ht.)		610-	Each 795-
Cn-756/1	Cross Holder (XLO)	Cargo / Cheetal	(4H - \varnothing 6" - Round Ht.)		730-	Each 950-
Cn-756/4	Cross Holder	Cargo SERRATED	(4 Holes - Sloted Base -Cross Canter)		1090-	Each 1415-
Cn-757	Half Yoke Shaft End	Canter N/M / Cargo / Swaraj Mazda / Mahindra Xylo			670-	Each 870-
Cn-758	Yoke & Teeth Set	Canter N/M / Cargo / Swaraj Mazda / Tata 407 Turbo Rear			1590-	Set 2065-
TN-758	Yoke & Teeth Set	Canter N/M	Teflone Coated		1890-	Set 2455-
Cn-758/1	Full yoke only-	Canter N/M / Cargo / Swaraj Mazda			1010-	Each 1315-
Cn-758/2	Rear Teeth only	Canter N/M / Cargo / Swaraj Mazda		OE No. P7D00012	630-	Each 820-
Cn-758A	Yoke & Teeth Set	Swaraj Mazda 4X4 / Canter Long		(Same Cn - 954/1)	1810-	Set 2355-
TN-758A	Yoke & Teeth Set	Swaraj Mazda 4X4	Teflone Coated	(Same Tn - 954/1)	2110-	Set 2745-
Cn-759	Front Teeth with Nut	Canter N/M	(10 - Teeth)		790-	Each 1025-
Cn-760	C.B. Coupling	Canter	(4 Holes - 10 Teeth - Square)		670-	Each 870-
Cn-760/1	G.B. Coupling	Canter N/M Long	(4 Holes - 18 Teeth - Square)		970-	Each 1260-
Cn-760/2	Pinion Coupling	Canter N/M	(4 Holes - 14 Teeth - Square)		670-	Each 870-
Cn-760/3	Pinon Coupling	Canter 10.90 G	(4 Holes - 14 Teeth - Round)		910-	Each 1185-
Cn-760/4	Pinon Coupling	Canter 11.10	(4 Holes - 18 Teeth - Round)		930-	Each 1210-
TATA 407			Cross - (Cn-005) - 30.04x81.80 mm			
Cn-761	Cross Holder		(6 Holes - \varnothing -4")		550-	Each 715-
Cn-761/1	Cross Holder Assly. (Holder + Cross + Holder)		(6 Holes - \varnothing -4" - Ht. 102mm)		1590-	Unit 2065-
Cn-762	Half Yoke Shaft End		(\varnothing -2 $\frac{3}{8}$ " Cross Tata 407)		570-	Each 740-
Cn-762/1	Half Yoke Shaft End N/M		(\varnothing -2 $\frac{3}{8}$ " Cross Tata 1210)		730-	Each 950-
Cn-763	Front Teeth with Nut		(16 Teeth)		790-	Each 1025-
Cn-764	Full Yoke Rear only		(16 Spline)		770-	Each 1000-
Cn-764/1	Yoke & Teeth Set Tata 407		(16 Spline-Pipe \varnothing -2 $\frac{3}{8}$ ")		1370-	Set 1780-
TN-764/1	Yoke & Teeth Set Tata 407	TEFLONE	(16 Spline-Pipe \varnothing -2 $\frac{3}{8}$ ")		1650-	Set 2145-
Cn-765	Rear Teeth only		(16 Teeth)		610-	Each 795-



Our Responsibility : Your Trust upon us.



PART No.	DESCRIPTION			LIST	-	MRF
TN-765	Rear Teeth only	TEFLONE	(16 Teeth)	910-	Each	1185-
Cn-765/1	Rear Teeth only N/M		(10 Teeth - Pipe $\varnothing 2\frac{3}{8}$ ")	870-	Each	1130-
Cn-766	Centre / Gear / Pinion Coup. O/M SMALL		(6 Holes - 16 Spline)	510-	Each	665-
Cn-767	Gear Box / Pinion Coupling N/M BIG		(6 Holes - 16 Spline)	590-	Each	765-
Cn-768	Full Yoke Assembly		(Full Yoke + Cross + Holder)	1810-	Unit	2355-
Cn-769	Half Yoke Assembly		(Half Yoke + Cross + Holder)	1610-	Unit	2095-
Cn-769/1	Half Yoke Assembly N/M		(H. Y. N/M + Cross 1210+ Holder)	1970-	Unit	2560-
Cn-770	Yoke & Teeth Set Tata 407 Turbo Front		(16 Teeth - Cr - D.Jeep) (Same Cn-788/1)	1630-	Set	2120-
TATA SUMO			Cross - (Cn-005 - Tata 407) 30.04x81.80 mm			
Cn-771	Cross Holder		(Same Cn - 761)	550-	Each	715-
Cn-772	Half Yoke Shaft End		(Same Cn - 762)	570-	Each	740-
Cn-773	Front Teeth with Nut		(16 Teeth)	850-	Each	1105-
Cn-774	Full Yoke Rear Only Tubler		(16 Spline)	890-	Each	1155-
Cn-775	Rear Teeth Only		(16 Teeth)	670-	Each	870-
Cn-776	C.B./G.B./ Pinion Coup		(6 Holes - 16 Spline) (Same Cn - 766)	510-	Each	665-
Cn-777	Yoke & Teeth Set Tubler		(16 Teeth)	1570-	Set	2040-
TN-777	Yoke & Teeth Set Tubler	Teflone Coated		1870-	Set	2430-
TATA 207 DI / SUMO-SPICER / DELUX / TC			Cross - (CR-006) - 27x81.80 mm			
Cn-782	Half Yoke 207 DI / Xenon/ Yodha		(Turn $\varnothing 59.5$ - Cross D.Jeep) (Same Cn-856)	480-	Each	625-
Cn-785	C.B. Coupling (Spicer Type) (Ht.- 84mm)		(16 Spline - Clamp Type)	710-	Each	925-
Cn-786	G.B. Coupling (Spicer Type) (Ht.-110mm)		(27 Spline - Clamp Type)	750-	Each	975-
Cn-787	Pinion Coupling (Spicer Type) (Ht.- 86mm)		(26 Spline - Clamp Type)	630-	Each	820-
Cn-788	Yoke & Teeth Set	SUMO Deluxe		1570-	Set	2040-
TN-788	Yoke & Teeth Set	Teflone	(16 Teeth - Cr. D.Jeep)	1870-	Set	2430-
Cn-788/1	Yoke & Teeth Set	(207 DI, Tempo Traveller)	(Same Cn-814)	1630-	Set	2120-
TN-788/1	Yoke & Teeth Set	Teflone	(Yoke-6 $\frac{1}{2}$ " - Teet -8"-16T - Brg. \varnothing -35)	1930-	Set	2510-
Cn-788/2	Yoke & Teeth Set	(Victa / Safari "MONOTRON" Shaft - Pipe- $\varnothing 2$ ")	(Same Cn-799/6)	1450-	Set	1885-
TN-788/2	Yoke & Teeth Set	Teflone	(Yoke-6 $\frac{1}{2}$ "-Teeth-8"-16T, Brg. \varnothing -35 - Fitting \varnothing -59.5)	1750-	Set	2275-
Mahindra - JEEP / MaXx / Maxi / Bolero / Scorpio			Cross - (Cn-007) - 27x81.80 mm			
Cn-791	Cross Holder (Round)	(Jeep Diesel, Commander)	(4H - PCD-80 - CR Jeep - Ht.63)	430-	Each	560-
Cn-791/1	Cross Holder (Square)	(Scorpio, Bolero, Maxi Truck, MaXx Pickup)		440-	Each	570-
Cn-792	Half Yoke	(Bolero, D. Jeep)	(Fitting \varnothing -60.5, Pipe- $\varnothing 2\frac{3}{8}$ ")	490-	Each	635-
Cn-792/1	Half Yoke	(MaXx Pickup)	(Fitting \varnothing -71, Pipe- $\varnothing 3$ ")	610-	Each	795-
Cn-792/2	Half Yoke	(Scorpio, Maxi Truck)	(Fitting \varnothing -66, Pipe- $\varnothing 2\frac{3}{8}$ ")	590-	Each	765-
Cn-793	Full Yoke Only	(Commander)		650-	Each	845-
Cn-794	Rear Teeth Only - 6"	(Commander, Bolero Pickup)		500-	Each	650-
Cn-794/1	Rear Teeth Only - 7"	(Jeep Diesel)		510-	Each	665-
Cn-795	G.B. Coupling	(Jeep Diesel)	(10 Spline - Round Base)	460-	Each	600-



PART No.	DESCRIPTION			LIST	MRP	
Cn-795/1	Pinion Coupling	Bolero	(10 Spline - Patti Type)	610- Each	795-	
Cn-795/2	Coupling Gear	Bolero NGT.	(25T - 4H-Ø97 - Ht.-97 - Seal-40)	710- Each	925-	
Cn-796	Pinion Coupling (Ht. - 76mm)	Scorpio,Jeep,Tempo Trv.	(26 Spline - Patti Type)	590- Each	765-	
Cn-796/1	Pinion Coupling	Maxi Truck, MaXx	(26 Spline - Round Base)	460- Each	600-	
Cn-797	Yoke & Teeth Set - 6"	(Commander, FC-360)	(Pipe-Ø2½")	1090- Set	1415-	
TN-797	Yoke & Teeth Set - 6"	Teflone Coated	(Yoke - 6½", Teeth-6" - Fitting Ø-60)	1350- Set	1755-	
Cn-798	Yoke & Teeth Set - 7"	(Jeep Diesel, Peoguet)	(Pipe-Ø2½")	1110- Set	1445-	
TN-798	Yoke & Teeth Set - 7"	Teflone Coated	(Yoke - 6½", Teeth-7" - Fitting Ø-60)	1370- Set	1780-	
Cn-799	Yoke & Teeth Set	(Bolero - MaXx Pickup)	(Pipe-Ø3")	1210- Set	1575-	
TN-799	Yoke & Teeth Set	Teflone Coated	(Yoke - 6½", Teeth-6¼"-Fitting Ø-71)	1510- Set	1965-	
Cn-799/1	Yoke & Teeth Set	(Bolero - Maxi Truck)	(Pipe-Ø2¾")	1210- Set	1575-	
TN-799/1	Yoke & Teeth Set	Teflone Coated	(Yoke - 6½", Teeth-6" - Fitting Ø-66)	1510- Set	1965-	
Cn-799/2	Yoke & Teeth Set HD	(Bolero Pickup Rear, SLX, Utility)	(Pipe-Ø2½")	1130- Set	1470-	
TN-799/2	Yoke & Teeth Set	Teflone Coated	(Yoke - 6½", Teeth-6" - Fitting Ø-60)	1410- Set	1835-	
Cn-799/3	Yoke & Teeth Set	(Scorpio Rear)	(Pipe-Ø2¾")	1390- Set	1805-	
TN-799/3	Yoke & Teeth Set	Teflone Coated	(Yoke - 6½", Teeth-6" - Fitting Ø-66)	1710- Set	2225-	
Cn-799/4	Yoke & Teeth Set	Bolero 4x4 Front / Jeep Willys (Rear)	(Pipe-Ø1¾")	1210- Set	1575-	
TN-799/4	Yoke & Teeth Set	Teflone Coated	(Yoke - 6½",Teeth-7½" - Fitting Ø-41)	1470- Set	1910-	
Cn-799/5	Yoke & Teeth Set	MaXx Turbo "MONOTRON" Shaft	(Pipe-Ø2½")	1330- Set	1730-	
TN-799/5	Yoke & Teeth Set	Teflone Coated	(Yoke-6",Teeth-8"Brg Ø 35-Fitting Ø-59.5)	1630- Set	2120-	
Cn-799/6	Yoke & Teeth Set HD	Scorpio Turbo	(Same Cn-788/2)	(Pipe-Ø2½")	1450- Set	1885-
TN-799/6	Yoke & Teeth Set	Teflone Coated	(Yoke - 6½",Teeth-8"Brg Ø 35-Fitting Ø-59.5)	1750- Set	2275-	
TATA 1210			Cross - (Cn-001) - 38.04x56.70 mm (IN)			
Cn-801	Cross Holder	(6 Holes - Ø120)		590- Each	765-	
Cn-801/1	Cross Holder Assembly	(6 Holes - Ø120 - Ht. 110) (Holder + Cross + Holder) (For Machine Shaft)		1870- Unit	2430-	
Cn-802	Half Yoke Shaft End	(Pipe Ø 2¾" - Cross Tata 1210)		690- Each	895-	
Cn-803	Front Teeth 1210, 1109	(Pipe Ø 2¾" - 14 Teeth)		970- Each	1260-	
Cn-804	FullYoke Rear Only	(10 Spline)		1250- Each	1625-	
Cn-805	Rear Teeth Only	(Pipe Ø 2¾" - 10 Teeth)		950- Each	1235-	
Cn-806	Centre Bearing Coupling	(6 Holes - 14 Spline)		550- Each	715-	
Cn-807	Gear Box Coupling	(6 Holes - 14 Spline)		550- Each	715-	
Cn-808	Pinion / Differential Coupling	(6 Holes - 26 Spline)		610- Each	795-	
Cn-809	Full Yoke Assembly	(Full Yoke + Cross + Holder)		2430- Unit	3160-	
Cn-810	Half Yoke Assembly 1109 / 1210	(Half Yoke 2¾" + Cross + Holder)		1930- Unit	2510-	

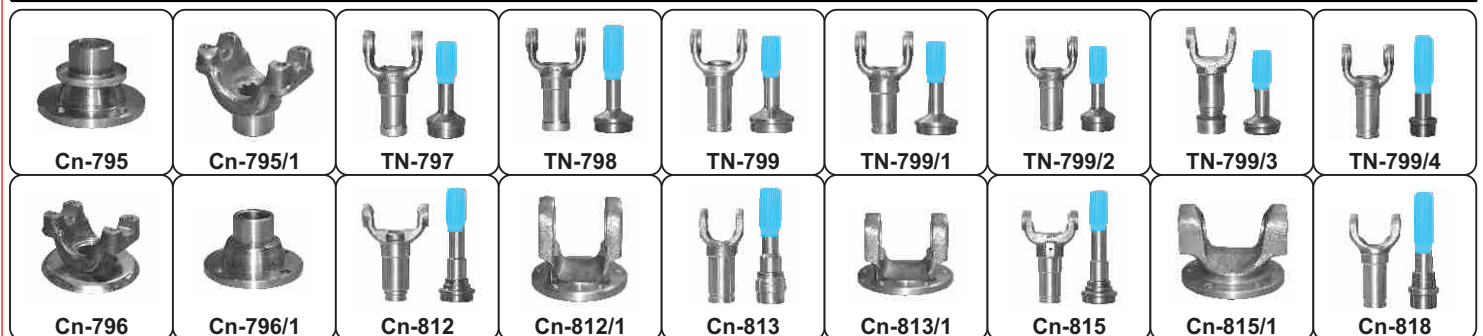

Our Responsibility : Your Trust upon us.



PART No.		DESCRIPTION			LIST	-	MRP
TATA 407 / 709 / 712 Turbo Marcopolo		Cross - Jeep / Canter / 35x106 / Chevrolet / 407 / Tusker					
TN-811	Y&T Tata 407 Spicer (Teflone)	(16T - Cr.35x106 - Y-7", - T-9½" - Brg.Ø40 - Pipe Ø3")	Marcopolo Bus	2350-	Set	3055-	
Cn-811/1	Cross Holder (Cr.35x106)	(6H - Ø120 - Plate 1210 - Cr.35x106)	(Same Cn -816/1)	770-	Each	1000-	
Cn-811/2	Half Yoke	(Pipe Ø3" - Cr.35x106)		780-	Each	1015-	
TN-812	Y&T 712 MSL, 909 Trubo (Teflone)	(16T - Cr.Tusker - Y-8" - T-9½" Brg.Ø40 - Pipe Ø3")	Marcopolo Bus	2590-	Set	3365-	
Cn-812/1	Cross Holder (Cr.35x126)	(6H - Ø120 - Plate 1210 - Cross Tusker)		830-	Each	1080-	
Cn-812/2	Half Yoke	(Pipe Ø3" - Cr. Tusker)	(Same Cn -896)	890-	Each	1155-	
TN-813	Y&T 709 / 712 Turbo (Teflone)	(22T - Cr.1210 - Y-8" - T-10" Brg.Ø50 - Pipe Ø2¾")	Marcopolo Bus	2650-	Set	3445-	
Cn-813/1	Cross Holder (Cr.38x57)	(8H - Ø5" - Plate 1312 - Cr.Tata 1210)		990-	Each	1285-	
Cn-813/2	Half Yoke	(Pipe Ø2¾" - Cr. 1210)	(Same Cn -802)	690-	Each	895-	
Cn-814	Y&T 407 Turbo Front	(16T - Cr.Jeep - Y-6½", - T-8" Brg.Ø35 - Pipe-Ø2½")	(Same Cn -788/1)	1630-	Set	2120-	
TN-814	Y&T 407 Turbo Front (Teflone)	(16T - Cr.Jeep - Y-6½", - T-8" Brg.Ø35 - Pipe-Ø2½")	(Same TN -788/1)	1930-	Set	2510-	
Cn-814/1	Cross Holder (Cr.27x82)	(4H - PCD-80 Cr. D. Jeep)	(Same Cn -791)	430-	Each	560-	
Cn-814/2	Half Yoke	(Pipe Ø2½" - Cr. D. Jeep)	(Same Cn -792)	490-	Each	635-	
TN-815	Y&T 709 Turbo (Teflone)	(16T - Cr.Canter - Y-7½", - T-9½" Brg.Ø40)	(Pipe-Ø3")	2090-	Set	2715-	
Cn-815/1	Cross Holder (Cr.30.2x106)	(6H - Ø120 - Plate 1210 - Cross Canter)	(Same Cn -820/1)	710-	Each	925-	
Cn-815/2	Half Yoke	(Pipe Ø3" - Cr. Canter)	(Same Cn -757)	670-	Each	870-	
TN-816	Y&T 407 Picup Star Bus (Teflone)	(16T - Cr.35x106 - Y-7", - T-7½")	(Pipe-Ø3½")	2270-	Set	2950-	
Cn-816/1	Cross Holder (Cr.35x106)	(6H - Ø120 - Plate 1210 - Cross 35x106)	(Same Cn -811/1)	770-	Each	1000-	
Cn-816/2	Half Yoke	(Pipe Ø3½" - Cr. 35x106)	(Same Cn -1763)	830-	Each	1080-	
Cn-816/3	Cr. Holder ULTRA (Cr.35x106)	(4H - Ø120 - Cross 35x106 - Ht. - 84)	(Serrated)	1230-	Each	1600-	
TN-816/4	Y&T Tata ULTRA (Teflone)	(24T - Cr.35x106 - Y-9", - T-8½")	(Pipe-Ø3½")	2590-	Set	3365-	
TN-816/5	Y&T Tata ULTRA (Teflone)	(24T - Cr.-35x106- -Y-9", - T-10½" - Brg Ø40)	(Pipe-Ø3½")	2870-	Set	3730-	
TN-817	Y&T 407 / 410 MSL (Teflone)	(16T - Cr.-Chevrolet -Y-6¾", -T-8" Brg.Ø35)	(Pipe-Ø3")	2030-	Set	2640-	
Cn-817/1	Cross Holder (Cr.30.2x92)	(6H - Ø120 - Plate 1210 - Cr.-Chevrolet, Ht. - 88)		730-	Each	950-	
Cn-817/2	Half Yoke	(Pipe Ø3" - Cr.-Chevrolet)		690-	Each	895-	
TN-818	Y&T 407 Turbo. (Teflone)	(16T - Cr. 407 - Y-7", - T-9" - Brg.Ø35)	(Pipe-Ø2¾")	1770-	Set	2300-	
Cn-818/1	Cross Holder (Cr.30x82)	(6H - Ø4" - Plate 407 - Cr.-407)	(Same Cn -761)	550-	Each	715-	
Cn-818/2	Half Yoke	(Pipe Ø2¾" - Cr. 407)	(Same Cn -762)	570-	Each	740-	
TN-819	Y&T 407 Turbo (Spicer) (Teflone)	(16T - Cr.-Chevrolet - Y-6¾"-T-9"-Brg.Ø35)	(Pipe-Ø2¾")	1990-	Set	2585-	
Cn-819/1	Cross Holder (Cr.30.2x92)	(6H - Ø4" - Plate 407 - Cr.-Chevrolet - Ht.-73)		770-	Each	1000-	
TN-820	Y&T 407 City Ride (6-Tyer) (Teflone)	(16T - Cr.-Canter -Y-6¾"-T-10"-Brg.Ø35)	(Pipe-Ø3")	2070-	Set	2690-	
Cn-820/1	Cross Holder (Cr.30.2x106)	(6H - Ø120 - Plate 1210 - Cr.-Canter)	(Same Cn-815/1)	710-	Each	925-	
Cn-820/2	Half Yoke	(Pipe Ø3" - Cr. Canter)	(Same Cn -757)	670-	Each	870-	
TATA SE		Cross - (Cn-001) - Tata 1210					
Cn-821	Half Yoke Shaft End	(3" - Cross Tata 1210)		750-	Each	975-	
Cn-822	Front Teeth with Nut	(3" - 14 Teeth)		990-	Each	1285-	
Cn-823	Rear Teeth Only	(3" - 10 Teeth)		1030-	Each	1340-	
Cn-824	Gear Box Coupling G.B.40	(6H - 16 Spline - Ht. 63)		650-	Each	845-	
Cn-825	Half Yoke Assembly	(Half Yoke 3" + Cross + Holder)		2030-	Unit	2640-	



Your Satisfaction - Our true reward



PART No.	DESCRIPTION		LIST	-	MRP
TATA ACE SUPER			Cross - (Cn-007) - 27x81.80 mm		
Cn-826	Cr. Holder Ace Super, Xenon, 207DI	(4H - PCD-90.5 - Square - Cr.D.Jeep - DUB.60 - Ht-67)	500-	Each	650-
Cn-827	Half Yoke Shaft End	(Cr.D.Jeep - Pipe Fitting Ø47.0mm)	540-	Each	700-
Cn-828	Full Yoke / Gear Yoke	(21 Spline - Long 6" - Cr.D.Jeep)	870-	Each	1130-
Cn-829	Pinion Coupling	(26 Spline)	610-	Each	795-
Cn-830	Prop. Shaft Assly.	(Comp. Length- 37", Pipe-26") (OE No. SIL-5016361-0665)	4590-	Unit	5965-
TATA ACE O/M			Cross - (Cn-027) - 23.82x34.9 mm (IN)		
Cn-831	Cross Holder	(4 Holes)	390-	Each	555-
Cn-832	Half Yoke Shaft End	(Turn Ø41)	410-	Each	535-
Cn-833	Full Yoke / Gear Yoke	(22 Spline)	730-	Each	950-
Cn-834	Pinion Coupling	(4 Holes - 23 Spline - Base Ø 97.0-Seal Ø 47.6 - Ht.72)	530-	Each	690-
Cn-835	Prop. Shaft Assly.	(Comp. Length-42" Pipe-30") (Yoke+Cr+HY+Pipe+HY+Cr+C.Hol.)	3990-	Unit	5185-
TATA ACE MAGIC			Cross - (Cn-035) - 22x55.0 mm		
Cn-836	Cross Holder	(4 Holes)	390-	Each	505-
Cn-837	Half Yoke Shaft End	(Turn Ø41)	410-	Each	535-
Cn-837/1	Half Yoke Ace Magic N/M	(Turn Ø41)	430-	Each	560-
Cn-838	Full Yoke / Gear Yoke	(22 Spline)	750-	Each	975-
Cn-839	Pinion Coupling	(4H - 23 Spline - Base Ø 90.5 - Seal Ø 38.6 - Ht.72)	550-	Each	715-
Cn-839/1	Pinion Coupling Ace Magic	(4H - 26T - Big Seal Dia)	530-	Each	690-
Cn-840	Prop. Shaft Assly.	(Comp. Length-45½", Pipe-36")(Yoke+Cr+HY+Pipe+HY+Cr+C.Hol.)	4090-	Unit	5315-
TATA 1312 / 1510 / 1516 / 1612 / TATA TIPPER			Cross - (Cn-010) - 46.05x68.7 mm (IN)		
Cn-841	Cross Holder	(8H - Dia - 5")	1050-	Each	1365-
Cn-841/1	Cross Holder Tata 1613 Tipper	(6H -Base1210 -Cross 1312)	1090-	Each	1415-
Cn-841/2	Cross Holder Assly.	(8H- Dia - 5" - Ht.157mm)	3190-	Unit	4145-
Cn-842	Half Yoke	(3½" - Cross 1312 - Turn Ø 82)	1110-	Each	1445-
Cn-842/1	Half Yoke Tata 1613 Tipper	(3" - Cross 1312 - Turn Ø 68)	1090-	Each	1415-
Cn-843	Front Teeth With Nut	(3½"-26Teeth)	1350-	Each	1755-
Cn-843/1	Front Teeth Tata Tipper	(3" - 14Teeth)	990-	Each	1575-
Cn-843/2	Front Teeth Tata 1613 Tipper	(3" - 26Teeth - 76 mm Pipe)	1330-	Each	1730-
Cn-844	Full Yoke Rear only	(16 Spline)	1910-	Each	2585-
Cn-844/1	Full Yoke Tata 3015,1613 Tipper	(24 Spline)	1950-	Each	2535-
Cn-845	Rear Teeth Only	(3½" - 16 Teeth)	1530-	Each	1990-
TN-845	Rear Teeth Only TEFLONE	(3½" - 16 Teeth)	1950-	Each	2535-
Cn-845/1	Rear Teeth Tata 3015,1613 Tipper	(3½" - 24 Spline)	1570-	Each	2040-
Cn-846	Centre Bearing Coupling	(8 Holes - 14 Spline)	670-	Each	870-
Cn-847	C. B Coupling 2416 (LONG)	(8 Holes - 26 Spline)	870-	Each	1130-
Cn-848	Gear Box Coupling	(8 Holes - 16 Spline -Ht. 70)	710-	Each	925-
Cn-849	Pinion / Differential Coupling	(8 Holes - 26 Spline)	730-	Each	950-
Cn-850	Full Yoke Assembly	(Full Yoke + Cross + Holder)	4150-	Unit	5395-
Cn-851	Half Yoke Assembly	(Half Yoke 3½" + Cross + Holder)	3230-	Unit	4200-
Cn-852	Yoke & Teeth Set Tata 1312	(16 Teeth - Ø 3½")	3450-	Set	4485-
TN-852	Yoke & Teeth 1312 TEFLONE	(16 Teeth - Ø 3½")	3850-	Set	5005-
Cn-852/1	Yoke & Teeth Set Tata 3015	(24 Teeth - Ø 3½")	3490-	Set	4535-



Your Suggestions are always welcome on www.cenron.org

Easy Serach Table For : Full Yoke & Reverse Yoke Set															
Cross Used	16 Teeth			20 Teeth			24 Teeth			28 Teeth			30 Teeth		
	Cn-No.	L	Pipe Ø	Cn-No.	L	Pipe Ø	Cn-No.	L	Pipe Ø	Cn-No.	L	Pipe Ø	Cn-No.	L	Pipe Ø
Tata 407 (Cn-005)	764	7"													
Canter (Cn-016)	758/1	7½"													
	758A/1	9"													
Tata 1210 (Cn-001)															
Tata 1312 (Cn-010)	844	10½"					1044	10½"							
	996/2	12"													
Tusker (Cn-004)	898	8"								981/1	12½"		981/3	14"	
	981	12½"													
	981/2	14"													
	1082/1	14"													
	1204	9½"													
L/L-370 (Cn-002)	884	8"													
Taurus L/T (Cn-019)	913	9½"													
	981/4	10½"													
Taurus P/T (Cn-020)	923	9½"													
L/L Spicer (Cn-022)	974/1	12"													
	974/3	10"													
	1083/1	14"											974	12"	
	1113/1	12"											974/2	10"	
4018 P/T (Cn-030)	1054	11"													
	1094	13"													

Centre Bearing Yoke & Teeth Set (With Bearing Seat)																																											
Tata 1210 (Cn-001)	Yoke												813	8"																													
	Teeth												Brg Ø 50	10"	Ø 2¾"																												
D.Jeep (Cn-007)	Yoke	814	6½"																																								
	Teeth	Brg Ø 35	8"	Ø 2½"																																							
Canter (Cn-016)	Yoke	815	7½"																																								
	Teeth	Brg Ø 40	9½"	Ø 3"																																							
	Yoke	820	6½"																																								
35 x 106 (Cn-024/1)	Yoke	811	7"				816/4	9"																																			
	Teeth	Brg Ø 40	9½"	Ø 3"				8½"	Ø 3½"																																		
	Yoke	816	7"				816/5	9"																																			
Chevrolet (Cn-017)	Yoke	817	6½"																																								
	Teeth	Brg Ø 35	8"	Ø 3"																																							
	Yoke	819	6½"																																								
Tata 407 (Cn-005)	Yoke	818	7"																																								
	Teeth	Brg Ø 35	9"	Ø 2¾"																																							
	Yoke	812	8"																																								
Tusker (Cn-004)	Yoke	812	8"																																								
	Teeth	Brg Ø 40	9½"	Ø 3"																																							
	Yoke	812	8"																																								
<table border="1"> <thead> <tr> <th colspan="2">Bearing Dia</th> <th colspan="2">Bearing No.</th> </tr> </thead> <tbody> <tr> <td>Ø 35</td> <td>—</td> <td>6207</td> <td></td> </tr> <tr> <td>Ø 40</td> <td>—</td> <td>6208 - 88508</td> <td></td> </tr> <tr> <td>Ø 45</td> <td>—</td> <td>6209 - 88509</td> <td></td> </tr> <tr> <td>Ø 50</td> <td>—</td> <td>6210</td> <td></td> </tr> <tr> <td>Ø 55</td> <td>—</td> <td>6211</td> <td></td> </tr> <tr> <td>Ø 60</td> <td>—</td> <td>6212</td> <td></td> </tr> </tbody> </table>																Bearing Dia		Bearing No.		Ø 35	—	6207		Ø 40	—	6208 - 88508		Ø 45	—	6209 - 88509		Ø 50	—	6210		Ø 55	—	6211		Ø 60	—	6212	
Bearing Dia		Bearing No.																																									
Ø 35	—	6207																																									
Ø 40	—	6208 - 88508																																									
Ø 45	—	6209 - 88509																																									
Ø 50	—	6210																																									
Ø 55	—	6211																																									
Ø 60	—	6212																																									
<table border="1"> <thead> <tr> <th colspan="2">No. of Teeth-27</th> </tr> </thead> <tbody> <tr> <td>874</td> <td>10"</td> </tr> <tr> <td>Brg Ø 45</td> <td>11"</td> </tr> <tr> <td></td> <td>Ø 3½"</td> </tr> </tbody> </table>																No. of Teeth-27		874	10"	Brg Ø 45	11"		Ø 3½"																				
No. of Teeth-27																																											
874	10"																																										
Brg Ø 45	11"																																										
	Ø 3½"																																										

Reverse Yoke & Bottle															
L/L-370 (Cn-002)	926	13"x5"	Ø 3"												
	929	13"x6"	Ø 3½"												
Tusker (Cn-004)	926/1	13"x5"	Ø 3"												
42 x 120 (Cn-029)				1024	13"x7"	Ø 3½"									
				1024/1	13"x7"	Ø 4"									
				1024/2	16"x10"	Ø 4"									
42 x 129 (Cn-033)				1034	13"x7"	Ø 3½"									
				1034/1	13"x7"	Ø 4"									
				1034/2	14"x9"	Ø 4"									
4018L/T 48 x 135 (Cn-034)	1064/4	15"x10"	Ø 4"										1064	13½"x8"	Ø 4"
	1064/5	16"x11"	Ø 4"										1064/1	14½"x10"	Ø 4"
													1064/2	16"x11"	Ø 4"
L/L TC (Cn-022)	1124	13"x7"	Ø 4"	1080	15"x9"	Ø 4"									
	1133/1	15"x10"	Ø 4"												
Tata 1312 (Cn-010)	1135	15"x12"		1049	13"x7"	Ø 4"									
47.7 x 135 (Cn-019/1)	1310	15"x9"	Ø 4"				1308(34T)	15"x10"	Ø 4"	1308/2(34T)	12"x9"	Ø 4"			
	1310/1	14"x9"	Ø 4"				1308/1(34T)	14"x9"	Ø 4"	1309(34T)	13½"x9½"	Ø 4¾"			
52 x 133 (Cn-039)						1244(24T)	16"x9"	Ø 4"	1244/1(34T)	15"x9"	Ø 4"				
52 x 147 (Cn-038)				1254/2(36T)	15"x8"	Ø 4¾"	1254/3(38T)	15"x8"	Ø 4¾"				1254/4	13"x8"	Ø 4"
													1254/5	15"x9"	Ø 4"
													1254/6	16"x10"	Ø 4"

PART No.	DESCRIPTION			LIST	-	MRF
TATA YODHA		Cross - (Cn-007) - 27x81.8 mm (IN)				
Cn-855	Cross Holder Tata Yodha	(4H - PCD 90.5 - Sq - Cr. - Jeep-Dub.60 - Ht-67)	(Same Cn-826)	500-	Each	650-
Cn-856	Half Yoke Tata Yodha	(Ø2? - Cr.27x81.8 - Ht.-84 - TurnØ59.5)	(Same Cn-782)	480-	Each	625-
Cn-857	Yoke & Teeth Tata Yodha	(16T - Cr.27x82 - Yoke-8" Teeth-9" - BrgØ35 - Turn Ø59.50)		1850-	Set	2405-
Tn-857	Yoke & Teeth Tata Yodha TEFLONE	(16T - Cr.27x82 - Yoke-8" Teeth-9" - BrgØ35 - Turn Ø59.50)		2250-	Set	2925-
Tata 1612 TC. / 1613 TC. (Spicer Shafts)		Cross - (Cn-004) - Tusker				
Cn-860	CrossHolder	(For Conversion) INSKU100467 (8 Holes- Ø5"-Cr. Tusker)	(Same Cn-871)	990-	Each	1285-
Cn-861	Half Yoke	(Dia. 3½") Spicer No. 4-28-307	(Same Cn-897)	1010-	Each	1315-
Cn-862	Front Teeth With Nut	No. 4-53-401+16-74-101 (3½" - 10 Teeth)	(Same Cn-1203)	1090-	Each	1415-
Cn-863	Full Yoke	(16 Spline) Spicer No. 4-3-1241KX	(Same Cn-898)	1430-	Each	1860-
Cn-864	Rear Teeth	(3½"-16Teeth) Spicer No. 4-40-761	(Same Cn-891)	1110-	Each	1445-
Cn-865	C. B. Coup. TC	(Clamp Type) Spicer No. 4-4-4211-1	(10 T-Cross Tusker)	1410-	Each	1835-
Cn-865/1	C.B. Coup.	(For Conversion)Spicer No. INSKU-100533	(10 T-TelcoType)	1230-	Each	1600-
Cn-865/2	C.B.Coup.	(For Conversion)	(10 T-Modified-Small)	890-	Each	1155-
Cn-866	G.B. Coup. TC	(Clamp Type) Spicer No.4-4-7661-1	(16 T-Cross Tusker)	1450-	Each	1885-
Cn-867	Pinion Coup. TC	(Clamp Type) Spicer No. INSKU-100175	(26 T-Cross Tusker)	1650-	Each	2145-
Cn-868	Yoke & Teeth Set	Spicer No.4-3-1241KX+4-40-761	(16 T-Ø 3½")	2490-	Set	3235-
TATA 1109 Ex2 (Spicer Shaft / 709 / 909 BS-3)		Cross - (Cn-004) - Tusker				
Cn-871	Cross Holder	(8 Hole-Ø5"-Cr. Tusker)	(Same Cn-1201/2)	990-	Each	1285-
Cn-872	Half Yoke Shaft End	(Ø3½"-Cr. Tusker)	(Same Cn-897)	1030-	Each	1340-
TN-874	Yoke & Teeth TEFLONE	(Cr.Tusker, 27Teeth- Brg.Ø45 - Pipe Ø3½"	(Spicer-5015800)	3430-	Set	4460-
Cn-874/1	Full Yoke Only	(Cr.Tusker, 27Teeth - Length-10")	(Spicer-5015802)	1730-	Each	2250-
TN-874/2	Rear Teeth TEFLONE	(27 T - Ø3½"- Brg Seat Ø 45)	(Spicer-5015803)	1750-	Each	2275-
Cn-875	Coupling Gear	(16T - 8H - Ø5"- Plate 1312 - Ht. 62 - Seal 58)		710-	Each	925-
Cn-876	Coupling Pinion	(16T - 6H - Ø120- Plate 1210 - Ht. 65)		650-	Each	845-
Cn-876/1	Coupling Pinion Tata 1109 Serrated	(4H-Ø6" - 24T - Ht.89 - Seal 85)	(Same Cn-1320)	1630-	Each	2120-
LEYLAND - BEDFORD / TUSKER (MSL)		Cross-(Cn-002 / Cn-004)-39.7x115 / 34.9x126.2 mm				
Cn-881	Cross Holder	L/L 370, Bedford (4 Holes.)		1010-	Each	1315-
Cn-881/1	Cross Holder Assly.	Hol. + Cr. + Hol. (4 Holes - Ø 6" - Ht. 132mm)		2870-	Unit	3730-
Cn-882	Half Yoke Shaft End	L/L 370, Bedford (3" Truck)		1030-	Each	1340-
Cn-883	Half Yoke Shaft End	L/L 370, Bedford (3½" Bus)		1150-	Each	1495-
Cn-884	Full Yoke Rear Only	L/L 370, Bedford (16-Spline)		1270-	Each	1650-
Cn-885	Full Yoke Assly	L/L 370, Bedford (Full Yoke +Cross+Holder)		3150-	Unit	4095-
Cn-886	Half Yoke Assly 3"	L/L 370, Bedford (Half Yoke 3" + Cross + Holder)		2830-	Unit	3680-
Cn-887	Half Yoke Assly 3½"	L/L 370, Bedford (Half Yoke 3½" + Cross + Holder)		2930-	Unit	3810-
Cn-888	Front Teeth	L/L 370, Tusker (3" - 10 Teeth)		1030-	Each	1340-
Cn-889	Front Teeth	L/L 370, Tusker (3½ - 10 Teeth)		1110-	Each	1445-
Cn-890	Rear Teeth	L/L 370, Bedford, Tusker (3" - 16 Teeth)		990-	Each	1285-
TN-890	Rear Teeth TEFLONE	L/L 370, Bedford, Tusker (3" - 16 Teeth)		1290-	Each	1675-
Cn-891	Rear Teeth	L/L 370, Bedford, Tusker (3½" - 16Teeth)		1110-	Each	1445-
TN-891	Rear Teeth TEFLONE	L/L 370, Bedford, Tusker (3½" - 16Teeth)		1410-	Each	1835-
Cn-892	C.B. Coupling	L/L 370, Tusker (10 Spline Square)		890-	Each	1155-
Cn-893	G.B. Coup. (SQUARE)	L/L 370, Tusker (6 Spline-Square)		970-	Each	1260-
Cn-893/1	G.B. Coup. (ROUND)	L/L 370, Tusker (6 Spline-Round)		1090-	Each	1415-
Cn-894	Pinion Coupling	L/L 370, Tusker (10 Spline Round)		1050-	Each	1365-
Cn-895	Cross Holder (SQUARE)	(4 Holes) Tusker (Same Cn-1201)		810-	Each	1055-



Cn-871



Cn-872



Cn-874



Cn-892



Cn-893



Cn-893/1



Cn-913



Cn-916



Cn-917

Building future with trust



PART No.	DESCRIPTION			LIST	MRP
Cn-896	Half Yoke Shaft End	Tusker	(3" Truck)	890- Each	1155-
Cn-897	Half Yoke Shaft End	Tusker	(3½ - Bus) (Same Cn-1202)	1030- Each	1340-
Cn-898	Full Yoke Rear (Regular)	Tusker	(16 Spline, Total Length 8")	1430- Each	1860-
Cn-899	Full Yoke Assly.	Tusker	(Full Yoke+Cross+Holder)	2950- Unit	3835-
Cn-900	Half Yoke Assly. 3"	Tusker	(Half Yoke 3" + Cross + Holder)	2450- Unit	3185-
Cn-901	Half Yoke Assly. 3½"	Tusker	(Half Yoke 3½"+Cross + Holder)	2590- Unit	3365-
Leyland Taurus, 1612, 1613, Hino			Cross - (Cn-019 / 020) - 47.62x134.9 mm		
Cn-911	Cross Holder	Circlip Type - Lock Type	(8 Holes)	1610- Each	2095-
Cn-912	Half Yoke Shaft End	Circlip Type - Lock Type		1630- Each	2120-
Cn-913	Full Yoke Rear Only	Circlip Type - Lock Type	(16 Spline) MSL - 3520101	2150- Each	2795-
Cn-914	Full Yoke Assly	Circlip Type - Lock Type	(Yoke+Cross+Holder)	4950- Unit	6435-
Cn-915	Half Yoke Assly	Circlip Type - Lock Type	(Half Yoke +Cross+Holder)	4450- Unit	5785-
Cn-916	Front Teeth with Nut	(Same Cn-1753/1)	(3½" - 16 Teeth)	1310- Each	1705-
Cn-917	Rear Teeth Only		(3½" - 16 Teeth) MLS-3540901	1290- Each	1675-
Cn-918	Centre Bearing Coupling		(8 H - 16 Spline)	1530- Each	1990-
Cn-918/1	Centre Bearing Coupling		(8 H - 10 Spline)	1510- Each	1965-
Cn-919	Gear Box Coupling		(8 H - 6 Spline)	1590- Each	2065-
Cn-920	Pinion Coupling	Same Cn-977/2	(8 H - 39 Spline)	1530- Each	1990-
Cn-920/1	Pinion Coupling		(8 H - 10 Spline Big Bore - 95mm)	1630- Each	2120-
Cn-921	Cross Holder	Patti Type	(8 H)	1670- Each	2170-
Cn-922	Half Yoke Shaft End	Patti Type		1650- Each	2145-
Cn-923	Full Yoke Rear Only	Patti Type	(16 Spline)	2170- Each	2820-
Cn-926	Reverse Yoke 13" & Bottle	Pipe Ø 3"x16 T	(Cross L/L 370)	3770- Set	4900-
Cn-926/1	Reverse Yoke 13" & Bottle	Pipe Ø 3"x16 T	(Cross Tusker)	3750- Set	4875-
Cn-928	Only Bottle 3"		Leyland / Tusker Teeth	1450- Each	1885-
Cn-928/1	Only Bottle 3 ½"		Taurus Teeth Heavy Duty	1830- Each	2380-
Cn-929	Reverse Yoke 13" & Bottle	Pipe Ø 3 ½"x16 T	(H. Duty Teeth-Cross L/L 370)	4130- Set	5370-
MAHINDRA MAXIMO / PLUS			Cross - (Cn-007) - 27.02x81.80 mm		
Cn-931	Cross Holder		(Cross D.Jeep-Square-4Hole)	460- Each	600-
Cn-932	Half Yoke Shaft End	Same Jeep Willy's	(Cross D.Jeep)	430- Each	560-
Cn-933	Full Yoke / Gear Yoke		(Cross D.Jeep)	890- Each	1155-
Cn-934	Pinion Coupling			530- Each	690-
Cn-935	Prop. Shaft Assly. Maximo	(Complete Length-26½", Pipe-15")	(Yoke+Cr+HY+Pipe+HY+Cr+C.Hol.)	4550- Unit	5915-
Cn-935/1	Prop. Shaft Assly. MaximoM Plus	(Complete Length-30½", Pipe-19")	(Yoke+Cr+HY+Pipe+HY+Cr+C.Hol.)	4650- Unit	6045-
AMBASSADOR			Cross - (Cn-009) - 23.82x61.30 mm		
Cn-941	Cross Holder		(4 H- Round)	340- Each	440-
Cn-941/1	Cross Holder	(Milled-Plain Face)	(4 H- Round)	350- Each	455-
Cn-942	Half Yoke Shaft End			370- Each	480-
Cn-943	Full Yoke Rear Only		(16-Spline)	530- Each	690-
Cn-943/1	Full Yoke Assly.	Machine Shaft	(Cr-Hol+Cross Amb+F.Yoke)	1250- Unit	1625-



For new development visit us at : www.cenron.org

PART No.	DESCRIPTION			LIST	-	MRP
Cn-944	Rear Teeth Only		(16-Teeth)	400-	Each	520-
Cn-945	Gear Box Coupling		(4 H - 6 Spline)	410-	Each	535-
Cn-946	Pinion Coupling		(4 H - 6 Spline)	410-	Each	535-
Cn-947	Yoke & Teeth Set		(16-Spline & Teeth)	890-	Set	1155-
TN-947	Yoke & Teeth Set	Teflone Coated	(16 Spline & Teeth)	1130-	Set	1470-
Cn-948	Cross Holder Assly.	Holder + Cross + Holder	(4 H - Ø 86 - Ht. 63) (Same Cn-2110)	1130-	Unit	1470-
SWARAJ MAZDA			Cross - (Cn-016) - 30.18x106.3 mm			
Cn-951	Cross Holder		(4 H - Round Base)	690-	Each	895-
Cn-951/1	Cross Holder		(4 H - Square Base)	710-	Each	925-
Cn-952	Half Yoke	Same Cn-757	(Cross Canter)	670-	Each	870-
Cn-953	Front Teeth with Nut		(34 Teeth)	750-	Each	975-
Cn-954	Yoke & Teeth set	Same Cn-758	(Cross Canter)	1590-	Set	2065-
TN-954	Yoke & Teeth set	Same TN-758	(TEFLONE COATED)	1890-	Set	2455-
Cn-954/1	Yoke & Teeth set 4x4	Same Cn-758A	(16T - Cr. Canter - Pipe Ø3" - Brg. Ø40)	1810-	Set	2355-
TN-954/1	Yoke & Teeth set	Same TN-758A	(TEFLONE COATED)	2110-	Set	2745-
Cn-955	C.B. Coupling		(4 H - 34 Teeth)	670-	Each	870-
Cn-956	Pinion Coupling		(4 H - 31 Teeth-Square)	690-	Each	895-
LEYLAND DOST			Cross - (Cn-007) - 27x81.80 mm			
Cn-961	Cr. Holder		(4 H - Square - Fitting Ø 50mm - Cr.D.Jeep)	510-	Each	665-
Cn-962	Half Yoke Shaft End		(Cr. D.Jeep - Pipe Fitting Ø 47mm)	510-	Each	665-
Cn-963	Full Yoke / Gear Yoke		(25 Spline - Long 7" - Cr. D.Jeep)	930-	Each	1210-
Cn-964	Pinion Coupling			650-	Each	845-
Cn-965	Prop. Shaft Assly.	(Complete Length- ", Pipe-24") (Yoke+Cr+HY+Pipe+HY+Cr+Cr.Hol.)		4750-	Unit	6175-
TATA HYWA, LEYLAND 2214, TUSKER SUPER (SPICER-Spl. 90)			Cross - (Cn-022) -41.28x126 mm			
Cn-971	Cr. Holder	Spicer No. 90-2-19	(8H - Ø7" - Cr. L/L TC -Ht-120)	1450-	Each	1885-
Cn-971/1	Cr. Holder Short	SERRATED 90-2-15/30	(4H - Ø6" - Cr. L/L TC - Ht-110) (Same Cn-1071)	1570-	Each	2040-
Cn-971/2	Cr. Holder Long	SERRATED	(4H - Ø6"-Long-Cr L/L TC - Ht-127) (Same Cn-1121)	1610-	Each	2095-
Cn-971/3	Cr. Holder	SERRATED	(4H - Ø5" - Cr. L/L TC - Ht-110)	1370-	Each	1780-
Cn-972	Half Yoke	90-28-27 / 90-28-17	(Ø4" - Cr. L/L TC -Ht-128) (Same Cn-1072)	1350-	Each	1755-
Cn-972/1	Half Yoke	Long	(Ø4" - Cr. L/L TC -Ht-135)	1710-	Each	2225-
Cn-973	Front Teeth	5-53-271 / 90-53-31	(Ø4" - 34 T-Brg. Ø45 - Ht-6) (Same Cn-1043/3)	1130-	Each	1470-
Cn-974	Full Yoke	Spicer 2214 30 Teeth	(30T - Cr. L/L TC - Ht.12") (Same Cn-996)	2230-	Each	2900-
TN-974	Yoke & Teeth	Spicer 2214 Teflone	(30T - Ø4" - Cr L/L TC - Y-12",T-10¾")	4190-	Set	5445-
Cn-974/1	Full Yoke	MSL 2214 16 Teeth	(16T - Cr. L/L TC - Ht.12") (Same Cn-996/1)	2210-	Each	2875-
TN-974/1	Yoke & Teeth	MSL 2214 Teflone	(16T - Ø4" - Cr L/L TC - Y-12", T-10¾")	4170-	Set	5420-
Cn-974/2	Full Yoke Small	Spicer 3516 / 4018 - 30 Teeth	(30T -Cr. L/L TC - Ht.10") (Same Cn-996/4)	2210-	Each	2875-
Cn-974/3	Full Yoke Small	MSL 3516 / 4018 - 16 Teeth	(16T - Cr. L/L TC - Ht.10") (Same CN-996/3)	2190-	Each	2845-
Cn-975	Rear Teeth	INSKU-100051 30 Teeth	(Ø4" - 30T - Ht.10%) EN-15	1550-	Each	2015-
TN-975	Rear Teeth	INSKU-100276 Teflone	(Ø4" - 30T - Ht.10%) EN-15	1950-	Each	2535-



Cross Holders

Easy Search Table for : Cross Holders

Base Dia	Ø 4¾" or 120 mm			Ø 5" or 130 mm			Ø 6" or 145 mm			Ø 6½" or 165 mm			Ø 7" or 175 mm		
	Tata 1210 Plate			Tata 1312 Plate			L/L 370 Plate			4018 Plate			Taurus Plate		
Holes	Cn-No.	Cross	Ht.	Cn-No.	Cross	Ht.	Cn-No.	Cross	Ht.	Cn-No.	Cross	Ht.	Cn-No.	Cross	Ht.
4 Hole				951	Canter	69	881	L/L370	95						
							895	Tusker	80						
							983	Tusker	105						
							983/3	L/L Spicer	105						
							1761/1	35 x 106	75						
6 Hole	801	Tata 1210	87												
	812/1	Tusker	90												
	815/1	Canter	88												
	816/1	35 x 106	88												
	817/1	Chevrolet	88												
	841/1	Tata 1312	113												
8 Hole				813/1	Tata 1210	90	1021/3	42 x 120	100	1031	42 x 129	135	911	Taurus L/T	116
				841	Tata 1312	113	1021/5	42 x 120	116	1051	4018 PT	135	921	Taurus P/T	120
				871	Tusker	114	1031/4	42 x 129	130	1051/1	L/L Spicer	125	971	L/L Spicer	115
				990	Tata 1312	118	1041	Tata 1312	121	1051/6	L/L Spicer	115	1031/3	42 x 129	135
				990/2	L/L Spicer	113	1041/2	L/L Spicer	116	1061	48 x 135	126			
				1021	40 x 120	110	1041/2	42 x 129	116	1281	57 x 144	136			
				1031/7	42 x 129	116	1061/5	48 x 135	126						
				1051/7	4018 PT	145	1088/1	Tusker	106						
10 Hole				1301	47.7 x 135	132							1261	57x152	140

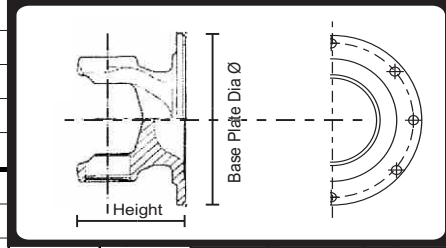

Serrated Base Cross Holders

4 Hole	756/4	Canter	81	971/3	L/L Spicer	110	971/1	L/L Spicer	110						
	816/3	3 5x 106	84	1021/1	42 x 120	110	971/2	L/L Spicer	127						
	1201/1	Tusker	94				1021/2	42 x 120	110						
							1021/4	42 x 120	127						
							1031/1	42 x 129	127						
							1031/2	42 x 129	105						
							1041/4	Tata 1312	125						
							1051/2	4018 P/T	120				1031/5	42 x 129	128
							1051/4	4018 P/T	130				1051/3	4018 P/T	120
							1061/1	48 x 135	116				1061/2	48 x 135	112
							1061/3	48 x 135	134				1061/4	48 x 135	128
							1088	Tusker	100				1241/1	52 x 133	128
							1241	52 x 133	125				1251/1	52 x 47	140
							1251	52 x 147	125				1251/2	52 x 147	125
							1251/3	52 x 147	140				1261/1	57 x 152	135
							1285	48 x 154	130				1261/2	57 x 152	150
							1302	47.7 x 135	120				1303	47.7 x 135	112
							1302/1	47.7 x 135	135				1303/1	47.7 x 135	138

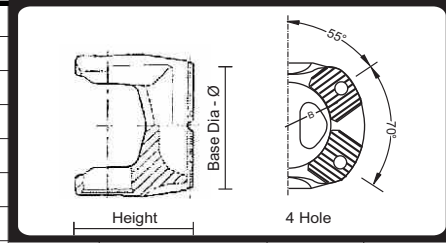

We will certainly appreciate your intimation about any error in our efforts in tabulating the informations. Kindly inform at mantry@cenron.org or at our customer care no.: +91-9711 2111 24 The specifications are for references only.

PART No.	DESCRIPTION				LIST	-	MRP
Cn-975/1	Rear Teeth	MSL 2214 -	16 Teeth	(Ø4" - 16T - Ht.-10¾")	EN-15	1570-	Each 2040-
TN-975/1	Rear Teeth	TEFLONE	16 Teeth	(Ø4" - 16T - Ht.-10¾")	EN-15	1970-	Each 2560-
Cn-975/2	Rear Teeth Small	Spicer 3516 / 4018	30 Teeth	(Ø4" - 30T - Ht.-9")	INSKU-100147)	1530-	Each 1990-
Cn-975/3	Rear Teeth Small	MSL 3516 / 4018	16 Teeth	(Ø4" - 16T - Ht.-9")		1550-	Each 2015-
Cn-976	C.B. Coup.	No. 5-1-6501		(8H - 34T - Dia-7" - Ht-61 - Seal-55)		1250-	Each 1625-
Cn-976/1	C.B. Coup.	No. 90-4-11-1 (Patti Type)		(34T - Cross - Spl. 90)		1750-	Each 2275-
Cn-976/2	C.B. Coup.	SERRATED . 90-1-15		(4H - Ø6" - 34T - Ht.62" - Seal-56) (Same Cn-1039)		1350-	Each 1755-
Cn-977	Pin. Coup.			(8H - Ø7" - 39T - Ht-87 - Seal-76)		1550-	Each 2015-
Cn-977A	Pin. Coup.	LONG		(8H - Ø7" - 39T - Ht-103 - Seal-76)		1650-	Each 2145-
Cn-977/1	Pin. Coup.			(8H - Ø7" - 41T - Ht-80 - Seal-76)		1510-	Each 1965-
Cn-977/2	Pin. Coup.			(8H - Ø7" - 39T - Ht-87 - Seal-71) (Same Cn-920)		1530-	Each 1990-
Cn-978	G. Box Coupling		(ZF Coupling)	(8H - Ø7" - 28T - Ht-60 - Seal-54)		1250-	Each 1625-
Cn-978/1	G. Box Coupling	LONG	(ZF Coupling)	(8H - Ø7" - 28T - Ht-114 - Seal-54)		1670-	Each 2170-
Cn-978/2	Coupling 2214 Ex	SERRATED	(ZF Coupling) (SC)	(4H - Ø6" - 28T - Ht-100 - Seal-60) (Same Cn-1074)		1690-	Each 2195-
Cn-978/3	Coupling 2214 Ex	SERRATED	(ZF Coupling)	(4H - Ø6" - 39T - Ht-92 - Seal-76) (Same Cn-1038)		1770-	Each 2300-
Cn-978/4	Coupling	SERRATED	EATON	(4H - Ø6" - 28T - Ht. 75 - Seal-78) (Same Cn-1319)		1710-	Each 2225-
Cn-978/5	Coupling	SERRATED	EATON	(4H - Ø6" - 28T - Ht. 95 - Seal-78) (Same Cn-1319/1)		1730-	Each 2250-
Cn-978/6	Coupling Gear	SERRATED	EATON Tata L/L	(4H-Ø6" - 30T - Ht.77 - Seal-70)		1710-	Each 2225-
Cn-978/7	Coupling Gear	SERRATED	GB-850 L/L	(4H-Ø6" - 28T - Ht.60 - Seal-70, Brg Ø72) Diamond Cut		1350-	Each 1755-
Cn-978/8	Coupling Gear ZF	SERRATED	Cargo 909	(4H-Ø5" - 28T - Ht.90 - Seal-54, Brg Ø60)		1230-	Each 1600-
INTER AXLE SHAFT FOR LEYLAND 2516 TC AC TATA LPK 2516 (6X4) TIPPER (HYWA)				Cross - (Cn-004) - Tusker 34.94x126.2 mm			
Cn-981	Full Yoke only	(MSL Shaft)		(16T - Cr. Tusker - Ht.12½")		2030-	Each 2640-
Cn-981/1	Full Yoke	(Spicer No. INSKU- 100377)		(28T - Cr. Tusker - Ht.12½")		2070-	Each 2690-
Cn-981/2	Full Yoke Big	(MSL Shaft)		(16T - Cr. Tusker - Ht.14")		2110-	Each 2745-
Cn-981/3	Full Yoke Big	(SIL No.INSKU-100449)		(30T - Cr. Tusker - Ht.14")		2130-	Each 2770-
Cn-981/4	Full Yoke	2214 Taurus N/M		(16T - Cr. Taurus LT - Ht.10½")		2450-	Each 3185-
Cn-982	Rear Teeth	(MSL Shaft)		(Ø3½" - 16T - Ht.10½")		1530-	Each 1990-
Cn-982A	Rear Teeth			(Ø4" - 16T - Ht.10¾") (Same Cn-975/1)		1570-	Each 2040-
Cn-982/1	Rear Teeth	(No. INSKU-100370)		(Ø3½" - 28T - Ht.11½")		1530-	Each 1990-
Cn-982/2	Rear Teeth Big	(MSL Shaft)		(Ø3½" - 16T - Ht.12½")		1650-	Each 2145-
Cn-982/3	Rear Teeth Big	No. INSKU-100448		(Ø3½" - 30T - Ht.12½")		1670-	Each 2170-
Cn-982/4	Rear Teeth	2214 Taurus N/M		(Ø3½" - 16T - Ht.11½")		1630-	Each 2120-
Cn-983	Long Cross Holder	No. INSKU-100082		(4H - Square - Cr. Tusker - Ht-105)		1150-	Each 1495-
Cn-983/1	Long Cross Holder	(L/L-370)		(4H - Square - Cr.L/L 370 - Ht-105)		1130-	Each 1470-
Cn-983/3	Long Cross Holder	(L/L-1613TC)		(4H - Square - Cr.L/L TC - Ht-105)		1150-	Each 1495-
Cn-984	Long Half Yoke	No. 4-28-417		(Ø3½ - Cr. Tusker - Ht-115)		1130-	Each 1470-
Cn-984/1	Long Half Yoke	(Use CN-883)		(Ø3½ - Cr. L/L 370 - Ht-120)		1150-	Each 1495-
Cn-984/2	Long Half Yoke	INSKU-100975 / 963		(Ø4" - Cr.Tusker - Ht-107)		1270-	Each 1650-
Cn-984/3	Long Half Yoke	(L/L 1613TC)		(Ø3½" - Cr. L/L TC - Ht-135) (Same Cn-995/1)		1410-	Each 1835-
Cn-984/4	Long Half Yoke	(Extra Long)		(Ø4" - Cr. Tusker - Ht-125)		1450-	Each 1885-



PART No.	DESCRIPTION			LIST	MRP
Cn-985	Pinion Coupling	1st Axle output	(4H - 34T - L/L Square - Ht-78 - Seal-63)	970- Each	1260-
Cn-985/1	Pinion Coupling	No. 4-4-4101-1	(34T - Cr.Tusker - Patti Type)	1670- Each	2170-
Cn-985/2	Coup.Through Shaft	SERRATED	(4H.- Ø6 - 34 T - Ht-85 - Seal-64) (Same Cn-1039/1)	1510- Each	1965-
Cn-986	Pinion Coupling	1st Axle Input	(4H - 41T - L/L Square - Ht-92 - Seal-76.5)	1190- Each	1545-
Cn-986/1	Pinion Coupling	No. INSKU-100475	(41T - Cr. L/L Spicer - Patti Type)	1670- Each	2170-
Cn-987	Pinion Coupling	2nd Axle Input	(4H - 39T - L/L Square - Ht-87 - Seal-69.7)	1190- Each	1545-
Cn-987/1	Pinion Coupling	No. INSKU-100476	(39T - Cr.Tusker - Patti Type)	1670- Each	2170-
Cn-988	Output Coupling	(ZF Coupling)	(4H - 28 T- L/L Square - Ht-83 - Seal-54)	1190- Each	1545-
TATA 2515 / 2516 (HYWA) / 3118 EX. SERIES			Cross - (Cn-022) - L/L Spicer		
Cn-990	Cr. Hol. Long	INSKU-100231	(8H - Ø5" - Cr 1312 - Ht-118)	1110- Each	1445-
Cn-990/1	Cross Holder		(8H - Ø7" - Cr - L/L TC - Ht -120) (Same Cn-971)	1450- Each	1885-
Cn-990/2	Cross Holder	INSKU 100860	(8H - Ø5" - Cr - L/L TC - Ht -113)	1130- Each	1470-
Cn-991	C.B. Coupling	One Step	(8H - Ø5" - 34T - Ht-77)	950- Each	1235-
Cn-991/1	C.B. Coupling.	No.-90-4-11-1	(34T - Cr L/L TC - Patti Type) (Same Cn- 976/1)	1750- Each	2275-
Cn-991/2	C.B. Coupling	Two Step Hywa N/M	(8H - Ø5" - 34T - Ht-78 - Seal-64)	1050- Each	1365-
Cn-992	Pinion Coupling		(8H - Ø5" - 39T - Ht-85 - Seal-76.3)	1130- Each	1470-
Cn-993	Pinion Coupling		(8H - Ø5" - 41T - Ht-91 - Seal-76.3)	1150- Each	1495-
Cn-993/1	Pinion Coupling	No. 100475	(41T - Cr L/L TC - Patti Type) (Same Cn-986/1)	1670- Each	2170-
Cn-994	G.B. Coupling	GB-60	(8H - Ø5" - 18T - Ht-90)	970- Each	1260-
Cn-994/1	Gear Coupling	GB-60 Modified SERRATED	(4H - Ø6" - 18T - Ht. 90 - Seal-64)	1590- Each	2065-
Cn-995	Half Yoke	No. INSKU-100232	(Ø3½" - Cr Tata 1312) (Same Cn-842)	1110- Each	1445-
Cn-995/1	Half Yoke		(Ø 3½" - Cr L/L TC - Ht-135) (Same Cn-1042)	1410- Each	1835-
Cn-996	Full Yoke	No. INSKU-100257	(30T - Cr L/L TC - Ht.12") (Same Cn-974)	2230- Each	2900-
TN-996	Yoke & Teeth Set	Tata 2515 HYWA	Spicer No. INSKU-100257+100524	4050- Set	5265-
		Teflone Coated	(30T - Ø3½" - Cr L/L TC - Yoke-12" Teeth-10%)		
Cn-996/1	Full Yoke MSL Shaft		(16T - Cr L/L TC - Ht.12") (Same 974/1)	2210- Each	2875-
TN-996/1	Yoke & Teeth Set	Tata 2515 HYWA MSL Shafts		4070- Unit	5290-
		Teflone Coated	(16T - Ø3½" - Cr L/L TC - Yoke-12" Teeth-10%)		
Cn-996/2	Full Yoke	(Tata 1312 Long)	(16T - Cr 1312 - Ht.-12")	2230- Each	2900-
Cn-996/3	Full Yoke (Small)		(16T- Cr. L/L TC - Ht-10") (Same Cn-974/3)	2190- Each	2845-
Cn-996/4	Full Yoke (Small)	No. INSKU-100259	(30T - Cr. L/L TC - Ht-10")	2210- Each	2875-
Cn-997	Rear Teeth	No. INSKU-100524	(Ø3½" - 30T - Ht 10%)	1530- Each	1990-
Cn-997/1	Rear Teeth	(MSL Shaft)	(Ø3½" - 16T -Ht.10%)	1550- Each	2015-
Cn-997/2	Rear Teeth	(Tata 1312 Long)	(Ø3½" - 16T - Ht.13½")	1750- Each	2275-
Cn-997/3	Rear Teeth (Small)	MSL Shafts	(Ø3½" - 16T - Ht.-9")	1450- Each	1885-
Cn-997/4	Rear Teeth (Small)	INSKU-100433	(Ø3½" - 30T - Ht.-9")	1470- Each	1910-
Cn-998	Front Teeth	No. 100853	(Ø4" - Ht-8" - 26T - Brg.Ø55)	1570- Each	2040-
Cn-998/1	Front Teeth	Two Step	(Ø4" - Ht-7" - 26T - Brg.Ø65) (Same Cn-1093/2)	1550- Each	2015-
Cn-998/2	Front Teeth	One Step	(Ø4" - Ht-7" - 26T - Brg.Ø65)	1570- Each	2040-
Cn-999	Coup 2416 Extra Long	INSKU-100847	(8H - Ø5" - 26T - Ht-92)	1030- Each	1340-
Cn-999/1	Coupling Center	SERRATED	(4H - Ø6" - 26T - Ht.-80 - Seal-69)	1610- Each	2095-
Cn-999/2	Coupling	SERRATED Diamond Cut	(4H - Ø6" - 26 T - Ht.-110- Seal-68) (Same Cn-1037/2)	1710- Each	2225-
Cn-999/3	Coupling	Tata	(8H - Ø6" - 26 T -Ht.-82 - Seal-68)	1350- Each	1755-
Cn-1000	Coupling Center	Tata	(8H - Ø7" - 26 T - Ht.-95 - Seal-71)	1550- Each	2015-





PART No.		DESCRIPTION			LIST	-	MRP	
TATA 2518 cEx		Cross - (Cn-029) - 42x119.60mm						
Cn-1021	Cross Holder		(8H - Ø5" - Cr. 42x120 - Ht-110)		1190-	Each	1545-	
Cn-1021/1	Cross Holder	SERRATED	(4H - Ø5" - Cr. 42x120 - Ht-105)		1290-	Each	1675-	
Cn-1021/2	Cross Holder	SERRATED	(4H - Ø6" - Cr. 42x120 - Ht-110)		1510-	Each	1965-	
Cn-1021/3	Cross Holder	Tata 2516 Turbo	(8H - Ø6" - Cr. 42x120 - Ht-106)		1250-	Each	1625-	
Cn-1021/4	Cross Holder Long	SERRATED	(4H - Ø6" - Cr.42x120 - Ht-127)		1630-	Each	2120-	
Cn-1021/5	Cross Holder Long	Tata 2518	(8H - Ø6" - Cr. 42x120 - Ht-116)		1330-	Each	1730-	
Cn-1022	Half Yoke		(Ø3½" - Cr 42x120 - Ht-120)		1370-	Each	1780-	
Cn-1022/1	Half Yoke		(Ø4" - Cr 42x120 - Ht-128)		1490-	Each	1935-	
Cn-1022/2	Half Yoke Long		(Ø3½" - Cr 42x120 - Ht.128)		1550-	Each	2015-	
Cn-1023	Front Teeth Tata 1613 TC / 2518		(Ø3½" - 26T - Ht-8" - Brg.Ø55) One Step		1690-	Each	2195-	
Cn-1023/1	Front Teeth Tata 2518		(Ø4" 26T - Ht-8" - Brg.Ø55) One Step		1710-	Each	2225-	
Cn-1024	Reverse Yoke & Bottle		(20T - Ø3½" - Cr 42x120 - Yoke -12" - Bottle-7")		4190-	Set	5445-	
Cn-1024/1	Reverse Yoke & Bottle		(20T - Ø4" - Cr 42x120 - Yoke -12" Bottle-7")		4290-	Set	5575-	
Cn-1024/2	Reverse Yoke & Bottle		(20T - Ø4" - Cr. 42x120 - Yoke 16" - Bottle 10")		4990-	Set	6485-	
Cn-1025	Only Bottle	(Glassy-Sleeve)	(20T - Ø3½" - Ht-7")	(Same Cn-1035)	1710-	Each	2225-	
TN-1025	Bottle / Sleeve	TEFLONE	(20T - Ø3½" - Ht-7")		2210-	Set	2875-	
Cn-1025/1	Only Bottle	(Glassy-Sleeve)	(20T - Ø4" - Ht-7")	(Same Cn-1035/1)	1810-	Each	2355-	
TN-1025/1	Bottle / Sleeve	TEFLONE	(20T - Ø4" - Ht-7")	(Same Tn-1035/1)	2410-	Set	3135-	
Cn-1026	Coupling Centre	SERRATED Ultra	(4H - Ø5"-26T - Ht.80 - Seal-69)		1330-	Each	1730-	
Cn-1026/1	Coupling Pinion	SERRATED Ultra	(4H - Ø5" - 39T - Ht)		1370-	Each	1780-	
Cn-1026/2	Coupling Input	SERRATED Ultra	(4H - Ø5" - 41T - Ht)		1390-	Each	1805-	
L/L-TATA 2515 / 2518 Ex / 1618 - RSB SHAFTS		Cross - (Cn-033) - 42x129.4mm (403 Series)						
Cn-1030	Shaft Assly. Complete	SERRATED	(4H - Ø6" - Length-26" - Cr.42X129)		15900-	Unit	20670-	
Cn-1030/1	Shaft Assly. Complete	SERRATED	(4H - Ø6" - Length-23" - Cr.42X129)		15700-	Unit	20410-	
(Cr. Holder + Cross + HY.Ø4" + Pipe + Rev Yoke & Bottle + Cr + Cross Holder)					REVERSE			
(Cn-1031/1 + Cn-033 + Cn-1032/2 + Ø4" + Cn-1034/1 + Cn-033 + Cn-1031/1)					KAMANI VEHICLE			
Cn-1030/2	Shaft Assly. Complete	PLAIN PLATE	(8H - Ø5" - Length-27" - Cr. 1312)		11500-	Unit	14950-	
Cn-1030/3	Shaft Assly. Complete	PLAIN PLATE	(8H - Ø5" - Length-29" - Cr. 1312)		11700-	Unit	15210-	
(Cr. Holder 1312 Long + Cross + HY.Ø3 ½" + Pipe + Y&T 1312 Long + Cr + Cr Holder 1312 Long)								
(Cn-990 + Cn-010 + Cn-842 + 3 ½" + Cn-997/2+ Cn-996/2 + Cn-010 + Cn-990) (OE No. 217141120101)								
Cn-1031	Cross Holder		(8H - Ø6½" - Cr. 42x129 - Ht-135)		1430-	Each	1860-	
Cn-1031/1	Cross Holder Big	SERRATED	(4H - Ø6" - Cr. 42x129 - Ht-127) (Same Cn-1071/1)		1650-	Each	2145-	
Cn-1031/2	Cross Holder Short	SERRATED	(4H - Ø6" - Cr. 42x129 - Ht-105)		1570-	Each	2040-	
Cn-1031/3	Cross Holder Big	AL No.PID 00012	(8H - Ø7" - Cr. 42x129 - Ht-135)		1650-	Each	2145-	
Cn-1031/4	Cross Holder	Tata L/L-4018	(8H - Ø6" - Cr-42x129 - Ht.130)		1330-	Each	1730-	
Cn-1031/5	Cross Holder	SERRATED	(4H - Ø7" - Cr. 42x129 - Ht-128)		2010-	Each	2615-	
Cn-1031/7	Cross Holder		(8H - Ø5" - Cr. 42x129 - Ht.113)		1250-	Each	1625-	
Cn-1032	Half Yoke		(Ø3½" - Cr. 42x129 - Ht-120)		1490-	Each	1935-	
Cn-1032/1	Half Yoke		(Ø4" - Cr. 42x129 - Ht-127) (Same Cn-1072/1)		1550-	Each	2015-	
Cn-1032/2	Half Yoke Long		(Ø4" - Cr. 42x129 - Ht-140) (Same Cn-1132)		1770-	Each	2300-	
Cn-1034	Reverse Yoke & Bottle		(20T - Ø3½" - Cr. 42x129 - Yoke-13" - Bottle-7")		4290-	Set	5575-	
Cn-1034/1	Reverse Yoke & Bottle	(Same Cn-1073)	(20T - Ø4" - Cr. 42x129 - Yoke-13" - Bottle-7")		4370-	Set	5680-	
Cn-1034/2	Reverse Yoke & Bottle	(Long)	(20T - Ø4" - Cr. 42x129 - Yoke-14" - Bottle-9")		4890-	Set	6355-	
Cn-1034/3	Reverse Yoke & Bottle	(Extra Long)	(20T - Ø4" - Cr. 42x129-Yoke-16", Bottle-10")		5090-	Set	6615-	





CENRON AUTO IMPEX
Price List w.e.f. 10-11-2021

FOR ROUGH WORK

CENRON

E-mail : mantrycron@gmail.com

PART No.	DESCRIPTION			LIST	-	MRP
Cn-1035	Only Bottle	(Glassy-Sleeve)	(20T - Ø3½" Ht- 7")	(Same Cn-1025)	1710-	Each 2225-
Cn-1035/1	Only Bottle	(Glassy-Sleeve)	(20T - Ø4" - Ht-7")	(Same Cn-1025/1)	1810-	Each 2355-
TN-1035/1	Bottle / Sleeve	TEFLONE	(20T - Ø4" - Ht- 7")	(Same TN-1025/1)	2410-	Each 3135-
Cn-1035/2	Only Bottle	(Long)	(20T - Ø4" - Ht-9")	(Same Cn-1134)	2070-	Each 2690-
TN-1035/2	Bottle / Sleeve	TEFLONE	(20T - Ø4" - Ht- 9")		2870-	Each 3730-
Cn-1035/3	Only Bottle	(Extra Long)	(20T - Ø4" -Ht-11")		2150-	Each 2795-
TN-1035/3	Bottle / Sleeve	TEFLONE	(20T - Ø4" - Ht-11")		2950-	Each 3835-
Cn-1036	Coup. Pinion		(8H - Ø6½" - 26T - Ht-76 - Seal-68)	(Same Cn- 1057)	1310-	Each 1705-
Cn-1036/1	Coup. Pinion		(8H - Ø6½" - 39T - Ht-90 - Seal-76.3)	(Same Cn- 1057/1)	1390-	Each 1805-
Cn-1037	Coup. Gear	SERRATED Diamond Cut	(4H - Ø6" - 18T - Ht-63 - Seal-63.5)	(Same Cn- 1066)	1350-	Each 1755-
Cn-1037/1	Coup. GB-75	SERRATED Diamond Cut	(4H - Ø6" - 26T - Ht-64 - Seal-68)	(Same Cn- 1066/1)	1370-	Each 1780-
Cn-1037/2	Coup. GB-75	SERRATED Coller Type	(4H - Ø6" - 26T - Ht.110 - Seal-68)	(Same Cn-1066/2)	1710-	Each 2225-
Cn-1037/3	Coup. Center	SERRATED Diamond Cut	(4H - Ø6" - 26T - Ht.95 - Seal-71)	(Same Cn-1096/3)	1570-	Each 2040-
Cn-1037/4	Coup. Center	SERRATED	(4H - Ø6" - 26T - Ht.108 - Seal-70- Coller Depth 15)		1750-	Each 2275-
Cn-1038	Coup. Pinion	SERRATED	(4H - Ø6" - 39T - Ht-92 - Seal 76)	(Same Cn-1075)	1770-	Each 2300-
Cn-1038/1	Coup. Through	SERRATED	(4H - Ø6" - 39T - Ht-85 - Seal 70)		1650-	Each 2145-
Cn-1038/2	Coup. Gear	SERRATED L/L BS-4	(4H - Ø6" - 39T - Ht-75 - Seal 71)		1630-	Each 2120-
Cn-1039	Coup. Center	SERRATED Two Step	(4H - Ø6" - 34T - Ht-62 - Seal-56)	(Same Cn-1067)	1350-	Each 1755-
Cn-1039/1	Coup. Through	SERRATED One Step	(4H - Ø6" - 34T - Ht-85 - Seal-64)	(Same Cn-1067/1)	1510-	Each 1965-
Cn-1039/1A	Coup. Through	SERRATED Heavy Duty	(4H - Ø6" - 34T - Ht.80 - Seal 64)		1570-	Each 2040-
Cn-1039/2	Coup. Center	SERRATED Two Step	(4H - Ø6" - 34T - Ht-80 - Seal-67)		1550-	Each 2015-
TATA 1616, 3015 Ex- TILTER			Cross- (Cn-022) - 41.28x126mm			
Cn-1041	Cross Holder		(8H - Ø6" - Cr - Tata 1312 - Ht-121)		1290-	Each 1675-
Cn-1041/1	Cross Holder		(8H - Ø6" - Cr - L/L TC - Ht-116)		1230-	Each 1600-
Cn-1041/2	Cross Holder Tata		(8H - Ø6" - Cr - 42 x 129 - Ht-116)		1270-	Each 1650-
Cn-1041/4	Cross Holder	SERRATED	(4H - Ø6" - Cr -Tata 1312)		1830-	Each 2380-
Cn-1042	Half Yoke		(Ø3½" - Cr - L/L TC - Ht-135)	(Same Cn 984/3)	1410-	Each 1835-
Cn-1042/1	Half Yoke		(Ø4" - Cr - Tata 1312)		1510-	Each 1965-
Cn-1043	Front Teeth		(Ø3½" - 34T - Brg. Ø45 - Ht-5½")		1190-	Each 1545-
Cn-1043/1	Front Teeth	No. 100 950 / 100 902	(Ø4" - 34T - Brg. Ø55 - Ht-6½")	(Same Cn 1086)	1370-	Each 1780-
Cn-1043/2	Front Teeth		(Ø3½" - 34T - Brg. Ø55 - Ht-6½")		1330-	Each 1730-
Cn-1043/3	Front Teeth Tata 1616		(Ø4" - 34T - Brg. Ø45 - Ht-6½")	(Same Cn 1753)	1130-	Each 1470-
Cn-1043/4	Front Teeth Tata 1616		(Ø4" - 18T - Ht - Brg.Ø)		1570-	Each 2040-
Cn-1044	Full Yoke		(24T - Cr - Tata 1312 - Ht-10½")	(Same Cn-844/1)	1950-	Each 2535-
Cn-1045	Rear Teeth		(Ø3½" - 24 Teeth Ht-11½")	(Same Cn-845/1)	1570-	Each 2040-
Cn-1046	Coupling Center		(8H - Ø6" - 34T - Ht.74 - Seal-64)		1230-	Each 1600-
Cn-1046/1	Coupling Center		(8H - Ø6" - 34T - Ht.82 - Seal-66)		1270-	Each 1650-
Cn-1046/2	Coupling Tata 1616		(8H - Ø6" - 34T - Ht.75 - Seal-54)		1210-	Each 1575-
Cn-1046/4	Coup. Centre Tata 1616	SERRATED	(4H - Ø6" - 18T - Ht. - Seal)		1590-	Each 2065-
Cn-1047	Coupling Gear		(8H - Ø6" - 18T - Ht-66 - Seal-65)		1190-	Each 1545-
Cn-1047/1	Coup.Pinion Tata 1613	SERRATED	(4H - Ø6" - 26T- Ht.90 - Seal 85)		1790-	Each 2325-
Cn-1047/2	Coup.Pinion Tata 1613	SERRATED	(4H - Ø7" - 26T- Ht.90 - Seal 85)		2150-	Each 2795-
Cn-1048	Coupling Pinion		(8H - Ø6" - 26T- Ht-65 - Seal-68)		1210-	Each 1575-
Cn-1049	Reverse Yoke & Bottle	Tata 1616	(20T - Ø4" - Cr.Tata 1312 - Yoke-13", Bottle-7")		4450-	Set 5785-

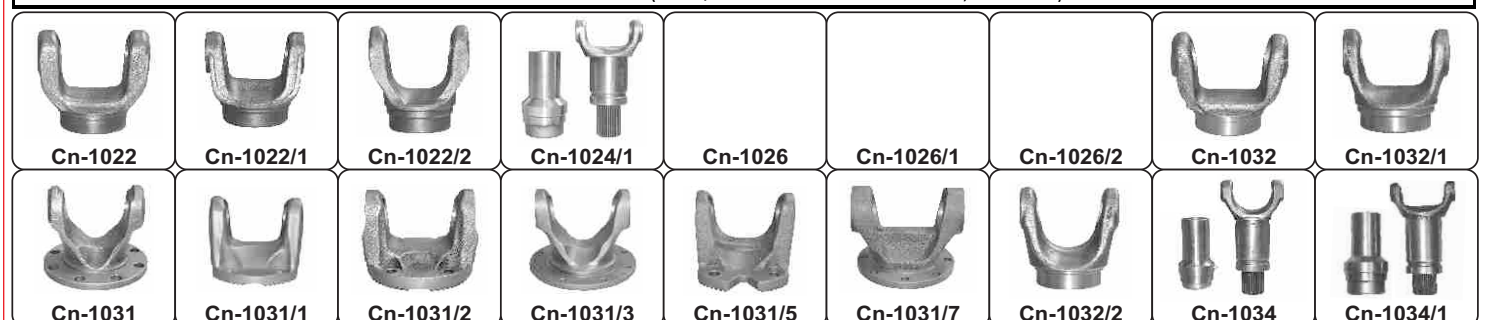

Our motto : Quality , Variety n Quantity at The Most Reasonable Prices

PART No.	DESCRIPTION			LIST	-	MRP
L / L - TATA HYVA 4018, 4022 (PATTI TYPE) Construction Design (Welded Plate Type Balls)			Cross - (Cn-030) - 49.20x154.90mm (1710 Series)			
Cn-1051	Cross Holder		(8H - Ø 6½" - Cr 49.2x155 - Ht-135) (Same Cn-1091)	1650-	Each	2145-
Cn-1051/1	Cross Holder	Big	(8H - Ø 6½" - Cr L/L TC - Ht-125)	1550-	Each	2015-
Cn-1051/2	Cross Holder	SERRATED	(4H.- Ø6" - Cr. 4018 PT - Ht-120) (Same Cn-1091/2)	1770-	Each	2300-
Cn-1051/3	Cr. Hol. 6-2-25	SERRATED	(4H.- Ø7" - Cr. 4018 PT - Ht-120) (Same Cn-1091/3)	1990-	Each	2585-
Cn-1051/4	Cr. Hol. 6-2-15	SERRATED Long	(4H.- Ø6" - Cr. 4018 PT - Ht-130) (Same Cn-1091/1)	1830-	Each	2380-
Cn-1051/6	Cross Holder	Small	(8H - Ø 6½" - Cr. L/L TC - Ht-115)	1470-	Each	1910-
Cn-1051/7	Cross Holder	Tata 4018 PT.	(8H-Ø5" - Cr-49.2x155 PT - Ht.145)	1590-	Each	2065-
Cn-1052	Half Yoke	Spicer 6-28-347	(Ø4" - Cross 49.2x155 - Ht-130) (Same Cn-1092)	1810-	Each	2355-
Cn-1054	Full Yoke	Spicer 6-3-129-2	(16T - Cr. 49.2x155 - Ht-11") (Same Cn-1103)	3330-	Each	4330-
TN-1055	Rear Teeth	TEFLONE	(Ø4" -16T- - Ht-10½")	2990-	Each	3885-
Cn-1055/1	Rear Teeth	INSKU-1216391	(Ø4" - 16T - Ht-10½") (Same Cn-1114)	2270-	Each	2950-
Cn-1056	Coupling Gear		(8H - Ø6½" - 18T - Ht-76 - Seal-65)	1430-	Each	1860-
Cn-1057	Coupling Pinion		(8H - Ø6½" - 26T - Ht-76 - Seal-68) (Same Cn-1036)	1310-	Each	1705-
Cn-1057/1	Coupling Pinion		(8H - Ø6½" - 39T - Ht-90 - Seal-76) (Same Cn-1036/1)	1390-	Each	1805-
Cn-1057/2	Coupling Pinion		(8H - Ø6½" - 39T - Ht-110 - Seal-76)	1590-	Each	2065-
Cn-1058	Coupling Pinion		(8H - Ø6½" - 41T - Ht-93- Seal-76)	1610-	Each	2095-
Cn-1058/1	Coupling Pinion		(8H - Ø6½" - 41T - Ht-110 - Seal-76)	1730-	Each	2250-
Cn-1059	Coupling Gear	SERRATED	(4H - Ø7" - 21T - Ht-63 - Seal-90) (Same Cn-1117/2)	2430-	Each	3160-
Cn-1059/1	Coupling Pinion	SERRATED	(4H - Ø7" - 39T - Ht-112 - Seal-71)	2390-	Each	3105-
Cn-1059/1A	Coupling Pinion Tata 2518	SERRATED	(4H-Ø7" - 39T - Ht.90 - Seal 71)	2090-	Each	2715-
Cn-1059/2	Coupling Input	SERRATED	(4H- Ø7" - 41T - Ht-110 - Seal-76)	2410-	Each	3135-
Cn-1059/3	Coup. Through Shaft	SERRATED	(4H - Ø7" - 44T - Ht-109 - Seal-76)	2450-	Each	3185-
Cn-1059/4	Coup. Through Shaft	SERRATED	(4H- Ø7" - 46T - Ht.-90 - Seal-85)	2450-	Each	3185-
Cn-1059/5	Coup.Input Shaft	SERRATED	(4H- Ø7" - 31T - Ht.-82 - Seal-85)	2570-	Each	3340-
Cn-1059/6	Coup.Input Shaft	SERRATED	(4H - Ø7" - 46T - Ht. 70 - Seal-83)	2470-	Each	3210-
Cn-1059/7	Coup.Input Shaft	SERRATED	(4H - Ø6" - 46T - Ht. 90 - Seal-85)	1970-	Each	2560-
Cn-1059/8	Coupling	SERRATED	(4H - Ø7" - 41T - Ht. 90 - Seal-76)	2430-	Each	3160-
L/L 4921 TATA 4018 (Lock Type) - RSB SHAFTS / MAAN			Cross - (Cn-034) - 48x135mm. (490 Series)			
Cn-1060	Assly.Interaxle	SERRATED	(4H - Ø7" - Length- 23" - Cr.-48 x 135)	16700-	Unit	21710-
(Cr. Hol. + Cr + HY + Pipe + Rev Yoke & Bottle + Cr.+ Cr.Hol.)						
(Cn-1061/4 + Cn-034 + Cn-1062/1 + Pipe Ø4" + Cn-1064 + Cn-034 + Cn-1061/4) OE NO. 5011 4112 0107						
Cn-1060A	Ass.Interaxle	SERRATED AMW	(4H - Ø7" - Cr. 48X135 - Length-27")	16900-	Unit	21970-
Cn-1060/1	Assly.Interaxle	SERRATED	(4H - Ø6" - Cr.L/L TC - (Length-25")	14700-	Unit	19110-
Cn-1060/2	Assly.Interaxle	SERRATED	(Same Cn-1060/1 Except Length-27")	14900-	Unit	19370-
Cn-1060/3	Assly.Interaxle	SERRATED	(Same Cn-1060/1 Except Length-31")	15100-	Unit	19630-
Cn-1061	Cross Holder		(8H - Ø6½" - Cr 48x135 - Ht.126)	1810-	Each	2355-
Cn-1061/1	Cross Holder	SERRATED	(4H - Ø6" - Cr 48x135 - Ht.116)	1790-	Each	2325-
Cn-1061/2	Cross Holder	SERRATED	(4H - Ø7" - Cr 48x135 - Ht.112)	1890-	Each	2455-
Cn-1061/3	Cross Holder	SERRATED Long	(4H - Ø6" - Cr 48x135 - Ht.134)	1830-	Each	2380-

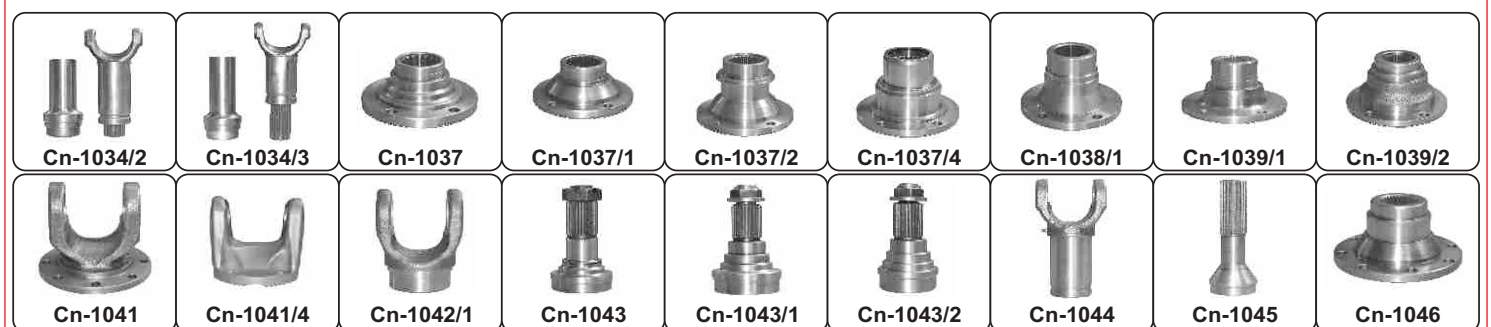

PART No.	DESCRIPTION			LIST	-	MRP
Cn-1061/4	Cross Holder	SERRATED Long	(4H - Ø7" - Cr. 48x135 - Ht.130)	1970-	Each	2560-
Cn-1061/5	Cross Holder		(8H - Ø6" - Cr 48x135 - Ht-126)	1650-	Each	2145-
Cn-1061/8	Cross Holder	SERRATED Long	(4H - Ø7" - Cr 47.7x135 - Ht-130)	(Same Cn-1303/1)	1990-	Each 2585-
Cn-1061/9	Cross Holder	SERRATED Long	(4H - Ø6" - Cr 47.7x135 - Ht-135)	(Same Cn-1302/1)	1890-	Each 2455-
Cn-1062	Half Yoke	(for Main Assly.)	(Ø4" - Cr. 48x135, Ht-135)	1870-	Each	2430-
Cn-1062/1	Half Yoke Deep	for Inter Axle Assly	(Ø4" - Cr. 48x135, Ht-135)	1750-	Each	2275-
Cn-1062/6	Half Yoke		(Ø4¾" - Cr. 48x135 - Turn Ø112)	2390-	Each	3105-
Cn-1062/9	Half Yoke	Tata / Bharat Benz	(Ø4" - Cr 47.7x135 - Ht-155 - Turn Ø91.4 / 95.0)	(Same Cn-1303/1)	1910-	Each 2485-
Cn-1063	Rev Yoke & Bottle	Tata / Bharat Benz	(34T - Ø4" - Cr.47.7x135 Y-16 "B-10"- Turn Ø91.4/95)	(Cn-1308)	6450-	Set 8385-
Cn-1063/1	Rev Yoke & Bottle	Tata / Bharat Benz	(34T - Pipe Ø4"-Cr. 47.7x135-Y 14"-B-8"- Turn Ø91.4/95)	(Cn-1308/1)	5950-	Set 7735-
Cn-1063/1BY	Bottle Yoke Interaxle	Tata Prima	(HY-47.7x135 + Bottle - 30T - Ø4" L-13")	4890-	Each	6355-
Cn-1064	Rev Yoke & Bottle		(30T - Pipe Ø4" - Cr.48x135 Yoke - 13½" - Bottle-8")	5450-	Set	7085-
Cn-1064/1	Rev Yoke & Bottle	Long	(30T - Pipe Ø4" - Cr.48x135 Yoke-14½" - Bottle-9")	5950-	Set	7735-
Cn-1064/2	Rev Yoke & Bottle	Extra Long	(30T - Pipe Ø4" - Cr.48x135 Yoke-16" - Bottle-10")	6350-	Set	8255-
Cn-1064/4	Rev Yoke & Bottle	Long Modified	(16T - Pipe Ø4" - Cr.48x135 Yoke-15" - Bottle-9")	6550-	Set	8515-
Cn-1064/5	Rev Yoke & Bottle	Extra Long Modified	(16T - Pipe Ø4" - Cr.48x135 Yoke-16" - Bottle-10")	6850-	Set	8905-
Cn-1064/6	Rev Yoke & Bottle		(30T - Pipe Ø4¾" - Cr. 48x135 Yoke-16 "Bottle-9" - Turn Ø112)	7350-	Set	9555-
Cn-1065	Only Bottle	(Glassy - Sleeve)	(30T - Ø4" - Ht.8")	2250-	Each	2925-
TN-1065	Only Bottle	TEFLONE	(30T - Ø4" - H 8")	2850-	Set	3705-
Cn-1065/1	Only Bottle	(Glassy - Sleeve)	(30T - Ø4" - Ht.9")	2350-	Each	3055-
TN-1065/1	Bottle / Sleeve	TEFLONE	(30T - Ø4" - Ht 9")	3050-	Set	3965-
Cn-1065/2	Only Bottle / Sleeve		(30T - Ø4" - Ht 10")	2450-	Each	3185-
Cn-1065/4	Only Bottle / Sleeve		(16T - Ø4" - Ht 10")	2350-	Each	3055-
Cn-1065/5	Only Bottle / Sleeve		(16T - Ø4" - Ht 9")	2450-	Each	3185-
Cn-1066	Coupling	SERRATED Diamond Cut	(4H - Ø6" -18T - Ht-63 - Seal-63.5)	(Same CR-1037)	1350-	Each 1755-
Cn-1066/1	Coupling	SERRATED Diamond Cut	(4H - Ø6" - 26T - Ht-64 - Seal-68)	(Same CR-1037/1)	1450-	Each 1885-
Cn-1066/2	Coupling Gear GB-75	SERRATED Diamond Cut	(4H - Ø6" - 26T - Ht.108 - Seal-70)	(Same Cn-999/2)	1710-	Each 2225-
Cn-1066/3	Coupling Center	SERRATED Diamond Cut	(4H - Ø6" - 24T)	(Coller Type)	1990-	Each 2585-
Cn-1066/4	Coup. Prima 4923	SERRATED GB-75	(4H - Ø7" - 26T - Ht.104 - Seal-68)	(Coller Type)	2590-	Each 3365-
Cn-1067	Coupling Center	SERRATED	(4H - Ø6" - 34T - Ht.62 - Seal-56)	(Same Cn-1078)	1350-	Each 1755-
Cn-1067/1	Coupling	SERRATED	(4H - Ø6" - 34T - Ht.85 - Seal-64)	(Same Cn-985/2)	1510-	Each 1965-
Leyland 2515 / 2518 Mining Tipper (1710 Series)			Cross - Cn-022 / Cn-033			
Cn-1071	Cross Holder	SERRATED	(4H - Ø6" - Cr. L/L TC - Ht-110)	(Same Cn-971/1)	1570-	Each 2040-
Cn-1071/1	Cross Holder	SERRATED	(4H - Ø6" - Cr.42x129 - Ht-127)	(Same Cn-1131)	1650-	Each 2145-
Cn-1072	Half Yoke	Spicer No. 90-28-17	(Ø4" - Cr. L/L TC - Ht-128)	(Same Cn-972)	1350-	Each 1755-
Cn-1072/1	Half Yoke		(Ø4" - Cr 42x129- Ht-127)	(Same Cn-1032/1)	1550-	Each 2015-
Cn-1073	Rev Yoke & Bottle		(20T - Ø4"-Cr. 42x129 - Y-13" B-7)	(Same Cn-1133)	4370-	Set 5680-
Cn-1074	Coupling	SERRATED	(4H - Ø6" - 28T - Ht.100- Seal-60)	(Same Cn-978/2)	1690-	Each 2195-
Cn-1075	Coup. Pinion	SERRATED	(4H - Ø6" - 39T - Ht.92- Seal-76)	(Same Cn-978/3)	1770-	Each 2300-
Cn-1076	Coup. Through Shaft	SERRATED	(4H - Ø6" - 41T - Ht-92 - Seal-76)		1750-	Each 2275-
Cn-1077	Coup. Through Shaft	SERRATED	(4H - Ø6" - 44T - Ht.90 - Seal-75)	(Same Cn-1357)	1710-	Each 2225-
Cn-1078	Coup. Center	SERRATED 90-1-65	(4H - Ø6" - 34T - Ht-62- Seal 56)	(Same Cn-1096)	1350-	Each 1755-
Cn-1079	Coup. Gear 3718	SERRATED U-Truck	(4H - Ø7" - 31+3T - Ht-120 - Seal 80)	(9 Speed GB)	4250-	Each 5525-





Easy Search Table for : Rear Teeth															
No. of Teeth	Pipe Ø 2¾"			Pipe Ø 3"			Pipe Ø 3½"			Pipe Ø 4"			Pipe Ø 4¾"		
	Turn Ø 64"			Turn Ø 69/71"			Turn Ø 84"			Turn Ø 91/95"			Turn Ø 112"		
	Cn-No.	L	Brg	Cn-No.	L	Brg	Cn-No.	L	Brg	Cn-No.	L	Brg	Cn-No.	L	Brg
10 Teeth	805	8½"		823	8½"										
16 Teeth				758A/2	9½"	40	845	11½"		975/1	10¾"		1095/1	13½"	
				758/2	6¾"		891	7¾"		975/3	9"				
				890	7¾"		917	9"		1055/1	10½"				
							982	10½"		1082/2	11½"				
							982/2	12½"		1083/2	11½"				
							982/4	11½"							
							997/1	10¾"							
							997/2	13½"							
							997/3	8¾"							
							1205	9"							
							1205/1	10"							
							1215	11"							
24 Teeth							1045	11½"							
28 Teeth							982/1	11½"							
30 Teeth							982/3	12½"		975	10¾"				
							997	10¾"		975/2	9"				
							997/4	9"							
Front Teeth with Nut															
10 Teeth				759	5½"	40	862	5½"	45	1093/3	7½"	50			
				888	8"	46	889	8½"	46						
14 Teeth	803	7½"	40	822	7½"	40									
16 Teeth				1753/2	7"	62	916	7"	62	1093/1	7¾"	60			
18 Teeth										1043/4					
20 Teeth										1093/4	6¾"	60	1093/5	6"	55
26 Teeth				843/2	8"	55	843	8"	55	998	8"	55	1093/8	6"	55
								8"	55	998/1	7"	65	1093/9	6"	70
										998/2	7"	65	1093/16	7"	55
										1023/1	8"	55	1093/17	7½"	55
										1093/7	6"	55			
										1093/15	7"	55			
28 Teeth							1093/18	6"	45	1093/13	6"	45			
30 Teeth												1093/10	9"	85	
34 Teeth				953	5"	47	1043	5¾"	45	973	6½"	45			
							1043/2	6½"	55	1043/1	6½"	55			
39 Teeth									1753/3	6½"	55				
46 Teeth									1093/11	8"	60	1093/12	8"	50	
Suitable Bearing for Seat Dia															
				Brg. Seat Dia	Bearing No.	Brg. Seat Dia	Bearing No.								
				35 mm	6207	50 mm	6210								
				40 mm	6208-88508	55 mm	6211								
				45 mm	6209-88509	60 mm	600112								
				46 mm	MSN-14	62 mm	6011								
				47 mm		65 mm	6013								

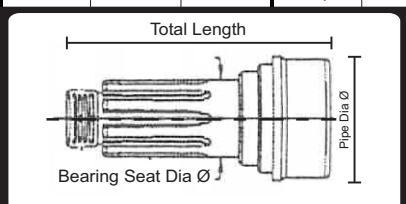
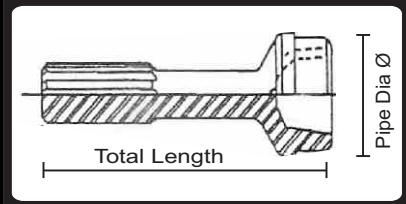

Always eager to serve in a better way



PART No.		DESCRIPTION		LIST	-	MRP
Leyland 2515 / 2518-6x4, Tata LPS 4018 (1710 Series)			Cross (Cn-004) Tusker			
Cn-1080	Rev Yoke & Bottle AMW,L/L 3116	(20T - Ø4"-Cr. L/L TC-Yoke 15"-Bottle 9")	(Same Cn-1124/1)	5190-	Set	6745-
Cn-1081	Bottle & Teeth Set Interaxle	(INSKU-100650+INSKU-100727)		5490-	Set	7135-
		(Both Side Pipe Ø4" - T16 - Long 12")				
TN-1082	Yoke & Teeth Interaxle	TEFLONE	(Spicer No. 4-3-0110)	6670-	Set	8670-
			(16T - Pipe Ø4" - Cr.Tusker - Yoke14" - Teeth12")			
Cn-1082/1	Interaxle Yoke Only		(16T - Cr Tusker - Yoke-14")	3310-	Each	4305-
Cn-1082/2	Interaxle Rear Teeth		(Ø4" - 16T -Dia Ø2½" - Ht-12")	2810-	Each	3655-
TN-1082/2	Rear Teeth	TEFLONE	(Ø4" - 16T -Dia Ø2½" - Ht-12")	3410-	Each	4435-
TN-1083	Yoke & Teeth Interaxle	TEFLONE	(Spicer No. 5013734-3 + 100650)	6630-	Set	8620-
	Eicher, AMW, L/L-3116		(16T - Pipe Ø4" - Cr.L/L TC- Yoke14" - Teeth12")			
Cn-1083/1	Interaxle Yoke		(16T - Cr L/L TC - Long 14")	3290-	Each	4275-
Cn-1083/2	Interaxle Rear Teeth	INSKU-100650	(Ø4" - 16T -Dia Ø2½" - Ht-12")	2810-	Each	3655-
TN-1083/2	Rear Teeth	TEFLONE	(Ø4" - 16T -Dia Ø2½" - Ht-12")	3410-	Each	4435-
TN-1084	Yoke & Teeth Intraxle MSL	TEFLONE	(16T - Cr-L/L TC- Yoke-14" - Teeth 13" Ø2½" - Pipe Ø4")	7090-	Set	9215-
Cn-1085	Assembly Interaxle	(Using Cn-1082)	(Spicer No. 22743C10S)	Comp. Length-29"	14700-	Unit 19110-
			(Cr. Hol. + Cr.Tusker + Yoke & Teeth Set + Pipe + HYØ4" + Cr. Tusker + r. Hol.)			
			(Cn-983 + Cn-004 + TN-1082 + Pipe Ø4" + Cn-984/2 + Cn-004 + Cn-983)			
Cn-1085A	Assembly Interaxle		Same Cn-1085	Except	Comp. Length-25"	14300- Unit 18590-
Cn-1085B	Assembly Interaxle		Same Cn-1085	Except	Comp. Length-27"	14500- Unit 18850-
Cn-1085C	Assembly Interaxle		Same Cn-1085	Except	Comp. Length-31"	14900- Unit 19370-
Cn-1086	Front Teeth	Spicer-100950	(Ø4"-34T - Brg. Ø55 - Ht-6½")	Same Cn-1043/1	1370-	Each 1780-
Cn-1087	Coup. L/L 3116, 3121	Spicer -6-53-311	(4H-Ø6" - 34T - Ht-60 - Seal-56)	(Plain Base)	1250-	Each 1625-
Cn-1088	Cross Holder	SERRATED	(4H - Ø6" - Cr. Tusker - Ht-100)		1450-	Each 1885-
Cn-1088/1	Cross Holder		(8H - Ø6" - Cr. Tusker - Ht-106)		1310-	Each 1705-
Tata - L/L-3116 / 3118 / 4921 / 4923 / AMW 3723			Cross (Cn-030) - 49.2 x 155mm			
Cn-1091	Cross Holder 6-2-1259		(8H-Ø6½"-Cr.49x155 - Ht -135)	(Same Cn-1051)	1650-	Each 2145-
Cn-1091/1	Cr. Hol. Long 6-2-15	SERRATED	(4H.-Ø6" - Cr.4018 PT- Ht -130)	(Same Cn-1051/4)	1830-	Each 2380-
Cn-1091/2	Cross Holder	SERRATED	(4H.-Ø6" - Cr.4018 PT- Ht -120)	(Same Cn-1101)	1770-	Each 2300-
Cn-1091/3	Cross Holder	SERRATED	(4H.-Ø7" - Cr.4018 PT- Ht -120)	(Same Cn-1051/3)	1990-	Each 2585-
Cn-1092	Half Yoke 6-28-347		(Ø4"-Cr 49.2x155- Ht -130)	(Same Cn-1102)	1810-	Each 2355-
Cn-1093/1	Front Teeth Tata 4923 / 4018		(Ø4"-16T.-Ht.8"-Brg Ø60)	Spicer-6-53-311	1870-	Each 2430-
Cn-1096/1	Coupling Center	SERRATED	(4H.-Ø6" - 16T - Ht 84 - Seal-73)		1670-	Each 2170-
Cn-1096/2	Coupling Center		(8H -Ø7" - 16T - Ht 100 - Seal-73)		1970-	Each 2560-
Cn-1096/22	Coupling Center	SERRATED	(4H -Ø7" - 16T - Ht 95 - Seal-73)		2290-	Each 2975-
Cn-1093/2	Front Teeth		(Ø4" - 26T - Brg. Ø65 - Ht-7)	(Same Cn-998/1)	1550-	Each 2015-
Cn-1093/7	Front Teeth Tata 3718		(Ø4" - 26T - Ht.6" - Brg Ø55)	Bolt Type	1710-	Each 2225-
Cn-1093/15	Front Teeth Tata RSB		(Ø4" - 26T - Ht.7" - Brg.Ø55)	One Step	1670-	Each 2170-
Cn-1096/3	Coup. Center Diamond Cut	SERRATED	(4H - Ø6" - 26T - Ht-95 - Seal Ø71)	(Same Cn-1037/3)	1570-	Each 2040-
Cn-1093/3	Front Teeth Tata Hywa		(4H - Ø4" - 10T - Ht. 7½" - Brg Ø50)	Nut 32x1.5	1910-	Each 2485-
Cn-1093/11	Front Teeth	MSL 2040	(Ø4" - 46T - Ht.7½" - Brg Ø60)	(6 & 8 Speed G.Box)	1930-	Each 2510-
Cn-1093/12	Front Teeth	MSL 2040	(Ø4¾" - 46T - Ht.8" - Brg Ø)	(9 Speed G.Box)	2130-	Each 2770-
Cn-1096/16	Coupling L/L 3718	SERRATED	(4H - Ø6" - 46T - Ht.81 - Seal-83)	(Diamond Cut)	1790-	Each 2325-
Cn-1093/4	Front Teeth 2523, 3118		(Ø4"- 20T - Ht.6½" - Brg. Ø60)	Bolt Type	1830-	Each 2380-
Cn-1093/5	Front Teeth 2523, 3118		(Ø4¾" - 20T - Ht.6" - Brg Ø55)	Bolt Type	2070-	Each 2690-
Cn-1096/8	Coupling Centre	SERRATED	(4H - Ø7" - 20T - Ht.79 - Seal 64)	(Same Cn-1317)	2210-	Each 2875-
Cn-1096/9	Coupling Centre	SERRATED	(4H - Ø6" - 20T - Ht.71- Seal 64)	(Diamond cut)	1770-	Each 2300-
Cn-1096/13	Coupling Centre	SERRATED	(4H - Ø6" - 20T - Ht.71- Seal Plain)	(Diamond cut)	1870-	Each 2430-



PART No.	DESCRIPTION			LIST	-	MRP
Cn-1093/8	Front Teeth Tata 3718		(Ø4¾" - 26T - Ht.6" - Brg Ø55)	Bolt Type	1870-	Each 2430-
Cn-1093/16	Front Teeth Tata RSB		(Ø4¾" - 26T - Ht.7" - Brg.Ø55 - Turn Ø112)	One Step	1950-	Each 2535-
Cn-1093/17	Front Teeth Long RSB		(Ø4¾" - 26T - Ht.7½" - Brg.Ø55 - Turn Ø112)	Two Step	2030-	Each 2640-
Cn-1096/10	Coupling Center	SERRATED	(4H - Ø7" - 26T - Ht.93 - Seal -71)	(Diamond Cut)	2270-	Each 2950-
Cn-1096/21	Coupling Center RSB	SERRATED	(4H - Ø7" - 26T - Ht.93 - Seal -71)		2250-	Each 2925-
Cn-1093/9	Front Teeth Tata 3718	2060 Series	(Ø4¾" - 26T - Ht.6" - Brg Ø70- Turn Ø112)	Bolt Type	2150-	Each 2795-
Cn-1096/18	Coupl. Center L/L 3118	SERRATED	(4H - Ø7" - 26T - Ht.95 - Seal -85 - Bore-71)		2570-	Each 3340-
Cn-1096/19	Coupling Center	SERRATED	(4H - Ø7" - 26T - Ht.94 - Seal -79 - Bore-66)		2850-	Each 3705-
Cn-1093/10	Front Teeth RSB 620 Series		(Ø4¾" - 30T - Ht.9" - Brg.Ø85)		2570-	Each 3340-
Cn-1096/15	Coup.Spicer RSB 620 Series	SERRATED	(4H - Ø7" - 30T - Brg.Ø - Ht. 117)	(Side Cut)	2430-	Each 3160-
Cn-1093/13	Front Teeth RSB 403 Series		(Ø4" - 28T - Ht.6" - Brg. Ø45)		1350-	Each 1755-
Cn-1093/18	Front Teeth RSB 403 Series		(Ø3½" - 28T - Ht.6" - Brg. Ø45)		1230-	Each 1600-
Cn-1096/17	Coupling RSB 403 Series	SERRATED	(4H - Ø6" - 28T - Ht.78 - Seal-56)	(Diamond Cut)	1470-	Each 1910-
Cn-1096/20	Coup. Center RSB 403 Series		(8H - Ø5" - 28T - Ht.78 - Seal -59)		1170-	Each 1520-
Cn-1094	Full Yoke 4018 Long	6-3-2651/71	(16T - Cr.49.2x155 - Ht-13½")	(Same Cn-1113)	3970-	Each 5160-
Cn-1095	Rear Teeth 4018 Long	6-40-521	(Ø4" - 16T - Long 12")	(Same Cn-1082/2)	2810-	Each 3655-
TN-1095	Rear Teeth 4018 Long	TEFLONE	(Ø4" - 16T - Long 12")	(Same Tn-1082/2)	3410-	Each 4435-
TN-1095/1	Rear Teeth 4018 Ex.Long	TEFLONE	(Ø4" - 16T - Long 13½")		3790-	Each 4925-
Cn-1096	Coupling 90-1-65	SERRATED	(4H.- Ø6" - 34T. - Ht.62- Seal -56)	(Same Cn-976/2)	1350-	Each 1755-
Cn-1096/4	Coup. Through Shaft	SERRATED	(4H - Ø6" - 26T - Ht. 85 - Seal Ø90 - Bore 63)		1750-	Each 2275-
Cn-1096/5	Coup. Through Shaft	SERRATED	(4H - Ø7" - 26T - Ht. 85 - Seal Ø90 - Bore 63)		2030-	Each 2640-
Cn-1096/6	Coupling		(8H - Ø7" - 44T - Ht.108 - Seal -76)		2010-	Each 2615-
Cn-1096/7	Coupling Input Shaft		(8H - Ø7" - 46T - Ht.85 - Seal -84)		2170-	Each 2820-
Cn-1096/11	Coupling GB-1150	SERRATED	(4H - Ø6" - 26T - Ht.85 - Seal -85)		1830-	Each 2390-
Cn-1096/12	Coupling GB-1150	SERRATED	(4H - Ø6" - 26T - Ht.90 - Seal -80)	(Diamond Cut)	2010-	Each 2615-
Cn-1096/14	Coupling Centre	SERRATED	(4H - Ø7" - 26T - Ht.90 - Seal -80)	(Diamond Cut)	2430-	Each 3160-
Cn-1097	Coup.Through Shaft L/L 4021		(4H - Sq - 39T - Ht.87 - Seal -76)		1170-	Each 1520-
AMW 2515			Cross - (Cn-030) - 49.2x155.0 mm			
Cn-1101	Cross Holder	SERRATED	(4 H.- Ø6" - Cr. 4018 PT - Ht.120)	(Same Cn-1051/2)	1770-	Each 2300-
Cn-1102	Half Yoke	SIL- 6-28-347	(Ø4" - Cr 49.2x155 - Ht.130)	(Same Cn-1052)	1810-	Each 2355-
Cn-1103	Full Yoke	SIL- 6-3-129-2	(16T - Cr.4018 P/T - Ht.11")	(Same Cn-1054)	3330-	Each 4330-
TN-1104	Rear Teeth	TEFLONE	(Ø4" -16 T - Ht.10½")	SIL- 1216391 (Same Tn-1114/1)	2990-	Each 3885-
Cn-1107	Coupling	SERRATED	(4H - Ø6" - 38T - Ht.75 - Seal Ø71)		1770-	Each 2300-
TATA L/L, AMW INTER AXLE 2515 / 2518 RSB SHAFT			Cross - (Cn-033) - 42.0x129.0 mm			
Cn-1110	Interaxle Assly.	SERRATED	(4H.- Ø6" - Cr.L/L TC)	Length-24"	15900-	Unit 20670-
			(Cn-971/1 + Cn-022 + Cn-972/1 + Pipe Ø4 + TN-1114/1 + Cn-1113/1 + Cn-022 + Cn-971/1)			
Cn-1111	Cross Holder	SERRATED	(4H.- Ø7" - Cr. 4018 PT - Ht-120)	(Same Cn-1051/3)	1990-	Each 2585-
Cn-1112	Half Yoke Shaft End		(Ø4" - Cr 49.2x155 - Ht-130)	(Same Cn-1052)	1810-	Each 2355-
Cn-1113	Full Yoke	4018 Long	(16T - Cr.4018 P/T - Ht-13½")	(Same Cn-1094)	3970-	Each 5160-
Cn-1113/1	Full Yoke	Inter Axle	(16T - Cr.L/L TC - Ht-12")	(Same Cn-1122)	3290-	Each 4275-
Cn-1114	Rear Teeth	4018 Small	(Ø4"-16T - Thick-Ø2½" - Ht-10½")	(Same Cn-1055/1)	2270-	Each 2950-
TN-1114/1	Rear Teeth Inter Axle	TEFLON	(Ø4"-16T -Thick-Ø2½" - Ht-10½")	(Same TN-1055)	2990-	Each 3885-
Cn-1117	Coupling EATON	SERRATED	(4H - Ø7" - 30T - Ht-78 - Seal-71)	(Same Cn-1319/2)	2470-	Each 3210-
Cn-1117/1	Coupling Gear	SERRATED	(4H - Ø7" - 31T - Ht-83 - Seal-85)		2470-	Each 3210-
Cn-1117/2	Coupling Gear	SERRATED	(4H - Ø7" - 21T - Ht-63 - Seal-90)	(Same Cn-1059)	2430-	Each 3160-
Cn-1117/3	Coupling Gear	SERRATED	(4H-Ø6" - 31T - Ht.77 - Seal 85)		1770-	Each 2300-

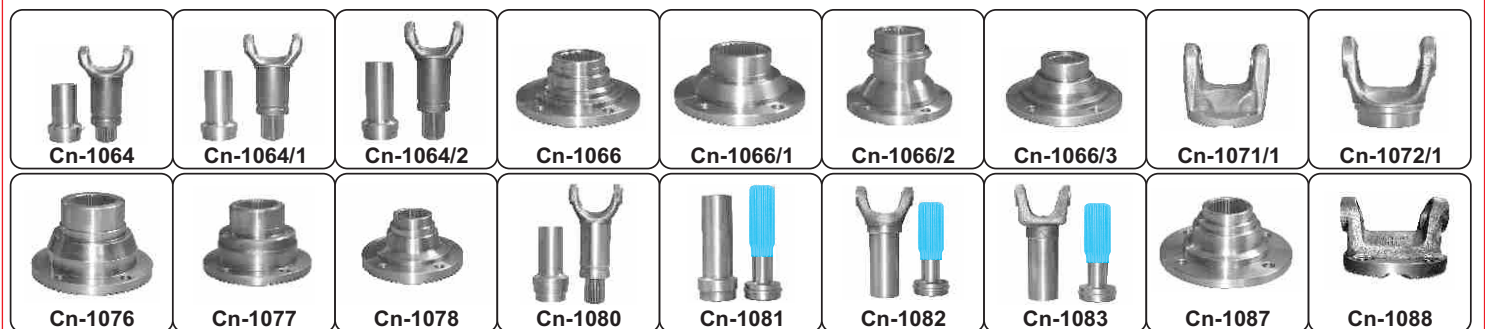

Through Shaft

PART No.	DESCRIPTION			LIST	-	MRF
TATA L/L, AMW INTER AXLE 2515 / 2518 SPICER SHAFT			MSL Shaft Cross - (Cn-022) - 41.28x126 mm			
Cn-1120	Interaxle Assly.	SERRATED	(4H - Ø6" - Cr L/L TC) Length-27" (Cn-971/2+022+1122+1123+022+971/2)	16300-	Unit	21190-
Cn-1121	Cross Holder	SERRATED	(4H - Ø6" - Cr L/L TC - Ht-127) (Same Cn-971/2)	1610-	Each	2095-
Cn-1122	Full Yoke	Thick Teeth	(16T - Cr.L/L TC - Ht -12") (Same Cn-1734)	3290-	Each	4275-
Cn-1123	Rev Yoke	Thick Teeth	(16T - Cr.L/L TC - Ht -13") (Cn-972/1+1055/1)	4550-	Each	5915-
Cn-1124	Rev Yoke & Bottle	Thick Teeth	(16T - Cr.L/L TC - Yoke13" - Bottle 7" - Pipe Ø4")	5950-	Set	7770-
Cn-1124/1	Rev Yoke & Bottle	Same Cn-1080	(20T - Cr.L/L TC - Yoke15" - Bottle 9" - Pipe Ø4")	5190-	Set	6745-
Cn-1124/2	Rev Yoke & Bottle MSL	Thick Teeth	(16T - Cr L/L Tc - Yoke14" - Bottle-8 - Pipe Ø4")	5810-	Set	7555-
TATA L/LAMW INTER AXLE 2515 / 2518 RSB SHAFT			MSL Shaft Cross - (Cn-033) - 42.0x129.0 mm			
Cn-1130	Interaxle Assly.	SERRATED	(4H - Ø6" - Cr.42x129) Length-24" (Cn-1031/1+033+1034/1+Pipe+1032/2+033+1031/1)	15500-	Unit	20150-
Cn-1130/1 Db	Interaxle Assly. MSL	SERRATED	(4H - Ø6" - Cr L/L TC) Length- 25" L/L 3118 (Cn-971/2+022+1135+022+971/2)	14500-	Unit	18850-
Cn-1131	Cross Holder Big	SERRATED	(4H - Ø6" - Cr.42x129 - Ht-140) (Same Cn-1031/1)	1650-	Each	2145-
Cn-1132	Half Yoke Long		(4H - Cr.42x129 - Ht-140) (Same Cn-1032/2)	1770-	Each	2300-
Cn-1133	Rev Yoke & Bottle	(Same Cn-1034/1)	(20T - Cr.42x129 - Yoke13" - Bottle 7" - Pipe- Ø4")	4370-	Set	5680-
Cn-1133/1	Rev Yoke & Bottle	Long MSL	(16T - Cr.L/L TC - Yoke15" - Bottle 10" - Pipe Ø4")	5750-	Set	7475-
Cn-1133/2	Rev.Yoke & Bottle MSL	Thick Teeth	(16T- Cr 42x129 - Yoke-14" - Bottle-8" - Pipe Ø4")	5830-	Set	7580-
Cn-1134	Only Bottle Long		(20T - - Pipe Ø4" - Ht-9") (Same Cn-1035/2)	2070-	Each	2690-
Cn-1135	Rev Yoke & Sleeve Yoke		(16T - Cr.L/L TC - Rev.Yoke15"+ Sleeve Yoke (Cn-974/1)	5790-	Set	7525-
Through Shaft / Lay Shaft - Tata, L/L			(Double Powered Axle Vehicles)			
Cn-1191	Tata 2516	Brg. No. 603049. Seat Ø45	(34Teeth x 32Teeth-Length-15")	1770-	Each	2300-
Cn-1191/1	Through Shaft Housing	Tata 2516	Nakka Type with bearing	2150-	Unit	2795-
Cn-1192	Tata 2518	Brg. No. 494910. Seat Ø51	(39Teeth x 20Teeth-Length-16¾")	2110-	Each	2745-
Cn-1192/1	Through Shaft Housing	Tata 2518	Dana Spicer with bearing	2290-	Unit	2975-
Cn-1193	Tata 2518 N/M	Brg. No. 32011X Seat Ø55	(26Teeth x 35Teeth-Length-20¾")	3070-	Each	3990-
Cn-1193/1	Throu Shaft Housing Plate	Tata 4018 N/M		850-	Unit	1105-
Cn-1194	Dana Spicer	Brg. No. 494910. Seat Ø51	(39Teeth x 34Teeth-Length-15")	2390-	Each	3105-
L/L 1613 Hino Tipper / Stag / Ecomet / Eicher Jumbo / Tata 909 Ex			Cross - (Cn-004) - Tusker			
Cn-1201	Cross Holder	INSKU-100060	(4H - Sq - Cr.Tusker - Ht-80) Same Cn-895	810-	Each	1055-
Cn-1201/1	Cross Holder	SERRATED	(4H. - Ø120 - Cr.Tusker - Ht-94) Spicer No. 4-2-35	1130-	Each	1470-
Cn-1201/2	CrossHolder	INSKU 100467	(8H - Ø5"-Cr. Tusker - Ht-114) Same Cn-860	990-	Each	1285-
Cn-1202	Half Yoke	Spicer No. 4-28-307	(Ø3½" - Cr Tusker - Ht-105) Same Cn-897	1030-	Each	1340-
Cn-1203	Front Teeth	INSKU - 100557	(Ø3½" - 10T - Ht-5½" - Brg-45) Same Cn-862	1090-	Each	1415-
Cn-1204	Full Yoke Hino	Truck Length 9½"	(16T - Cr Tusker - Ht-9½") Spicer No.4-3-2641X	1650-	Each	2145-
Cn-1204/1	Full Yoke Hino	Bus Length 10½"	(16T - Cr Tusker - Ht-10½") OE No. P-4503339	1690-	Each	2195-
Cn-1205	Rr. Teeth Hino	Truck - Length 9"	(Ø3½" - 16T - Ht-9") Spicer No. 4-40-1071	1210-	Each	1575-
TN-1205	Rr. Teeth Hino	TEFLONE	(Ø3½" - 16T - Ht-9")	1510-	Each	1965-
Cn-1205/1	Rr. Teeth Hino	Bus - Length 10"	(Ø3½" - 16T - Ht-10") OE No. 4502433	1350-	Each	1755-
TN-1205/1	Rr. Teeth Hino	TEFLONE	(Ø3½" - 16T - L 10")	1650-	Each	2145-



RSB / Spicer Series

	CR.HOLDER			HALF YOKE		YOKE & TEETH / BOTTLE			SHAFT ASSLY.				
	Part No	Hole-Dia	Ht.	Part No. Pipe	Ht.	Part No	Teeth-Pipe	Yoke x Teeth	Part No.	Plate Size	Length		
Spl.90 Series	990/2	- 8H-Ø5"	- 113	984/3	- Ø3½"	- 125	Tn-996/1	- 16T-Ø3½"	- 12" x 10½"	1060/1	# 4H-Ø6"	- 25"	
	1041/1	- 8H-Ø6"	- 116	972	- Ø4"	- 128	974/3+5/3	- 16T-Ø4"	- 10" x 9"	1060/2	# 4H-Ø6"	- 27"	
	1051/6	- 8H-Ø6½"	- 116	972/1	- Ø4"	- 135	Tn-974/1	- 16T-Ø4"	- 12" x 10½"	1064/4	# 4H-Ø6"	- 29"	
	1051/1	- 8H-Ø6½"	- 125				1113/1+14	- 16T-Ø4"	- 12"x 10½"- HD	1060/3	# 4H-Ø6"	- 31"	
	971	- 8H-Ø7"	- 115				1083	- 16T-Ø4"	- 14" x 11½"-HD	1130/1	# 4H-Ø6"	- 23"	
	971/3	# 4H-Ø5"	- 110				1084	- 16T-Ø4"	- 14" x 13"- HD	1110	# 4H-Ø6"	- 24"	
	971/1	# 4H-Ø6"	- 110				1124	Y&B	- 16T-Ø4"	- 13"x 7"	1120	# 4H-Ø6"	- 27"
	971/2	# 4H-Ø6"	- 127				1124/2	Y&B	- 16T-Ø4"	- 14" x 8"			
							1133/1	Y&B	- 16T-Ø4"	- 15" x 10"			
							1135	Y&B	- 16T-Ø4"	- 15" x 12"			
						1080	Y&B	- 20T-Ø4"	- 15" x 9"				
						Tn-996		- 30T-Ø3½"	- 12" x 10½"				
						974/2+5/2		- 30T-Ø4"	- 10" x 9"				
						Tn-974		- 30T-Ø4"	- 12" x 10½"				
Spicer 1550 Series	895	- 4H-5q.	- 80	896	- Ø3"	- 105	898+890	- 16T-Ø3"	- 8"x 7½"	1085	- 4H-Sq	- L-29"	
	983	- 4H-5q.	- 105	1202	- Ø3½"	- 105	898+891	- 16T-Ø3½"	- 8"x 7½"	1085C	- 4H-Sq	- L-31"	
	812/1	- 6H-Ø4½"	- 90	984	- Ø3½"	- 115	981+982	- 16T-Ø3½"	- 12½"x 10½"	1085X	- 4H-Sq	- L-29" (Cr.L/L TC.)	
	1201/2	- 8H-Ø5"	- 114	984/2	- Ø4"	- 107	981/1+82/1	- 28T-Ø3½"	- 12½"x 11½"	1085Y	- 4H-Sq	- L-31" (Cr.L/L TC.)	
	1088/1	- 8H-Ø6"	- 106	984/4	- Ø4"	- 125	981/2+82/2	- 16T-Ø3½"	- 14"x 12½"				
	1201/1	# 4H-Ø4½"	- 94				981/3+982/3	- 30T-Ø3½"	- 14"x 12½"				
	1088	# 4H-Ø6"	- 100				1082	- 16T-Ø4"	- 13"x 11"				
							1204+05	- 16T-Ø3½"	- 9½"x 9"				
							1204/1+05/1	- 16T-Ø3½"	- 10½"x 10"				
Spicer 1710 Series	1051	- 8H-Ø6½"	- 135	1052	- Ø4"	- 130	1113+14	16T-Ø4"	13"x 10½" - HD				
	1051/2	# 4H-Ø6"	- 120				1054+55	16T-Ø4"	11"x 10½" - HD				
	1051/4	# 4H-Ø6"	- 130				1094+95	16T-Ø4"	13" x 11½"-HD				
	1051/3	# 4H-Ø7"	- 120										
	1291	- 12H-Ø8"	- 130										
Spicer 1810 Series													
	1281	- 8H-Ø6½"	- 136	1282	- Ø4½"	- 165							
Spicer 2040 Series	1301	- 8H-Ø5"	- 132	1305	- Ø4	- 155	1310/1	Y&B	- 16T-Turn Ø91	- 14" x 9" HD	1325	# 4H-Ø6"	- 24"
	1302	# 4H-Ø6"	- 120	1306	- Ø4½" Turn Ø114	- 153	1310	Y&B	- 16T-Turn Ø95	- 15" x 9" HD	1325/1	# 4H-Ø6"	- 25"
	1302/1	# 4H-Ø6"	- 135				1308/2	Y&B	- 34T-Turn Ø91	- 12" x 9"	1325/2	# 4H-Ø6"	- 26"
	1303	# 4H-Ø7"	- 112				1308/1	Y&B	- 34T-Turn Ø91	- 14" x 9"	1325/3	# 4H-Ø6"	- 28"
	1303/1	# 4H-Ø7"	- 137				1308	Y&B	- 34T-Turn Ø91	- 15" x 10"			
							1309	Y&B	- 34T-Turn Ø114	- 13½" x 9½"			
Spicer 2045 Series							1063/1	BY	- 30T-Ø4"+HY	- 13"			
	1251	# 4H-Ø6"	- 125	1252	- Ø4" Turn Ø95	- 162	1255	BY	- 30T-Ø4+HY	- 13.5"	1250	# 4H-Ø7"	- 24"
	1251/3	# 4H-Ø6"	- 140	1252/2- Ø4½" Turn Ø100-	162	1254/6	Y&B	- 30T-Turn Ø95	- 16"x 10"	1250/1	# 4H-Ø7"	- 25"	
	1251/1	# 4H-Ø7"	- 125	1252/1- Ø4¾" Turn Ø112-	152	1254/4	Y&B	- 30T-Turn Ø95	- 13"x 8"	1250/2	# 4H-Ø7"	- 26"	
	1251/2	# 4H-Ø7"	- 140				1254/5	Y&B	- 30T-Turn Ø95	- 15"x 9"			
						1254/3	Y&B	- 30T-Turn Ø112	- 14"x 8"				
						1254	Y&B	- 30T-Turn Ø100	- 15½"x 10"				
Spicer 2055 Series													
	1261	- 10H-Ø7"	- 140				1264	Y&B	36T-Turn Ø112	14"x 8"			
	1261/1	# 4H-Ø7"	- 135	1262	- Ø4¾" Turn Ø112-	152	1264/1	Y&B	38T-Turn Ø112	15"x 8"			
	1261/2	# 4H-Ø7"	- 150										
Spicer 2060 Series													
	1271/1	# 4H-Ø7"	-	1272	- Ø5" Turn Ø118	- 152	1274	Y&B	- 40T-Turn Ø118	- 14" x 9"			
RSB-325 Series													
	1021	- 8H-Ø5"	- 110	1022	- Ø3½"	- 120	1024	Y&B	- 20T-Ø3½"	- 12"x 7"			
	1021/3	- 8H-Ø6"	- 106	1022/2- Ø3½"	- 128	1024/1	Y&B	- 20T-Ø4"	- 12"x 7"				
	1021/5	- 8H-Ø6"	- 116	1022/1- Ø4"	- 128	1024/2	Y&B	- 20T-Ø4"	- 16"x 10"				
	1021/1	# 4H-Ø5"	- 105										
	1021/2	# 4H-Ø6	- 110										
	1021/4	# 4H-Ø6"	- 127										
RSB-403 Series													
	1031/7	- 8H-Ø5"	- 118	1032	- Ø3½"	- 128	1034	Y&B	- 20T-Ø3½"	- 13"x 7"	1030/2	- 8H-Ø5"	- 27" (Cr.1312)
	1031/4	- 8H-Ø6"	- 130	1032/2- Ø4"	- 128	1034/1	Y&B	- 20T-Ø4	- 13"x 7"	1030/3	- 8H-Ø5"	- 29" (Cr.1312)	
	1031	- 8H-Ø6½"	- 135	1032/1- Ø4"	- 145	1034/2	Y&B	- 20T-Ø4	- 14"x 9"	1130	# 4H-Ø6"	- 24"	
	1031/3	- 8H-Ø7"	- 135				1034/3	Y&B	- 20T-Ø4	- 16"x 10"	1030/1	# 4H-Ø6"	- 23"
	1031/2	# 4H-Ø6"	- 110				1133/2	Y&B	- 16T-Ø4	- 14"x 8"	1030	# 4H-Ø6"	- 26"
	1031/1	# 4H-Ø6"	- 128			1024/2	Y&B	- 20T-Ø4	- 16"x 10"	1030/4	# 4H-Ø6"	- 29"	
	1031/5	# 4H-Ø7"	- 128										
RSB-490 Series													
	1061/5	- 8H-Ø6"	- 126	1062	- Ø4"	- 140	1064/4	Y&B	- 16T-Ø4	- 15"x 9"	1060C	# 4H-Ø6"	- 24"
	1061	- 8H-Ø6½"	- 126	1062/1- Ø4" (Deep)	- 140	1064/5	Y&B	- 16T-Ø4	- 16"x 10"	1060B	# 4H-Ø6"	- 25"	
	1061/1	# 4H-Ø6"	- 116				1064	Y&B	- 30T-Ø4"	- 13"x 8"	1060D	# 4H-Ø6"	- 26"
	1061/3	# 4H-Ø6"	- 134				1064/1	Y&B	- 30T-Ø4"	- 15"x 9"	1060	# 4H-Ø7"	- 23"
	1061/2	# 4H-Ø7"	- 112			1064/2	Y&B	- 30T-Ø4"	- 16"x 10"	1060A	# 4H-Ø7"	- 27"	
	1061/4	# 4H-Ø7"	- 128			1064/6	Y&B	- 30T-Turn Ø112"	- 16" x 9"				
RSB-585 Series													
	1285	# 4H-Ø6"	- 130	1286	- Ø4"	- 157	1287	- 30T-Ø4"	- 15"x 9"				
RSB-590 Series													
	1251	# 4H-Ø6"	- 125	1252	- Ø4" Turn Ø95	- 162	1255	BY	- 30T-Ø4+HY	- 13.5"	1250	# 4H-Ø7"	- 24"
	1251/3	# 4H-Ø6"	- 140	1252/2- Ø4¾" Turn Ø100-	162	1254/6	Y&B	- 30T-Turn Ø95	- 16"x 10"	1250/1	# 4H-Ø7"	- 25"	
	1251/1	# 4H-Ø7"	- 125	1252/1- Ø4¾" Turn Ø112-	152	1254/4	Y&B	- 30T-Turn Ø95	- 13"x 8"	1250/2	# 4H-Ø7"	- 26"	
	1251/2	# 4H-Ø7"	- 140				1254/5	Y&B	- 30T-Turn Ø95	- 15"x 9"			
						1254/3	Y&B	- 30T-Turn Ø112	- 14"x 8"				
						1254	Y&B	- 30T-Turn Ø100	- 15½"x 10"				
RSB-620 Series													
	1261	- 10H-Ø7"	- 140				1264	Y&B	36T-Turn Ø112	14"x 8"			
	1261/1	# 4H-Ø7"	- 135	1262	- Ø4¾" Turn Ø112-	152	1264/1	Y&B	38T-Turn Ø112	15"x 8"			
	1261/2	# 4H-Ø7"	- 150										

PART No.	DESCRIPTION				LIST	-	MRP
Cn-1206	C.B. Coupling	(L/L 370 Plate)	(4H - Ø6" - 10T - Ht.63 - Seal-58)	Spicer No. 4-1-540	1050-	Each	1365-
Cn-1206/1	Coupling Centre	SERRATED	(4H - Ø120 - 10T - Ht.60 - Seal-50)	Spicer No. 3-1-75	1230-	Each	1600-
Cn-1206/2	Coupling	SERRATED	(4H - Ø120 - 21T - Ht.60 - Seal-50)		1290-	Each	1675-
Cn-1206/3	Coupling	SERRATED	(4H - Ø120 - 21T - Ht. 84)		1450-	Each	1885-
Cn-1206/4	Coupling	SERRATED	(4H - Ø120 - 30T)		1370-	Each	1780-
Cn-1206/5	Coupling	SERRATED	(4H - Ø120 - 26T)		1450-	Each	1885-
Cn-1206/6	Coupling Gear	SERRATED	(4H - Ø120 - 28T - Ht.91 - Seal 54)		1430-	Each	1860-
Cn-1206/7	Coupling L/L Stag	SERRATED	(4H - Ø120 - 34T - Ht.60 - Seal -56)		1210-	Each	1575-
Cn-1206/8	Coupling L/L Stag	SERRATED	(4H - Ø120 - 34T - Ht.88 - Seal -65)		1310-	Each	1700-
Cn-1207	Coupling Pinion	Dana Spicer	(4H - Ø6" - 39T - Ht.102 - Seal 76)	Plain Base	1550-	Each	2015-
Cn-1207/1	Coupling Pinion	Dana Spicer	(4H - Ø6" - 39T - Ht.86 - Seal 67)	Plain Base	1170-	Each	1520-
Cn-1207/2	Coup. Dana Spi.	SERRATED	(4H - Ø6" - 39T - Ht.86 - Seal 67)	Through Shaft	1490-	Each	1935-
Cn-1207/3	Coup. Dana Spi.	SERRATED	(4H - Ø6" - 39T - Ht.105 - Seal 76)	Pinion	1710-	Each	2225-
Cn-1207/4	Coup. Dana Spi.	SERRATED	(4H - Ø6" - 44T - Ht.105 - Seal 76)	Input Shaft	1730-	Each	2250-
Leyland Hippo-8" (Patti Type) / Leyland 680			Cross- (Cn-032) - 49.20x154.80 Patti Type				
Cn-1211	Cross Holder		(8H - Ø8" - Cr. 49.2x155 Patti Type)		2630-	Each	3420-
Cn-1212	Half Yoke		(Ø3½" - Cr. 49.2x155 Patti Type - Ht-130)		2110-	Each	2745-
Cn-1214	Full Yoke		(16T - Cr. 49.2x155 Patti Type - Ht-11")		3430-	Each	4460-
Cn-1215	Rear Teeth		(Ø3½" - 16 Teeth - Ht-10½")		2410-	Each	3135-
Tata Hywa N/M, AMW			Cross- (Cn-039) 52 x 133.00 mm				
Cn-1240	Assly. Interaxle RSB	SERRATED	(4H - Ø7" - Cr.-52x133-Rev. Y&B Cn-1244) Comp. Length 27"		22800-	Unit	29640-
Cn-1241	Cross Holder	SERRATED	(4H - Ø6" - Cr.-52x133-Ht.- 116)		1970-	Each	2560-
Cn-1241/1	Cross Holder	SERRATED	(4H - Ø7" - Cr.-52x133-Ht.- 127)		2070-	Each	2690-
Cn-1242	Half Yoke		(Ø4" - Cr. 52x133-Ht.- 5")		2050-	Each	2665-
Cn-1244	Reverse Yoke & Bottle	RSB Type	(24T - Pipe Ø4" - Cr. 52x133 - Yoke 16" - Bottle 9")		9450-	Set	12285-
Cn-1244/1	Reverse Yoke & Bottle	Spicer Type	(34T - Pipe Ø4" - Cr. 52x133 - Yoke 14" - Bottle 9")		7950-	Set	10335-
Tata 4928 Prima, AMW, Bharat BENZ			Cross- (Cn-038) 52 x 147 mm (590 / 2045 Series)				
Cn-1251	Cr. Holder	SERRATED	(4H - Ø6" - Cr.-52x147 - Ht-125)		1930-	Each	2510-
Cn-1251/1	Cr. Holder	SERRATED	(4H - Ø7" - Cr.-52x147 - Ht-140)		2330-	Each	3030-
Cn-1251/2	Cr. Holder	SERRATED	(4H - Ø7" - Cr.-52x147 - Ht. 125)		2230-	Each	2900-
Cn-1251/3	Cr. Holder	SERRATED	(4H - Ø6" - Cr.-52x147 - Ht. 140)		2030-	Each	2640-
Cn-1252	Half Yoke		(Ø4" -Turn Ø95 - Cr. 52x147 - Ht.-162)		2250-	Each	2925-
Cn-1252/1	Half Yoke		(Ø4¾" -Turn Ø112 - Cr. 52x147 - Ht.-152)		2330-	Each	3030-
Cn-1252/2	Half Yoke		(Ø4½" -Turn Ø100 - Cr. 52x147 - Ht.-162)		2310-	Each	3005-
Cn-1254	Rev. Yoke & Bottle	Spicer 2045	(38T -Turn Ø100 - Cr. 52x147 - Yoke 15½" - Bottle10")		9550-	Set	12415-
TN-1254	Rev. Yoke & Bottle	TEFLONE	(38T -Turn Ø100 - Cr. 52x147 - Yoke 15½" - Bottle 10")		10550-	Set	13715-
Cn-1254/3	Rev. Yoke & Bottle	RSB	(36T -Turn Ø112 - Cr. 52x147 - Yoke 14"-Bottle 8")		9250-	Set	12025-
TN-1254/3	Rev. Yoke & Bottle	TEFLONE	(36T -Turn Ø112 - Cr. 52x147 - Yoke 14"-Bottle 8")		10250-	Set	13325-
Cn-1254/4	Rev. Yoke & Bottle	RSB 590	(30T -Turn Ø95 - Cr. 52x147 - Yoke 13"- Bottle 8")		7450-	Set	9685-
TN-1254/4	Rev. Yoke & Bottle	TEFLONE	(30T -Turn Ø95 - Cr. 52x147 - Yoke 13"- Bottle 8")		8250-	Set	10725-
Cn-1254/5	Rev. Yoke & Bottle	RSB 590	(30T -Turn Ø95 - Cr. 52x147 - Yoke 15"- Bottle 9")		8050-	Set	10465-
TN-1254/5	Rev. Yoke & Bottle	TEFLONE	(30T -Turn Ø95 - Cr. 52x147 - Yoke 15"- Bottle 9")		8850-	Set	11505-
TN-1254/6	Rev.Yoke & Bottle	RSB-590 TEFLONE	(30T -Turn Ø95 - Cr.52x147 - Yoke 16" - Bottle 10" - Pipe Ø4")		9150-	Set	11895-
Cn-1255 BY	Bottle Yoke Intetaxle	Tata - Prima / Benz	(HY-52x147- Bottle- 30T - Ø4" L-13.5")	Direct Weld	5630-	Each	7320-
TN-1255/4 Db	Assly. Interaxle	SERRATED	(4H - Ø6" - Cr.-52x147-Rev. Y&FY Tn-1254/4) Comp. Length 24"		20200-	Unit	26260-



PART No.	DESCRIPTION			LIST	-	MRP
Tata 4923 Hywa, AMW				Cross- (Cn-041) 57 x 152.0 mm (620/ 2055 Series)		
Cn-1261	Cross Holder		(10H - Ø7" - Cr.-57x152 - Ht.-140)	2370-	Each	3080-
Cn-1261/1	Cross Holder	SERRATED	(4H - Ø7" - Cr.-57x152 - Ht.-135)	2270-	Each	2950-
Cn-1261/2	Cross Holder Long	SERRATED	(4H - Ø7" - Cr.-57x152 - Ht.-150)	2470-	Each	3210-
Cn-1262	Half Yoke		(Ø4¾" - Turn Ø112 - Cr. 57x152 - Ht.-152)	2570-	Each	3340-
Cn-1264	Rev. Yoke & Bottle	RSB	(36T - Turn Ø112 - Cr. 57x152 - Yoke 14", Bottle 8")	9750-	Set	12675-
TN-1264	Rev. Yoke & Bottle	TEFLONE	(36T - Turn Ø112 - Cr. 57x152 - Yoke 14", Bottle 8")	10750-	Set	13975-
Cn-1264/1	Rev. Yoke & Bottle	Spicer	(38T - Turn Ø112 - Cr. 57x152 - Yoke 15", Bottle 8")	9950-	Set	12935-
TN-1264/1	Rev. Yoke & Bottle	TEFLONE	(38T - Turn Ø112 - Cr. 57x152 - Yoke 15", Bottle 8")	10950-	Set	14235-
AMW				Cross- (Cn-043) 59 x 167.7 mm (2060 Series)		
Cn-1271	Cross Holder	For Machine Shaft	(8H - Ø9" - Cr.-59x168 - Patti Type)	3590-	Each	4665-
Cn-1271/1	Cross Holder	SERRATED	(4H - Ø7" - Cr.-59x168 - Lock Type)	2570-	Each	3340-
Cn-1271/2	Cross Holder	For Machine Shaft	(8H - Ø10" - Cr.-59x168 - Patti Type)	3850-	Each	5005-
Cn-1272	Half Yoke	Lock Type	(Ø5" - Turn Ø118 - Cr. 59x168 - Ht. 152)	3750-	Each	4875-
Cn-1272/1	Half Yoke	For Machine Shaft	(Ø4½" - Turn Ø104 - Cr. 59x168 - Patti Type)	3950-	Each	5135-
Cn-1274	Rev. Yoke & Bottle	Spicer 2060	(40T - Ø5" - Turn Ø118 - Cr. 59x168 -Yoke 14", Bottle 9")	10550-	Set	13715-
TN-1274	Rev. Yoke & Bottle	TEFLONE	(40T - Ø5" - Turn Ø118 - Cr. 59x168 -Yoke 14", Bottle 9")	11750-	Set	15275-
AMW / TATA RSB / EICHER				Cross- (Cn-040) 57 x 144.0 mm (1810 Series)		
Cn-1281	Cross Holder	AMW	(8H - Ø6½" - Cr. 57x144 - Ht.136)	2070-	Each	2690-
Cn-1282	Half Yoke	AMW	(Ø4½" - Turn Ø100 - Cr. 57x144 - Ht.6½")	2590-	Each	3365-
Cn-1291	Cross Holder	Tata 4018 N/M	(12H - Ø8" - Cr.4018 PT - Ht.130)	1970-	Each	2560-
Cn-1292	Coup. Through Shaft		(12H - Ø8" - 39T - Ht.85 - Seal -70)	3390-	Each	4405-
Cn-1292/1	Coup. Through Shaft		(12H - Ø8" - 46T - Ht.85 - Seal-84)	3310-	Each	4305-
Cn-1292/2	Coup. Gear		(12H - Ø8" - 30T - Ht.81 - Seal-72)	3370-	Each	4380-
Cn-1292/3	Coupling AMW /	Eicher 40.40	(12H - Ø8" - 32T - Ht.82 - Seal -68)	3410-	Each	4435-
Cn-1292/4	Coupling AMW /	Eicher 40.40	(12H - Ø8" - 31T - Ht.80 - Seal -72)	3330-	Each	4330-
RSB-585 SERIES				CROSS -(CN-034/1) - 48x154		
Cn-1285	Cross Holder	585 Series SERRATED	(4H-Ø6" - Cross 48x154 - Ht.130) Diamond Cut	1930-	Each	2510-
Cn-1286	Half Yoke	585 Series	(Ø4"-Cr. 48x154 - Ht.157 - Turn Ø95)	2030-	Each	2640-
TN-1287	Yoke & Teeth Set	585 Series TEFLONE	(30T - Pipe Ø4" - Cr. 48x154 - Yoke-14" Teeth-9")	8490-	Set	11035-
BHARAT BENZ / TATA				CROSS (CN-019/1) - 47.7 x 135 (2040 SERIES)		
Cn-1301	Cross Holder		(8H-Ø5" - Cr.47.7x135 - Ht. 132)	1510-	Each	1965-
Cn-1302	Cross Holder	SERRATED	(4H-Ø6" - Cr.47.7x135 - Ht. 120)	1770-	Each	2300-
Cn-1302/1	Cross Holder Long	SERRATED	(4H-Ø6" - Cr.47.7x135 - Ht. 135) (Same Cn-1061/9)	1890-	Each	2455-
Cn-1303	Cross Holder	SERRATED	(4H-Ø7" - Cr.47.7x135 - Ht. 112)	1870-	Each	2430-
Cn-1303/1	Cross Holder Long	SERRATED	(4H-Ø7" - Cr.47.7x135 - Ht. 137) (Same Cn-1061/8)	1990-	Each	2585-
Cn-1305	Half Yoke	2040 Series	(Ø4" - Cr.47.7x135 - Ht. 155) (Same Cn-1062/9)	1910-	Each	2485-
Cn-1306	Half Yoke	2040 Series	(Ø4¾" - Turn Ø114 - Cr.47.7x135 - Ht. 153)	2230-	Each	2900-
Cn-1308	Rev.Yoke & Bottle	Cr-47.7x135	(34T - Yoke-15" - Bottle-10" - Pipe Ø4" - Turn Ø91 / Ø95) (same Cn-1063)	6450-	Set	8385-
Cn-1308/1	Rev.Yoke & Bottle	Cr-47.7x135	(34T - Yoke-14" - Bottle-9" - Pipe Ø4"-Turn Ø91 / Ø95) (same Cn-1063/1)	5950-	Set	7735-
Cn-1308/2	Rev.Yoke & Bottle	Cr-47.7x135	(34T - Yoke-12"-Bottle-9"-Pipe Ø4"-Turn Ø91 / Ø95)	5590-	Set	7265-
Cn-1309	Rev.Yoke & Bottle	Cr-47.7x135	(34T - Yoke-13.5"-Bottle-9.5"-Pipe Ø4¾"-Turn Ø114)	6250-	Set	8125-
Cn-1310	Rev.Yoke & Bottle	Cr-47.7x135 Thick Teeth	(16T - Yoke-15" - Bottle-9" - Pipe Ø4" - Turn Ø91 / Ø95)	6070-	Set	7890-
Cn-1310/1	Rev.Yoke & Bottle	Cr-47.7x135 Thick Teeth	(16T - Yoke-14" - Bottle-9" - Pipe Ø4" - Turn Ø91 / Ø95)	5850-	Set	7605-
Cn-1314	Front Teeth	(Bolt Type)	(Ø4" - 20T - Ht.6¼" - Brg Ø60 - Turn Ø95) (Same Cn-1093/4)	1830-	Each	2380-
Cn-1315	Front Teeth	(Bolt Type)	(Ø4¾"-20T - Ht.6" - Brg Ø55 - Turn Ø114) (Same Cn-1093/5)	2070-	Each	2690-
Cn-1317	Coupling Centre	SERRATED	(4H-Ø7" - 20T - Ht.79, Seal-64) (Same Cn-1096/8)	2210-	Each	2875-



PART No.	DESCRIPTION			LIST	-	MRP
Cn-1318	Coupling Centre Diamond Cut	SERRATED	(4H-Ø6"- 20T - Ht.71, Seal-64)	(Same Cn-1096/9)	1770-	Each 2300-
Cn-1318/1	Coupling Centre Diamond Cut	SERRATED	(4H-Ø6"- 20T - Ht.71, Without Seal)	(Same Cn-1096/13)	1870-	Each 2430-
Cn-1319	Coupling Gear EATON	SERRATED	(4H-Ø6" - 28T - Ht.75 - Seal-78)	(Same Cn-978/4)	1710-	Each 2225-
Cn-1319/1	Coupling Gear EATON	SERRATED	(4H-Ø6"- 28T - Ht.95 - Seal-78)	(Same Cn-978/5)	1730-	Each 2250-
Cn-1319/2	Coupling Gear EATON	SERRATED	(4H-Ø7"- 30T - Ht.78 - Seal-71)	(Same Cn-1117)	2470-	Each 3210-
Cn-1320	Coupling Bharat Benz	SERRATED	(4H-Ø6 - 24T - Ht 89- Seal-85)		1630-	Each 2120-
Cn-1320/1	Coupling Bharat Benz	SERRATED	(4H-Ø6 - 26T - Ht 4"- Seal)	Diamond Cut	1710-	Each 2225-
Cn-1325 Db	Interaxle Assly.	SERRATED	(4H-Ø6"- Cr.47.7x135 - Comp.Length-24")	(Direct Weld Yoke)	18200-	Unit 23660-
(Cn-1302/1 + 019/1 + 1305 + Pipe Ø4" + 1308/2 + 019/1 + CN-1302/1)						
Cn-1325/1 Db	Interaxle Assly.	SERRATED	(4H-Ø6"- Cr.47.7x135 - Comp.Length-25")	(Direct Weld Yoke)	18500-	Unit 24050-
Cn-1325/2	Interaxle Assly.	SERRATED	(4H-Ø6"- Cr.47.7x135 - Comp.Length-26")		17600-	Unit 22880-
Cn-1325/3	Interaxle Assly.	SERRATED	(4H-Ø6"- Cr.47.7x135 - Comp.Length-29")		17900-	Unit 23270-
Mahindra-Navi Star						
Cn-1357	Coup. Center Navi Star, L/L 3118	SERRATED	(4H - Ø6" - 44T - Ht.90 - Seal-75)	(Same-Cn-1077)	1710-	Each 2225-
Cn-1357/1	Coup. Center Navi Star, L/L 3118	SERRATED	(8H - Ø7" - 44T - Ht.90 - Seal-75)		1950-	Each 2535-
Eicher Jumbo, 20.16, 30.20, 30.25						
			Cross. Cn-022) 41.28x126mm			
TN-1733	Yoke & Teeth	TEFLONE	(16T - Cr L/L TC - Pipe Ø4" - Yoke 12" - Teeth 10½")		6270-	Set 8150-
Cn-1734	Full Yoke		(16T - Cr L/L TC - Ht-12")	(Same Cn-1113/1)	3290-	Each 4275-
TN-1735	Rear Teeth	TEFLONE	(16T - Pipe Ø4" - Ht-10½")	(Same TN-1055)	2990-	Each 3885-
TN-1736	Yoke & Teeth Set	TEFLONE	(Spicer No. 5013734-3 +100650)	(Same TN-1083)	6630-	Set 8620-
Eicher, AMW, L/L-3116						
			(16T - Cr L/L TC- Y-14" - T-12" - Pipe Ø4")			
Cn-1744	Full Yoke		(28T - Cr Tusker - Ht-12½)	(Same Cn-981/1)	2070-	Each 2690-
Cn-1745	Rear Teeth		(28T - Pipe Ø3½" - Ht-11½)	(Same Cn-982/1)	1530-	Each 1990-
Cn-1751	Cross Holder		(8H - Ø7" - Cr. L/L Spicer - Ht-120)	(Same Cn-971)	1450-	Each 1885-
Cn-1751/1	Cross Holder		(8H - Ø5" - Cr. L/L Spicer - Ht-113)	(Same Cn-990/2)	1130-	Each 1470-
Cn-1752	Half Yoke		(Ø4" - Cr. L/L Spicer - Ht-128)	(Same Cn-972)	1350-	Each 1755-
Cn-1753	Front Teeth		(Ø4" - 34T - Ht-6½" - Brg. Ø45)	(Same Cn-973)	1130-	Each 1470-
Cn-1753/1	Front Teeth		(Ø3½" - 16T - Ht-7" - Brg. Ø62)	(Same Cn-916)	1310-	Each 1705-
Cn-1753/2	Front Teeth		(Ø3" - 16T - Ht-7" - Brg. Ø62)		1210-	Each 1575-
Cn-1753/3	Front Teeth Eicher 50.16,L/L 2518		(Ø4" - 39T - Ht 6½" - Brg Ø55 - Turn Ø91 / Ø95)		1550-	Each 2015-
Cn-1754	Full Yoke		(16T - Cr. L/L Spicer - Ht-12")	(Same Cn-974/1)	2210-	Each 2875-
Cn-1755	Rear Teeth		(Ø4" -16T- Ht-10¾) EN-15	(Same Cn-975/1)	1570-	Each 2040-
TN-1755	Rear Teeth	TEFLONE	(Ø4" - 16T - Ht-10¾)	(Same as TN-975/1)	1970-	Each 2560-
Cn-1756	Yoke & Teeth		(Ø4" -16T- Cr. L/L TC-Y-12- T-10¾")	(Same Cn-974/1+975/1)	3770-	Set 4900-
TN-1756	Yoke & Teeth	TEFLONE	(Ø4" - 16T - Cr. L/L TC-Y-12- T-10¾")	(Same TN-974/1)	4170-	Set 5420-
Cn-1757	Coupling Centre		(8H - Ø5" - 34 T - Ht. 78-Seal -55.7)		970-	Each 1260-
Cn-1757/1	Coup. Centre Eicher 30.20		(4H - Ø6" - Square - 16T - Ht. 92-Seal -62)		1190-	Each 1545-
Cn-1757/2	Coup. Eicher Jumbo		(4H - Ø6" - Square - 34T - Ht. 74-Seal -58)		1050-	Each 1365-
Cn-1757/3	Coup. Centre Jumbo		(8H - Ø7" - 16T - Ht. 92-Seal -70)		1710-	Each 2225-
Cn-1757/4	Coup. Gear Galaxy 30.25		(8H - Ø7" - 34T - Ht. 84-Seal -58)		1770-	Each 2300-
Cn-1757/5	Coup. Centre Jumbo	SERRATED	(4H - Ø6" - 34T - Ht. 76-Seal -58)		1730-	Each 2250-
Cn-1757/6	Coup. Centre Eicher 50.16	SERRATED	(4H - Ø6" - 39T - Ht.82, Seal-63)	Diamond Cut	1690-	Each 2195-
Cn-1757/7	Coup. Centre Eicher Jumbo		(4H - Ø6" Sq-16T - Ht.96, Seal-71)		1250-	Each 1625-
Cn-1757/8	Coup. Centre Eicher Jumbo	SERRATED	(4H - Ø6" - 16T - Ht.)		1490-	Each 1935-
Cn-1757/9	Coup. Gear Eicher Jumbo	SERRATED	(4H - Ø6" - 32T - Ht.88, Seal-68 - Coller Type)		1770-	Each 2300-
Cn-1761	Cross Holder Eicher Pro 10.80	SERRATED	(4H - Ø120 - Cr-35x106 - Ht.84mm)	(Same Cn-816/3)	1230-	Each 1600-
Cn-1761/1	Cross Holder Eicher Pro 30.15 Square		(4H - Sq- Cr-35x106 - Ht.75mm)	(Same Cn-2113/4)	870-	Each 1130-
Cn-1763	Half Yoke Pro 10.80,3015	SERRATED	(Ø3½ - Cr-35x106 - Ht.92mm)	(Same Cn-816/2)	810-	Each 1055-
TN-1765	Y & T Set Eicher Pro 10.80	TEFLONE	(24T - Cr-35x106 - Ye-9" T-8½ - Pipe Ø3½")	(Same-TN-816/4)	2590-	Set 3365-
TN-1765/1	Y & T Set Eicher Pro 10.90	TEFLONE	(16T - Cr-35x106 - Y-7" T- 7½ - Pipe Ø3½")	(Same-TN-816)	2270-	Set 2950-
TN-1765/2	Y & T Set Eicher Pro 10.95	TEFLONE	(16T - Cr-35x106 - Y 7" T-6¾ - Pipe Ø3")		2070-	Set 2690-
TN-1765/3	Y & T Set Eicher Pro 30.15	TEFLONE	(24T - Cr-35x106 - Y-9" T-10½ - Pipe Ø3½ - Brg Ø40)	(Same-TN-816/5)	2890-	Set 3755-



PART No.	DESCRIPTION			LIST	-	MRP	
Pump Drive Shaft Assly.		Dynamically Balanced					
Cn-2101	P.D. Shaft Assly.	Hydra	(Comp. Length 10" - Cr. Amb - Flange 4 H - Ø86)	2730-	Unit	3550-	
Cn-2101/1	P.D. Shaft Assly.	Crane	(Comp. Length 8" - Cr. Amb - Flange 4 H - Ø86)	2710-	Unit	3525-	
Cn-2101/2	P.D. Shaft Assly.	Hydra Crane	(Comp.Length 12" - Cr.Amb-Flange 4H- Ø86)	2730-	Unit	3550-	
Cn-2102	P.D. Shaft Assly.	Tipper	(Comp. Length 11" - Cr. Jeep - Flange 4 H - Ø98)	3730-	Unit	4850-	
Cn-2103	P.D. Shaft Assly.	Tipper	(Comp. Length 15" - Cr. Jeep - Flange 4 H - Ø98)	3790-	Unit	4925-	
Cn-2103/1	P.D. Shaft Assly.	L/L Gally	(Comp. Length 20" - Cr. Jeep - Flange 4 H - Ø98)	3830-	Unit	4980-	
Cn-2104	P.D. Shaft Assly.	Tipper	(Comp. Length 25" - Cr. Jeep - Flange 4 H - Ø98)	3890-	Unit	5055-	
Cn-2105	P.D. Shaft Assly.	JCB 3D N/M	(Comp. Length 13" - Cr. Jeep) Bore 25mm	3850-	Unit	5005-	
Cn-2105/1	P.D. Shaft Assly.	JCB 3D O/M	(Comp. Length 13" - Cr. Jeep) Bore 28mm	3870-	Unit	5030-	
Cn-2108	P.D. Shaft Assly.	L&T Digger O/M	(Comp. Length 11" - Cr. Canter - Flange 6 H - Ø120)	4470-	Unit	5810-	
Cn-2108/1	P.D. Shaft Assly.	L&T Digger N/M	(Comp. Length 10" - Cr. Canter Flange 8 H - Ø120 - Female Spigot Ø75)	4450-	Unit	5785-	
Cn-2109	P.D. Shaft Assly.	TERREX N/M	(Comp. Length 310 mm - Cr. Canter)	4370-	Unit	5680-	
Cn-2110	P.D. Shaft Assly.	ESCORT K-10	(Cross Holder + Cross Amb. + Cross Holder) Height - 63mm	1130-	Unit	1470-	
Cn-2112	Rear Shaft Assly.	Complete	JCB 3D (Hol.+Cr.+Yoke+Rev.Yoke+Cr.)Comp. Length - 12"	5170-	Unit	6720-	
Cn-2112/1	Rear Shaft Half Assly.	Male Assly	JCB 3D (Rev.Yoke+Cr.38x56 IN)	2230-	Unit	2900-	
Cn-2112/2	Reverse Yoke Only.	Rear Shaft	JCB 3D (Cr. 38 x 56 IN)	1470-	Each	1910-	
Cn-2112/3	Sleeve Yoke Only.	Rear Shaft	JCB 3D (Cr. 35 x 126)	1310-	Each	1705-	
Cn-2112/4	Cross Holder	Rear Shaft	JCB 3D (Same Cn-895) (Cr. 35 x 126)	810-	Each	1055-	
Cn-2113	Rear Shaft Assly.	Complete	JCB 3DX (Hol.+Cr.+Yoke+Rev.Yoke+Cr.)	5370-	Unit	6980-	
Cn-2113/1	Rear Shaft Half Assly.	Male Assly	JCB 3DX (Rev.Yoke+Cr.35x106)	2530-	Unit	3290-	
Cn-2113/2	Reverse Yoke Only.	Rear Shaft	JCB 3DX (Cr. 35 x 106)	1590-	Each	2065-	
Cn-2113/3	Sleeve Yoke Only.	Rear Shaft	JCB 3DX (Cr. 35 x 106)	1350-	Each	1755-	
Cn-2113/4	Cross Holder	Rear Shaft	JCB 3DX (Same Cn-1761/1) (Cr. 35 x 106)	890-	Each	1155-	
Cn-2113/5	Holder Coupling	Rear Shaft	JCB-3DX (35T - Cr 35x106 - Ht.95 - Brg Ø55)	1190-	Each	1545-	
Cn-2114	Rear Shaft Assly.		JCB 3DX Super (4x4) Comp. Length - 27"	6250-	Unit	8125-	
Cn-2114/1	Rear Shaft Assly		JCB 3DX Super (4x4) Comp. Length - 25"	6150-	Each	7995-	
Cn-2121	Power Pack Assly.	Tractor	(Comp. Length 174 - Cr. Amb. - Flange 4 H - Ø86)	2570-	Unit	3340-	
Cn-2122	P.D. Shaft Assly.	Godrej Fork Lift	(Cross Amb.) (Length - 160mm)	2170-	Unit	2820-	
Cn-2151	Jt. Sleeve Yoke Set	M+F Small	(Mini Tractor Captain - Length 200 - Cr. Jeep)	1510-	Unit	1965-	
Cn-2151/1	Jt. Sleeve Yoke Set	M+F Big	(Mini Tractor Captain - Length 245 - Cr. Jeep)	1610-	Unit	2095-	

Pump Drive Shaft Assemblies

23.82x61.30 (Ambassador) ← Cross Size → 27.00x81.80 (Jeep) ← Cross Size → 27.00x81.80 (Jeep) ← Cross Size → 27.00x81.80 (Jeep)



27.00x81.80 (Jeep) ← Cross Size → 27.00x81.80 (Jeep) ← Cross Size → 30.18x106.3 (Canter) ← Cross Size → 30.18x106.3 (Canter)



30.18x106.3 (Canter) ← Cross Size → 23.82x61.30 (Amb) ← Cross Size → 34.95x126.20 (Base) ← Cross Size → 38.04x56.7 + 34.95x106



34.95x106.00 ← Cross Size → 34.95x106.00 ← Cross Size → 34.95x106.00 ← Cross Size → 23.82x61.30 (Amb)

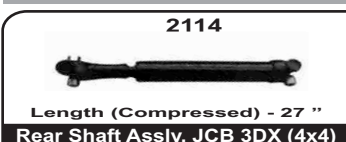

Water Pump Assly.

CENRON AUTO IMPEX
Price List w.e.f. 10-11-2021

PART No.	DESCRIPTION	LIST	MRP
Maruti Suzuki Application			
Cn-2501	W.P. Assly Maruti 800cc Car / Van	17400M7811 / 78100	830- Unit 1080-
Cn-2502	W.P. Assly Maruti Car MPFI - ALTO / WagonR		870- Unit 1130-
Cn-2502/1	W.P. Assly. Maruti Alto - K10 / Estilo		990- Unit 1285-
Cn-2503	W.P. Assly Maruti Zen / Esteem / Swift Petrol / Eeco	1740082850 / M82631	930- Unit 1210-
Cn-2504	W.P. Assly Maruti Swift Diesel / Ciaz Diesel / Baleno Diesel / Vitara Brezza		1350- Unit 1755-
Mahindra & Mahindra Application			
Cn-2511	W.P. Assly Jeep Diesel C.J. 500 DI / Pickup	(A. Groove Pulley) 0051 818 / 008 4490	1670- Unit 2170-
Cn-2511/1	W.P. Assly Jeep Diesel C.J. 500 D / Pickup	(B. Groove Pulley) 005 1620	1690- Unit 2195-
Cn-2514	W.P. Assly Scorpio CRDI (Alum. Body)	(7 PK Pulley)	2850- Unit 3705-
Cn-2514/1	W.P. Assly Scorpio CRDI (Alum. Body)	(7 PK Pulley) (With Back Pipe)	2870- Unit 3730-
Cn-2515	W.P. Assly Scorpio M 2 Di	030 4EBO 480N	2030- Unit 2640-
Cn-2515/1	W.P. Assly Scorpio M - Hawk		2470- Unit 3210-
Cn-2516	W.P. Assly Bolerio Trubo / MaXx Turbo	(Universal) 030 4EBO 410N	2050- Unit 2665-
Cn-2517	W.P. Assly Maximo Cargo		1130- Unit 1470-
Cn-2517/1	W.P. Assly Maximo Passenger	(With Nozzle)	1150- Unit 1495-
Cn-2518	W.P. Assly Mahindra jeeto		930- Unit 1210-
Tata Application			
Cn-2531	W.P. Assly Tata Iris. / Mahindra Champion	N/M 2101 058 001	890- Unit 1155-
Cn-2532	W.P. Assly Tata Indica Turbo / Tata ACE	(With Gear) 2790 2010 0108	790- Unit 1025-
Cn-2532/1	W.P. Assly Tata Indica Vista / Indigo Manza		1550- Unit 2015-
Cn-2533	W.P. Assly Tata Sumo/Safari/Winger/207 Mobile	(With Gear) 2547 2010 0118	1030- Unit 1340-
Cn-2533/1	W.P. Assly Tata 207 DI, Spacio, 407, 608	2534 2010 0120	2350- Unit 3055-
Cn-2534	W.P. Assly Tata 407 Ex. / Sumo Gold	(With Back Pipe)	2370- Unit 3080-
Cn-2534/1	W.P. Assly Tata 407 Turbo / 608 Turbo / Safari Dicor 3.0		2390- Unit 3105-
Cn-2534/2	W.P. Assly Tata 407 Ex., 410 -	(EURO - II, III)	2870- Unit 3730-
Cn-2534/3	W.P. Assly. Tata 407 - BS-IV		2970- Unit 3860-
Cn-2537	W.P. Assly. Tata Ultra		1930- Unit 2510-
Cn-2538	W.P. Assly Tata Marcopolo / 4923 / 4018 / AMW	2786 2099 9972	1650- Unit 2145-
Cn-2541	W.P. Assly Tata 1109 / 1613 / 2515 Turbo	(EURO-II) Small Hose 2525 2010 0124	3390- Unit 4405-
Cn-2541/1	W.P. Assly Tata 1109 / 1613 / 2515 Turbo	(EURO-III) Big Hose 2525 2010 0126	3490- Unit 4535-
Cn-2542	W.P. Assly Tata 1210	2523 2010 0103 /113/114	2430- Unit 3160-
Cn-2543	W.P. Assly Tata 1312 / 1510 / 2213/ 2416	(Small Hole) 2525 2010 0116	3290- Unit 4275-
Cn-2543K	W.P. Repair Kit Minor Tata 1312 / 1313		290- Set 375-
Cn-2544	W.P. Assly Tata Cummins 1512 / 2416 / 2516	2786 2099 9959	1670- Unit 2170-
Ashok Leyland Application			
Cn-2551	W.P. Assly Leyland Dost		1150- Unit 1495-
Cn-2554	W.P. Assly Leyland 370 / Comet / Viking / Cheetah / Marine E/G.	B200 0801 / 805	2490- Unit 3235-
Cn-2555	W.P. Assly Leyland 400 / 401	(Double Port Outlet) B200 0808	2690- Unit 3495-
Cn-2556	W.P. Assly L/L Taurus 3416, Tusker Super	(Double Port Outlet) B700 7101 / 03	2730- Unit 3550-
Cn-2557	W.P. Assly Leyland Hino 6D	(Fan Bolt - 8x1.25) B701 6001 / 6008	1830- Unit 2380-
Cn-2557/1	W.P. Assly Leyland Hino	(EURO-II) B876 0406 / B701 6011	2510- Unit 3265-
Cn-2557/2	W.P. Assly Leyland Hino	(EURO-III) B876 0406 / 8780401	2530- Unit 3380-
Cn-2557/3	W.P. Assly Leyland Hino (Impeller Dia 75mm)	(EURO-II)	2490- Unit 3235-
Cn-2557/4	W.P. Assly Leyland Hino	(EURO - IV)	3290- Each 4275-

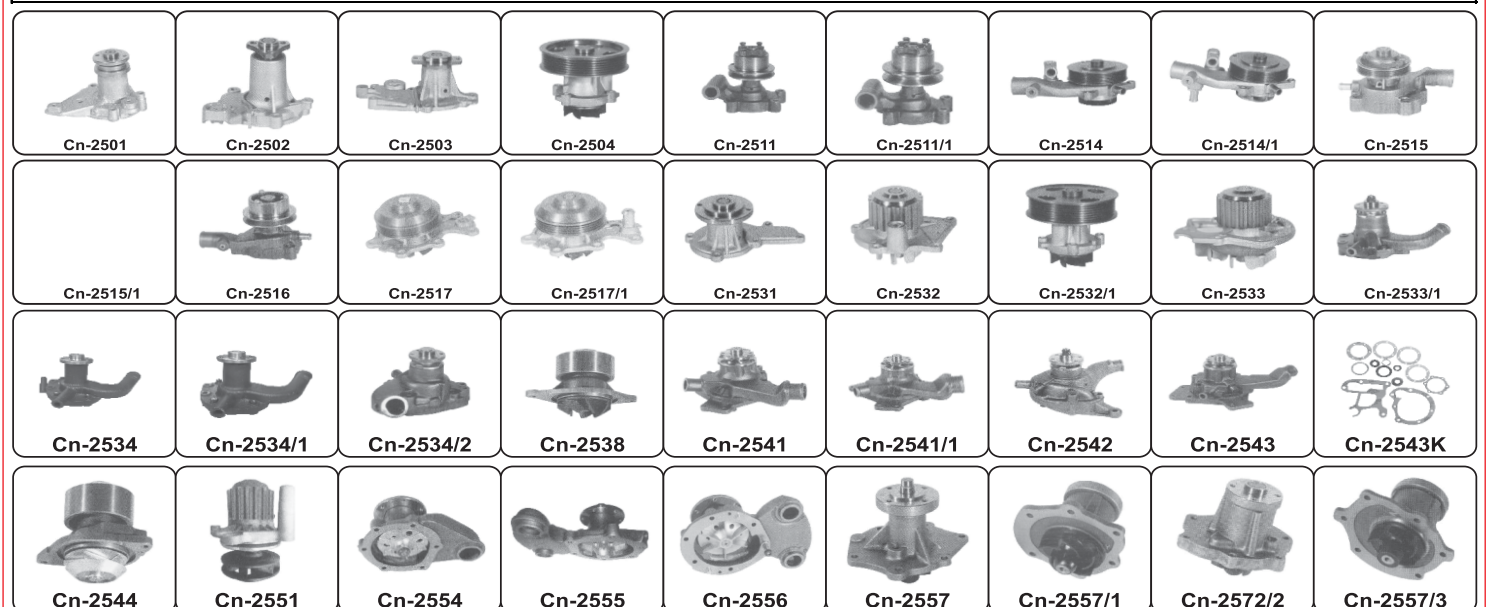

Fly Wheel Assly.

CENRON AUTO IMPEX
Price List w.e.f. 10-11-2021

PART No.	DESCRIPTION			LIST	-	MRP
Fly Wheel Assly.		Dia	Teeth	Reference No.		
Cn-2722	Tata 407 Turbo	240 mm Dia	114 T	5070-	Each	6590-
Cn-2723	Tata ACE, Magic	170 mm Dia	120 T	2350-	Each	3055-
Cn-2726	Tata SE, GB - 40	310 mm Dia	125 T	2525 0311 0104	4530-	Each 5890-
Cn-2726A	Tata 1613 Turbo, EURO - II, GB-40	330 mm Dia	125 T	2525 0311 0128	4550-	Each 5915-
Cn-2726B	Tata 1109 EURO III	330 mm Dia	125 T	2527 0311 0135	6570-	Each 8540-
Cn-2728	Tata 2516 Turbo (Plain)	350 mm Dia	146 T	2525 0311 0117	6170-	Each 8020-
Cn-2728A	Tata 2515 Turbo, 1615 TC (6 Sensor slot Type)	350 mm Dia	146 T	2525 0311 0132	6830-	Each 8880-
Cn-2728B	Tata 1616 EURO - IV (58 Sensor Hole -Button Type)	350 mm Dia	146 T		6930-	Each 9010-
Cn-2729	Tata 1312 TC, 1613 CNG (4 Bolt -12 Hole)	330 mm Dia	159 T	2786 0798 9927	5650-	Each 7345-
Cn-2729/1	Tata 1312 TC, 2416 CNG (4 Bolt)	330 mm Dia	127 T	2786 0798 9925	5610-	Each 7295-
Cn-2730	Tata 2515 Ex. (GB 50/60)	352 mm Dia	173 T	2786 0399 9983	5510-	Each 7165-
Cn-2730/1	Tata 2515 TC, Ex, Hywa (GB 50/60)	352 mm Dia	138 T		5470-	Each 7110-
Cn-2730/1A	Tata 4923 (GB - 75)	380 mm Dia	138 T	2786 0399 9801	9670-	Each 12570-
Cn-2730/2	Tata 2515, 3118, 4018 TC (4 LN Bolt)	352 mm Dia	138 T	T065 6000 0053	5750-	Each 7475-
Cn-2732	L/L Taurus, 4018 (Thin) Flywheel+Back Plate - 14"	350 mm Dia	136 T	B 824 9801	9750-	Each 12675-
Cn-2733	Leyland E comet, Hino 4D - 8040	330 mm Dia	126 T	B 3F0 0401	6750-	Each 8775-
Cn-2734	L/L Hino 6D, 4018 Flywheel+Back Plate -15"	380 mm Dia	136 T	B 922 4202	9950-	Each 12935-
Cn-2734A	L/L 4923 (Sensor Type) Flywheel+Back Plate -15"	380 mm Dia	136 T	B 928 8401	11200-	Each 14560-
Cn-2734/2	Fly Wheel Assly L/L 4019 Captain-15"		136 T		8170-	Unit 10620-
Cn-2734/3	Fly Wheel Assly L/L Bus-15" - Valeo Type		136 T		8190-	Unit 10645-
Cn-2735/1	Leyland Dost	215 mm Dia	119 T	B 970 8217	3470-	Each 4510-
Cn-2737	Eicher Canter 6 Hole	275 mm Dia	110 T	IB 001 784	5570-	Each 7240-
Cn-2737A	Eicher Canter 9 Hole	275 mm Dia	110 T	ID 000 032	5590-	Each 7265-
Cn-2737/1	Eicher Jumbo	300/325 Dia	140 T	ID 000 112	7950-	Each 10335-
Face Plate - Back Plate						
Cn-2743	Face Plate Leyland - 14" (4 Finger) (13mm Thick)	352 mm			1750-	Each 2275-
Cn-2743/1	Back Plate Leyland - 14" (4 Finger)	352 mm			3370-	Each 4380-
Cn-2746	Face Plate Leyland - 15" (4 Finger) (19mm Thick)	380 mm			2650-	Each 3445-
Cn-2746/1	Back Plate Leyland - 15" (4 Finger)	380 mm			3330-	Each 4330-
WHEEL SPANNER (POWDER COATED)						
Cn-1701	Wheel Pana Length-10"		Size - 24 x 27		370-	Each 480-
Cn-1702	Wheel Pana Length-10"		Size - 27 x 27		370-	Each 480-
Cn-1702/1	Wheel Pana Length-10"		Size - 27 x 33		390-	Each 505-
Cn-1703	Wheel Pana Length-10"		Size - 28 x 33		390-	Each 505-
Cn-1705	Wheel Pana Length-16"		Size - 24 x 27		620-	Each 805-
Cn-1705/1	Wheel Pana Length-16" JCB Special		Size - 25 x 28		650-	Each 845-
Cn-1706	Wheel Pana Length-16"		Size - 27 x 27		620-	Each 805-
Cn-1706/1	Wheel Pana Length-16"		Size - 27 x 30		620-	Each 805-
Cn-1706/2	Wheel Pana Length-16"		Size - 27 x 32		620-	Each 805-
Cn-1706/3	Wheel Pana Length-16"		Size - 27 x 33		620-	Each 805-
Cn-1707	Wheel Pana Length-16"		Size - 30 x 30		620-	Each 805-
Cn-1707/1	Wheel Pana Length-16"		Size - 30 x 32		620-	Each 805-
Cn-1707/2	Wheel Pana Length-16"		Size - 30 x 33		620-	Each 805-
Cn-1708	Wheel Pana Length-16"		Size - 32 x 32		620-	Each 805-
Cn-1708/1	Wheel Pana Length-16"		Size - 32 x 33		620-	Each 805-
Cn-1709	Wheel Pana Length-16"		Size - 33 x 33		620-	Each 805-
Cn-1711	Wheel Pana Length-20"		Size - 30 x 32		790-	Each 1025-
Cn-1712	Wheel Pana Length-20"		Size - 32 x 32		790-	Each 1025-
Cn-1712/1	Wheel Pana Length-20"		Size - 32 x 33		790-	Each 1025-
Cn-1713	Wheel Pana Length-20"		Size - 33 x 33		790-	Each 1025-
Cn-1721	Wheel Pana Length-22"		Size - 32 x 32		910-	Each 1185-
Cn-1721/1	Wheel Pana Length-22"		Size - 32 x 33		910-	Each 1185-
Cn-1722	Wheel Pana Length-22"		Size - 33 x 33		910-	Each 1185-
JACK ROD / WHEEL PANA ROD EN-8D						
Cn-1725	Jack Rod 48" Long		Heave Duty Full Hard & Tempered		770-	Each 1000-
Cn-1726	Jack Rod 54" Long		Heave Duty Full Hard & Tempered		880-	Each 1145-
Cn-1727	Jack Rod 60" Long		Heave Duty Full Hard & Tempered		990-	Each 1290-

PART No.	DESCRIPTION		LIST	MRP
BRAKE DISC ROTOR				
Cn-3201	Brake Disk Rotor	Tata ACE, Magic	Vented	640- Each 830-
Cn-3201/1	Brake Disk Rotor	Tata ACE Venture, Super Ace	Vented	1350- Each 1755-
Cn-3201/2	Brake Disk Rotor	Tata Ace Dicor	Vented	1410- Each 1835-
Cn-3201/3	Brake Disk Rotor	Tata Ace Mega	Vented	1310- Each 1705-
Cn-3202	Brake Disk Rotor	Tata Indica O/M	Solid	870- Each 1130-
Cn-3202/1	Brake Disk Rotor	Tata Indica N/M	Vented	910- Each 1185-
Cn-3202/2	Brake Disk Rotor	Tata Indica vista (Petrol)	Vented	970- Each 1260-
Cn-3203	Brake Disk Rotor	Tata Sumo O/M	Solid	1630- Each 2120-
Cn-3203/1	Brake Disk Rotor	Tata Sumo N/M, 207 DI, Ex Telcoline, Spacio	Vented	1490- Each 1940-
Cn-3203/2	Brake Disk Rotor	Tata Sumo Victa, Xenon O/M 11" (280mm-Dia)	Vented	1930- Each 2510-
Cn-3203/3	Brake Disk Rotor	Tata Sumo Grande, Xenon 11½" (296mm-Dia)	Vented	2070- Each 2690-
Cn-3203/4	Brake Disk Rotor	Tata 207 DI Rx (263mm-Dia)	Vented	1390- Each 1805-
Cn-3203/5	Brake Disk Rotor	Tata Safari Dicor, Telcoline (270mm-Dia)	Vented Flower Type	2050- Each 2665-
Cn-3203/6	Brake Disk Rotor	Tata Safari Dicor, Telcoline (280mm-Dia)	Vented Flower Type	2290- Each 2975-
Cn-3203/7	Brake Disk Rotor	Tata Safari 2-2, Xenon - 12" (302mm-Dia)	Vented	2470- Each 3210-
Cn-3221	Brake Disk Rotor	Mahindra Bolero O/M, Utility	Solid	1890- Each 2460-
Cn-3221/1	Brake Disk Rotor	Mahindra Bolero N/M, Utility Maxi Truck Plus	Vented	1410- Each 1835-
Cn-3221/2	Brake Disk Rotor	Mahindra Bolero, Strom Rear	Vented	1830- Each 2380-
Cn-3221/3	Brake Disk Rotor	Mahindra Bolero, Strom Front	Vented	1830- Each 2380-
Cn-3221/4	Brake Disk Rotor	Mahindra Bolero Sensor Type	Vented	1470- Each 1910-
Cn-3222	Brake Disk Rotor	Mahindra Scorpio O/M, M2 DI	Vented	1410- Each 1835-
Cn-3222/1	Brake Disk Rotor	Mahindra Scorpio CRD	Vented	2030- Each 2640-
Cn-3222/2	Brake Disk Rotor	Mahindra Scorpio S2 / S6 / TUV 300	Vented	1950- Each 2535-
Cn-3222/3	Brake Disk Rotor	Mahindra Scorpio S4 / S8 / S10	Vented	1990- Each 2585-
Cn-3223	Brake Disk Rotor	Mahindra Maximo Loader N/M	Vented (82mm Bore)	770- Each 1000-
Cn-3223/1	Brake Disk Rotor	Mahindra Maximo Passenger / Mini / Jeeto	Vented	870- Each 1130-
Cn-3223/2	Brake Disk Rotor	Mahindra Maximo, Loader O/M	Vented (78mm Bore)	770- Each 1000-
Cn-3223/3	Brake Disk Rotor	Mahindra Supro	Vented	1270- Each 1650-
Cn-3224	Brake Disk Rotor	Mahindra Xylo - RH / Genio / Quanto	Vented	1930- Each 2510-
Cn-3224/1	Brake Disk Rotor	Mahindra Xylo - LH / Genio / Quanto	Vented	1930- Each 2510-
Cn-3225	Brake Disk Rotor	XUV 500 Rear	Solid	1850- Each 2405-
Cn-3225/1	Brake Disk Rotor	XUV 500 Front	Vented	2950- Each 3835-
Cn-3225/2	Brake Disk Rotor	Mahindra XUV 300 Front	Vented	2710- Each 3525-
Cn-3225/3	Brake Disk Rotor	Mahindra XUV 300 Rear	Solid	2530- Each 3290-
Cn-3226	Brake Disk Rotor	Scorpio - M Hawk Sensor-RH	Vented	2930- Each 3810-
Cn-3226/1	Brake Disk Rotor	Scorpio - M Hawk Sensor-LH	Vented	2930- Each 3810-
Cn-3231	Brake Disk Rotor	Maruti 800 / Zen O/M / Van	Solid	770- Each 1000-
Cn-3232	Brake Disk Rotor	Maruti Alto O/M	Solid	990- Each 1285-
Cn-3232/1	Brake Disk Rotor	Maruti Alto N/M / Wagon R / Zen Estilo	Vented	1050- Each 1365-
Cn-3233	Brake Disk Rotor	Maruti Swift Diesel / Petrol, Swift DeZire/Ritz	Vented	1270- Each 1650-
Cn-3234	Brake Disk Rotor	Maruti Eeco / Versa	Vented	1070- Each 1390-
Cn-3241	Brake Disk Rotor	Toyota Innova	Vented	2050- Each 2665-
Cn-3241 /1	Brake Disk Rotor	Toyota Qualis	Vented	1470- Each 1910-
Cn-3245	Brake Disk Rotor	Chevrolet Tavera	Vented	1390- Each 1805-
Cn-3261	Brake Disk Rotor	Tempo Traveller O/M	Solid	1950- Each 2535-
Cn-3261/1	Brake Disk Rotor	Tempo Traveller N/M	Vented	2530- Each 3290-
Cn-3271	Brake Disk Rotor	Leyland Dost (4Hole)	Vented	1350- Each 1755-
Cn-3271 /1	Brake Disk Rotor	Leyland Dost Plus (5 Holes)	Vented	1410- Each 1835-



PART No.	DESCRIPTION		LIST	-	MRP
FRONT / REAR HUB & BRAKE DRUM					
Cn-3301	Brake Drum	Tata ACE	790-	Each	1025-
Cn-3303	Brake Drum	Tata Sumo N/M, Spicer (SPICER TYPE)	2430-	Each	3160-
Cn-3304	Brake Drum	Tata Iris / Zip Front	1230-	Each	1600-
Cn-3304/1	Brake Drum	Tata Iris / Zip Rear	1250-	Each	1625-
Cn-3321	Brake Drum	Mahindra Bolero O/M, Scorpio O/M. 282mm (HALF TAPPER)	1810-	Each	2355-
Cn-3321/1	Brake Drum	Mahindra Bolero, Utility, N/M, Scorpio, Maxi Truck (FULL TAPPER)	1990-	Each	2585-
Cn-3322	Brake Drum	Scorpio S2 / S4 / S6 / S10	2570-	Each	3340-
Cn-3323	Brake Drum	Mahindra Maximo Cargo / Loader	970-	Each	1260-
Cn-3323/1	Brake Drum	Mahindra Maximo Passenger	1290-	Each	1675-
Cn-3323/2	Brake Drum	Mahindra Jeeto	810-	Each	1055-
Cn-3331	Brake Drum	Maruti Van Rear	1430-	Each	1860-
Cn-3371	Brake Drum	Leyland Dost (4Hole)	2110-	Each	2745-
Cn-3371/1	Brake Drum	Leyland Dost Plus (5Hole)	2090-	Each	2715-
Cn-3401	Front Hub	Tata ACE	870-	Each	1130-
Cn-3420	Rear Hub	Mahindra - Jeep Diesel	1010-	Each	1315-
Cn-3421	Front Hub	Mahindra Bolero, Maxi Truck Plus	1770-	Each	2300-
Cn-3421/1	Rear Hub	Mahindra Bolero, Maxi Truck Plus	1810-	Each	2355-
Cn-3422	Front Hub Set	Scorpio S2 / S4 / S6 / S8 / S10	4470-	Each	5810-
Cn-3423	Front Hub	Mahindra Maximo	870-	Each	1130-
Cn-3471	Front Hub	Leyland Dost	1170-	Each	1520-
Cn-3471/1	Front Hub	Leyland Dost Plus	1690-	Each	2195-

SPINDLE - MAHINDRA & MAHINDRA

Cn-3521	Spindle Front	Utility Picup 4 x 4 (Double Brg - Ø41 - Long Coller)	730-	Each	950-
Cn-3521/1	Spindle Front	Maxxi Truck N/M (Single Brg - Ø40 - Solid)	710-	Each	925-
Cn-3522	Spindle Front	Jeep Picup (Double Brg - Ø41 - Solid)	730-	Each	950-
Cn-3523	Spindle Front	M & M Picup (Double Brg - Ø41 - Big Coller)	670-	Each	870-
Cn-3524	Spindle Rear	M & M Picup (Double Brg - Ø41 - Small Coller)	670-	Each	870-
Cn-3531	Front Axel	Utility Picup 4x4 10 - Teeth	810-	Each	1055-
Cn-3532	Axel Flange With Grove	Utility Picup 4x4 10 - Teeth	350-	Each	455-

EASY SEARCH TABLE FOR : HALF YOKE

Cross Fitting	Pipe Ø 2 ³ / ₈ "		Pipe Ø 2 ³ / ₄ "		Pipe Ø 3"		Pipe Ø 3 ¹ / ₂ "		Pipe Ø 4"		Pipe Ø 4 ¹ / ₂ "		Pipe Ø 4 ³ / ₄ "	
	Turn Ø 53mm		Turn Ø 63mm		Turn Ø 69 / 71		Turn Ø 84mm		Turn Ø 91 / 95		Turn Ø 100mm		Turn Ø 112mm	
	Cn-No.	L	Cn-No.	L	Cn-No.	L	Cn-No.	L	Cn-No.	L	Cn-No.	L	Cn-No.	L
D.Jeep (Cn-007)			792/2	85	792/1	85								
Tata 407 (Cn-005)	762	90												
30.2 x 92 (Cn-017)					817/2									
Canter (Cn-016)					757	93								
Tata 1210 (Cn-001)	762/1	120	802	120	821	120								
35 x 106 (Cn-024/1)					811/2	95	816/2	95						
Tusker (Cn-004)					896	105	872	105	984/2	107				
L/L - 370 (Cn-002)							984	115	984/4	125				
L/L Spicer (Cn-022)							984/3	15	972	128				
									972/1	135				
42 x 120 (Cn-029)							1022	120	1022/1	127				
							1022/2	130						
42 x 129 (Cn-033)							1032	120	1032/1	127				
									1032/2	140				
Tata 1312 (Cn-010)					842/1	135	842	135	1042/1	140				
Taurus L/T (Cn-019)							912	145	1062/9	135				
Taurus P/T (Cn-020)							922	145						
47.7 x 135 (Cn-019/1)									1305	153			1306	153
48 x 135 (Cn-034)									1062	135			1062/6	
48 x 154 (Cn-034/1)									1062/1	135				
4018 P/T (Cn-030)									1286	157				
Hippo P/T (Cn-032)									1052	130				
52 x 133 (Cn-039)									1212	183				
52 x 147 (Cn-038)									1242	150				
57 x 152 (Cn-041)									1252	162	1252/2	162	1251/1	152
													1262	152

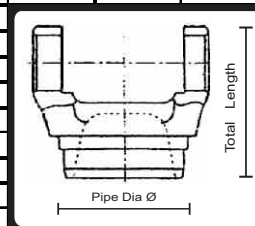

Misc. Interaxle Prop. Shaft Assly. Complete (Dully Balanced)

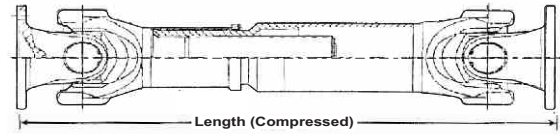

PART No.			DESCRIPTION				LIST	-	MRP
Interaxle Prop. Shaft Assembly			Dynamically		Balanced				
Cn-1030	Assly Interaxle 2518 Tipper	Cr.42x129	Rev.Y&B(Cn-1034/2)	Flange-4H.Ø6"	Serrated	Comp.Length 26"	15900-	Unit	25520-
Cn-1030 A	Assly Interaxle 2518 Tipper			Same Cn-1030	Except	Comp.Length 29"	16100-	Unit	20930-
Cn-1030/1	Assly Interaxle 2518 Tipper	Cr.42x129	Rev.Y&B(Cn-1034/1)	Flange-4H.Ø6"	Serrated	Comp.Length 23"	15700-	Unit	20410-
Cn-1030/2	Assly Interaxle 2516 Mixer	Cr.1312	Long Y&T(-996/2)	Flange-8H.Ø5"	Plain Base	Comp.Length 27"	11500-	Unit	14950-
Cn-1030/3	Assly Interaxle 2516		Same Cn-1030/2		Except	Comp.Length 31"	11700-	Unit	15210-
Cn-1060	Assly Interaxle 4921,2518 N/M	Cr.48x135	Rev.Y&B(Cn-1064)	Flange-4H.Ø7"	Serrated	Comp.Length 22"	16700-	Unit	21710-
Cn-1060 A	Assly Interaxle AMW,2518 N/M		Same Cn-1060		Except	Comp.Length 27"	16900-	Unit	21970-
Cn-1060 B	Assly Interaxle AMW,Maan,Volvo	Cr.48x135	Rev.Y&B(Cn-1064)	Flange-4H.Ø6"	Serrated	Comp.Length 25"	17100-	Unit	22230-
Cn-1060/1	Assly Interaxle L/L 2516 Tipper	Cr.L/L TC	Y&T(Cn-1083)	Flange-4H.Ø6"	Serrated	Comp.Length 25"	14700-	Unit	19110-
Cn-1060/2	Assly Interaxle L/L 2516 Tipper		Same Cn-1060/1		Except	Comp.Length 27"	14900-	Unit	19370-
Cn-1060/3	Assly Interaxle L/L 2516 Tipper		Same Cn-1060/1		Except	Comp.Length 31"	15100-	Unit	19630-
Cn-1085	Assly Interaxle 2516,2515 Ex	Cr.Tusker	Y&T(Cn-1082)	Flange-4H.Sq.	Plain Base	Comp.Length 29"	14700-	Unit	19110-
Cn-1085A	Assly Interaxle L/L 4921,2518 Ex		Same Cn-1085		Except	Comp.Length 25"	14300-	Unit	18590-
Cn-1085B	Assly Interaxle L/L 4921,2518 Ex		Same Cn-1085		Except	Comp.Length 27"	14500-	Unit	18850-
Cn-1085C	Assly Interaxle L/L 4921,2518 Ex		Same Cn-1085		Except	Comp.Length 31"	14900-	Unit	19370-
Cn-1110	Assly Interaxle AMW Spicer Sh.	Cr.L/L TC	Y&T (Cn-1113/1+1114/1)	Flange-4H.Ø6"	Serrated	Comp.Length 24"	15900-	Unit	20670-
Cn-1120	Assly Interaxle AMW Spicer Sh.	Cr.L/L TC	Rev.Y&FY (Cn-1122+1123)	Flange-4H.Ø6"	Serrated	Comp.Length 27"	16300-	Unit	21190-
Cn-1130	Assly Interaxle AMW RSB Sh.	Cr.42x129	Rev.Y&B(Cn-1034/1)	Flange-4H.Ø6"	Serrated	Comp.Length 23"	15500-	Unit	20150-
Cn-1130/1Db	Assly Interaxle AMW RSB Sh.	Cr.L/L TC	Rev.Y&FY(Cn-1135)	Flange-4H.Ø6"	Serrated	Comp.Length 25"	14500-	Unit	18850-
Cn-1240	Assly Interaxle Tata RSB	Cr.52x133	Rev.Y&B(Cn-1244)	Flange-4H.Ø7"	Serrated	Comp.Length 27"	22800-	Unit	29640-
TN-1255/4 Db	Assly Interaxle Tata Prima	Cr.57x147	Rev.Y&FY(TN-1254/4)	Flange-4H.Ø6"	Serrated	Length 24" Direct weld	20200-	Unit	26260-
Cn-1325 Db	Assly Interaxle Bharat Benz	Cr.47.7x135	Rev.Y&FY(Cn-1308/2)	Flange-4H.Ø6"	Serrated	Length 24" Direct weld	18200-	Unit	23660-
			(Cn-1302/1 + 019/1 + 1305 + Pipe Ø4" + 1308/2 + 019/1 + CN-1302/1)						
Cn-1325/1Db	Assly Interaxle Bharat Benz	Cr.47.7x135	Rev.Y&FY(Cn-1308/2)	Flange-4H.Ø6"	Serrated	Length 25" Direct weld	18500-	Unit	24050-
Cn-1325/2	Assly Interaxle Bharat Benz	Cr.47.7x135	Rev.Y&B(Cn-1308/2)	Flange-4H.Ø6"	Serrated	Length 26"	17600-	Unit	22880-
Cn-1325/3	Assly Interaxle Bharat Benz	Cr.47.7x135	Rev.Y&B(Cn-1308/1)	Flange-4H.Ø6"	Serrated	Length 29"	17900-	Unit	23270-

TERMS AND CONDITIONS

- All prices, listed here, are subjected to change without any notice and are subjected to the trade discounts.
- The prices mentioned here are the wholesale Prices and are exclusive of the prevailing taxes.
- Transit losses will be only in customer's account.
- All orders are subjected to our confirmation. We reserve the right to execute the order in full or part depending upon the stock availability.
- Disputes if any, will be subjected to the jurisdiction of Delhi Courts only.
- Should our bill remains uncleared after 30 days of despatch, interest at the rate of 18%, will be charged extra.
- The other manufacturer part no. are only for references
- For Customer care cell please contact on +91 9711 2111 24 / mantrycron@gmail.com

PART No.	DESCRIPTION		LIST	-	MRP
GEAR BOX RETAINERS (CHILLAM)					
Cn-3100	Gear Box Retainer	Tata Ace	450-	Each	585-
Cn-3101	Gear Box Retainer	Tata 407	590-	Each	765-
Cn-3102	Gear Box Retainer	Tata 608	670-	Each	870-
Cn-3103	Gear Box Retainer	with Oil Seal Tata 709	650-	Each	845-
Cn-3104	Gear Box Retainer	550 - GB Tata 1109 Ultra	690-	Each	895-
Cn-3104/1	Gear Box Retainer	950 - GB Tata Prima	2950-	Each	3835-
Cn-3107	Gear Box Retainer	Tata 1210	550-	Each	715-
Cn-3108	Gear Box Retainer	with Oil Seal GB - 40 Tata SE	670-	Each	870-
Cn-3110	Gear Box Retainer	with Oil Seal Tata 1613 TC	710-	Each	925-
Cn-3111	Gear Box Retainer	with Oil Seal GB - 60 Tata Hywa	510-	Each	665-
Cn-3114	Gear Box Retainer	Tata 2416	930-	Each	1210-
Cn-3115	Gear Box Retainer	with Oil Seal GB - 50 Tata 2515 TC/EX	650-	Each	845-
Cn-3116	Gear Box Retainer	with Oil Seal GB - 75 Tata TC	850-	Each	1105-
Cn-3116/1	Gear Box Retainer	with Oil Seal GB - 75 Long Tata TC - 1150	890-	Each	1155-
Cn-3121	Gear Box Retainer	L/L Cargo	590-	Each	765-
Cn-3122	Gear Box Retainer	Leyland 370	630-	Each	820-
Cn-3123	Gear Box Retainer	Tusker - Mark II	690-	Each	895-
Cn-3124	Gear Box Retainer	Short Pipe Leyland ZF	1050-	Each	1365-
Cn-3124/1	Gear Box Retainer	Long Pipe Leyland ZF	1130-	Each	1470-
Cn-3125	Gear Box Retainer	9 Speed Gear Box L/L 4921 - Ace Container	1650-	Each	2145-
Cn-3125/1	Gear Box Retainer	6 Speed Gear Box L/L ZF Round	1490-	Each	1935-
Cn-3141	Gear Box Retainer	EATON AMW	1670-	Each	2170-



SHADED LINES ARE NEW - ADDITIONS

WARRANTY

WE WILL REPLACE, WITHOUT ANY EXTRA COST, PRODUCT DEFECTIVE DUE TO WORKMANSHIP OR RAW MATERIAL, PROVIDED NO MISHANDLING HAS TAKEN PLACE.

Our Stockist

Welcome at www.cenron.org

Mfd. By:- CENRON AUTO IMPEX, ANAND PARBAT, N.DELHI - 110005 (INDIA)