



### Easily confirm flow of liquids

SIGMAMOTOR Visual Flow Indicators will enhance your feed systems by allowing visual indication of the flow of liquid in the system.

The Visual Flow Indicator allows for viewing of flow through a clear NSF61 approved PVC or glass flow tube.

- CNC precision machined ends
- Clear sight tube
- NSF-61 approved materials
- 100-psi maximum pressure rating
- Available in PVC or glass with protective cover
- Glass end caps available in PVC, Polypropylene, CPVC, PTFE, Kynar® PVDF, 316SS, Alloy 20 or Hastelloy C276



### Typical System Block Diagram

#### END CAP CONNECTIONS



End caps are permanently attached to the top of the PVC indicators and are removable on the glass indicators. They are available with NPT, socket, flanged or union connections.

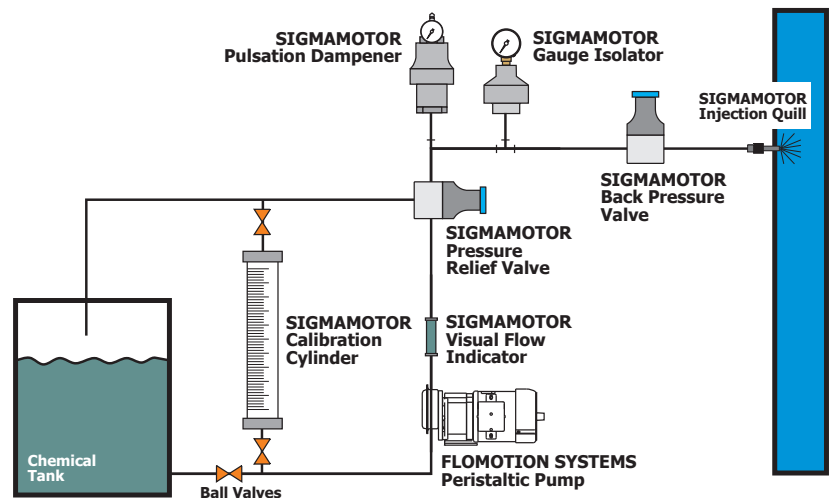

VFI:      -      -      -       
           1      2      3\*   4\*

\* Glass Only

**Glass Example: VFI-G-N-P-V**  
**PVC Example: VFI-P-N**

<b>TYPE 1</b>		
SELECT:	<b>G</b> (GLASS)	<b>P</b> (PVC)
A-Height (in)	8.75	4
B-Diameter (in)	2.5	1.5
C-Connection (in)	1/2	1/2

<b>PROCESS CONNECTION TYPE 2</b>	
NPT	<b>N</b>
SOCKET	<b>S</b>
FLANGED	<b>F</b>
UNION	<b>U</b>

<b>PROCESS CONNECTION MATERIAL FOR GLASS ONLY 3</b>	
PVC	<b>P</b>
POLYPROPYLENE	<b>PP</b>
CPVC	<b>CP</b>
PTFE	<b>T</b>
Kynar® PVDF	<b>K</b>
316 SS	<b>S</b>
ALLOY 20	<b>A</b>
HASTELLOY C276	<b>H</b>

<b>O-RING MATERIAL FOR GLASS ONLY 4</b>	
VITON	<b>V</b>
EPDM	<b>E</b>
TEFLON ENCAPSULATED	<b>T</b>

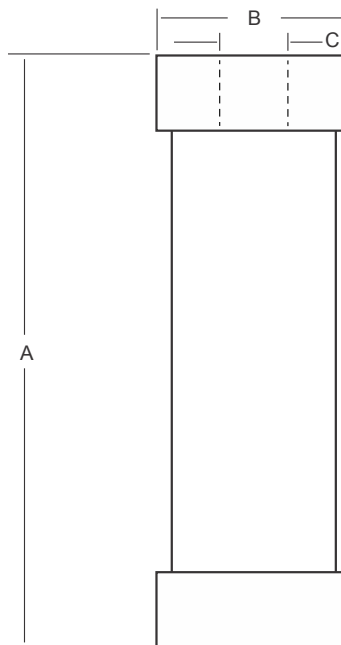

**FLOMOTION SYSTEMS Inc.**  
 165 Creekside Drive, Suite 112  
 Buffalo NY 14228-2103  
 Tel: 716-691-3941  
 Fax: 716-691-1253  
 Email: [info@flomotionsystems.com](mailto:info@flomotionsystems.com)  
[www.flomotionsystems.com](http://www.flomotionsystems.com)

