

# COMBINED JUDGING PROGRAM



**FEBRUARY 8, 9, 10 & 11, 2024**

**DALLAS MARKET HALL**

**2200 STEMMONS FRWY., DALLAS, TX 75207**

**SHOW HOURS (THURSDAY): 8:00 A.M. - 10:00 P.M. EXCEPT**

**SAINT BERNARDS - SHOW #1 8:00 A.M. - 8:00 P.M. & SHOW #2 10:00 A.M. - 10:00 P.M.**

**SHOW HOURS (FRIDAY - SUNDAY): 7:00 A.M. - 7:00 P.M.**

**THESE SHOWS WILL BE HELD INDOORS**

- OVER 170,000 SQ. FT. OF SPACE ALL ON ONE LEVEL • THREE DAYS OF ALL BREED SHOWS •
- ONE DAY OF MULTIPLE INDEPENDENT SPECIALTIES • FREE & RESERVED RV PARKING •
- FREE RV & GENERAL PARKING •
- AKC NATIONAL OWNER-HANDLED SERIES – ALL THREE DAYS •

*Stay up to date on our shows by visiting our website:*

**[www.LoneStarStateClassic.com](http://www.LoneStarStateClassic.com)**

LIKE US ON FACEBOOK: <https://www.facebook.com/LoneStarStateClassic>

FOLLOW US ON TWITTER: @DallasDogShows



**PURINA IS THE OFFICIAL  
SPONSOR OF THESE EVENTS**



**American  
Heart  
Association.**



***Saturday will be "Heart Day"***  
celebrating the 100th Anniversary of the  
American Heart Association  
as well as Valentine's Day.

***Please wear Red to the event on Saturday and  
make a donation to the AHA.***

When you donate to the American Heart Association, you are joining the fight against our nation's No. 1 and No. 5 killers – heart disease and stroke. Your donation helps fund lifesaving research, advocate for healthier communities, improve patient care, and work for equitable health for all people. The Association's Healthy Bond for Life™ initiative promotes the many cardiovascular health benefits of pet companionship – including increased physical activity, reduced stress and lower blood pressure.

Please use this QR code to make your donation.



***Sunday will be "Jersey Day"***  
***in celebration of the Super Bowl.***

***Please wear a Sports Jersey***

to support your favorite team - football, hockey, soccer, etc at every level (pro, college, high school, etc).

Just dress somewhat relaxed for a fun day at the dog show on Super Bowl Sunday.



***Congratulations to  
Greater Collin Kennel Club  
celebrating their  
50th Anniversary  
on Friday!!***

**NOTE:**

**To find out about any AKC event cancellations call the AKC Event Cancellation Hotline (877) 252-3229.**

**THE CLUBS AND THEIR SUPERINTENDENT** caution all persons entering the show site and show grounds against all hazards which may exist, including, but not limited to: Condition of the site/grounds, parking/loading/unloading areas, entrances, floors and stairways, elevators and escalators, floor coverings, walkways, tenting/canopies, electrical appliances, cords and fittings, exercise pens, and the presence of animals. All persons should take into consideration this is a sporting event and dress, act and exercise caution appropriate for the activity involved. All persons entering the show, the grounds, site and show areas for whatever purpose do so entirely at their own risk. By virtue of entering the show, the entrant has indicated their acceptance of the terms listed in the premium list and assumes all risks involved.

## TABLE OF CONTENTS

Lone Star State Classic Combined Specialties .....	5 - 8
<i>Judges</i> .....	9
<i>4 &amp; Under 6 Months Puppy Competitions</i> .....	6 & 8
All Breed Dog Shows	
All-Breed Clubs Combined Index .....	10 - 13
<i>Judges</i> .....	31
Greater Collin Kennel Club, Inc. ....	15 - 19
Texas Kennel Club, Inc. ....	21 - 25
Trinity Valley Kennel Club, Inc. ....	27 - 31
Accommodations .....	34
Directions.....	35

---

### EMERGENCY PHONE NUMBER

Larry Abbott, LSSC Chair (972) 740-4881 Cell Phone

**THERE WILL BE AN EMT AT THE SHOW SITE DURING SHOW HOURS EACH DAY.**  
An Automated External Defibrillator (AED) is on the show grounds and is located with the EMT.

### OFFICIAL PHOTOGRAPHER

Melia Photography  
7613 S. 72nd Ave., LaVista, NE 68128 (402) 331-5071  
Select & purchase pictures on the website: meliaphotography.com

### SHOW VETERINARIAN (ON CALL) 24 HOUR EMERGENCY VETERINARIAN

VCA Metroplex Animal Hospital  
700 West Airport Frwy., Irving, TX (972) 438-7113  
[www.vcahospitals.com/metroplex](http://www.vcahospitals.com/metroplex)

**Directions to VCA Animal Hospital:** Take I-35 from Market Hall North to Hwy 183 West (Airport Frwy.). Exit at MacArthur. Loop underneath the freeway & head eastbound on the access road on the opposite side. Clinic is a free-standing building with blue trim just past the Wells Fargo Building on the right.

***“Exhibitors should follow their veterinarian's recommendation to assure their dogs are free of internal and external parasites, any communicable diseases, and have appropriate vaccinations.”***

---

***No dogs that are disqualified for aggression will be allowed to enter these shows, nor be allowed to be on the grounds. In addition, no aggression reinstatement procedures will be performed at these shows.***

**EQUIPMENT & SERVICE FURNISHED BY:**

**MB-F Inc.**

620 Industrial Ave. • P.O. Box 22107 • Greensboro, NC 27420 • 336-379-9352  
32351 Edward Ave. • P.O. Box 9999 • Madison Hts., MI 48071 • 248-588-5000  
FAX - 336-272-0864 • Internet Address <http://www.infodog.com>  
E-Mail Address [mbf@infodog.com](mailto:mbf@infodog.com)

AMERICAN KENNEL CLUB ANNUALLY LICENSED SUPERINTENDENT  
Member of the Dog Show Superintendents Association • [dogshowsupers.org](http://dogshowsupers.org)

*"Please feel free to come by and take a tour of our Headquarters Office in NC any business day Mon. thru Fri., 9:00 A.M. to 4:00 P.M."*

# Lone Star State Classic Dog Shows Dallas Market Hall -- Dallas, Texas February 2024

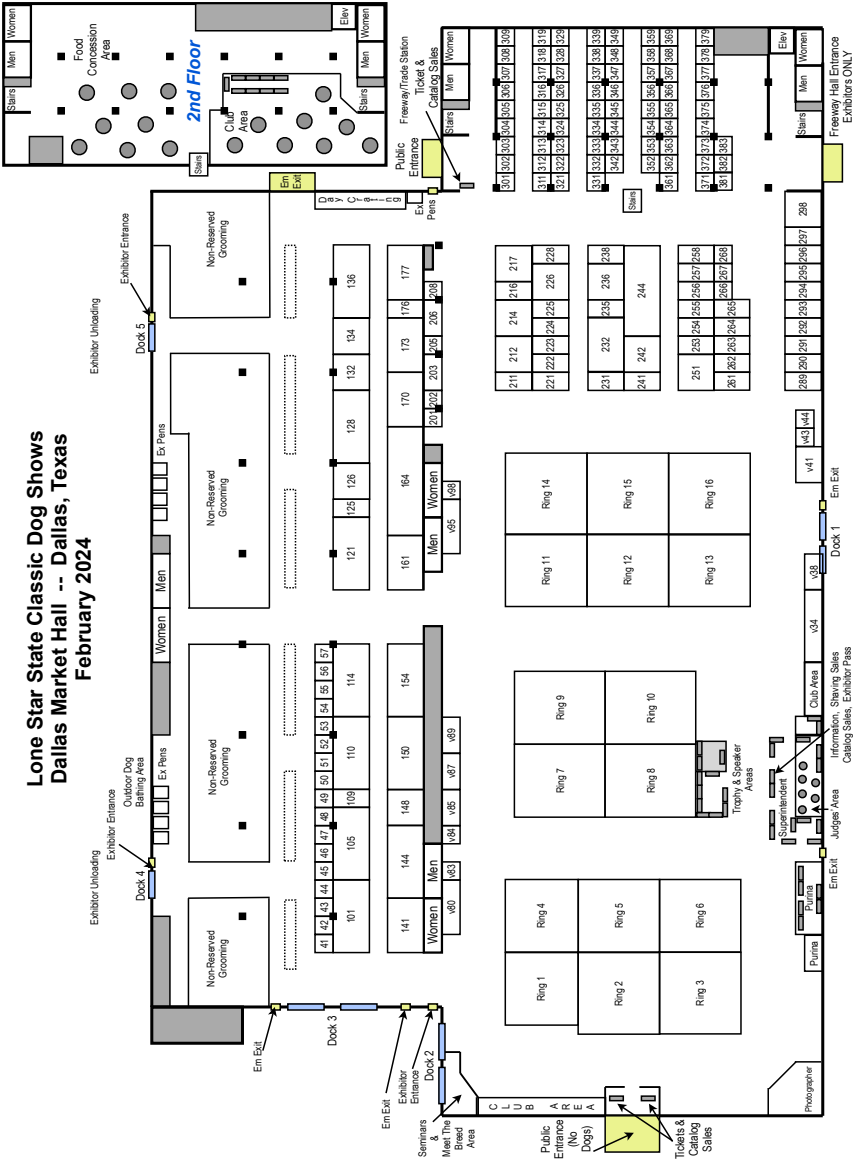

Group & Specialty Shows  
(Unbenched)

## LONE STAR STATE CLASSIC



### COMBINED SPECIALTIES

All clubs are Licensed by the American Kennel Club.

- Dal-Tex Basset Hound Club** Specialty - 2024074101
- North Texas Saint Bernard Club** Specialty #1 - 2024071201
- North Texas Saint Bernard Club** Specialty #2 - 2024071202
- North Texas Terrier Club** Group Show - 2024654502
- and 4 & Under 6 Month Puppy Competition - 2024654503
- Dallas-Ft. Worth Toy Dog Club, Inc.** Group Show - 2024502103
- Cavalier King Charles Spaniel Club of North Texas** Specialty - 2024688802
- and 4 & Under 6 Month Puppy Competition - 2024688801
- Pekingese Club of Texas** Specialty - 2024077802
- Trinity Valley Shih Tzu Club** Specialty - 2024116402
- North Texas Boston Terrier Club, Inc.** Specialty - 2024187302
- North Texas Chow Chow Club, Inc.** Specialty - 2024142901
- Lone Star Poodle Club** Specialty - 2024070101
- Bluebonnet Cardigan Welsh Corgi Club, Inc.** Specialty - 2024134803

**THURSDAY, FEBRUARY 8, 2024**  
**DALLAS MARKET HALL**  
**2200 STEMMONS FRWY., DALLAS, TX 75207**

**SHOW HOURS: 8:00 A.M. - 10:00 P.M. EXCEPT**  
**SAINT BERNARDS - SHOW #1 8:00 A.M. - 8:00 P.M. & SHOW #2 10:00 A.M. - 10:00 P.M.**  
**THESE SHOWS WILL BE HELD INDOORS**

### PROGRAM OF JUDGING

There are 582 dogs in these Combined Specialty Shows with a total entry of 633 in 59 different Breeds or Varieties, including 7 4-6 Month Puppies. For your convenience, the following division of sexes has been carefully tabulated; however, neither the Club nor the Superintendent/Show Secretary assumes responsibility for absolute accuracy.

In accordance with Chapter 7, Section 8, of "Rules Applying to Dog Shows" and with American Kennel Club Approval the following changes apply:

<b>Breed</b>	<b>TRINITY VALLEY SHIH TZU CLUB</b>	<b>New Judge</b>
Shih Tzu	<u>Original Judge</u> *Mr. Cleidith M. Wakefield	Mrs. Nancy D. Simmons

The number before each Breed (Variety) indicates the number of dogs entered in that Breed (Variety). The numbers following each Breed (Variety) indicate the number of Regular Class Dogs, Regular Class Bitches, Best of Breed (Variety) (Dogs-Bitches), and Non-Regular Class Dogs or Bitches.

### NORTH TEXAS TERRIER CLUB

#### RING ONE

**JUDGE: Ms. Gay Glazbrook**

#### 9:00 AM

- 1 Bull Terriers (Colored) Sweepstakes (0-1)
- 2 Bull Terriers (White) Sweepstakes (0-2)
- 1 American Staffordshire Terriers Sweepstakes (0-1)
- 1 Rat Terriers Sweepstakes (0-1)
- 2 Manchester Terriers (Standard) Sweepstakes (0-2)
- 2 Russell Terriers Sweepstakes (1-1)
- 2 Cesky Terriers Sweepstakes (0-2)
- 4 American Hairless Terriers Sweepstakes (1-3)

15 Total Dogs

#### RING ONE

**JUDGE: Mr. Rick Fowler**

#### 9:45 AM

##### Specialty

- 1 Fox Terriers (Smooth) Sweepstakes (1-0)

##### Specialty

- 2 Fox Terriers (Wire) Sweepstakes (0-2)
- 1 West Highland White Terriers Sweepstakes (0-1)

#### Junior Showmanship Competition

- 4 \*Open
- \*Best Junior Handler

8 Total Dogs

#### RING TWO

**JUDGE: Mrs. Vicki L. Abbott**

#### 9:20 AM

- 2 Norfolk Terriers 0-0-(2-0)
- 2 Border Terriers 0-1-(1-0)
- 5 Cairn Terriers 1-1-(1-2)
- 14 Norwich Terriers 4-7-(1-2)

#### 10:15 AM

- 1 Lakeland Terriers 0-1-(0-0)
- 3 Miniature Bull Terriers 0-2-(1-0)
- 1 Irish Terriers 0-0-(1-0)
- 2 Kerry Blue Terriers 0-0-(2-0)
- 3 Soft Coated Wheaten Terriers 0-2-(0-1)
- 3 Staffordshire Bull Terriers 0-1-(0-2)
- 7 American Staffordshire Terriers 3-2-(1-1)
- 6 Airedale Terriers 3-2-(1-0)

#### 11:15 AM

##### Specialty

- 8 Fox Terriers (Smooth) 2-1-(2-2)-1

##### Specialty

- 8 Fox Terriers (Wire) 0-2-(4-2)
- 4 Russell Terriers 1-2-(1-0)
- 12 Scottish Terriers 2-5-(3-2)

#### 12:30 PM

Lunch

#### 1:15 PM

- 1 Sealyham Terriers 0-1-(0-0)
- 1 Skye Terriers 0-0-(1-0)
- 3 Manchester Terriers (Standard) 0-2-(1-0)
- 13 West Highland White Terriers 5-3-(2-3)

99 Total Dogs

#### RING THREE

**JUDGE: Ms. Jane M. Engemann**

#### 9:20 AM

- 6 \*Bull Terriers (Colored) 2-1-(1-2)
- 7 \*Bull Terriers (White) 1-5-(0-1)
- 3 \*Bedlington Terriers 1-0-(1-1)
- 4 \*Rat Terriers 0-1-(2-1)
- 4 \*Cesky Terriers 0-2-(1-1)

#### 10:30 AM

- 1 \*Dandie Dinmont Terriers 0-0-(0-1)
- 12 \*Miniature Schnauzers 4-1-(4-3)
- 15 \*American Hairless Terriers 5-6-(3-1)

### NORTH TEXAS TERRIER CLUB 4-6 MONTHS PUPPY

#### RING THREE

**JUDGE: Ms. Jane M. Engemann**

#### 12:00 NOON

- 1 American Hairless Terriers
- 2 Fox Terriers (Wire)
- Best 4-6 Month Puppy Terrier**

55 Total Dogs

#### RING TWO

**2:00 PM**

Terrier Sweepstakes Group.....	Ms. Gay Glazbrook
Owner-Handled Terrier Group .....	Mr. Rick Fowler
Terrier Group .....	Mrs. Vicki L. Abbott

**DAL-TEX BASSET HOUND CLUB****RING FOUR****JUDGE:** Mrs. Sulie Greendale-Paveza**2:00 PM**

Specialty

7 Basset Hounds 1-2-(4-0)

7 Total Dogs

**NORTH TEXAS ST. BERNARD CLUB #1****RING SIX****JUDGE:** Ms. Cindy J. Valko**1:00 PM****Junior Showmanship Competition**

1 \*Open

\*Best Junior Handler

Specialty

18 Saint Bernards 6-7-(3-2)

1 Veteran Dog

20 Total Dogs

**NORTH TEXAS ST. BERNARD CLUB #2****RING SIX****JUDGE:** Ms. Nancy E. Ridgway**4:00 PM**

Specialty

6 Saint Bernards Sweepstakes (3-3)

6 Total Dogs

**RING SIX****JUDGE:** Ms. Sandra K. Nadalin**4:30 PM**

Specialty

18 Saint Bernards 5-7-(4-2)

1 Veteran Dog

19 Total Dogs

**BLUEBONNET CARDIGAN WELSH CORGI CLUB****RING SEVEN****JUDGE:** Mr. Russell Allen**10:00 AM**

Specialty

13 Cardigan Welsh Corgis Sweepstakes (1-12)

1 Cardigan Welsh Corgis Veteran Sweepstakes (0-1)

14 Total Dogs

**RING SEVEN****JUDGE:** Ms. Peggy Beisel-Mcllwaine**10:45 AM**

Specialty

28 Cardigan Welsh Corgis 5-9-(5-9)

1 Veteran Bitch

See Ring 16 at 1:15 PM for balance of assignment.

**NORTH TEXAS BOSTON TERRIER CLUB****RING NINE****JUDGE:** Mrs. Kimberly (Kim) Rutherford**1:00 PM**

Specialty

1 Boston Terriers Sweepstakes (1-0)

1 Total Dogs

**RING NINE****JUDGE:** Mr. Chad Howard**1:15 PM****Junior Showmanship Competition**

1 Open

Best Junior Handler

Specialty

16 Boston Terriers 3-6-(3-4)

17 Total Dogs

**LONE STAR POODLE CLUB****RING TEN****JUDGE:** Mrs. Louise Cunningham**(There will be a 15 minute break between varieties)****12:00 NOON**

Specialty

10 Poodles (Toy) 5-2-(2-1)

Specialty

4 Poodles (Miniature) 1-1-(1-1)

Specialty

19 Poodles (Standard) 6-6-(5-2)

33 Total Dogs

**DALLAS-FT. WORTH TOY DOG CLUB****RING ELEVEN****JUDGE:** Mr. David Fitzpatrick**9:00 AM****Junior Showmanship Competition**

2 Open

1 Master

Best Junior Handler

9 Chinese Cresteds 1-1-(3-4)

11 Japanese Chin 2-4-(4-1)

**10:00 AM**

19 Italian Greyhounds 6-6-(5-2)

**10:45 AM**

14 Russian Toys 6-3-(3-2)

14 Havanese 5-5-(1-3)

15 Pekingese 5-6-(2-2)

85 Total Dogs

**RING TWELVE****JUDGE:** Dr. John V. Iola**9:00 AM**

2 English Toy Spaniels (KC &amp; R) 0-1-(0-1)

5 Chihuahuas (Smooth Coat) 1-2-(1-1)

10 Chihuahuas (Long Coat) 3-4-(1-2)

13 Pugs 2-3-(6-2)

**DALLAS-FT. WORTH TOY DOG CLUB (CONT.)**

**10:15 AM**

- 5 English Toy Spaniels (B & PC) 1-2-(1-1)
- 6 Brussels Griffons 2-3-(1-0)
- 21 Pomeranians 7-7-(5-2)

**11:30 AM**

Lunch

**12:15 PM**

- 10 Maltese 3-5-(2-0)
- 29 Cavalier King Charles Spaniels 6-15-(5-3)
- 101 Total Dogs

**RING FOURTEEN**

**JUDGE: Mrs. Wendy Paquette**

**9:00 AM**

- 1 Manchester Terriers (Toy) 0-0-(1-0)
- 3 Affenpinschers 0-0-(2-1)
- 14 Papillons 2-4-(5-3)

**9:45 AM**

- 5 Toy Fox Terriers 3-0-(1-1)
- 6 Miniature Pinschers 1-2-(2-1)
- 4 Biewer Terriers 1-0-(0-3)
- 6 Shih Tzu 1-3-(2-0)
- 11 Yorkshire Terriers 5-4-(1-1)

See Ring 14 at 3:15 PM for balance of assignment.

**RING ELEVEN  
1:45 PM**

Bred by Exhibitor Toy Group..... Mrs. Wendy Paquette  
 Owner-Handled Toy Group..... Dr. John V. Iola  
 Toy Group..... Mr. David Fitzpatrick

**CAVALIER KING CHARLES SPANIEL CLUB  
OF NORTH TEXAS 4-6 MONTHS PUPPY**

**RING ELEVEN**

**JUDGE: Mr. Cesar Cortes**

**3:45 PM**

- 4 Cavalier King Charles Spaniels

**CAVALIER KING CHARLES SPANIEL CLUB  
OF NORTH TEXAS**

**RING ELEVEN**

**JUDGE: Mr. Cesar Cortes**

**4:00 PM**

Specialty

- 31 Cavalier King Charles Spaniels 8-17-(4-2)
- 1 Veteran Dog
- 1 Veteran Bitch
- 37 Total Dogs

**PEKINGESE CLUB OF TEXAS**

**RING FOURTEEN**

**JUDGE: Mrs. Wendy Paquette**

Continuation of assignment from 9:45 AM

**3:15 PM**

Specialty

- 17 Pekingese 6-6-(3-2)
- 67 Total Dogs

**TRINITY VALLEY SHIH TZU CLUB**

**RING FIFTEEN**

**JUDGE: Mrs. Nancy D. Simmons**

**3:30 PM**

Specialty

- 8 Shih Tzu 1-4-(3-0)
- 8 Total Dogs

**NORTH TEXAS CHOW CHOW CLUB**

**RING SIXTEEN**

**JUDGE: Ms. Mary Harris**

**1:00 PM**

Specialty

- 3 Chow Chows Sweepstakes (2-1)
- 3 Total Dogs

**RING SIXTEEN**

**JUDGE: Ms. Peggy Beisel-McIlwaine**

Continuation of assignment from Ring 7 at 10:45 AM

**1:15 PM**

Specialty

- 9 Chow Chows 2-2-(4-1)
- 38 Total Dogs





### COMBINED SPECIALTY JUDGES

Mrs. Vicki L. Abbott .....	1060 Pecan Dr., Fairview, TX 75069
Mr. Russell Allen .....	10420 Carry Back Cir., Dallas, TX 75229
Ms. Peggy Beisel-McIlwaine .....	6225 N. Maple Rd., Ann Arbor, MI 48105
Mr. Cesar Cortes .....	30 West St. Apt. 25F, New York, NY 10004
Mrs. Louise Cunningham .....	Cransbrook Bungalow, Blind Ln., Ashford, Kent, UKG TN25 7HB
Ms. Jane M. Engemann .....	2726 N.W. 34th St., Lawton, OK 73505
Mr. David Fitzpatrick .....	2151 Baltimore Pike, East Berlin, PA 17316
Mr. Rick Fowler .....	2412 Carmel Dr., Carrollton, TX 75006
Ms. Gay Glazbrook .....	4410 Garden Dr., Arlington, TX 76001
Mrs. Sulie Greendale-Paveza .....	6715 Deleon Ave., Fort Pierce, FL 34951
Ms. Mary Harris .....	6811 Highland Crest Ln., Sachse, TX 75068
Mr. Chad Howard .....	P.O. Box 227, Damascus, MD 20872
Dr. John V. Iola .....	236 Windsor Dr., Hurley, NY 12443
Ms. Sandra K. Nadalin .....	5727 Biggett Rd., London, OH 43140
Mrs. Wendy Paquette .....	7105 Hwy. 160 E., Henryville, IN 47126
Ms. Nancy E. Ridgway .....	1446 N. Buckner Blvd., Dallas, TX 75218
Mrs. Kimberly (Kim) Rutherford .....	120 County Rd. 947, Teague, TX 75860
Mrs. Nancy D. Simmons .....	3804 Simmons Creek Ln., Flower Mound, TX 75022
Ms. Cindy J. Valko .....	2561 Wickline Rd., Gibsonsia, PA 15044

**\*PROVISIONAL/PERMIT JUDGE - SEE ASSIGNMENTS**

**IMPORTANT** - TRANSFERS of dogs from regular classes to Best of Breed/Variety Competition (Ch. 11 Section 6, AKC Rules) MUST be made to the Superintendent/Show Secretary at least one half hour prior to the start of any regular conformation judging at this show. TRANSFERS by Junior Handlers from Novice to Open Class or from the Open to Master Class MUST be made to the Superintendent/Show Secretary prior to the judging of the class at the show. SUBSTITUTIONS of Junior Showmanship dogs must be made prior to the judging of the class at the show.

## AKC SANCTIONED 4 & UNDER 6 MONTHS PUPPY COMPETITION NORTH TEXAS TERRIER CLUB - THURSDAY CAVALIER KING CHARLES SPANIEL CLUB OF NORTH TEXAS - THURSDAY

This is a recorded event by the AKC for the Certificate of Merit and Puppy of Achievement certificates.

Section 1 - Classifications

The Four-to-Six Month Puppy competition shall be for dogs that are four months of age and over, but under six months on the first day of the event.

Section 2 - Entry and Eligibility

For additional information on entry and eligibility requirement, please see the Sanctioned Four-to-Six Month (Beginner Puppy) Competition Regulations available on the AKC website at:

[https://images.akc.org/pdf/rulebooks/Sanctioned\\_Regulations\\_4-6\\_Month\\_POA.pdf](https://images.akc.org/pdf/rulebooks/Sanctioned_Regulations_4-6_Month_POA.pdf)

**NO PUPPIES UNDER THE AGE OF SIX (6) MONTHS, EXCEPT THOSE PARTICIPATING IN THE 4-6 MONTH PUPPY COMPETITIONS, MAY BE ON THE GROUNDS.**

**APPLIES TO ALL FOUR DAYS**



**ALL PURINA PRO PLAN AWARDS, IF NOT PRESENTED IN THE RING, MUST BE PICKED UP DURING THE EVENT AT THE PRO PLAN BOOTH. PRESENTATION OF THE WINNING RIBBON IS REQUIRED. PRO PLAN RESERVES THE RIGHT TO MAKE AWARD SUBSTITUTIONS OF EQUAL OR GREATER VALUE IN THE EVENT A LISTED AWARD IS NOT AVAILABLE.**

**4067 Greater Collin Kennel Club, Inc., Friday - February 9, 2024**  
**082 Texas Kennel Club, Inc., Saturday - February 10, 2024**  
**401 Trinity Valley Kennel Club, Inc., Sunday - February 11, 2024**

This index has been prepared to enable exhibitors to (1) identify the Ring(s) in which their Breed(s) is (are) to be judged and (2) have an approximation of the number of dogs entered. The entry figures are not to be taken as a representation on the part of the Superintendent/Show Secretary that all dogs entered will be present on the Show day.

	<b>Friday</b>	<b>Saturday</b>	<b>Sunday</b>
	<b>RING TIME</b>	<b>RING TIME</b>	<b>RING TIME</b>
Affenpinschers	6 9:00 AM	4 10:45 AM	12 8:00 AM
Afghan Hounds	6 10:00 AM	10 11:30 AM	1 9:15 AM
Airedale Terriers	2 10:45 AM	5 8:00 AM	2 8:45 AM
Akitas	7 9:45 AM	9 11:00 AM	6 9:15 AM
Alaskan Malamutes	7 9:45 AM	13 8:00 AM	6 9:15 AM
American Eskimo Dogs	15 9:00 AM	14 10:15 AM	4 9:45 AM
American Hairless Terriers	2 8:00 AM	13 11:30 AM	11 8:00 AM
American Staffordshire Terriers	2 8:00 AM	14 10:15 AM	11 9:45 AM
Anatolian Shepherd Dogs	7 9:45 AM	9 11:00 AM	6 9:15 AM
Australian Cattle Dogs	8 8:00 AM	2 8:00 AM	14 8:00 AM
Australian Shepherds	8 8:45 AM	3 10:45 AM	14 8:00 AM
Basenjis	10 9:30 AM	6 8:00 AM	5 8:00 AM
Basset Hounds	5 12:30 PM	6 10:30 AM	1 9:15 AM
Beagles, 13 Inch	9 10:30 AM	6 9:15 AM	15 1:00 PM
Beagles, 15 Inch	9 9:30 AM	6 8:00 AM	15 1:00 PM
Bearded Collies	8 10:00 AM	3 9:30 AM	14 11:15 AM
Beaucerons	8 8:00 AM	2 8:00 AM	14 9:15 AM
Bedlington Terriers	2 9:45 AM	13 9:30 AM	11 10:45 AM
Belgian Malinois	1 9:00 AM	3 8:00 AM	6 9:15 AM
Belgian Sheepdogs	1 9:00 AM	15 10:45 AM	6 10:15 AM
Belgian Tervuren	1 9:00 AM	15 10:45 AM	6 10:15 AM
Berger Picards	1 9:00 AM	16 11:15 AM	13 8:00 AM
Bernese Mountain Dogs	3 10:30 AM	5 9:15 AM	6 11:30 AM
Bichons Frises	15 9:00 AM	13 11:30 AM	4 9:45 AM
Biewer Terriers	5 12:30 PM	4 10:45 AM	11 10:45 AM
Black Russian Terriers	7 9:45 AM	9 10:00 AM	6 10:15 AM
Bloodhounds	9 8:00 AM	6 10:30 AM	5 8:00 AM
Boerboels	11 9:00 AM	8 8:45 AM	6 9:15 AM
Border Collies	1 8:00 AM	15 12:30 PM	5 9:00 AM
Border Terriers	2 8:00 AM	14 9:00 AM	11 8:00 AM
Borzoi	5 12:30 PM	6 10:30 AM	1 9:15 AM
Boston Terriers	5 8:45 AM	13 8:00 AM	4 8:00 AM
Bouvier des Flandres	1 11:15 AM	3 11:45 AM	13 10:45 AM
Boxers	3 8:30 AM	3 8:00 AM	3 9:00 AM
Bracchi Italiani	9 9:30 AM	5 8:00 AM	15 8:00 AM
Briards	1 11:15 AM	3 10:45 AM	13 10:45 AM
Brittanys	9 9:30 AM	16 11:15 AM	14 9:15 AM
Brussels Griffons	4 8:00 AM	4 10:45 AM	5 9:00 AM
Bull Terriers (Colored)	2 8:00 AM	13 8:00 AM	11 9:45 AM
Bull Terriers (White)	2 8:00 AM	13 8:00 AM	11 9:45 AM
Bulldogs	13 9:15 AM	9 10:00 AM	9 9:45 AM
Bullmastiffs	3 8:30 AM	8 8:45 AM	3 8:00 AM
Cairn Terriers	16 9:00 AM	5 9:15 AM	16 8:00 AM
Canaan Dogs	1 10:00 AM	2 8:00 AM	13 8:00 AM
Cane Corsos	3 9:30 AM	3 9:30 AM	3 9:00 AM
Cardigan Welsh Corgis	12 11:00 AM	12 8:00 AM	13 9:15 AM

	Friday		Saturday		Sunday	
	RING	TIME	RING	TIME	RING	TIME
Cavalier King Charles Spaniels	5	10:00 AM	4	9:30 AM	11	8:00 AM
Cesky Terriers	14	10:00 AM	5	10:15 AM	16	8:00 AM
Chihuahuas (Long Coat)	4	8:00 AM	14	9:00 AM	5	10:15 AM
Chihuahuas (Smooth Coat)	4	8:00 AM	14	9:00 AM	5	10:15 AM
Chinese Cresteds	5	8:45 AM	4	8:00 AM	9	9:45 AM
Chinese Shar-Pei	16	8:00 AM	10	8:00 AM	4	8:00 AM
Chow Chows	16	8:00 AM	11	10:30 AM	4	8:00 AM
Cirnechi dell'Etna	9	9:30 AM	6	10:30 AM	1	9:15 AM
Collies (Rough)	8	10:00 AM	12	10:30 AM	5	10:15 AM
Collies (Smooth)	8	8:00 AM	12	10:30 AM	5	9:00 AM
Cotons de Tulear	15	11:15 AM	13	11:30 AM	16	9:00 AM
Dachshunds (Longhaired)	9	10:30 AM	6	9:15 AM	1	8:00 AM
Dachshunds (Smooth)	9	10:30 AM	6	9:15 AM	1	8:00 AM
Dachshunds (Wirehaired)	9	10:30 AM	6	9:15 AM	1	8:00 AM
Dalmatians	15	8:00 AM	13	8:00 AM	16	8:00 AM
Dandie Dinmont Terriers	14	10:45 AM	5	10:15 AM	16	8:00 AM
Danish-Swedish Farmdogs	14	9:00 AM	4	9:30 AM	10	9:00 AM
Doberman Pinschers	8	10:00 AM	8	10:00 AM	7	10:30 AM
Dogo Argentinos	3	8:00 AM	3	8:00 AM	3	8:00 AM
English Foxhounds	6	8:00 AM	10	8:00 AM	5	8:00 AM
English Toy Spaniels (B & PC)	6	9:00 AM	4	10:45 AM	12	9:00 AM
English Toy Spaniels (KC & R)	6	9:00 AM	4	10:45 AM	12	8:00 AM
Finnish Spitz	15	11:15 AM	13	10:30 AM	16	9:00 AM
Fox Terriers (Smooth)	2	8:00 AM	13	1:15 PM	11	10:45 AM
Fox Terriers (Wire)	2	9:45 AM	13	1:15 PM	11	10:45 AM
Fox Terriers (Wire) SWP			13	1:00 PM		
French Bulldogs	13	9:15 AM	9	8:00 AM	9	8:00 AM
German Pinschers	3	10:30 AM	8	8:45 AM	6	9:15 AM
German Shepherd Dogs	1	8:00 AM	16	11:15 AM	13	8:00 AM
Giant Schnauzers	3	9:30 AM	5	9:15 AM	6	9:15 AM
Grand Basset Griffon Vendeens			10	8:00 AM	5	10:15 AM
Great Danes	7	8:45 AM	15	9:15 AM	7	8:00 AM
Great Pyrenees	8	10:00 AM	9	11:00 AM	6	9:15 AM
Harriers	6	8:00 AM	10	8:00 AM	5	8:00 AM
Havanese	4	9:15 AM	4	10:45 AM	5	12:15 PM
Ibizan Hounds	6	8:00 AM	7	8:45 AM	5	8:00 AM
Icelandic Sheepdogs	1	10:00 AM	13	10:30 AM	13	10:45 AM
Irish Terriers	16	8:00 AM	13	10:30 AM	16	9:00 AM
Irish Wolfhounds	12	9:00 AM	7	8:45 AM	5	8:00 AM
Italian Greyhounds	5	10:00 AM	7	9:45 AM	12	10:00 AM
Japanese Chin	5	8:00 AM	4	8:00 AM	12	10:00 AM
Junior Showmanship Novice Jr	6	11:00 AM	7	10:30 AM	15	10:45 AM
Junior Showmanship Novice Int	6	11:00 AM	7	10:30 AM	15	10:45 AM
Junior Showmanship Open Jr	6	11:00 AM	7	10:30 AM	15	10:45 AM
Junior Showmanship Open Int	6	11:00 AM	7	10:30 AM	15	10:45 AM
Junior Showmanship Open Sr	6	11:00 AM	7	10:30 AM	15	10:45 AM
Junior Showmanship JMaster	6	11:00 AM	7	10:30 AM	15	10:45 AM
Junior Showmanship BJ	6	11:00 AM	7	10:30 AM	15	10:45 AM
Keeshonden	15	11:15 AM	13	10:30 AM	16	9:00 AM
Kerry Blue Terriers	14	10:00 AM	5	9:15 AM	16	9:00 AM
Kuvaszok	7	9:45 AM	5	8:00 AM	6	9:15 AM
Lagotti Romagnoli	9	9:30 AM	5	9:15 AM	15	10:45 AM
Lakeland Terriers	16	9:00 AM	5	10:15 AM	16	8:00 AM
Leonbergers	6	9:00 AM	9	11:00 AM	6	10:15 AM

	Friday		Saturday		Sunday	
	RING	TIME	RING	TIME	RING	TIME
Lhasa Apsos	3	10:30 AM	13	11:30 AM	16	11:30 AM
Maltese	13	11:30 AM	2	10:30 AM	5	12:15 PM
Manchester Terriers (Standard)	16	9:00 AM	5	9:15 AM	16	8:00 AM
Manchester Terriers (Toy)	13	8:00 AM	14	9:00 AM	11	8:00 AM
Mastiffs	6	8:00 AM	2	8:00 AM	3	9:00 AM
Miniature American Shepherds	15	10:15 AM	12	9:30 AM	13	12:30 PM
Miniature Bull Terriers	16	8:00 AM	5	9:15 AM	16	9:00 AM
Miniature Pinschers	4	8:00 AM	11	9:00 AM	4	8:00 AM
Miniature Schnauzers	14	10:00 AM	5	10:15 AM	16	10:15 AM
Mudik	1	10:00 AM	13	10:30 AM	13	9:15 AM
Newfoundlands	15	8:00 AM	15	9:15 AM	3	10:45 AM
Norfolk Terriers	11	8:00 AM	1	9:45 AM	2	8:45 AM
Norwegian Elkhounds	2	10:45 AM	6	10:30 AM	9	9:45 AM
Norwich Terriers	11	8:00 AM	1	8:45 AM	2	8:00 AM
Old English Sheepdogs	15	11:15 AM	12	10:30 AM	13	12:30 PM
Papillons	2	9:45 AM	4	8:00 AM	12	8:00 AM
Pekingese	2	10:45 AM	2	9:30 AM	4	10:30 AM
Pembroke Welsh Corgis	15	9:00 AM	12	8:00 AM	13	8:00 AM
Petits Bassets Griffons Vendeens	6	9:00 AM	11	9:00 AM	8	9:15 AM
Pharaoh Hounds	6	9:00 AM	7	8:45 AM	8	9:15 AM
Pointers	9	9:30 AM	5	8:00 AM	15	8:00 AM
Pointers (German Shorthaired)	12	8:00 AM	10	8:00 AM	2	8:45 AM
Pomeranians	6	10:00 AM	11	12:30 PM	12	9:00 AM
Poodles (Miniature)	14	10:00 AM	2	10:30 AM	16	10:15 AM
Poodles (Standard)	14	10:45 AM	2	11:15 AM	16	11:30 AM
Poodles (Toy)	14	9:00 AM	2	9:30 AM	16	9:00 AM
Portuguese Podengo Pequenos	12	10:00 AM	7	8:45 AM	10	9:00 AM
Portuguese Water Dogs	3	9:30 AM	3	9:30 AM	3	10:45 AM
Pugs	13	8:00 AM	11	8:00 AM	10	9:00 AM
Pumik	8	8:45 AM	12	9:30 AM	8	9:15 AM
Pyrenean Shepherds	8	8:45 AM	12	10:30 AM	8	9:15 AM
Rat Terriers	11	8:00 AM	1	8:45 AM	7	10:30 AM
Ret (Nova Scotia Duck Tolling)	1	10:00 AM	16	11:15 AM	8	10:15 AM
Retrievers (Chesapeake Bay)	1	11:15 AM	10	11:30 AM	15	1:00 PM
Retrievers (Flat-Coated)	12	9:00 AM	12	10:30 AM	8	10:15 AM
Retrievers (Golden)	16	9:45 AM	10	9:15 AM	15	8:00 AM
Retrievers (Labrador)	9	8:00 AM	16	8:00 AM	14	9:15 AM
Rhodesian Ridgebacks	10	8:00 AM	16	9:45 AM	10	10:00 AM
Rottweilers	15	8:00 AM	8	8:00 AM	7	9:15 AM
Russell Terriers	11	8:00 AM	1	8:45 AM	2	8:00 AM
Russian Toys	13	8:00 AM	11	9:00 AM	16	10:15 AM
Saint Bernards	14	9:00 AM	8	8:45 AM	7	9:15 AM
Salukis	10	9:30 AM	10	8:00 AM	10	9:00 AM
Samoyeds	11	9:00 AM	9	11:00 AM	3	10:45 AM
Schipperkes	3	10:30 AM	1	8:00 AM	6	11:30 AM
Scottish Terriers	11	9:00 AM	1	9:45 AM	2	9:45 AM
Setters (English)	12	10:00 AM	12	10:30 AM	8	9:15 AM
Setters (Gordon)	12	10:00 AM	12	10:30 AM	8	10:15 AM
Setters (Irish)	12	10:00 AM	14	10:15 AM	8	9:15 AM
Shetland Sheepdogs	15	10:15 AM	15	12:30 PM	5	12:15 PM
Shiba Inu	3	10:30 AM	11	9:00 AM	16	8:00 AM
Shih Tzu	13	11:30 AM	11	10:30 AM	2	9:45 AM
Siberian Huskies	7	9:45 AM	3	11:45 AM	13	10:45 AM
Skye Terriers	11	10:00 AM	1	9:45 AM	2	9:45 AM

	Friday RING TIME	Saturday RING TIME	Sunday RING TIME
Soft Coated Wheaten Terriers	11 9:00 AM	1 9:45 AM	2 8:45 AM
Spaniels (Boykin)	12 9:00 AM	5 9:15 AM	8 10:15 AM
Spaniels (Clumber)	12 9:00 AM	5 9:15 AM	8 10:15 AM
Spaniels (Cocker) A.S.C.O.B.	9 10:30 AM	5 10:15 AM	14 11:15 AM
Spaniels (Cocker) Black	9 9:30 AM	5 10:15 AM	14 11:15 AM
Spaniels (Cocker) Parti-Color	9 10:30 AM	5 10:15 AM	14 11:15 AM
Spaniels (English Cocker)	12 10:00 AM	10 11:30 AM	2 9:45 AM
Spaniels (English Springer)	12 9:00 AM	14 10:15 AM	8 10:15 AM
Spaniels (Field)	12 9:00 AM	14 10:15 AM	8 10:15 AM
Spaniels (Irish Water)	12 9:00 AM	14 10:15 AM	8 9:15 AM
Spaniels (Welsh Springer)	12 9:00 AM	14 10:15 AM	8 10:15 AM
Spinoni Italiani	1 11:15 AM	14 8:00 AM	8 10:15 AM
Staffordshire Bull Terriers	11 9:00 AM	1 9:45 AM	2 8:45 AM
Standard Schnauzers	15 11:15 AM	9 10:00 AM	11 9:45 AM
Swedish Vallhunds	8 8:00 AM	12 9:30 AM	9 9:45 AM
Tibetan Spaniels	3 10:30 AM	1 8:00 AM	6 11:30 AM
Tibetan Terriers	3 10:30 AM	1 9:45 AM	6 11:30 AM
Toy Fox Terriers	16 9:00 AM	11 8:00 AM	4 9:45 AM
Vizslas	12 8:00 AM	14 8:00 AM	8 8:00 AM
Weimaraners	1 10:00 AM	5 8:00 AM	8 8:00 AM
West Highland White Terriers	11 10:00 AM	1 9:45 AM	2 9:45 AM
Whippets	10 9:30 AM	13 9:30 AM	10 8:00 AM
Wirehaired Pointing Griffons	1 11:15 AM	5 8:00 AM	8 8:00 AM
Xoloitzcuintli	14 9:00 AM	1 8:45 AM	7 10:30 AM
Yorkshire Terriers	11 10:00 AM	11 10:30 AM	4 10:30 AM

## AKC National Owner-Handled Series

The AKC National Owner-Handled Series is a non-titling competition for dogs that are exhibited by their owners that are not professional handlers.

Exhibitors must declare their dog is Owner-Handled eligible at the time of entry on the entry form.

Dogs entered in the Amateur-Owner-Handler class will automatically be marked as eligible to compete in the NOHS. Eligible dogs will be identified by an asterisk in the judge's book, steward's book & the catalog. Dogs must be handled throughout the breed level competition for the regular show by an eligible owner.

Professional handlers\*, household members and current assistants\*\* to professional handlers may not exhibit the dog in any NOHS competition during the entire show. For a detailed description of the National Owner-Handled Series, please visit the AKC website NOHS pages at:

<https://www.akc.org/sports/conformation/national-owner-handled-series/>

*\*Professional handlers are defined as any person who belongs or has belonged to a professional handlers' organization, distributed rate cards, or otherwise advertised or represented themselves as handling dogs for pay within the last five years.*

*\*\*A current assistant is defined as anyone employed by a professional handler on a full-time basis or assisting a professional handler at the show or any time during the cluster/weekend. Current assistants that are eligible to compete in Junior Showmanship (meet age & amateur status requirements) may participate in NOHS.*

### EXHIBITORS PLEASE NOTE:

It is understood that each club associated with the Lone Star State Classic reserves the right to substitute any unavailable prizes with ones of equal or greater value. Prizes must be picked up the each day of the shows. None will be mailed. All unclaimed prizes become the property of the club where offered.

# JUDGING PROGRAM

Specialty Show, Sweepstakes & Veteran Sweepstakes  
Concurrent with Texas Kennel Club, Inc.  
(Unbenched)

CAVALIER KING CHARLES SPANIEL CLUB OF NORTH TEXAS  
(American Kennel Club Licensed)



DALLAS MARKET HALL  
2200 STEMMONS FRWY., DALLAS, TX 75207

**SATURDAY, FEBRUARY 10, 2024**

SHOW HOURS: 7:00 A.M. - 7:00 P.M.

THIS SHOW WILL BE HELD INDOORS

**AKC NATIONAL OWNER-HANDLED SERIES**

There are 36 dogs in this Specialty Show with a total entry of 47.

**SEE PAGE 22 FOR THE SCHEDULE**

The following breeds must be judged on a Ramp through all levels of conformation competition: Clumber Spaniels, Sussex Spaniels, Basset Hounds, Cirneci dell'Etna, Kerry Blue Terriers, Bulldogs, Chinese Shar-Pei, Chow Chows, Keeshonden. Breeds designated as ramp optional may, at the discretion of the judge, be judged on a ramp through all levels of competition. The full policy and list of Table and Ramp eligible/required breeds is available on the AKC website at:

[https://images.akc.org/pdf/judges/table\\_breeds.pdf](https://images.akc.org/pdf/judges/table_breeds.pdf)

Judges may request the ramp to judge any breed in emergency situations; if granted, unless the use of a ramp has been indicated in the premium list, an exhibitor has the option of withdrawing their entry and receiving a refund.

Junior Showmanship judges should follow the above.

#### NOTICE

Junior Handlers who win a third Novice Class with competition present or a first place in Novice without competition leading to a Best Junior award with competition would count as one win towards moving to Open, after the closing of entries for a show, **ARE REQUIRED TO TRANSFER** their entry from the Novice Class to the Open Class. **MUST NOTIFY** the Superintendent/Show Secretary prior to the judging of the class at the show.

**JUNIORS WITH A DOG ALSO ENTERED IN ANOTHER CLASS OFFERED AT THIS SHOW WHO SUBSTITUTE A DOG NOT ENTERED IN THIS SHOW MUST REMIT THE DIFFERENCE BETWEEN JUNIOR SHOWMANSHIP ONLY AND JUNIOR SHOWMANSHIP AS AN ADDITIONAL CLASS ENTRY FEE. JUNIORS WHO HAVE ENTERED JUNIOR SHOWMANSHIP ONLY WHO THEN SUBSTITUTE ANOTHER DOG WILL NOT BE CHARGED A FURTHER FEE.**

#### NO PRACTICING ALLOWED IN RINGS AT ANY TIME.

**Dogs May Arrive** any time prior to their scheduled time of judging. **Dogs not required for further judging will be excused.**

**Judges Will Not Wait for Any Dog Holding Up a Class.** Owners or agents alone are responsible for the presence of their dogs in the judging ring when their classes are called to be judged.

**All Dogs Present** must be held on leash or confined to their crates except when being judged or when in the exercising ring.

**No gasoline or diesel generators** are permitted inside any building or within 100 feet of any tent in which this dog show is conducted. **As specified in Chapter 12, Section 4** of the AKC Rules Applying to Dog Shows, information contained on the entry form is required to be published in the club's show catalog. This information is also subject to publication in other media.

**Entry Fees** shall not be refunded in the event that a dog is absent, disqualified, excused by Veterinarian or Judge, or barred from competition by action of the event's Show Committee. If because of riots, wars, strikes, civil disturbances, national emergencies, health emergencies, and the dictates of law enforcement or of the owner(s) of the grounds and/or facilities or other acts beyond the control of the management it is impossible to open or to complete the show, no refund of entry fee will be made. Extreme weather conditions, such as, but not limited to, snow storms, hurricanes, lightning, extreme heat, heavy rains, or other circumstances including, but not limited to, the condition of the facilities or grounds and/or the ingress and egress from the grounds, must be considered for the health and safety of the dogs, exhibitors and spectators. The well-being of dogs, exhibitors and spectators is of paramount importance and, in the event it is necessary to cancel or stop the show before completion, no refund of entry fee will be made.

**PUBLICATION RIGHTS:** By entering this show, all owners, handlers, breeders and kennels agree that all rights to televise, videotape, photograph, advertise, promote and publicize or otherwise exploit this show, or the persons or animals participating in it or the results of the competition before, during or after the event, shall belong solely to The American Kennel Club and their respective assigns, including the use of the names, likenesses or biographical matter of all dogs, owners, handlers, breeders and kennels participating in the show and no such owner, handler, breeder or kennel shall allow any other party to make commercial use of any videotape or photograph of any person or animal participating in this competition.

**50th Anniversary All-Breed Dog Show**  
(Unbenched)

# **GREATER COLLIN KENNEL CLUB, INC.**

(Member of the American Kennel Club)



**DALLAS MARKET HALL  
2200 STEMMONS FRWY.  
DALLAS, TX 75207**

**FRIDAY, FEBRUARY 9, 2024**

**SHOW HOURS: 7:00 A.M. - 7:00 P.M.  
THIS SHOW WILL BE HELD INDOORS**

**AKC NATIONAL OWNER-HANDLED SERIES**

**Supported Entry**  
Great Dane Club of Greater Dallas, Inc.

---

Greater Collin Kennel Club, Inc. Website: [www.greatercollinkc.org](http://www.greatercollinkc.org)

LIKE us on FACEBOOK: [facebook.com/greatercollinkc](https://facebook.com/greatercollinkc)

*No dog owned or co-owned by a member of the Greater Collin Kennel Club, Inc. will be entered at this show. No member of the Greater Collin Kennel Club, Inc. will exhibit a dog at this show.*

## PROGRAM OF JUDGING - FRIDAY - FEBRUARY 9, 2024

There are 1420 dogs in this show with a total entry of 1440 in 171 different Breeds or Varieties. For your convenience, the following division of sexes has been carefully tabulated; however, neither the Club nor the Superintendent/Show Secretary assumes responsibility for absolute accuracy. The numbers following each Breed (Variety) indicate the number of Regular Class Dogs, Regular Class Bitches, Best of Breed (Variety) (Dogs-Bitches), and Non-Regular Class Dogs or Bitches.

In accordance with Chapter 7, Section 8, of "Rules Applying to Dog Shows" and with American Kennel Club Approval the following changes apply:

<u>Breed</u>	<u>Original Judge</u>	<u>New Judge</u>
Akitas	Mr. Cleidith M. Wakefield	Mr. Adrian W. Woodfork
Alaskan Malamutes	Mr. Cleidith M. Wakefield	Mr. Adrian W. Woodfork
Anatolian Shepherd Dogs	Mr. Cleidith M. Wakefield	Mr. Adrian W. Woodfork
Black Russian Terriers	Mr. Cleidith M. Wakefield	Mr. Adrian W. Woodfork
Dogo Argentinos	Mr. Cleidith M. Wakefield	Mr. Adrian W. Woodfork
Great Danes	Mr. Cleidith M. Wakefield	Mr. Adrian W. Woodfork
Kuvaszok	Mr. Cleidith M. Wakefield	Mr. Adrian W. Woodfork
Siberian Huskies	Mr. Cleidith M. Wakefield	Mr. Adrian W. Woodfork
Affenpinschers	Mr. Cleidith M. Wakefield	Mr. D. Scott Pfeil
English Toy Spaniels (B & P C)	*Mr. Cleidith M. Wakefield	Mr. D. Scott Pfeil
English Toy Spaniels (K C & R)	*Mr. Cleidith M. Wakefield	Mr. D. Scott Pfeil
Papillons	*Mr. Cleidith M. Wakefield	Ms. Kathi Brown
Chow Chows	Mr. Cleidith M. Wakefield	Mrs. Christine E. Calcinari
Toy Group	*Mr. Cleidith M. Wakefield	Mr. James G. Reynolds

The number before each Breed (Variety) indicates the number of dogs entered in that Breed (Variety). The numbers following each Breed (Variety) indicate the number of Regular Class Dogs, Regular Class Bitches, Best of Breed (Variety) (Dogs-Bitches), and Non-Regular Class Dogs or Bitches.

### RING ONE

**JUDGE: Ms. Edweena (Teddy) McDowell**

#### 8:00 AM

- 10 German Shepherd Dogs 1-7-(2-0)
- 16 Border Collies 4-5-(2-5)

#### 9:00 AM

- 2 Belgian Malinois 1-0-(1-0)
- 2 Berger Picards 1-0-(0-1)
- 11 Belgian Sheepdogs 1-3-(3-4)
- 10 Belgian Tervuren 4-0-(2-4)

#### 10:00 AM

- 1 Canaan Dogs 0-0-(1-0)
- 9 Weimaraners 1-5-(1-2)
- 4 Icelandic Sheepdogs 0-3-(0-1)
- 7 Ret (Nova Scotia Duck Tolling) 0-3-(2-2)
- 11 Mudik 2-4-(2-3)

#### 11:15 AM

- 1 Briards 1-0-(0-0)
- 8 Bouviers des Flandres 2-2-(2-2)
- 4 Spinoni Italiani 0-0-(2-2)
- 6 Retrievers (Chesapeake Bay) 2-3-(1-0)
- 8 Wirehaired Pointing Griffons 1-1-(3-3)
- 110 Total Dogs

### RING TWO

**JUDGE: Ms. Kathi Brown**

#### 8:00 AM

- 6 Bull Terriers (Colored) 2-1-(1-2)
- 6 Bull Terriers (White) 1-4-(0-1)
- 6 American Staffordshire Terriers 3-2-(1-0)
- 2 Border Terriers 0-1-(1-0)
- 7 Fox Terriers (Smooth) 2-1-(2-2)
- 15 American Hairless Terriers 5-6-(3-1)

#### 9:45 AM

- 3 Bedlington Terriers 2-0-(0-1)
- 8 Fox Terriers (Wire) 0-2-(4-2)
- 14 Papillons 2-4-(5-3)

#### 10:45 AM

- 3 \*Norwegian Elkhounds 0-0-(2-1)
- 6 Airedale Terriers 3-2-(1-0)
- 17 Pekingese 6-6-(3-2)

93 Total Dogs

### RING THREE

**JUDGE: Mr. Adrian W. Woodfork**

#### 8:00 AM

- 11 Dogo Argentinos 2-5-(2-2)

See Ring 7 at 8:45 AM for balance of assignment.

### RING THREE

**JUDGE: Mrs. Karen McFarlane**

#### 8:30 AM

- 10 Boxers 4-4-(2-0)
- 16 Bullmastiffs 1-9-(4-2)

#### 9:30 AM

- 15 Cane Corsos 3-8-(3-1)
- 4 Giant Schnauzers 1-0-(2-1)
- 6 Portuguese Water Dogs 0-4-(0-2)

#### 10:30 AM

- 1 German Pinschers 0-0-(1-0)
- 1 Bernese Mountain Dogs 0-0-(1-0)
- 5 Shiba Inu 2-3-(0-0)
- 5 Tibetan Spaniels 1-0-(2-2)
- 5 Tibetan Terriers 1-3-(1-0)
- 5 Lhasa Apsos 1-0-(1-3)
- 8 Schipperkes 2-1-(5-0)

81 Total Dogs



**FRIDAY**

**RING FOUR**

**JUDGE: Mr. Jeffrey Kestner**

**8:00 AM**

- 4 Brussels Griffons 2-2-(0-0)
- 5 Chihuahuas (Smooth Coat) 1-2-(1-1)
- 8 Miniature Pinschers 1-3-(3-1)
- 14 Chihuahuas (Long Coat) 5-6-(1-2)

**9:15 AM**

- 18 Havanese 6-6-(2-4)
- 49 Total Dogs

**RING FIVE**

**JUDGE: Ms. Amy Sorbie**

**8:00 AM**

- 16 \*Japanese Chin 6-6-(3-1)

**8:45 AM**

- 10 \*Chinese Cresteds 1-1-(4-4)
- 17 Boston Terriers 3-6-(2-6)

**10:00 AM**

- 17 \*Italian Greyhounds 6-5-(4-2)
- 23 Cavalier King Charles Spaniels 7-11-(4-1)

**11:45 AM**

Lunch

**12:30 PM**

- 6 \*Biewer Terriers 2-1-(0-3)
- 5 Basset Hounds 1-1-(3-0)
- 11 Borzois 2-4-(4-1)
- 105 Total Dogs

**RING SIX**

**JUDGE: Mr. D. Scott Pfeil**

**8:00 AM**

- 2 English Foxhounds 0-0-(1-1)
- 3 Harriers 0-0-(2-1)
- 6 Ibizan Hounds 2-2-(1-1)
- 15 Mastiffs 5-6-(4-0)

**9:00 AM**

- 2 Leonbergers 0-0-(0-2)
- 8 Pharaoh Hounds 2-0-(4-2)
- 5 Petits Bassets Griffons Vendéens 2-0-(1-2)
- 2 English Toy Spaniels (KC & R) 0-1-(0-1)
- 3 Affenpinschers 0-0-(2-1)
- 5 English Toy Spaniels (B & PC) 1-2-(1-1)

**10:00 AM**

- 6 Afghan Hounds 1-1-(2-2)
- 20 Pomeranians 7-6-(5-2)

**11:00 AM**

**Junior Showmanship Competition**

- 1 Novice Junior
- 1 Novice Intermediate
- 3 Open Junior
- 9 Open Intermediate
- 6 Open Senior
- 1 Master
- Best Junior Handler

98 Total Dogs

**RING SEVEN**

**JUDGE: Mr. Adrian W. Woodfork**

**Continuation of assignment from Ring 3 at 8:00 AM**

**8:45 AM**

- 26 Great Danes 6-10-(7-3)

**9:45 AM**

- 1 Anatolian Shepherd Dogs 0-1-(0-0)
- 3 Alaskan Malamutes 1-1-(0-1)
- 3 Kuvaszok 1-1-(1-0)
- 4 Black Russian Terriers 1-1-(2-0)
- 5 Akitas 1-2-(2-0)
- 11 Siberian Huskies 0-6-(2-3)
- 64 Total Dogs

**RING EIGHT**

**JUDGE: Ms. Linda Robey**

**8:00 AM**

- 2 Collies (Smooth) 0-0-(2-0)
- 6 Beaucerons 2-2-(2-0)
- 8 Australian Cattle Dogs 1-1-(4-2)
- 2 Swedish Vallhunds 0-1-(1-0)

**8:45 AM**

- 2 Pyrenean Shepherds 2-0-(0-0)
- 4 Pumik 0-1-(1-2)
- 26 Australian Shepherds 8-11-(4-3)

**10:00 AM**

- 4 \*Great Pyrenees 1-1-(1-1)
- 4 Collies (Rough) 0-2-(1-1)
- 8 Bearded Collies 1-4-(1-2)
- 27 Doberman Pinschers 5-13-(5-4)

93 Total Dogs

**RING NINE**

**JUDGE: Mr. Nathaniel Horn**

**8:00 AM**

- 2 Bloodhounds 0-1-(1-0)
- 42 Retrievers (Labrador) 17-18-(4-3)

**9:30 AM**

- 1 Cirnechi dell'Etna 0-0-(0-1)
- 1 Lagotti Romagnoli 0-0-(1-0)
- 2 Braochi Italiani 1-1-(0-0)
- 2 Pointers 0-0-(1-1)
- 5 Brittanys 0-2-(2-1)
- 3 Spaniels (Cocker) Black 0-0-(1-2)
- 16 Beagles, 15 Inch 5-6-(2-3)

**10:30 AM**

- 7 Dachshunds (Smooth) 2-2-(2-1)
- 3 Beagles, 13 Inch 0-0-(0-3)
- 5 Dachshunds (Wirehaired) 0-2-(1-2)
- 6 Spaniels (Cocker) A.S.C.O.B. 1-4-(1-0)
- 9 Dachshunds (Longhaired) 3-2-(3-1)
- 9 Spaniels (Cocker) Parti-Color 2-2-(1-4)

113 Total Dogs

**RING TEN**

**JUDGE: Mr. James Donahue**

**8:00 AM**

- 29 \*Rhodesian Ridgebacks 8-10-(8-3)

**9:30 AM**

- 6 Salukis 4-1-(1-0)
- 10 Basenjis 1-6-(2-1)
- 24 Whippets 10-8-(4-2)

69 Total Dogs

**RING ELEVEN**

**JUDGE: Ms. Peggy Beisel-McIlwaine**

**8:00 AM**

- 2 Norfolk Terriers 0-0-(2-0)
- 4 Russell Terriers 1-2-(1-0)
- 5 Rat Terriers 0-1-(3-1)
- 14 Norwich Terriers 4-7-(1-2)

**9:00 AM**

- 3 Soft Coated Wheaten Terriers 0-2-(0-1)
- 3 Staffordshire Bull Terriers 0-1-(0-2)
- 1 Boerboels 1-0-(0-0)
- 8 Samoyeds 2-0-(3-3)
- 11 Scottish Terriers 2-4-(3-2)

**10:00 AM**

- 1 Skye Terriers 0-0-(1-0)
- 13 West Highland White Terriers 5-3-(2-3)
- 11 Yorkshire Terriers 5-4-(1-1)

76 Total Dogs

**RING TWELVE**

**JUDGE: Mrs. Debbie L. Melgreen**

**8:00 AM**

- 12 Pointers (German Shorthaired) 3-1-(3-5)
- 13 Vizslas 5-2-(5-1)

**9:00 AM**

- 1 Spaniels (Irish Water) 0-0-(0-1)
- 4 Retrievers (Flat-Coated) 0-3-(0-1)
- 4 \*Irish Wolfhounds 2-1-(0-1)
- 1 Spaniels (Field) 1-0-(0-0)
- 2 Spaniels (Boykin) 0-0-(2-0)
- 2 Spaniels (Welsh Springer) 0-0-(2-0)
- 3 Spaniels (Clumber) 0-0-(2-1)
- 7 Spaniels (English Springer) 0-2-(2-3)

**10:00 AM**

- 4 Setters (Gordon) 2-1-(1-0)
- 6 Setters (Irish) 0-2-(2-2)
- 8 Setters (English) 2-2-(2-2)
- 1 \*Portuguese Podengo Pequenos 0-0-(0-1)
- 5 Spaniels (English Cocker) 1-2-(2-0)

**11:00 AM**

- 23 Cardigan Welsh Corgis 4-6-(5-8)

96 Total Dogs

**RING THIRTEEN**

**JUDGE: Mr. Jeffery M. Bazell**

**8:00 AM**

- 1 Manchester Terriers (Toy) 0-0-(1-0)
- 14 Russian Toys 6-3-(3-2)
- 15 Pugs 2-5-(6-2)

**9:15 AM**

- 12 Bulldogs 3-5-(3-1)
- 45 French Bulldogs 19-17-(6-3)

**FRIDAY****11:30 AM**

- 7 Shih Tzu 1-4-(2-0)
- 10 Maltese 3-5-(2-0)

104 Total Dogs

**RING FOURTEEN**

**JUDGE: Mr. James G. Reynolds**

**9:00 AM**

- 15 Saint Bernards 4-6-(3-2)
  - 1 Xoloitzcuintli 0-0-(1-0)
  - 11 Poodles (Toy) 5-3-(2-1)
  - 1 Danish-Swedish Farmdogs 1-0-(0-0)
- Best in Miscellaneous Class

**10:00 AM**

- 2 Kerry Blue Terriers 0-0-(2-0)
- 4 Cesky Terriers 0-2-(1-1)
- 4 Poodles (Miniature) 1-1-(1-1)
- 12 Miniature Schnauzers 4-1-(4-3)

**10:45 AM**

- 1 Dandie Dinmont Terriers 0-0-(0-1)
- 18 Poodles (Standard) 4-7-(5-2)

69 Total Dogs

**RING FIFTEEN**

**JUDGE: Mrs. Sulie Greendale-Paveza**

**8:00 AM**

- 4 Dalmatians 1-0-(0-3)
- 5 Newfoundlands 1-0-(1-3)
- 16 Rottweilers 6-6-(3-1)

**9:00 AM**

- 12 American Eskimo Dogs 0-5-(3-4)
- 16 Pembroke Welsh Corgis 4-5-(5-2)
- 2 Bichons Frises 0-0-(1-1)

**10:15 AM**

- 10 Shetland Sheepdogs 2-5-(3-0)
- 16 Miniature American Shepherds 5-5-(3-3)

**11:15 AM**

- 6 Cotons de Tulear 0-3-(1-2)
- 1 Finnish Spitz 0-0-(1-0)
- 4 Keeshonden 1-1-(1-1)
- 7 Standard Schnauzers 0-1-(3-3)
- 13 Old English Sheepdogs 2-7-(2-2)

112 Total Dogs

**RING SIXTEEN**

**JUDGE: Mrs. Christine E. Calcinari**

**8:00 AM**

- 14 Chinese Shar-Pei 4-5-(2-3)
- 1 Irish Terriers 0-0-(1-0)
- 7 Chow Chows 2-2-(3-0)
- 4 Miniature Bull Terriers 0-2-(1-1)

**9:00 AM**

- 1 Lakeland Terriers 0-1-(0-0)
- 3 Manchester Terriers (Standard) 0-2-(1-0)
- 5 \*Toy Fox Terriers 3-0-(1-1)
- 6 Cairn Terriers 1-1-(1-3)

**9:45 AM**

- 67 Retrievers (Golden) 18-35-(11-3)

108 Total Dogs

**FRIDAY  
RING SEVEN**

**1:00 PM Variety Groups and Best in Show**

(The groups will be judged in the following order unless otherwise announced)

Non-Sporting .....	Mr. Nathaniel Horn
Working .....	Ms. Peggy Beisel-McIlwaine
Terrier .....	Ms. Kathi Brown
Herding .....	Ms. Linda Robey
Toy .....	Mr. James G. Reynolds
Sporting .....	Mrs. Christine E. Calcinari
Hound .....	Ms. Amy Sorbie
Best in Show .....	Dr. Clyde E. Shaw

**RING TWO**

**12:30 PM Owner-Handled Variety Groups and Best Owner-Handled in Show**

Owner-Handled Non-Sporting .....	Mr. Jeffrey Kestner
Owner-Handled Working .....	Mrs. Debbie L. Melgreen
Owner-Handled Terrier .....	Mrs. Karen McFarlane
Owner-Handled Herding .....	Ms. Amy Sorbie
Owner-Handled Toy .....	Mr. D. Scott Pfeil
Owner-Handled Sporting .....	Mr. Nathaniel Horn
Owner-Handled Hound .....	Mr. Jeffery M. Bazell
Best Owner-Handled in Show .....	Ms. Edweena (Teddy) McDowell

---

**LSSC RESERVED RV PARKING SPACE**

***Reservations closed Jan. 24, 2024 or when limit reached.***

- Although Paid Reservations are available, free RV Parking (locations same as prior years) will be available.
- Reserved spaces are limited and are available on a first-received, first-served basis. When reserved space limit has been reached, additional reservations will be returned.
- Reservations must have been received no later than Close of Entries Jan. 24, 2024, or when limit is reached.  
Monies will not be refunded, and reservations cannot be changed after closing.
- **Do not include reservation form and payment with Entries.**
- Reservations are for 5 days; no partial reservations are accepted.
- Only one (1) request for space per envelope will be accepted. All others will be returned.
- Fax, E-mail, walk-ins or telephone reservations will NOT be accepted.
- Reserved parking will be done Wednesday, Feb. 7, 2024. Please arrive on Wednesday to be parked.
- Parking locations will be done on a first-arrived, first-parked basis and location will be dependent upon your parking order.
- There will be NO Access to electrical hook-ups in this area.
- Reserved space will be strictly enforced.
- **Specific location or space requests will not be considered.**
- Please make sure all reservations (including any via an entry service) arrive by the deadline.

**Go to [www.LoneStarStateClassic.com](http://www.LoneStarStateClassic.com) for details.**

**Confirmations will be published in a listing of all reservations along with a map on our website at [www.LoneStarStateClassic.com](http://www.LoneStarStateClassic.com)**

Space locations will NOT be provided by phone, E-mail, or letter. Your cancelled check is your receipt.

**SEE PAGE 8 OF THE PREMIUM LIST  
FOR MORE INFORMATION.**

---

**LSSC RESERVED GROOMING/CRATING SPACE**

***Reservations closed Jan. 24, 2024 or when limit reached.***

- Although Reservations are recommended, free areas for grooming space and day crating will be available.
- Reserved spaces are limited and are available on a first-come, first-served basis. When reserved space limit has been reached, additional reservations will be returned.
- Reservations must have been received no later than Close of Entries Jan. 24, 2024. Monies will not be refunded, and reservations cannot be changed after closing.
- **Do not include reservation form and payment with entries.**
- Reservations are for 4 days; no partial reservations are accepted.
- Club reservations are welcome.
- Only one (1) request for space per envelope will be accepted. All others will be returned.
- No fax, E-mail, walk-ins or telephone reservations can be accepted.
- Reserved setup will start on Wednesday, Feb. 7, 2024, however, "your" space will be reserved for your arrival on any day of the cluster.
- Access to electrical plugs is not exclusive and is not reserved.
- Reserved space will be strictly enforced.
- **Specific location or space requests will not be considered.**
- Please make sure all reservations (including those via an entry service) arrive by the deadline.

**Confirmations will be published in a listing of all reservations along with a map on our website at [www.LoneStarStateClassic.com](http://www.LoneStarStateClassic.com)**

Space locations will NOT be provided by phone, E-mail, or letter. Your cancelled check is your receipt.

**SEE PAGE 9 OF THE PREMIUM LIST  
FOR MORE INFORMATION**

# The American Kennel Club

Presents:

## “Judging Junior Showmanship”

*Held in conjunction with the  
Texas Kennel Club show*

February 10, 2024

Dallas, Texas

**\$50.00**

*Please review the Junior Showmanship Rulebook prior to attending the seminar. [Http://images.akc.org/pdf/rulebooks/REJRSH.pdf](http://images.akc.org/pdf/rulebooks/REJRSH.pdf)*

*\*Please meet at the Superintendent's office 30 minutes prior to the start of*

*Junior Showmanship Judging*

*To Register complete and return to Kathy Caruana ♦ American Kennel Club ♦  
Judging Operations Department ♦ PO Box 900062 ♦ Raleigh, NC 27675-9062  
♦919-816-3862 ♦ fax# 919-816-4225*

Name: \_\_\_\_\_

Address: \_\_\_\_\_  
\_\_\_\_\_

Phone: \_\_\_\_\_ Judges # \_\_\_\_\_

Have you already submitted an application for your first breed or JS? \_\_\_\_\_

Email: \_\_\_\_\_

Check or Credit Card only:

Exp. Date: \_\_\_\_\_

**Cash cannot be accepted**

**♦If you are using a credit card - Please do not email this form - send by fax or mail only♦**

*The AKC retains all rights to photograph or videotape by any means, televise or reproduce these events in any way, now and in the future. Photos of this event may be used, but are not limited to, future educational literature, training purposes, newsletters, or advertisements.*

**NO REFUNDS ONE MONTH PRIOR TO THE DATE OF THE SEMINAR**

*\*Time subject to change based upon final judging schedule.*

*Seminar to be conducted in-conjunction with Junior Showmanship Judging*

All-Breed Dog Show  
(Unbenched)

# TEXAS KENNEL CLUB, INC.

(Member of the American Kennel Club)



DALLAS MARKET HALL  
2200 STEMMONS FRWY.  
DALLAS, TX 75207

Visit Texas Kennel Club, Inc. website for complete Club information:

[www.texaskenneclub.net](http://www.texaskenneclub.net)

## SATURDAY, FEBRUARY 10, 2024

SHOW HOURS: 7:00 A.M. - 7:00 P.M.  
THIS SHOW WILL BE HELD INDOORS

**AKC NATIONAL OWNER-HANDLED SERIES**

**Specialty Show**

American Fox Terrier Club (& Sweepstakes)

**Supported Entry**

Great Dane Club of Greater Dallas, Inc.

**Concurrent Specialty**

Cavalier King Charles Spaniel Club of North Texas

---

*No dog owned or co-owned by a member of the Texas Kennel Club, Inc. will be entered at this show. No member of the Texas Kennel Club, Inc. will exhibit a dog at this show.*

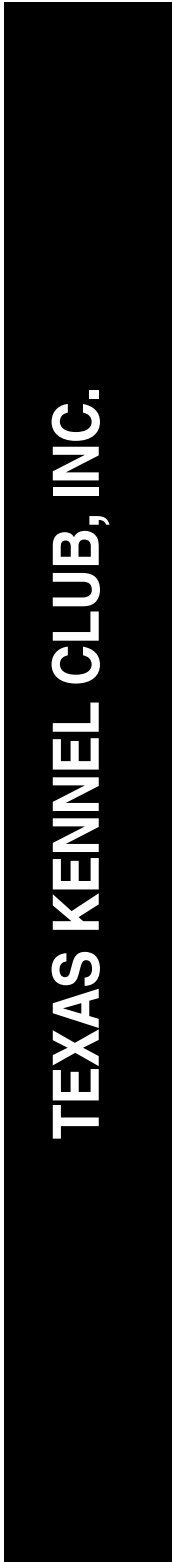

**PROGRAM OF JUDGING - SATURDAY - FEBRUARY 10, 2024**

There are 1513 dogs in this show with a total entry of 1541 in 172 different Breeds or Varieties. For your convenience, the following division of sexes has been carefully tabulated; however, neither the Club nor the Superintendent/Show Secretary assumes responsibility for absolute accuracy.

In accordance with Chapter 7, Section 8, of "Rules Applying to Dog Shows" and with American Kennel Club approval the following changes apply:

<u>Breed</u>	<u>Original Judge</u>	<u>New Judge</u>
Boerboels	Mr. Cledith M. Wakefield	Mr. Adrian W. Woodfork
Bullmastiffs	Mr. Cledith M. Wakefield	Mr. Adrian W. Woodfork
Doberman Pinschers	Mr. Cledith M. Wakefield	Mr. Adrian W. Woodfork
German Pinschers	Mr. Cledith M. Wakefield	Mr. Adrian W. Woodfork
Rottweilers	Mr. Cledith M. Wakefield	Mr. Adrian W. Woodfork
Saint Bernards	Mr. Cledith M. Wakefield	Mr. Adrian W. Woodfork
Manchester Terriers (Toy)	*Mr. Cledith M. Wakefield	Mrs. Christine E. Calcinaro
Boston Terriers	Mr. Cledith M. Wakefield	Mr. James G. Reynolds
Working Group	Mr. Cledith M. Wakefield	Mr. Adrian W. Woodfork
Owner-Handled Herding Group	Mr. Cledith M. Wakefield	Mr. Jeffrey Kestner

With American Kennel Club approval the following change applies:

<u>Breed</u>	<u>Original Judge</u>	<u>New Judge</u>
Samoyeds	Mrs. Sulie Greendale-Paveza	Mrs. Karen McFarlane

The number before each Breed (Variety) indicates the number of dogs entered in that Breed (Variety). The numbers following each Breed (Variety) indicate the number of Regular Class Dogs, Regular Class Bitches, Best of Breed (Variety) (Dogs-Bitches), and Non-Regular Class Dogs or Bitches.

**RING ONE**

**JUDGE: Ms. Kathi Brown**

**8:00 AM**

- 6 Tibetan Spaniels 1-0-(3-2)
- 12 Schipperkes 4-3-(5-0)

**8:45 AM**

- 1 Xoloitzcuintli 0-0-(1-0)
- 5 Rat Terriers 0-1-(3-1)
- 5 Russell Terriers 2-2-(1-0)
- 14 Norwich Terriers 4-7-(1-2)

**9:45 AM**

- 4 Staffordshire Bull Terriers 0-2-(0-2)
  - 3 Soft Coated Wheaten Terriers 0-2-(0-1)
  - 1 Skye Terriers 0-0-(1-0)
  - 2 Norfolk Terriers 0-0-(2-0)
  - 5 Tibetan Terriers 1-3-(1-0)
  - 10 Scottish Terriers 2-4-(2-2)
  - 14 West Highland White Terriers 5-4-(2-3)
- 82 Total Dogs

**RING ONE**

**JUDGE: Mrs. Carla M. Holt**

**12:00 NOON**

**Junior Showmanship Competition**

- 2 Open
- Best Junior Handler
- 34 \*Cavalier King Charles Spaniels 8-19-(5-2)
- 1 \*Veteran Dog
- 1 \*Veteran Bitch
- 38 Total Dogs

**RING TWO**

**JUDGE: Mrs. Sulie Greendale-Paveza**

**8:00 AM**

- 1 Canaan Dogs 0-0-(1-0)
- 5 Beaucerons 2-1-(2-0)
- 8 Australian Cattle Dogs 1-1-(4-2)
- 16 Mastiffs 5-7-(4-0)

See Ring 3 at 9:30 AM for balance of assignment.

**RING TWO**

**JUDGE: Mr. Jeffrey Kestner**

**9:30 AM**

- 10 Poodles (Toy) 5-3-(1-1)
- 12 \*Pekingese 4-5-(2-1)

**10:30 AM**

- 4 Poodles (Miniature) 1-1-(1-1)
- 9 \*Maltese 3-4-(2-0)

**11:15 AM**

- 20 Poodles (Standard) 6-8-(4-2)
- 55 Total Dogs

**CONCURRENT SHOW**

**Cavalier King Charles Spaniel Club of North Texas**

**RING ONE**

**JUDGE: Mrs. Mary Grace Eubank**

**11:30 AM**

- 7 Cavalier King Charles Spaniels Sweepstakes (2-5)
  - 2 Cavalier King Charles Spaniels
  - Veteran Sweepstakes (1-1)
- 9 Total Dogs

## SATURDAY

### RING THREE

JUDGE: Ms. Linda Robey

#### 8:00 AM

- 11 Dogo Argentinos 2-5-(2-2)
- 2 Belgian Malinois 1-0-(1-0)
- 11 Boxers 4-4-(2-1)

See Ring 15 at 9:15 AM for balance of assignment.

### RING THREE

JUDGE: Mrs. Sulie Greendale-Paveza

Continuation of assignment from Ring 2 at 8:00 AM

#### 9:30 AM

- 16 Cane Corsos 4-8-(3-1)
- 8 Portuguese Water Dogs 1-4-(1-2)
- 8 Bearded Collies 1-4-(1-2)

#### 10:45 AM

- 1 Briards 1-0-(0-0)
- 24 Australian Shepherds 6-11-(4-3)

#### 11:45 AM

- 8 Bouviers des Flandres 2-2-(2-2)
  - 12 Siberian Huskies 1-6-(2-3)
- 107 Total Dogs

### RING FOUR

JUDGE: Mr. Jeffery M. Bazell

#### 8:00 AM

- 10 Chinese Cresteds 1-1-(4-4)
- 13 Japanese Chin 5-5-(2-1)
- 16 Papillons 2-5-(5-4)

#### 9:30 AM

- 1 Danish-Swedish Farmdogs 1-0-(0-0)
- Best in Miscellaneous Class
- 30 Cavalier King Charles Spaniels 8-14-(5-3)

#### 10:45 AM

- 2 English Toy Spaniels (KC & R) 0-1-(0-1)
  - 3 Affenpinschers 0-0-(2-1)
  - 4 Brussels Griffons 2-2-(0-0)
  - 5 English Toy Spaniels (B & PC) 1-2-(1-1)
  - 7 Biewer Terriers 2-1-(1-3)
  - 18 Havanese 5-7-(2-4)
- 109 Total Dogs

### RING FIVE

JUDGE: Ms. Peggy Beisel-McIlwaine

#### 8:00 AM

- 2 Bracchi Italiani 1-1-(0-0)
- 3 Pointers 0-1-(1-1)
- 9 Weimaraners 1-5-(1-2)
- 9 Wirehaired Pointing Griffons 1-1-(3-4)
- 3 Kuvaszok 1-1-(1-0)
- 6 Airedale Terriers 3-2-(1-0)

#### 9:15 AM

- 1 Bernese Mountain Dogs 0-0-(1-0)
- 4 Giant Schnauzers 1-0-(2-1)
- 1 Lagotti Romagnoli 0-0-(1-0)
- 2 Spaniels (Boykin) 0-0-(2-0)
- 2 Spaniels (Clumber) 0-0-(1-1)
- 3 Kerry Blue Terriers 0-0-(3-0)
- 4 Miniature Bull Terriers 0-2-(1-1)
- 3 Manchester Terriers (Standard) 0-2-(1-0)
- 5 Cairn Terriers 1-1-(1-2)

#### 10:15 AM

- 3 Spaniels (Cocker) Black 0-0-(1-2)
  - 1 Dandie Dinmont Terriers 0-0-(0-1)
  - 1 Lakeland Terriers 0-1-(0-0)
  - 4 Cесky Terriers 0-2-(1-1)
  - 9 Spaniels (Cocker) A.S.C.O.B. 3-4-(2-0)
  - 12 Miniature Schnauzers 4-1-(4-3)
  - 10 Spaniels (Cocker) Parti-Color 2-3-(1-4)
- 97 Total Dogs

### RING SIX

JUDGE: Mr. D. Scott Pfeil

#### 8:00 AM

- 11 Basenjis 1-6-(3-1)
- 20 Beagles, 15 Inch 6-9-(2-3)

#### 9:15 AM

- 3 Beagles, 13 Inch 0-0-(0-3)
- 5 Dachshunds (Wirehaired) 0-2-(1-2)
- 8 Dachshunds (Smooth) 3-2-(2-1)
- 14 Dachshunds (Longhaired) 5-5-(3-1)

#### 10:30 AM

- 1 Cirneci dell'Etna 0-0-(0-1)
  - 6 Basset Hounds 1-2-(3-0)
  - 2 Bloodhounds 0-1-(1-0)
  - 2 Norwegian Elkhounds 0-0-(1-1)
  - 13 Borzois 2-6-(4-1)
- 85 Total Dogs

### RING SEVEN

JUDGE: Mr. James Donahue

#### 8:45 AM

- 1 Portuguese Podengo Pequenos 0-0-(0-1)
- 8 Ibizan Hounds 2-4-(1-1)
- 8 Pharaoh Hounds 2-0-(4-2)
- 7 Irish Wolfhounds 2-3-(0-2)

#### 9:45 AM

- 19 Italian Greyhounds 6-7-(3-3)

#### 10:30 AM

#### Junior Showmanship Competition

- 2 Novice Junior
- 2 Novice Intermediate
- 5 Open Junior
- 10 Open Intermediate
- 8 Open Senior
- 1 Master
- Best Junior Handler

71 Total Dogs

### RING EIGHT

JUDGE: Mr. Adrian W. Woodfork

#### 8:00 AM

- 17 Rottweilers 7-6-(3-1)

#### 8:45 AM

- 1 German Pinschers 0-0-(1-0)
- 1 Boerboels 1-0-(0-0)
- 12 Saint Bernards 4-5-(2-1)
- 16 Bullmastiffs 1-9-(4-2)

#### 10:00 AM

- 28 Doberman Pinschers 6-13-(5-4)

75 Total Dogs

**SATURDAY****RING NINE****JUDGE: Mrs. Karen McFarlane****8:00 AM**

48 French Bulldogs 21-18-(6-3)

**10:00 AM**

13 Bulldogs 3-6-(3-1)

8 Standard Schnauzers 0-2-(3-3)

5 Black Russian Terriers 1-2-(2-0)

**11:00 AM**

1 Anatolian Shepherd Dogs 0-1-(0-0)

4 Great Pyrenees 1-1-(1-1)

5 Leonbergers 3-0-(0-2)

7 Akitas 1-3-(2-1)

8 Samoyeds 2-0-(3-3)

99 Total Dogs

**RING TEN****JUDGE: Mr. Nathaniel Horn****8:00 AM**

2 Grand Basset Griffon Vendeens 1-0-(1-0)

12 Chinese Shar-Pei 3-3-(2-4)

2 English Foxhounds 0-0-(1-1)

3 Harriers 0-0-(2-1)

6 Salukis 4-1-(1-0)

12 Pointers (German Shorthaired) 3-1-(3-5)

**9:15 AM**

65 Retrievers (Golden) 18-32-(11-4)

**11:30 AM**

5 Spaniels (English Cocker) 1-2-(2-0)

7 Retrievers (Chesapeake Bay) 2-3-(2-0)

3 Afghan Hounds 0-0-(1-2)

117 Total Dogs

**RING ELEVEN****JUDGE: Ms. Amy Sorbie****8:00 AM**

5 \*Toy Fox Terriers 3-0-(1-1)

15 \*Pugs 0-5-(7-3)

**9:00 AM**

5 Petits Bassets Griffons Vendeens 2-0-(1-2)

5 Shiba Inu 2-3-(0-0)

9 \*Miniature Pinschers 0-4-(2-3)

14 \*Russian Toys 6-3-(3-2)

**10:30 AM**

7 Chow Chows 2-2-(3-0)

8 \*Shih Tzu 1-4-(3-0)

13 \*Yorkshire Terriers 6-4-(1-2)

**11:45 AM**

Lunch

**12:30 PM**

20 \*Pomeranians 7-6-(5-2)

101 Total Dogs

**RING TWELVE****JUDGE: Ms. Edweena (Teddy) McDowell****8:00 AM**

19 Cardigan Welsh Corgis 3-6-(4-6)

20 Pembroke Welsh Corgis 4-8-(6-2)

**9:30 AM**

18 Miniature American Shepherds 6-7-(2-3)

4 Pumik 0-1-(1-2)

4 Swedish Vallhunds 2-1-(1-0)

**10:30 AM**

1 Pyrenean Shepherds 1-0-(0-0)

2 Collies (Smooth) 0-0-(2-0)

3 Retrievers (Flat-Coated) 0-2-(0-1)

4 Setters (Gordon) 2-1-(1-0)

8 Setters (English) 2-2-(2-2)

4 Collies (Rough) 0-2-(1-1)

13 Old English Sheepdogs 2-7-(2-2)

100 Total Dogs

**RING THIRTEEN****JUDGE: Mr. James G. Reynolds****8:00 AM**

3 Alaskan Malamutes 1-1-(0-1)

6 Bull Terriers (Colored) 2-1-(1-2)

7 Bull Terriers (White) 1-5-(0-1)

7 Dalmatians 2-1-(1-3)

17 Boston Terriers 3-6-(2-6)

**9:30 AM**

3 Bedlington Terriers 2-0-(0-1)

25 Whippets 10-8-(5-2)

**10:30 AM**

1 Irish Terriers 0-0-(1-0)

1 Finnish Spitz 0-0-(1-0)

4 Icelandic Sheepdogs 0-3-(0-1)

5 Keeshonden 1-1-(2-1)

16 Mudik 2-8-(3-3)

**11:30 AM**

2 Bichons Frises 0-0-(1-1)

5 Lhasa Apsos 1-0-(1-3)

6 Cotons de Tulear 0-3-(1-2)

16 American Hairless Terriers 5-6-(4-1)

See 1:15 PM for balance of assignment.

**RING THIRTEEN****JUDGE: Ms. Carolyn Snavelly****1:00 PM**

Specialty

2 Fox Terriers (Wire) Sweepstakes (0-2)

2 Total Dogs

**RING THIRTEEN****JUDGE: Mr. James G. Reynolds****1:15 PM**

Specialty

7 Fox Terriers (Smooth) 2-1-(2-2)

Specialty

8 Fox Terriers (Wire) 0-2-(4-2)

139 Total Dogs

**RING FOURTEEN****JUDGE: Mrs. Christine E. Calcinari****8:00 AM**

4 Spinoni Italiani 0-0-(2-2)

22 Vizslas 8-7-(5-2)



**SATURDAY**

**9:00 AM**

- 1 Manchester Terriers (Toy) 0-0-(1-0)
- 7 Border Terriers 1-4-(2-0)
- 4 \*Chihuahuas (Smooth Coat) 1-1-(1-1)
- 14 \*Chihuahuas (Long Coat) 5-6-(2-1)

**10:15 AM**

- 12 American Eskimo Dogs 0-5-(3-4)
- 1 Spaniels (Field) 1-4-(0-0)
- 2 Spaniels (Welsh Springer) 0-0-(2-0)
- 6 American Staffordshire Terriers 2-2-(1-1)
- 1 Spaniels (Irish Water) 0-0-(0-1)
- 6 Setters (Irish) 0-2-(2-2)
- 7 Spaniels (English Springer) 0-2-(2-3)

87 Total Dogs

**RING FIFTEEN**

**JUDGE: Ms. Linda Robey**

**Continuation of assignment from Ring 3 at 8:00 AM**

**9:15 AM**

- 5 \*Newfoundlands 1-0-(1-3)
- 30 Great Danes 7-10-(9-4)

**10:45 AM**

- 13 Belgian Sheepdogs 1-5-(3-4)
- 13 Belgian Tervuren 5-2-(2-4)

**11:45 AM**

Lunch

**12:30 PM**

- 9 Shetland Sheepdogs 2-4-(3-0)
- 17 Border Collies 4-6-(2-5)

111 Total Dogs

**RING SIXTEEN**

**JUDGE: Mrs. Debbie L. Melgreen**

**8:00 AM**

- 45 Retrievers (Labrador) 17-20-(4-4)

**9:45 AM**

- 30 \*Rhodesian Ridgebacks 8-9-(10-3)

**11:15 AM**

- 2 Berger Picards 1-0-(0-1)
- 10 German Shepherd Dogs 1-7-(2-0)
- 6 Brittany 0-3-(2-1)
- 11 Ret (Nova Scotia Duck Tolling) 1-5-(2-3)

104 Total Dogs

**RING SEVEN**

**1:00 PM Variety Groups and Best in Show**

**(The groups will be judged in the following order unless otherwise announced)**

Hound.....	Mr. D. Scott Pfeil
Working.....	Mr. Adrian W. Woodfork
Sporting.....	Mr. Nathaniel Horn
Non-Sporting.....	Ms. Kathi Brown
Herding.....	Ms. Edweena (Teddy) McDowell
Terrier.....	Ms. Peggy Beisel-McIlwaine
Toy.....	Mr. Jeffery M. Bazell
Best in Show.....	Mr. James G. Reynolds

**RING TWO**

**12:30 PM Owner-Handled Variety Groups and Best Owner-Handled in Show**

Owner-Handled Hound.....	Ms. Kathi Brown
Owner-Handled Working.....	Mr. D. Scott Pfeil
Owner-Handled Sporting.....	Mrs. Christine E. Calcinari
Owner-Handled Non-Sporting.....	Ms. Peggy Beisel-McIlwaine
Owner-Handled Herding.....	Mr. Jeffrey Kestner
Owner-Handled Terrier.....	Ms. Edweena (Teddy) McDowell
Owner-Handled Toy.....	Mr. Jeffrey Kestner
Best Owner-Handled in Show.....	Mr. James Donahue

**Attention New Exhibitors**

A New Exhibitor Briefing will be held Saturday at

9:30 AM at the Superintendent's desk.

Spectators are welcome to attend.

# Lone Star State Classic Dog Shows

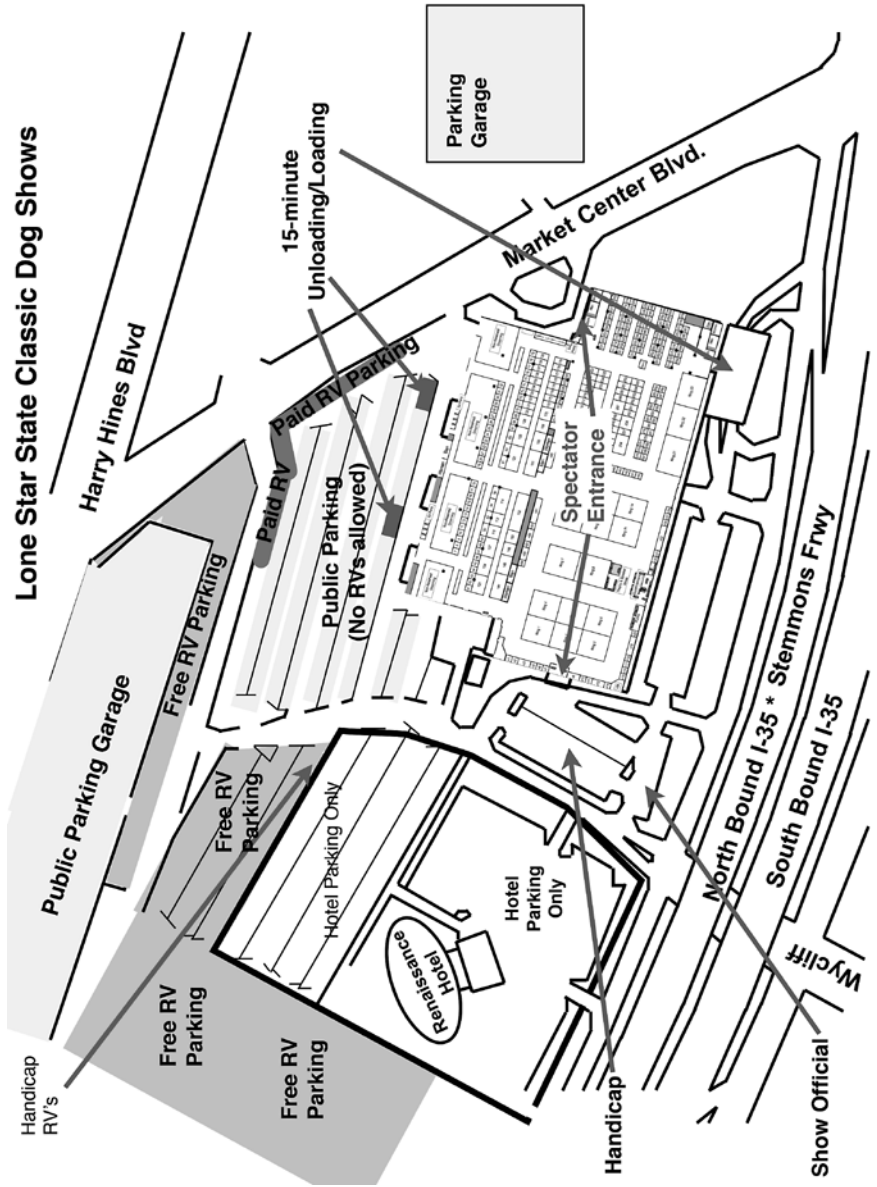

All-Breed Dog Show  
(Unbenched)

# **TRINITY VALLEY KENNEL CLUB, INC.**

(Member of the American Kennel Club)

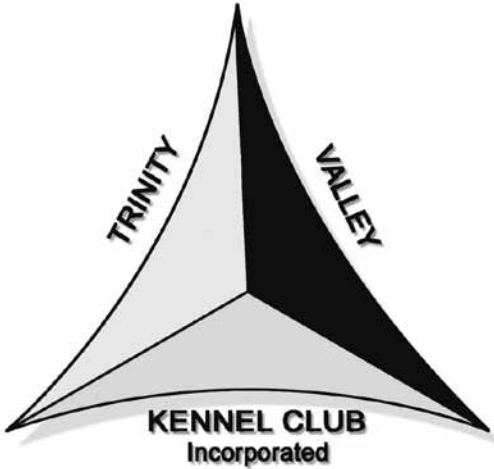

**DALLAS MARKET HALL  
2200 STEMMONS FRWY.  
DALLAS, TX 75207**

**SUNDAY, FEBRUARY 11, 2024**

**SHOW HOURS: 7:00 A.M. - 7:00 P.M.  
THIS SHOW WILL BE HELD INDOORS**

**AKC NATIONAL OWNER-HANDLED SERIES**

**Supported Entry**  
Great Dane Club of Greater Dallas, Inc.

**TRINITY VALLEY KENNEL CLUB, INC.**

## PROGRAM OF JUDGING - SUNDAY - FEBRUARY 11, 2024

There are 1483 dogs in this show with a total entry of 1508 in 172 different Breeds or Varieties. For your convenience, the following division of sexes has been carefully tabulated; however, neither the Club nor the Superintendent/Show Secretary assumes responsibility for absolute accuracy.

In accordance with Chapter 7, Section 8, of "Rules Applying to Dog Shows" and with American Kennel Club Approval the following changes apply:

<u>Breed</u>	<u>Original Judge</u>	<u>New Judge</u>
Boxers	Mr. Cledith M. Wakefield	Mr. Adrian W. Woodfork
Cane Corsos	Mr. Cledith M. Wakefield	Mr. Adrian W. Woodfork
Mastiffs	Mr. Cledith M. Wakefield	Mr. Adrian W. Woodfork
Newfoundlands	Mr. Cledith M. Wakefield	Mr. Adrian W. Woodfork
Portuguese Water Dogs	Mr. Cledith M. Wakefield	Mr. Adrian W. Woodfork
Samoyeds	Mr. Cledith M. Wakefield	Mr. Adrian W. Woodfork
Chinese Cresteds	*Mr. Cledith M. Wakefield	Mr. James G. Reynolds
Maltese	Mr. Cledith M. Wakefield	Ms. Amy Sorbie
Pugs	*Mr. Cledith M. Wakefield	Mr. D. Scott Pfeil
Russian Toys	*Mr. Cledith M. Wakefield	Ms. Kathi Brown
Toy Fox Terriers	*Mr. Cledith M. Wakefield	Mr. Jeffery M. Bazell

The number before each Breed (Variety) indicates the number of dogs entered in that Breed (Variety). The numbers following each Breed (Variety) indicate the number of Regular Class Dogs, Regular Class Bitches, Best of Breed (Variety) (Dogs-Bitches), and Non-Regular Class Dogs or Bitches.

### RING ONE

JUDGE: Mr. James Donahue

#### 8:00 AM

- 8 Dachshunds (Smooth) 3-2-(2-1)
- 8 Dachshunds (Wirehaired) 1-3-(2-2)
- 14 Dachshunds (Longhaired) 5-5-(3-1)

#### 9:15 AM

- 1 \*Cirneci dell'Etna 0-0-(0-1)
- 5 \*Basset Hounds 1-2-(2-0)
- 13 Borzois 2-6-(4-1)
- 6 Afghan Hounds 1-1-(2-2)
- 55 Total Dogs

### RING TWO

JUDGE: Mrs. Christine E. Calcinari

#### 8:00 AM

- 5 Russell Terriers 2-2-(1-0)
- 13 Norwich Terriers 4-6-(1-2)

#### 8:45 AM

- 2 Norfolk Terriers 0-0-(2-0)
- 4 Staffordshire Bull Terriers 0-2-(0-2)
- 3 Soft Coated Wheaten Terriers 0-2-(0-1)
- 5 Airedale Terriers 2-2-(1-0)
- 12 Pointers (German Shorthaired) 3-1-(3-5)

#### 9:45 AM

- 1 Skye Terriers 0-0-(1-0)
- 5 Spaniels (English Cocker) 1-2-(2-0)
- 9 Scottish Terriers 2-4-(2-1)
- 14 West Highland White Terriers 5-4-(2-3)
- 7 \*Shih Tzu 1-4-(2-0)
- 80 Total Dogs

### RING THREE

JUDGE: Mrs. Sulie Greendale-Paveza

#### 8:00 AM

- 11 Dogo Argentinos 2-5-(2-2)
- 15 Bullmastiffs 1-8-(4-2)

### RING THREE

JUDGE: Mr. Adrian W. Woodfork

#### 9:00 AM

- 12 Boxers 4-5-(2-1)
- 16 Cane Corsos 4-8-(3-1)
- 16 Mastiffs 5-7-(4-0)

#### 10:45 AM

- 5 Newfoundlands 1-0-(1-3)
- 8 Samoyeds 2-0-(3-3)
- 8 Portuguese Water Dogs 1-4-(1-2)
- 65 Total Dogs

### RING FOUR

JUDGE: Mr. Jeffery M. Bazell

#### 8:00 AM

- 14 Chinese Shar-Pei 4-5-(2-3)
- 7 Chow Chows 2-2-(3-0)
- 10 Miniature Pinschers 1-4-(3-2)
- 14 Boston Terriers 3-5-(2-4)

#### 9:45 AM

- 5 Toy Fox Terriers 3-0-(1-1)
- 2 Bichons Frises 0-0-(1-1)
- 12 American Eskimo Dogs 0-5-(3-4)

#### 10:30 AM

- 14 Pekingese 5-5-(2-2)
- 13 Yorkshire Terriers 6-4-(1-2)
- 91 Total Dogs

### RING FIVE

JUDGE: Ms. Amy Sorbie

#### 8:00 AM

- 2 Bloodhounds 0-1-(1-0)
- 2 English Foxhounds 0-0-(1-1)
- 3 Harriers 0-0-(2-1)
- 9 Ibizan Hounds 2-4-(2-1)
- 7 Irish Wolfhounds 2-3-(0-2)
- 3 Basenjis 0-0-(3-0)

See Ring 6 at 9:15 AM for balance of assignment.

## SUNDAY

### 9:00 AM

- 6 \*Brussels Griffons 2-3-(1-0)
- 2 \*Collies (Smooth) 0-0-(2-0)
- 17 \*Border Collies 4-6-(2-5)

### 10:15 AM

- 2 Grand Basset Griffon Vendeens 1-0-(1-0)
- 4 \*Collies (Rough) 0-2-(1-1)
- 6 \*Chihuahuas (Smooth Coat) 1-3-(1-1)
- 15 \*Chihuahuas (Long Coat) 5-6-(2-2)

### 11:30 AM

Lunch

### 12:15 PM

- 9 \*Shetland Sheepdogs 2-4-(3-0)
- 10 Maltese 3-5-(2-0)
- 17 \*Havanese 6-6-(1-4)

114 Total Dogs

### RING SIX

JUDGE: Mrs. Sulie Greendale-Paveza

### Continuation of assignment from Ring 3 at 8:00 AM

### 9:15 AM

- 1 German Pinschers 0-0-(1-0)
- 2 Belgian Malinois 1-0-(1-0)
- 1 Anatolian Shepherd Dogs 0-1-(0-0)
- 1 Boerboels 1-0-(0-0)
- 3 Alaskan Malamutes 1-1-(0-1)
- 3 Kuvaszok 1-1-(1-0)
- 4 Giant Schnauzers 1-0-(2-1)
- 4 Great Pyrenees 1-1-(1-1)
- 7 Akitas 1-3-(2-1)

### 10:15 AM

- 5 Black Russian Terriers 1-2-(2-0)
- 5 Leonbergers 3-0-(0-2)
- 11 Belgian Sheepdogs 1-3-(3-4)
- 12 Belgian Tervuren 5-1-(2-4)

### 11:30 AM

- 1 Bernese Mountain Dogs 0-0-(1-0)
- 4 Tibetan Spaniels 0-0-(2-2)
- 5 Tibetan Terriers 1-3-(1-0)
- 11 Schipperkes 4-3-(4-0)

106 Total Dogs

### RING SEVEN

JUDGE: Mrs. Karen McFarlane

### 8:00 AM

- 31 Great Danes 8-10-(9-4)

### 9:15 AM

- 14 Saint Bernards 4-6-(2-2)
- 17 Rottweilers 7-6-(3-1)

### 10:30 AM

- 6 Flat Terriers 0-1-(3-2)
- 1 Xoloitzcuintli 0-0-(1-0)
- 27 Doberman Pinschers 5-13-(5-4)

96 Total Dogs

### RING EIGHT

JUDGE: Mr. Nathaniel Horn

### 8:00 AM

- 8 Wirehaired Pointing Griffons 1-1-(3-3)
- 9 Weimaraners 1-5-(1-2)
- 19 Vizslas 7-6-(5-1)

### 9:15 AM

- 1 Pyrenean Shepherds 1-0-(0-0)
- 4 Pumik 0-1-(1-2)
- 5 Petits Bassets Griffons Vendeens 2-0-(1-2)
- 1 Spaniels (Irish Water) 0-0-(0-1)
- 6 Setters (English) 2-1-(2-1)
- 7 Pharaoh Hounds 1-0-(4-2)
- 6 Setters (Irish) 0-2-(2-2)

### 10:15 AM

- 4 Retrievers (Flat-Coated) 0-3-(0-1)
- 4 Spinoni Italiani 0-0-(2-2)
- 4 Setters (Gordon) 2-1-(1-0)
- 2 Spaniels (Boykin) 0-0-(2-0)
- 1 Spaniels (Field) 1-0-(0-0)
- 2 Spaniels (Cumber) 0-0-(1-1)
- 2 Spaniels (Welsh Springer) 0-0-(2-0)
- 7 Spaniels (English Springer) 0-2-(2-3)
- 10 Ret (Nova Scotia Duck Tolling) 0-5-(2-3)

102 Total Dogs

### RING NINE

JUDGE: Mr. James G. Reynolds

### 8:00 AM

- 50 French Bulldogs 22-19-(6-3)

### 9:45 AM

- 13 Bulldogs 3-6-(3-1)
- 3 Norwegian Elkhounds 0-0-(2-1)
- 3 Swedish Vallhunds 1-1-(1-0)
- 10 Chinese Cresteds 1-1-(4-4)

79 Total Dogs

### RING TEN

JUDGE: Mr. D. Scott Pfeil

### 8:00 AM

- 25 Whippets 10-8-(5-2)

### 9:00 AM

- 1 Portuguese Podengo Pequenos 0-0-(0-1)
- 1 Danish-Swedish Farmdogs 1-0-(0-0)
- Best in Miscellaneous Class
- 15 Pugs 0-5-(7-3)
- 6 Salukis 4-1-(1-0)

### 10:00 AM

- 32 Rhodesian Ridgebacks 8-10-(11-3)

80 Total Dogs

### RING ELEVEN

JUDGE: Ms. Peggy Beisel-McIlwaine

### 8:00 AM

- 1 Manchester Terriers (Toy) 0-0-(1-0)
- 7 Border Terriers 1-4-(2-0)
- 16 American Hairless Terriers 5-6-(4-1)
- 22 Cavalier King Charles Spaniels 6-10-(4-2)

### 9:45 AM

- 5 Bull Terriers (Colored) 1-1-(1-2)
- 6 Bull Terriers (White) 1-5-(0-0)
- 6 American Staffordshire Terriers 2-2-(1-1)
- 7 Standard Schnauzers 0-1-(3-3)

## SUNDAY

### 10:45 AM

- 3 Bedlington Terriers 2-0-(0-1)
- 6 Fox Terriers (Smooth) 1-1-(2-2)
- 8 Fox Terriers (Wire) 0-2-(4-2)
- 7 Biewer Terriers 2-1-(1-3)

94 Total Dogs

### RING TWELVE

JUDGE: Mr. Jeffrey Kestner

### 8:00 AM

- 2 English Toy Spaniels (KC & R) 0-1-(0-1)
- 3 \*Affenpinschers 0-0-(2-1)
- 15 \*Papillons 2-5-(5-3)

### 9:00 AM

- 5 English Toy Spaniels (B & PC) 1-2-(1-1)
- 20 Pomeranians 7-6-(5-2)

### 10:00 AM

- 7 Japanese Chin 3-2-(1-1)
- 18 Italian Greyhounds 6-7-(3-2)

70 Total Dogs

### RING THIRTEEN

JUDGE: Ms. Linda Robey

### 8:00 AM

- 1 Canaan Dogs 0-0-(1-0)
- 2 Berger Picards 1-0-(0-1)
- 9 German Shepherd Dogs 1-7-(1-0)
- 20 Pembroke Welsh Corgis 4-8-(6-2)

### 9:15 AM

- 23 Cardigan Welsh Corgis 4-6-(6-7)
- 16 Mudik 2-8-(3-3)

### 10:45 AM

- 4 Icelandic Sheepdogs 0-3-(0-1)
- 1 Briards 1-0-(0-0)
- 8 Bouviers des Flandres 2-2-(2-2)
- 12 Siberian Huskies 1-6-(2-3)

### 11:45 AM

Lunch

### 12:30 PM

- 14 Old English Sheepdogs 2-8-(2-2)
- 19 Miniature American Shepherds 6-7-(3-3)

129 Total Dogs

### RING FOURTEEN

JUDGE: Ms. Edweena (Teddy) McDowell

### 8:00 AM

- 8 Australian Cattle Dogs 1-1-(4-2)
- 22 Australian Shepherds 5-10-(4-3)

### 9:15 AM

- 5 Beaucerons 2-1-(2-0)
- 5 Brittanys 0-2-(2-1)
- 40 Retrievers (Labrador) 16-18-(4-2)

### 11:15 AM

- 3 Spaniels (Cocker) Black 0-0-(1-2)
- 8 Spaniels (Cocker) Parti-Color 2-2-(1-3)
- 8 Bearded Collies 1-4-(1-2)
- 9 Spaniels (Cocker) A.S.C.O.B. 3-4-(2-0)

108 Total Dogs

### RING FIFTEEN

JUDGE: Mrs. Debbie L. Melgreen

### 8:00 AM

- 2 Bracchi Italiani 1-1-(0-0)
- 3 Pointers 0-1-(1-1)
- 65 Retrievers (Golden) 19-32-(10-4)

### 10:45 AM

- 1 Lagotti Romagnoli 0-0-(1-0)

### Junior Showmanship Competition

- 2 Novice Junior
- 1 Novice Intermediate
- 6 Open Junior
- 10 Open Intermediate
- 8 Open Senior
- 1 Master
- Best Junior Handler

### 12:15 PM

Lunch

### 1:00 PM

- 7 Retrievers (Chesapeake Bay) 2-3-(2-0)
- 3 Beagles, 13 Inch 0-0-(0-3)
- 20 Beagles, 15 Inch 6-9-(2-3)

129 Total Dogs

### RING SIXTEEN

JUDGE: Ms. Kathi Brown

### 8:00 AM

- 7 Dalmatians 2-1-(1-3)
- 5 Shiba Inu 2-3-(0-0)
- 1 Lakeland Terriers 0-1-(0-0)
- 1 Dandie Dinmont Terriers 0-0-(0-1)
- 1 Manchester Terriers (Standard) 0-1-(0-0)
- 4 Cesky Terriers 0-2-(1-1)
- 6 Cairn Terriers 1-1-(1-3)

### 9:00 AM

- 6 Cotons de Tulear 0-3-(1-2)
- 10 Poodles (Toy) 5-3-(1-1)
- 4 Miniature Bull Terriers 0-2-(1-1)
- 1 Finnish Spitz 0-0-(1-0)
- 1 Irish Terriers 0-0-(1-0)
- 3 Kerry Blue Terriers 0-0-(3-0)
- 5 Keeshonden 1-1-(2-1)

### 10:15 AM

- 4 Poodles (Miniature) 1-1-(1-1)
- 12 Miniature Schnauzers 4-1-(4-3)
- 14 Russian Toys 6-2-(4-2)

### 11:30 AM

- 6 Lhasa Apsos 2-0-(1-3)
- 19 Poodles (Standard) 6-8-(4-1)

110 Total Dogs

**SUNDAY  
RING SEVEN**

**1:00 PM Variety Groups and Best in Show**

(The groups will be judging in the following order unless otherwise announced)

Terrier .....	Mr. James G. Reynolds
Non-Sporting .....	Mrs. Karen McFarlane
Working .....	* Ms. Linda Robey
Sporting .....	Mrs. Debbie L. Melgreen
Herdng .....	Mrs. Sulie Greendale-Paveza
Toy .....	* Ms. Amy Sorbie
Hound .....	Mrs. Christine E. Calcinari
Best in Show .....	Mr. Jeffery M. Bazell

**RING TWO**

**12:30 PM Owner-Handled Variety Groups and Best Owner-Handled in Show**

Owner-Handled Terrier .....	Mrs. Sulie Greendale-Paveza
Owner-Handled Non-Sporting .....	Ms. Judy Wade
Owner-Handled Working .....	Mrs. Barbara A. Shaw
Owner-Handled Sporting .....	Dr. Clyde E. Shaw
Owner-Handled Herding .....	Ms. Kathi Brown
Owner-Handled Toy .....	Mrs. Christine E. Calcinari
Owner-Handled Hound .....	Mr. James Donahue
Best Owner-Handled in Show .....	Mr. Jeffrey Kestner

**ALL-BREED JUDGES**

Mr. Jeffery M. Bazell .....	231 Marietta St., Bremen, OH 43107
Ms. Peggy Beisel-McIlwaine .....	6225 N. Maple Rd., Ann Arbor, MI 48105
Ms. Kathi Brown .....	296 Taylor Rd., Stow, MA 01775
Mrs. Christine E. Calcinari .....	1246 South St., Portsmouth, NH 03801
Mr. James Donahue .....	27722 W. Brandenburg Rd., Ingleside, IL 60041
Mrs. Mary Grace Eubank .....	5523 Del Roy Dr., Dallas, TX 75230
Mrs. Sulie Greendale-Paveza .....	6715 Deleon Ave., Fort Pierce, FL 34951
Mrs. Carla M. Holt .....	4017 Blackthorn Pl., La Grange, KY 40031
Mr. Nathaniel Horn .....	101425 Overseas Hwy. PMB 108, Key Largo, FL 33037
Mr. Jeffrey Kestner .....	231 Marietta St., Bremen, OH 43107
Ms. Edweena (Teddy) McDowell .....	12130 S. Moonlight Rd., Olathe, KS 66061
Mrs. Karen McFarlane .....	15826 Oakmont Dr., Kearney, MO 64060
Mrs. Debbie L. Melgreen .....	386 Knox Rd. 2300 E., Yates City, IL 61572
Mr. D. Scott Pfeil .....	27722 W. Brandenburg Rd., Ingleside, IL 60041
Mr. James G. Reynolds .....	3580 Rivergate Way Ste. 405, Ottawa, ON, CN K1V 1V5
Ms. Linda Robey .....	4491 Green Valley Dr., High Ridge, MO 63049
Mrs. Barbara A. Shaw .....	322 Russell Ln., Denison, TX 75021
Dr. Clyde E. Shaw .....	322 Russell Ln., Denison, TX 75021
Ms. Carolyn Snavey .....	4960 Timbercrest Dr., Canfield, OH 44460
Ms. Amy Sorbie .....	4186 S. Pagosa Ct., Aurora, CO 80013
Ms. Judy Wade .....	608 Willow Springs Rd., Mead, OK 73449
Mr. Adrian W. Woodfork .....	5912 Park Village St., Sacramento, CA 95822

**\*PROVISIONAL/PERMIT JUDGE - SEE ASSIGNMENTS**

**IMPORTANT** - TRANSFERS of dogs from regular classes to Best of Breed/Variety Competition (Ch. 11 Section 6, AKC Rules) MUST be made to the Superintendent/Show Secretary at least one half hour prior to the start of any regular conformation judging at this show. TRANSFERS by Junior Handlers from Novice to Open Class or from the Open to Master Class MUST be made to the Superintendent/Show Secretary prior to the judging of the class at the show. SUBSTITUTIONS of Junior Showmanship dogs must be made prior to the judging of the class at the show.

**Attention Exhibitors  
Dallas Market Hall**

**Over 170,000 Square Feet of Space All on One Level!**

**Exhibitor Access Wednesday through Sunday:**

PROOF OF ENTRY WILL BE REQUIRED FOR EXHIBITOR BUILDING ACCESS WEDNESDAY THROUGH SUNDAY OF THE EVENT. Exhibitor identification (wristbands) will be distributed to all exhibitors, which will be good for all days of the event FOR ACCESS TO THE BUILDING AND TO THE SHOW FLOOR WHERE THE RINGS ARE LOCATED (one entry does NOT allow admittance to multiple family members and/or friends). Exhibitor identification may be picked up at the Information Table located next to the Superintendent area in Main Hall on any day with proof of entry. **Do not ask for multiple wristbands – only one will be distributed per person at the Information Table for security and health reasons.** Please put your Exhibitor identification in a place where you can locate it easily to wear at all times when going in and out of the building – do not lose it! Security guards and show officials will be checking for your Exhibitor identification – if you do not have it, you will be stopped and required to show proof of entry even if you have a dog with you. This will be strictly enforced and is in place for the safety of both you and your dogs.

**ANY EXHIBITOR ARGUING WITH OR IGNORING LONE STAR STATE CLASSIC SHOW OFFICIALS OR SECURITY GUARDS, EXHIBITING UNSPORTSMANLIKE BEHAVIOR, OR VIOLATING ANY SHOW OR AKC RULE WILL BE SUBJECT TO EVENT COMMITTEE JURISDICTION.**

**Preferred Grooming Space:**

In order to provide better comfort and protection for you and your dogs, the Lone Star State Classic will offer preferred crating and grooming space. This will allow you to unload dogs at your leisure, when the building is fully temperature controlled. For exhibitors who do not show until Saturday, you can save on hotel bills, and still be assured of having a space.

Reservations close on **Wednesday, January 24, 2024 or until limit is reached.**

- SOFT-SIDED CRATES WILL BE ALLOWED in the building but are not allowed to be stacked.
- The show committee reserves the right to request the relocation, removal, or restriction of any chairs, crates, or other equipment anywhere in or around the building it deems necessary.
- RINGSIDE CRATING & SMALL TOY BREED TABLES will be allowed around their respective breed rings no earlier than 10 minutes prior to scheduled breed judging & MUST be removed immediately following completion of breed judging.
- NO GROOMING TABLES OF ANY SIZE WILL BE ALLOWED RINGSIDE. Foldable Toy Breed tables only, & only for time of breed judging.
- Crates and/or Toy Breed tables must not be left overnight in Main Hall around any of the rings. Each evening, the Show Committee will remove & discard all crates, and other equipment left around the rings.
- **Do not remove the chairs provided by the LSSC from around or within the rings or in Club or Superintendent Areas. Any violation is subject to discipline.**

**Site Availability:**

1. a. Exhibitors can drive in to unload from 6:30 P.M. to 8:30 P.M. on Wednesday, February 7, 2024. This is subject to change by the event committee so check the LSSC website for any updates. All vehicles must be removed by 9:00 P.M. Wednesday. Unloading after 9:00 P.M. will be done from the loading dock area.  
b. Drag in unloading times are 6:30 P.M. to 11:00 P.M. on Wednesday, February 7, 2024.  
c. The LSSC reserves the right to deny any vehicle access to drive into the building due to size of vehicle and/or safety considerations.
2. All engines and generators must be turned off during unloading and loading.
3. The building will be locked at 11:00 P.M. on Wednesday. The building hours other days of the event are: Thursday - 6:00 A.M. to 11:00 P.M., Friday - 6:00 A.M. to 11:00 P.M., Saturday - 6:00 A.M. to 11:00 P.M., Sunday - 6:00 A.M. to 8:00 P.M.
4. Exhibitors are required to unload and remove their vehicles as quickly as possible. You can set up your equipment after your vehicle is removed.
5. All dogs and equipment must be removed immediately following BIS on Sunday, February 11, 2024. The building is fully temperature controlled except during hours of vehicle access. Please plan accordingly.

**Reserved RV Parking Reservations:**

- See RV Parking Reservation Form on Page 8 of the Premium List..

**Access and Parking:**

1. All loading and unloading must be done through the **designated** Loading Doors in the North Hall and Freeway Hall. No crates, dollies, pens, or other equipment can be transported through other doors or entrances to the building.
2. Absolutely no cones allowed in parking areas
3. NEW! Two types of RV Parking will be offered at our February, 2024 Event – Free NON-RESERVED RV PARKING in the normal RV Parking area and RESERVED RV PARKING in an area closer to the North Hall. Reservations are required for the RESERVED RV PARKING LOT. Please see the RV Parking Reservation form and maps of the RV parking lots in the Premium List. Deadline for reservations for the Reserved Lot is January 24, 2024. No reservation is necessary for the Non-Reserved RV Lot. Locations are on a first come, first park basis in both areas starting no earlier than Wednesday, February 7th, at 12 Noon.
4. Absolutely no dumping of holding tanks on the grounds – Any unit suspected of a gray water or sewage leakage will be asked to leave the parking lot.
5. All vehicles must be removed from the facility immediately following Best in Show on Sunday, February 11th, 2024.



6. During the show, all exhibitors will enter the property through the North Hall or Freeway Hall doors where the main grooming areas are located. The Main (Spectator) Entrance will be at the North West Entrance to the Main Hall (Main entrance). **No dogs or equipment are allowed through the North West (Main) Entrance.**

#### **Reserved Grooming Reservations:**

- See Grooming Reservation Form on Page 9 of the Premium List..

#### **All Crating and Grooming Space:**

1. Crating and Grooming Space will be reserved, although space will be provided for exhibitors without reservations (non-reserved) and for day crating. **ALL CRATES MUST BE MARKED WITH EMERGENCY CONTACT INFORMATION.**
2. Soft-sided crates will be allowed in the building BUT WILL NOT BE ALLOWED TO BE LEFT WITH A DOG IN THEM UNSUPERVISED OR OVERNIGHT. Soft-sided crates are not allowed to be stacked.
3. The Show Committee will mark all crating and grooming space. Only approved crating and grooming space may be used. ROPING OFF OF OR OTHERWISE RESERVING UNUSED CRATING AND GROOMING SPACE IS NOT ALLOWED.
4. The Show Committee reserves the right to remove exercise pens anywhere in or around the building.
5. There will be space provided somewhere in the building for private exercise pens for those in non-reserved grooming with a limit of two ex-pens per set-up. **THIS LIMITED SPACE PROVIDED FOR THESE PENS ARE FOR NON-RESERVED GROOMING ONLY** – Reserved spaces should have enough room for the exhibitor's ex-pens and they should not use the non-reserved pen space. Any pens set up in the non-reserved area that belong to a holder of a reserved space will be moved by the Show Committee.
6. **POSITIVELY NO EXERCISING WILL BE PERMITTED OUTSIDE THE BUILDING EXCEPT IN DESIGNATED AREAS.** Dogs are not allowed in the landscape area around Dallas Market Hall, in the lawn or shrubs around the complex, or on the landscape area (lawn or shrubs) around the Renaissance Dallas Hotel across the street. This will be monitored. Outdoor exercise pens will be provided. IN CASE OF ACCIDENTS, POOP BAGS ARE AVAILABLE AT MULTIPLE LOCATIONS BOTH INSIDE AND OUTSIDE THE BUILDING. **Exhibitors are expected to clean up after their dogs on all occasions. This will help retain the show site for future events. Any disregard of the above policy may result in an Event Committee Hearing.**
7. **NO PLASTIC ALLOWED ON FLOORS UNDER ANY EXERCISE PENS ANYWHERE IN THE BUILDING.** Plastic is allowed on the sides of exercise pens. Please use sawdust (shavings) in pens & change daily. Sawdust (shavings) will be provided for a fee by the Lone Star State Classic if you have forgotten to bring your own, and is located at the Information Table in the Main Hall. **NO ELECTRICAL CORDS** allowed in the aisles. No sod allowed in the building.
8. Each exhibitor is responsible for cleaning his set-up each day. **REMEMBER TO BRING A BROOM**
9. Public exercise pens will be provided & must be attended by owner or handler while in use.
10. No tents are allowed in Non-Reserved grooming space. Pop-ups will be allowed in Reserved grooming space, but may not have sides, or tent walls (canopies only). This must be within the allotted reserved space with no encroachment on other spaces or aisles. Be a good neighbor.

#### **Reserved Grooming Area:**

1. Sawdust (shavings) and/or paper are allowed in or under ex-pens in Reserved Grooming. **No plastic is allowed under pens anywhere in the building.**
2. Breathable mats are allowed in Reserved Grooming areas.
3. There will be space provided somewhere in the building for private exercise pens for those in non-reserved grooming. **Reserved spaces should have enough room for the exhibitor's ex-pens and they should not use the non-reserved pen space.** Any pens set up in the non-reserved area that belong to a holder of a reserved space will be removed by the Show Committee.

#### **Non-Reserved Grooming Area:**

1. Please stack crates (with the exception of soft-sided crates).
2. The Show Committee reserves the right to require the stacking of crates, limiting the use of exercise pens, and any other remedies it may deem necessary for space in non-reserved spaces on a case by case basis at their discretion.
3. No rugs or mats allowed in non-reserved grooming areas. **No plastic is allowed under pens anywhere in the building.**
4. **THERE WILL BE NO EXERCISE PENS ALLOWED IN NON-RESERVED GROOMING.** There will be space provided somewhere in the building for private exercise pens for those in non-reserved grooming with a limit of 2 ex-pens per set-up. Ex-pens must be labeled and kept clean. **SAWDUST AND/OR PAPER ONLY must be used in the ex-pens and must be changed daily. THIS LIMITED SPACE PROVIDED FOR THESE PENS ARE FOR NON-RESERVED GROOMING ONLY.**

#### **Day Crating Area:**

Space will be provided for exhibitors who want to "Show and Go". Crates & grooming tables will be allowed. No exercise pens or drop pens in Day Crating. Everything must be removed immediately following Best in Show judging each day or the Show Committee will remove & discard same.

#### **Security:**

24-hour security will be provided inside and outside the building.

**The Lone Star State Classic, Texas Kennel Club Inc, Trinity Valley Kennel Club, Inc., Greater Collin Kennel Club, Inc., the Superintendent, their agents, employees, etc. assume no responsibility for any loss, damage or injury sustained by exhibitors, handlers, or to any of the dogs or property, and further assume no responsibility for injury to children or damage caused by a dog.**

All persons attending these dog shows hereby waive any claims for damages against the Greater Collin Kennel Club, Inc., the Texas Kennel Club, Inc., the Trinity Valley Kennel Club, Inc., the Superintendent or their members in the event a motor vehicle must be entered to rescue a dog from overheating or suffocation due to improper ventilation.

**Building Rules:**

1. NO ALCOHOLIC BEVERAGES ARE ALLOWED TO BE BROUGHT INTO THE BUILDING. SMOKING AND/OR USING TOBACCO PRODUCTS ARE PROHIBITED IN ANY SPACE IN DALLAS MARKET HALL.
2. NO FOOD OR DRINKS MAY BE BROUGHT INTO THE BUILDING FROM FRIDAY THROUGH SUNDAY. ONLY FOOD PURCHASED FROM THE CONCESSIONAIRES CAN BE CONSUMED IN THE BUILDING ON THOSE DAYS. FOOD MAY BE BROUGHT INTO THE BUILDING ON THURSDAY(SPECIALTY DAY)
3. UNENTERED DOGS ARE NOT ALLOWED IN THE BUILDING.
4. Skates (including shoes with rollers), skateboards, scooters, electric bicycles and electric scooters are not allowed in the building (with the exception of ADA approved aids).
5. STROLLERS are allowed in the building at your own risk. Please be careful with Strollers. Don't run over a dog's tail! Since children in strollers are at face level with large dogs, watch out for quick tongues and wagging tails.
6. No decoration of any type shall be attached to the ceiling, walls, floor, furnishings or fixtures. No artificial snow, glitter, confetti, rice, or birdseed is allowed. Balloons of any type, or helium tanks are not allowed.
7. Responsibility for an exhibitor's child is the exhibitor's – both for the child's welfare & any damages done by the child.

**Extension Cord Requirements**

The City of Dallas enforces the 1996 national Electrical Code to ensure the public is not exposed to electrical hazards. This Code has specific requirements for the type of extension cord that may be used and how they are used.

If extension cords are used, Ground Fault Circuit Interrupt Protection (GFCI) is required. This cord is sold at most building or electrical supply stores. These cords are easily recognized as they have a test and a reset button on the cord. Most of these cords have the words "GFCI protected" printed on the cord.

All 120-volt extension cords shall be three wire grounding type cords (recognized by the three-prong plug on the end of the cord). Frayed or damaged cords may not be used. Extension cords may not be placed through doorways or across aisles.

These requirements will help eliminate harmful or fatal electrical hazards to you and/or your animals. City staff, including Fire Inspectors, will check the premises from time to time for your compliance. Your cooperation is appreciated.

**NOTICE**

All rights to TELEVISION, VIDEOTAPE, ADVERTISE, PHOTOGRAPH, PROMOTE or otherwise exploit this event are vested in the Clubs, or in persons to whom assignments of such rights have been made in writing by the Clubs. All persons and animals on the Show grounds at any time while the Shows are in progress, do by attending these shows or participation therein, grant to the clubs the right to photograph, televise, videotape, audiotape or otherwise use their likeness and voice in any manner without further release or consent

The Greater Collin Kennel Club, Inc., Texas Kennel Club, Inc. & Trinity Valley Kennel Club, Inc. do not agree to arbitrate claims as set forth on the Official AKC entry form for these events.

**ACCOMMODATIONS  
HEADQUARTERS HOTEL**

Renaissance Dallas Hotel • 2222 Stemmons Frwy., Dallas TX 75207 ..... (214) 631-2222

*Link for reservations: Go to [www.LoneStarStateClassic.com](http://www.LoneStarStateClassic.com) Click on Exhibitors, Hotel Information, and the Hotel reservation link for the "LSSC Room Reservation Block"*

No dogs • Hotel is on same property & right across from Dallas Market Hall • Block Cutoff date was January 24, 2024  
(One time self-parking charge for hotel guests - \$10.00 per car for your stay)

**HOTELS & MOTELS THAT MAY ACCEPT DOGS (Updated October 2023)**

Please contact hotel for rates and policies (There is no LSSC contracted rate for these hotels listed below)

- Sheraton Suites Market Center • 2101 Stemmons Frwy., Dallas, TX 75207 Pets allowed ..... (214) 747-3000
- Holiday Inn Dallas Market Center • 4500 Harry Hines Blvd., Dallas, TX 75219 Pet friendly ..... (214) 219-3333
- Residence Inn by Marriott Dallas Market Center • 6950 N. Stemmons Frwy., Dallas, TX 75247 Pet friendly..... (214) 631-2472
- Hawthorn Suites Dallas Market Center • 2900 Brookriver Dr., Dallas, TX 75247 Pet friendly..... (214) 306-8409
- Homewood Suites Dallas Market Center • 7700 N. Stemmons Frwy., Dallas, TX 75207 Pet friendly ..... (214) 819-9700
- Embassy Suites Hotel - Dallas Love Field • 3880 W. Northwest Hwy., Dallas, TX 75220 Pet friendly rooms.....(214) 357-4500
- Element - Dallas Love Field..... (469) 466-8072
- 2333 W. Mockingbird Ln., Dallas, TX 75235 Pet friendly, Extended Stay Hotel
- Aloft - Dallas Love Field • 2333 W. Mockingbird Ln., Dallas, TX 75235 Pet friendly ..... (214) 358-7575
- Candlewood Suites - Dallas Market Center • 7930 N. Stemmons Frwy., Dallas, TX 75247 Pets welcome ..... (214) 631-3333
- La Quinta Inn & Suites - Dallas Love Field • 8300 John W. Carpenter Frwy, Dallas, TX 75247 Pets allowed ..... (214) 414-9000
- Holiday Inn Express & Suites Dallas Market Center • 7800 John W. Carpenter Frwy., Dallas, TX 75247 Pet friendly ..... (214) 951-9198

**FOR RV PARKING OFFSITE**

- Dallas/ Arlington KOA • 2715 S. Cooper, Arlington, TX 76015 ..... (817) 277-6600
- Plantation Place • 345 Barnes Bridge Rd., Sunnyvale, TX 75812..... (469) 846-9839
- Traders Village • 2602 Mayfield Dr., Grand Prairie, TX 75052 ..... (972) 647-8205
- Treetops RV Resort • 1901 W. Arbrook Blvd., Arlington, TX 76015..... (817) 467-7943
- Sandy Lake RV Park • 1915 Sandy Lake Rd., Carrollton, TX 75006..... (972) 242-6808

## DALLAS MARKET CENTER

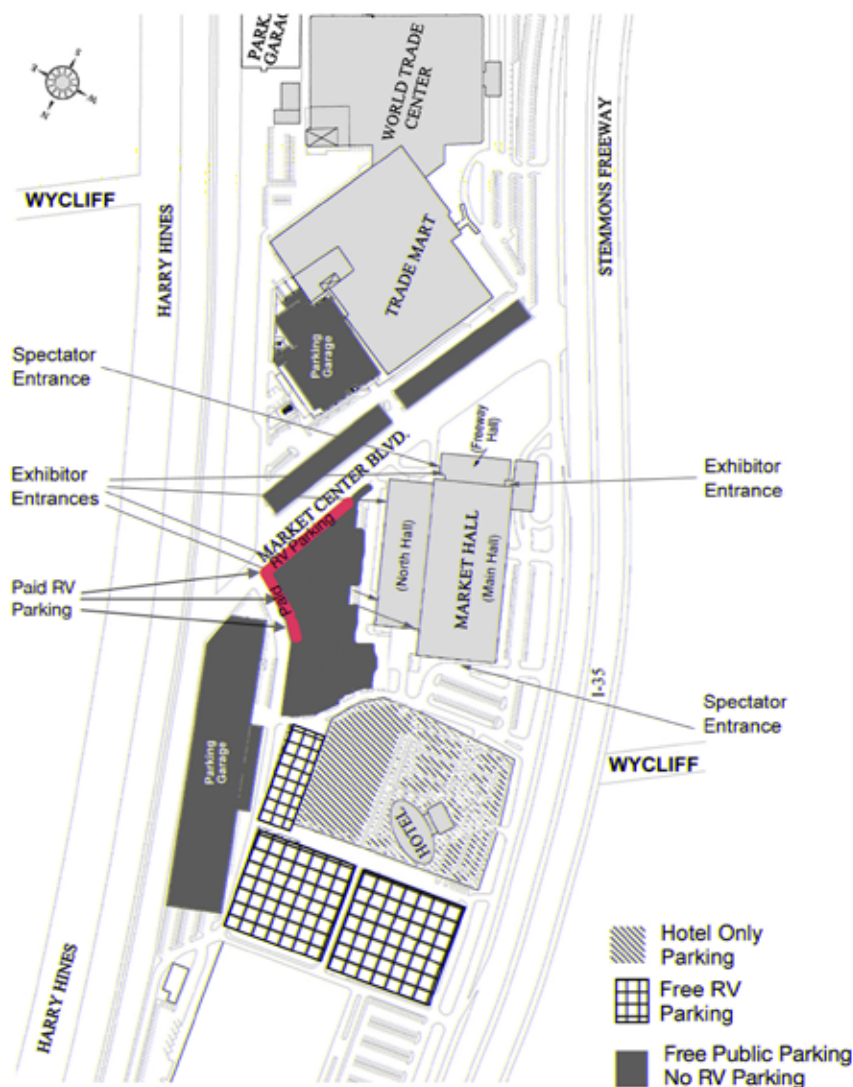

### ROUTES TO THE SHOW

**From I-35 E Southbound** - Exit at Wycliff Ave. Turn Left on Wycliff Ave. Building is straight ahead and on the right.

**From I-35 E Northbound** - Exit at Oak Lawn Ave. Stay on access road northbound past Market Center Blvd. Building is on the right.

From The Makers Of The

#1

VETERINARIAN  
RECOMMENDED

Probiotic Supplement\*



CONVENIENT  
CHEWABLE TABLET!  
AVAILABLE IN 45-COUNT  
AND 90-COUNT

Everything you love about  
Purina® Pro Plan® Veterinary Supplements  
FortiFlora®, in an easy-to-feed tablet.

DIETARY MANAGEMENT OF PUPPIES AND DOGS WITH DIARRHEA	PROMOTES A STRONG IMMUNE SYSTEM	EASY TO FEED
--	---------------------------------------	--------------

ORDER TODAY ON [PROPLANVETDIRECT.COM](http://PROPLANVETDIRECT.COM).  
ALSO AVAILABLE AT PET SPECIALTY RETAILERS AND YOUR VETERINARIAN.



\*Kynotec, Probiotic Recommendation Study, March 2019.

Purina trademarks are owned by Société des Produits Nestlé S.A.



Your Pet, Our Passion.®