

How to fit a Buoyancy aid.



Step 1 Loosen all straps and buckles.

Step 2 Put on the buoyancy aid and do up any front buckles or front zips.

Step 3 Tighten all straps, starting from the waist and working your way upwards to the shoulder straps. Finish by sitting down and checking shoulder straps.

*Please make sure when fitting the child's buoyancy aid you fasten the leg strips under their legs, this will stop the buoyancy aid from riding up and coming off.

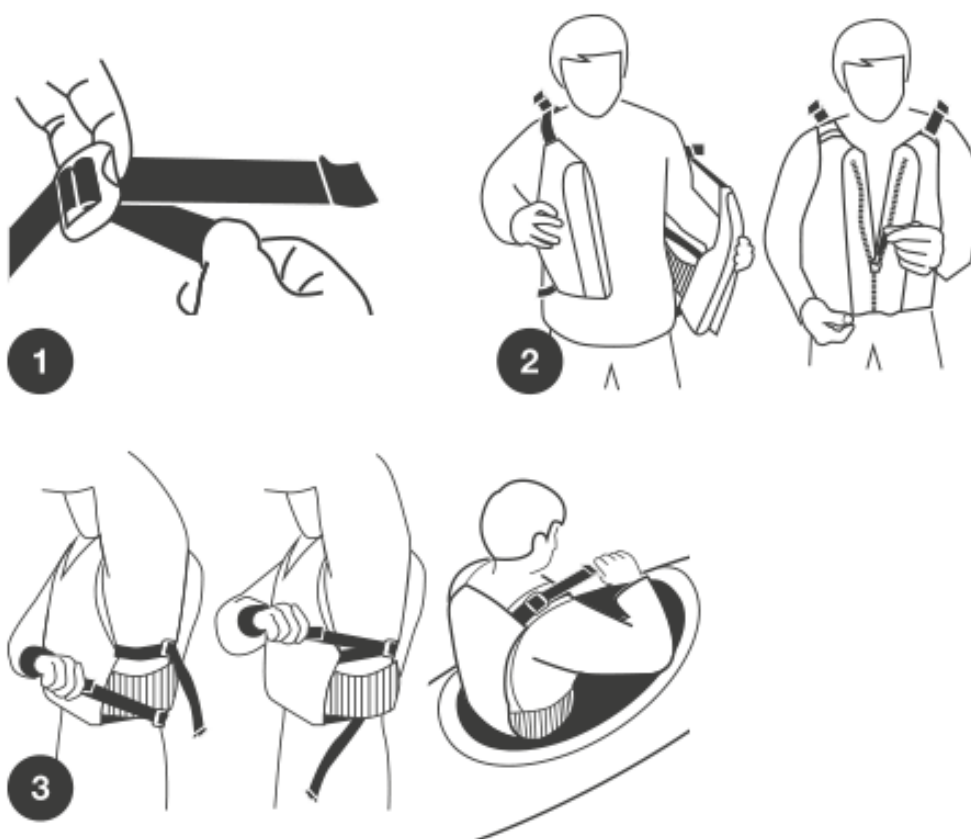

Please DO NOT use as a seat, this could save your life.