



ATLAS LIFTING & RIGGING



STRENGTH • SAFETY • RELIABILITY



We are committed to building the

ATLAS LIFTING & RIGGING IS A GLOBAL LEADER IN INNOVATION AND MANUFACTURING OF CHAIN HOISTS WITH ITS CORPORATE HEADQUARTERS BASED IN THE UNITED STATES. WE HAVE DISTRIBUTION CENTERS AND REPAIR CENTERS STRATEGICALLY LOCATED ACROSS THE US AND HAVE EXCLUSIVE PARTNERS IN EVERY CONTINENT OF THE WORLD.

Atlas Lifting & Rigging with over 270,000 sq. ft. of manufacturing, has one of the most advanced manual hoist manufacturing facilities in the world. Our manufacturing principles and philosophies are based on European and American standards.

The origins of our engineering, manufacturing and strict quality control processes trace back to centuries of German engineered and production techniques. We have blended hundreds of years of European and American hoist manufacturing expertise with today's cutting-edge engineering technology and advanced manufacturing to create a hoist that is designed to be the Strongest, Safest and Most Reliable hoist possible.



OUR COMPANIES HAVE A PROVEN TRACK RECORD OF PROVIDING THE HIGHEST QUALITY AND MOST RELIABLE MANUAL HOISTS IN THE WORLD. FOR DECADES OUR COMPANIES HAVE SUPPLIED MANUAL HOISTS TO SOME OF THE MOST WELL-KNOWN AND RESPECTED COMPANIES AROUND THE GLOBE.



Many years ago, the founder of ALR had a vision of how his companies could change the future of the global hoist industry. He saw that the world was becoming much more connected and there was an opportunity to do something that had never been done before.

He envisioned building a line of hoists that would be unmatched in the industry. He would then deliver his products direct to local distributors around the globe. He could deliver the best technology the industry has to offer at an affordable price to every job site in the world.

ATLAS LIFTING & RIGGING

STRONGEST, SAFEST, and MOST RELIABLE hoists in the world.

BUILT TO HANDLE THE TOUGHEST JOBS

- Atlas Lifting & Rigging Premium hoists are designed for pulling, lifting and positioning loads on the toughest job site. Whether your job site is an oil rig, a construction site, a fab shop, a shipyard or any other tough workplace, we have you covered.
- Our Premium chain hoists are engineered for the harshest of environments and deliver exceptional durability to meet your toughest demands.
- Packed with a patented US-Made EXTREME APPLICATION lubricant that will keep you working in the harshest environments and extreme temperatures.
- Our ultimate strength is more than 4 times Workload Limit (WLL) meeting structural requirements for use in tough applications. Every hoist is tested and certified to 150% of rated capacity.
- The Load Carrying Side Plates carry most of the load on a hoist. Our side-plates are 20% stronger because we upgraded to alloy steel rather than carbon steel like all the competition. This gives our product the strongest structure in the industry.
- Unlike most manufacturers, our hoists have a drop forged and then welded pinion shaft with Titanium for ultimate strength to give another layer of structural integrity that other competitor don't offer.
- We are committed to building the strongest hoist in the world.

BUILT TO KEEP YOU SAFE

- Every Atlas hoist is tested manually and by machine to meet our strict manufacturing requirements. Most manufactures test randomly.
- Loaded with industry leading safety features to keep you safe on the job site.
- Compact design to be light weight and durable for confined spaces and heavy loads.
- Heavy duty cast hook latches designed to allow user to actuate the latch easily without putting a finger into the hook opening which will keep your fingers from being injured and will keep your load in place and keep you safe.
- We are one of the only manufacturers to have all our manufacturing and batch identification marking on our hooks to give you complete traceability
- We are committed to building the safest hoist in the world.

BUILT TO LAST

- Atlas Lifting & Rigging Premium hoists are built to the highest tolerances and with the best materials so you know it will last. We are committed to building the best hoists in the world.
- We upgraded everything on our hoists — US-made Extreme Grease, Gears, Bearings, Braking System, Load Carrying Side Plates, Chrome Plated Corrosive Resistant Internal Parts, Welded Pinion Shafts, Handle Grips, Hooks, Safety Latches, Chain.. You name it and we have upgraded it.
- We are committed to building the most reliable hoist in the world.

Every ALR Hoist meets or exceeds ANSI / ASME HST-3 Standards

BUILT TOUGH



We are committed to building the

ALR PREMIUM HOISTS



STRENGTH • SAFETY • RELIABILITY

STRONGEST, SAFEST, and MOST RELIABLE hoists in the world.



HEAVY DUTY

“We deliver it everyday”



High-Performance USA Blue Grease

This Premium American-Made blue grease is specifically formulated to excel in extreme conditions, such as: High operating temperatures, Contaminated environments (water, dust), Heavy loading, Extended re-lubrication intervals.

- RELIABILITY



Zinc "Flake" Coating

We are one of the only manufacturers to use "Zinc Flake" coating on crucial parts. The use of this type of coating gives our hoist the ability to last in extreme environments such as in or around saltwater. In extensive Salt Spray testing, our hoists last more than 200 hours before rusting appears. Most of our competitors will only last 30 hours before rusting appears.

- RELIABILITY



Upgraded High-Strength Alloy Side Plates

The Load Carrying Side Plates carry most of the load on a hoist. Our side plates are 20% stronger because we upgraded to alloy steel rather than carbon steel like most competitors. This gives our product the strongest structure in the industry.

- STRENGTH



Welded Structural Stay Bolts

Our Lever Hoists have structural stay bolts welded directly to the side plate instead of simply fastening them like most competitors. This is a crucial upgrade to the lever hoist that increases strength and safety by a large factor.

- STRENGTH



Sintered Brake System on all ALR Hoists

We have upgraded all our hoist to come standard with a Sintered Braking System. The design starts with applying high heat and pressure to copper, a high-performance metal. Other materials and metallic particles are then fused together to give the brake pad its extraordinary strength. The result is a brake system that won't crack, shatter or absorb moisture and holds up to the heaviest hoist loads.

- SAFETY



Quick-Adjust Free Spool Feature

Engineered to allow for quick hoist positioning, our lever hoists have a new and innovative way to adjust without accidentally freewheeling under load.

Our hoist does not have to be under load to adjust with the ratchet unlike our competitors hoists which must have a load on the hoist in order to adjust the length of the chain with the ratchet.

- SAFETY



Drop Forged Pinion Shaft

Our lever hoist pinion shafts and washers are drop forged with Titanium embedded into the metal creating a single strong shaft for ultimate strength. Most manufacturers simply add a washer onto their pinion shafts.

- STRENGTH



Caged & Sealed Roller Bearings

Caged and Sealed Roller bearings provides smooth, controlled operation of the gears and shafts. This ensures maintenance-free lubrication and increased efficiency

- STRENGTH

Rigging is one of and **MOST RELIABLE** hoists in the world.



Quick Hook Replacement Design

The top hook of our chain hoist is easy to remove from the body of the hoist, making it easier to replace hooks that have been stretched or otherwise damaged due to an overload condition. The bolt holding the hook in place can be removed without disassembling the hoist body. This new configuration minimizes the hoist's headroom; plus, it makes the ALR hoist the better choice as a dedicated trolley-mounted hoist.

- RELIABILITY



Forged Identity Markings

We are one of the only manufacturers to have our manufacturing identifying marks and production date codes, plus the hook's rated capacity, embedded on the sides of the hook during the drop forge operation. Traceability is a key component of being an ISO certified manufacturer of hoists.

- SAFETY



Heavy-Duty Cast Steel Safety Latch

This new Heavy-Duty cast-steel safety latch design bulks up the base of the latch where the torque and side load stresses are greatest, this is where ordinary stamped latches fail and will bend out of compliance. The latch also has a bolt-and-lock nut connection which simplifies changing latches in the field.

- STRENGTH - SAFETY
- RELIABILITY



Hook Strength Pads

Small Raised Pads - At the base and tip of each hook are permanent measuring points to check the hook's throat opening for signs of "stretching"—an indication that the hoist has been overloaded and that the hook should be replaced.

- STRENGTH



Heavy-Duty Black Phosphate Chain

We manufacture our own hardened link type steel load chain. It is 100% load tested and has an industry leading Black Phosphate Finish which delivers Maximum Corrosion protection compared to ordinary black oxide and nickel plating. Our load chain has smaller, more compact links that are 20% stronger than Grade 80 load chain.

- STRENGTH



Chain Stop Grip

The ergonomically designed and black phosphate coated cast chain stop used in our level hoists is more comfortable to grasp than the ordinary O-Ring. The design prevents the load chain from feeding through the hoist body and has the same highly corrosion resistant and scratch resistant coating that's applied to the Load Chain.

- SAFETY

HOOK & CHAIN

Every ALR Hoist meets or exceeds ANSI / ASME HST-3 Standards



We are committed to building the

All-Steel Construction

Impact resistant all-steel construction ensures added durability and protection while providing a long and dependable service life in toughest environments.

— STRENGTH

Compact Handle Design

Built to last new handle design allows for maximum power and lower head room for those tight quarter jobs.

— RELIABILITY

High-Performance USA Blue Grease

This Premium American Made blue grease is specifically formulated to excel in extreme conditions, such as: High operating temperatures, Contaminated environments (water, dust), Heavy loading, Extended re-lubrication intervals.

— RELIABILITY

Quick-Adjust Free Spool Feature

Engineered to allow for quick hoist positioning, our hoists have a new and innovative way to adjust without accidentally freewheeling under load. Our hoist does not have to be under load to adjust with the ratchet unlike our competitors hoists which must have a load on the hoist in order to adjust the length of the chain with the ratchet.

— SAFETY

Welded Structural Stay Bolts

Our Lever Hoists have structural stay bolts welded directly to the side plate instead of simply fastening them like most competitors. This is a crucial upgrade to the lever hoist that increases strength and safety by a large factor.

— STRENGTH

Sintered Brake System On All ALR Hoists

We have upgraded all our hoist to come standard with a Sintered Braking System. The design starts with applying high heat and pressure to copper, a high-performance metal. Other materials and metallic particles are then fused together to give the brake pad its extraordinary strength. The result is a brake system that won't crack, shatter or absorb moisture and holds up to the heaviest hoist loads.

— SAFETY

Weston-Style Brake System

Weston-Style load brake system has a Chrome Plated twin ratchet pawl brake design to reduce rusting. Fusing one brake disc to each side of the pawl allows the load to be divided between two disc and helps eliminates premature brake-disc failure.

— RELIABILITY

Upgraded High-Strength Alloy Side Plates

The Load Carrying Side Plates carry most of the load on a hoist. Our side-plates are 20% stronger because we upgraded to alloy steel rather than carbon steel like most competitors. This gives our product the strongest structure in the industry.

— STRENGTH

Drop Forged Pinion Shaft

Our lever hoist pinion shafts and washers are drop forged with Titanium embedded into the metal creating a single strong shaft for ultimate strength. Most manufacturers simply add a washer onto their pinion shafts.

— STRENGTH

Caged & Sealed Roller Bearings

Caged and Sealed Roller bearings provides smooth, controlled operation of the gears and shafts. This ensures maintenance-free lubrication and increased efficiency.

— STRENGTH

Relaxed Grip Handle Design

Our new lever handle grip features an ergonomic non-slip hilt at the base that guards against losing your grip on the tool.

Molded from a unique engineered thermoplastic, this new grip provides a soft, tactile surface that “relaxes the grip” to reduce fatigue, yet durable enough to survive years of use and exposure to the elements.

— SAFETY



LEVER HOIST

STRONGEST, SAFEST, and MOST RELIABLE hoists in the world.

Premium Powder Coated Finish

Featuring a specifically designed long lasting powder coat finish for harsh environments.
— RELIABILITY

Overload Protection

Optional Overload Protection prevents lifting or pulling damaging loads beyond the rated capacity of the hoist and when triggered, as well as injury to personnel. Overload Protection is set at approximately 150% of rated and can be reset on site.
— SAFETY

Forged Identity Markings

We are one of the only manufacturers to have our manufacturing identifying marks and production date codes, plus the hook's rated capacity, embedded on the sides of the hook during the drop forge operation. Traceability is a key component of being an ISO certified manufacturer of hoists.
— SAFETY

Heavy-Duty Cast Steel Safety Latch

This new Heavy-Duty cast-steel safety latch design bulks up the base of the latch where the torque and side load stresses are greatest, this is where ordinary stamped latches fail and will bend out of compliance. The latch also has a bolt-and-lock nut connection which simplifies changing latches in the field.
— STRENGTH — SAFETY — RELIABILITY

Heavy-Duty Black Phosphate Chain

We manufacture our own hardened link type steel load chain. It is 100% load tested and has an industry leading Black Phosphate Finish which delivers Maximum Corrosion protection compared to ordinary black oxide and nickel plating. Our load chain has smaller, more compact links that are 20% stronger than Grade 80 load chain.
— STRENGTH

Chain Stop Grip

The ergonomically designed and black phosphate coated cast chain stop used in our level hoists is more comfortable to grasp than the ordinary O-Ring. The design prevents the load chain from feeding through the hoist body and has the same highly corrosion resistant and scratch resistant coating that's applied to the Load Chain.
— SAFETY

Hook Strength Pads

Small Raised Pads - At the base and tip of each hook are permanent measuring points to check the hook's throat opening for signs of "stretching"—an indication that the hoist has been overloaded and that the hook should be replaced.
— STRENGTH

360-Degree Hook Rotation

The 360 Degree swivel hook design allows the operator to work in confined spaces with quick and easy positioning of the hoist in any directions.
— RELIABILITY

Optional Shipyard Hook

Shipyard Hooks are designed with blunt tips for point loading and engineered to help eliminate stretched hooks.
— SAFETY

Quick Hook Replacement Design

The top hook of our chain hoist is easy to remove from the body of the hoist, making it easier to replace hooks that have been stretched or otherwise damaged due to an overload condition.

The bolt holding the hook in place can be removed without disassembling the hoist body. This new configuration minimizes the hoist's headroom; plus, it makes the ALR hoist the better choice as a dedicated trolley-mounted hoist.
— RELIABILITY



LEVER
HOIST

Every ALR Hoist meets or exceeds ANSI / ASME HST-3 Standards

STRENGTH

- Atlas Lifting & Rigging Premium hoists are designed for pulling, lifting and positioning loads on the toughest job site.
- Engineered for the harshest of environments and delivering exceptional durability to meet your toughest demands.

SAFETY

- Loaded with industry leading safety features to keep you safe on the job site.
- Compact design is light weight and durable for confined spaces and heavy loads.

RELIABILITY

- Built to the highest tolerances and with the best materials so you know it will last.
- We Upgraded everything on our hoists — US-made Extreme Grease, Gears, Bearings, Braking System, Load Carrying Side Plates, Chrome Plated Corrosive Resistant Internal Parts, Welded Pinion Shafts, Handle Grips, Hooks, Safety Latches, Chain.. You name it and we have upgraded it.



OVERLOAD PROTECTION ADDS AN EXTENDED LAYER OF PROTECTION TO THE USER OF THE HOIST AND THE HOIST ITSELF.

It's not uncommon for a worker to rig a load without knowing the exact weight of what they are lifting. Overload protection prevents lifting or pulling damaging loads beyond the rated capacity of the hoist and when triggered, as well as injury to personnel.

OVERLOAD PROTECTION WILL ACTIVATE AT APPROXIMATELY 150% OF RATED LOAD.



STRONGEST, SAFEST, and MOST RELIABLE hoists in the world.

WITH Overload Protection

Product Number	Capacity (ton)	Capacity (lbs)	Chain (ft)
ALH-008-5-OP	3/4	1,760	5
ALH-008-10-OP	3/4	1,760	10
ALH-008-15-OP	3/4	1,760	15
ALH-008-20-OP	3/4	1,760	20
ALH-010-5-OP	1	2,200	5
ALH-010-10-OP	1	2,200	10
ALH-010-15-OP	1	2,200	15
ALH-010-20-OP	1	2,200	20
ALH-016-5-OP	1.6	3,500	5
ALH-016-10-OP	1.6	3,500	10
ALH-016-15-OP	1.6	3,500	15
ALH-016-20-OP	1.6	3,500	20
ALH-025-5-OP	2.5	5,500	5
ALH-025-10-OP	2.5	5,500	10
ALH-025-15-OP	2.5	5,500	15
ALH-025-20-OP	2.5	5,500	20
ALH-032-5-OP	3.2	7,050	5
ALH-032-10-OP	3.2	7,050	10
ALH-032-15-OP	3.2	7,050	15
ALH-032-20-OP	3.2	7,050	20
ALH-063-5-OP	6.3	13,900	5
ALH-063-10-OP	6.3	13,900	10
ALH-063-15-OP	6.3	13,900	15
ALH-063-20-OP	6.3	13,900	20
ALH-090-5-OP	9	19,800	5
ALH-090-10-OP	9	19,800	10
ALH-090-15-OP	9	19,800	15
ALH-090-20-OP	9	19,800	20

WITH-OUT Overload Protection

Product Number	Capacity (ton)	Capacity (lbs)	Chain (ft)
ALH-008-5	3/4	1,760	5
ALH-008-10	3/4	1,760	10
ALH-008-15	3/4	1,760	15
ALH-008-20	3/4	1,760	20
ALH-010-5	1	2,200	5
ALH-010-10	1	2,200	10
ALH-010-15	1	2,200	15
ALH-010-20	1	2,200	20
ALH-016-5	1.6	3,500	5
ALH-016-10	1.6	3,500	10
ALH-016-15	1.6	3,500	15
ALH-016-20	1.6	3,500	20
ALH-025-5	2.5	5,500	5
ALH-025-10	2.5	5,500	10
ALH-025-15	2.5	5,500	15
ALH-025-20	2.5	5,500	20
ALH-032-5	3.2	7,050	5
ALH-032-10	3.2	7,050	10
ALH-032-15	3.2	7,050	15
ALH-032-20	3.2	7,050	20
ALH-063-5	6.3	13,900	5
ALH-063-10	6.3	13,900	10
ALH-063-15	6.3	13,900	15
ALH-063-20	6.3	13,900	20
ALH-090-5	9	19,800	5
ALH-090-10	9	19,800	10
ALH-090-15	9	19,800	15
ALH-090-20	9	19,800	20



LEVER HOIST

Custom Chain Lengths and Shipyard Hooks Available





We are committed to building the

ALR LEVER HOIST SPECIFICATIONS & DIMENSIONS

Product Number			ALH-008	ALH-010	ALH-016	ALH-025	ALH-032	ALH-063	ALH-090
Capacity		(ton)	3/4	1	1.6	2.5	3.2	6.3	9
Number of Falls			1	1	1	1	1	2	3
Capacity Test Load		(lbs)	1,760	2,200	3,500	5,500	7,050	13,900	19,800
Capacity Test Load		(ton)	1.20	1.50	2.40	3.75	4.80	9.45	13.50
Load Chain		(mm)	5.6x15.7	5.6x15.7	7.1x19.9	8.8x24.6	10x28	10x28	10x28
Standard Lift		(ft)	5	5	5	5	5	5	5
Height	h	(in)	11.0	11.8	13.2	14.8	15.6	21.3	26.8
Length	a	(in)	5.7	5.7	6.5	7.0	7.7	7.7	7.7
Width	b	(in)	4.7	4.7	5.0	5.9	6.3	8.6	11.7
Net Weight		(lbs)	13.3	13.7	18.7	26.4	35.4	60.3	92.4
Gross Weight		(lbs)	14.5	14.9	20.2	28.2	38.3	63.4	104.5
Pull to Rated Load		(lbs)	67.7	67.7	76.2	86.8	87.2	89.5	88.1
Dimensions	a	(in)	5.7	5.7	6.5	7.0	7.7	7.7	7.7
	b	(in)	4.7	4.7	5.0	5.9	6.3	8.6	11.7
	c	(in)	9.6	9.6	10.4	10.4	16.3	16.3	16.3
	d	(in)	3.8	3.8	3.9	4.1	4.5	4.5	4.5
	e	(in)	1.0	1.2	1.4	1.6	1.7	2.1	2.5
	f	(in)	1.4	1.7	1.7	1.9	2.0	2.4	3.3
	g	(in)	1.6	1.9	2.0	2.3	2.4	3.3	-
	h	(in)	11.0	11.8	13.2	14.8	15.6	21.3	26.8
	t	(in)	0.6	0.6	0.7	0.8	1.0	1.3	1.6

LEVER HOIST



STRONGEST, SAFEST, and MOST RELIABLE hoists in the world.

MANUAL OPERATED LEVER HOIST

3
YEAR*
WARRANTY

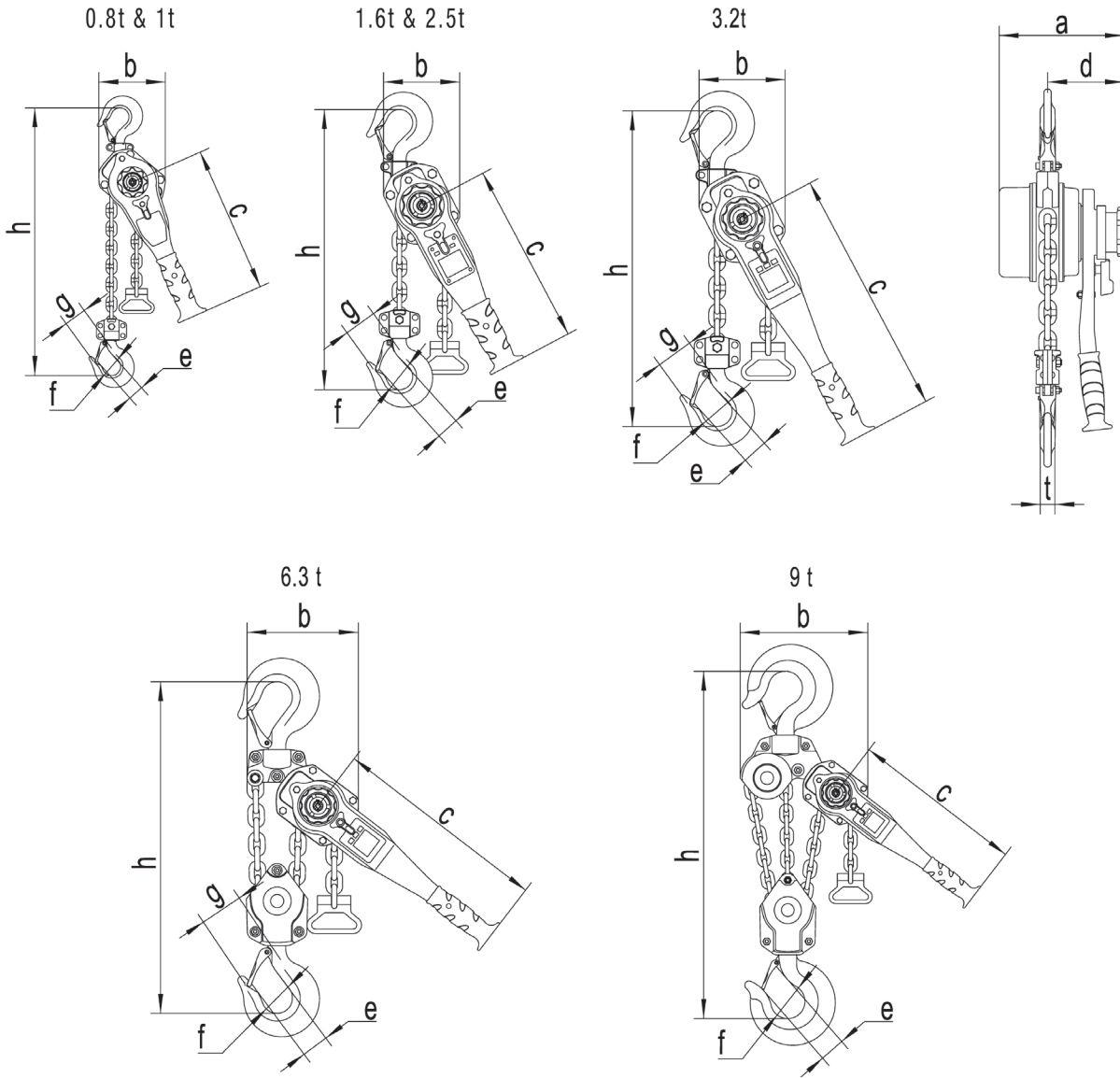

LEVER HOIST



**The ALHC Series compact hoist is built tough and will fit in a toolbox.
A great hoist for construction, plumbing, HVAC, electrical work and ATV use.**

Available in ¼, ½ and ¾ Ton capacities and will easily handle most applications where weights are under 1 ton. This is a must have tool for any toolbox. When you have something that needs to be lifted quick and easily, there is no better tool to have by your side.

Tough Aluminum Body and Steel Frame

Its lightweight and extremely compact die-cast aluminum body make the ALHC your ideal tool for elevated or difficult-to-reach places.

Tools aren't always treated with the respect they deserve, which is why the durable steel frame provides long-lasting, high-strength support - **STRENGTH**

Compact Handle Design

Built to last new handle design allows for maximum power and lower head room for those tight quarter jobs - **RELIABILITY**

360-Degree Hook Rotation

The 360 Degree swivel hook design allows the operator to work in confined spaces with quick and easy positioning of the hoist in any directions - **RELIABILITY**

Weston-Style Brake System

Weston-Style load brake system has a twin ratchet pawl brake design. Fusing one brake disc to each side of the pawl allows the load to be divided between two disc and helps eliminates premature brake-disc failure - **RELIABILITY**



Heavy-Duty Cast Steel Latch

This new Heavy-Duty case-steel safety latch design bulks up the base of the latch where the torque and side load stresses are greatest, this is where ordinary stamped latches fail and will bend out of compliance. The latch also has a bolt-and-lock nut connection which simplifies changing latches in the field - **STRENGTH**

Relaxed Grip Handle Design

Molded from a unique engineered thermoplastic, this new grip provides a soft, tactile surface that "relaxes the grip" to reduce fatigue, yet durable enough to survive years of use and exposure to the elements - **SAFETY**

- Every unit is inspected and tested to 150% of rated capacity before leaving the factory in accordance with ASME B30.21 requirements.

MANUAL OPERATED COMPACT LEVER HOIST

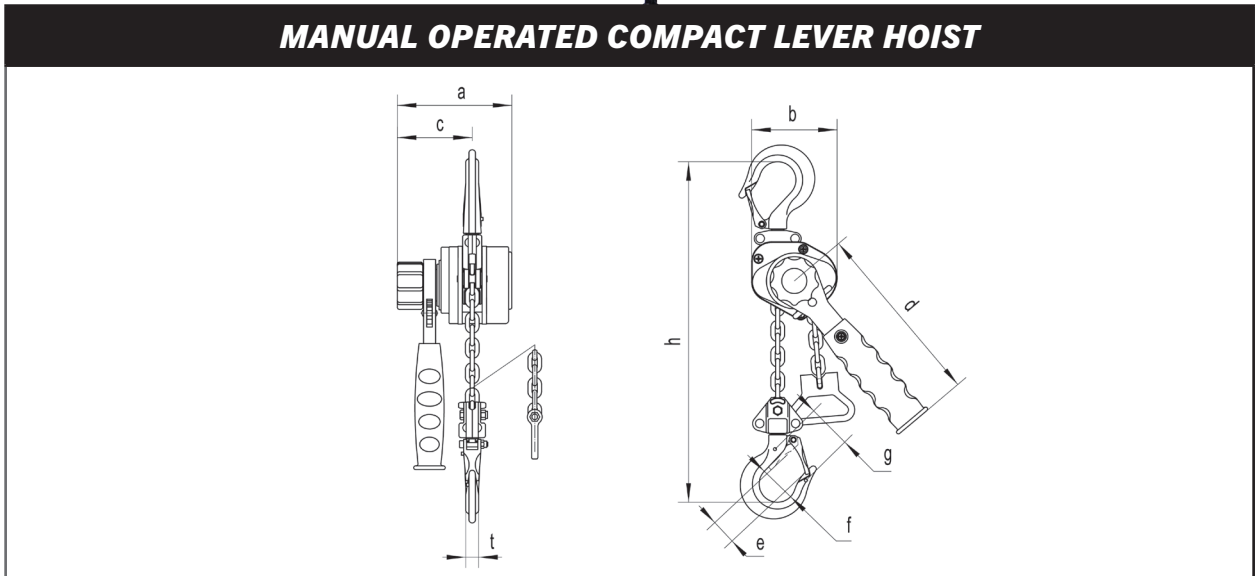

Every ALR Hoist meets or exceeds ANSI / ASME HST-3 Standards

STRONGEST, SAFEST, and MOST RELIABLE hoists in the world.

ALHC SERIES COMPACT LEVER HOIST

Product Number	Description	Capacity (lbs)
ALHC-0025-05	1/4 Ton Lever Hoist with 5 ft. Chain Fall	550
ALHC-0025-10	1/4 Ton Lever Hoist with 10 ft. Chain Fall	550
ALHC-0025-15	1/4 Ton Lever Hoist with 15 ft. Chain Fall	550
ALHC-0025-20	1/4 Ton Lever Hoist with 20 ft. Chain Fall	550
ALHC-0025-30	1/4 Ton Lever Hoist with 30 ft. Chain Fall	550
ALHC-005-05	1/2 Ton Lever Hoist with 5 ft. Chain Fall	1,100
ALHC-005-10	1/2 Ton Lever Hoist with 10 ft. Chain Fall	1,100
ALHC-005-15	1/2 Ton Lever Hoist with 15 ft. Chain Fall	1,100
ALHC-005-20	1/2 Ton Lever Hoist with 20ft. Chain Fall	1,100
ALHC-005-30	1/2 Ton Lever Hoist with 30ft. Chain Fall	1,100
ALHC-0075-05	3/4 Ton Lever Hoist with 5 ft. Chain Fall	1,650
ALHC-0075-10	3/4 Ton Lever Hoist with 10 ft. Chain Fall	1,650
ALHC-0075-15	3/4 Ton Lever Hoist with 15 ft. Chain Fall	1,650
ALHC-0075-20	3/4 Ton Lever Hoist with 20 ft. Chain Fall	1,650
ALHC-0075-30	3/4 Ton Lever Hoist with 30 ft. Chain Fall	1,650

Custom Chain Lengths Available

ALHC COMPACT LEVER HOIST SPECIFICATIONS

Product Number	Capacity	(ton)	ALHC-0025 1/4	ALHC-0050 1/2	ALHC-0075 3/4
Capacity	(lbs)		550	1,100	1,650
Load Chain	(mm)		3.2x9	4.3x12	5.0x15
Pull to Rated Load	(lbs)		40	72.8	83.85
Proof Load	(lbs)		825	1,650	2,475
Standard Lift	(ft)		5	5	5
Net Weight	(lbs)		4.0	6.8	8.6
Gross Weight	(lbs)		4.4	7.2	9.2
Headroom	h	(in)	7.9	9.8	10.2
Handle Length	d	(in)	5.5	6.3	7.1
Dimensions	a	(in)	3.4	4.0	4.1
	b	(in)	3.0	3.2	3.6
	c	(in)	2.2	2.5	2.5
	d	(in)	5.5	6.3	7.1
	e	(in)	0.8	1.0	1.1
	f	(in)	1.3	1.4	1.4
	g	(in)	1.4	1.7	1.7
	t	(in)	0.4	0.5	0.6



COMPACT LEVER HOIST





We are committed to building the

All-Steel Construction

Impact resistant all-steel construction ensures added durability and protection while providing a long and dependable service life in toughest environments.

— **STRENGTH**

Premium Powder Coated Finish

Featuring a specifically designed long lasting powder coat finish for harsh environments. — **RELIABILITY**

Overload Protection

Optional Overload Protection prevents lifting or pulling damaging loads beyond the rated capacity of the hoist and when triggered, as well as injury to personnel. Overload Protection is set at approximately 150% of rated and can be reset on site.

— **SAFETY**

High-Performance USA Blue Grease

This Premium American Made blue grease is specifically formulated to excel in extreme conditions, such as: High operating temperatures, Contaminated environments (water, dust), Heavy loading, Extended re-lubrication intervals. — **RELIABILITY**

Sintered Brake System On All ALR Hoists

We have upgraded all our hoist to come standard with a Sintered Braking System. The design starts with applying high heat and pressure to copper, a high-performance metal. Other materials and metallic particles are then fused together to give the brake pad its extraordinary strength. The result is a brake system that won't crack, shatter or absorb moisture and holds up to the heaviest hoist loads.

— **SAFETY**

Oversized Sintered Brake System

All of our chain hoist 5 ton and larger come with an oversized "Sintered Brake System" is specifically engineered for "Heavy Loads". If the contact area of the braking system is too small, it will cause overheating and failure. We have oversized the crucial components to create more contact area for braking. — **SAFETY**

Weston-Style Brake System

Weston-Style load brake system has a Chrome Plated twin ratchet pawl brake design to reduce rusting. Fusing one brake disc to each side of the pawl allows the load to be divided between two disc and helps eliminates premature brake-disc failure. — **RELIABILITY**

Upgraded High-Strength Alloy Side Plates

The Load Carrying Side Plates carry most of the load on a hoist. Our side-plates are 20% stronger because we upgraded to alloy steel rather than carbon steel like most competitors. This gives our product the strongest structure in the industry. — **STRENGTH**



HOIST BODY

STRONGEST, SAFEST, and MOST RELIABLE hoists in the world.

Quick Hook Replacement Design

The top hook of our chain hoist is easy to remove from the body of the hoist, making it easier to replace hooks that have been stretched or otherwise damaged due to an overload condition.

The bolt holding the hook in place can be removed without disassembling the hoist body. This new configuration minimizes the hoist's headroom; plus, it makes the ALR hoist the better choice as a dedicated trolley-mounted hoist.

— RELIABILITY

Caged & Sealed Roller Bearings

Caged and Sealed Roller bearings provides smooth, controlled operation of the gears and shafts. This ensures maintenance-free lubrication and increased efficiency. — STRENGTH

Forged Identity Markings

We are one of the only manufacturers to have our manufacturing identifying marks and production date codes, plus the hook's rated capacity, embedded on the sides of the hook during the drop forge operation. Traceability is a key component of being an ISO certified manufacturer of hoists. — SAFETY

Heavy-Duty Cast Steel Safety Latch

This new Heavy-Duty cast-steel safety latch design bulks up the base of the latch where the torque and side load stresses are greatest, this is where ordinary stamped latches fail and will bend out of compliance. The latch also has a bolt-and-lock nut connection which simplifies changing latches in the field.

— STRENGTH — SAFETY — RELIABILITY

Heavy-Duty Black Phosphate Chain

We manufacture our own hardened link type steel load chain. It is 100% load tested and has an industry leading Black Phosphate Finish which delivers Maximum Corrosion protection compared to ordinary black oxide and nickel plating. Our load chain has smaller, more compact links that are 20% stronger than Grade 80 load chain. — STRENGTH

Hook Strength Pads

Small Raised Pads - At the base and tip of each hook are permanent measuring points to check the hook's throat opening for signs of "stretching"—an indication that the hoist has been overloaded and that the hook should be replaced. — STRENGTH

360-Degree Hook Rotation

The 360 Degree swivel hook design allows the operator to work in confined spaces with quick and easy positioning of the hoist in any directions. — RELIABILITY

Optional Shipyard Hook

Shipyard Hooks are designed with blunt tips for point loading and engineered to help eliminate stretched hooks. — SAFETY



HOOK & CHAIN

Every ALR Hoist meets or exceeds ANSI / ASME HST-3 Standards

STRENGTH

- Atlas Lifting & Rigging Premium hoists are designed for pulling, lifting and positioning loads on the toughest job site.
- Engineered for the harshest of environments and delivering exceptional durability to meet your toughest demands.

SAFETY

- Loaded with industry leading safety features to keep you safe on the job site.
- Compact design is light weight and durable for confined spaces and heavy loads.

RELIABILITY

- Built to the highest tolerances and with the best materials so you know it will last.
- We Upgraded everything on our hoists - US-made Extreme Grease, Gears, Bearings, Braking System, Load Carrying Side Plates, Chrome Plated Corrosive Resistant Internal Parts, Welded Pinion Shafts, Handle Grips, Hooks, Safety Latches, Chain.. You name it and we have upgraded it.



OVERLOAD PROTECTION ADDS AN EXTENDED LAYER OF PROTECTION TO THE USER OF THE HOIST AND THE HOIST ITSELF.

It's not uncommon for a worker to rig a load without knowing the exact weight of what they are lifting. Overload protection prevents lifting or pulling damaging loads beyond the rated capacity of the hoist and when triggered, as well as injury to personnel.

OVERLOAD PROTECTION WILL ACTIVATE AT APPROXIMATELY 150% OF RATED LOAD.

STRONGEST, SAFEST, and MOST RELIABLE hoists in the world.

WITH Overload Protection

Product Number	Capacity (ton)	Capacity (lbs)	Chain (ft)
ACH-0025-10-OP	1/4	550	10
ACH-0025-15-OP	1/4	550	15
ACH-0025-20-OP	1/4	550	20
ACH-0025-30-OP	1/4	550	30
ACH-005-10-OP	1/2	1,100	10
ACH-005-15-OP	1/2	1,100	15
ACH-005-20-OP	1/2	1,100	20
ACH-005-30-OP	1/2	1,100	30
ACH-010-10-OP	1	2,200	10
ACH-010-15-OP	1	2,200	15
ACH-010-20-OP	1	2,200	20
ACH-010-30-OP	1	2,200	30
ACH-015-10-OP	1.5	3,300	10
ACH-015-15-OP	1.5	3,300	15
ACH-015-20-OP	1.5	3,300	20
ACH-015-30-OP	1.5	3,300	30
ACH-020-10-OP	2	4,400	10
ACH-020-15-OP	2	4,400	15
ACH-020-20-OP	2	4,400	20
ACH-020-30-OP	2	4,400	30
ACH-030-10-OP	3	6,600	10
ACH-030-15-OP	3	6,600	15
ACH-030-20-OP	3	6,600	20
ACH-030-30-OP	3	6,600	30
ACH-032-10-OP	3.2	7,050	10
ACH-032-15-OP	3.2	7,050	15
ACH-032-20-OP	3.2	7,050	20
ACH-032-30-OP	3.2	7,050	30
ACH-050-10-OP	5	11,000	10
ACH-050-15-OP	5	11,000	15
ACH-050-20-OP	5	11,000	20
ACH-050-30-OP	5	11,000	30
ACH-100-10-OP	10	22,000	10
ACH-100-15-OP	10	22,000	15
ACH-100-20-OP	10	22,000	20
ACH-100-30-OP	10	22,000	30
ACH-150-10-OP	15	33,000	10
ACH-150-15-OP	15	33,000	15
ACH-150-20-OP	15	33,000	20
ACH-150-30-OP	15	33,000	30
ACH-200-10-OP	20	44,000	10
ACH-200-15-OP	20	44,000	15
ACH-200-20-OP	20	44,000	20
ACH-200-30-OP	20	44,000	30

WITH-OUT Overload Protection

Product Number	Capacity (ton)	Capacity (lbs)	Chain (ft)
ACH-0025-10	1/4	550	10
ACH-0025-15	1/4	550	15
ACH-0025-20	1/4	550	20
ACH-0025-30	1/4	550	30
ACH-005-10	1/2	1,100	10
ACH-005-15	1/2	1,100	15
ACH-005-20	1/2	1,100	20
ACH-005-30	1/2	1,100	30
ACH-010-10	1	2,200	10
ACH-010-15	1	2,200	15
ACH-010-20	1	2,200	20
ACH-010-30	1	2,200	30
ACH-015-10	1.5	3,300	10
ACH-015-15	1.5	3,300	15
ACH-015-20	1.5	3,300	20
ACH-015-30	1.5	3,300	30
ACH-020-10	2	4,400	10
ACH-020-15	2	4,400	15
ACH-020-20	2	4,400	20
ACH-020-30	2	4,400	30
ACH-030-10	3	6,600	10
ACH-030-15	3	6,600	15
ACH-030-20	3	6,600	20
ACH-030-30	3	6,600	30
ACH-032-10	3.2	7,050	10
ACH-032-15	3.2	7,050	15
ACH-032-20	3.2	7,050	20
ACH-032-30	3.2	7,050	30
ACH-050-10	5	11,000	10
ACH-050-15	5	11,000	15
ACH-050-20	5	11,000	20
ACH-050-30	5	11,000	30
ACH-100-10	10	22,000	10
ACH-100-15	10	22,000	15
ACH-100-20	10	22,000	20
ACH-100-30	10	22,000	30
ACH-150-10	15	33,000	10
ACH-150-15	15	33,000	15
ACH-150-20	15	33,000	20
ACH-150-30	15	33,000	30
ACH-200-10	20	44,000	10
ACH-200-15	20	44,000	15
ACH-200-20	20	44,000	20
ACH-200-30	20	44,000	30



CHAIN HOIST

30 - 50 - 80 Ton Chain Hoist Available Upon Request | Custom Chain Lengths Available

Every ALR Hoist meets or exceeds ANSI/ASME HST-3 Standards

ACH SERIES CHAIN HOIST SPECIFICATION & DIMENSIONS

Product Number		ACH-0025	ACH-005	ACH-010	ACH-015	ACH-020	ACH-030	ACH-032	ACH-050	ACH-100	ACH-150	ACH-200
Capacity	(ton)	0.25	0.5	1	1.5	2	3	3.2	5	10	15	20
No. of Falls		1	1	1	1	1	2	1	2	4	6	8
Capacity	(lbs)	550	1,100	2,200	3,300	4,400	6,600	7,050	11,000	22,000	33,000	44,000
Capacity Test Load	(lbs)	825	1,650	3,300	4,950	6,600	9,900	10,575	16,500	33,000	49,500	66,000
Capacity Test Load	(ton)	0.375	0.75	1.5	2.25	3	4.5	4.8	7.5	15	22.5	25
Load Chain	(mm)	4x12	5x15	6.3x19	7.1x21	8x24	7.1x21			10x30		
Standard Lift	(ft)	10	10	10	10	10	10	10	10	10	10	10
Hand Chain	(mm)	3x15x10	5x25x18									
Overhaul Ratio	per 1 ft	4.7	7.7	13.0	17.2	21.0	34.3	33.5	69.5	139.0	208.5	277.9
Height	h (in)	9.8	11.2	11.6	13.8	14.8	20.1	19.1	23.6	29.9	39.4	45.3
Length	a (in)	3.8	5.1	6.4	6.7	7.2	6.7	7.5	7.6	7.6	8.7	9.1
Width	b (in)	4.3	5.5	6.3	7.2	8.0	9.3	9.3	11.1	14.2	19.4	25.8
Net Weight	(lbs)	10.0	19.1	27.3	34.1	43.9	52.8	60.3	92.2	183.9	336.6	451.0
Gross Weight	(lbs)	11.0	20.4	28.4	36.0	45.8	54.6	63.6	95.7	196.0	365.2	481.8
Pull to Rated Load	(N)	220	260	308	348	379	363	381	353	379	409	445 x2
Dimensions	a (in)	3.8	5.1	6.4	6.7	7.2	6.7	7.5	7.6	7.6	8.7	9.1
	b (in)	4.3	5.5	6.3	7.2	8.0	9.3	9.3	11.1	14.2	19.4	25.8
	c (in)	1.2	1.7	2.0	2.5	2.5	4.2	2.7	5.2	10.4	4.3	11.3
	d (in)	0.8	1.0	1.2	1.3	1.3	2.1	1.5	2.5	3.7	6.7	4.8
	e (in)	1.1	1.1	1.3	1.3	1.5	1.7	1.7	2.0	2.5	3.1	3.2
	f (in)	1.3	1.3	1.6	1.7	1.8	2.0	1.9	2.4	3.3	3.9	4.3
	g (in)	1.4	1.4	1.8	1.9	2.0	2.5	2.5	3.1			
	h (in)	9.8	11.2	11.6	13.8	14.8	20.1	19.1	23.6	29.9	39.4	45.3

MANUAL CHAIN HOIST

0.25t , 0.5t , 1t , 1.5t , 2t & 3.2t

3t & 5t

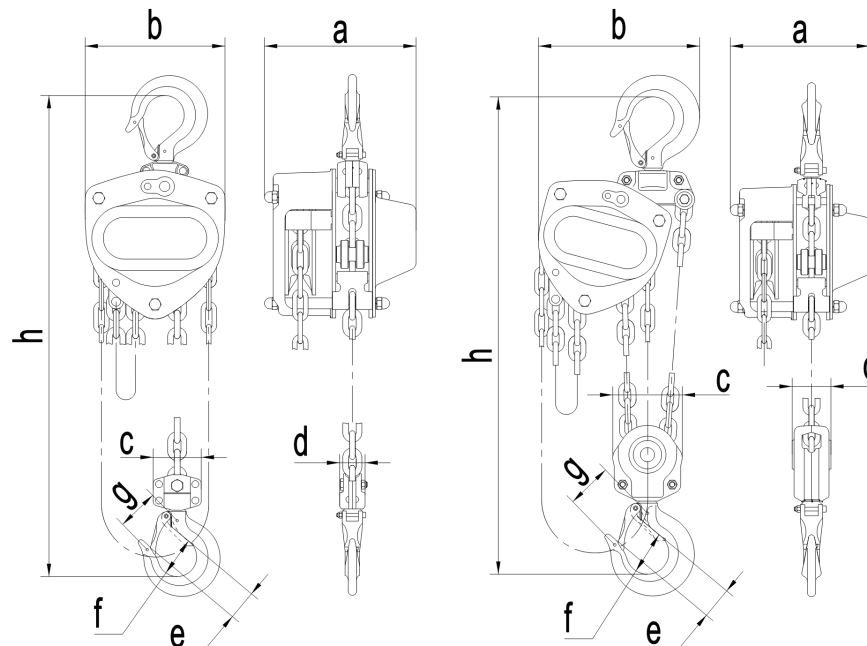

STRONGEST, SAFEST, and MOST RELIABLE hoists in the world.

MANUAL CHAIN HOIST (cont.)

3
YEAR*
WARRANTY

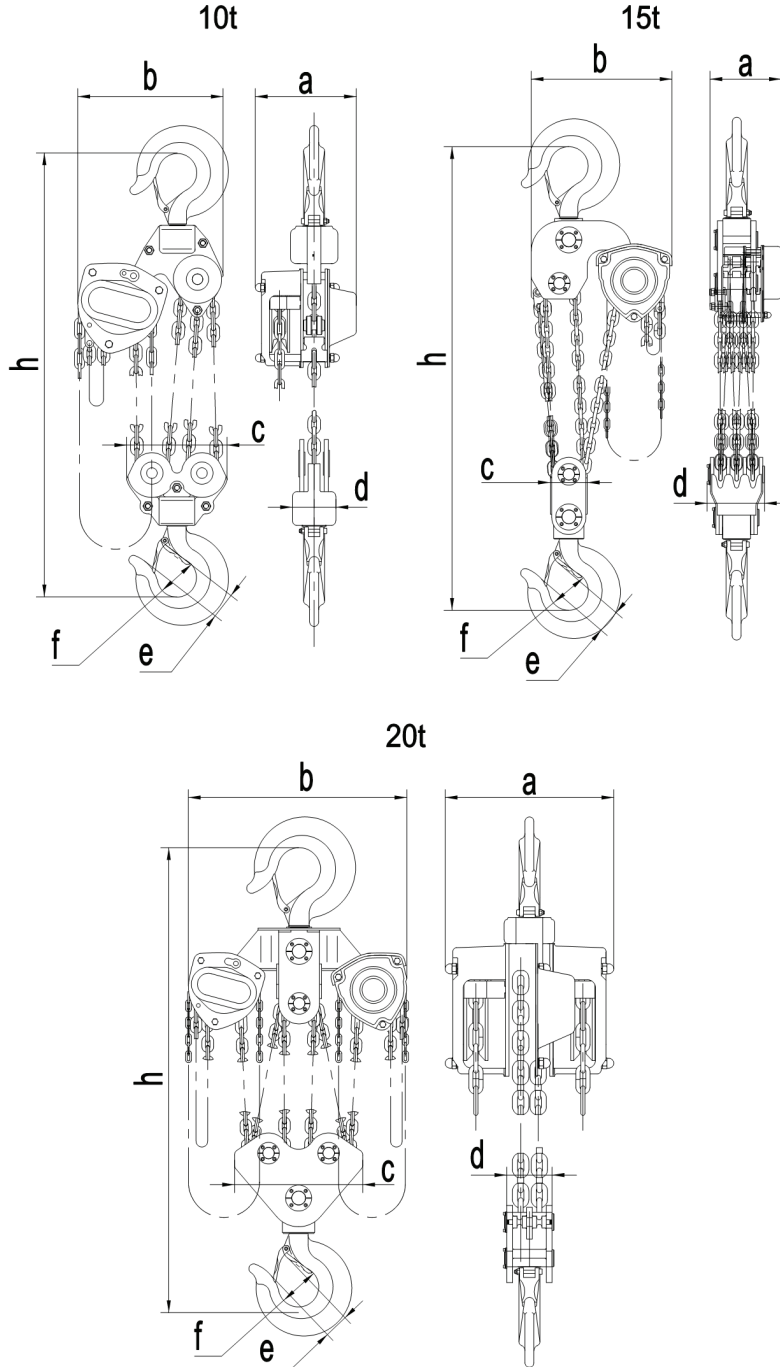

CHAIN HOIST

Every ALR Hoist meets or exceeds ANSI / ASME HST-3 Standards



This revolutionary patented dual speed chain hoist is equipped with Load Sensing Automatic Speed Transmission which is the first in this industry. The hoist can lift and lower the load chain 5 times faster than a regular chain hoist when it does not have a load.

When the hoist is loaded, the lifting and lowering speed will be the same as a regular chain hoist. Smooth speed transmissions between high and standard speed without neutral position, which is reliable and safe. The Dual Speed Chain Hoist is equipped with an overload limiter ensuring safe operation.

5 Times Faster

When the hoist is not loaded, the lifting and lowering speed are geared for quick load adjustment, making the hoist 5 times faster than a standard hoist.

Dual Speed

When the hoist is loaded, the lifting and lowering speed will be the same as a regular chain hoist.

Automatic Speed Transmission

Equipped with Load Sensing "Automatic Speed Transmission" which is the first in this field.

Reliable and Safe

Smooth speed transmission between high and standard speed without neutral position.

Quick Safety Inspection Indicator

The dual speed chain hoist top and bottom hooks have overload indicator marks on the hook throat that can be quickly measured for possible overloading.

Meets and Exceeds Standards

EN13157, ASNE B30.16 and JIS B8802 standards.

Patented

USA, Canada, Germany, Australia, China, S. Korea and Taiwan China.

Overload Protection

Equipped with an overload limiter ensuring safe operation.

Double Pawl

Reinforced double pawl brake system and larger diameter pawl springs ensure reliable brake.



STRONGEST, SAFEST, and MOST RELIABLE hoists in the world.



Product Number	Capacity (ton)	Capacity (lbs)	Chain (ft)
ADSCH-032-10	3.2	7,050	10
ADSCH-032-20	3.2	7,050	20
ADSCH-050-10	5	11,000	10
ADSCH-050-20	5	11,000	20
ADSCH-075-10	7.5	16,500	10
ADSCH-075-20	7.5	16,500	20
ADSCH-100-10	10	22,000	10
ADSCH-100-20	10	22,000	20
ADSCH-150-10	15	33,000	10
ADSCH-150-20	15	33,000	20
ADSCH-200-10	20	44,000	10
ADSCH-200-20	20	44,000	20

Custom Chain Lengths Available

ADSCH SERIES CHAIN HOIST SPECIFICATIONS & DIMENSIONS

Product Number		ADSCH-032	ADSCH-050	ADSCH-075	ADSCH-100	ADSCH-150	ADSCH-200	
Capacity		(ton)	3.2	5	7.5	10	15	20
No. of Falls			1	2	3	3	5	6
Capacity	(lbs)		7,050	11,000	16,500	22,000	33,000	44,000
Capacity Test Load	(lbs)		10,575	16,500	24,750	33,000	49,500	66,000
Capacity Test Load	(ton)		4.8	7.5	11.25	15	22.5	30
Load Chain Grade			100	100	100	100	100	100
Load Chain	(mm)		10x30					
Hand Chain	(mm)		5x25x18					
Standard Lift	(ft)		10	10	15	15	15	15
High Speed to Low	(lbs)		>121	>242	>363	>363	>606	>727
Low Speed to High	(lbs)		<55	<110	<165	<165	<275	<330
Pull to Rated Load	(N)		360	296	312	328	345	328 x2
Net Weight	(lbs)		61.6	88.0	151.8	171.6	272.8	360.8
Gross Weight	(lbs)		68.3	99.2	168.7	190.7	318.6	405.7
Height	h (in)		18.3	23.6	29.1	29.9	39.4	45.3
Length	b (in)		8.9	10.8	14.4	14.4	19.1	25.5
Width	a (in)		9.7	9.7	9.7	9.7	10.8	11.2
Dimensions	a (in)		9.7	9.7	9.7	9.7	10.8	11.2
	b (in)		8.9	10.8	14.4	14.4	19.1	25.5
	c (in)		2.7	5.2	4.7	10.4	4.3	11.3
	d (in)		1.5	2.5	2.8	3.7	6.6	4.8
	e (in)		1.7	2.0	2.5	2.5	3.1	3.2
	f (in)		1.9	2.4	3.3	3.3	3.9	4.3
	g (in)		2.4	3.1	0.0	0.0	0.0	0.0
	h (in)		18.3	23.6	29.1	29.9	39.4	45.3

5X FASTER



ALTB Ultra-Low Headroom Trolley Hoist

ALTB series ultra-low trolley hoist offers premium quality and durability in a low profile package. This industrial grade hand chain hoist and geared trolley configuration minimizes beam-to-hook distance, making it ideal for applications where longer hook travel is required.

- Extremely low headroom for use where space is limited.
- Efficient hoist drive train minimizes effort required to operate.
- Trolley wheels fit on both tapered or flat flanged beams.
- Maintenance-free sealed trolley ball bearings are lubed-for-life and offer smooth movement with low friction and long life.

Capabilities to Count On:

- Reliable hoist braking with double enclosed brake cover that keeps out rain, dust and dirt.
- Steel trolley wheels and steel side plated for heavy-duty applications.
- With anti-drop & anti-tilt device integrated.



STRONGEST, SAFEST, and MOST RELIABLE hoists in the world.

ALTB Ultra-Low Headroom Trolley Hoist

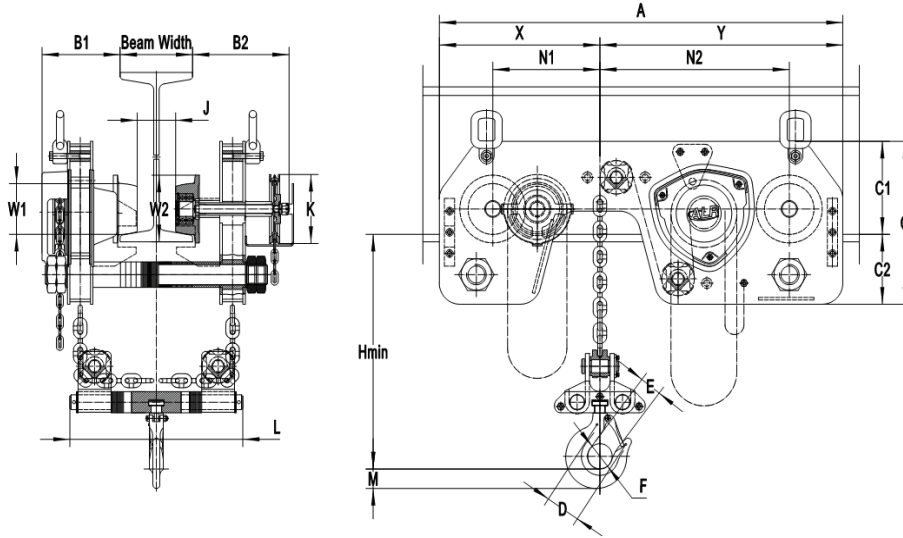

3
YEAR*
WARRANTY

ULTRA-LOW HEADROOM TROLLEY

ALTB Ultra-Low Headroom Trolley Hoist SPECIFICATIONS & DIMENSIONS

Product Number		ALTB-010	ALTB-020	ALTB-030	ALTB-050	ALTB-075	ALTB-100	ALTB-200	
Capacity	(ton)	1	2	3	5	7.5	10	20	
No. of Falls		2	2	2	2	4	4	8	
Capacity	(lbs)	2,200	4,400	6,600	11,000	16,500	22,000	44,000	
Capacity Test Load	(ton)	1.5	3	4.5	7.5	11.25	15	30	
Capacity Test Load	(lbs)	3,300	6,600	9,900	16,500	24,750	33,000	66,000	
Pull to Rated Load	(N)	267	426	385	405	448	448	448	
Beam Width	(in)	2.44 - 7.09	2.95 - 8.27	4.33 - 8.27	4.92 - 12.2	4.92 - 12.2	4.92 - 12.2	4.92 - 12.2	
Load Chain	(mm)	Ø 6x8	Ø6x18	Ø8x24	Ø10x30				
Standard Lift	(ft)	10	10	10	10	10	10	10	
Hand Chain	(mm)	5x25x18							
Min. Radius	(ft)	7.22	11.81	13.12	19.68	22.96		31.82	
Net Weight	(lbs)	143.0	143.0	272.8	389.4	688.6	688.6	1166.0	
Gross Weight	(lbs)	224.4	331.0	455.4	484.0	814.0	814.0	1342.0	
Extra Weight per 1m Extra Lift	(lbs)	5.5	5.5	8.1	11.7	21.1	21.1	40.3	
Dimensions	Headroom	H (in)	5.12	6.10	7.28	8.86	11.02	11.02	17.32
	A (in)	26.77	26.77	32.68	38.58	46.46	46.46	76.38	
	B1 (in)	5.91	5.91	6.50	7.54	7.68	7.68	7.87	
	B2 (in)	6.77	6.77	7.87	9.21	9.84	9.84	9.84	
	C (in)	10.63	10.63	12.99	15.16	17.32	17.32	17.32	
	C1 (in)	6.30	6.30	7.48	8.66	9.84	9.84	9.84	
	C2 (in)	4.33	4.33	5.51	6.50	7.48	7.48	7.48	
	D (in)	1.77	2.05	2.46	3.07	3.54	3.54	3.54	
	E (in)	1.26	1.46	1.17	2.05	2.52	2.52	3.23	
	F (in)	1.57	1.81	2.05	2.36	3.35	3.35	4.33	
	W1 (in)	3.15	3.94	4.33	4.80	5.98	5.98	5.98	
	W2 (in)	4.25	4.25	5.67	6.30	7.91	7.91	7.91	
	J (in)	0.94 - 5.59	1.46 - 6.77	2.2 - 5.71	1.65 - 8.94	1.65 - 8.78	1.65 - 8.78	1.77 - 9.06	
	K (in)	4.25	4.25	6.42	6.42	7.80	7.80	7.80	
	L (in)	12.20	12.20	15.16	16.54	17.72	17.72	21.65	
	M (in)	0.84	0.84	1.42	1.81	2.40	2.40	3.39	
	N1 (in)	6.73	6.73	8.07	10.24	9.84	9.84	30.51	
N2 (in)	12.17	12.17	14.76	18.11	24.80	24.80	30.51		
X (in)	10.67	10.67	12.99	15.35	15.75	15.75	36.42		
Y (in)	16.10	16.10	19.69	23.23	30.71	30.71	36.42		

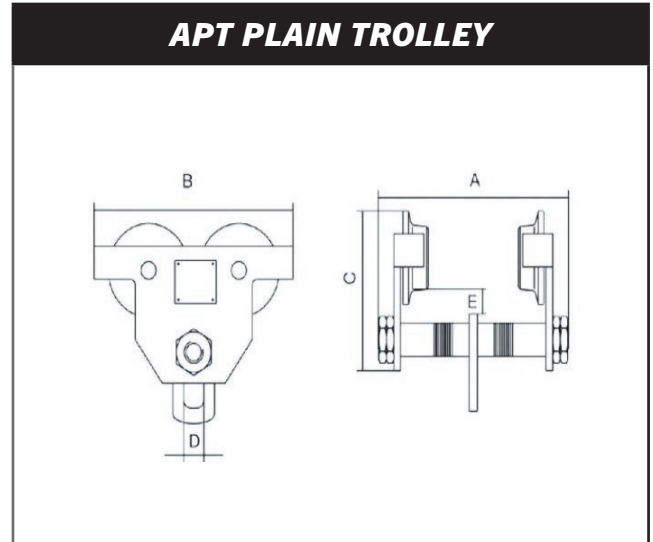

APT PLAIN TROLLEY SPECIFICATIONS							
Product Number		APT-005	APT-010	APT-020	APT-030	APT-050	APT-100
Capacity	(ton)	0.5	1	2	3	5	10
Capacity	(lbs)	1,100	2,200	4,400	6,600	11,000	22,000
Proof Load	(ton)	0.75	1.5	3	4.5	7.5	15
Proof Load	(lbs)	1,650	3,300	6,600	9,900	16,500	33,000
I-Beam Width	(in)	2 - 6	2.5 - 8	3.5 - 8	4 - 8	4.5 - 8	5 - 8.3
Dimensions (in)	A	9.1	11.7	12.3	13.1	14.3	16.1
	B	8.6	10.1	11.8	13.4	15.0	15.3
	C	6.1	7.1	8.4	9.9	11.4	14.4
	D	0.9	1.2	1.4	1.8	2.4	3.1
	E	0.9	0.9	0.9	1.3	1.1	1.9
Min. Radius Curve	(ft)	3.3	3.3	3.6	4.3	4.6	5.6
Net Weight	(lbs)	14.6	24.7	40.8	65.0	96.2	196.8
Gross Weight	(lbs)	15.7	26.0	43.0	66.3	101.3	203.0

Every ALR Trolley meets or exceeds ANSI/ASME HST-3 Standards

STRONGEST, SAFEST, and MOST RELIABLE hoists in the world.

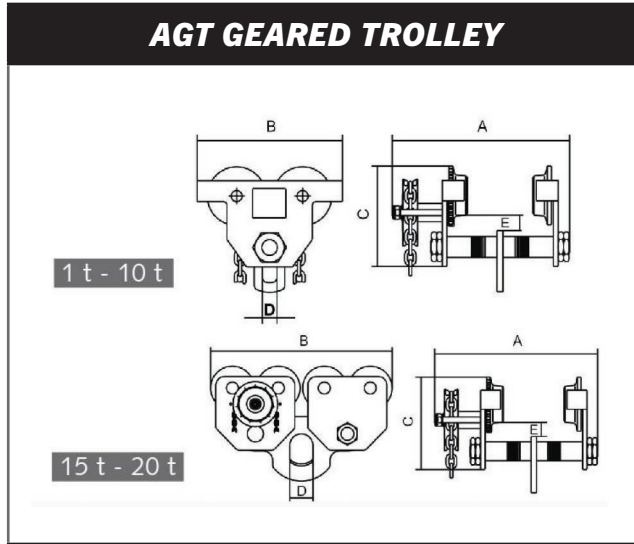

3
YEAR*
WARRANTY

GEARED TROLLEY

AGT GEARED TROLLEY SPECIFICATIONS

Product Number		AGT-010	AGT-020	AGT-030	AGT-050	AGT-100	AGT-150	AGT-200
Capacity	(ton)	1	2	3	5	10	15	20
Capacity	(lbs)	2,200	4,400	6,600	11,000	22,000	33,000	44,000
Proof Load	(ton)	1.5	3	4.5	7.5	15	22.5	30
Proof Load	(lbs)	3,300	6,600	9,900	16,500	33,000	49,500	66,000
I-Beam Width	(in)	2.5 - 8	3.5 - 8	4 - 8	4.5 - 8	5 - 8.3	5 - 8.3	5 - 8.3
Dimensions (in)	A	13.5	14.3	15.1	16.4	18.1	18.9	18.9
	B	10.1	11.8	13.4	15.0	15.3	31.1	31.1
	C	7.1	8.4	9.9	11.4	14.4	14.4	14.4
	D	1.2	1.4	1.8	2.4	3.1	3.9	3.9
	E	0.9	0.9	1.3	1.1	1.9	1.9	1.9
Min. Radius Curve	(ft)	3.3	3.3	3.6	4.3	4.6	5.6	5.6
Net Weight	(lbs)	37.4	51.7	85.1	122.5	204.6	420.2	420.2
Gross Weight	(lbs)	38.5	53.4	88.0	126.5	209.9	445.5	445.5



ABC BEAM CLAMP SPECIFICATIONS

Product Number		ABC-010	ABC-020	ABC-030	ABC-050	ABC-100
Capacity	(ton)	1	2	3	5	10
Capacity	(lbs)	2,200	4,400	6,600	11,000	22,000
Proof Load	(ton)	1.5	3	4.5	7.5	15
Proof Load	(lbs)	3,300	6,600	9,900	16,500	33,000
I-Beam Width	(in)	3 - 9	3 - 9	3.5 - 12.5	3.5 - 12.5	3.5 - 12.5
Dimensions (in)	A	10.4	11.0	14.8	14.7	14.0
	B	7.3	6.9	8.9	8.9	9.8
	B	14.6	15.2	19.7	19.7	20.5
	C	2.6	3.0	3.9	4.4	4.7
	D	0.2	0.2	0.3	0.4	0.5
	E	8.5	8.7	11.0	11.0	11.2
	F	5.9	5.7	9.1	9.1	9.1
	F	3.5	3.1	5.3	5.3	6.3
	G	1.3	1.3	2.2	2.2	2.0
H	0.9	0.9	1.0	1.3	1.7	
Net Weight	(lbs)	8.8	11.0	22.0	26.4	35.9
Gross Weight	(lbs)	9.9	12.1	24.0	28.4	37.8

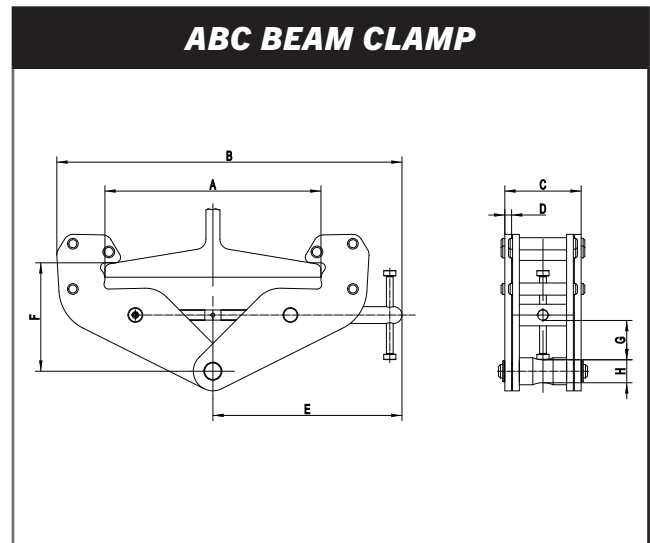

STRONGEST, SAFEST, and MOST RELIABLE hoists in the world.

Backward & Forward lever

placed in tandem providing a slim design and assuring power transfer along the center

Built-in shearing pin

prevent overload
It functions at approx. 25% overload
The pins can be replaced without removing the load

Safety pin

fastens the anchor bolt

Spare shear pins

Two pieces of spare shear pins located in the carrying handle

Rope clamp system

Easily disengaged with a lever allowing smooth installation of the wire rope

High strength cast aluminium alloy body

Light weight
Simple to operate
Smooth contour
Design with large, flat bottom surface for increased stability in horizontal as well as vertical working position

Anchor bolt

Offers numerous and versatile connection possibilities with load hooks, sling ropes and sling chains

Stamped serial number

for easy identification



GRIP PULLER

HAND HOIST SPECIFICATIONS

Product Number		AGP-008	AGP-016	AGP-032	AGP-054
Lifting Capacity (Rated Load)	(ton)	0.8	1.6	3.2	5.4
Lifting Capacity (Rated Load)	(lbs)	1,760	3,500	7,050	11,880
*Pulling Capacity	(ton)	1.2	2.4	4	8.1
*Pulling Capacity	(lbs)	2,640	5,250	10,575	17,820
Lever Pull at Rated Load	(N)	284	412	441	850
Forward Travel	(in)	2.0	2.2	1.1	1.0
Wire Rope Diameter	(mm)	8.3	11	16	20
Wire Rope Diameter	(in)	5/16	7/16	5/8	13/16
Net Weight (Body)	(lbs)	14.1	27.3	51.3	127.6
Gross Weight (Body)	(lbs)	15.9	29.5	143.6	130.9
Net Weight (Lever Handle)	(lbs)	2.5	5.5	5.5	8.1
Net Weight (65 ft Wire Rope)	(lbs)	15.4	25.3	51.7	79.2
Gross Weight (65 ft Wire Rope)	(lbs)	16.9	27.1	53.9	82.0
Dimensions (Body) L x W x H	(in)	17.3 x 2.7 x 10.0	22.0 x 3.9 x 11.6	26.6 x 4.7 x 13.8	37.0 x 6.7 x 17.3

Every ALR Grip Pullers meets or exceeds ANSI/ASME B30.21 Standards



We are committed to building the

TITON Series



STRENGTH • SAFETY • RELIABILITY

STRONGEST, SAFEST, and MOST RELIABLE hoists in the world.



STANDARD DUTY

“We deliver it everyday”

INDUSTRY LEADING FEATURES

Zinc Flake Coating

We are one of the only manufacturers to use “Zinc Flake” coating on crucial parts. The use of this type of coating gives our hoist the ability to last in extreme environments such as in or around saltwater. In extensive Salt Spray testing, our hoists last more than 200 hours before rusting appears. Most of our competitors will only last 30 hours before rusting appears. — **RELIABILITY**

Drop Forged Pinion Shaft

Our lever hoist pinion shafts and washers are drop forged with Titanium embedded into the metal creating a single strong shaft for ultimate strength. Most manufacturers simply add a washer onto their pinion shafts. — **STRENGTH**

Caged & Sealed Roller Bearings

Caged and Sealed Roller bearings provides smooth, controlled operation of the gears and shafts. This ensures maintenance-free lubrication and increased efficiency. — **STRENGTH**

Forged Identity Markings

We are one of the only manufacturers to have our manufacturing identifying marks and production date codes, plus the hook's rated capacity, embedded on the sides of the hook during the drop forge operation. Traceability is a key component of being an ISO certified manufacturer of hoists. — **SAFETY**

Heavy Duty Cast Steel Safety Latch

This new Heavy-Duty cast-steel safety latch design bulks up the base of the latch where the torque and side load stresses are greatest, this is where ordinary stamped latches fail and will bend out of compliance. The latch also has a bolt-and-lock nut connection which simplifies changing latches in the field. — **STRENGTH — SAFETY — RELIABILITY**

Heavy Duty Chain Stop Grip

The ergonomically designed and black phosphate coated cast chain stop used in our level hoists is more comfortable to grasp than the ordinary O-Ring. The design prevents the load chain from feeding through the hoist body and has the same highly corrosion resistant and scratch resistant coating that's applied to the Load Chain. — **SAFETY**

Hook Strength Pads

Small Raised Pads - At the base and tip of each hook are permanent measuring points to check the hook's throat opening for signs of “stretching”—an indication that the hoist has been overloaded and that the hook should be replaced. — **STRENGTH**

STANDARD FEATURES

All-Steel Construction

Impact resistant all-steel construction ensures added durability and protection while providing a long and dependable service life in toughest environments. — **STRENGTH**

Premium Powder Coated Finish

Featuring a specifically designed long lasting powder coat finish for harsh environments. — **RELIABILITY**

Heavy Duty Black Oxide Chain

We manufacture and test 100% of our Grade 100 Equivalent load chain. — **STRENGTH**

Weston-Style Brake System

Weston-Style load brake system has a Chrome Plated twin ratchet pawl brake design to reduce rusting. Fusing one brake disc to each side of the paw allows the load to be divided between two disc and helps eliminates premature brake-disc failure. — **RELIABILITY**



STRONGEST, SAFEST, and MOST RELIABLE hoists in the world.



LEVER HOIST

Product Number	Capacity (ton)	Capacity (lbs)	Chain (ft)
TLH-008-05	3/4	1,760	5
TLH-008-10	3/4	1,760	10
TLH-008-15	3/4	1,760	15
TLH-008-20	3/4	1,760	20
TLH-010-05	1	2,200	5
TLH-010-10	1	2,200	10
TLH-010-15	1	2,200	15
TLH-010-20	1	2,200	20
TLH-016-05	1.6	3,500	5
TLH-016-10	1.6	3,500	10
TLH-016-15	1.6	3,500	15
TLH-016-20	1.6	3,500	20
TLH-032-05	3.2	7,050	5
TLH-032-10	3.2	7,050	10
TLH-032-15	3.2	7,050	15
TLH-032-20	3.2	7,050	20
TLH-063-05	6.3	13,900	5
TLH-063-10	6.3	13,900	10
TLH-063-15	6.3	13,900	15
TLH-063-20	6.3	13,900	20

Custom Chain Lengths and Shipyard Hooks Available

Every ALR Hoist meets or exceeds ANSI/ASME HST-3 Standards

TITON SERIES LEVER HOIST SPECIFICATIONS & DIMENSIONS

Product Number			TLH-008	TLH-010	TLH-016	TLH-032	TLH-063
Capacity		(ton)	3/4	1	1.6	3.2	6.3
Number of Falls			1	1	1	1	2
Capacity		(lbs)	1,760	2,200	3,500	7,050	13,900
Capacity Test Load		(lbs)	2,640	3,300	5,250	10,575	20,850
Capacity Test Load		(ton)	1.2	1.5	2.4	4.8	9.5
Load Chain		(mm)	5.6x17	5.6x17	7.1x21	10x30	10x30
Standard Lift		(ft)	5	5	5	5	5
Height	h	(in)	11.0	11.8	13.2	15.6	21.3
Length	a	(in)	5.8	5.8	6.5	7.7	7.7
Width	b	(in)	3.5	3.5	4.2	4.4	4.4
Net Weight		(lbs)	13.4	13.6	21.1	37.2	65.8
Gross Weight		(lbs)	14.3	14.5	22.3	38.9	68.4
Pull to Rated Load		(N)	258	346	342	350	375
Dimensions	a	(in)	5.8	5.8	6.5	7.7	7.7
	b	(in)	3.5	3.5	4.2	4.4	4.4
	c	(in)	14.0	14.0	14.0	17.0	17.0
	d	(in)	3.9	3.9	4.2	4.4	4.4
	e	(in)	1.0	1.2	1.4	1.7	2.1
	f	(in)	1.4	1.7	1.7	2.0	2.4
	g	(in)	1.6	1.9	2.0	2.4	3.3
	h	(in)	11.0	11.8	13.2	15.6	21.3
t	(in)	0.6	0.6	0.7	1.0	1.3	

Series

TITON



STRONGEST, SAFEST, and MOST RELIABLE hoists in the world.

MANUAL OPERATED LEVER HOIST - TLH Series

3
YEAR*
WARRANTY

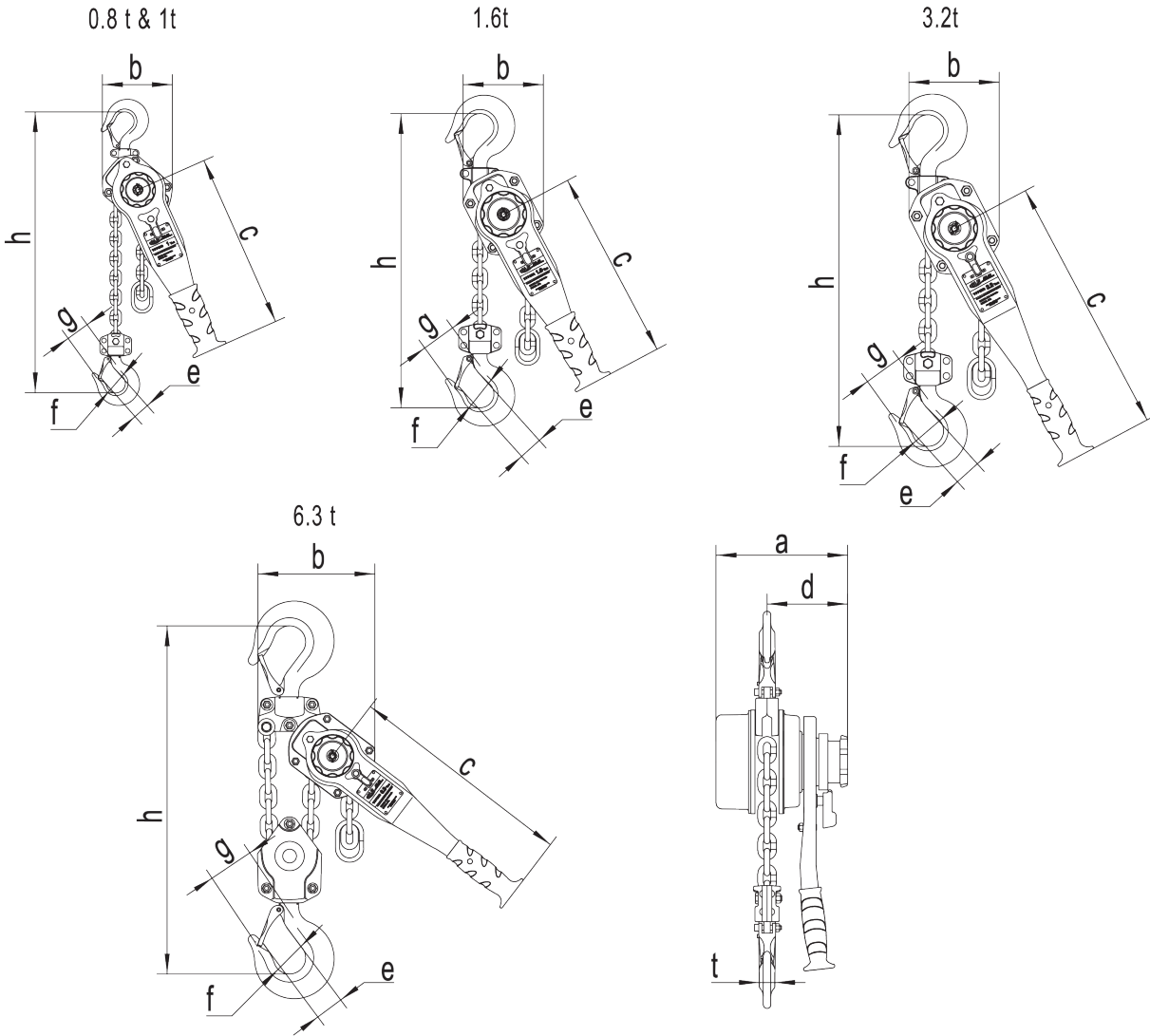

LEVER HOIST



All-Steel Construction

Impact resistant all-steel construction ensures added durability and protection while providing a long and dependable service life in toughest environments.

— *STRENGTH*

Premium Powder Coated Finish

Featuring a specifically designed long lasting powder coat finish for harsh environments. — *RELIABILITY*

Caged & Sealed Roller Bearings

Caged and Sealed Roller bearings provides smooth, controlled operation of the gears and shafts. This ensures maintenance-free lubrication and increased efficiency. — *STRENGTH*

Forged Identity Markings

We are one of the only manufacturers to have our manufacturing identifying marks and production date codes, plus the hook's rated capacity, embedded on the sides of the hook during the drop forge operation. Traceability is a key component of being an ISO-certified manufacturer of hoists.

— *SAFETY*

Heavy Duty Cast Steel Safety Latch

This new Heavy-Duty cast-steel safety latch design bulks up the base of the latch where the torque and side load stresses are greatest, this is where ordinary stamped latches fail and will bend out of compliance. The latch also has a bolt-and-lock nut connection which simplifies changing latches in the field.

— *STRENGTH* — *SAFETY* — *RELIABILITY*

Hook Strength Pads

Small Raised Pads - At the base and tip of each hook are permanent measuring points to check the hook's throat opening for signs of "stretching"—an indication that the hoist has been overloaded and that the hook should be replaced. — *STRENGTH*

360-Degree Hook Rotation

The 360-Degree swivel hook design allows the operator to work in confined spaces with quick and easy positioning of the hoist in any directions. — *RELIABILITY*

Weston-Style Brake System

Weston-Style load brake system has a Chrome Plated twin ratchet pawl brake design to reduce rusting. Fusing one brake disc to each side of the pawl allows the load to be divided between two disc and helps eliminates premature brake-disc failure. — *RELIABILITY*



STRONGEST, SAFEST, and MOST RELIABLE hoists in the world.



CHAIN HOIST

Product Number	Capacity (ton)	Capacity (lbs)	Chain (ft)
TCH-005-10	1/2	1,100	10
TCH-005-15	1/2	1,100	15
TCH-005-20	1/2	1,100	20
TCH-010-10	1	2,200	10
TCH-010-15	1	2,200	15
TCH-010-20	1	2,200	20
TCH-010-30	1	2,200	30
TCH-015-10	1.5	3,300	10
TCH-015-15	1.5	3,300	15
TCH-015-20	1.5	3,300	20
TCH-020-10	2	4,400	10
TCH-020-15	2	4,400	15
TCH-020-20	2	4,400	20
TCH-020-30	2	4,400	30
TCH-030-10	3	6,600	10
TCH-030-15	3	6,600	15
TCH-030-20	3	6,600	20
TCH-030-30	3	6,600	30
TCH-050-10	5	11,000	10
TCH-050-15	5	11,000	15
TCH-050-20	5	11,000	20
TCH-050-30	5	11,000	30
TCH-100-10	10	22,000	10
TCH-100-15	10	22,000	15
TCH-100-20	10	22,000	20
TCH-100-30	10	22,000	30

Every ALR Hoist meets or exceeds ANSI/ASME HST-3 Standards



We are committed to building the

TITON SERIES CHAIN HOIST SPECIFICATION & DIMENSIONS

Product Number			TCH-005	TCH-010	TCH-015	TCH-020	TCH-030	TCH-050	TCH-100
Capacity		(ton)	0.5	1	1.5	2	3	5	10
No. of Falls			1	1	1	1	2	2	4
Capacity		(lbs)	1,100	2,200	3,300	4,400	6,600	11,000	22,000
Capacity Test Load		(lbs)	1,650	3,300	4,950	6,600	9,900	16,500	33,000
Capacity Test Load		(ton)	0.75	1.5	2.25	3	4.5	7.5	15
Load Chain		(mm)	5x15	6x18	8x24	8x24	8x24	10x30	10x30
Standard Lift		(ft)	10	10	10	10	10	10	10
Hand Chain		(mm)	5x25x17						
Height	h	(in)	11.0	12.0	14.5	17.5	20.5	23.6	29.9
Length	a	(in)	4.9	5.3	5.9	6.2	6.2	7.1	7.1
Width	b	(in)	5.1	6.1	6.8	7.3	9.3	10.3	14.4
Net Weight		(lbs)	17.1	24.8	32.5	37.2	51.3	90.4	156.4
Gross Weight		(lbs)	18.5	25.7	33.9	38.5	52.8	93.2	168.5
Pull to Rated Load		(N)	219	254	351	405	366	385	426
Dimensions	a	(in)	4.9	5.3	5.9	6.2	6.2	7.1	7.1
	b	(in)	5.1	6.1	6.8	7.3	9.3	10.3	14.4
	c	(in)	1.7	2.0	2.5	2.5	3.9	5.0	10.2
	d	(in)	1.0	1.2	1.3	1.3	2.2	2.9	4.2
	e	(in)	1.1	1.2	1.4	1.5	1.7	2.1	2.5
	f	(in)	1.4	1.7	1.7	1.8	1.9	2.4	3.3
	g	(in)	1.6	1.9	2.0	2.2	2.4	3.3	3.5
	h	(in)	11.0	12.0	14.5	17.5	20.5	23.6	29.9

Series

TITON

STRONGEST, SAFEST, and MOST RELIABLE hoists in the world.

TCH SERIES CHAIN HOIST

3
YEAR*
WARRANTY

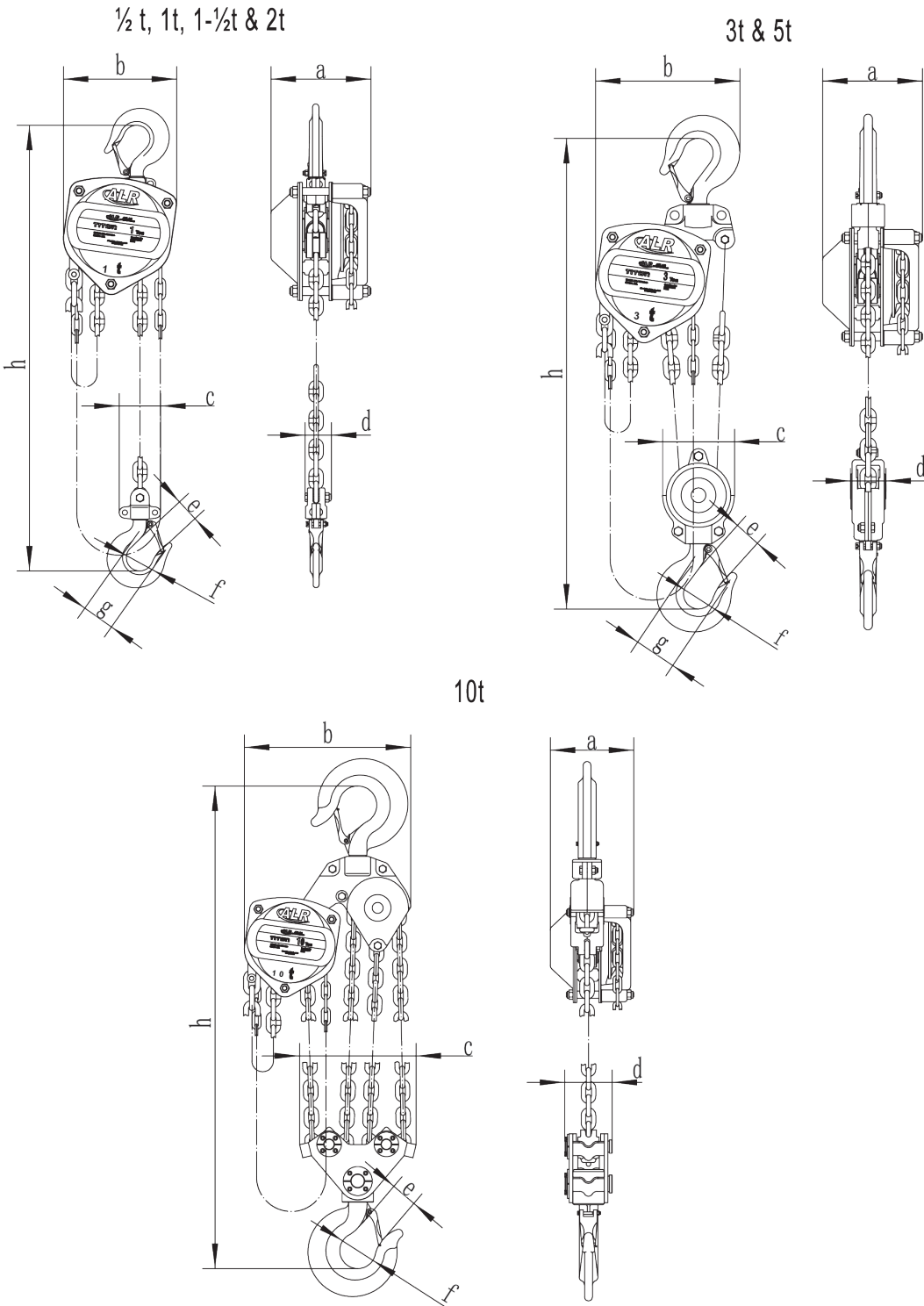

CHAIN HOIST

Every ALR Hoist meets or exceeds ANSI / ASME HST-3 Standards

The TLHC Series Mini-Ratchet Lever Hoist are the most compact ratchet lever hoists on the market. They perform just like the larger models, but can be easily transported and stored in a toolbox.

All-Steel Construction

Impact resistant all-steel construction ensure added durability and protection while providing a long and dependable service life in toughest environments - **STRENGTH**

Double Pawl (for 550lbs) - SAFETY

With Disc Gear (for 1100lbs) - EFFICIENT

- Weston-type load brake.
- Rubber hand grip for better comfort and security.
- Lightweight design for easy portability. Use in confined spaces with one-hand operation.
- Forged upper and lower hooks with latches standard.
- Impact-resistant, all-steel frame, gear case and cover.
- Free wheeling feature allows for quick load attachment.



Heavy-Duty Cast Steel Latch

This new Heavy-Duty case-steel safety latch design bulks up the base of the latch where the torque and side load stresses are greatest, this is where ordinary stamped latches fail and will bend out of compliance. The latch also has a bolt-and-lock nut connection which simplifies changing latches in the field - **STRENGTH**

Relaxed Grip Handle Design

Molded from a unique engineered thermoplastic, this new grip provides a soft, tactile surface that "relaxes the grip" to reduce fatigue, yet durable enough to survive years of use and exposure to the elements - **SAFETY**

- Every unit is inspected and tested to 150% of rated capacity before leaving the factory in accordance with ASME B30.21 requirements.

MANUAL OPERATED COMPACT LEVER HOIST

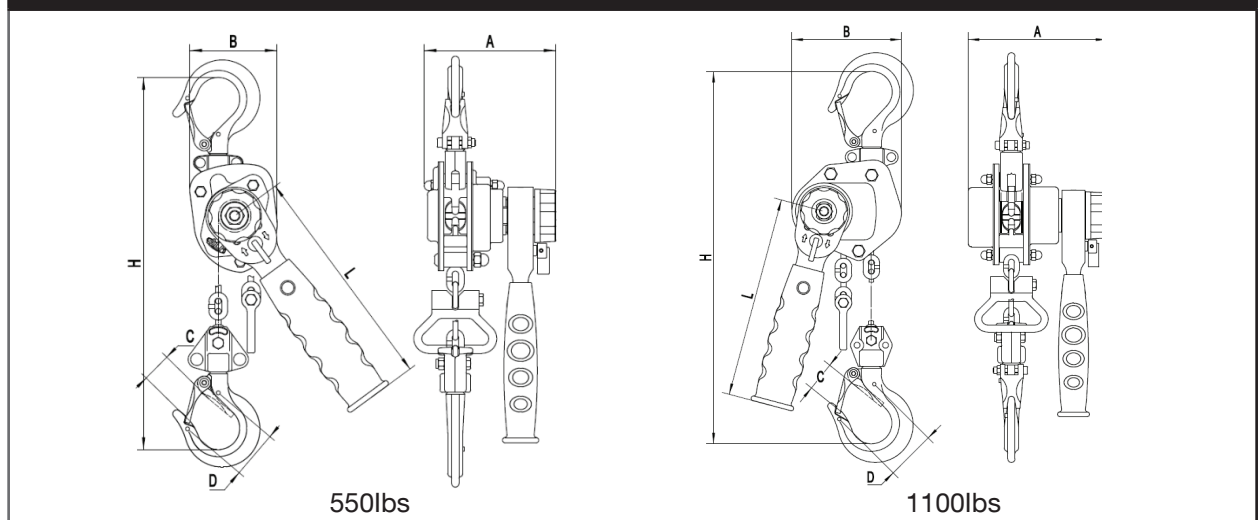

Every ALR Hoist meets or exceeds ANSI/ASME HST-3 Standards

STRONGEST, SAFEST, and MOST RELIABLE hoists in the world.



COMPACT LEVER HOIST

TLHC SERIES COMPACT LEVER HOIST		
Product Number	Description	Capacity (lbs)
TLHC-0025-05	1/4 Ton Lever Hoist with 5ft. Chain Fall	550
TLHC-0025-10	1/4 Ton Lever Hoist with 10 ft. Chain Fall	550
TLHC-0025-15	1/4 Ton Lever Hoist with 15 ft. Chain Fall	550
TLHC-0025-20	1/4 Ton Lever Hoist with 20 ft. Chain Fall	550
TLHC-005-05	1/2 Ton Lever Hoist with 5 ft. Chain Fall	1,100
TLHC-005-10	1/2 Ton Lever Hoist with 10 ft. Chain Fall	1,100
TLHC-005-15	1/2 Ton Lever Hoist with 15 ft. Chain Fall	1,100
TLHC-005-20	1/2 Ton Lever Hoist with 20 ft. Chain Fall	1,100

Custom Chain Lengths Available

TLHC COMPACT LEVER HOIST SPECIFICATIONS				
Product Number	Capacity	(ton)	TLHC-0025 1/4	TLHC-0050 1/2
Capacity		(lbs)	550	1,100
Load Chain		(mm)	4x12	4.3x12
Pull to Rated Load		(lbs)	76.4	64.7
Proof Load		(lbs)	825	1,650
Standard Lift		(ft)	5	5
Net Weight		(lbs)	4.4	6.6
Gross Weight		(lbs)	4.8	7.2
Headroom	H	(in)	9.1	10.2
Handle Length	D	(in)	6.7	6.7
Dimensions	A	(in)	3.9	4.6
	B	(in)	2.6	3.6
	C	(in)	0.8	0.9
	D	(in)	1.4	1.7
	H	(in)	9.1	10.2
	L	(in)	6.7	6.7

Powerful Performance In A Hard Working Design

The Titon Series Electric Chain Hoists are easy to operate, service, require minimal maintenance, and offer excellent headroom for every lifting application.

Standard overload device protects the hoist, operator, and surrounding structure from damaging overloads.

The Titon Series of Electric Hoists are:

Strong

- Electromagnetic brake holds a load even if power is interrupted
- Upper and lower limit switches prevent over-travel
- Built-in chain bag keeps chain out of the way during operation
- Ventilated heavy-duty motor shuts down to prevent overheating

Safe

- Handheld remote control with emergency stop switch can be controlled up to 20 feet away.
- Can be easily attached to most trolleys or beam clamps.
- Heat-treated, drop-forged hooks swivel 360° for easy rigging.

Reliable

- Quick-connect wiring connects power with pushbutton controls for smooth operation.
- Permanently lubricated gear train delivers a long life with low maintenance.
- Offered in single phase and three phase units.
- Integrated slip clutch ensures continuous duty and tension control and protects transmission from overload
- Gear trains are permanently lubricated for long life and minimal maintenance

US and EU Standards ASME HST-1, ASME B30.16, EN14492-2, EN60204-32
2 Year Warranty, Service and Parts Available in Stock in the USA



STRONGEST, SAFEST, and MOST RELIABLE hoists in the world.

TITON SERIES ELECTRIC CHAIN HOIST

Product Number	Capacity (ton)	Lift (ft)	Lifting Speed (fpm)	Motor (Prewired to 115V)	Rated Amps 115V	Rated Amps 230V	Headroom (in)	Duty Cycle Rating / Cycle	Load Chain (dia/mm) x No. of Falls	Max On Time Min/Hr.	Max No. Starts/Hr.	Net Weight (lbs)	Gross Weight (lbs)
----------------	----------------	-----------	---------------------	--------------------------	-----------------	-----------------	---------------	---------------------------	------------------------------------	---------------------	--------------------	------------------	--------------------

1/2-TON Single Speed 1 Phase

TEH-1-005-10	1/2	10	24.3	1-3/5HP, 115V, 1 Ph.	9.7	5.1	20-1/2	H3/25%	7.1 x 1	15	150	126.2	154.2
TEH-1-005-20	1/2	20	24.3	1-3/5HP, 115V, 1 Ph.	9.7	5.1	20-1/2	H3/25%	7.1 x 1	15	150	134	162
TEH-1-005-30	1/2	30	24.3	1-3/5HP, 115V, 1 Ph.	9.7	5.1	20-1/2	H3/25%	7.1 x 1	15	150	141.8	169.8

1-TON Single Speed 1 Phase

TEH-1-010-10	1	10	23.6	1-3/5HP, 115V, 1 Ph.	15.8	8	20-1/2	H3/25%	7.1 x 1	15	150	126.2	154.2
TEH-1-010-20	1	20	23.6	1-3/5HP, 115V, 1 Ph.	15.8	8	20-1/2	H3/25%	7.1 x 1	15	150	134	162
TEH-1-010-30	1	30	23.6	1-3/5HP, 115V, 1 Ph.	15.8	8	20-1/2	H3/25%	7.1 x 1	15	150	141.8	169.8

2-TON Single Speed 1 Phase

TEH-1-020-10	2	10	11.8	1-3/5HP, 115V, 1 Ph.	15.8	8	24-4/5	H3/25%	7.1 x 2	15	150	140.7	168.7
TEH-1-020-20	2	20	11.8	1-3/5HP, 115V, 1 Ph.	15.8	8	24-4/5	H3/25%	7.1 x 2	15	150	157.2	185.2
TEH-1-020-30	2	30	11.8	1-3/5HP, 115V, 1 Ph.	15.8	8	24-4/5	H3/25%	7.1 x 2	15	150	173.7	201.7

3-TON Single Speed 1 Phase

TEH-1-020-10	2	10	7.9	1-3/5HP, 115V, 1 Ph.	15.8	8	27-9/10	H3/25%	7.1 x 3	15	150	155	183
TEH-1-020-20	2	20	7.9	1-3/5HP, 115V, 1 Ph.	15.8	8	27-9/10	H3/25%	7.1 x 3	15	150	177.2	205.2
TEH-1-020-30	2	30	7.9	1-3/5HP, 115V, 1 Ph.	15.8	8	27-9/10	H3/25%	7.1 x 3	15	150	199.4	227.4

Product Number	Capacity (ton)	Lift (ft)	Lifting Speed (fpm)	Motor (Prewired to 460V)	Rated Amps 230V	Rated Amps 460V	Headroom (in)	Duty Cycle Rating / Cycle	Load Chain (dia/mm) x No. of Falls	Max On Time Min/Hr.	Max No. Starts/Hr.	Net Weight (lbs)	Gross Weight (lbs)
----------------	----------------	-----------	---------------------	--------------------------	-----------------	-----------------	---------------	---------------------------	------------------------------------	---------------------	--------------------	------------------	--------------------

1/2-TON Single Speed 3 Phase

TEH-3-005-10	1/2	10	28.2	2-1/7HP, 460V, 3 Ph.	4.6	2.3	20-1/2	H4/30%	7.1 x 1	18	180	126.2	154.2
TEH-3-005-20	1/2	20	28.2	2-1/7HP, 460V, 3 Ph.	4.6	2.3	20-1/2	H4/30%	7.1 x 1	18	180	134	162
TEH-3-005-30	1/2	30	28.2	2-1/7HP, 460V, 3 Ph.	4.6	2.3	20-1/2	H4/30%	7.1 x 1	18	180	141.8	169.8

1-TON Single Speed 3 Phase

TEH-3-010-10	1	10	27.5	2-1/7HP, 460V, 3 Ph.	6.3	3.1	20-1/2	H4/30%	7.1 x 1	18	180	126.2	154.2
TEH-3-010-20	1	20	27.5	2-1/7HP, 460V, 3 Ph.	6.3	3.1	20-1/2	H4/30%	7.1 x 1	18	180	134	162
TEH-3-010-30	1	30	27.5	2-1/7HP, 460V, 3 Ph.	6.3	3.1	20-1/2	H4/30%	7.1 x 1	18	180	141.8	169.8

2-TON Single Speed 3 Phase

TEH-3-020-10	2	10	13.8	2-1/7HP, 460V, 3 Ph.	6.3	3.1	24-4/5	H4/30%	7.1 x 2	18	180	140.7	168.7
TEH-3-020-20	2	20	13.8	2-1/7HP, 460V, 3 Ph.	6.3	3.1	24-4/5	H4/30%	7.1 x 2	18	180	157.2	185.2
TEH-3-020-30	2	30	13.8	2-1/7HP, 460V, 3 Ph.	6.3	3.1	24-4/5	H4/30%	7.1 x 2	18	180	173.7	201.7

3-TON Single Speed 3 Phase

TEH-3-030-10	3	10	15.7	4HP, 460V, 3 Ph.	11	6.5	31-1/2	H3/25%	9 x 2	18	180	209.4	237.4
TEH-3-030-20	3	20	15.7	4HP, 460V, 3 Ph.	11	6.5	31-1/2	H3/25%	9 x 2	18	180	232.9	260.9
TEH-3-030-30	3	30	15.7	4HP, 460V, 3 Ph.	11	6.5	31-1/2	H3/25%	9 x 2	18	180	256.4	284.4



ELECTRIC HOIST

ELECTRIC CHAIN HOIST

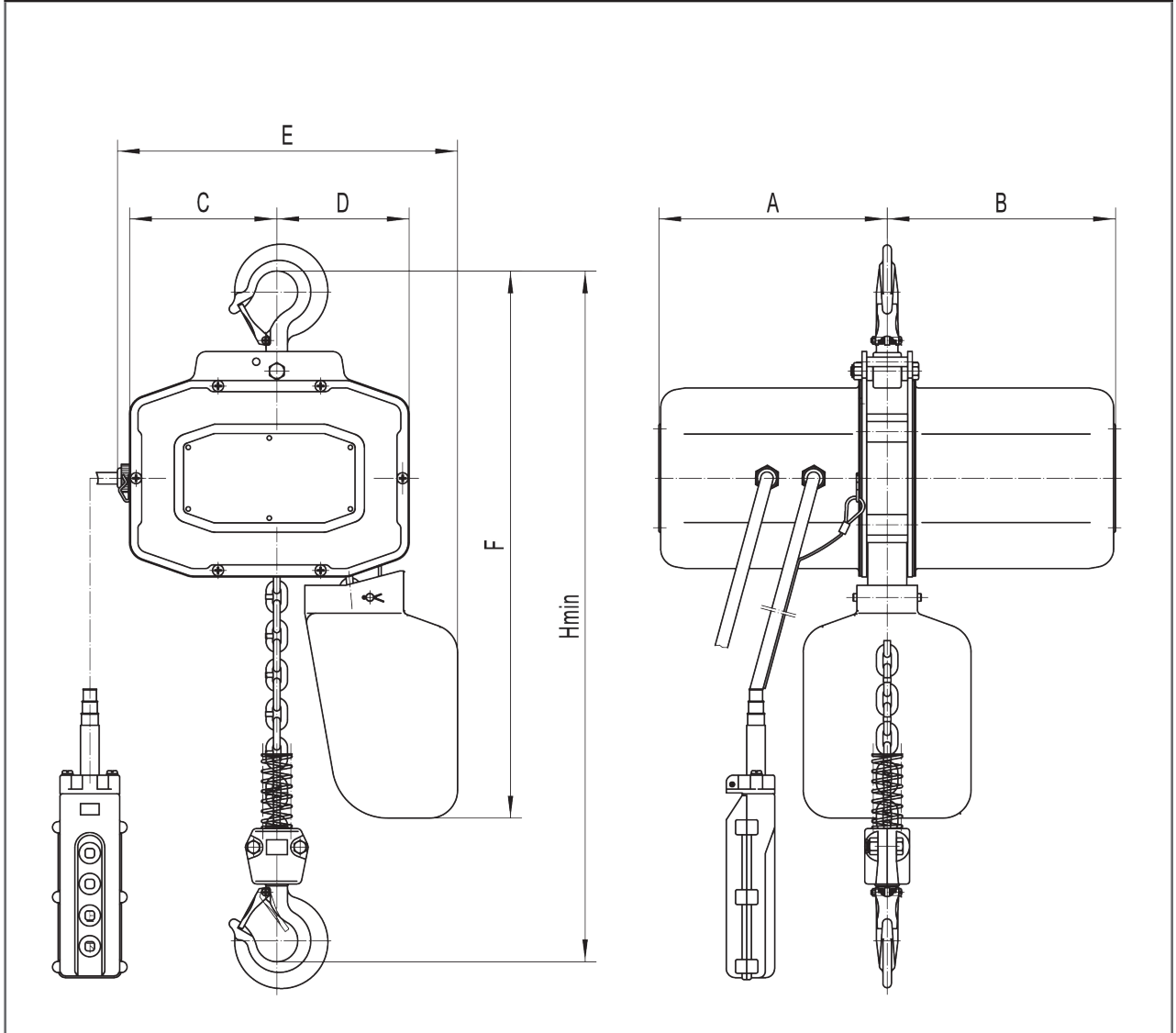

TITON ELECTRIC CHAIN HOIST DIMENSIONS

Product Number			TEH-1-005	TEH-1-010	TEH-1-020	TEH-3-005	TEH-3-010	TEH-3-020	TEH-3-030
Capacity		(ton)	0.5	1	2	0.5	1	2	3
Headroom Hmin	H	(in)	20.5	20.5	24.8	20.5	20.5	24.8	31.5
Dimensions	A	(in)	9.6	9.6	9.6	9.6	9.6	9.6	10.4
	B	(in)	9.6	9.6	9.6	9.6	9.6	9.6	10.4
	C	(in)	6.2	6.2	4.9	6.2	6.2	4.9	5.0
	D	(in)	5.6	5.6	6.9	5.6	5.6	6.9	8.1
	E	(in)	13.8	13.8	13.8	13.8	13.8	13.8	15.5
	F	(in)	23.6	23.6	24.0	23.6	23.6	24.0	29.1

STRONGEST, SAFEST, and MOST RELIABLE hoists in the world.

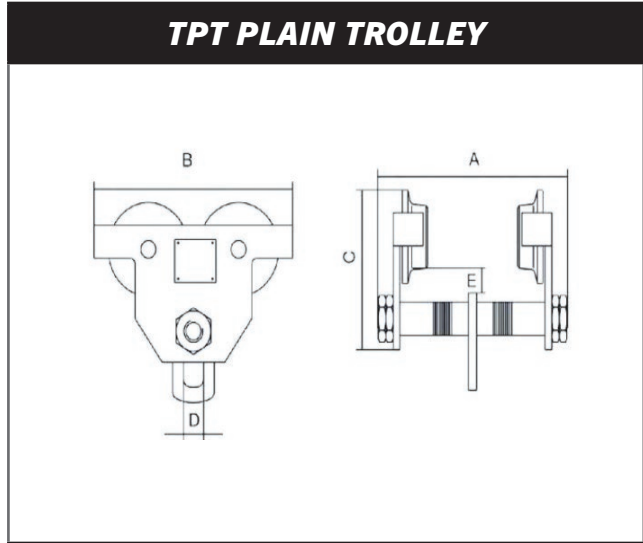

PLAIN TROLLEY

TPT PLAIN TROLLEY SPECIFICATIONS

Product Number		TPT-010	TPT-020	TPT-030
Capacity	(ton)	1	2	3
Capacity	(lbs)	2,200	4,400	6,600
Proof Load	(ton)	1.5	3	4.5
Proof Load	(lbs)	3,300	6,600	9,900
I-Beam Width	(in)	2 - 6	2.5 - 8	3.5 - 8
Dimensions (in)	A	9.1	11.7	12.3
	B	8.6	10.1	11.8
	C	6.1	7.1	8.4
	D	0.9	1.2	1.4
	E	0.9	0.9	0.9
Min. Radius Curve	(ft)	3.3	3.3	3.6
Net Weight	(lbs)	14.6	24.7	40.8
Gross Weight	(lbs)	15.7	26.0	43.0

Every ALR Hoist meets or exceeds ANSI / ASME HST-3 Standards



We are committed to building the



WARRANTY

WARRANTY INFORMATION AND TECHNICAL SERVICE

All products sold by Atlas Rigging & Lifting, LLC. are warranted to be free of defects in material and workmanship from date of shipment by Atlas Rigging & Lifting, LLC. If one of our products needs repair of service, please contact Technical Service at 1-833-ALR-LIFT, 8AM to 5PM Anywhere in the US, Monday through Friday.

Warranty Period and Coverage

- ALR products have a 3 YEAR WARRANTY, the products carry a standard limited warranty of 2 years and if the product is registered through our website (www.alrlift.com), ALR will add an additional 1 year to the warranty period.
- Accessories carry a limited warranty of one year from the date of receipt.
- This warranty covers only the initial purchaser of the product from the date of delivery.
- This warranty covers any defects in workmanship or materials subject to the limitations stated below.
- This warranty does not cover failures due directly or indirectly to misuse, abuse, negligence or accidents, normal wear-and-tear, improper repair, alterations or lack of maintenance.

See your owner's manual or visit our website for detailed information on the warranty of your ALR product. Every ALR lever hoist is tested and meets or exceeds OSHA and ANSI / ASME HST - 3 standards. Test certificate verifies that every hoist has been factory load tested to 150% of rated capacity.

Warranty Center
 Atlas Lifting & Rigging
 1-833-ALR-LIFT
 1-833-257-5438
www.ALRLift.com

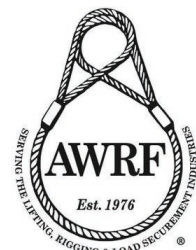

STRONGEST, SAFEST, and MOST RELIABLE hoists in the world.

NOTES

STRENGTH • SAFETY • RELIABILITY

“We deliver it everyday”



ALR

ATLAS

LIFTING & RIGGING

1-833-ALR-LIFT

1-833-257-5438

www.ALRLift.com