

TESSA TERRACE 2ND ADDITION

MOORHEAD, MN

12-16-21

- SOLD
- Contractor Lot
- Model

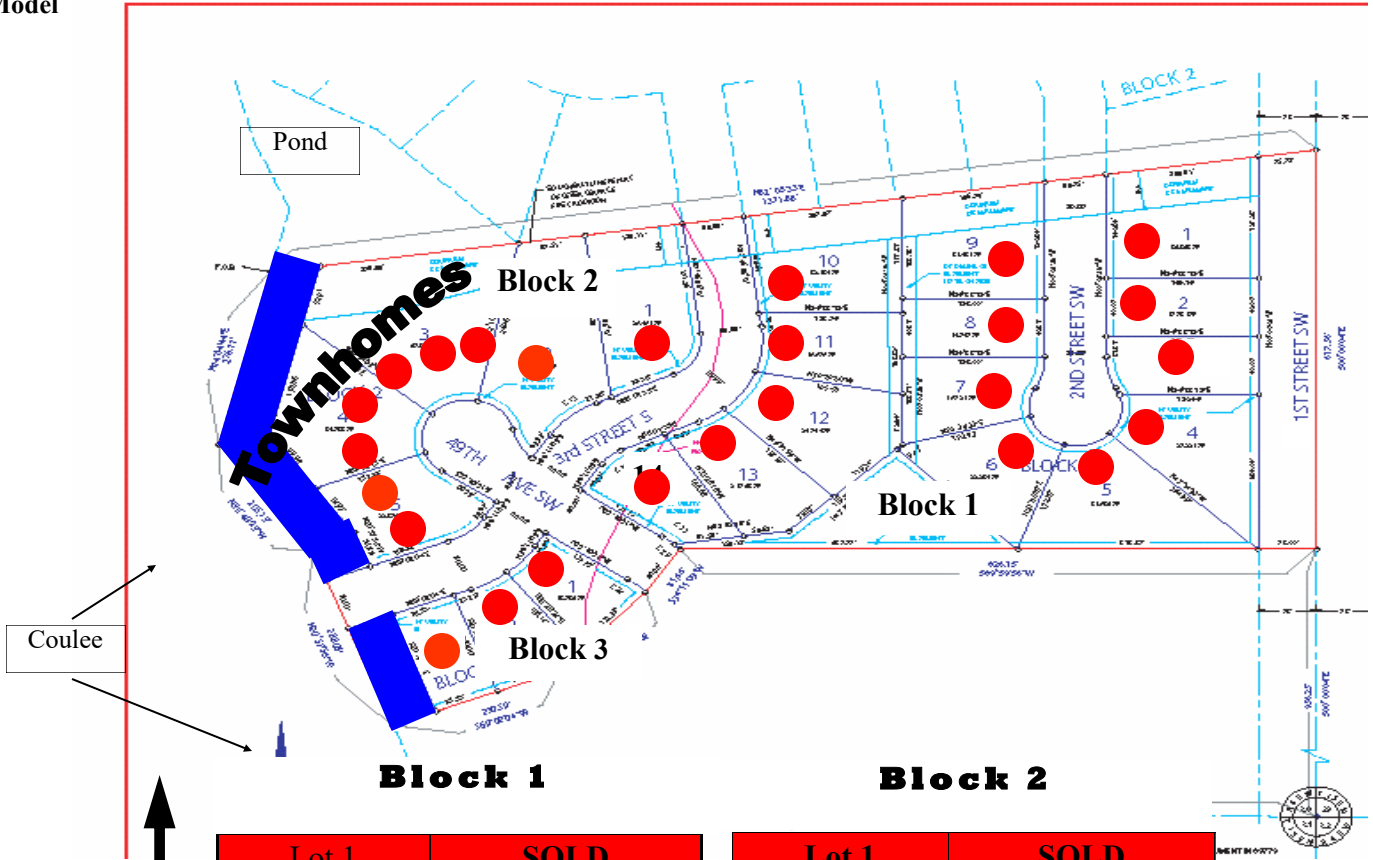

Lot 1	SOLD
Lot 2	SOLD
Lot 3	SOLD
Lot 4	SOLD
Lot 5	SOLD
Lot 6	SOLD
Lot 7	SOLD
Lot 8	SOLD
Lot 9	SOLD
Lot 10	SOLD
Lot 11	SOLD
Lot 12	SOLD
Lot 13	SOLD
Lot 14	SOLD

Lot 1	SOLD
Lot 2	Townhomes
Lot 3	
Lot 4	
Lot 5	

Block 3

Lot 1	SOLD
Lot 2	SOLD
Lot 3	SOLD

Purchaser responsible for special and general taxes of record payable in year of sale of thereafter.

- ◆ Neighborhood Association Membership Required (\$200/year) - due July 15th for previous 12 months
- ◆ Architectural Control Plan Submission Required Prior to Construction—2 Sets w/ Elevation
- ◆ General & Specials taxes due and payable in 2021 paid by purchaser
- ◆ Check for Updated Pricing
- ◆ \$295 Mailbox Fee
- ◆ EDIT NOTICE! Lot availability & prices may have been altered by someone not under the direction of R.S. Carey Land Co. Please verify these prices and availability with R. S. Carey Land Co. before making a decision.

Call *R. Scott Carey* for more information 218-979-6099 or 218-233-3630
 scott@rscareyland.com
 R. S. Carey Land Company
 1615 SE Main Avenue
 Moorhead, MN 56560

www.rscareyland.com