

LEWIS M. CARTER MFG. CO,
INC.

8794 WHEEL RAKE

QUALITY

SINCE 1954

SERVICE

"BUILT TO LAST EQUIPMENT"

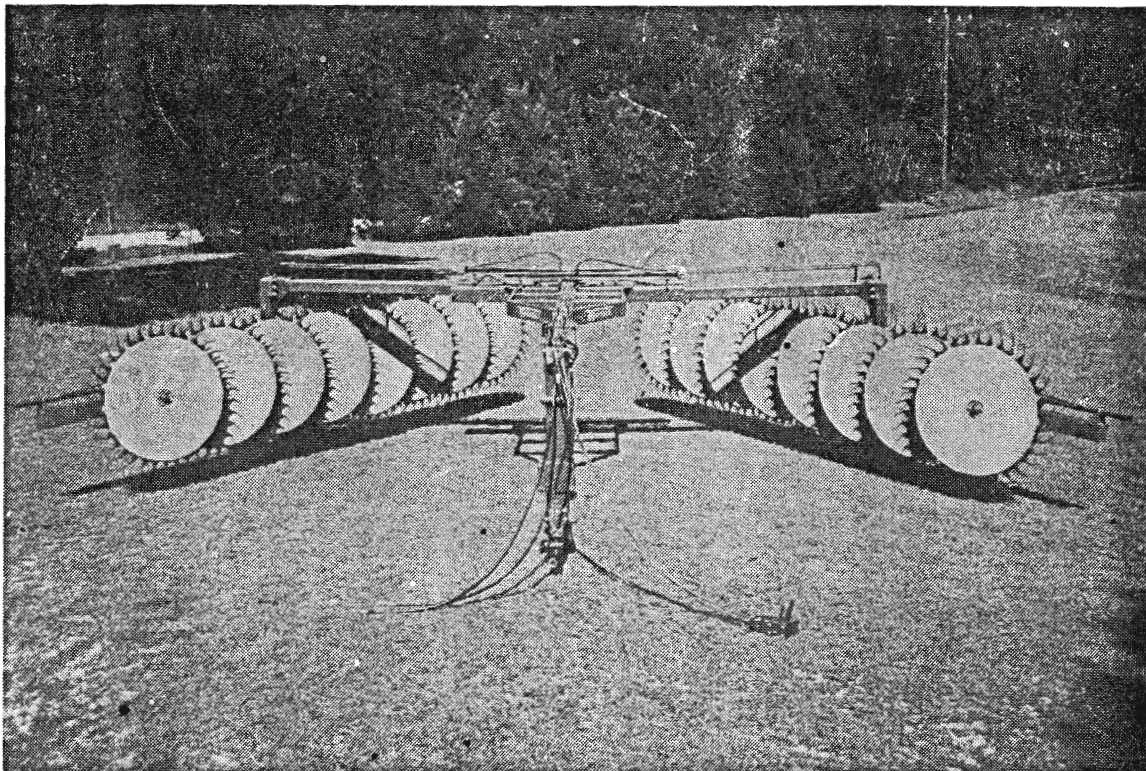

8794 WHEEL RAKE

PARTS MANUAL

APRIL 1996

CONTENTS

| | |
|---|----|
| MAIN FRAME | 6 |
| EXTENSION ARMS | 8 |
| WHEEL MOUNT ASSEMBLY. | 10 |
| WHEEL ASSEMBLY. | 12 |
| WHEEL HUB ASSEMBLY. | 13 |
| SPOOL & CHECK VALVE HYDRAULIC LINE ROUTING. | 14 |
| SWING & LIFT CYLINDER HYDRAULIC LINE ROUTING. | 16 |



SAFETY PRECAUTIONS



1. Always operate rake in a careful, controlled manner.
2. Always lower wheels to ground when not in use.
3. Stand clear of wheels when being raised or lowered.
4. Never operate rake while someone is standing on or inside main frame.
5. All personnel should stand clear of rake during preparation for movement of equipment from one location to another.
6. Always stand clear of rake when being operated.
7. Always place wheels in the down position before unhitching from tractor.
8. Do not park vehicles or place objects within 10 feet of the rear of the rake.
9. Always park rake on flat, level ground before unhooking from tractor.
10. When transporting rake, always make sure the wheel mounts are in the closed position and hydraulic spool valve hoses are connected to tractor outlets so the rake cannot open during transit.
11. Turn on flashing lights when transporting unit on highway, unless prohibited by law.
12. Never check for hydraulic leaks with hands or clothes.
13. Do not operate hydraulic systems when hydraulic leaks are present.
14. Do not operate unit close to high voltage electric lines.

SAFETY SYMBOLS

RECOGNIZE SAFETY INFORMATION

This is the safety symbol. When you see this symbol on your machine or in this manual, be alert to the potential for personal injury.

Follow recommended precautions and safe operating.



UNDERSTAND SIGNAL WORDS

A signal word – DANGER, WARNING, or CAUTION – is used with the safety-alert symbol. DANGER identifies the most serious hazards.

Safety signs with the signal word DANGER or WARNING are typically near specific hazards.

General precautions are listed on CAUTION safety signs. CAUTION also calls attention to safety messages in this manual.

 **DANGER**

 **WARNING**

 **CAUTION**

FOLLOW SAFETY INSTRUCTIONS

Carefully read all safety messages in this manual and on your machine safety signs. Keep safety signs in good condition. Replace missing or damaged safety signs.

Learn how to operate the machine and how to use controls properly. Do not let anyone operate without instruction.

Keep your machine in proper working condition. Unauthorized modifications to the machine may impair the function and/or affect machine life.

SAFETY INSTRUCTIONS AND RULES

KEEP RIDERS OFF MACHINE

Only allow the operator on the machine. Keep riders off.

Riders on machine are subject to injury such as being struck by foreign objects and being thrown off the machine. Riders also obstruct the operator's view resulting in the machine being operated in an unsafe manner.

OPERATOR'S MANUAL

Do not put this operator's manual away unread. Read the manual carefully regardless of previous experience. Allow yourself this time, it will save time and labor later on.

IMPORTANT: Keep an extra copy of the operator's manual in your office or in the garage in case one gets lost.

An extra copy may be acquired from your dealer.

PREPARE FOR EMERGENCIES

Be prepared if fire starts.

Keep a first aid kit and fire extinguisher handy.

Keep emergency numbers for doctors, ambulance service, hospital, and fire department near your telephone.

AVOID HIGH-PRESSURE FLUIDS

Escaping fluid under pressure can penetrate the skin causing serious injury. Relieve pressure before unhooking hydraulic or other lines. Tighten all connections before applying pressure. Keep hands and body away from pinholes and nozzles which eject fluids under pressure. Use a piece of cardboard to search for leaks.

If ANY fluid is injected into the skin, it must be surgically removed within a few hours by a doctor familiar with this type injury or gangrene may result.

CHECKING BOLT TORQUE

The table shown below gives correct torque values for various bolts and cap screws. Tighten all bolts to the torques specified in chart unless otherwise noted. Check tightness of bolts periodically using bolt torque chart as a guide. Replace hardware with the same strength bolt.

U.S. MEASUREMENT

| BOLT DIAMETER "A" | Bolt Torque in N-M (ft-lb) | | | | | |
|-------------------|----------------------------|-------|------|-------|------|--------|
| | SAE2 | | SAE5 | | SAE8 | |
| 1/4 | NOT USED | | 14 | (10) | 19 | (14) |
| 5/16 | NOT USED | | 27 | (20) | 41 | (30) |
| 3/8 | 31 | (23) | 47 | (35) | 68 | (50) |
| 7/16 | 47 | (35) | 75 | (55) | 108 | (80) |
| 1/2 | 75 | (55) | 115 | (85) | 163 | (120) |
| 9/16 | 102 | (75) | 176 | (130) | 237 | (175) |
| 5/8 | 142 | (105) | 231 | (170) | 325 | (240) |
| 3/4 | 217 | (160) | 407 | (300) | 576 | (425) |
| 7/8 | 251 | (185) | 603 | (445) | 929 | (685) |
| 1 | 339 | (250) | 910 | (670) | 1396 | (1030) |
| 1-1/4 | 450 | (330) | 1235 | (910) | 1979 | (1460) |

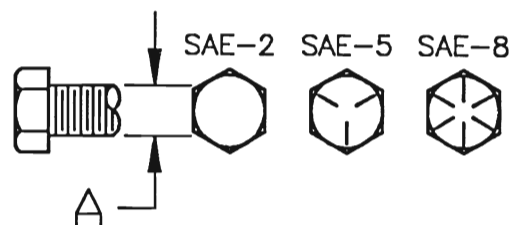

METRIC MEASUREMENT

| BOLT DIAMETER "A" | Bolt torque in N-M (ft-lb) | | | |
|-------------------|----------------------------|--------|------|--------|
| | 8.8 | | 10.9 | |
| 5mm | 6 | (5) | 9 | (7) |
| 6mm | 11 | (9) | 17 | (13) |
| 8mm | 28 | (20) | 40 | (30) |
| 10mm | 55 | (40) | 80 | (59) |
| 12mm | 95 | (70) | 140 | (103) |
| 16mm | 235 | (173) | 350 | (258) |
| 20mm | 475 | (350) | 675 | (498) |
| 24mm | 825 | (608) | 1170 | (863) |
| 30mm | 1630 | (1201) | 2320 | (1712) |

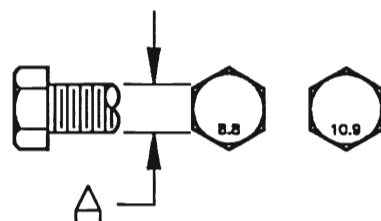

NOTE: Bolts having locknuts with plated and wax finish should be tightened to approximately 50 percent of amounts shown in chart.

MODEL 8794 WHEEL RAKE MAIN FRAME ASSEMBLY

ALL TUBES ARE SAME SIZE ON WHEEL RAKE WHICH IS 3/8" (REF. NO 26)

NO LONGER USES CLAMP - USES A TOP
PLATE W/ BOLTS - SEE ENGINEER DRAWINGS
1012 FOR AAAT NUMBERS
(ALSO FOR QTY AND
DESCRIPTION)

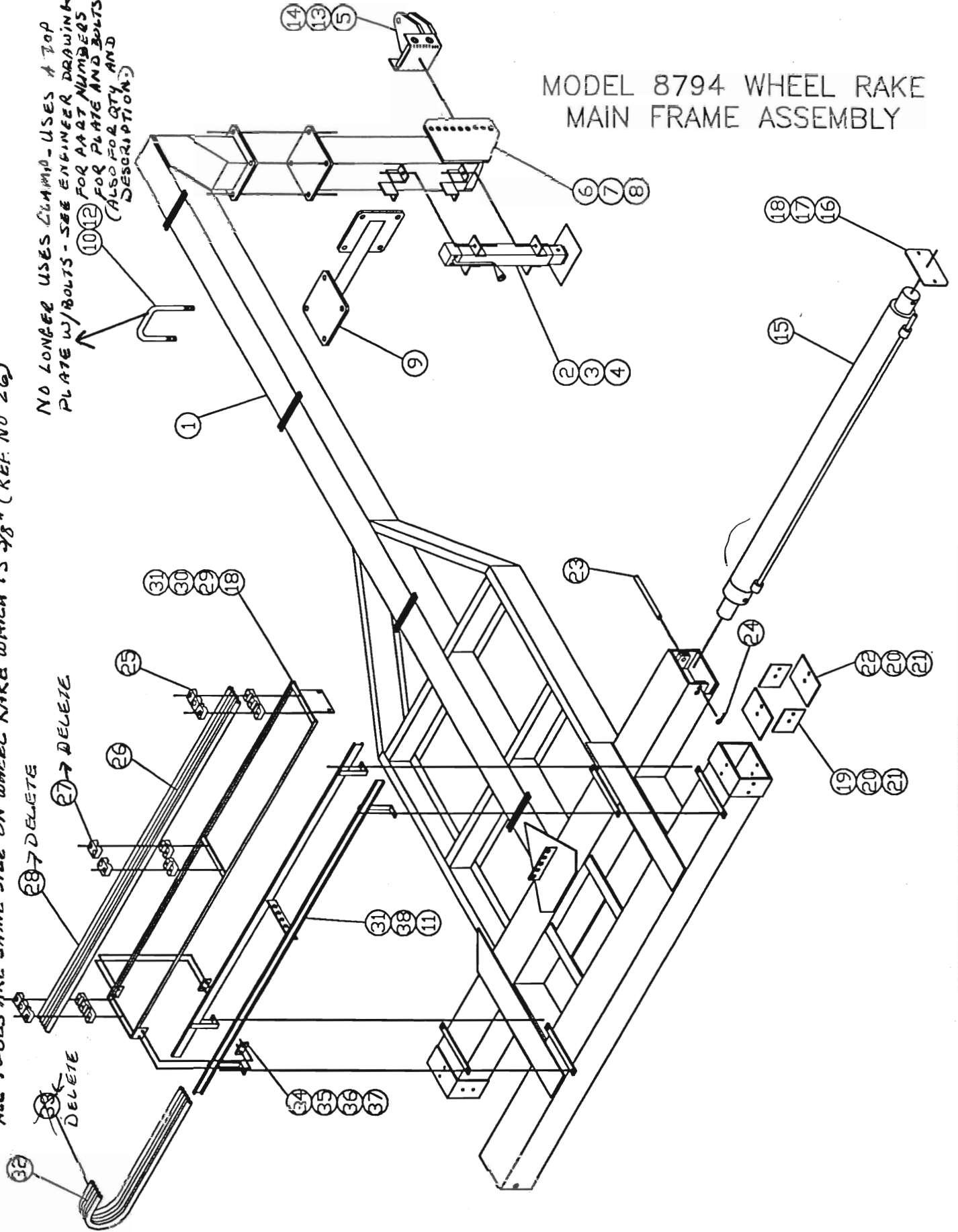

Main Frame Assembly

| Ref. No. | Harrell No. | Description | Qty. Req'd. |
|----------|----------------------|---|----------------------|
| 1 | 85-018-87 | Main Frame | 1 |
| 2 | 85-077-88 | Jack Stand | 1 |
| 3 | 2816-1210 | Hex Head Bolt 3/8"UNC x 1" Grade 5 | 4 |
| 4 | 1412-1200 | Hex Lock Nut 3/8"UNC | 4 |
| 5 | 85-074-88 | Hitch | 1 |
| 6 | 85-024-87 | Tongue Lower Section | 1 |
| 7 | 2816-2420 | Hex Head Bolt 3/4"UNC x 2" Grade 5 | 4 |
| 8 | 1412-2400 | Hex Lock Nut 3/4"UNC | 4 |
| 9 | 85-019-87 | Tongue Gusset | 1 |
| 10 | 79-035-38 | U-Bolt NO LONGER USES BOLT/USES TOP PLATE w/ BOLTS | 4 1 |
| 11 | 2816-0810 | Hex Head Bolt 1/4"UNC x 1" | 8 |
| 12 | 1412-2800 | Hex Lock Nut 7/8"UNC | 8 |
| 13 | 2816-2480 | Hex Head Bolt 3/4"UNC x 8" Grade 5 | 2 |
| 14 | 1412-2400 | Hex Lock Nut 3/4"UNC | 2 |
| 15 | 79-113-88 | Telescoping Cylinder | 2 |
| 16 | 93-010-87 | Bolt-on End Cap | 2 |
| 17 | 2816-0806 | Hex Head Bolt 1/4"UNC x 3/4" | 4 |
| 18 | 1702-0800 | Flat Washer 1/4" | 8 |
| 19 | 79-153-88 | Poly Slide Bearing <i>93-023-87 (8 1/2" x 4 7/8")</i> | 4 |
| 20 | 2816-1014 | Hex Head Bolt 5/16"UNC x 1 1/2" | 16 |
| 21 | 0812-1000 | Hex Nut 5/16"UNC | 16 |
| 22 | 79-005-87 | Poly Slide Bearing <i>93-021-87 (8 1/2" x 6 7/8")</i> | 4 |
| 23 | 96-005-87 | Extension Cylinder Pin, Butt End | 2 |
| 24 | 79-128-88 | Hair Pin Clip | 4 |
| 25 | 79-016-88 | Tubing Clamp 3/8" | 18 24 |
| 26 | 84-021-88 | Tube Assembly 3/8" x 75 1/2" | 3 8 |
| 27 | 79-012-88 | Tube Clamp 1/2" DELETE | 12 DELETE |
| 28 | 84-022-88 | Tube Assembly 1/2" x 75 1/2" DELETE | 2 DELETE |
| 29 | 85-028-88 | Tubing Rack | 2 |
| 30 | 2814-0804 | Hex Head Bolt 1/4"UNC x 1/2" | 4 |
| 31 | 1412-0800 | Hex Lock Nut 1/4"UNC | 15 |
| 32 | 79-041-88 | Hose Assembly AR-17 1/4 X 51 | 6 8 |
| 33 | 79-015-88 | Hose Assembly AR-7 DELETE | 4 DELETE |
| 34 | 79-001-88 | Poly Slide Bearing | 4 |
| 35 | 3114-0810 | Flat Head Screw 1/4"UNC x 1" | 8 |
| 36 | 0812-0800 | Hex Nut 1/4"UNC | 8 |
| 37 | 1602-0800 | Lock Washer 1/4" SAE | 8 |
| 38 | 85-022-87 | Lower Hose Rack | 2 |
| NS | 93-022-87 | SHIM (8 1/2" x 6 7/8") FOR 93-021-87 | |
| NS | 93-024-87 | SHIM (8 1/2" x 4 7/8") FOR 93-023-87 | |

MODEL 8794 WHEEL RAKE
EXTENSION ARM ASSEMBLY

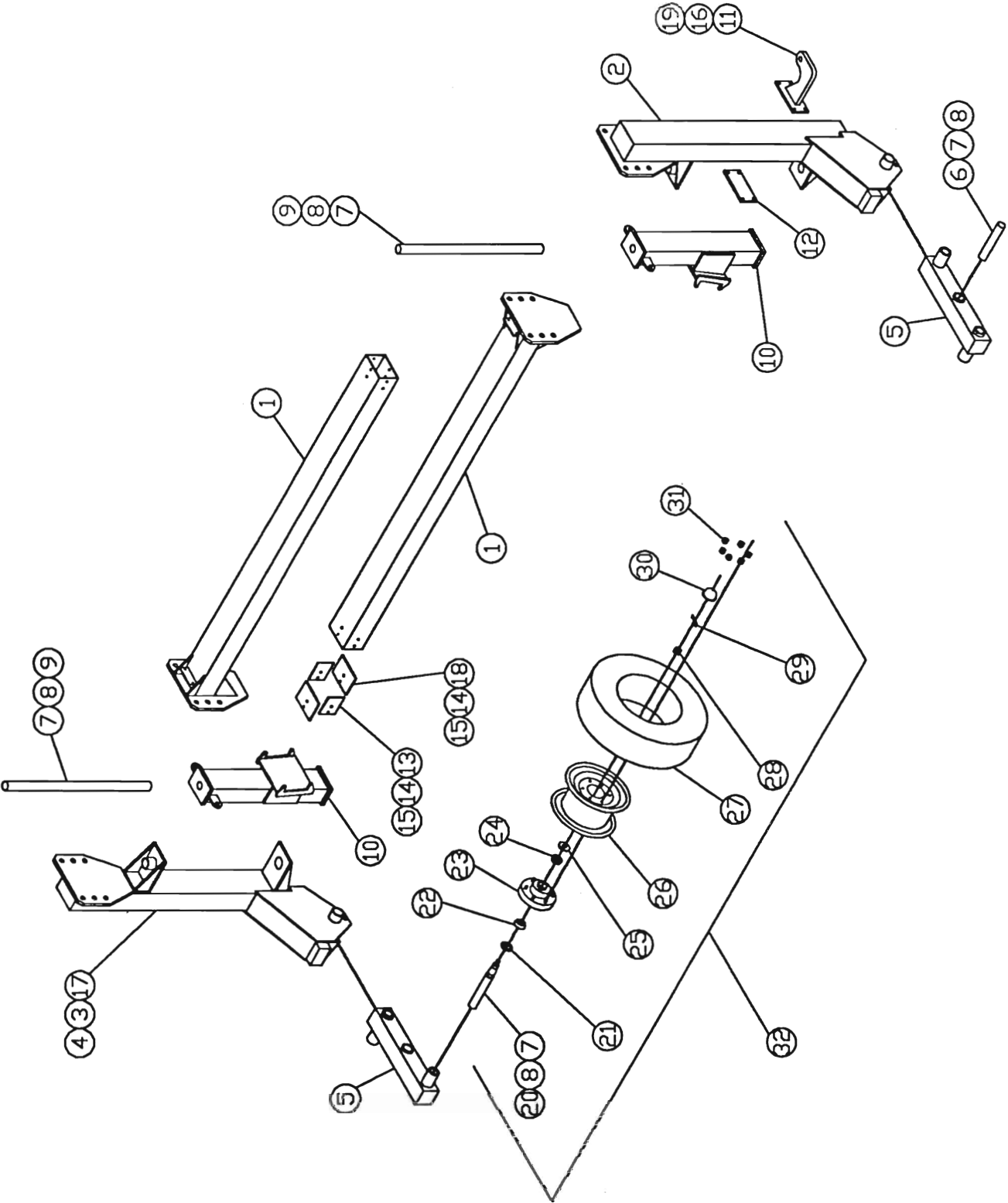

Extension Arm Assembly

| Ref. No. | Harrell No. | Description | Qty. Req'd. |
|----------|----------------------|---|-------------|
| 1 | 85-021-87 | Extension Arm | 2 |
| 2 | 85-013-87 | Vertical Frame Leg, R.H. | 1 |
| 3 | 2818-3230 | Hex Head Bolt 1"UNC x 3" Grade 8 | 12 |
| 4 | 1412-3200 | Hex Lock Nut 1"UNC | 12 |
| 5 | 85-030-87 | Oscillator | 2 |
| 6 | 96-008-87 | Oscillator Pivot Shaft | 2 |
| 7 | 2816-1234 | Hex Head Bolt 3/8"UNC x 3 1/2" Grade 5 | 8 |
| 8 | 1412-1200 | Hex Lock Nut 3/8" UNC | 8 |
| 9 | 96-004-87 | Main Pivot Shaft | 2 |
| 10 | 85-029-87 | 7 Degree Pivot Section | 2 |
| 11 | 85-032-87 | Fixed Lug | 2 |
| 12 | 98-024-87 | Mount Plate | 2 |
| 13 | 79-153-88 | Poly Slide Bearing <i>93-023-87 (8 1/2" X 4 7/8")</i> | 4 |
| 14 | 2816-1006 | Hex Head Bolt 5/16"UNC x 3/4" | 16 |
| 15 | 0812-1000 | Hex Nut 5/16"UNC | 16 |
| 16 | 2816-1664 | Hex Head Bolt 1/2"UNC x 6 1/2" | 4 |
| 17 | 85-014-87 | Vertical Frame Leg, L.H. | 1 |
| 18 | 79-005-87 | Poly Slide Bearing <i>93-021-87 (8 1/2" X 6 7/8")</i> | 4 |
| 19 | 1412-1600 | Hex Lock Nut 1/2"UNC | 4 |
| 20 | 96-034-88 | Spindle | 4 |
| 21 | 77-006-02 | Seal | 4 |
| 22 | 77-007-02 | Inner Bearing | 4 |
| 23 | 77-001-02 | Hub with Cups | 4 |
| 24 | 77-008-02 | Outer Bearing | 4 |
| 25 | 77-005-02 | Spindle Washer | 4 |
| 26 | 79-017-88 | 6-Hole Wheel | 4 |
| 27 | 79-018-88 | Tire 750 x 15 | 4 |
| 28 | 77-004-02 | Spindle Nut | 4 |
| 29 | 77-011-02 | Cotter Pin | 4 |
| 30 | 77-012-02 | Hub Cap | 4 |
| 31 | 77-013-02 | Lug Bolt 1/2"UNF | 24 |
| 32 | 84-046-88 | Hub Assembly (Includes #20-25 & 28-31) | 4 |
| NS | 77-010-02 | <i>OUTER RACE (AVAILABLE AS SEPERATE PART)</i> | |
| NS | 77-009-02 | <i>INNER RACE (AVAILABLE AS SEPERATE PART)</i> | |
| NS | 93-022-87 | <i>SHIM (8 1/2" X 6 7/8") FOR 93-021-87</i> | |
| NS | 93-024-87 | <i>SHIM (8 1/2" X 4 7/8") FOR 93-023-87</i> | |

MODEL 8794 WHEEL RAKE
WHEEL MOUNT ASSEMBLY

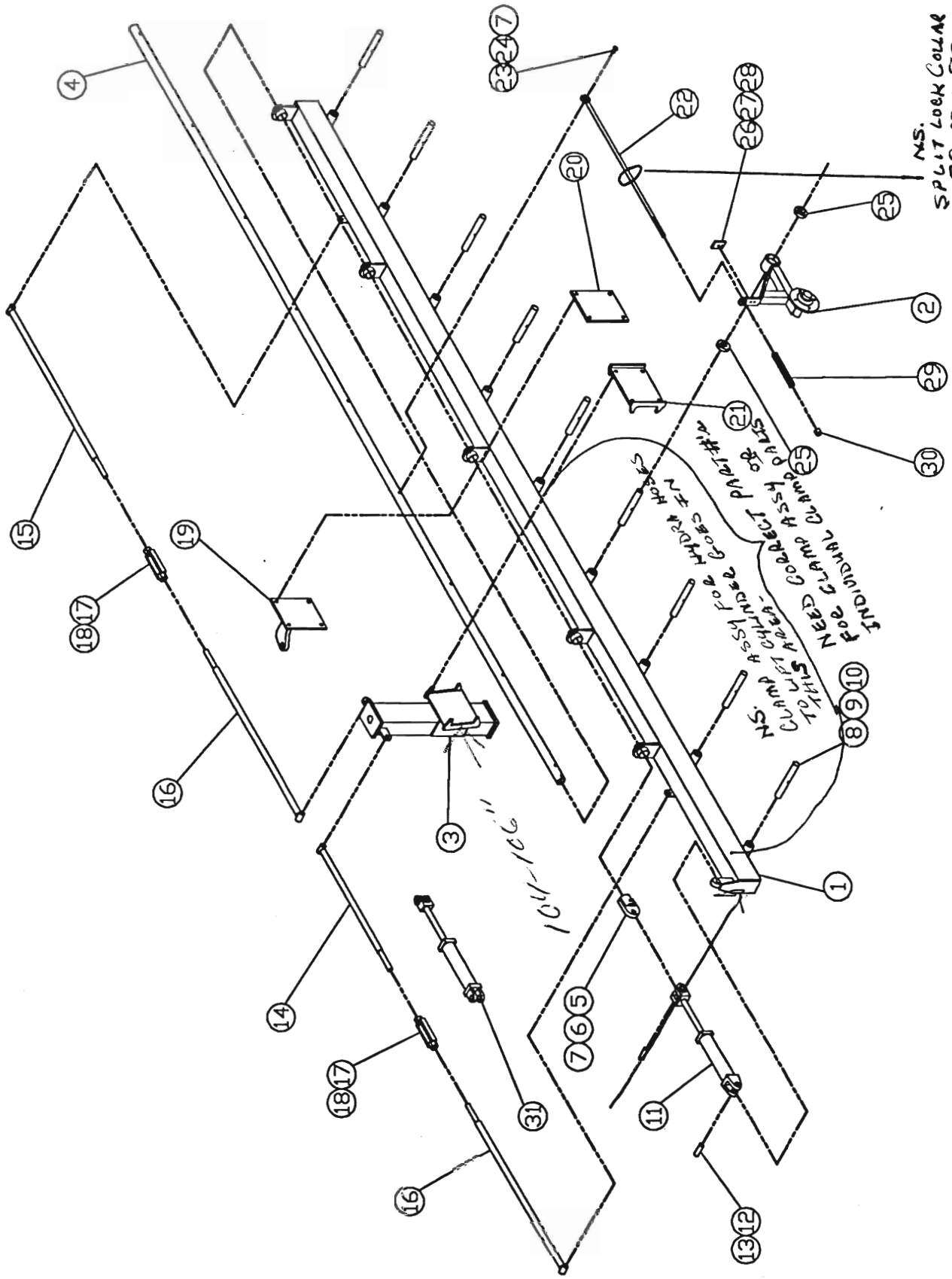

Wheel Mount Assembly

| Ref. No. | Harrell No. | Description | Qty. Req'd. |
|----------|-------------|--|-------------|
| 1 | 85-004-87 | Wheel Mount, L.H. | 1 |
| | 85-003-87 | Wheel Mount, R.H. | 1 |
| 2 | 85-027-87 | Pivot Arm, L.H. | 8 |
| | 85-005-87 | Pivot Arm, R.H. | 8 |
| 3 | 85-029-87 | 7' Pivot Section | 2 |
| 4 | 92-004-87 | Lift Tube | 2 |
| 5 | 85-008-87 | Wheel Lift Tube End | 2 |
| 6 | 2816-1630 | Hex Head Bolt 1/2"UNC x 3" Grade 5 | 2 |
| 7 | 1412-1600 | Hex Lock Nut 1/2"UNC | 18 |
| 8 | 96-001-87 | Pivot Arm Shaft | 16 |
| 9 | 2816-1224 | Hex Head Bolt 3/8"UNC x 2 1/2" Grade 5 | 16 |
| 10 | 1412-1200 | Hex Lock Nut 3/8"UNC | 16 |
| 11 | 79-007-87 | Wheel Lift Cylinder | 2 |
| 12 | 77-003-85 | Clevis Pin | 8 |
| 13 | 77-011-02 | Cotter Pin | 16 |
| 14 | 85-015-87 | Truss Rod, Short | 2 |
| 15 | 85-016-87 | Truss Rod, Long | 2 |
| 16 | 85-031-87 | Tension Rod, Short L.H. | 4 |
| 17 | 79-051-90 | Turnbuckle | 2 |
| 18 | 0812-3200 | Hex Nut 1"UNC | 2 |
| 19 | 85-033-87 | Swinging Lug | 2 |
| 20 | 93-012-87 | Clamp Plate | 2 |
| 21 | 85-028-87 | Clamp | 2 |
| 22 | 85-007-87 | Pivot Link | 16 |
| 23 | 94-006-87 | Bolt Bushing | 16 |
| 24 | 2816-1640 | Hex Head Bolt 1/2"UNC x 4" Grade 5 | 16 |
| 25 | 79-002-87 | Wheel Pivot Arm Bearing | 32 |
| 26 | 79-014-87 | Wear Pad | 16 |
| 27 | 2816-0814 | Hex Head Bolt 1/4"UNC x 1 1/2" Grade 5 | 32 |
| 28 | 1412-0800 | Hex Lock Nut 1/4"UNC | 32 |
| 29 | 79-015-87 | Compression Spring | 16 |
| 30 | 1412-2400 | Hex Lock Nut 3/4"UNC | 4 |
| 31 | 79-018-87 | Swing Cylinder | 2 |
| 32 | 2816-2434 | Hex Head Bolt 3/4"UNC x 3 1/2" Grade 5 | 4 |
| NS | 79-020-87 | SPLIT LOCK COLLAR (USED ON PIVOT LINK ARM) | |
| NS | 77-024-30 | CLAMP ASSY FOR HYDR HOSES TO LIFT CYLINDER | 6 |
| | 77-032-38 | top plate | |
| | 2814-1013 | Bolt. | |
| | 77-152-88 | SEAL KIT (FOR SWING CYLINDER) | |

MODEL 8794 WHEEL RAKE
WHEEL ASSEMBLY

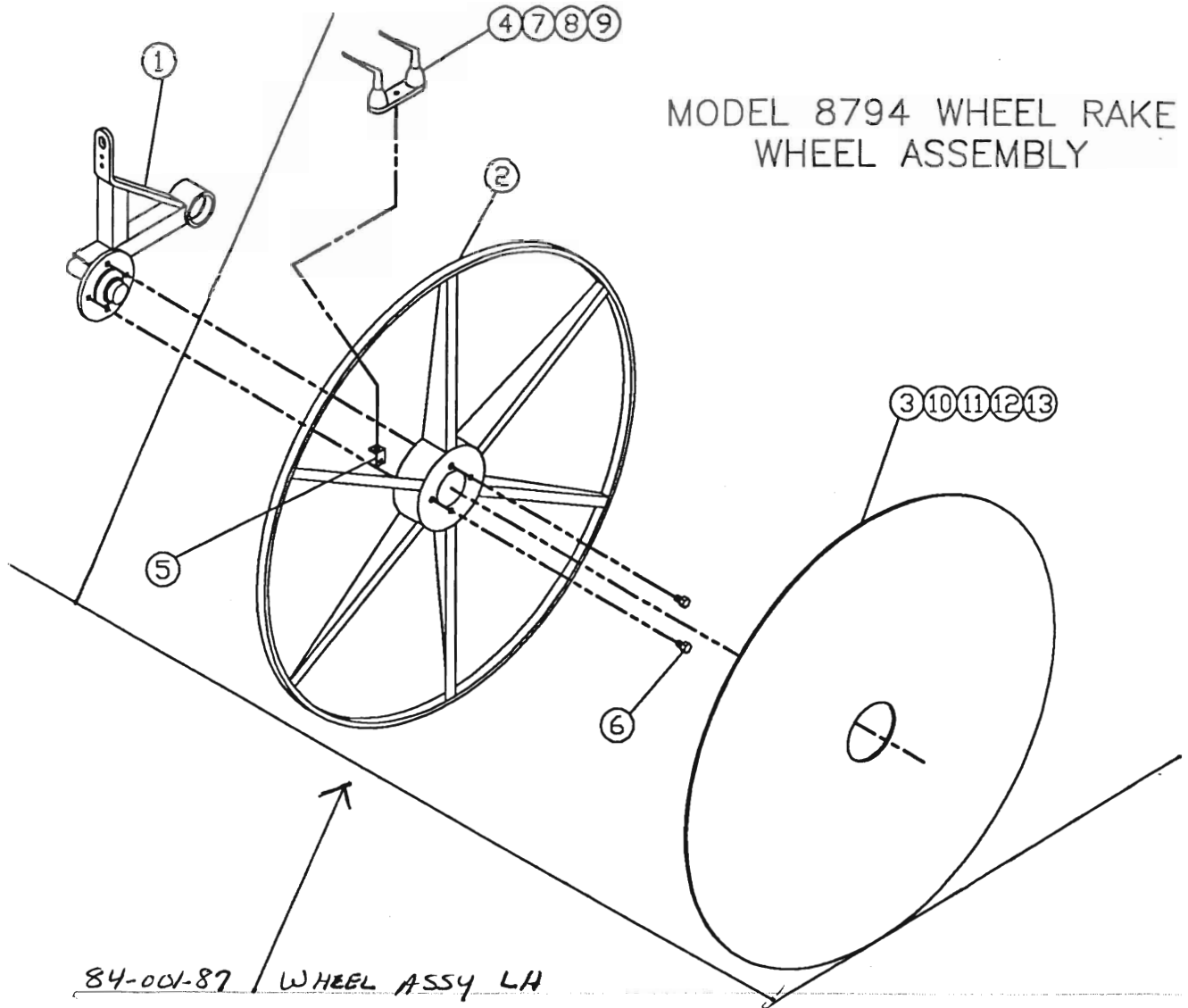

84-001-87 WHEEL ASSY LH

84-004-87 WHEEL ASSY RH

| Ref. No. | Harrell No. | Description | Qty. Req'd. |
|----------|-------------|---|-------------|
| 1 | 85-005-87 | Pivot Arm, R.H. (DOES INCLUDE HUB ASSY <u>BUT NOT BEARING</u>) | 1 |
| | 85-027-87 | Pivot Arm, L.H. (DOES INCLUDE HUB ASSY <u>BUT NOT BEARING</u>) | 1 |
| 2 | 85-001-87 | Wheel | 2 |
| 3 | 79-008-87 | Wheel Disc | 2 |
| 4 | 79-001-87 | Wheel Rake Tine | 18 |
| 5 | 98-023-87 | Clip | 6 |
| 6 | 77-009-36 | Hub Bolt | 4 |
| 7 | 2816-1214 | Hex Head Bolt 3/8"UNC x 1 1/2" Grade 5 | 18 |
| 8 | 1412-1200 | Hex Lock Nut 3/8"UNC | 18 |
| 9 | 1702-1200 | Flat Washer 3/8" SAE | 18 |
| 10 | 0512-0806 | Carriage Head Bolt 1/4"UNC x 3/4" | 18 |
| 11 | 0811-0800 | Hex Nut 1/4"UNC | 18 |
| 12 | 1602-0800 | Lock Washer 1/4" | 18 |
| 13 | 1702-1000 | Flat Washer 5/16" SAE | 18 |
| | 84-006-87 | PIVOT ARM ASSY W/HUB & BEARING RH | |
| | 84-007-87 | PIVOT ARM ASSY W/HUB & BEARING LH | |
| | 83-001-87 | WHEEL B'DLE (RH) (COMPLETE WHEEL W/TINES, PIVOT ARM ETC) | |

83-002-87 WHEEL B'DLE (LH) (12) (COMPLETE WHEEL W/TINES, PIVOT ARM ETC)

MODEL 8794 WHEEL RAKE
WHEEL HUB ASSEMBLY

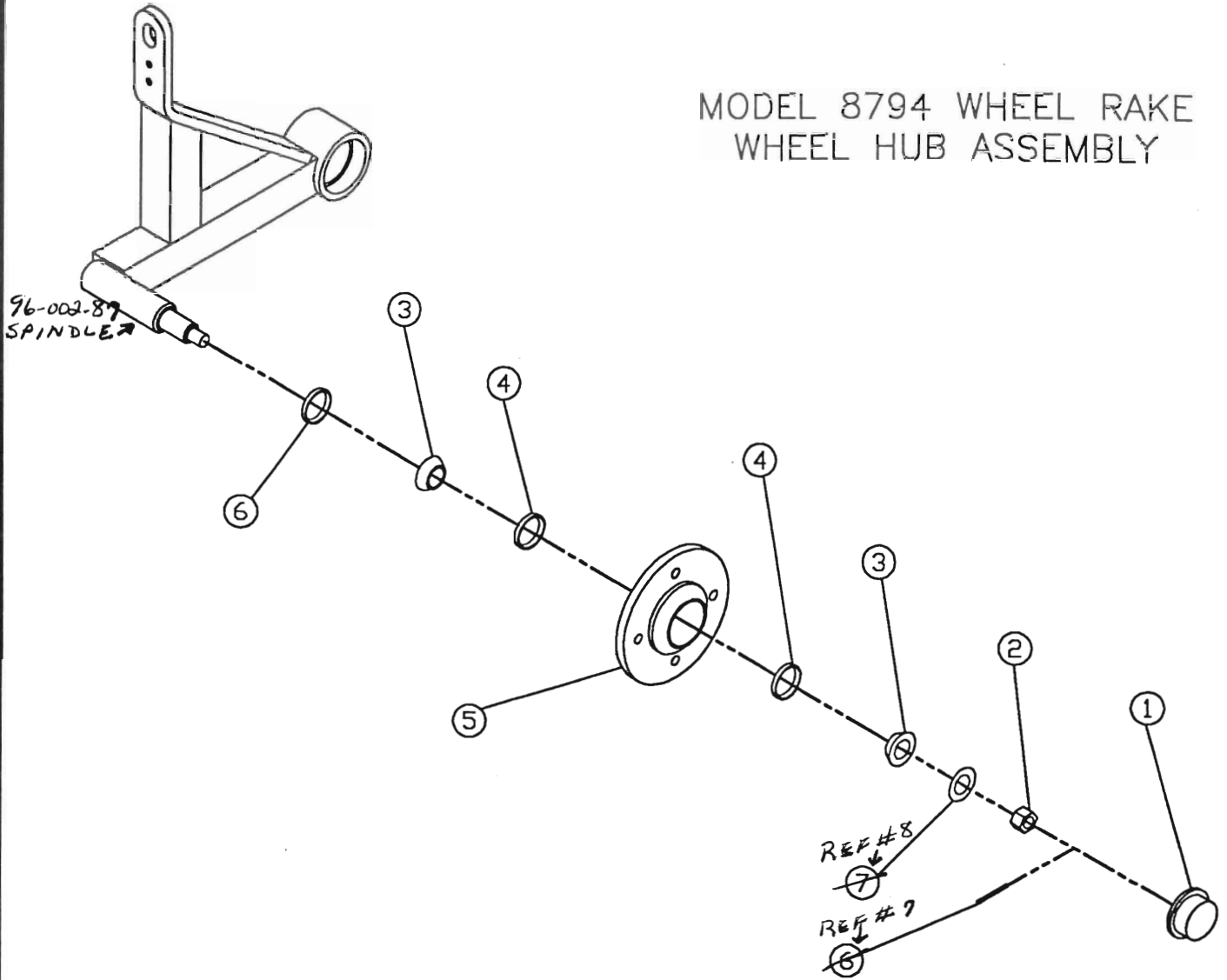

| Ref. No. | Harrell No. | Description | Qty. Req'd. |
|----------|-------------|--------------------------|-------------|
| 1 | 77-007-87 | Dust Cap | 1 |
| 2 | 77-001-87 | Spindle Nut | 1 |
| 3 | 77-045-88 | Bearing | 2 |
| 4 | 77-005-87 | Bearing Race | 2 |
| 5 | 77-012-87 | Hub with Pressed-in Cups | 1 |
| 6 | 77-006-87 | Rear Seal | 1 |
| 7 | 77-002-87 | Cotter Pin | 1 |
| 8 | 77-003-87 | Spindle Washer | 1 |
| NS | 79-004-87 | HUB ASSY W/O SPINDLE | |
| NS | 84-018-87 | HUB W/SPINDLE | |

MODEL 8794 WHEEL RAKE SPOOL & CHECK VALVE HYDRAULIC LINE ROUTING

TO FRONT EXTENSION
ARM CYLINDER PORTS
(ON RIGHT SIDE OF FRAME)

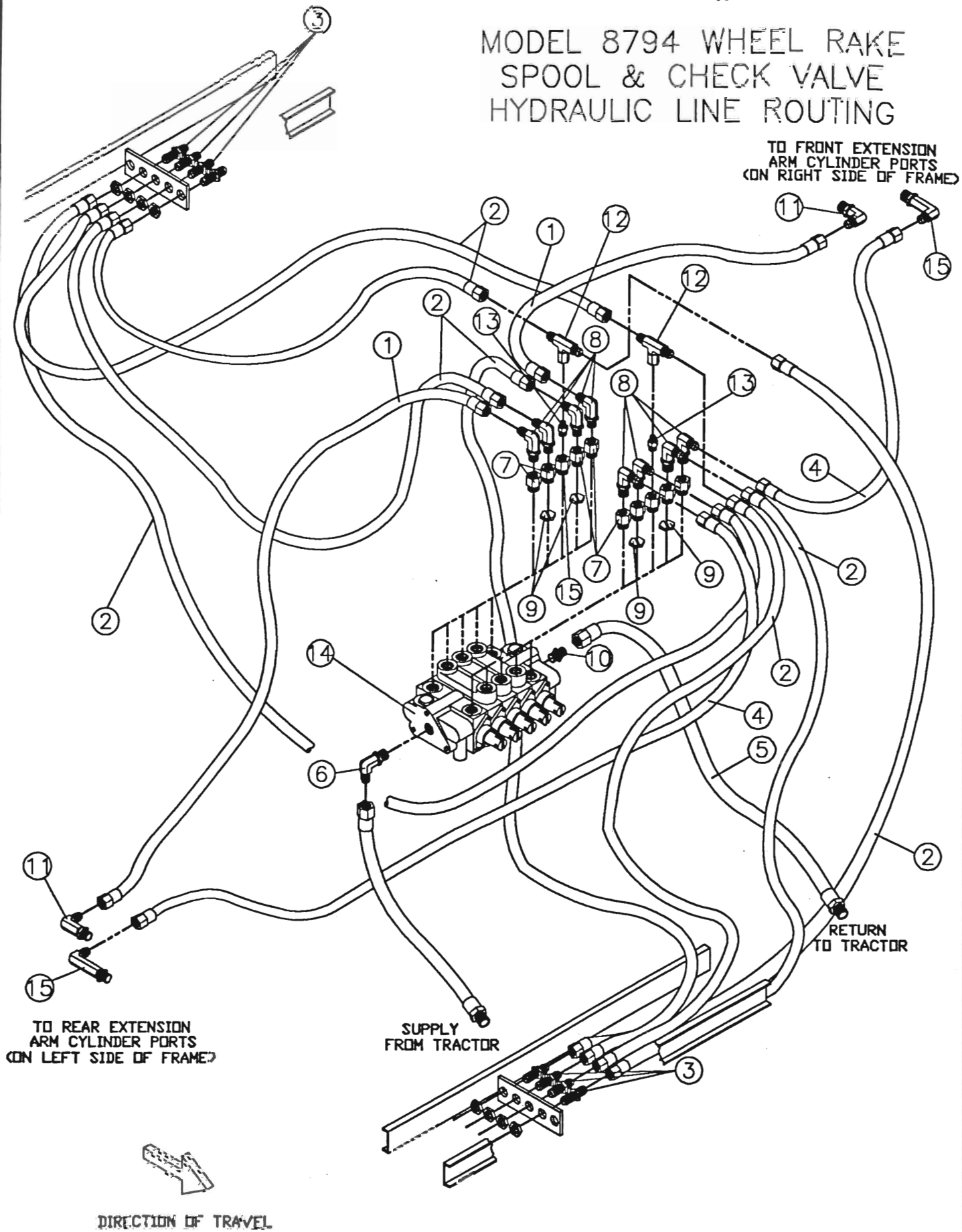

Spool Valve Hydraulic Line Routing

| Ref. No. | Harrell No. | Description | No. Req'd. |
|----------|-------------|--------------------------------|------------|
| 1 | 79-144-88 | Hose Ass'y. 1/4" x 56' - AR 19 | 2 |
| 2 | 79-101-88 | Hose Ass'y. 1/4" x 27' - AR 13 | 8 |
| 3 | 79-013-88 | #6 Bulkhead Fitting | 8 |
| 4 | 79-145-88 | Hose Ass'y. 1/4" x 58' - AR 20 | 2 |
| 5 | 79-102-88 | Hose Ass'y. 1/2" x 30' - AR 8 | 1 |
| 6 | 79-094-88 | Straight Thread 90° Elbow | 1 |
| 7 | 79-054-88 | Straight Thread Reducer | 10 |
| 8 | 79-052-88 | Straight Thread 90° Elbow | 8 |
| 9 | 77-058-88 | Restrictor (.032) | 4 |
| 10 | 79-050-88 | O-Ring Boss Adapter | 1 |
| 11 | 77-041-06 | Elbow 90° Pipe To JIC | 2 |
| 12 | 79-099-88 | JIC Swivel Branch Tee | 2 |
| 13 | 79-124-88 | Straight Thread Connector | 2 |
| 14 | 79-103-88 | Gresen 5 Spool Valve | 1 |
| 15 | 79-009-88 | Elbow 90° Pipe To JIC (X-Long) | 2 |

MODEL 8827 TWIN
SWING & LIFT CYLINDER
HYDRAULIC LINE ROUTING

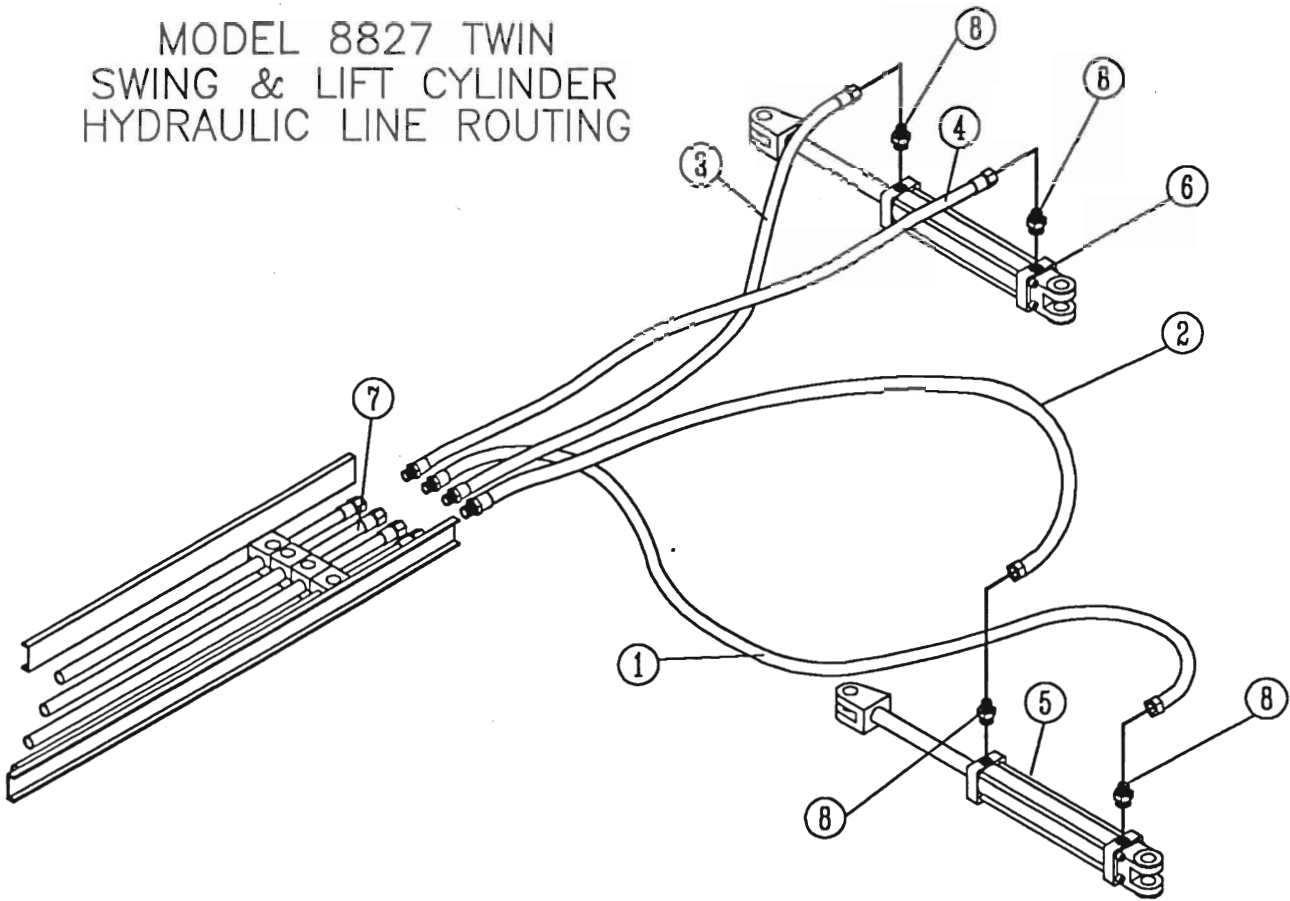

| Ref. No. | Harrell No. | Description | No. Req'd. |
|----------|-------------|--|------------|
| 1 | 79-011-87 | Hose Ass'y. 180" $\frac{1}{4}$ " X 180 (WR-3) | 2 |
| 2 | 79-010-87 | Hose Ass'y. 174" $\frac{1}{4}$ " X 174 (WR-2) | 4 |
| 3 | 79-017-87 | Hose Ass'y. 64" $\frac{1}{4}$ " X | 2 |
| 4 | 79-016-87 | Hose Ass'y. 54" $\frac{1}{4}$ " X 60 | 2 |
| 5 | 79-007-87 | Wheel Lift Cylinder | 2 |
| 6 | 79-018-87 | Swing Cylinder | 4 |
| 7 | 84-021-88 | Tubing Ass'y. $\frac{3}{8}$ " x 75 $\frac{1}{2}$ " | 8 |
| 8 | 79-169-88 | Straight Thread Connector | 4 |

MODEL 8794 WHEEL RAKE
FLOW CONTROL VALVE

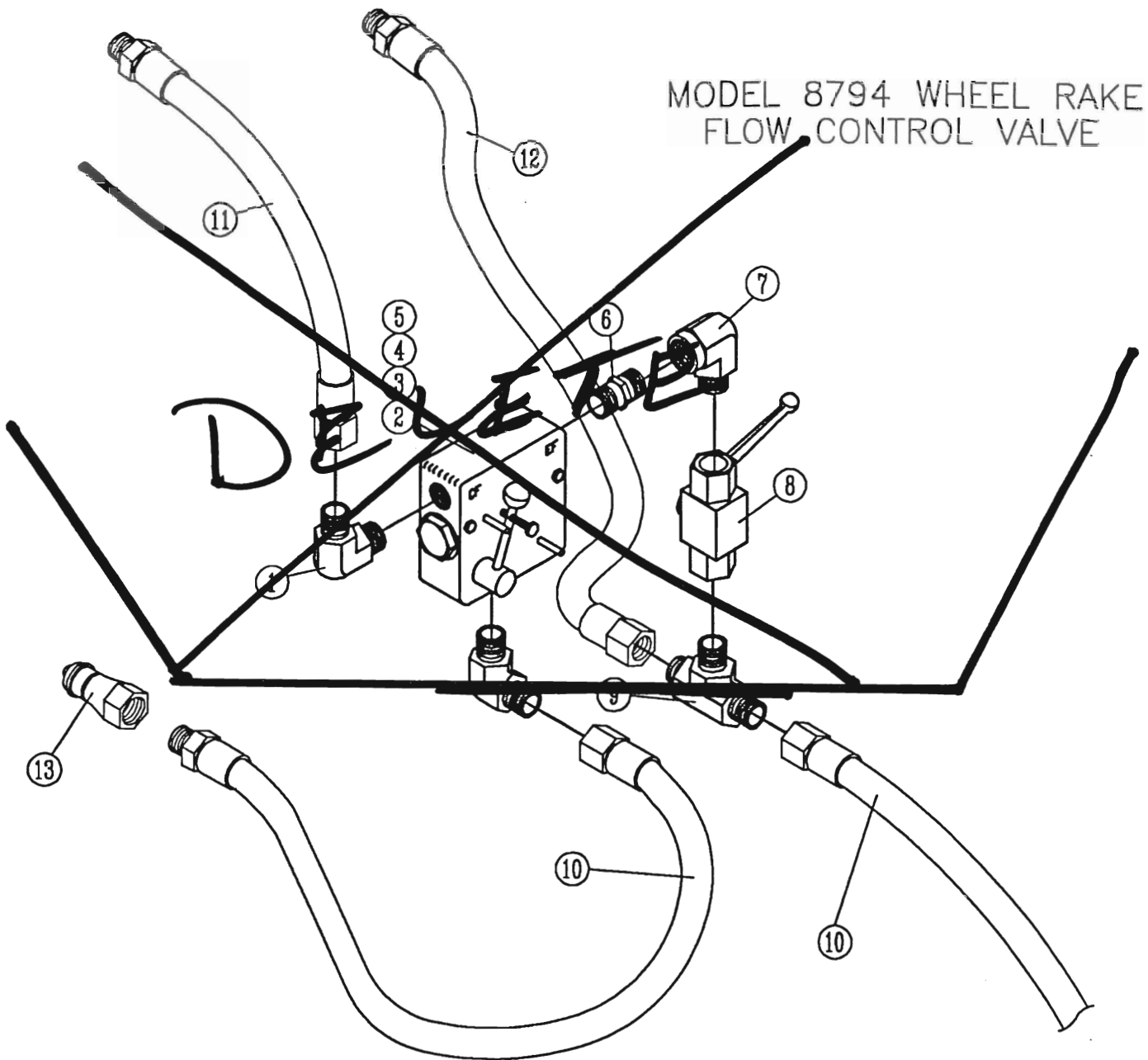

| Ref. No. | Harrell No. | Description | No. Req'd. |
|----------|----------------------|--|------------|
| 1 | 79-070-88 | Male Elbow DELETE | 2 |
| 2 | 79-042-88 | Flow Control Valve DELETE | 1 |
| 3 | 1412-0800 | Hex Lock Nut 1/4UNC DELETE | 2 |
| 4 | 2816-0824 | Hex Head Cap Screw 1/4UNC x 2 1/2" DELETE | 2 |
| 5 | 1702-0800 | Flat Washer 1/4" SAE DELETE | 2 |
| 6 | 79-068-38 | Pipe Nipple DELETE | 1 |
| 7 | 79-069-88 | Street Elbow DELETE | 1 |
| 8 | 79-072-88 | Ball Valve DELETE | 1 |
| 9 | 79-112-88 | Male Branch Tee DELETE | 1 |
| 10 | 79-009-87 | Hose Ass'y. 102' | 2 |
| 11 | 79-071-88 | Hose Ass'y. 1/2" x 20' - AR-3 DELETE | 1 |
| 12 | 79-066-88 | Hose Ass'y. 1/2" x 18' - AR-2 DELETE | 1 |
| 13 | 79-212-36 | Quick Disconnect Adaptor | 2 |

MODEL 8794 WHEEL RAKE CONTROL BOX

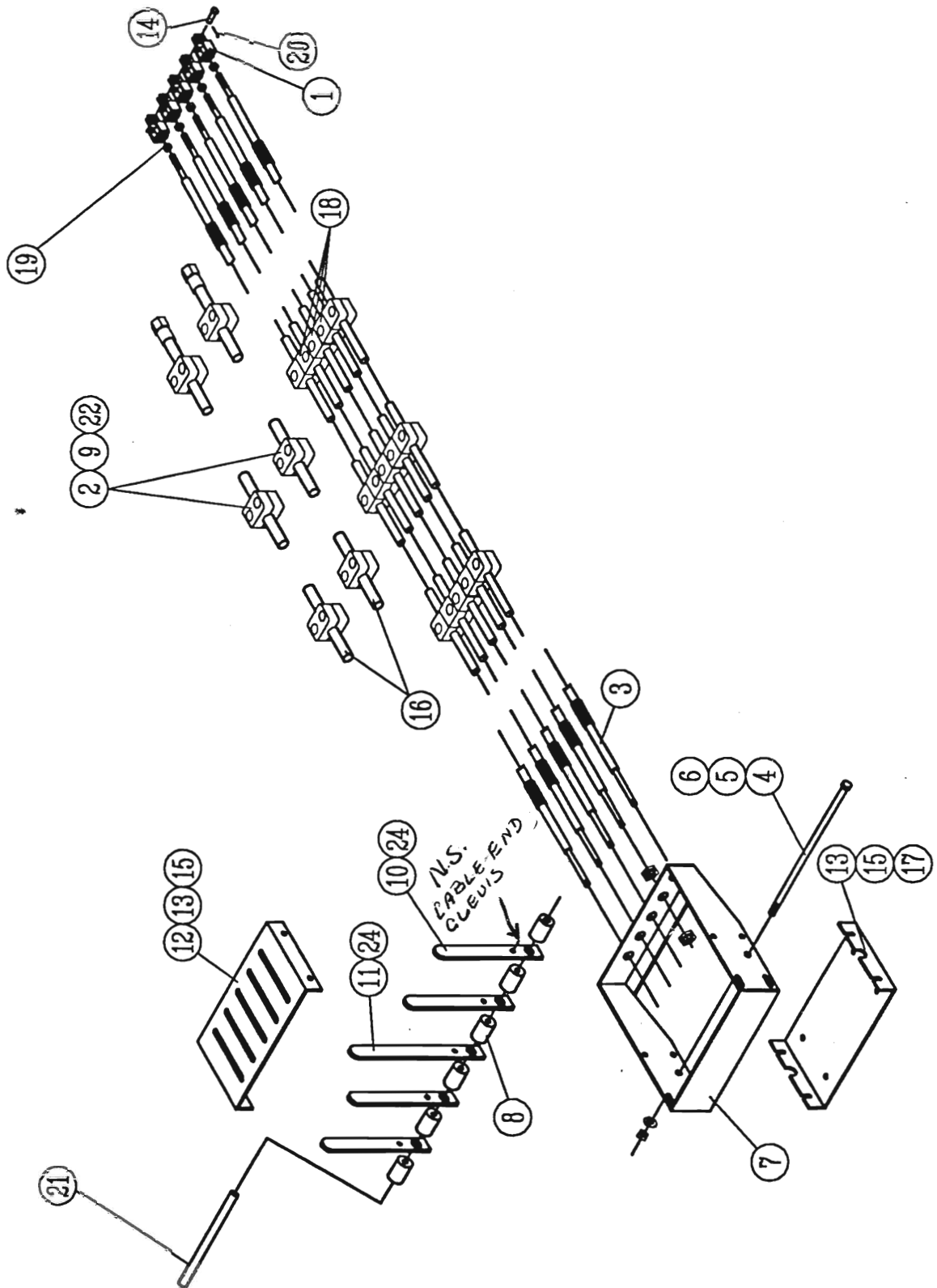

Control Box Assembly

| Ref. No. | Harrell No. | Description | No. Req'd. |
|----------|----------------------|---|------------|
| 1 | 79-073-88 | Terminal Eyes <i>96-048-88 CTO VALVE) W/1/4" HOLE</i> | 5 |
| 2 | 79-118-88 | Stacking Kit | 6 |
| 3 | 79-012-87 | Morse Cable <i>79-021-87 (1998 + LATER) 264" L</i> | 5 |
| 4 | 2814-1290 | Hex Bolt 3/8"UNC x 9" | 1 |
| 5 | 1702-1200 | Flat Washers 3/8" SAE | 1 |
| 6 | 1412-1200 | Hex Lock Nut 3/8UNC | 1 |
| 7 | 85-108-88 | Control Box (5 Spool) | 1 |
| 8 | 96-045-88 | Spacer | 6 |
| 9 | 2816-1013 | Hex Bolt 5/16"UNC x 1 3/8" Gr. 5 | 12 |
| 10 | 98-076-88 | Handle | 4 |
| 11 | 98-073-88 | Handle | 1 |
| 12 | 93-110-88 | Cover | 1 |
| 13 | 1702-0800 | Flat Washers 1/4" SAE | 8 |
| 14 | 79-135-88 | Clevis Pin | 5 |
| 15 | 79-147-88 | Thumbscrew | 8 |
| 16 | 84-003-87 | Hydraulic Tube Ass'y. | 2 |
| 17 | 93-111-88 | Bottom Plate | 1 |
| 18 | 77-071-88 | 3/8" Hose Clamp | 30 |
| 19 | 0832-0800 | Hex Nut 1/4UNF | 15 |
| 20 | 79-136-88 | Cotter Key | 5 |
| 21 | 94-073-88 | Control Box Bushing, 5-Spool | 1 |
| 22 | 77-072-88 | 1/2" Hose Clamp - DELETE | 12 |
| 23 | 84-005-87 | Control Box Assembly (Do not include #2,9,&16) | 1 |
| 24 | 79-175-88 | Handle Grip | 5 |
| N.S. | 79-073-88 | <i>CABLE END CLEVIS (TO CONTROL BOX) W/5/16 HOLE</i> | |
| N.S. | 2816-1010 | <i>HEX BOLT 5/16" - UNC</i> | |
| N.S. | 1412-1000 | <i>HEX LOCK NUT 5/16" UNF</i> | |

**PLEASE PLACE ALL ORDERS FOR PARTS
AND WHOLE GOODS THROUGH OUR
NEVADA WAREHOUSE**

**PHONE: 888-459-9615 (TOLL FREE)
FAX: 775-246-4512**