

Owner's Manual

Spiral LP Doors

1072204-0

Rev 1 02/21
© Rytec Corporation 2021



⚠ WARNING

Read and understand all operation, warning and safety instructions in this manual before operating or servicing the door.

When instructed to do so, follow lockout/tagout procedure before servicing the door.

Introduction	5	Drive Shaft, Non-Drive Side, all doors.	21
How to find the serial number	5	Drive Shaft, Drive Side, all doors	22
Rytec naming conventions	6	Door Panel Hinges, all doors.	23
Safety	7	Drive Belt, all doors	24
Safety information and the meaning of signal words.	7	Chain Hoist Assembly, all doors.	25
Operational and maintenance safety	7	Bottom Bar Assembly, all doors.	26
Safety features	8	Console Framework, all doors	27
Operation	9	Motor and Encoder, all doors	28
How to hold the door open	9	Door Panels, L doors with Full Vision Panels	29
How to open and close the door manually, gear disconnect	10	Door Panels, L doors without Full Vision Panels	30
How to open and close the door manually, optional chain hoist	10	Door Panels, S doors with Full Vision Panels	31
Maintenance.	11	Door Panels, S doors without Full Vision Panels	32
How to clean the door	11	Vertical Tracks, all doors	33
Daily maintenance	12	System 4 Controller and Accessories, all doors	34
How to inspect the safety labels	13	Remote Mobile Unit, all doors	35
Parts.	15	Motor Override Gears, all doors	36
How to order parts	15	Expansion Boards, all doors	37
How to return unwanted parts	16	Warranty	39
Warranty return	16	SPIRAL® LP-S/SP-S LIMITED WARRANTY	39
Physical return	16		
Why you may be sent substitute parts	16		
Rytec Technical Knowledge Center.	16		
Horizontal Track Assembly, all doors	17		
Spreader Assembly, all doors	18		
Side Column Assemblies, all doors.	19		
Cables and Connectors, all doors	20		

The information contained in this manual will allow you to operate and maintain your Rytec® Spiral LP door in a manner which will ensure maximum life and trouble-free operation.

Any unauthorized changes to these procedures, or failure to follow the steps as outlined, will automatically void the warranty. Any changes to the working parts, assemblies, or specifications as written, which are not authorized by Rytec Corporation, will also cancel the warranty. The responsibility for the successful operation and performance of this door lies with the owner.

DO NOT OPERATE OR PERFORM MAINTENANCE ON THIS DOOR UNTIL YOU READ AND UNDERSTAND THE INSTRUCTIONS CONTAINED IN THIS MANUAL.

If you have any questions contact your Rytec representative or **call the Rytec Technical Support Department at 800-628-1909**. Always refer to the serial number of the door when calling the representative or Technical Support.

A wiring schematic is provided with each individual door specifically covering the control panel and electrical components of that door. The schematic for a specific door is shipped inside the cover of the System 4® controller.

How to find the serial number

!IMPORTANT!

You will need to know the serial number of your door any time you call Rytec Technical Support.

There are labels displaying the serial number in several locations on the door.

The easiest label to locate is at roughly eye level on the motor side column of the door, between the door panel and the rear Pathwatch.

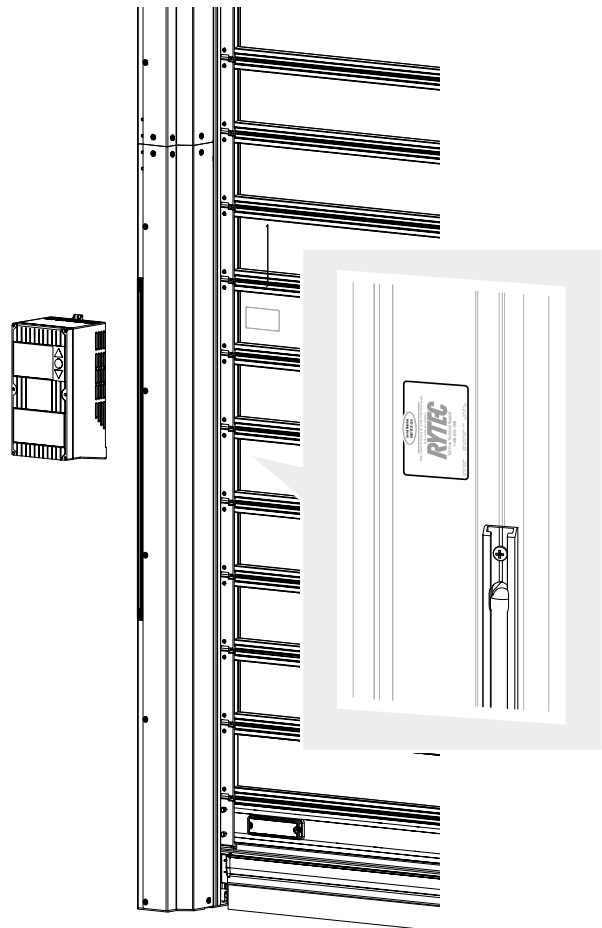

Rytec naming conventions

The illustration below shows the terms used by Rytec technical support to refer to the major components of your door. Using these terms helps technical support to provide assistance as quickly as possible.

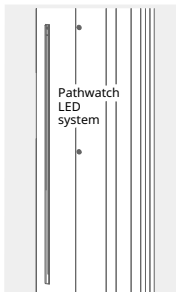
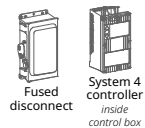
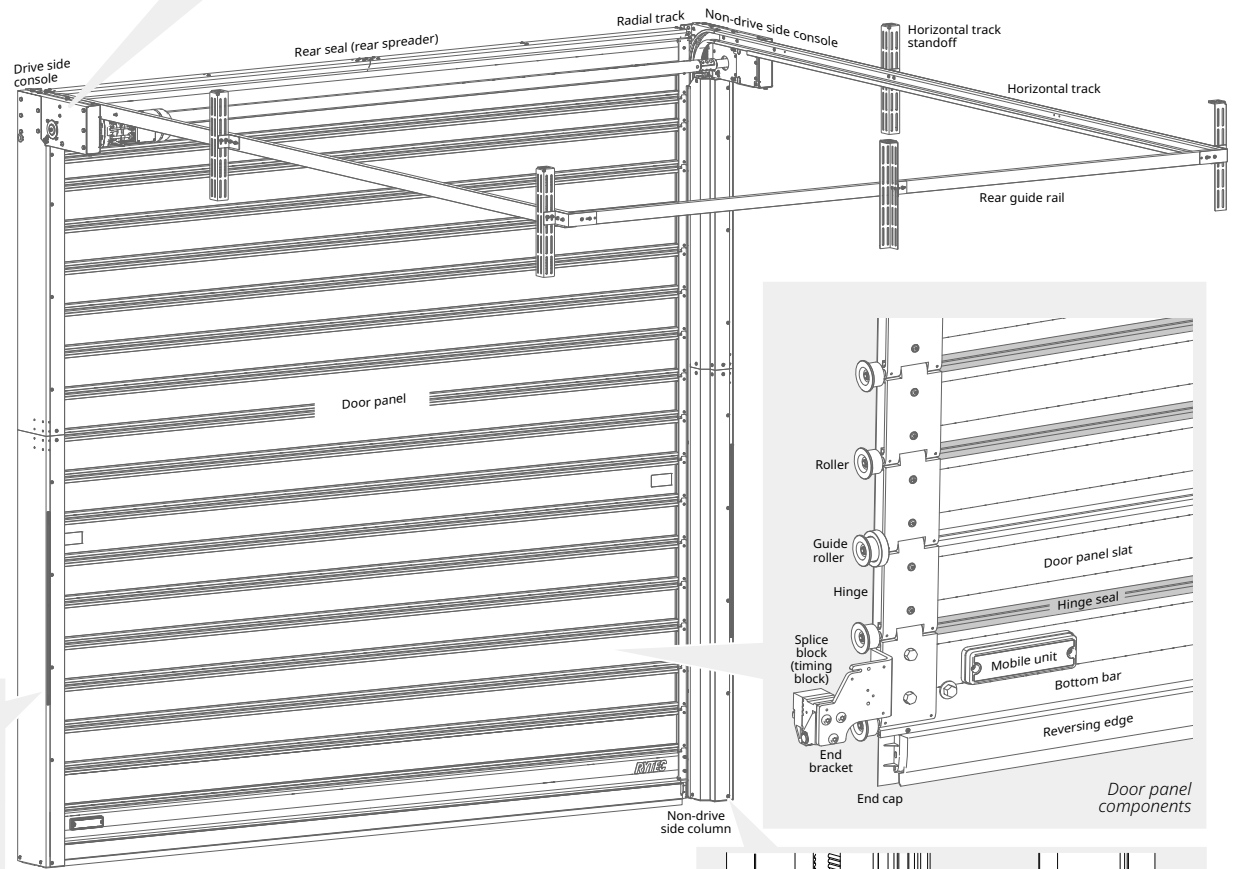
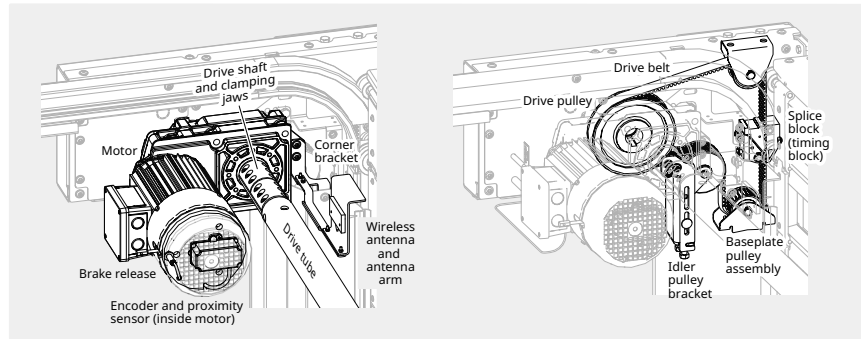

NOTE:
Drive side can be left (LH) or right (RH)

Rear
Front horizontal guide side

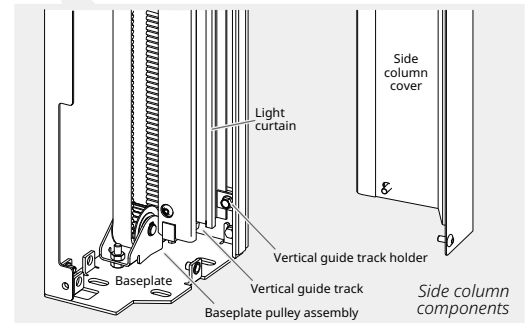

Safety information and the meaning of signal words

Summary



Technical content produced by Rytec includes safety information which must be read, understood and obeyed to reduce the risk of death, personal injury, or equipment damage. This information is boxed to set it apart from other text. The boxed text identifies the nature of the hazard and appropriate steps to avoid it.

The safety alert symbol identifies a situation that can result in personal injury. The accompanying signal word indicates the likelihood and potential severity of the injury. The meaning of the signal words are as follows:

	⚠ WARNING
	Warning indicates a hazardous situation which, if not avoided, could result in death or serious injury.
	⚠ CAUTION
	Caution indicates a hazardous situation which, if not avoided, could result in minor or moderate injury.
NOTICE	
Notice is used to address practices not related to physical injury but which, if not followed, can result in damage to the door or other property.	

Operational and maintenance safety

Operational precautions

Observe these precautions while using the door.

- Make sure that all individuals who use the door have been informed about the correct use of the door and all activating devices, and that they understand all safety devices for the door.
- Make sure that only individuals who are trained, qualified and authorized can access the control system, system software and control parameters.
- Do not run through the door opening or attempt to cross the threshold before you are able to do so while walking fully upright.
- Do not drive a vehicle through the door until the door is completely open and has stopped moving.
- Do not climb on or hang on the door.
- Do not touch any part of the door or door frame while the door is opening or closing.
- Only operate the door at the approved supply voltage.
- If the door is to be kept open for a sustained period of time, use the control system to set the door to the open position, then set the power disconnect to the OFF position and perform a lockout/tagout. Make sure all personnel are informed that the door is not operational during this time.
- Safety devices must not be modified or put out of services. Do not use the door if there is any indication that a safety device is not operating correctly.

SAFETY

- Maintenance precautions** Observe these precautions while performing maintenance on the door.
- Maintenance of the door and the control system is to be done by trained, qualified and authorized individuals only.
 - Make sure all routine maintenance is performed as scheduled in the instructions for the door.
 - Make sure the power disconnect is set to the OFF position and a correct lockout/tagout procedure has been performed before servicing any component of the door that is powered by the control system.
 - The control system includes components that remain charged after the power has been disconnected. Do not open the control box until at least 5 (five) minutes have elapsed after power is disconnected.
 - Do not pass through or stand in the door panel pathway while the door is being serviced.
 - Make sure you have and use all required Personal Protective Equipment.
 - Make sure that you are aware of the location of all power lines, piping and HVAC systems within the work site.
 - Make sure all components and hardware used to service the door are approved by the manufacturer.

Safety features

The standard Spiral LP installation includes two safety devices, which are located in the side panels of the door.

The **light curtain** ① prevents the door from closing when an obstruction is detected in the door opening, and holds the door open until the obstruction is removed. The light curtain extends from the floor to a height of five to seven feet, depending on the configuration of the door.

The **Pathwatch LED strips** ②③ alert you when the door is active. The strips flash in the following ways:

- **While the door opens or closes:** continuous red
- **Before the door closes:**
a three-second sequence of red-yellow-combined.

One Pathwatch strip faces the front of the door, and the other faces inside the door opening.

Your installation may also include other optional safety devices.

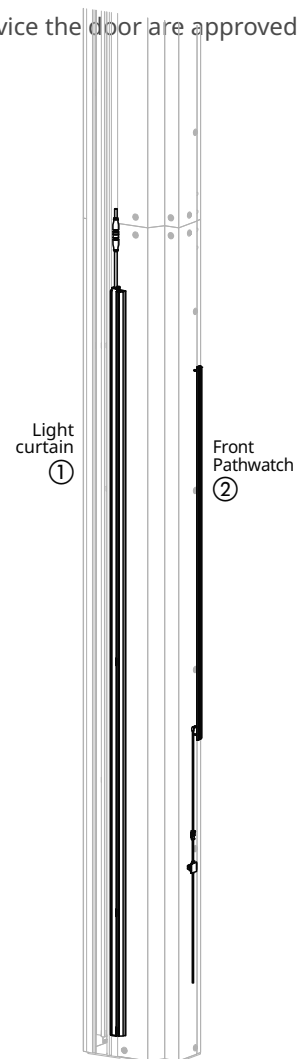

How to open and close the door using the System 4 controller

The System 4 controller should be installed within sight of the Spiral LP door.

- **Press the UP arrow** to manually open the door.
- **Press the DOWN arrow** to manually close the door. Under normal operating conditions, the door should always close automatically.

Under normal operating conditions, it should not be necessary to use the System 4 controller. Rytec offers a wide range of automatic and manual activators designed to fit the specific requirements of the installation. Call Rytec Technical support at **800-628-1909** if you have questions about the activators for your door.

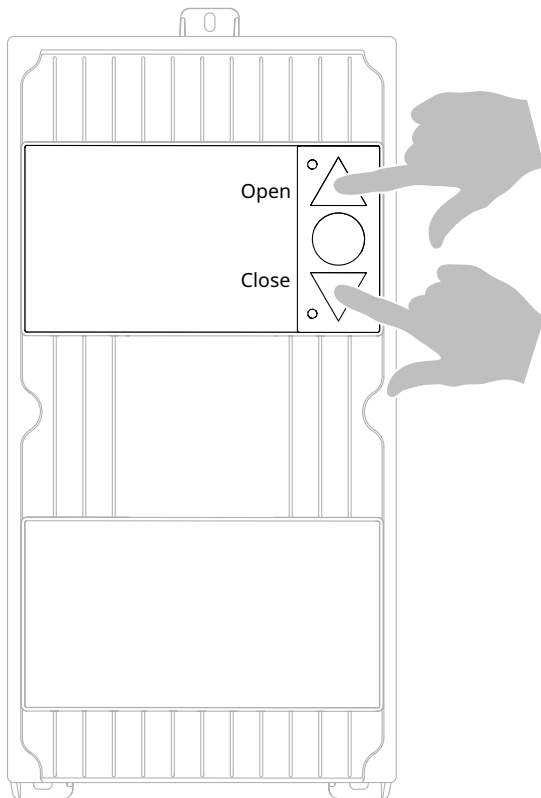

How to hold the door open

NOTICE

Do not use an activator, such as a light curtain or motion detector, to hold the door open.

- 1 Press the UP arrow** to open the door.

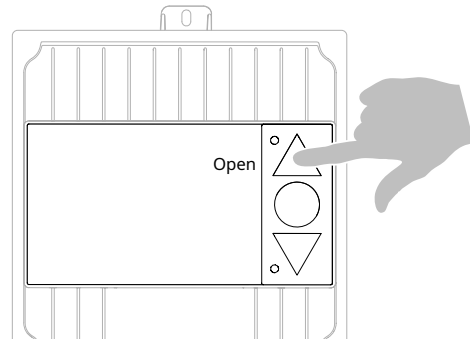

- 2 Turn the disconnect switch** to the OFF position. The switch may be located on the System 4 controller or on an external disconnect.

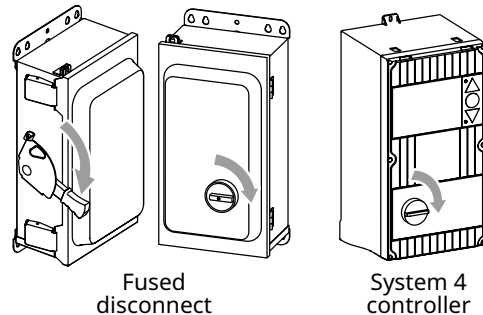

- 3 Perform a lockout/tagout.**



	⚠ CAUTION
	<p>Make sure all users of the door are informed when the door is out of service, and when it is put back into service.</p>

How to open and close the door manually (gear disconnect)

- 1** **NOTE:** if motor is covered, use a 5/16" socket to remove the four self-drilling screws that hold the cover in place.

Attach the manual gear disconnect to the chuck of a cordless electric drill.

- 2** **Engage** the brake release lever to release the brake.

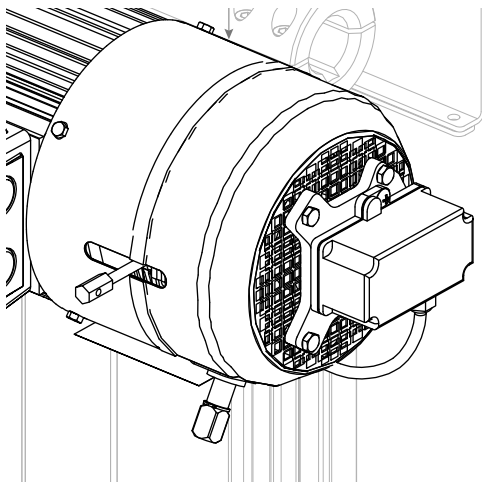

- 3** **Press** the drill inward to engage the manual gear.

- 4** **Operate** the drill to move the door panel:

- **Clockwise** to raise the door panel
- **Counterclockwise** to lower the door panel

- 5** **Release** the brake release lever when the door panel is at the desired height.

How to open and close the door manually (optional chain hoist)

- 1** **Smoothly pull** on one side of the looped chain to move the door panel upward or downward.

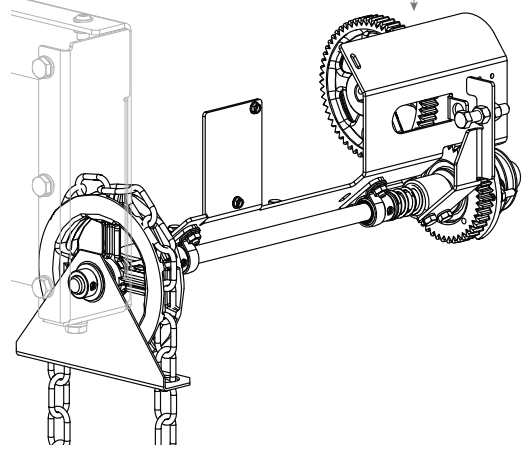

- 2** **Sharply pull** on one side of the looped chain to engage the brake mechanism.

How to clean the door

NOTICE

!IMPORTANT! Do not use bleach, industrial grade cleaners, abrasive cleaners or petroleum-based solvents on Rytec doors.

NOTICE

Rytec doors are self-lubricating. Do not lubricate the drive track or door panel. Grease and lubricating oil can attract dirt and grime, which may prevent the door from operating correctly.

Clean the Spiral LP door panels and side columns with a mix of household cleaner and water. Isopropyl alcohol can be used on hard-to-clean areas.

NOTICE

Clean the light curtains with a damp cloth soaked in water only. Do not get cleaners of any kind on the light curtain lenses.

Daily maintenance

These steps should be followed every day.

NOTICE

IMPORTANT! Immediately turn off the door and perform a lockout/tagout if any of the daily checks reveals that the door is not operating properly.

1 Activate the door using each activating system. **Run** the door through at least three cycles for each system.

- **Make sure** the door panel rises to the fully open position, remains in place for the standard time, and then closes to the fully closed position.
- **Make sure** the reversing edge is level when the door is fully closed.
- **Repeat** for each activating device.

2 While the door cycles, **look and listen** for:

- **Unusual noises** such as grinding, whining or excessive motor noise
- **Changes in door speed** from one cycle to the next. **NOTE:** The door motion should accelerate, then decelerate, during a normal run up or down.
- **Excess movement** by the motor, drive or door panels.
- **Unexpected delay** in activation or unusually long time period before automatically closing.

3 Make sure the Pathwatch operates correctly as the door opens and closes:

- **Continuous red light** while the door opens or closes.
- **Three-second sequence** of red-yellow-combined before the door closes.

4 Inspect the side columns and head assembly for signs of damage or signs of excessive wear.

5 Inspect the door panels, reversing edge, and rollers damage or signs of excessive wear.

6 Test the light curtain by placing your hand in the path of the door at the top ①, middle ② and bottom ③ of the light curtain while the door panel closes.

Make sure the door panel returns to the fully open position each time the light curtain is activated.

Make sure the door panel stops immediately when you place your hand at the top ① of the light curtain, and gradually when you place your hand in the middle ② or at the bottom ③.

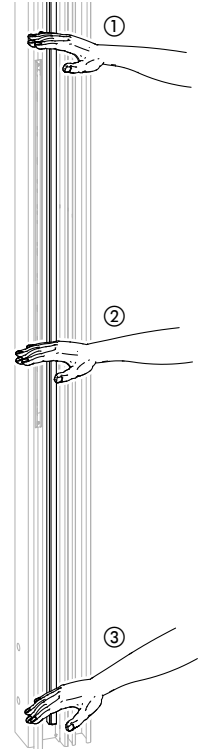

How to inspect the safety labels

1 There are three safety labels on this door: a DASMA label on the side column (depending on the configuration of the door, this can be the left side column or the right side column), a shock warning on the front of the System 4 control box, and a shock warning with instructions for manually moving the door on the bottom of the motor, next to the brake release lever.

Make sure all three labels have no rips or tears, that they can be clearly seen, and that all text is readable.

Call Rytec technical support at **800-628-1909** if any of the labels need to be replaced.

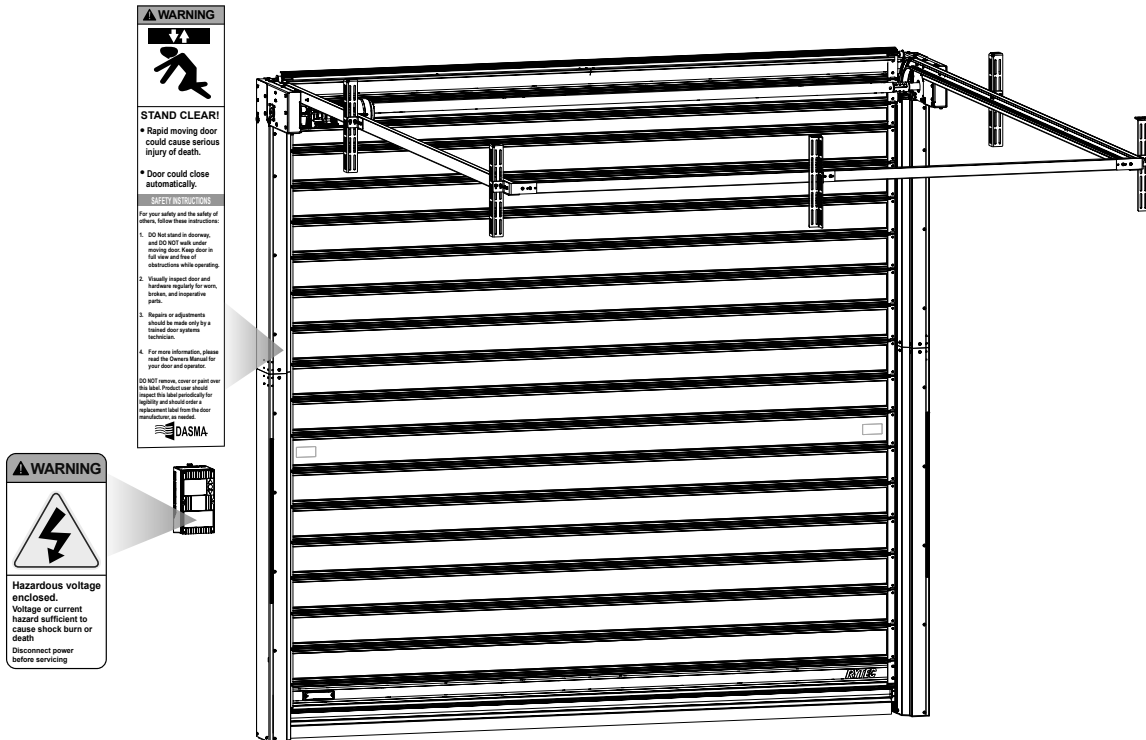

How to order parts

1 **!IMPORTANT! Make sure** you have the serial number of your door before you start.

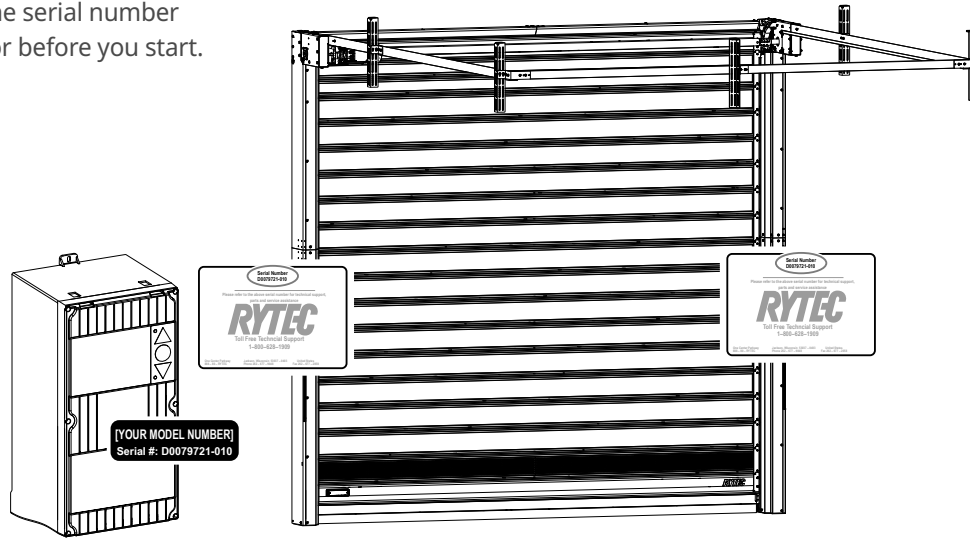

Check next to the drive track inside both side columns, and on the control box, for labels showing the serial number.

!IMPORTANT! Make sure all numbers match. Tell the person you speak with if they do not.

2 **Look** at the head assembly of your door to see if the drive side is left hand (LH) or right hand (RH).

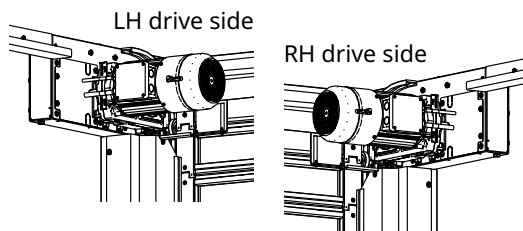

3 **Use** the parts lists on the following pages to find the part numbers and descriptions for the parts you need.

4 **Call** your local Rytec representative or Rytec technical support at **800-628-1909**. Enter #1 for technical support, #2 for the parts department.



NOTE: Rytec Corporation also has an online parts store at www.rytecdors.com.

- You must have a user account to access the site. Contact the Rytec parts department at **800-628-1909 Ext. 2** to request an account.
- The site stocks standard parts such as bearings, spools and encoders, as well as straps at precut lengths. Parts listed as "configured" in this manual **are not available** on the site.
- Some parts are available for next-day shipping.

How to return unwanted parts

- 1 Call the Rytec parts department at **800-628-1909 Ext. 2** for authorization.
 - The parts department will determine if you qualify for a **warranty return** or a **physical return**.
 - There may be a **restock fee** for the returned part.
 - There are restrictions on returns for **configured parts** that were built to match the specifications of your door.

Warranty return

- 1 Rytec will create a **Warranty Return Authorization (WRA)** and assign you an **incident number**.

- 2 **You will receive** replacement parts, a prepaid return label, and the WRA paperwork.

NOTE: Rytec may determine that it is not necessary to return the warranted parts in order to receive the replacement parts.

- 3 Use the box and prepaid label to return the warranted parts to Rytec **within 30 days of receiving the replacements**.
!IMPORTANT! You must include the WRA paperwork with the returned parts.

Physical return

- 1 Rytec will create a **Physical Return Authorization (PRA)** and assign you an **incident number**.

- 2 **You will receive** the return paperwork.

- 3 **Box and return** the parts.
!IMPORTANT! You must include the PRA paperwork with the returned parts.
Unless you are told otherwise by Rytec, shipping costs for a physical return **are your responsibility**. Call the Rytec parts department at **800-628-1909 Ext. 2** if you have any questions.

- 4 **When Rytec receives the parts**, we will inspect them. When we have determined the parts are in good working order, we will issue a refund to your account, or send a check by mail **within 30 days**.

Why you may be sent substitute parts

Many Rytec doors are custom engineered to meet the unique needs of the installation site, so the parts used for your door may be different from those shown in this manual.

If a part has been improved or updated since your installation, the new part will be substituted for the part ordered. The new part may have a revised part number.

Rytec Technical Knowledge Center

The Rytec Technical Knowledge Center, reached via the Customer Support page at **www.rytecdors.com**, holds manuals, service bulletins, and video presentations for all Rytec model doors.

Horizontal Track Assembly *all doors*

236856 GUIDE ASSY, HORIZONTAL RAIL, SSN

Qty: = 2 (One on each LH and RH sides)

Includes 236315

Configured part: requires door serial number to order Hardware listed below

236322Z1 STANDOFF, HORIZONTAL TRACK

Qty: = 5

236319Z1 BRACKET, BACK CORNER

Qty: = 2

236321 BRACKET, HORIZONTAL TRACK STANDOFF

Qty: = 2

Hardware listed below

1072123-1A01 COVER, TRACK, LH, PH 1200-2300

1072123-1B01 COVER, TRACK, LH, PH 2310-3660

1072123-2A01 COVER, TRACK, RH, PH 1200-2300

1072123-2B01 COVER, TRACK, RH, PH 2310-3660

Qty: = 2 (One on each LH and RH sides)

Configured part: requires door serial number to order

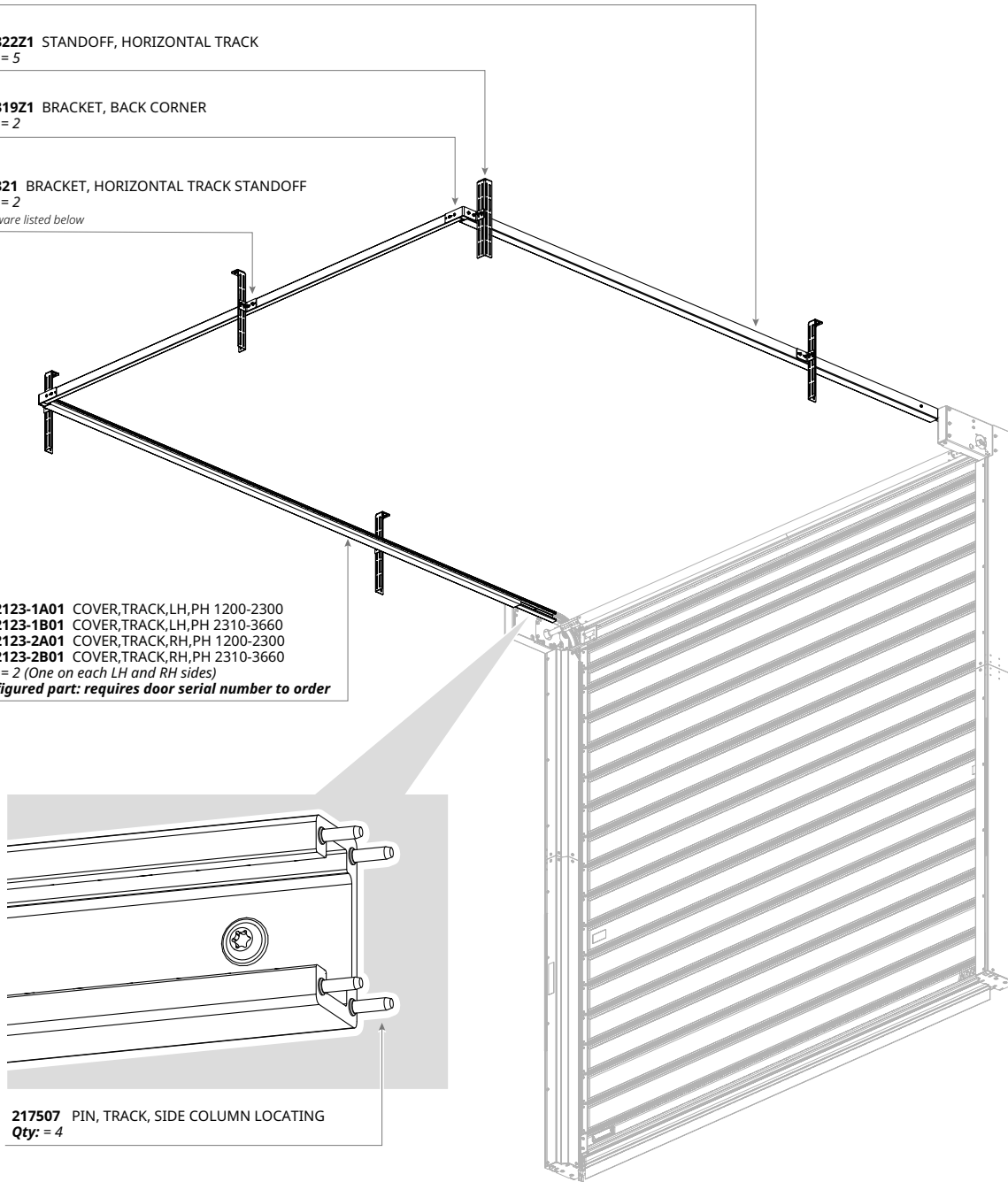

217507 PIN, TRACK, SIDE COLUMN LOCATING
Qty: = 4

Hardware – Order Separately

Part Number	Hardware	Description	Qty
236321	01901508	Nut, M8 Flanged	24
	01900825	BSCSF, M8-1.25 x 25mm, T40, ZN	24
236856	01901508	Nut, M8 Flanged	1
	01900825	BSCSF, M8-1.25 x 25mm, T40, ZN	1
	01900820	BSCSF, M8-1.25 X 20, T40, ZN	2
	217507	Pin, Track, Side Column Locating	4



01901508



01900825



01900820

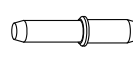

217507

Spreader Assembly *all doors*

1071628-0X01 SPREADER ASSY, REAR SEAL
 Includes 1071630-2Z01 and 1071630-1Z01
Configured part: requires door serial number to order

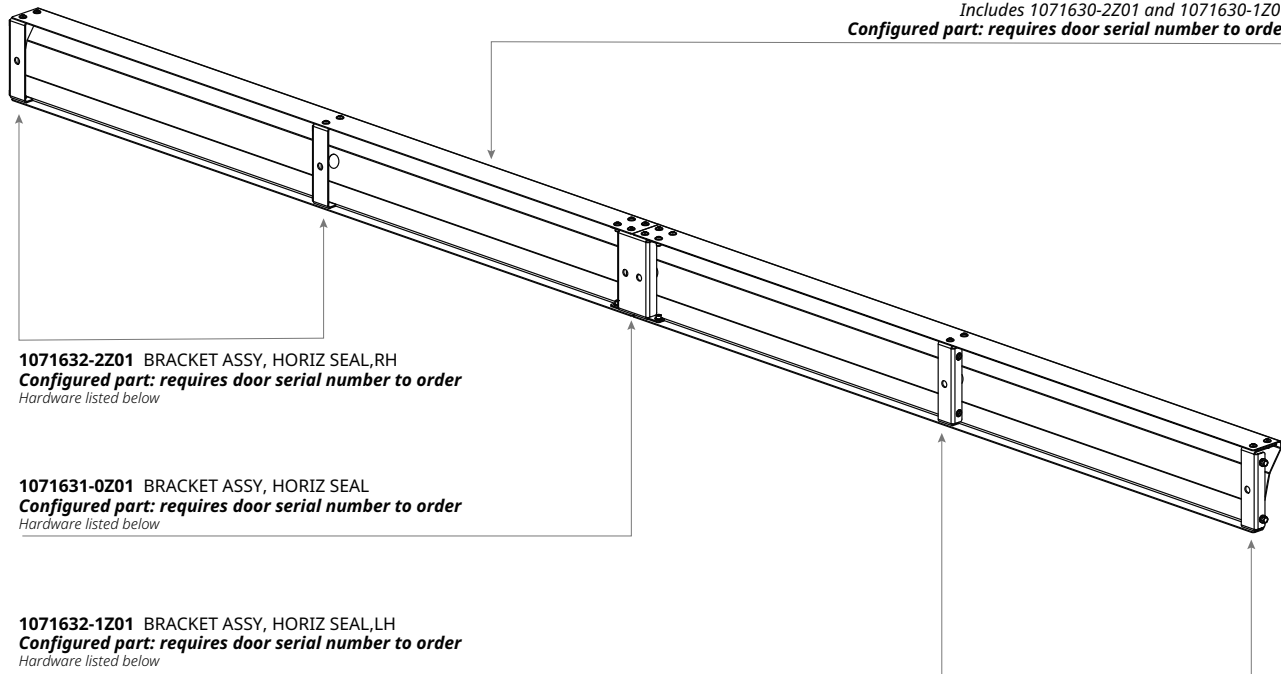

1071632-2Z01 BRACKET ASSY, HORIZ SEAL,RH
Configured part: requires door serial number to order
 Hardware listed below

1071631-0Z01 BRACKET ASSY, HORIZ SEAL
Configured part: requires door serial number to order
 Hardware listed below

1071632-1Z01 BRACKET ASSY, HORIZ SEAL,LH
Configured part: requires door serial number to order
 Hardware listed below

Hardware – Order Separately

Part Number	Hardware	Description	Qty
1071631-0Z01	5550286-0Z01	HFSMS, M8-1.25X20 CL8.8 ZN	2
	01900816	BSCSF,M8-1.25 X 16,T40,ZN	6
	5550295-0Z01	RIV-NUT, M8-1.25, AHS4T-8125-3.8	12
1071632-1Z01	5550286-0Z01	HFSMS, M8-1.25X20 CL8.8 ZN	2
	01900816	BSCSF,M8-1.25 X 16,T40,ZN	6
	5550295-0Z01	RIV-NUT, M8-1.25, AHS4T-8125-3.8	10
1071632-2Z01	5550286-0Z01	HFSMS, M8-1.25X20 CL8.8 ZN	2
	01900816	BSCSF,M8-1.25 X 16,T40,ZN	6
	5550295-0Z01	RIV-NUT, M8-1.25, AHS4T-8125-3.8	10

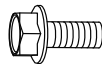

5550286-0Z01



01900816



5550295-0Z01

Side Column Assemblies *all doors*

1072035-1X ASSY,SC,STN-LP-S,LH
1072025-1X ASSY,SC,STN-LP-L,LH
Includes as applicable: 1072045-1Z01 or 1072048-1Z01
Configured part: requires door serial number to order
Hardware listed below

1072035-2X ASSY,SC,STN-LP-S,RH
1072025-2X ASSY,SC,STN-LP-L,RH
Includes as applicable: 1072045-2Z01 or 1072048-2Z01
Configured part: requires door serial number to order
Hardware listed below

1072057-1Z01 ASSY,SC COVER,STN-LP,LH
Includes as applicable:
 1072056-1Z01 one piece (shown) or 1072053-1Z01 spliced
Hardware listed below

1072057-2Z01 ASSY,SC COVER,STN-LP,RH
Includes as applicable:
 1072056-2Z01 one piece or 1072053-2Z01 spliced (shown)
Hardware listed below

04010337 SC SEAL,32.2/20X10MM

04010337 SC SEAL,32.2/20X10MM

0004530
 GROMMET
 1 X 1 3/4 OD

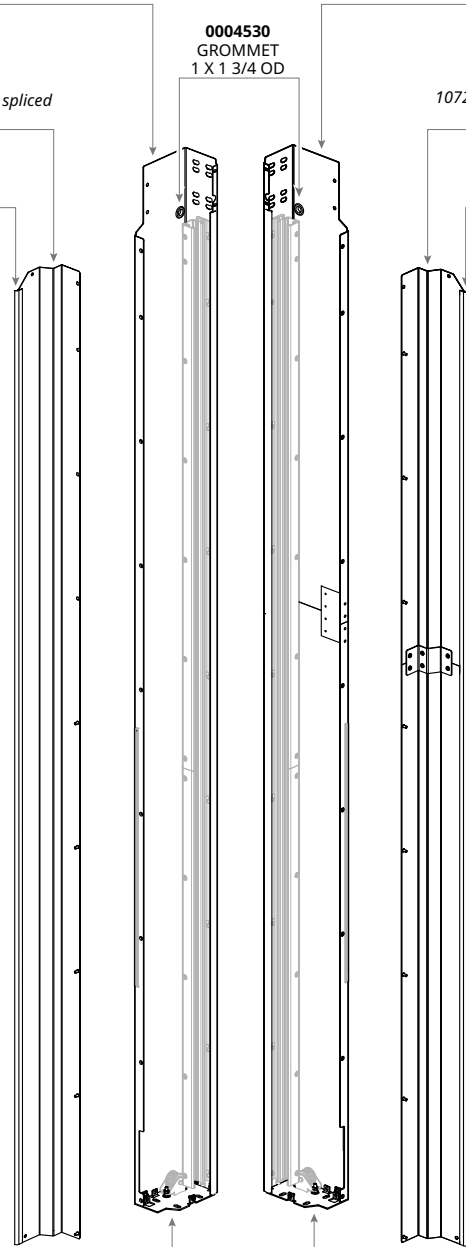

NOTE: drive side may be LH or RH.

** = multiple variations of part number: use wildcard to search (Rytec parts representative)*

1072060-1Z01 ASSY,BASEPLATE,SSN-LP-L,LH
Configured part: requires door serial number to order
Hardware listed below

R1072060-2Z01 ASSY,BASEPLATE,SSN-LP-L,RH
Configured part: requires door serial number to order
Hardware listed below

Hardware - Order Separately

Part Number	Hardware	Description	Qty
1072025*	5550289-0Z04	BLIND RIVET FLUSH HEAD 0.19OD 0.33GP SS	16
1072057*	01900816	BSCSF,M8-1.25 X 16,T40,ZN	15
1072060*	5550301-0Z01	HFSMS,M8-1.25X8 CL10.9 ZN	1
	5550296-0Z01	RIV-NUT, M8-1.25, AHS4T-8125-7.9	3
	01300530	SCREW, M10 X 30, DIN 963-4.8	2
	01270060	NUT, M10 HEX, DIN 934-8 ZN	4
	01900820	BSCSF,M8-1.25 X 20,T40,ZN	3

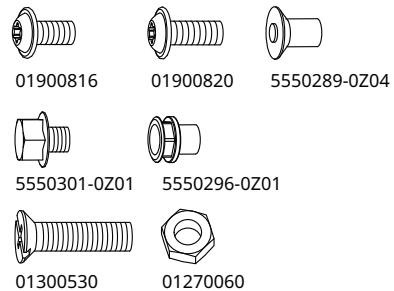

Cables and Connectors *all doors*

00142166 CABLE, REMOTE DISPLAY, 15M

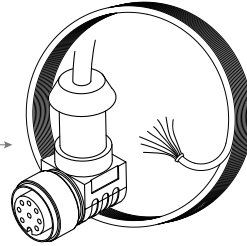

1210801-0B CABLE, 6 COND, M8 SOCKET TO FLYING LEADS, 1

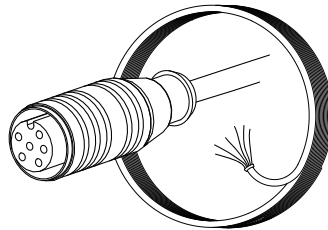

00142016 CABLE, 16 GA, 4 COND SHIELD, SEOW, 600V, 90C

1210595-0A CABLE, 16GA, 4C SHIELD, SEOW, 600V, 90C, 264"
 1210595-0B CABLE, 16GA, 4C SHIELD, SEOW, 600V, 90C, 384"
 1210595-0X CABLE, 16GA, 4C SHIELD, SEOW, 600V, 90C, VAR

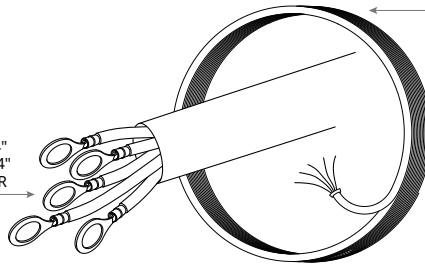

00142017 CABLE, 18 GA, 2 COND NON-SH, SEOW, 600V, 90C

1210596-0A CABLE, 18GA, 2C NON-SH, SEOW, 600V, 90C, 264"
 1210596-0B CABLE, 18GA, 2C NON-SH, SEOW, 600V, 90C, 384"
 1210596-0X CABLE, 18GA, 2C NON-SH, SEOW, 600V, 90C, VAR

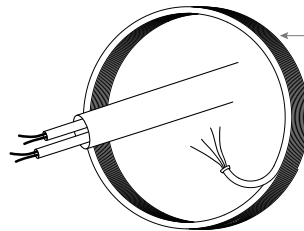

00142165 ASSY, CABLE, REMOTE DISPLAY

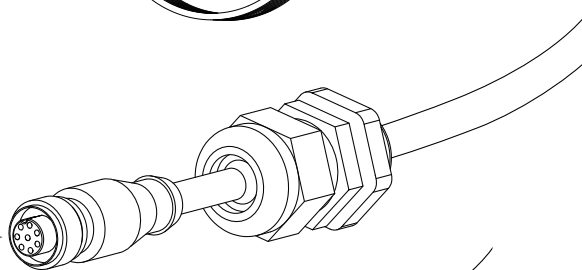

08092680 END, CABLE COVER, M6X22, 5.5MM

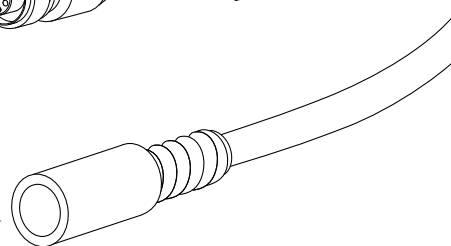

Drive Shaft, Non-Drive Side *all doors*

1072028-0Z01 LINE SHAFT
Configured part: requires door serial number to order

1072031-0Z01 SHAFT, NON-DRIVE SIDE
Hardware listed below

01531036 KEY,10X8X36,DIN 6885 A C45K
Qty: non-drive side = 1, drive side = 3

01340150 SHIM RING,35X45X2, DIN 988 PS
Qty: non-drive side = 2, drive side = 2

205533 PULLEY,HTD P64-8M-30,FLGD,D168
Qty: non-drive side = 1, drive side = 1

1072029-0Z01 BEARING HOUSING,2207
(Bearing included)

WN018-A SPACER, THRUST

5550278-0Z01
 HFSMS, M8-1.25X20 CL10.9 ZN

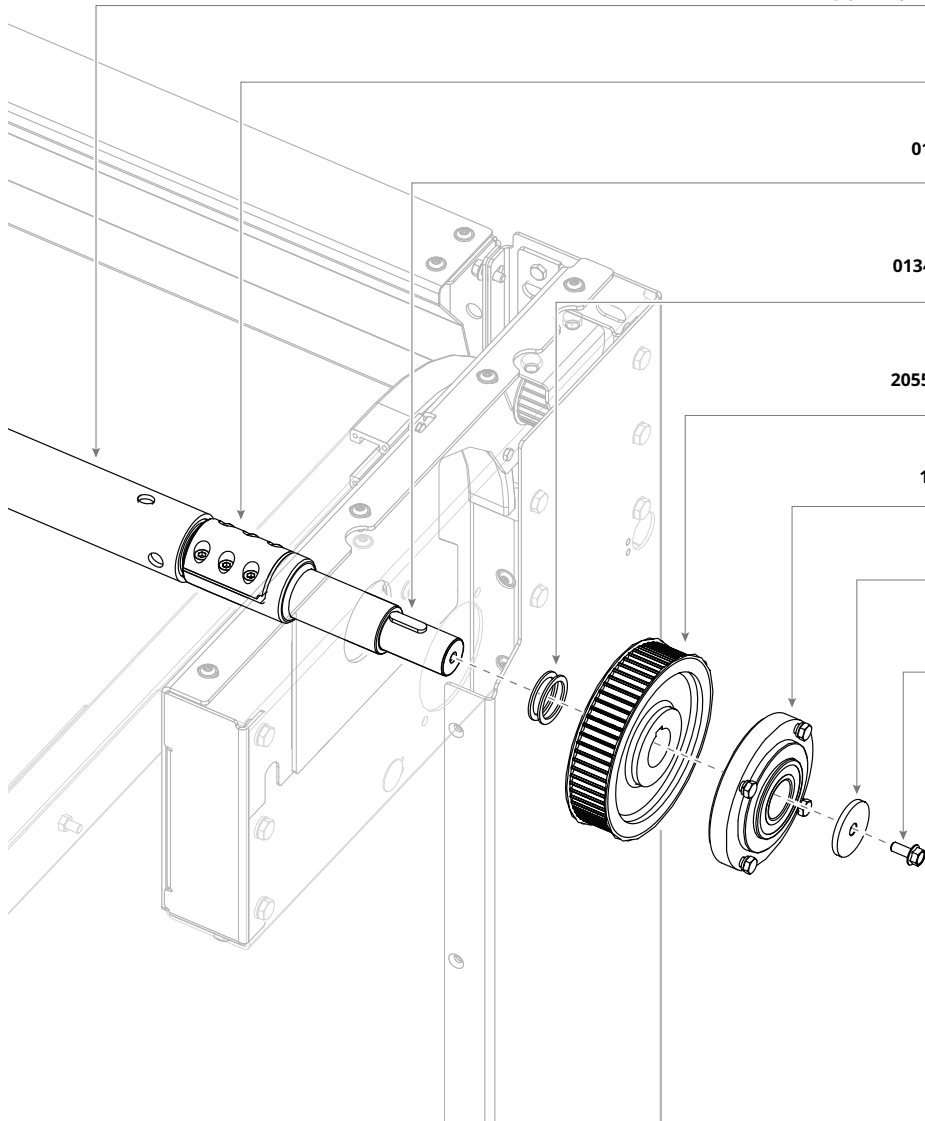

*NOTE: drive side may be LH or RH.
 RH drive shown.*

Hardware – Order Separately

Part Number	Hardware	Description	Qty
1072031-0Z01	01180525	M8-1.25 X 25 Socket Head Cap Screw	6
1072029-0Z01	01260274	HHCS,M8X20,DIN 933 - 8.8 ZN, Screw	4
	01080030	WASHER,M8,LOCK,HIGH COLLAR,DIN 7980,STL ZN	4

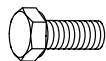

01180525



01080030

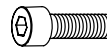

01260274

Drive Shaft, Drive Side *all doors*

1072028-0Z01 WLDMT,LINE SHAFT,SSN-LP-L
 1072038-0Z01 WLDMT,LINE SHAFT,SSN-LP-S
Configured part: requires door serial number to order

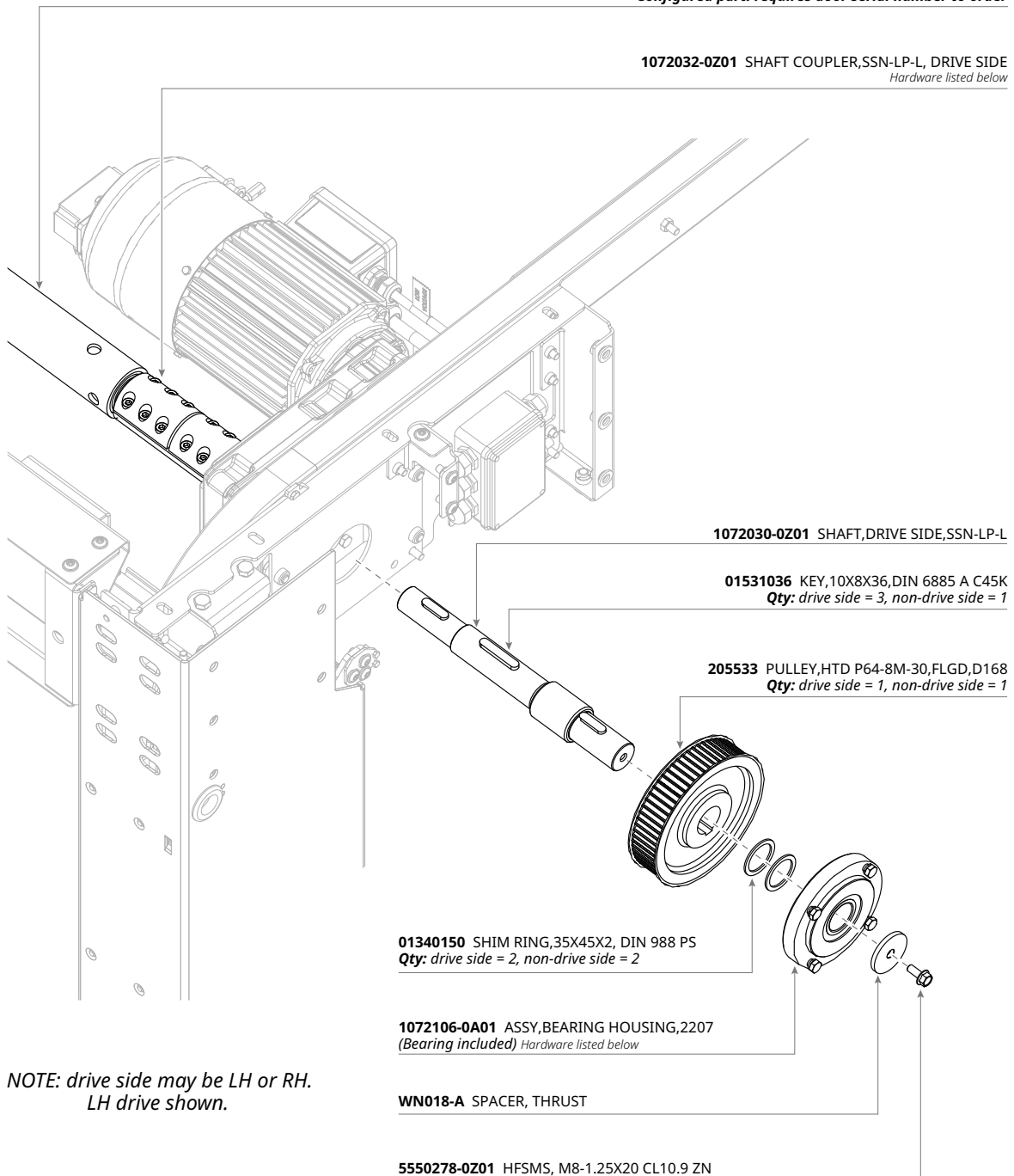

*NOTE: drive side may be LH or RH.
 LH drive shown.*

Hardware - Order Separately

Part Number	Hardware	Description	Qty
1072032-0Z01	01180525	M8-1.25 X 25 Socket Head Cap Screw	12
1072106-0A01	01260274	HHCS,M8X20,DIN 933 - 8.8 ZN, Screw	4
	01080030	WASHER,M8,LOCK,HIGH COLLAR,DIN 7980,STL ZN	4

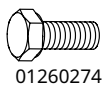

Door Panel Hinges *all doors*

HINGE CHAIN ASSY

Configured part: requires door serial number to order

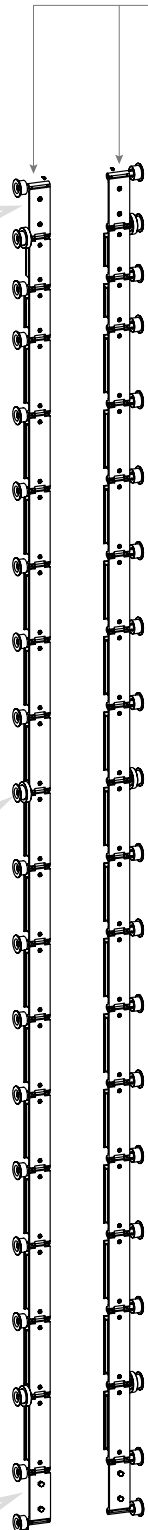
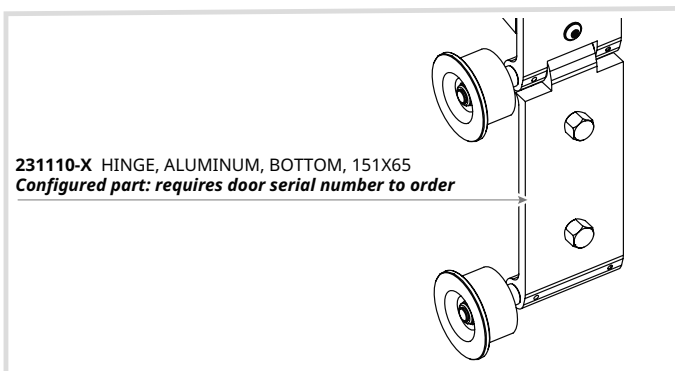
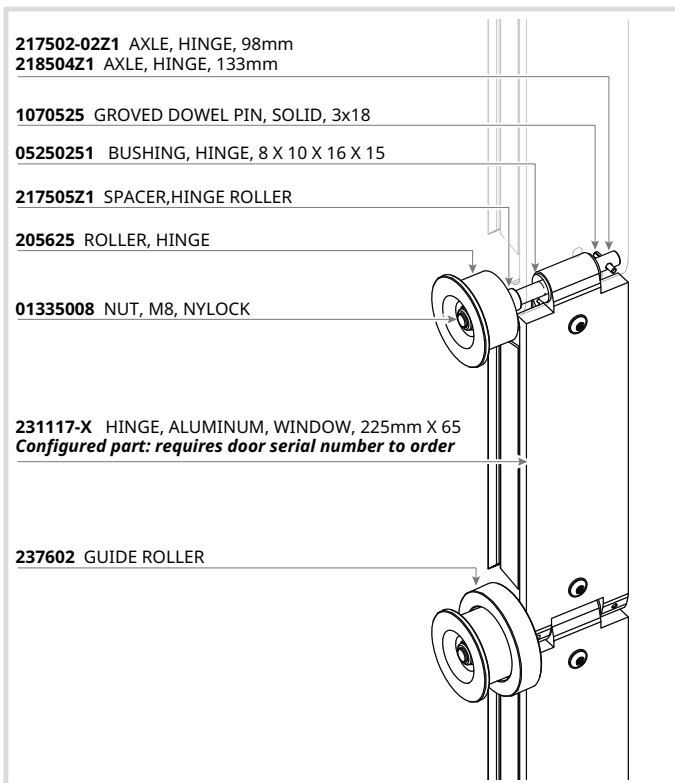
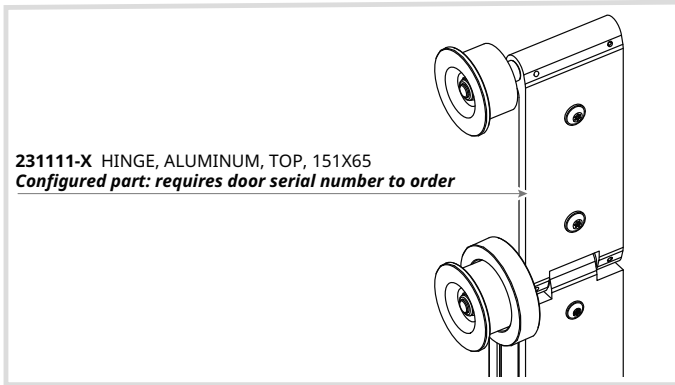

Drive Belt *all doors*

243804Z4 IDLER PULLEY ASSY,SSN-L
 Includes 243816, 243807
 Hardware listed below

1072104-0Z01 ASSY,CLEVIS,BELT ROLLER,SSN-LP-S
 Includes 243817-01

205522-01Z1 SHAFT,GUIDE PULLEY,SINGLE

1072107-0 TOOTH BELT,LL-8MR-30,GT2

1210798-0Z03 SPACER,RECTANGULAR

243814Z4 PULLEY ASSY,TOOTH BELT,SSN-L
 Includes 243807

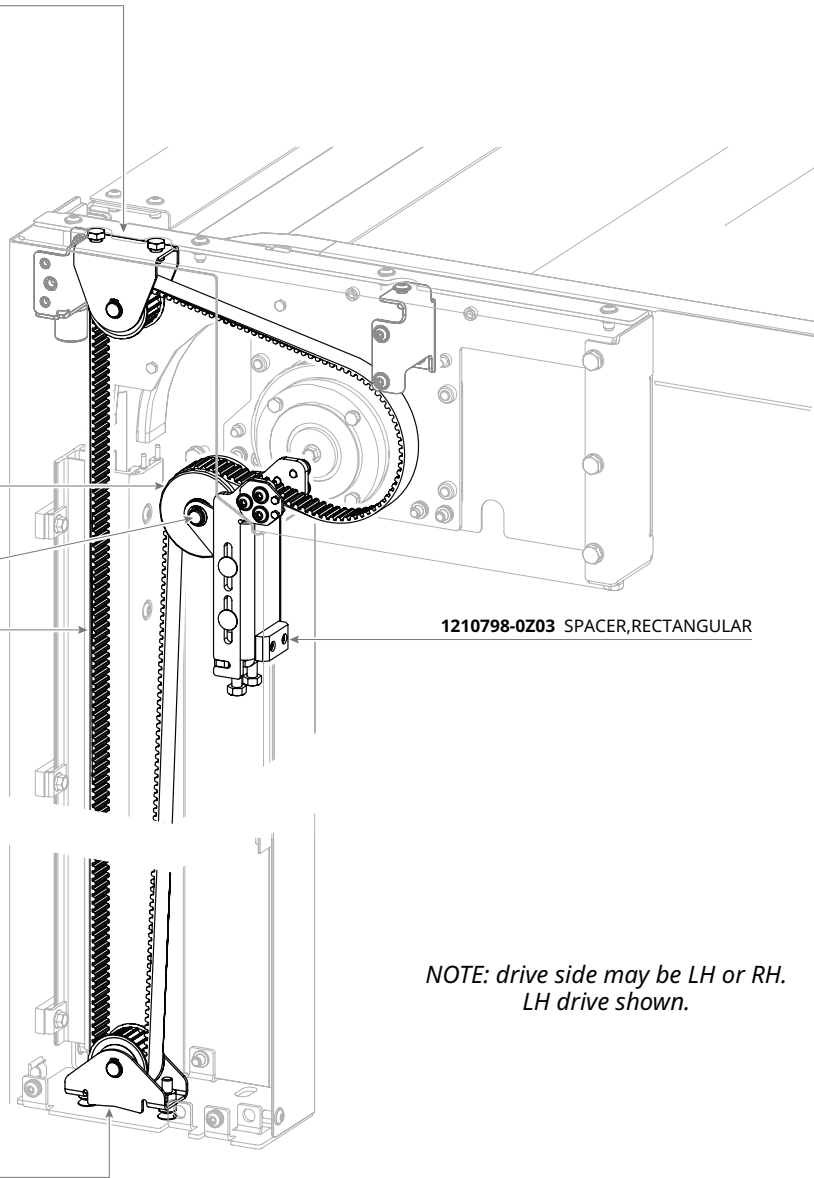

*NOTE: drive side may be LH or RH.
 LH drive shown.*

Hardware – Order Separately

Part Number	Hardware	Description	Qty
243804Z4	1260300	HHCS,M10X16,DIN 933-8.8 ZN	2
	01901610	M10 PRESS NUT	2
243814Z4	01300530	SCREW, M10 X 30, DIN 963-4.8	2
	01270060	NUT, M10 HEX, DIN 934-8 ZN	4



1260300

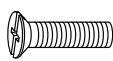

01300530



01270060



01901610

Chain Hoist Assembly *all doors*

1210840-1X ASSY,CHAIN HOIST,LH
Configured part: requires door serial number to order

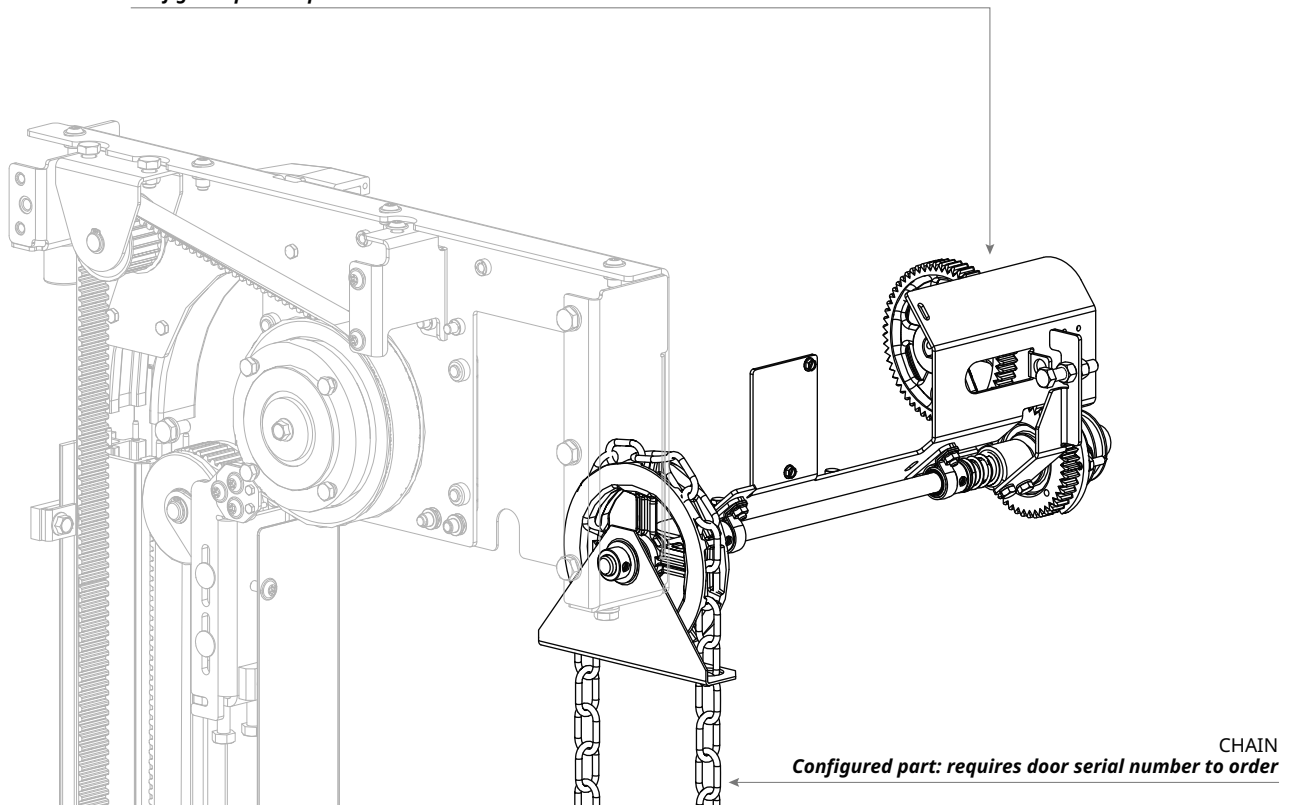

*NOTE: drive side may be LH or RH.
 LH drive shown.*

Bottom Bar Assembly *all doors*

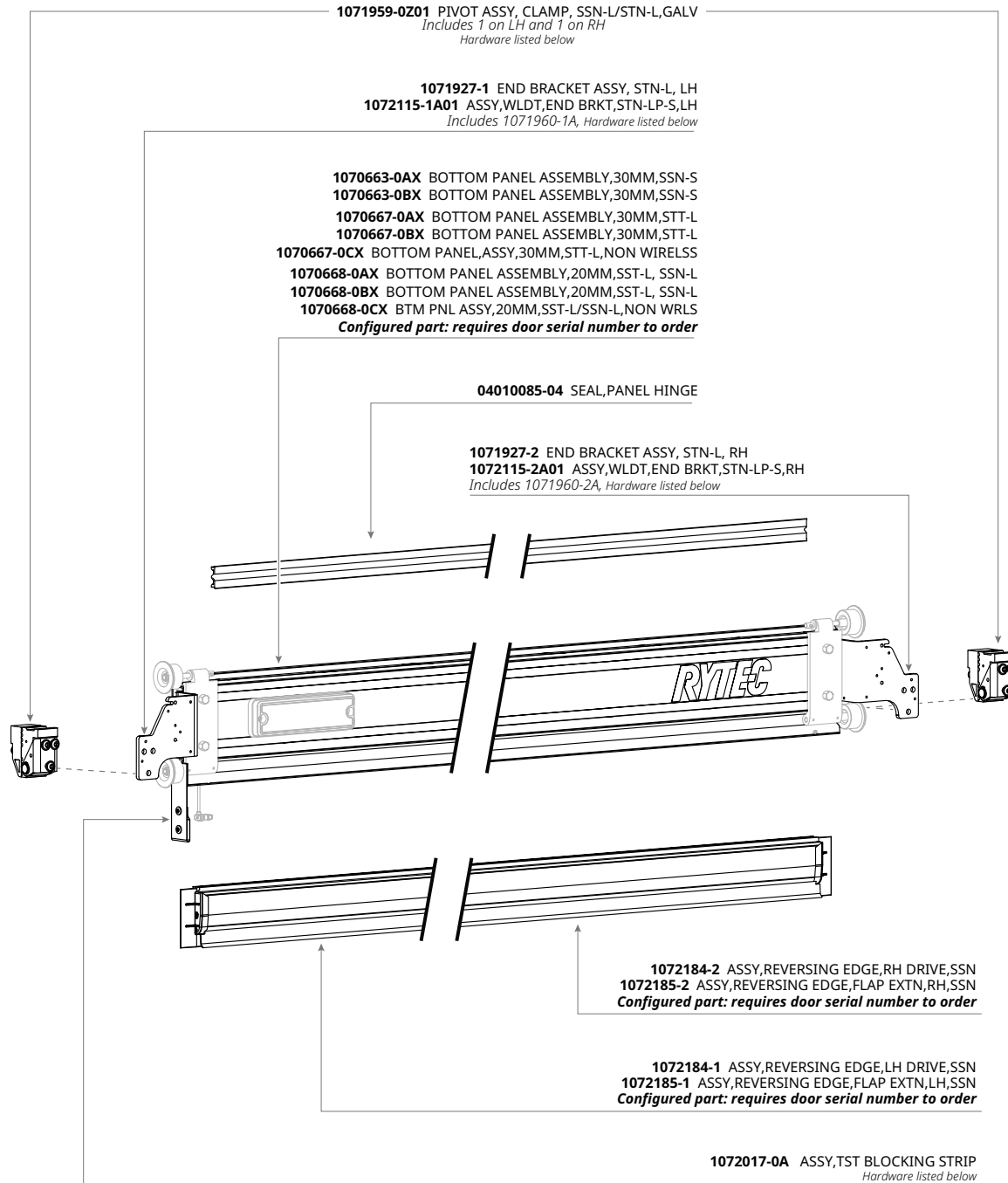

NOTE: Serial number required to verify if door is Standard or XL

X = multiple variations of part number (Rytec parts representative)

Hardware - Order Separately

Part Number	Hardware	Description	Qty
1071959-0Z01	01900816	BSCSF,M8-1.25 X 16,T40,ZN	3
1071927-X	01230008	NUT,M8,HEX,CAP,DIN 917 ZN	2
	01160515	CARRAIGE BOLT,M8X45,DIN 603MU	2
1072017-0A	5550140-0Z01	FLAT WASHER, .38 IDX1.25 ODX .13 STL ZN	1



01230008

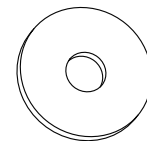

5550140-0Z01



01900816

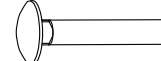

01160515

Console Framework *all doors*

1072027-1X ASSY, CONSOLE, SSN-LP-L, LH

1072027-X SET, CONSOLES, SSN-LP-L

Hardware listed below

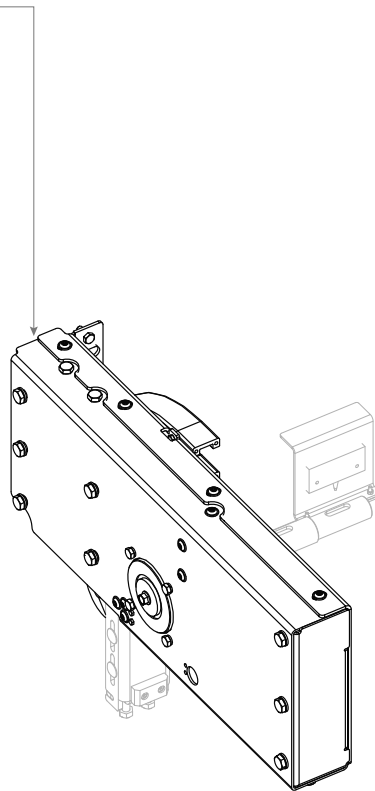

1072027-2X ASSY, CONSOLE, SSN-LP-L, RH

Hardware listed below

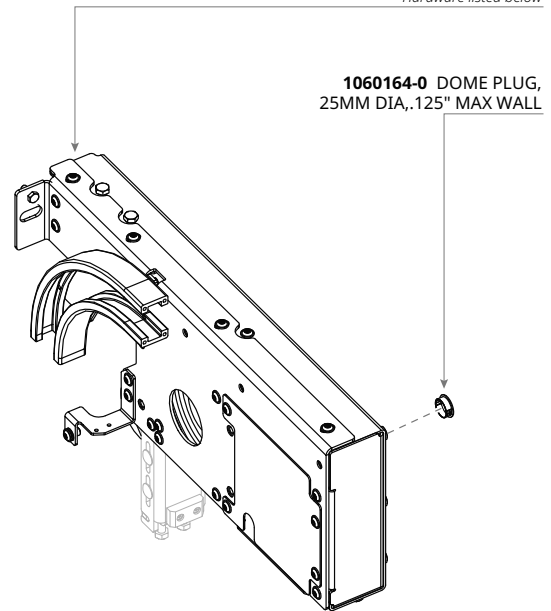

NOTE: drive side may be LH or RH.
LH drive shown.

* = multiple variations of part number: use wildcard to search (Rytec parts representative)

Hardware – Order Separately

Part Number	Hardware	Description	Qty
1072027*	01260310	HHCS, M10X20, DIN 933-8.8 ZN	4
	01900820	BSCSF, M8-1.25 X 20, T40, ZN	4



01260310



01900820

Motor and Encoder *all doors*

1071027-0Z04 WIRELESS BRACKET ARM WITH WARNING TAG
 Includes 1070678-0Z04, 2109
 Hardware listed below

1070960-0Z04 UPPER CORNER BRACKET WIRELESS ARM

1070652-0A JUNCTION BOX, HEAD CONSOLE, SPIRAL, 15M

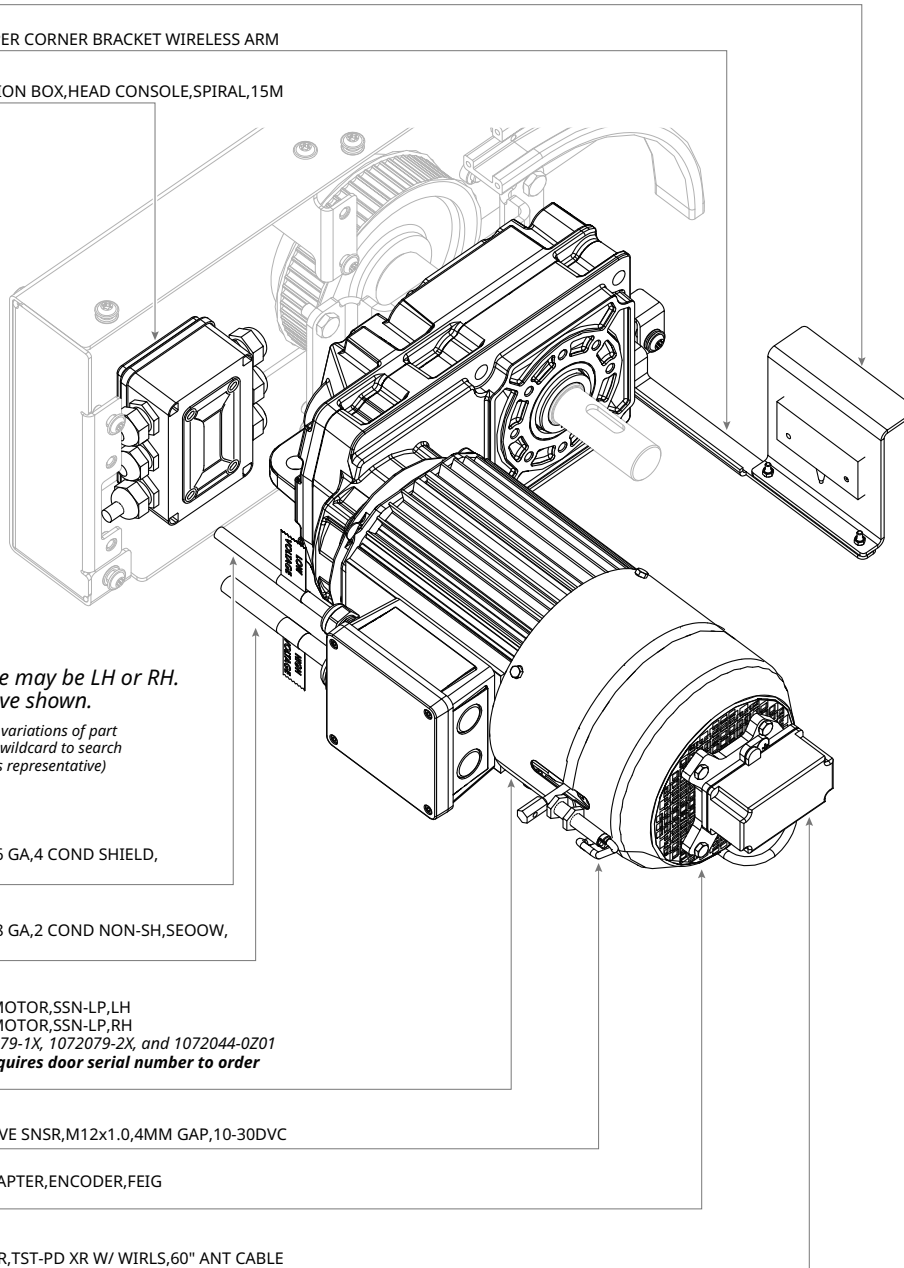

NOTE: drive side may be LH or RH.
 LH drive shown.

* = multiple variations of part number: use wildcard to search (Rytec parts representative)

00142017 CABLE, 16 GA, 4 COND SHIELD, SEOWW, 600V, 90C

00142016 CABLE, 18 GA, 2 COND NON-SH, SEOWW, 600V, 90C

1072081-1X ASSY, MOTOR, SSN-LP, LH
1072081-2X ASSY, MOTOR, SSN-LP, RH
 Included assy: 1072079-1X, 1072079-2X, and 1072044-0Z01
Configured part: requires door serial number to order
 Hardware listed below

00111188 INDUCTIVE SNSR, M12x1.0, 4MM GAP, 10-30DVC

1210782 PLATE, ADAPTER, ENCODER, FEIG
 Hardware listed below

00141120 ENCODER, TST-PD XR W/ WIRLS, 60" ANT CABLE

Hardware – Order Separately

Part Number	Hardware	Description	Qty
1071027-0Z04	5550246-0Z01	HHCS M4-0.7X16 GR5 ZN	4
	5550057-0Z01	NUT, M4-0.7, HEX HEAD,ZINC,NYLOCK	4
	5550264-0	RATCHET FASTENER, .16 X .04-.25,BLK NYLON	2
1072081*	01260274	HHCS, M8X20, DIN 933 - 8.8 ZN	6
1210782	01260110	HHCS, M6-1.0X14, DIN 933-8.8 ZN, S593 PATCH	4
	01270040	NUT, M6-1.0, HEX, DIN 934-8 ZN	4
	0550317	SCREW, 10-24UNC x 1/2, PHILLIP TRUSS HEAD	2

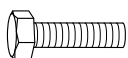

5550246-0Z01



5550264-0



01260274



01260110



0550317



5550057-0Z01



01270040

Door Panels *L doors with Full Vision Panels*

Door 1072020

1071896-0X For Door Assembly, LH Drive, PANEL/HINGE ASSY,STN-L
Configured part: requires door serial number to order

04010170 SEAL,SPIRAL DOOR TOP,L=37M
Configured part: requires door serial number to order

238832-X TOP PNL ASSY,30MM,SST-S
Configured part: requires door serial number to order

1071022-0AX ASSY,WNDW,LEXAN,STT-L,30X151,CL-112
1071022-0BX ASSY,WNDW,LEXAN,STT-L,30X151,GY-713
1071022-0CX ASSY,WNDW,LEXAN,STT-L,30X151,BZ-109
Configured part: requires door serial number to order

231848CZ4 WNDW ASSY,30MMX225MM,HPG AL,PAINTED
Configured part: requires door serial number to order

1070841-0 WINDOW ASSY,HPG,30MMX225MM COMPLETE
Configured part: requires door serial number to order

1070991-0AX ASSY,WNDW,LEXAN,STT-L,30X225,CL-112
1070991-0BX ASSY,WNDW,LEXAN,STT-L,30X225,GY-713
1070991-0CX ASSY,WNDW,LEXAN,STT-L,30X225,BZ-109
Configured part: requires door serial number to order

1071285-0 ASSY,RND VENT W/SPACERS,STT-L,30X225
1071285-0Z04 ASSY,RND VENT W/SPACERS,STT-L,30X225,PNT
Configured part: requires door serial number to order

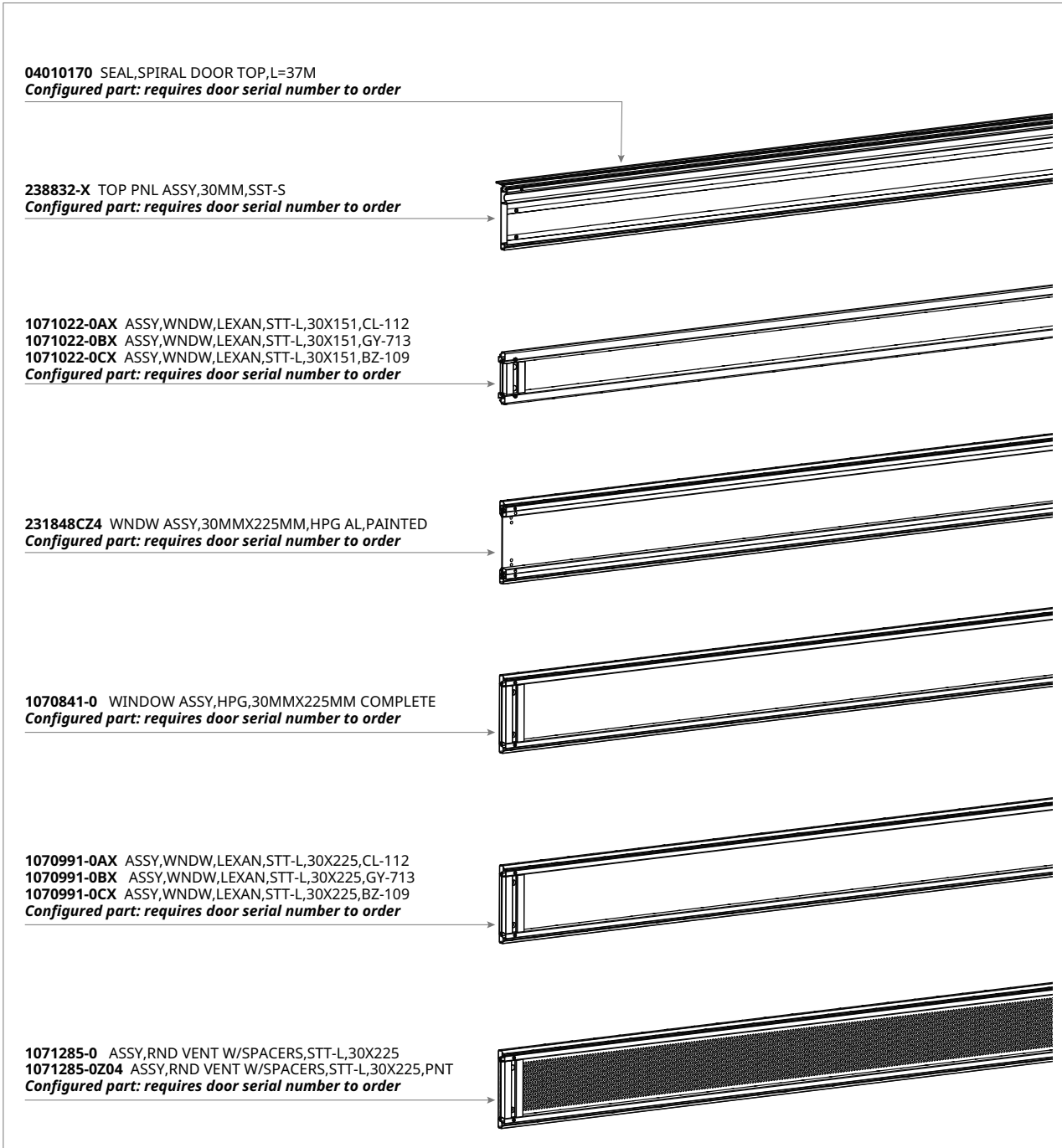

NOTE: drive side may be LH or RH.
 LH drive shown.

*X = multiple variations of part number
 (Rytec parts representative)*

Door Panels *L doors without Full Vision Panels*

Door 1072021

1071279-0 ASSY,RND VENT W/SPACERS,SSX-L,20X151
1071279-0Z04 ASSY,RND VENT W/SPACERS,SSX-L,20X151,PNT
Configured part: requires door serial number to order

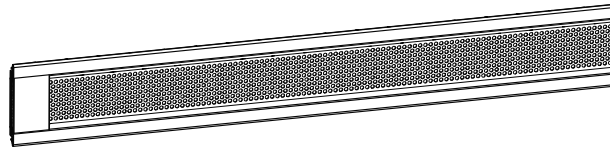

1071006-0AX ASSY,WNDW,LEXAN,SSX-L,20X151,CL-112
1071006-0BX ASSY,WNDW,LEXAN,SSX-L,20X151,GY-713
1071006-0CX ASSY,WNDW,LEXAN,SSX-L,20X151,BZ-109
Configured part: requires door serial number to order

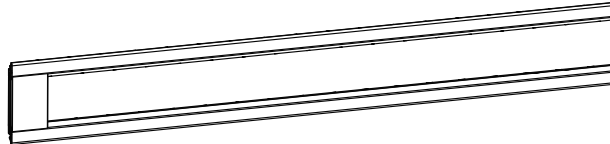

237834 TOP PNL ASSY, 20MM, SST-L
237834Z4 TOP PNL ASSY, 20MM, SST-L,PAINTED
Configured part: requires door serial number to order



237833 PANEL ASSY, 20MM, SST-L
237833Z4 PNL ASSY, 20MM, SST-L,PAINTED
Configured part: requires door serial number to order



04010085-04 SEAL,PANEL HINGE

231858 WINDOW ASSY,W/SPACERS,20mm X 151mm,SST-L,SST-L/R,SSN-L
Configured part: requires door serial number to order



1070853-0 PANEL/HINGE ASSY,SSN-L
1070853-0Z04 PANEL/HINGE ASSY,SSN-L,PAINTED
Configured part: requires door serial number to order

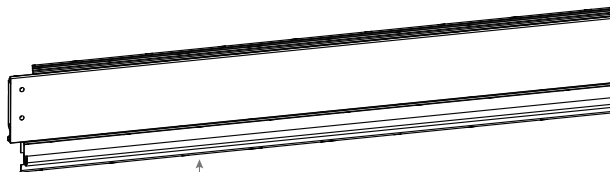

1072184-1 ASSY,REVERSING EDGE,LH DRIVE,SSN
1072184-2 ASSY,REVERSING EDGE,RH DRIVE,SSN
1070864-0 REVERSING EDGE FLAP EXTENSION
Configured part: requires door serial number to order

NOTE: drive side may be LH or RH.
 LH drive shown.

X = multiple variations of part number
 (Rytec parts representative)

Door Panels *S* doors with Full Vision Panels

Door 1072022

1072024-X For Door Assembly, PANEL ASSY,STN-LP-S
Configured part: requires door serial number to order

1071921-0 TOP PNL ASSY, 40MM, STN-S
K1071921-0Z04 TOP PNL ASSY, 40MM, STN-SMPAINTED
Configured part: requires door serial number to order

232813-01 WINDOW ASSY,40MMX151MM,STT
Configured part: requires door serial number to order

1071023-0AX ASSY,WNDW,LEXAN,STT-S,40x151,CL-112
1071023-0BX ASSY,WNDW,LEXAN,STT-S,40X151,GY-713
1071023-0CX ASSY,WNDW,LEXAN,STT-S,40X151,BZ-109
Configured part: requires door serial number to order

1070992-0AX ASSY,WNDW,LEXAN,STT-S,40X225,CL-112
1070992-0BX ASSY,WNDW,LEXAN,STT-S,40X225,GY-713
1070992-0CX ASSY,WNDW,LEXAN,STT-S,40X225,BZ-109
Configured part: requires door serial number to order

232819C-01X WIN ASSY,40MMX225MM,HPG,ALUM
Configured part: requires door serial number to order

1071287-0X ASSY,RND VENT W/SPACERS,STT-S,40X225
Configured part: requires door serial number to order

1070838-0X WINDOW ASSY, HPG 40MMX225MM COMPLETE
Configured part: requires door serial number to order

1071941-0AX ASSY,BTM PANEL,40MM,STN-S,WRLS,LH
1071941-0BX ASSY,BTM PANEL,40MM,STN-S,WRLS,RH
Configured part: requires door serial number to order

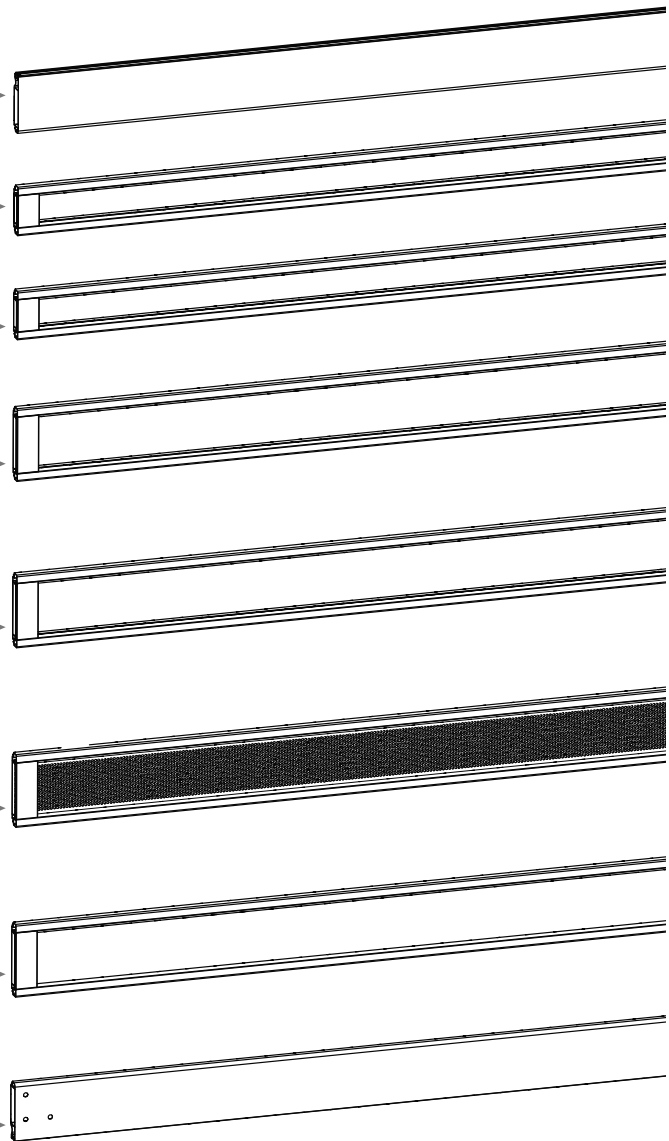

**NOTE: drive side may be LH or RH.
 LH drive shown.**

*X = multiple variations of part number
 (Rytec parts representative)*

Door Panels *S* doors without Full Vision Panels

Door 1072023

1072064-X PANEL ASSY,SSN-LP-S
Configured part: requires door serial number to order

238833 PANEL ASSY,30MM,SST-S
238833Z4 PNL ASSY,30MM,SST-S,PAINTED
Configured part: requires door serial number to order

04010085-04 SEAL,PANEL HINGE

232830 WINDOW ASSY,W/SPACERS,30mm x 151mm,
 SST-S,SST-S/R,SSN-S
Configured part: requires door serial number to order

1071281-0 ASSY,RND VENT W/SPACERS,SSX-S,30X151
1071281-0Z04 ASSY,RND VENT W/SPACERS,SSX-S,30X151,PNT
Configured part: requires door serial number to order

1071021-0AX ASSY,WNDW,LEXAN,SSX-S,30X151,CL-112
1071021-0BX ASSY,WNDW,LEXAN,SSX-S,30X151,GY-713
1071021-0CX ASSY,WNDW,LEXAN,SSX-S,30X151,BZ-109
Configured part: requires door serial number to order

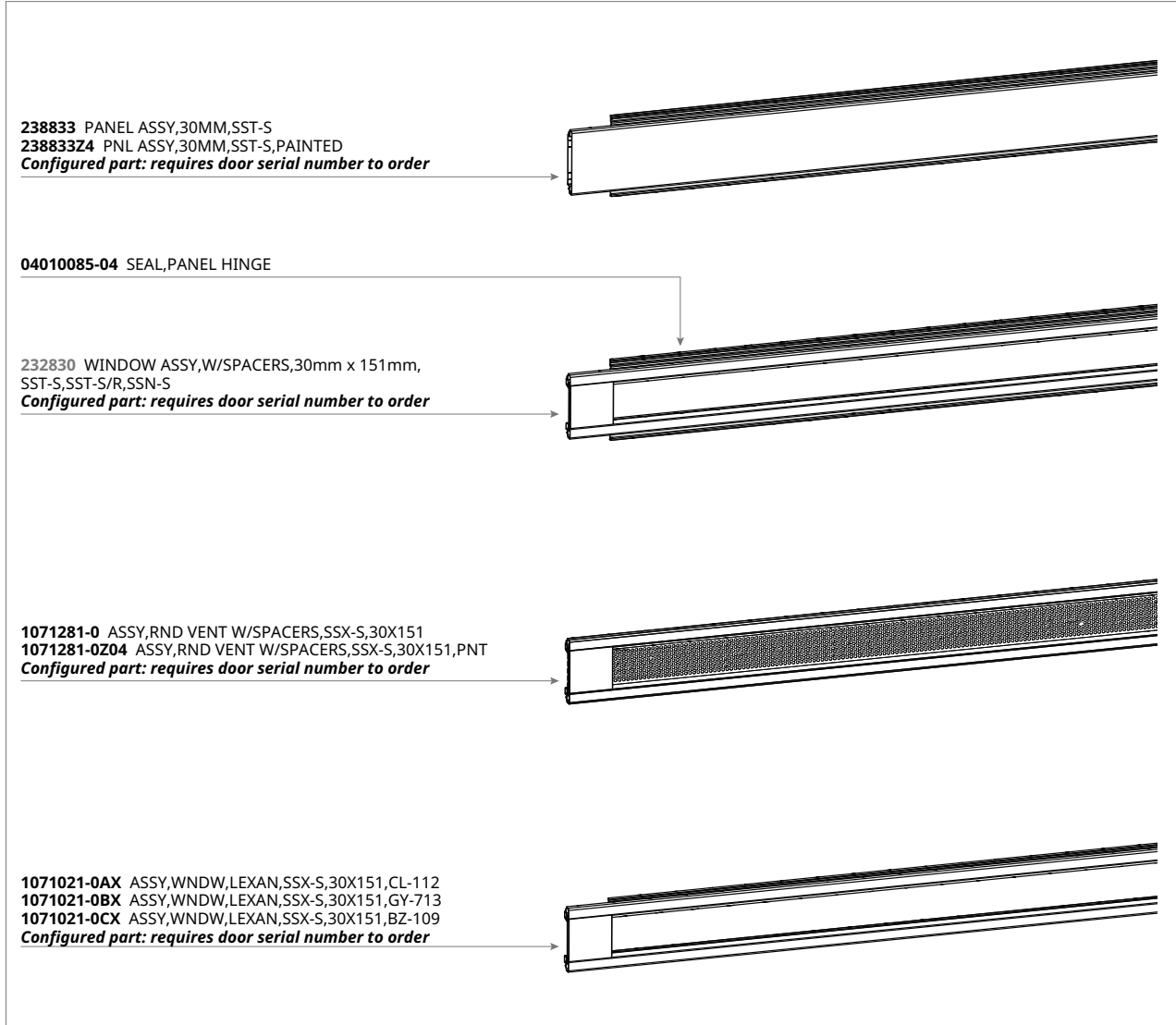

NOTE: drive side may be LH or RH.
 LH drive shown.

X = multiple variations of part number
 (Rytec parts representative)

Vertical Tracks *all doors*

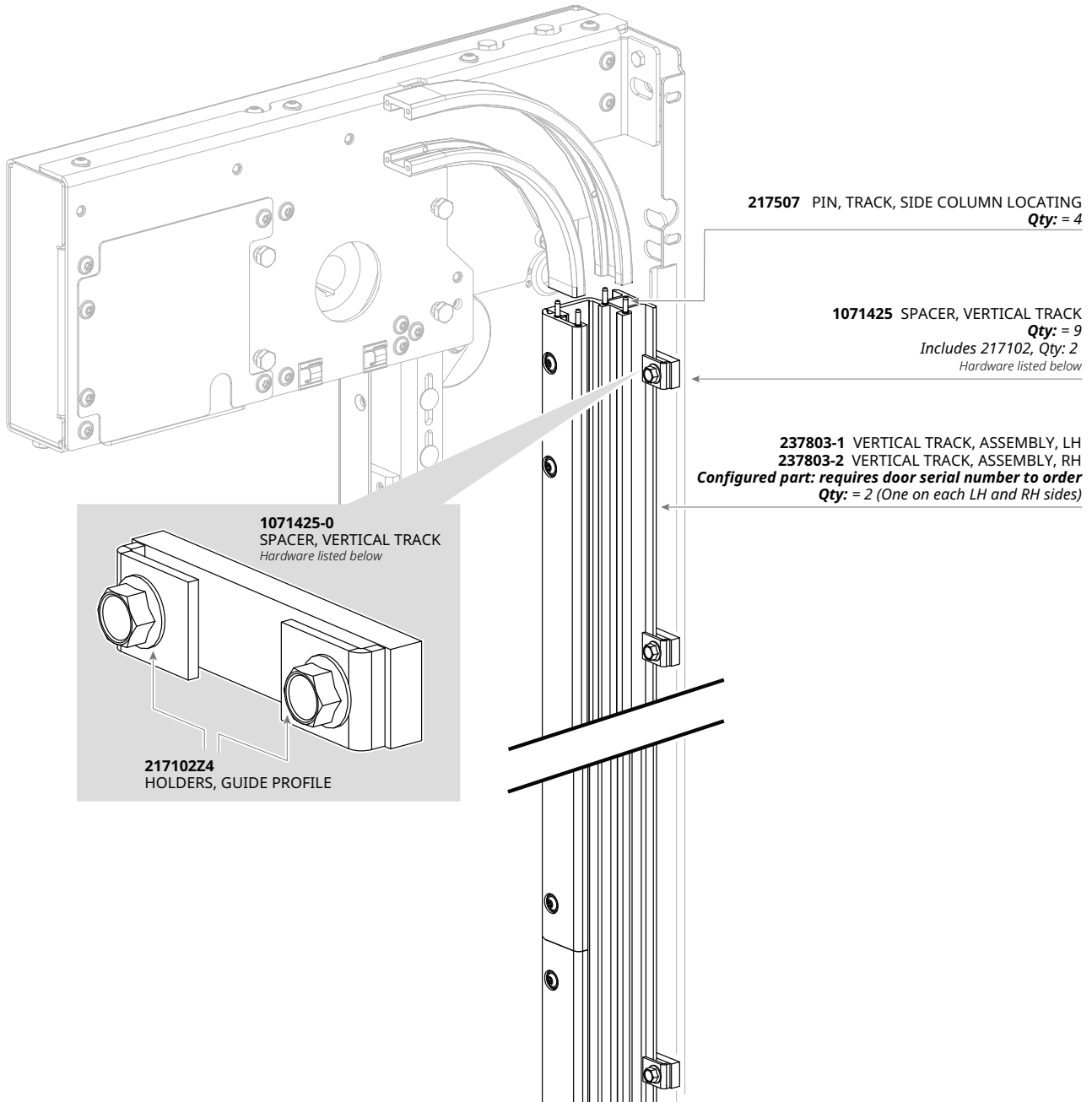

Hardware - Order Separately

Part Number	Hardware	Description	Qty
236311	01260110	HHCS,M6-1.0X14,DIN 933-8.8 ZN,S593 PATCH	2
236312	01260110	HHCS,M6-1.0X14,DIN 933-8.8 ZN,S593 PATCH	2
1071425-0	5550286-0Z01	HFSMS, M8-1.25X20 CL8.8 ZN	2



01260110

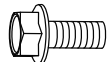

5550286-0Z01

System 4 Controller and Accessories *all doors*

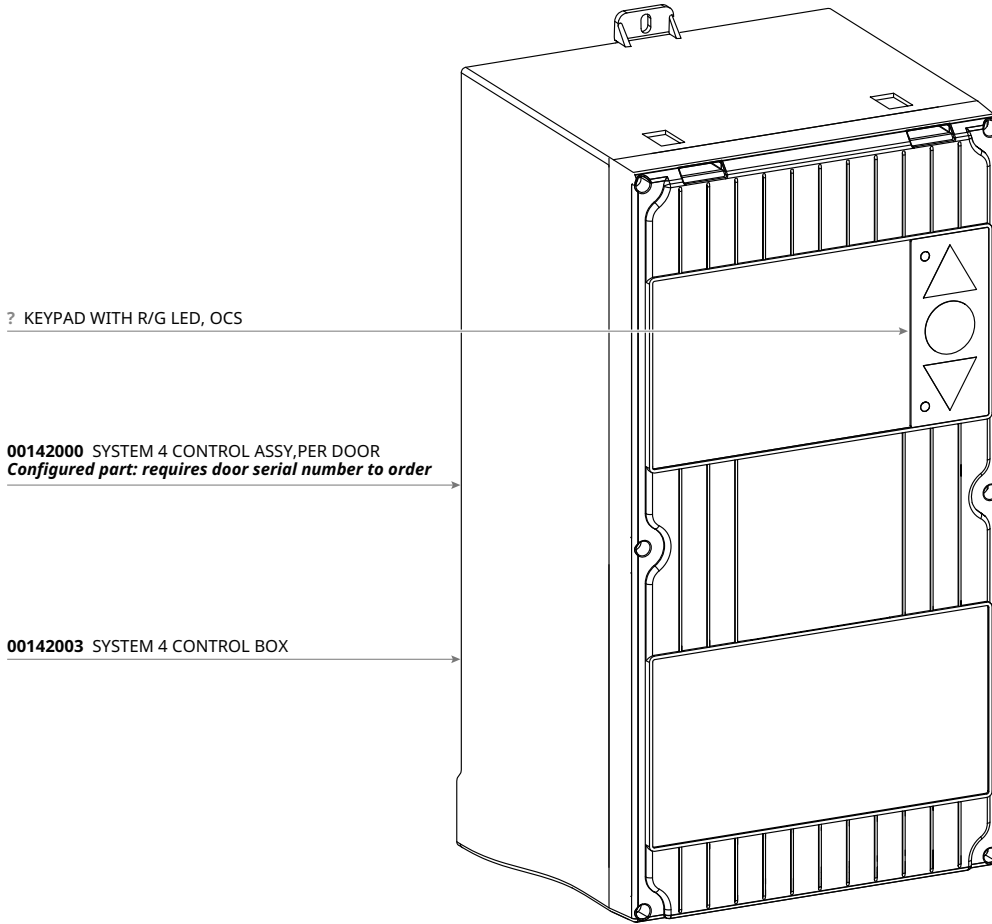

? KEYPAD WITH R/G LED, OCS

00142000 SYSTEM 4 CONTROL ASSY,PER DOOR
Configured part: requires door serial number to order

00142003 SYSTEM 4 CONTROL BOX

00142020 USB DRIVE



00142015 BATTERY,BUTTON CELL,CR2032,3V LITHIUM



00112023 FERRITE FILTER, SMALL
Qty: 3



00112001 FERRITE FILTER, LARGE
Qty: 2



1210590-0
AEROSOL CAN 12 OZ PAINT, RYTEC SILVER

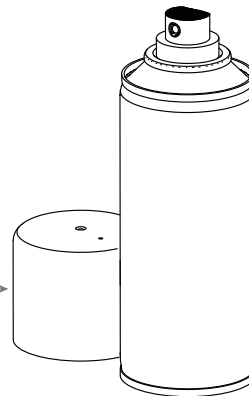

1070360-0Z1 PLATE,DOOR PANEL ASSY SERVICE



Remote Mobile Unit *all doors*

1210110-0 LABEL,WIRELESS COVER,RY-WI

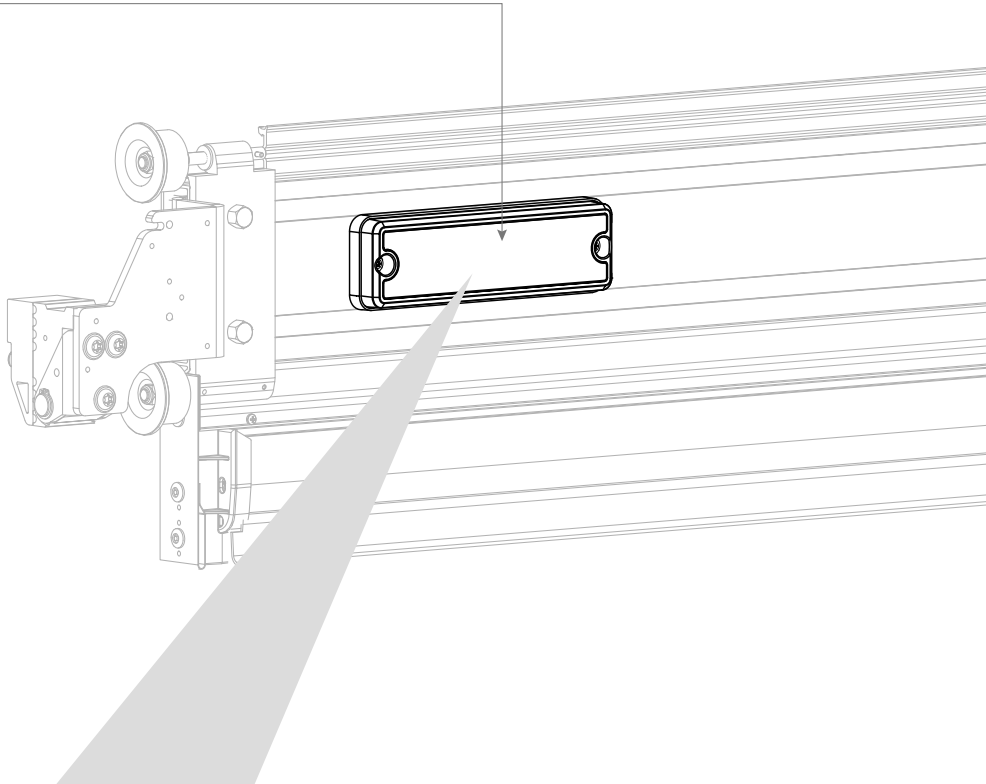

1071926-0 ASSY,MOBILE UNIT,POTTED,SPIRAL

0011193 BATTERY
WIRELESS "D" W/TABS

01900720
BSCSF,M6X20,T30,ZN,PRECOTE 80-8

1060514-0
COVER ASSY,MOBILE UNIT,
MOLDED,POTTED
Includes 1060116-0

1070625-0
GASKET,WIRELSS COVER

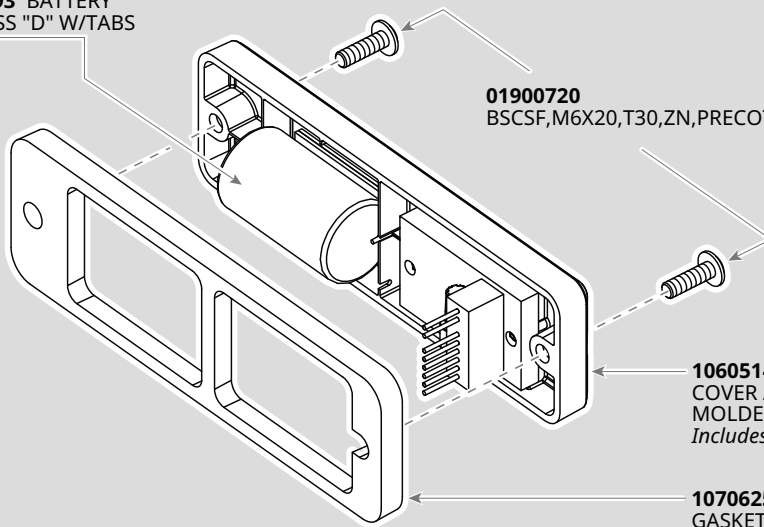

NOTE: drive side may be LH or RH.
LH drive shown.

*X = multiple variations of part number
(Rytec parts representative)*

Motor Override Gears *all doors*

1210799-1 MOTOR COVER MODIFICATION, SPIRAL LP, LH
 1210799-2 MOTOR COVER MODIFICATION, SPIRAL LP, RH
Configured part: requires door serial number to order

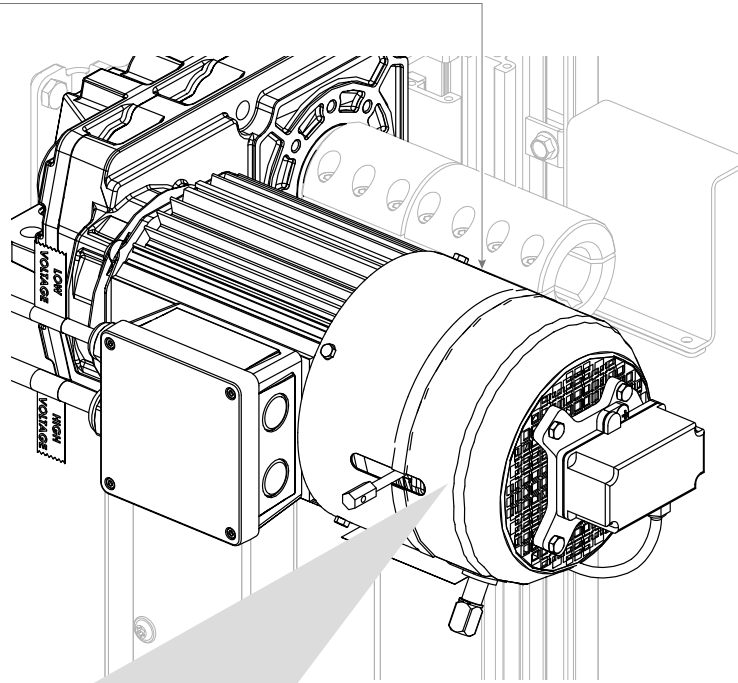

1210797-0204 BRKT, SENSOR, M12 THREAD
Configured part: requires door serial number to order

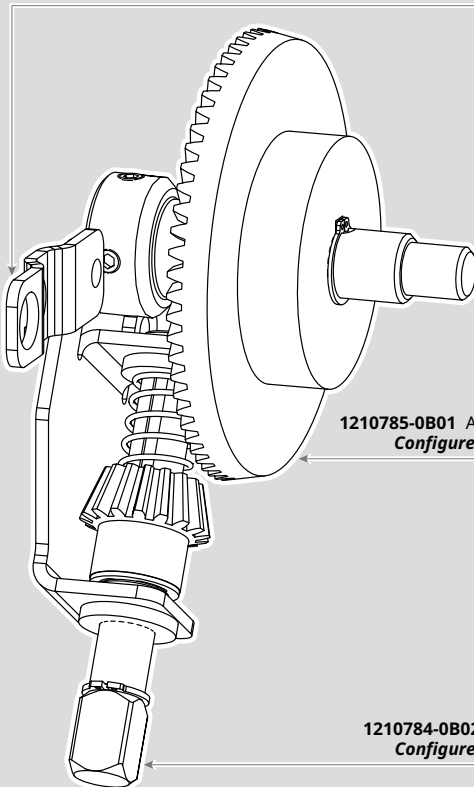

1210785-0B01 ASSY, BEVEL GEAR, SHAFT ADAPTER, 4:1 RATIO
Configured part: requires door serial number to order

1210784-0B02 ASSY, BEVEL GEAR DISCONNECT, 4:1 RATIO
Configured part: requires door serial number to order

NOTE: drive side may be LH or RH.
 LH drive shown.

Expansion Boards *all doors*

00142005 BOARD, COMM EXTENSION,
SYS4, TST RFUX-COM-R

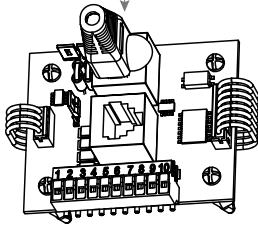

00142014 EXPANSION CARD
WITH I/O & 2 CH LOOP

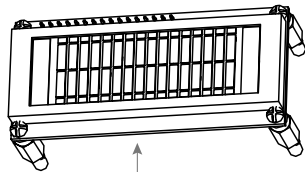
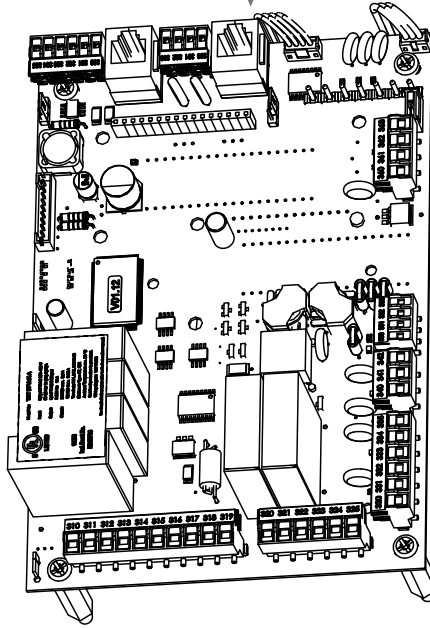

00142008
DISPLAY ONLY, SYS4

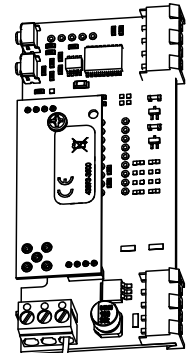

00121045 RC RECEIVER,
24VDC AM, 2 CHANNEL

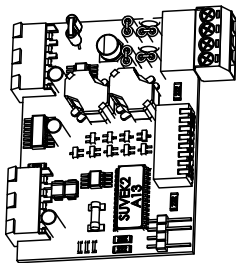

00122000 LOOP DETECTOR
MODULE, 2 CHANNEL, SYS4

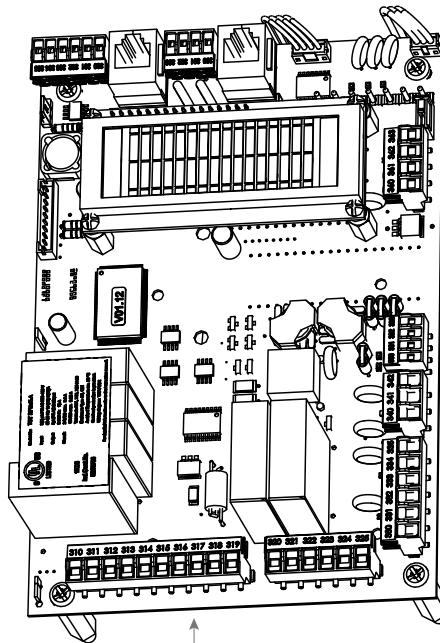

00142190 EXPANSION BOARD
WITH VF DISPLAY NO I/O

SPIRAL[®] LP-S/SP-S LIMITED WARRANTY

Rytec Corporation ("Seller"), an Illinois corporation with its principal place of business at One Cedar Parkway, PO Box 403, Jackson, WI 53037, warrants to the original registered end-user commercial purchaser ("Buyer") that the FlexTec ("Product") sold to the Buyer will be free of defects in materials and workmanship (ordinary wear and tear excepted) for the time periods set forth below:

- **Mechanical components** for a period of Five (5) Years from the date of shipment of the Product from the Seller's plant ("Shipment"). Note: Motor assembly is a mechanical component.
- **Electrical components** for a period of Two (2) Years from Shipment.
- **Standard door panel assemblies, including panel slats, hinge rollers, and hinges** for a period of Two (2) Years from Shipment.
- **Drive pulleys, side column brush/vinyl seals, spring straps, lower tooth pulley assembly, drive & timing belts, energy chain and cable, wireless mobile unit battery,** are considered wear items and are not covered under this Limited Warranty.
- **Aftermarket parts, accessories and assemblies** for a period of ninety (90) days from the date of Shipment.

Remedies

Seller's obligation under this Limited Warranty is limited to repairing or replacing, at Seller's option, any part which is determined by Seller to be defective during the applicable warranty period. Such repair or replacement shall be the Seller's sole obligation and the Buyer's exclusive remedy under this Limited Warranty.

Labor

Except in the case of aftermarket parts, accessories and assemblies, labor is warranted for one year. This means that Seller will provide warranty service without charge for labor in the first year of the warranty period. Thereafter, a charge will apply in to any repair or replacement under this Limited Warranty. In the case of aftermarket parts, accessories and assemblies, Seller will provide replacement parts only.

Claims

Claims under this Limited Warranty must be made (i) within 30 (thirty) days after discovery and (ii) prior to expiration of the applicable warranty period. Claims shall be made in writing delivered to the Seller at the address provided in the first paragraph of this warranty. Buyer must allow Seller and Dealer, or their agents, a reasonable opportunity to inspect any Product claimed to be defective and shall, at Seller's option, either (x) grant Seller and Dealer or their agents access to Buyer's premises for the purpose of repairing or replacing the Product or (y) return of the Product to the Seller, f.o.b. Seller's factory.

Original Buyer

This Limited Warranty is made to the original Buyer of the Product and is not assignable or transferable. This Limited Warranty shall not be altered or amended except in a written instrument signed by Buyer and Seller.

Not Warranted

Seller does not warrant against and is not responsible for, and no implied warranty shall be deemed to cover, damages that result directly or indirectly from: (i) the unauthorized modification or repair of the Product, (ii) damage due to misuse, neglect, accident, failure to provide necessary maintenance, or normal wear and tear of the Product, (iii) failure to follow Seller's instructions for installation, operation or maintenance of the Product, (iv) use of the Product in a manner that is inconsistent with Seller's guidelines or local building codes, (v) movement, settling, distortion, or collapse of the ground, or of improvements to which the Products are affixed, (vi) fire, flood, earthquake, elements of nature or acts of God, riots, civil disorder, war, or any other cause beyond the reasonable control of Seller, (vii) improper handling, storage, abuse, or neglect of the Product by Buyer or by any third party.

DISCLAIMERS

THIS WARRANTY IS EXCLUSIVE AND IN LIEU OF ALL OTHER REPRESENTATIONS AND WARRANTIES, EXPRESS OR IMPLIED, AND THE SELLER EXPRESSLY DISCLAIMS AND EXCLUDES ANY IMPLIED WARRANTIES OF MERCHANTABILITY OR FITNESS FOR PURPOSE. SELLER SHALL NOT BE SUBJECT TO ANY OTHER OBLIGATIONS OR LIABILITIES, WHETHER ARISING OUT OF BREACH OF CONTRACT, WARRANTY, TORT (INCLUDING NEGLIGENCE AND STRICT LIABILITY) OR OTHER THEORIES OF LAW, WITH RESPECT TO THE PRODUCTS SOLD OR SERVICES RENDERED BY THE SELLER, OR ANY UNDERTAKINGS, ACTS, OR OMISSIONS RELATING THERETO.

LIMITATION OF LIABILITY

IN NO EVENT WILL SELLER BE RESPONSIBLE FOR, OR LIABLE TO ANYONE FOR, SPECIAL, INDIRECT, COLLATERAL, PUNITIVE, INCIDENTAL, OR CONSEQUENTIAL DAMAGES, EVEN IF SELLER HAS BEEN ADVISED OF THE POSSIBILITY OF SUCH DAMAGES. Such excluded damages include, but are not limited to, personal injury, damage to property, loss of goodwill, loss of profits, loss of use, cost of cover with any substitute product, interruption of business, or other similar indirect financial loss.

Product Descriptions

Any description of the Products, whether in writing or made orally by the Seller or the Seller's agents, including specifications, samples, models, bulletins, drawings, diagrams, engineering or similar materials used in connection with the Buyer's order, are for the sole purpose of identifying the Product and shall not be construed as an express warranty. Any suggestions by the Seller or the Seller's agents regarding the use, application, or suitability of the Product shall not be construed as an express warranty unless confirmed to be such in writing by the Seller.

Limited Warranty Void

This Limited Warranty shall be void in its entirety if:

- (a) The Product is modified in a manner not approved in writing by Seller; or
- (b) Buyer fails to maintain the Product in accordance with instructions contained in the Owner's Manual for the Product.

© Rytec Corporation 2021v

WARRANTY

Owner's Manual

Spiral LP Doors



Copyright © Free Vector Maps.com



P.O. Box 403
One Cedar Parkway
Jackson, WI 53037

Ph: 262-677-9046
Fx: 262-677-2058

www.rytecdors.com
helpdesk@rytecdors.com

For original Rytec parts

www.rytecparts.com
Parts@rytecdors.com