

9,491 Square Feet  
80 Parking Spots



**4366 Park Drive | Norcross, Georgia 30093**  
**Gwinnett Park – Northeast Atlanta**

### Property Features:

- 9,491 Square Foot Office Building
- Ideal Call Center Facility
- Single Tenant Building
- AT&T Fiber Services
- Route 30 GCT Bus Stop On-Site
- 8.43/1,000 Sq. Ft. Parking Ratio
- Additional Parking Available
- Local Property Management
- Less Developed Census Tract 504.23
- Tax Credits Up to \$3,500.00 per Qualifying New Job to Georgia

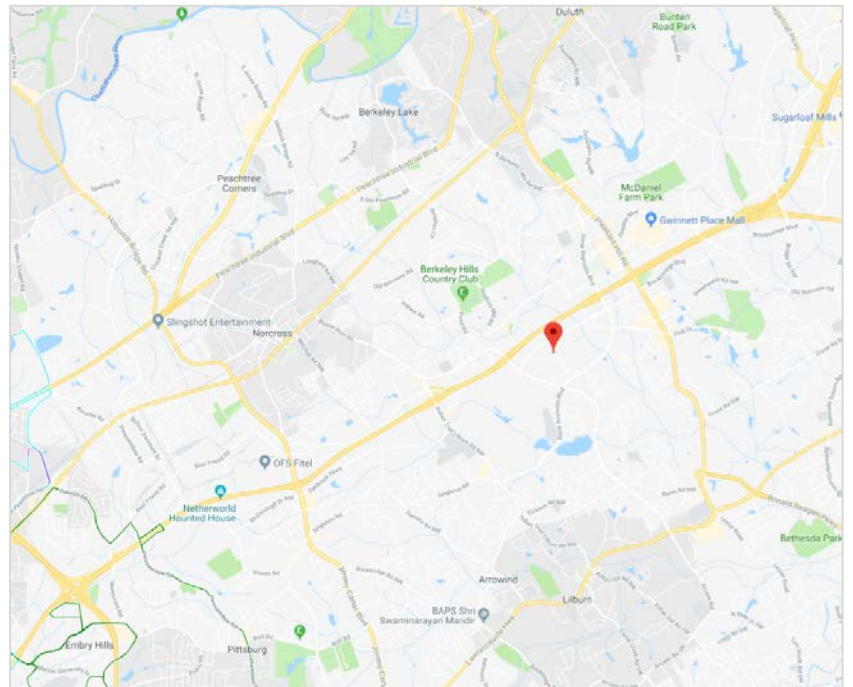

### For More Information, Contact:

Mr. David Nash  
dnash@nashcommercial.com  
404-386-5846



Property Owned &  
Professionally Managed By:



4366 Park Drive  
Norcross, Georgia 30093

9,491 Square Feet  
80 Parking Spots

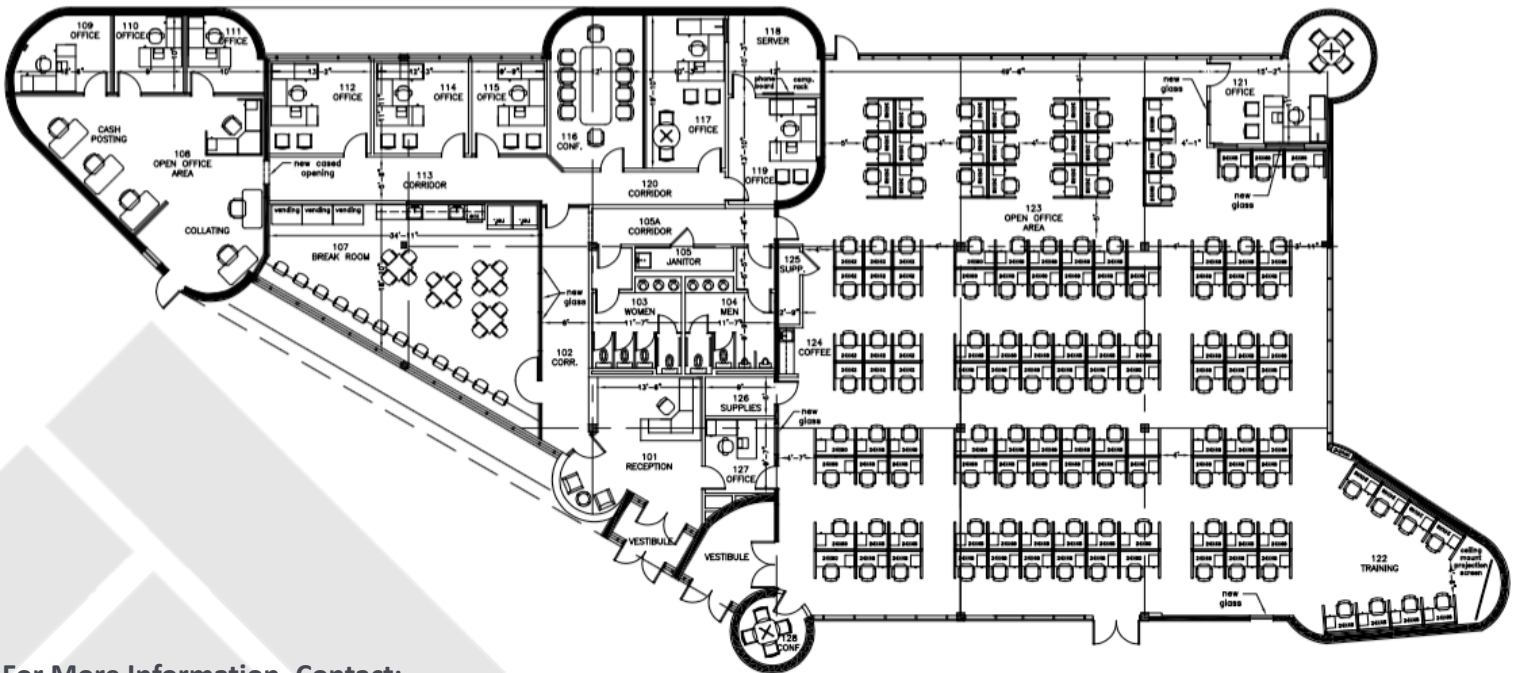

For More Information, Contact:  
Mr. David Nash  
dnash@nashcommercial.com  
404-386-5846

Property Owned &  
Professionally Managed By:

