

Aliante Kite Velox

MECCANISMO DI APERTURA SCORREVOLE SOVRAPPOSTO PER ANTE ARMADIO

OVERLAPPING SLIDING SYSTEM FOR WARDROBES



Aliante

sliding system

- BINARI IN ALLUMINIO ANODIZZATO (NATURALE, BROWN, GOLD)
 - RUOTE: CUSCINETTI RIVESTITI ANTIRUMORE
 - CARRELLI IN ALLUMINIO VERNICIATO
 - COMPONENTI IN MATERIALE PLASTICO + FIBER GLASS
 - PORTATA 85 KG
 - SPESSORI ANTE mm 25 / 30 / 35 / 40 / 50
 - DISTANZA DA TERRA mm 17 / 33
 - LARGHEZZA MINIMA ANTA: mm 530 PER ARMADIO 2/3 ANTE
 - AMMORTIZZAZIONE IN APERTURA E CHIUSURA SU TUTTE LE ANTE
 - FRENO MECCANICO CON TRE FORZE: SUPERLIGHT 15/20 KG , LIGHT 20/45 KG , STANDARD 45/85 KG
- RAIL IN ANODIZED ALUMINIUM (SILVER, BROWN, GOLD)
 - WHEELS: ANTI-NOISE BEARINGS
 - ALUMINIUM TRUCK
 - COMPONENTS IN PLASTIC MATERIAL + FIBER GLASS
 - LOAD CAPACITY 85 KG
 - DOOR'S THICKNESS mm 25 / 30 / 35 / 40 / 50
 - FLOOR'S DISTANCE mm 17 / 33
 - MINIMUM DOOR'S WIDTH: mm 530 FOR WARDROBE 2/3 DOORS
 - SOFT OPENING AND SOFT CLOSING 2/3 DOORS
 - SOFT CLOSING: SUPERLIGHT 15/20 KG , LIGHT 20/45 KG , STANDARD 45/85 KG

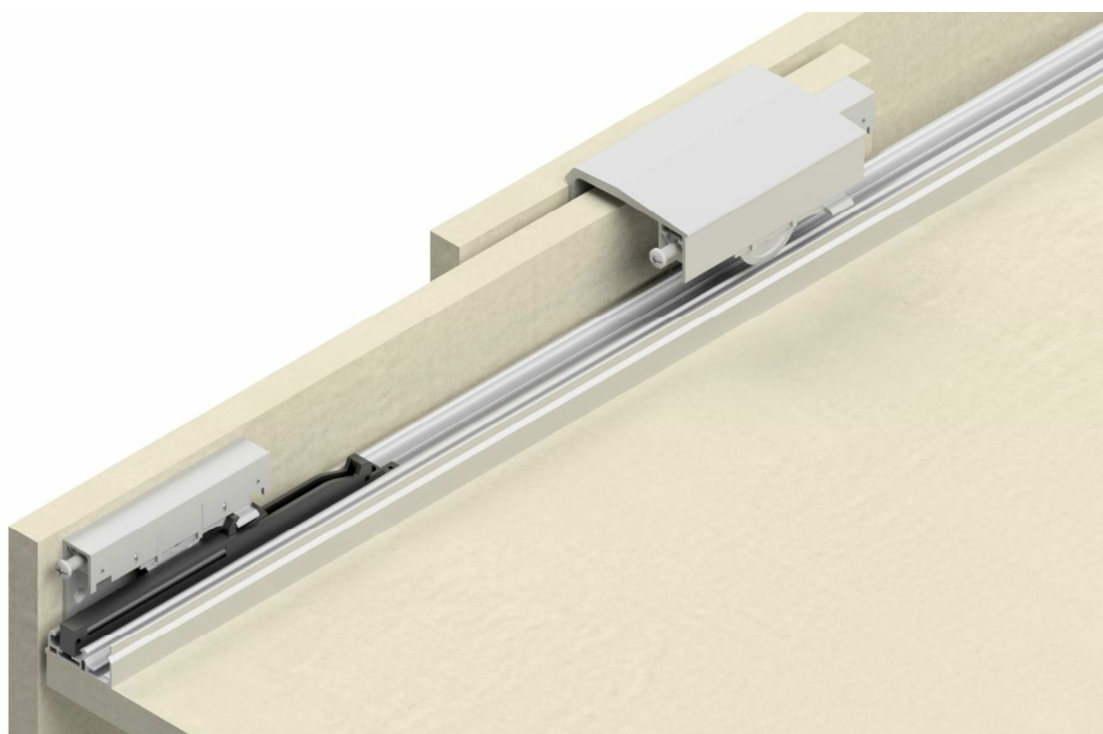

Kite

sliding system + magnetic soft closing

- BINARI IN ALLUMINIO ANODIZZATO (NATURALE, BROWN, GOLD)
- RUOTE: CUSCINETTI RIVESTITI ANTIRUMORE
- CARRELLI IN ALLUMINIO VERNICIATO
- COMPONENTI IN MATERIALE PLASTICO + FIBER GLASS
- PORTATA 85 KG
- SPESSORI ANTE mm 25 / 30 / 35 / 40 / 50
- DISTANZA DA TERRA mm 17 / 33
- LARGHEZZA MINIMA ANTA: mm 530 PER ARMADIO 2/3 ANTE
- AMMORTIZZAZIONE MAGNETICA IN APERTURA E CHIUSURA SU TUTTE LE ANTE
- UNICO FRENO MAGNETICO PER TUTTI I PESI DI ANTE
- RAIL IN ANODIZED ALUMINIUM (SILVER , BROWN , GOLD)
- WHEELS: ANTI-NOISE BEARINGS
- ALUMINIUM TRUCK
- COMPONENTS IN PLASTIC MATERIAL + FIBER GLASS
- LOAD CAPACITY 85 KG
- DOOR'S THICKNESS mm 25 / 30 / 35 / 40 / 50
- FLOOR'S DISTANCE mm 17 / 33
- MINIMUM DOOR'S WIDTH: mm 530 FOR WARDROBE 2/3 DOORS
- MAGNETIC SOFT OPENING AND SOFT CLOSING 2/3 DOORS

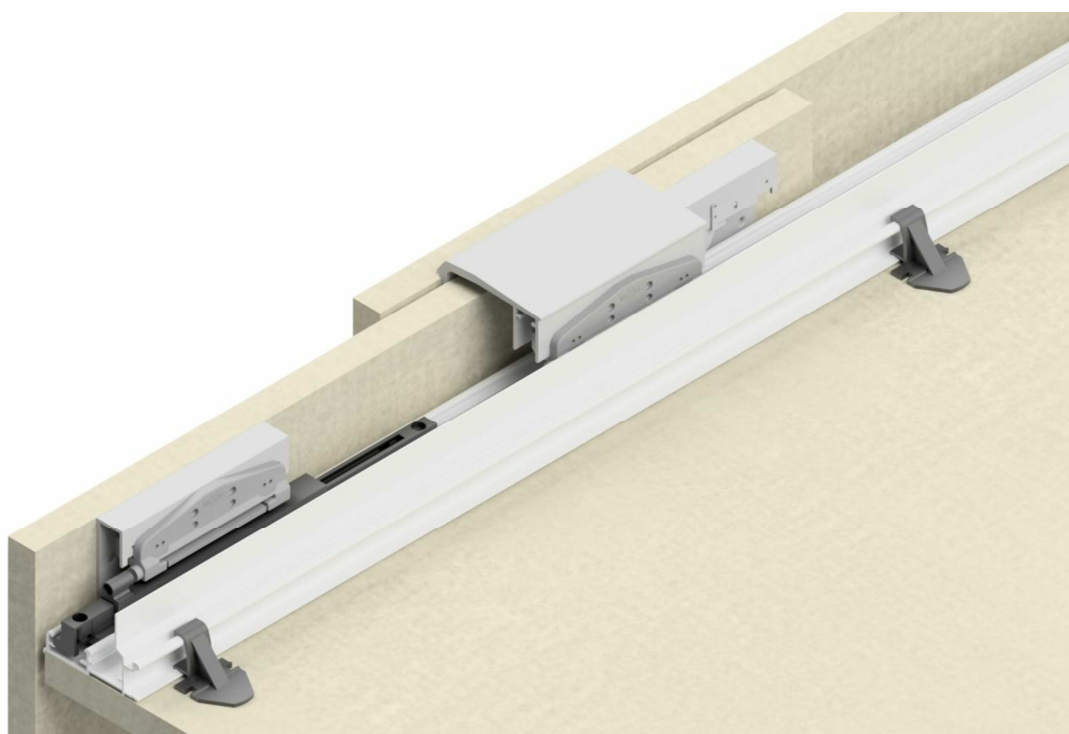

PATENT

Velox Premium

sliding system + DSS - double soft closing system

- BINARI IN ALLUMINIO ANODIZZATO (NATURALE, BROWN, GOLD)
- RUOTE: CUSCINETTI RIVESTITI ANTIRUMORE
- COMPONENTI IN MATERIALE PLASTICO + FIBER GLASS
- PORTATA 85 KG
- CARRELLO UNICO REGOLABILE PER SPESSORI ANTA DA mm 20 A 50
- DISTANZA DA TERRA mm 17 / 33
- REGOLAZIONE FRONTALE +/- mm 3
- **REGOLAZIONE INCLINAZIONE ANTA ESTERNA BREVETTATA**
- LARGHEZZA MINIMA ANTA:
mm 530 PER ARMADIO 2 ANTE
mm 700 PER ARMADIO 3 ANTE
- **AMMORTIZZATORE DSS A DOPPIA FRENATA MODULABILE, REGOLABILE IN FUNZIONE DEL PESO DELL' ANTA BREVETTATO**
- RAIL IN ANODIZED ALUMINIUM (SILVER, BROWN, GOLD)
- WHEELS: ANTI-NOISE BEARINGS
- COMPONENTS IN PLASTIC MATERIAL + FIBER GLASS
- LOAD CAPACITY 85 KG
- ADJUSTABLE TRUCK FOR DOOR'S THICKNESS FROM 20 mm UP TO 50 mm
- FLOOR'S DISTANCE mm 17 / 33
- FRONT REGULATION +/- mm 3
- **PATENTED DOOR'S INCLINATION ADJUSTMENT**
- MINIMUM DOOR'S WIDTH:
mm 530 FOR WARDROBE 2 DOORS
mm 700 FOR WARDROBE 3 DOORS
- **PATENTED DOUBLE BRAKING SHOCK ABSORBER, ADJUSTABLE ACCORDING TO THE DOOR'S WEIGHT**

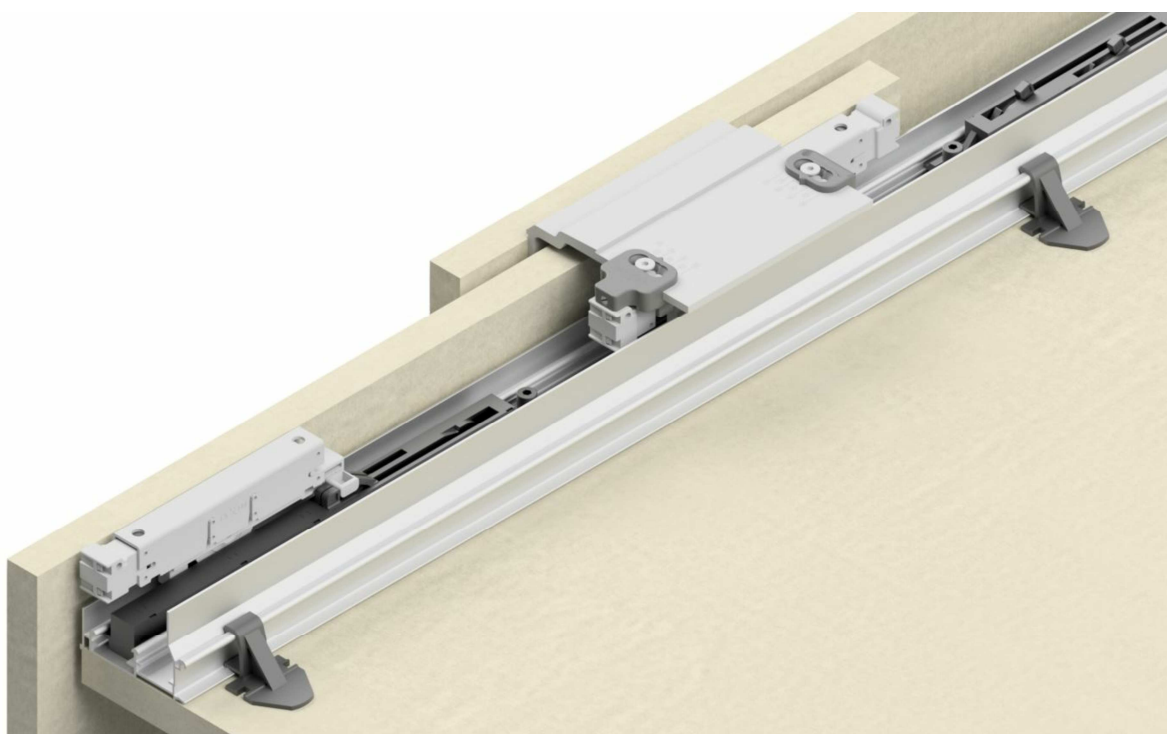

Velox Basic

sliding system +
DSS - double soft closing system

- BINARI IN ALLUMINIO ANODIZZATO (NATURALE, BROWN, GOLD)
 - RUOTE: CUSCINETTI RIVESTITI ANTIRUMORE
 - COMPONENTI IN MATERIALE PLASTICO + FIBER GLASS
 - PORTATA 85 KG
 - SPESSORI ANTE mm 20 / 25 / 30
 - DISTANZA DA TERRA mm 17 / 33
 - REGOLAZIONE FRONTALE +/- mm 3
 - LARGHEZZA MINIMA ANTA:
mm 530 PER ARMADIO 2 ANTE
mm 700 PER ARMADIO 3 ANTE
 - **AMMORTIZZATORE DSS A DOPPIA FRENATA MODULABILE, REGOLABILE IN FUNZIONE DEL PESO DELL' ANTA BREVETTATO**
- RAIL IN ANODIZED ALUMINIUM (SILVER, BROWN, GOLD)
 - WHEELS: ANTI-NOISE BEARINGS
 - COMPONENTS IN PLASTIC MATERIAL + FIBER GLASS
 - LOAD CAPACITY 85 KG
 - DOOR'S THICKNESS mm 20 / 25 / 30
 - FLOOR'S DISTANCE mm 17 / 33
 - FRONT REGULATION +/- mm 3
 - MINIMUM DOOR'S WIDTH:
mm 530 FOR WARDROBE 2 DOORS
mm 700 FOR WARDROBE 3 DOORS
 - **PATENTED DOUBLE BRAKING SHOCK ABSORBER, ADJUSTABLE ACCORDING TO THE DOOR'S WEIGHT**

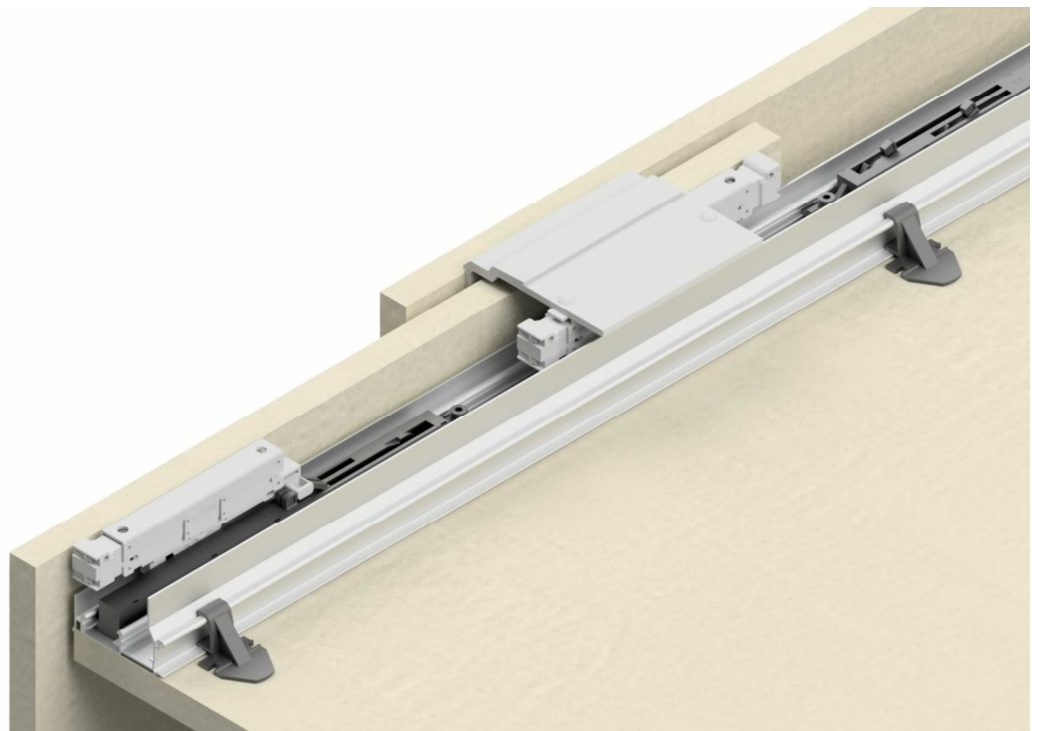

Aliante

BINARIO SUPERIORE
UPPER RAIL
P9000

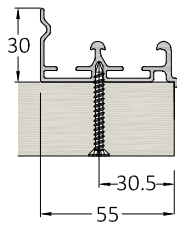

BINARIO SUPERIORE
UPPER RAIL
P9005 + CLIP E30125

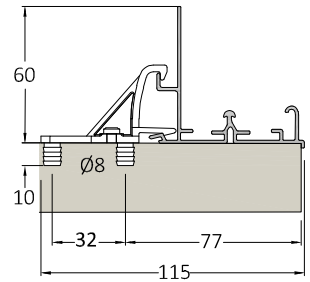

BINARIO SUPERIORE
RINFORZATO
REINFORCED
UPPER RAIL
P9001

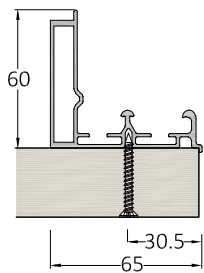

BINARIO SUPERIORE
RINFORZATO
REINFORCED
UPPER RAIL
P9006 + CLIP E30125

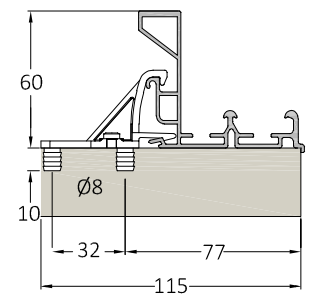

BINARIO INFERIORE
LOWER RAIL
P9050

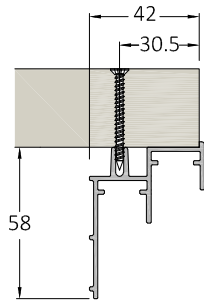

BINARIO INFERIORE
LOWER RAIL
P9053 + CLIP E30126

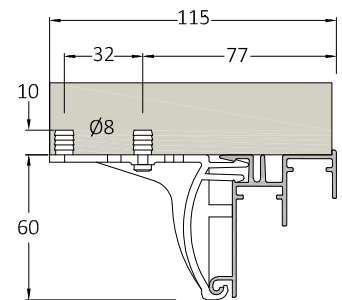

AMMORTIZZATORE
SOFT CLOSING

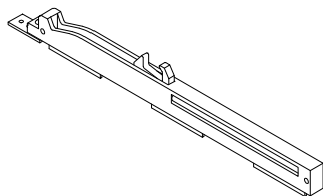

CLIP SUPERIORE
UPPER CLIP
E30125

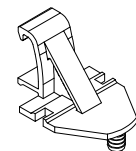

STOPPER INFERIORE
LOWER STOPPER



CLIP INFERIORE
LOWER CLIP
E30126

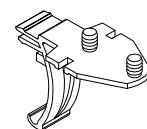

Kite

BINARIO SUPERIORE
UPPER RAIL
P9014 + CLIP E30125

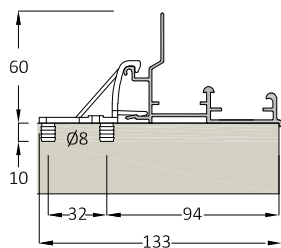

AMMORTIZZATORE MAGNETICO
MAGNETIC SOFT CLOSING

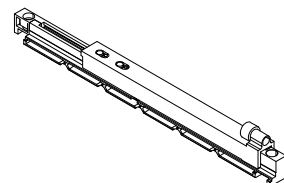

ATTIVATORE MAGNETICO
MAGNETIC ACTIVATOR

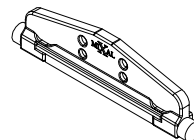

BINARIO INFERIORE
LOWER RAIL
P9053 + CLIP E30126

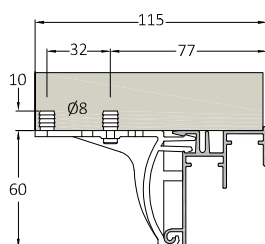

FERMO INFERIORE
LOWER STOPPER



PATENT

Velox

BINARIO SUPERIORE
UPPER RAIL
P9016 + CLIP E30125

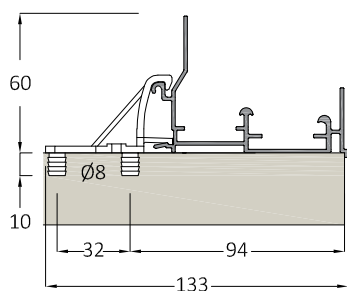

AMMORTIZZATORE DSS
DSS SOFT CLOSING

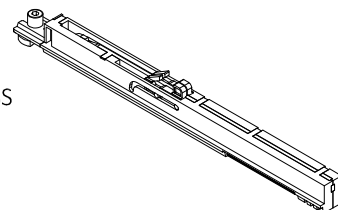

BINARIO INFERIORE
LOWER RAIL
P9053 + CLIP E30126

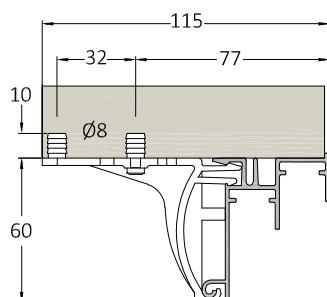

STOPPER INFERIORE
LOWER STOPPER



PATENT

SCHEMA FORATURA ANTE - DOORS DRILLING

A = Ø 8 X 10 mm
B = Ø 3 mm
X = 41 mm + SP
Y = 88 mm + SP

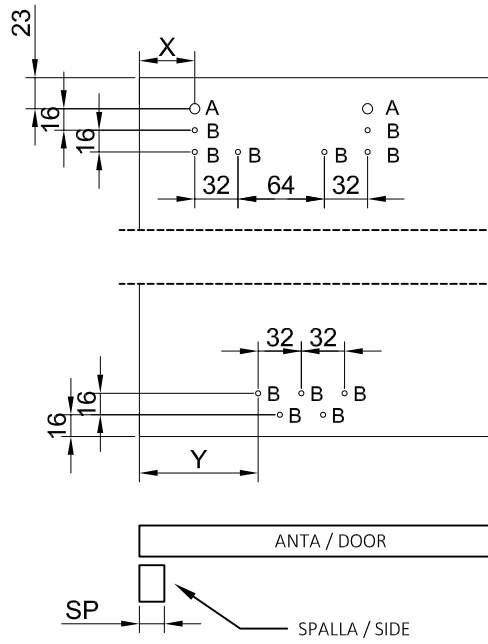

POSIZIONAMENTO FRENI - SOFT POSITION
 ALIANTE - VELOX

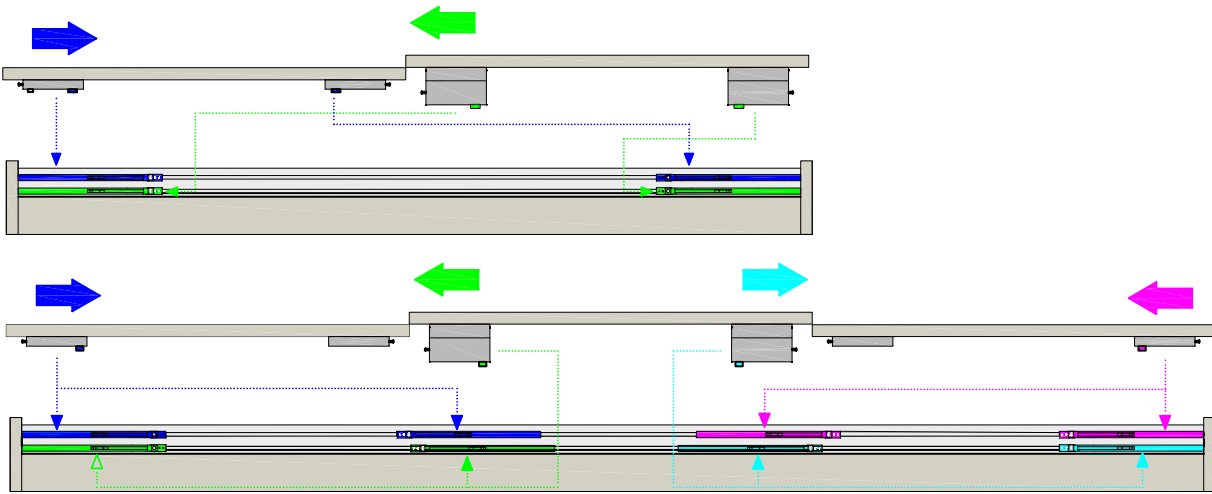

KITE

