

CHAMELEON

LOA 10'4"
BEAM 4'2"
SAIL AREA 50 sq
HULL WT. ~100 LBS.
MOTOR 2-4 H.P.
NESTED DIMENSIONS -
5'4" x 4'2" x 1'8"

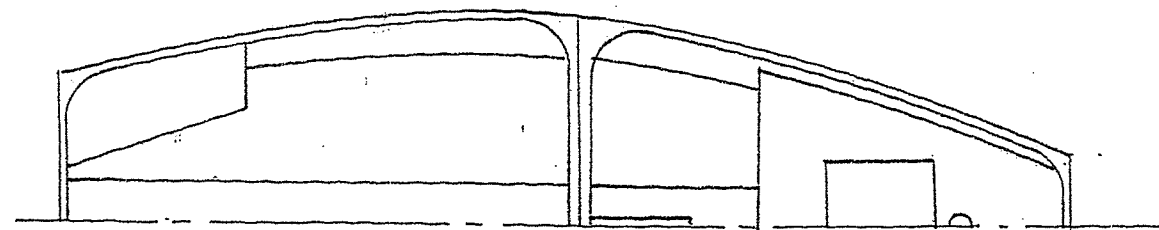
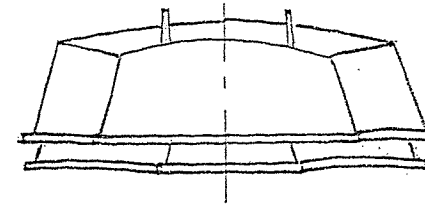
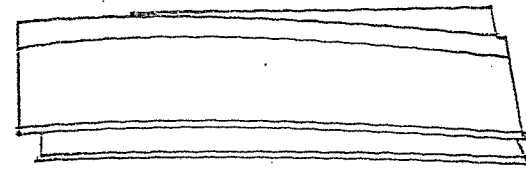
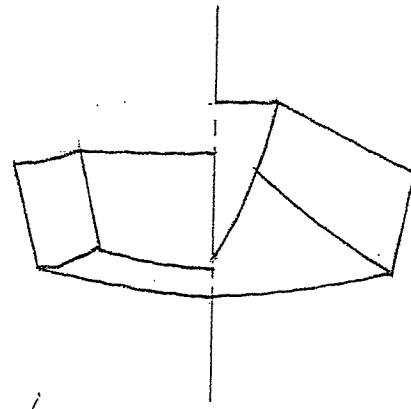
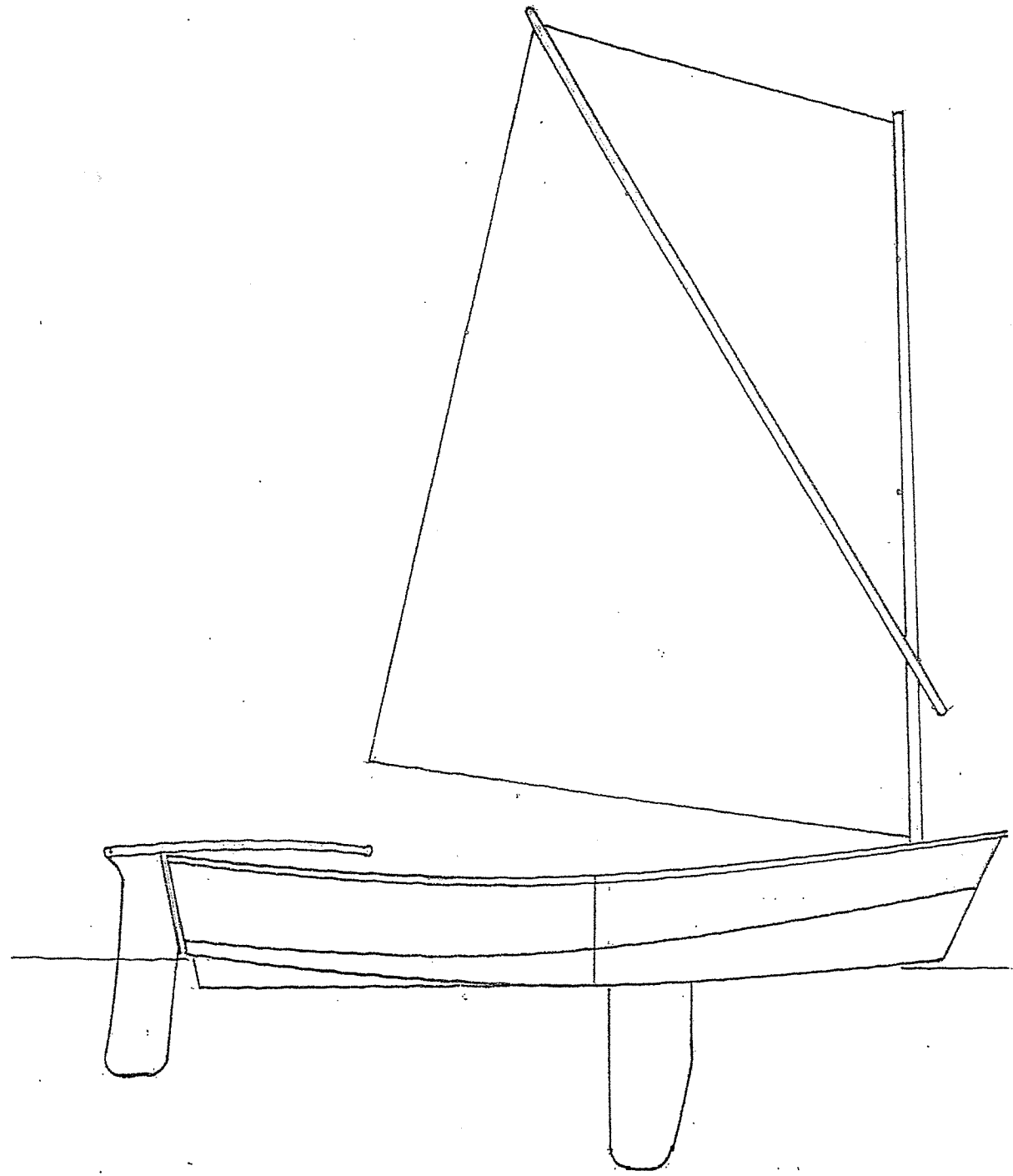

1/2" = 1'0"

DANNY GREENE
OFFSHORE DESIGN LTD.
PO BOX GE 213
ST. GEORGE'S, BERMUUDA
GE BX

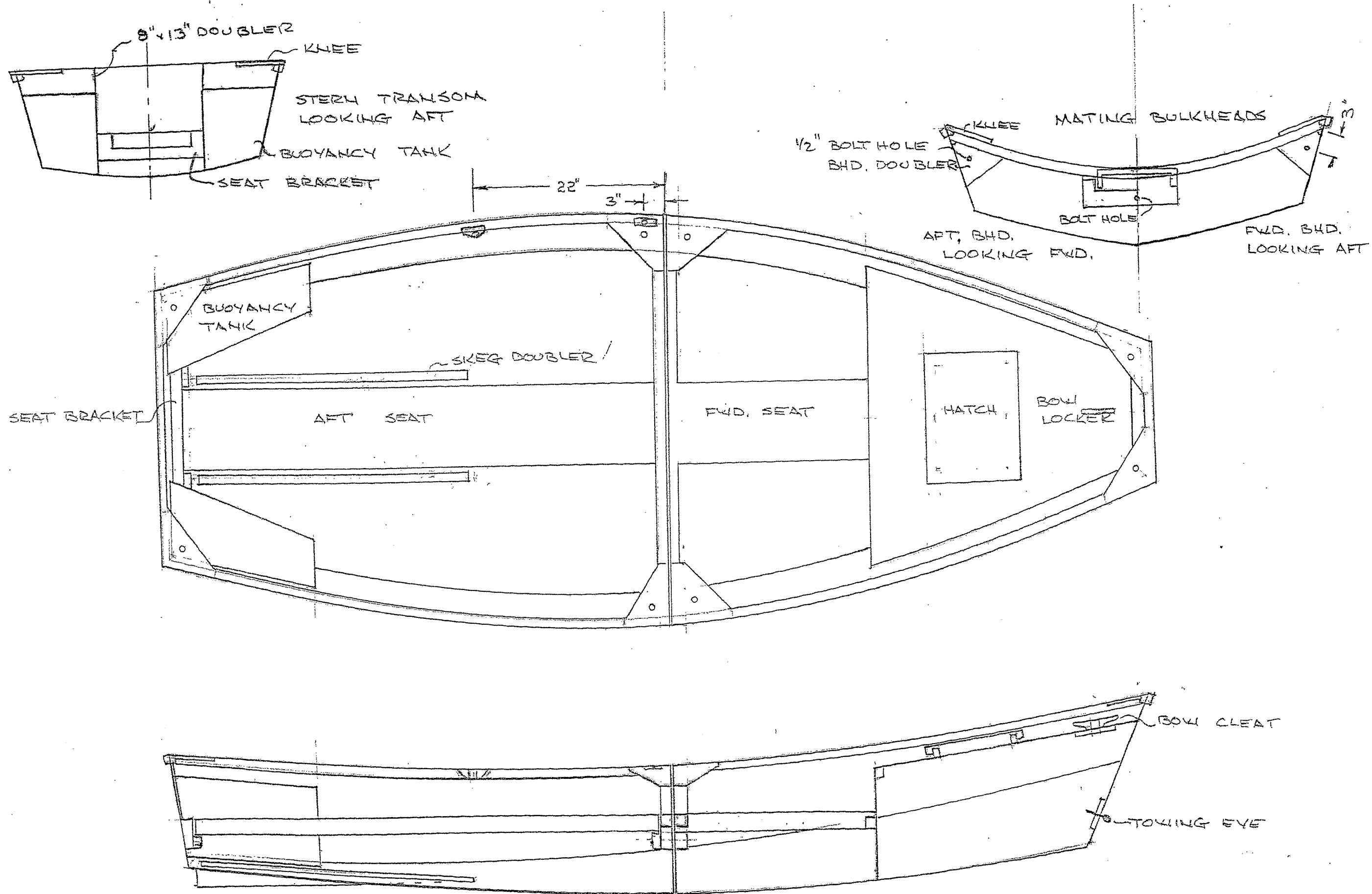

CONSTRUCTION
 PLAN
 1" = 10"

CHAMELEON
 DANNY GREENE/OFFSHORE DESIGN LTD.
 PO BOX 254
 CADET BERMUDA RB BK

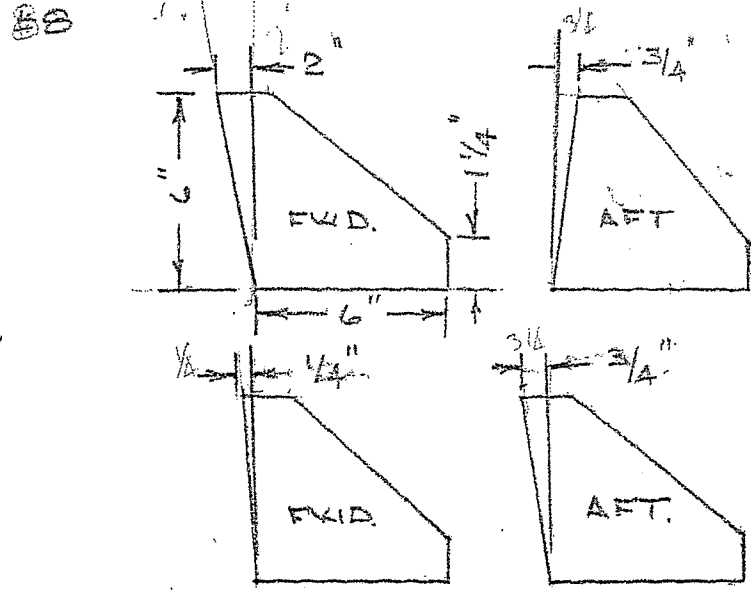
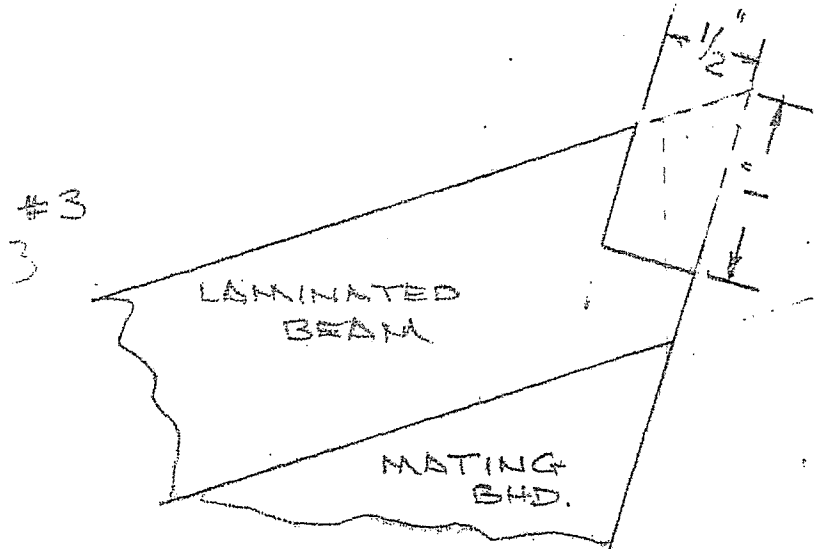
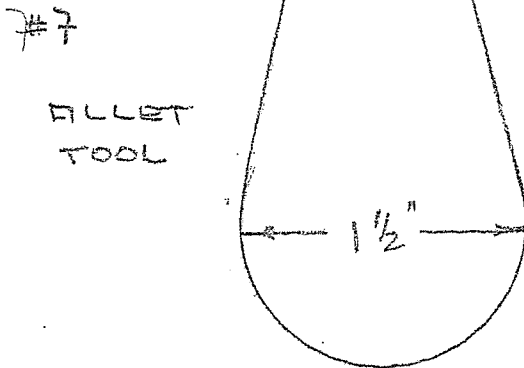
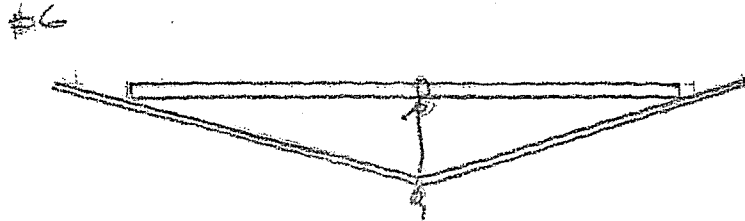
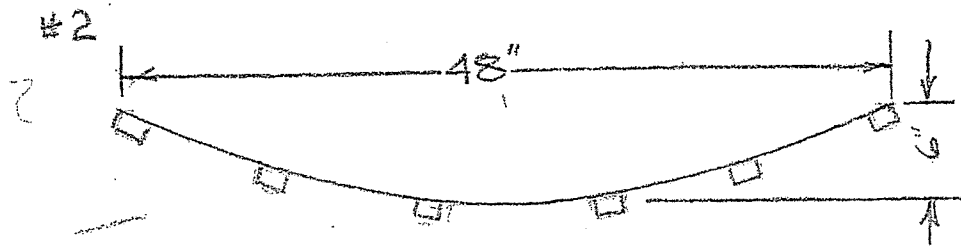
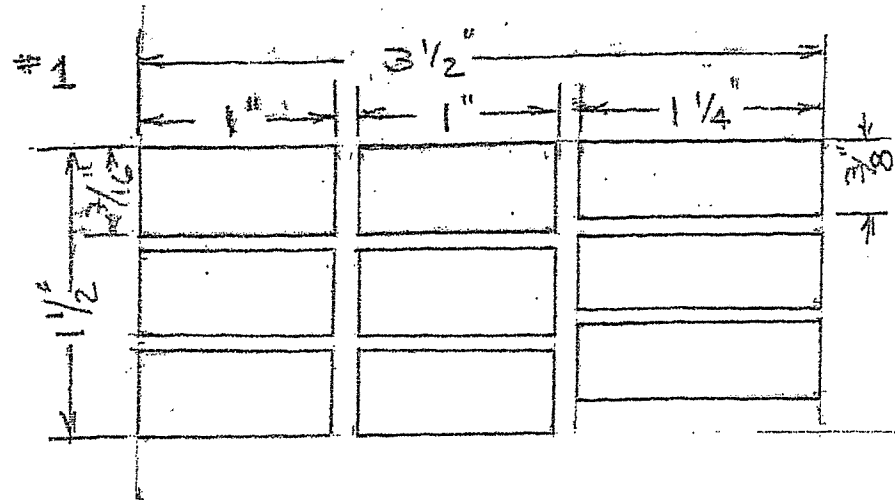

FWD SECTION

AFT SECTION

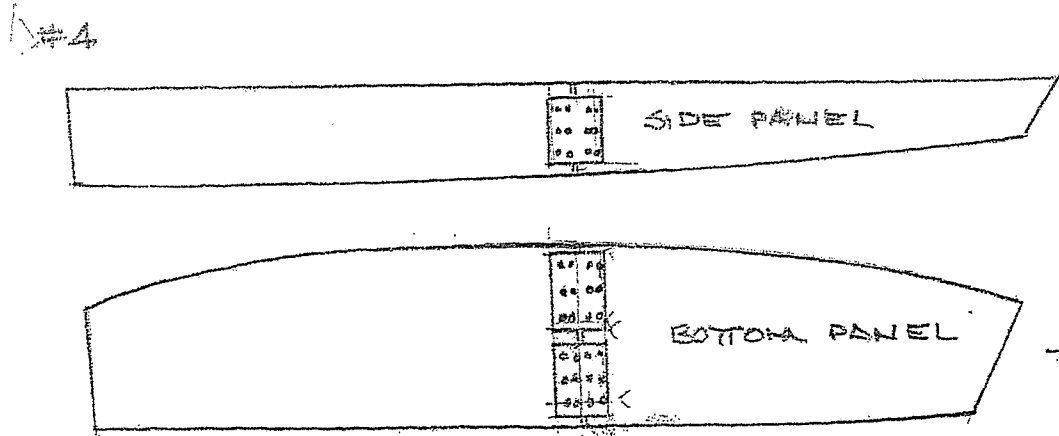

#9

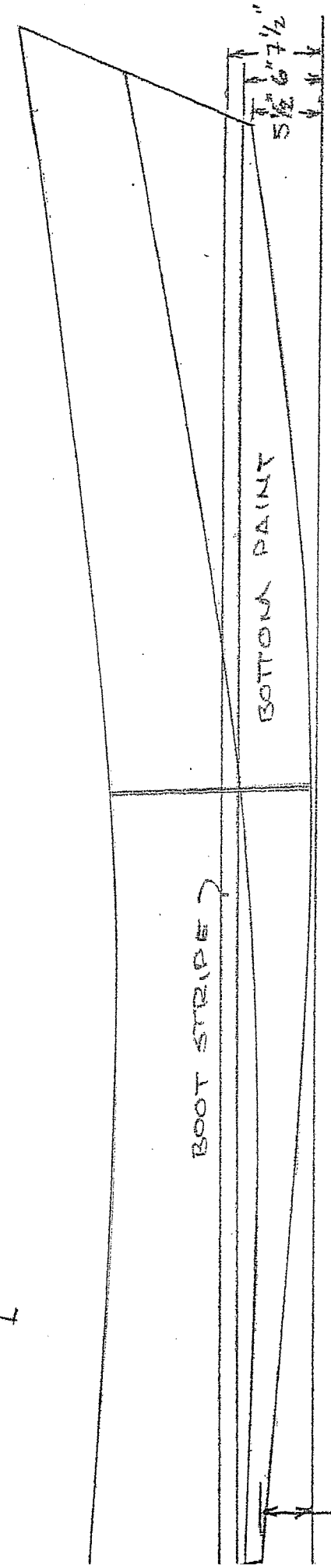

CHAMELEON CONSTRUCTION DETAILS.

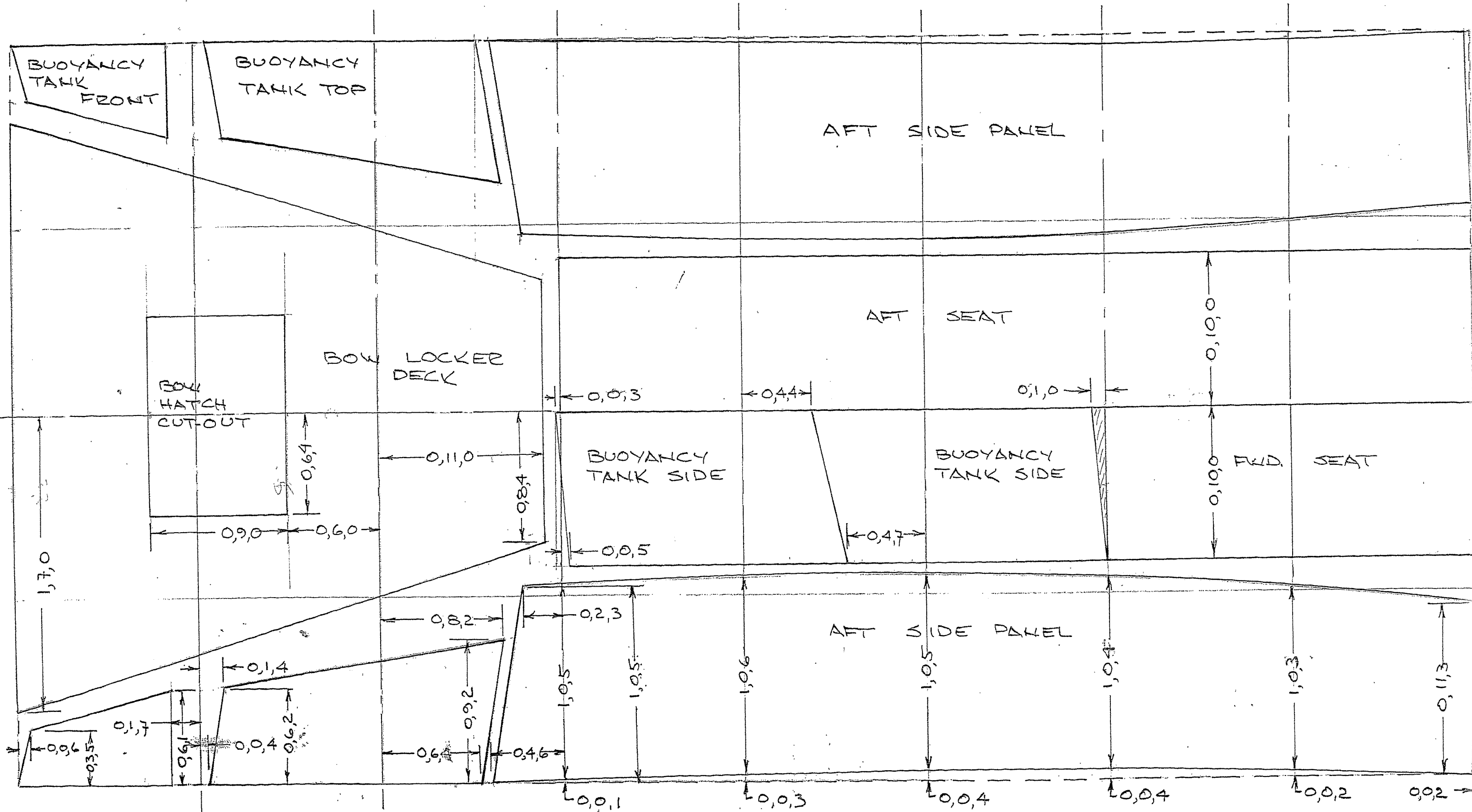

DIMENSIONS IN FEET, INCHES, EIGHTHS

CHAMELEON
PLYWOOD LAYOUT #3

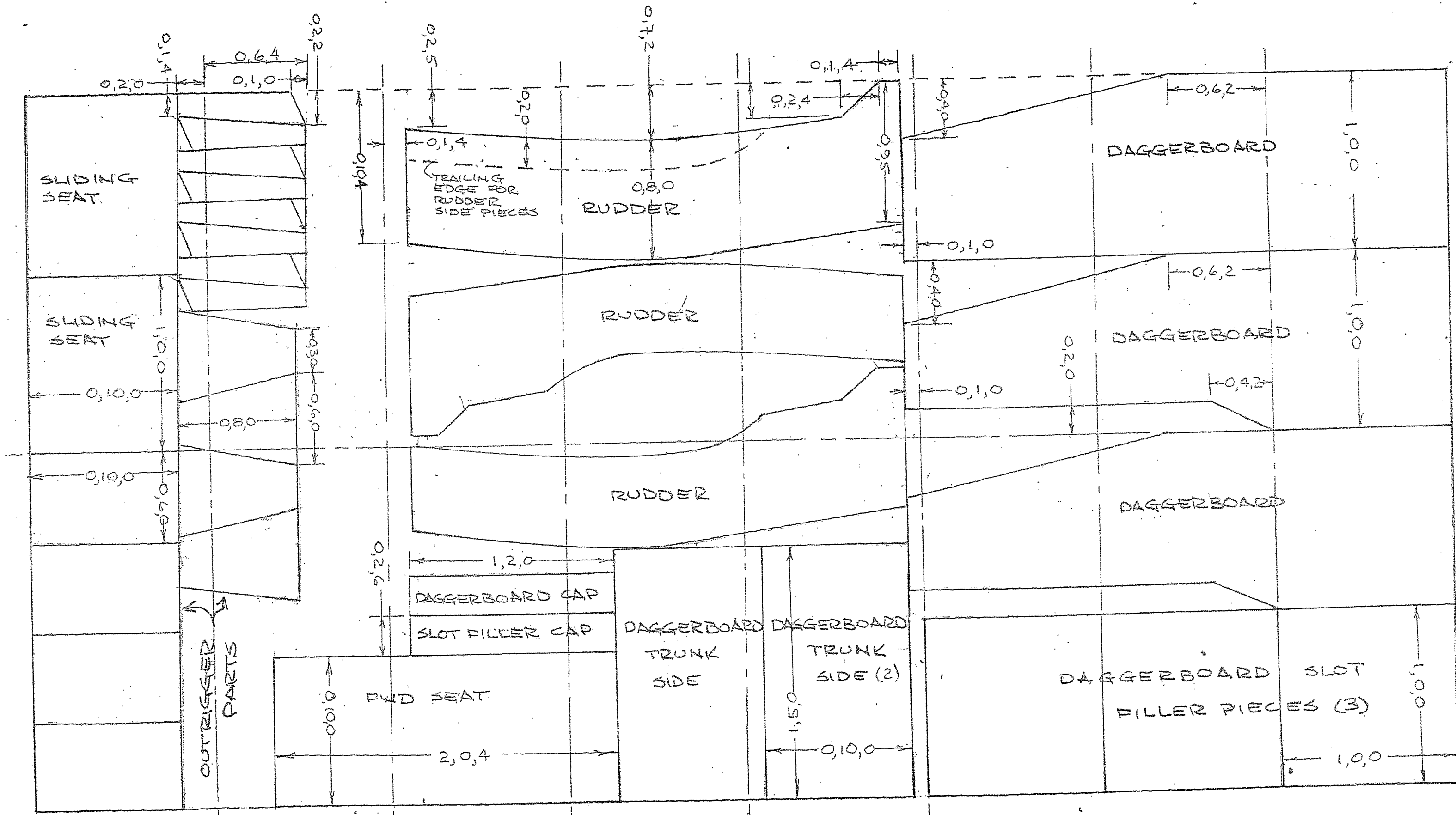

DIMENSIONS IN FEET, INCHES, EIGHTHS

CHAMELEON
 PLYWOOD LAYOUT #4 (SAILING VERSION)
 2 1/2" = 1" 0"

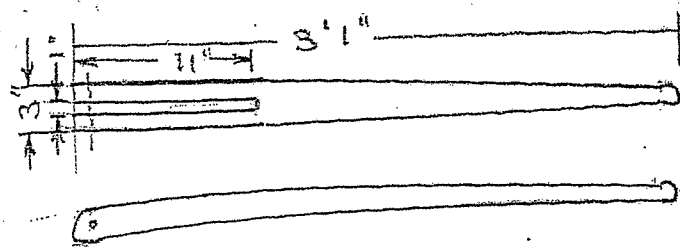

TILLER

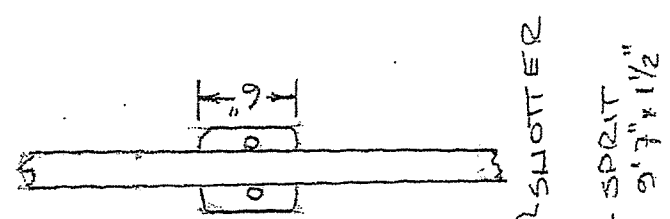

SPRIT
9 7/8" x 1 1/2"

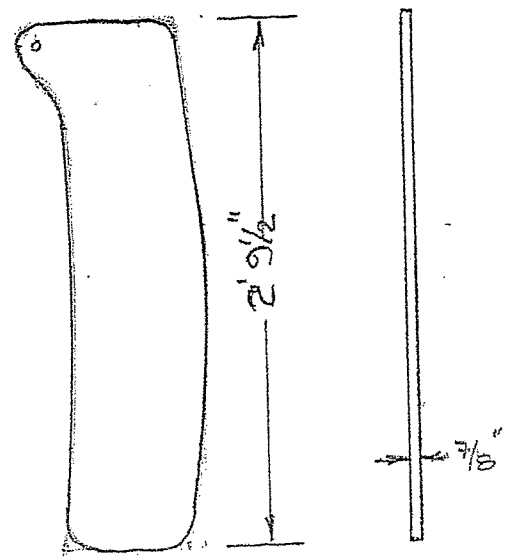

RUDDER

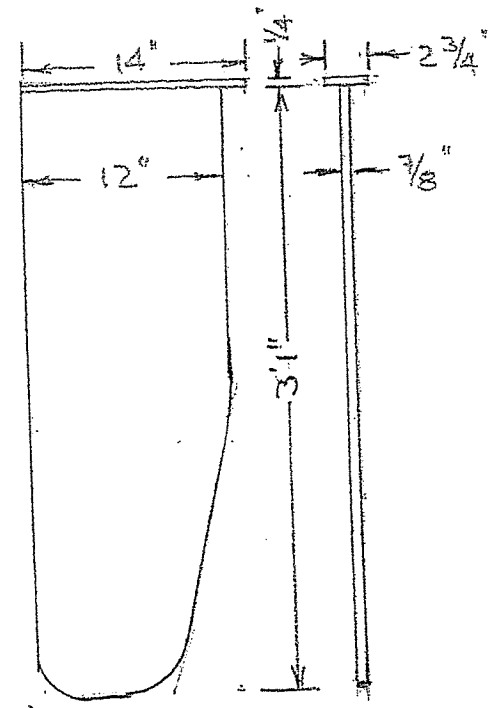

DAGGERBOARD

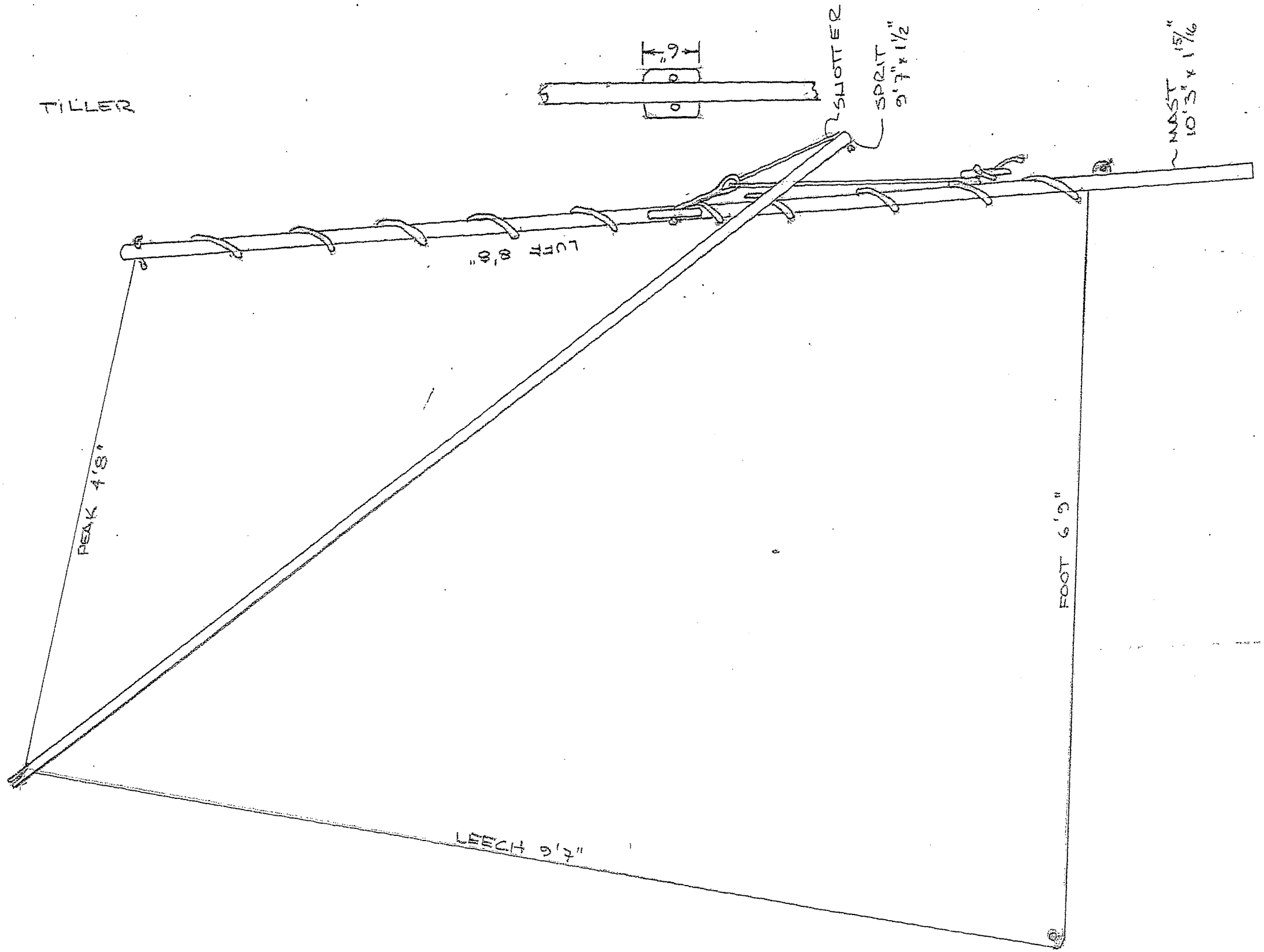

CHAMELEON
SAIL, SPARS, DAGGERBOARD
& RUDDER
1" = 10"

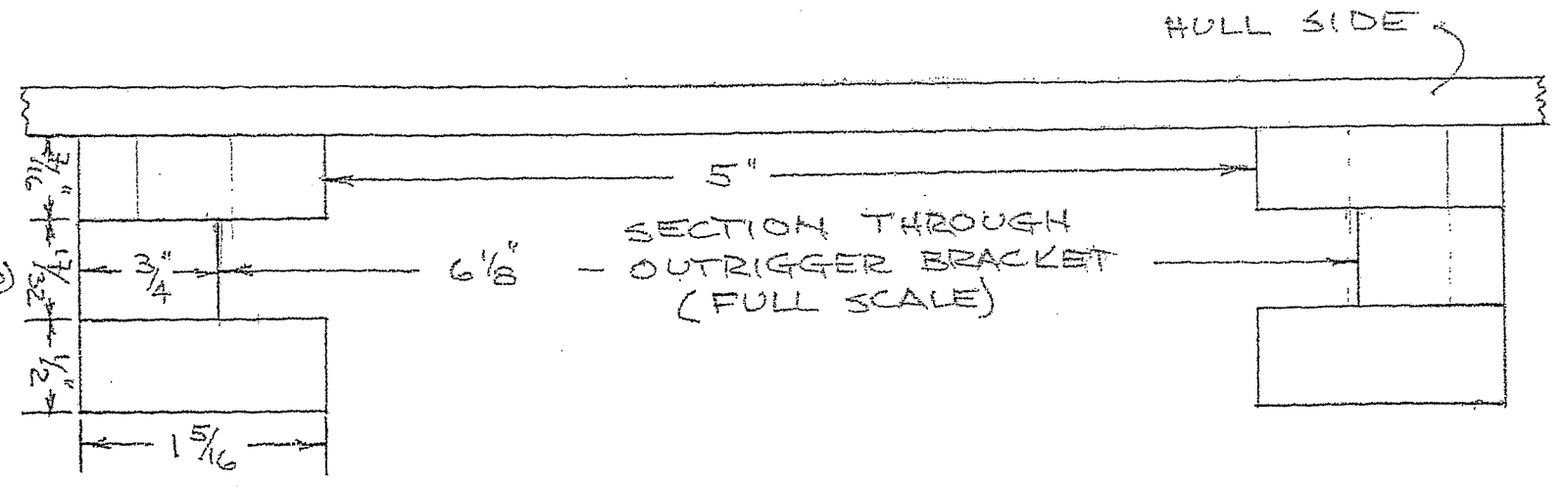
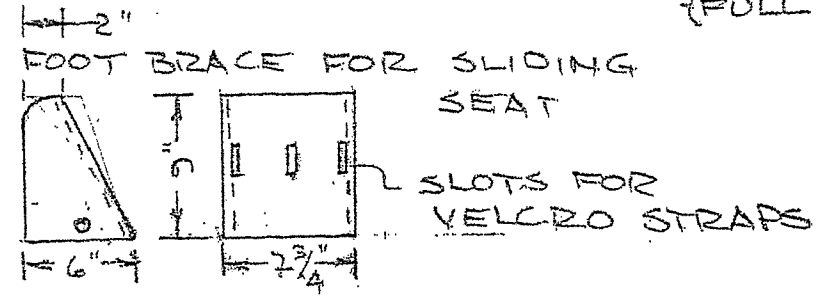
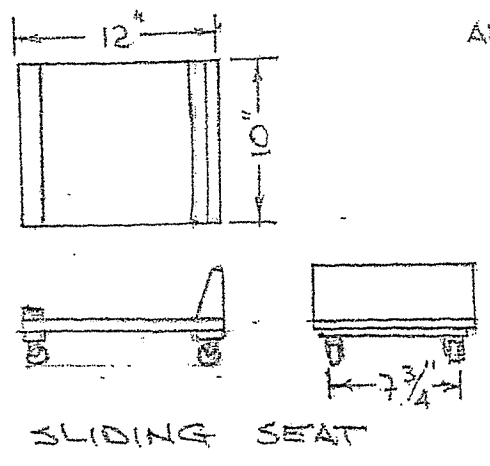
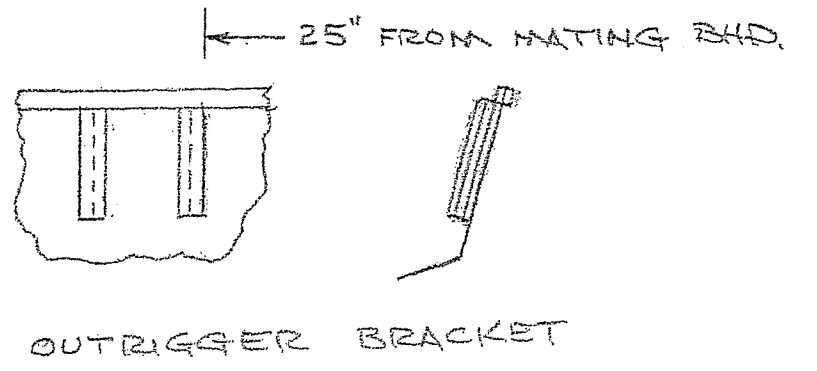
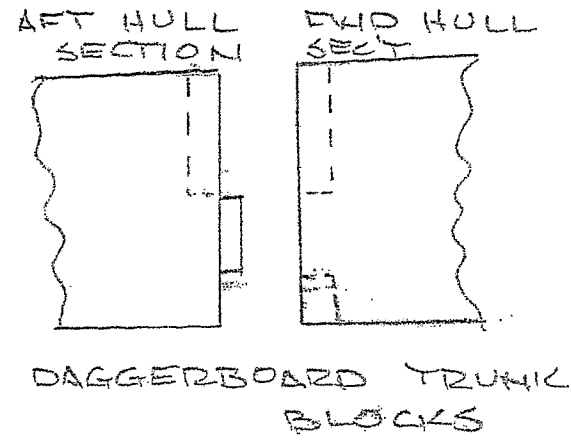
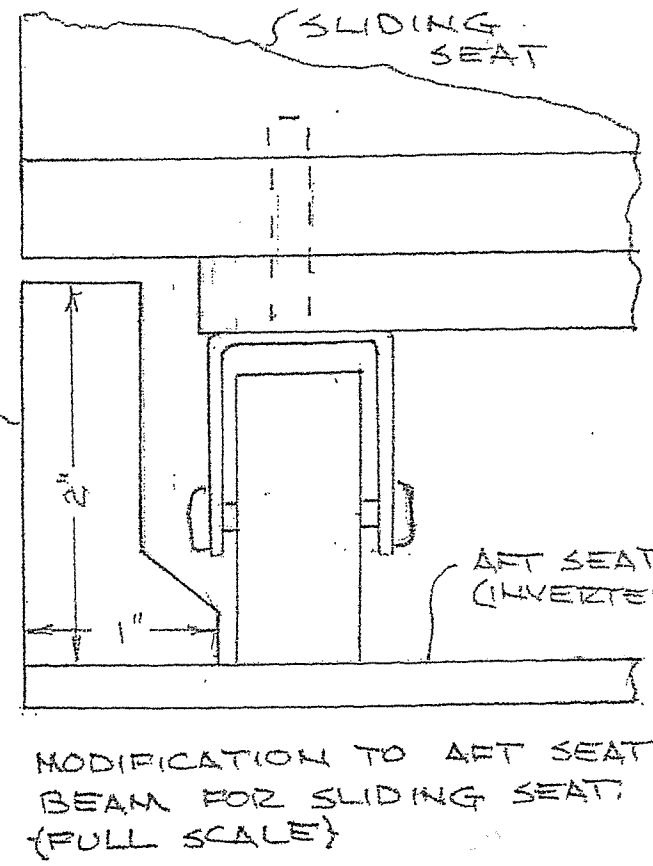
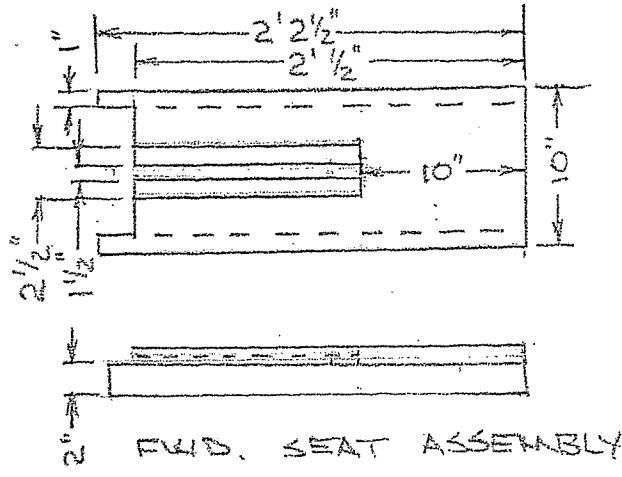
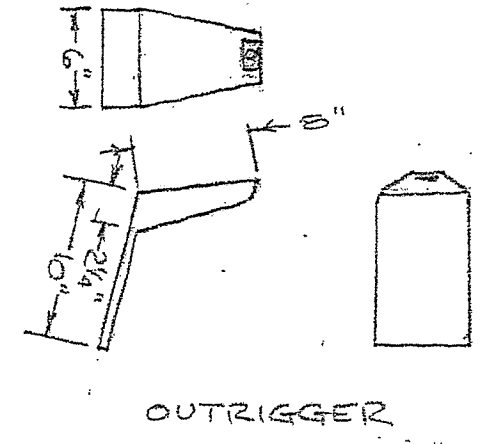
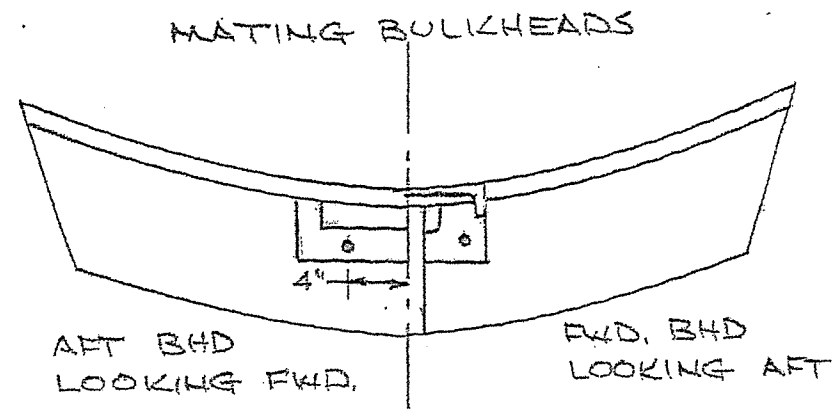
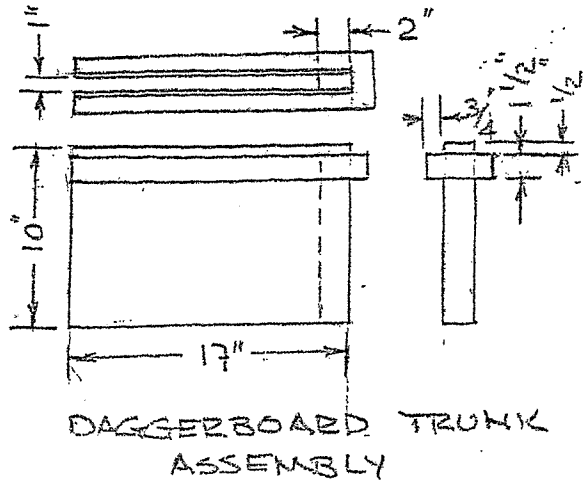

CHAMELEON
 DETAILS FOR SAILING &
 SLIDING SEAT VERSIONS
 1" = 1'0" (EXCEPT AS NOTED)

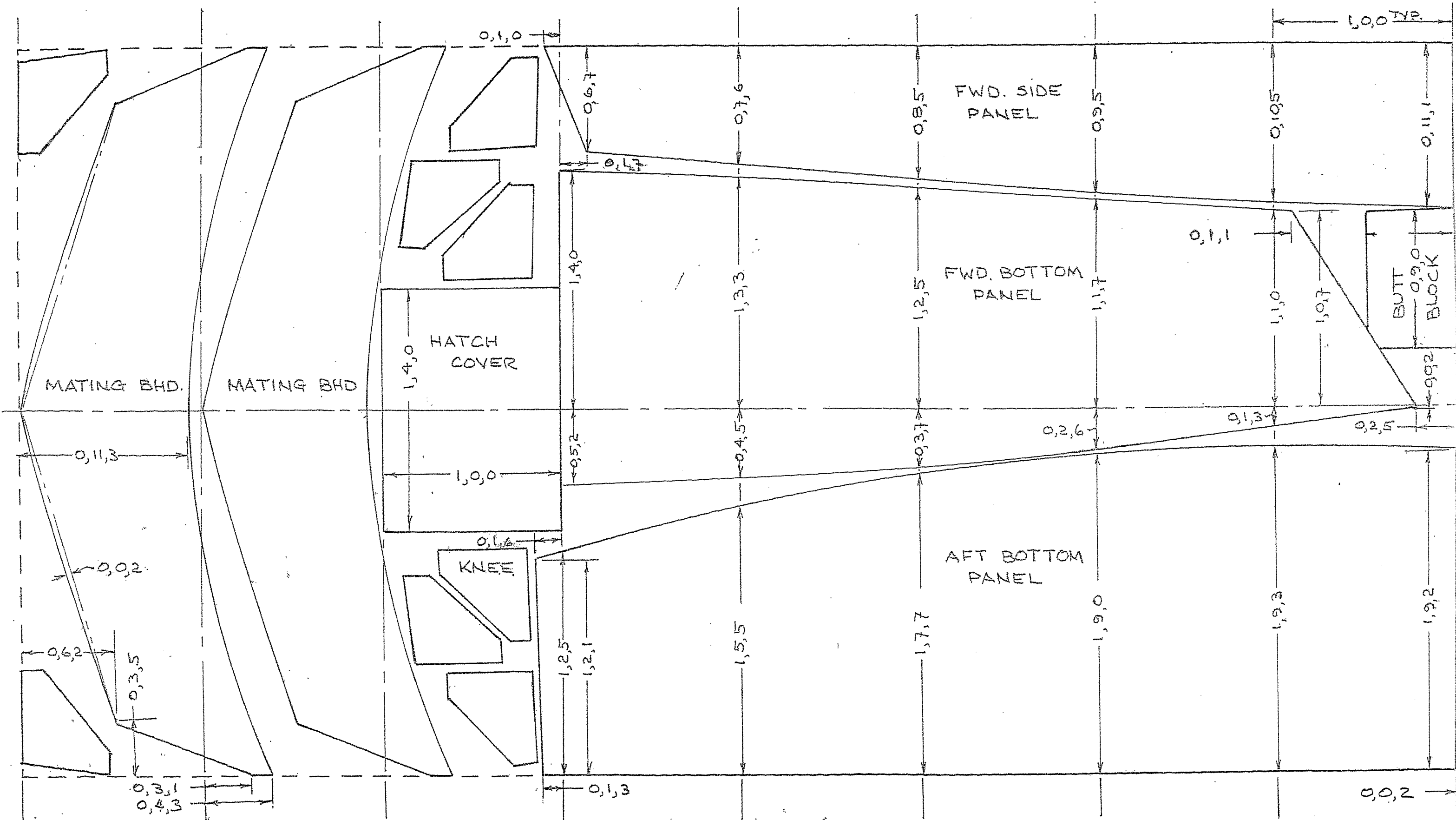

DIMENSIONS IN FEET, INCHES, EIGHTHS

CHAMELEON
 PLYWOOD LAYOUT #1
 2" = 1'0"

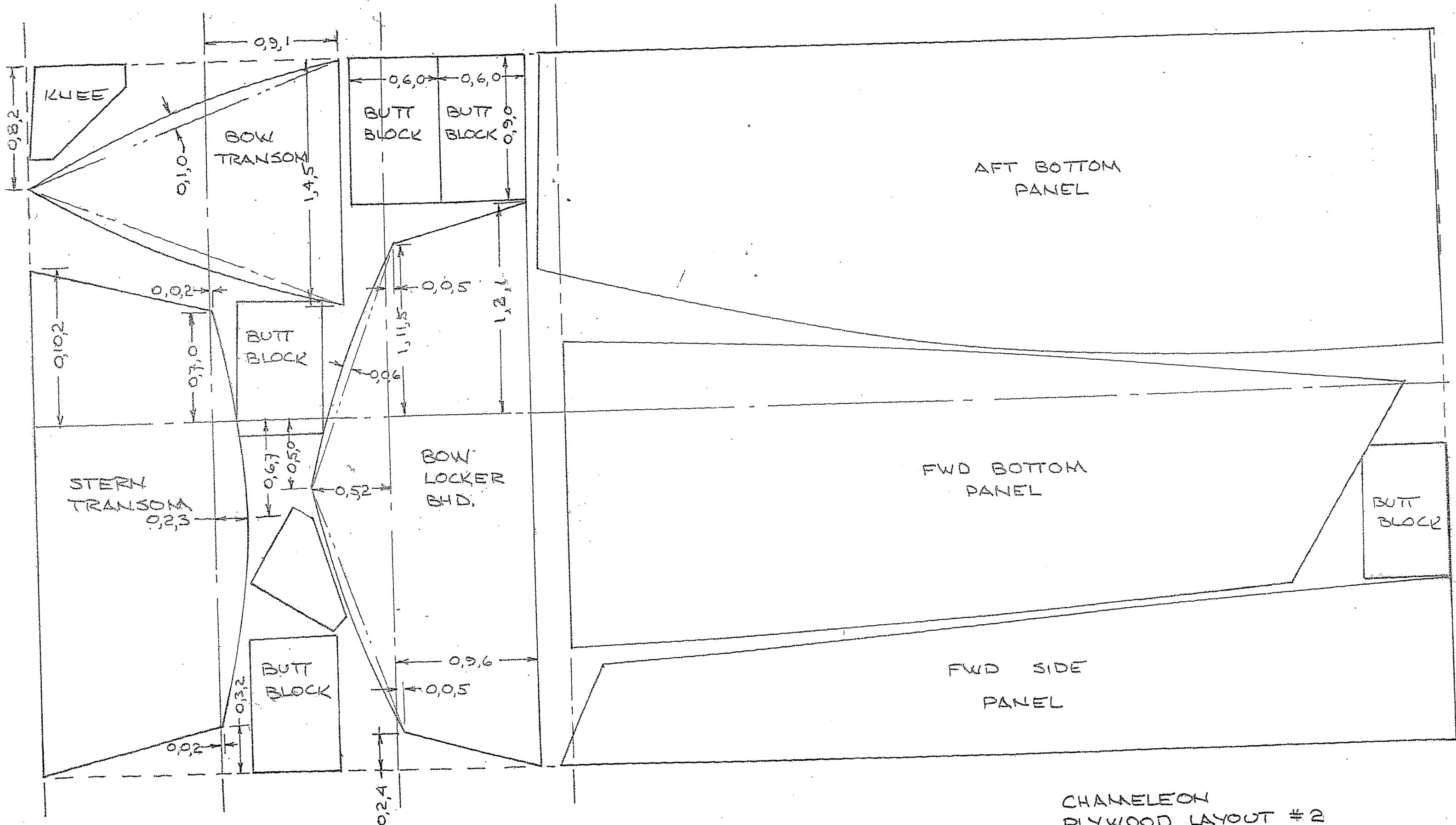

DIMENSIONS IN FEET, INCHES, EIGHTHS

CHAMELEON
 PLYWOOD LAYOUT #2
 2" = 1'0"