



Marquee/Specialty 2+2 Decorative Strip Lights

Custom lighting
for architects
and designers



Airey-Thompson's 2+2 marquee strip lights provide design flexibility unequaled in the lighting industry. The 2+2 is a custom series which allows you to specify accent lighting conforming to your exact design requirements. These could be straight runs, framed mirrors, perimeter outlines, grids, curves or various other design possibilities.

CONSTRUCTION: Made from extruded anodized aluminum. No exposed screws or fasteners

LAMPING: For medium base LED or incandescent lamps

FINISH: Satin anodized, polished or polished gold finishes are standard finish options, custom colors available

LISTINGS: 2+2 fixtures can be ordered UL listed for wet locations. UL Listed for damp location standard.

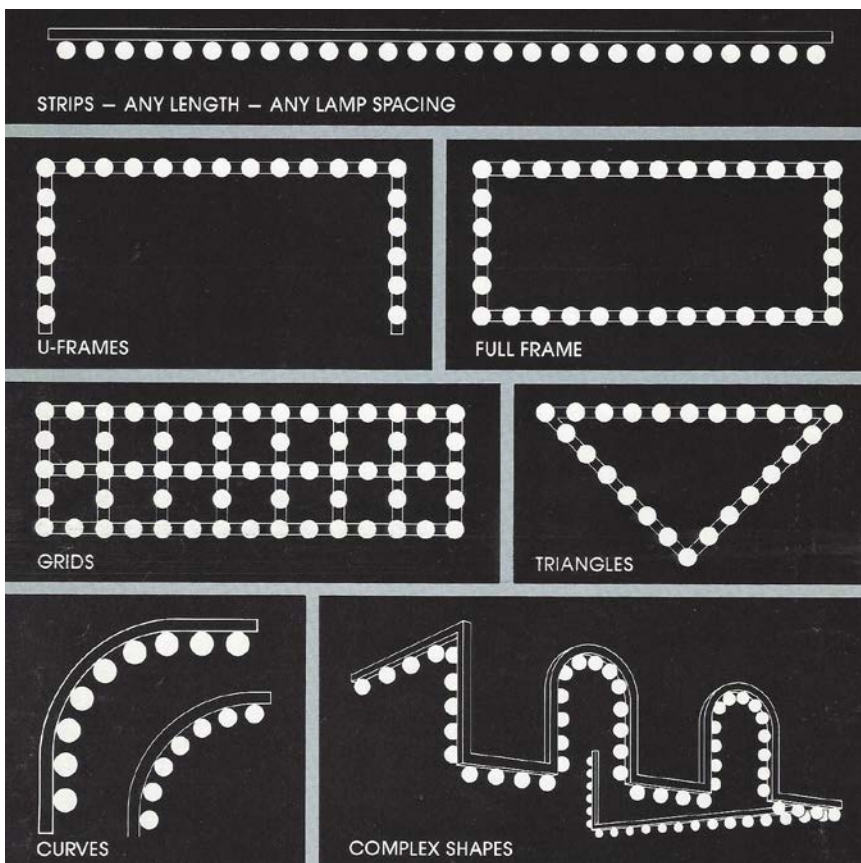

Theater Dressing Room Make-up Mirror Lighting



HEX
Lamp
Guard

*Beautiful
Hollywood Style*

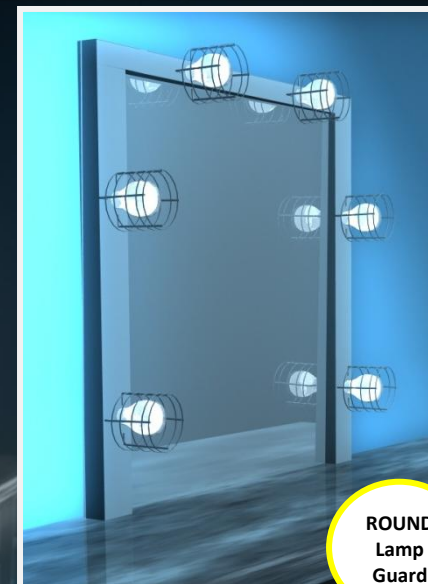

ROUND
Lamp
Guard

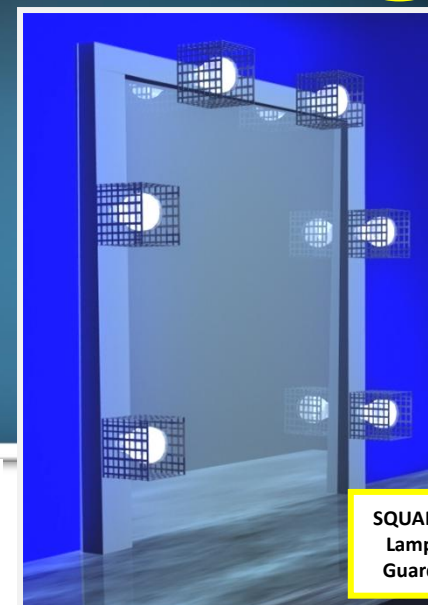

SQUARE
Lamp
Guard

2+2 or SLC Decorative Strip Lights

Transforms any dressing room befitting a star! Custom built in any configuration.

You're the director and our supporting cast of engineers will work with any design, special lengths, miters, lamp spacing and curving. Extruded aluminum with satin, polished aluminum or polished gold finish standard, custom finishes available upon special request.

3 styles of lamp guards are available. Hex, Round and Square

See lamp guard information page for information.

Ideal for use with screw base LED high C.R.I. energy efficient alternate to incandescent lamps.

Specifications at Dressing Room / Marquee
Products tab www.airey-thompson.com



AIREY-THOMPSON™
Manufacturing Quality Luminaires



AIREY-THOMPSON™
Manufacturing Quality Luminaires

2+2 SERIES DECORATIVE STRIP LIGHTS W/ MEDIUM BASE LAMPHOLDERS



Type:

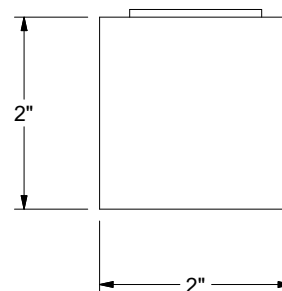

DESCRIPTION

	<u>SATIN ALUMINUM</u>	<u>POLISHED ALUMINUM</u>	<u>POLISHED GOLD</u>
2' FIXTURE, 4 LAMP HOLDERS, 6" O.C.	222060	222061	222062
3' FIXTURE, 6 LAMP HOLDERS, 6" O.C.	223060	223061	223062
4' FIXTURE, 8 LAMP HOLDERS, 6" O.C.	224060	224061	224062
5' FIXTURE, 10 LAMP HOLDERS, 6" O.C.	225060	225061	225062
10' FIXTURE, 20 LAMP HOLDERS, 6" O.C.	220060	220061	220062
2' FIXTURE, 2 LAMP HOLDERS, 12" O.C.	222120	222121	222122
3' FIXTURE, 3 LAMP HOLDERS, 12" O.C.	223120	223121	223122
4' FIXTURE, 4 LAMP HOLDERS, 12" O.C.	224120	224121	224122
5' FIXTURE, 5 LAMP HOLDERS, 12" O.C.	225120	225121	225122
10' FIXTURE, 10 LAMP HOLDERS, 12" O.C.	220120	220121	220122

SPECIFICATIONS

- Extruded aluminum with satin, polished aluminum or polished gold finish standard, custom finishes available upon special request.
- Supplied with flush mounted porcelain medium base lamp holders, lamps by others.
- Fixtures are shipped with blank end caps, for continuous row mounting, simply remove end caps where luminaires meet, and use the internal coupler (provided) to make a seamless link.
- Easy installation and wiring through snap off wiring compartment.
- LED and Incandescent lamps are easily dimmed with standard dimming controls.
- 60 watt max lamps for ceiling mount, 150 watt max for wall mounting or lamp base down mounting.
- Ideal for use with screw base energy efficient LED lamps.
- All units are UL & CUL LISTED damp locations. Optionally available for wet locations.
- Consult factory for special lengths, miters, lamp spacing, curving & layouts,
- On custom length continuous row luminaires lamp centers are adjusted to fit evenly over the length of the fixture.
- Lamp guards are available. See lamp guard sheets for information.



AIREY-THOMPSON™
Manufacturing Quality Luminaires

SL-2+2 SERIES DECORATIVE STRIP LIGHTS W/ MEDIUM BASE LAMP HOLDERS

Type: _____

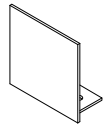

BLANK END

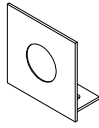

FEED END

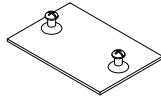

COUPLING

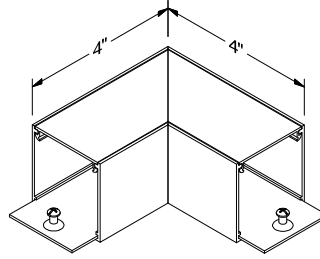

FLAT ELBOW

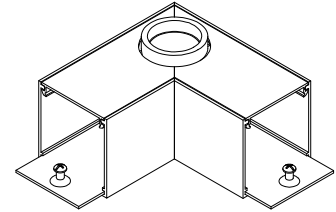

FLAT ELBOW W/ LAMP

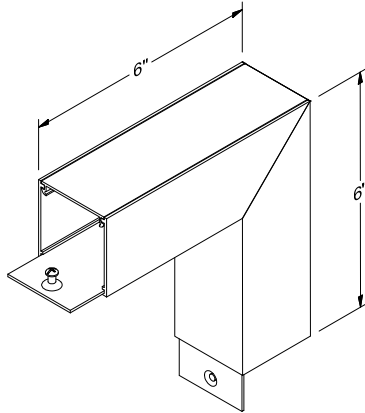

EXTERNAL ELBOW

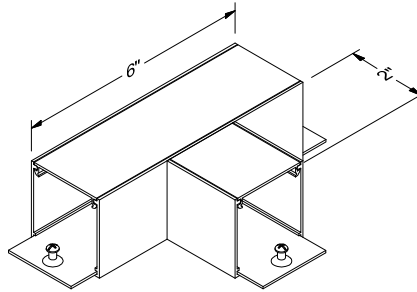

FLAT TEE

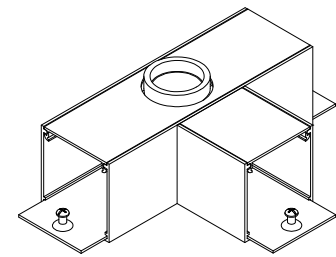

FLAT TEE W/ LAMP

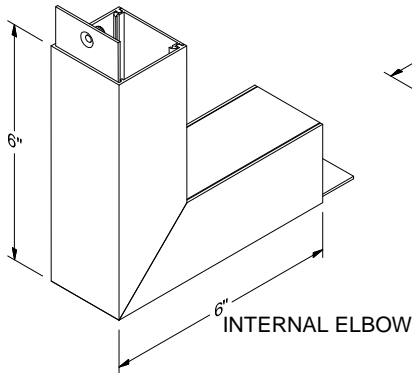

INTERNAL ELBOW

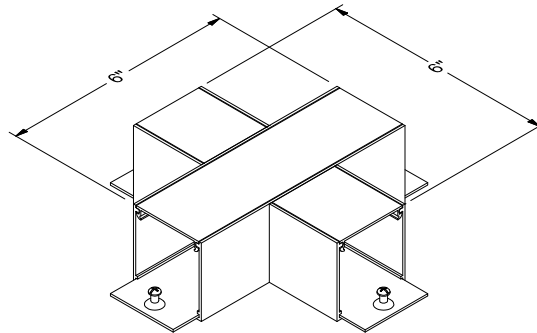

FLAT CROSS

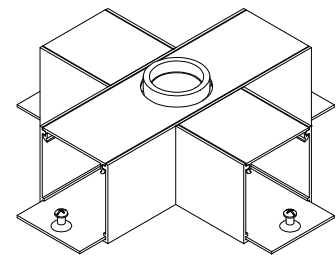

FLAT CROSS W/ LAMP

DESCRIPTION

COUPLING
BLANK END
FEED END FITTING, W/ 1/2" KO
FLAT ELBOW
FLAT ELBOW W/ LAMP HOLDER
INTERNAL ELBOW
EXTERNAL ELBOW
TEE
TEE W/ LAMPHOLDER
CROSS
CROSS W/ LAMPHOLDER

SATIN ALUMINUM

220430
220470
220480
220890
220900
220910
220920
220930
220940
220950
220960

POLISHED ALUMINUM

220430
220471
220481
220891
220901
220911
220921
220931
220941
220951
220961

POLISHED GOLD

220430
220472
220482
220892
220902
220912
220922
220932
220942
220952
220962

LAMPGUARDS AVAILABLE IN SQUARE, ROUND OR HEX SHAPES. SEE LAMPGUARD SPEC SHEET FOR MORE INFORMATION.

Type:

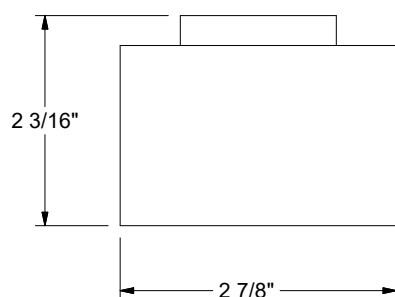
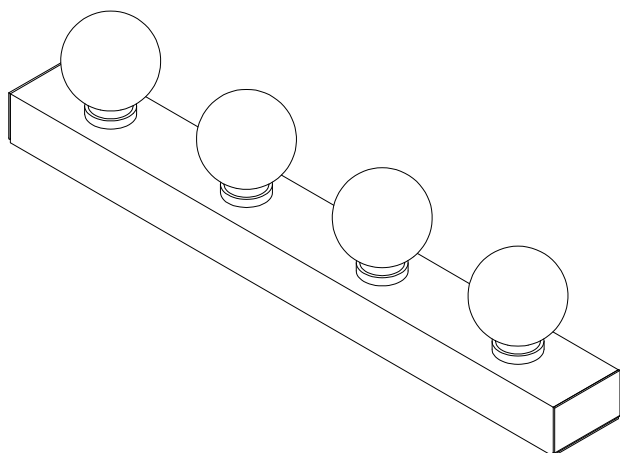

IDEAL FOR
USE WITH
SCREW BASE
LED LAMPS

DESCRIPTION

SATIN ALUMINUM

2' FIXTURE, 6 LAMP HOLDERS, 4" O.C.
3' FIXTURE, 9 LAMP HOLDERS, 4" O.C.
4' FIXTURE, 12 LAMP HOLDERS, 4" O.C.
8' FIXTURE, 24 LAMP HOLDERS, 4" O.C.

320204
320304
320404
320804

2' FIXTURE, 4 LAMP HOLDERS, 6" O.C.
3' FIXTURE, 6 LAMP HOLDERS, 6" O.C.
4' FIXTURE, 8 LAMP HOLDERS, 6" O.C.
8' FIXTURE, 12 LAMP HOLDERS, 6" O.C.

320206
320306
320406
320806

2' FIXTURE, 2 LAMP HOLDERS, 12" O.C.
3' FIXTURE, 3 LAMP HOLDERS, 12" O.C.
4' FIXTURE, 4 LAMP HOLDERS, 12" O.C.
8' FIXTURE, 5 LAMP HOLDERS, 12" O.C.

320212
320312
320412
320812

3' FIXTURE, 1 LAMP HOLDER, 24" O.C.
4' FIXTURE, 2 LAMP HOLDERS, 24" O.C.
8' FIXTURE, 4 LAMP HOLDERS, 24" O.C.

320324
320424
320824

SPECIFICATIONS

- Extruded aluminum with anodized finish standard, custom finishes upon special request.
- Supplied with porcelain medium base lamp holders, lamps by others.
- Fixtures are shipped with blank end caps, for continuous row mounting, simply remove end caps where luminaires meet, and use the internal coupler (provided) to make a seamless link.
- Easy installation and wiring through snap off wiring compartment.
- LED and Incandescent lamps are easily dimmed with standard dimming controls.
- 60 watt max lamps for ceiling mount, 150 watt max for wall mounting or lamp base down mounting.
- Ideal for use with medium screw base energy efficient LED lamps.
- All units are UL & CUL LISTED damp locations. Optionally available for wet locations.
- Consult factory for special lengths, miters, lamp spacing, curving & layouts.
- On custom length continuous row luminaires lamp centers are adjusted to fit evenly over the length of the fixture.
- Lamp guards are available in square, round or hex shapes. See lamp guard sheets for information.



AIREY-THOMPSON™
Manufacturing Quality Luminaires

SL-C SERIES SURFACE MOUNT STRIP LIGHTS MEDIUM BASE LAMP HOLDERS

Type: _____

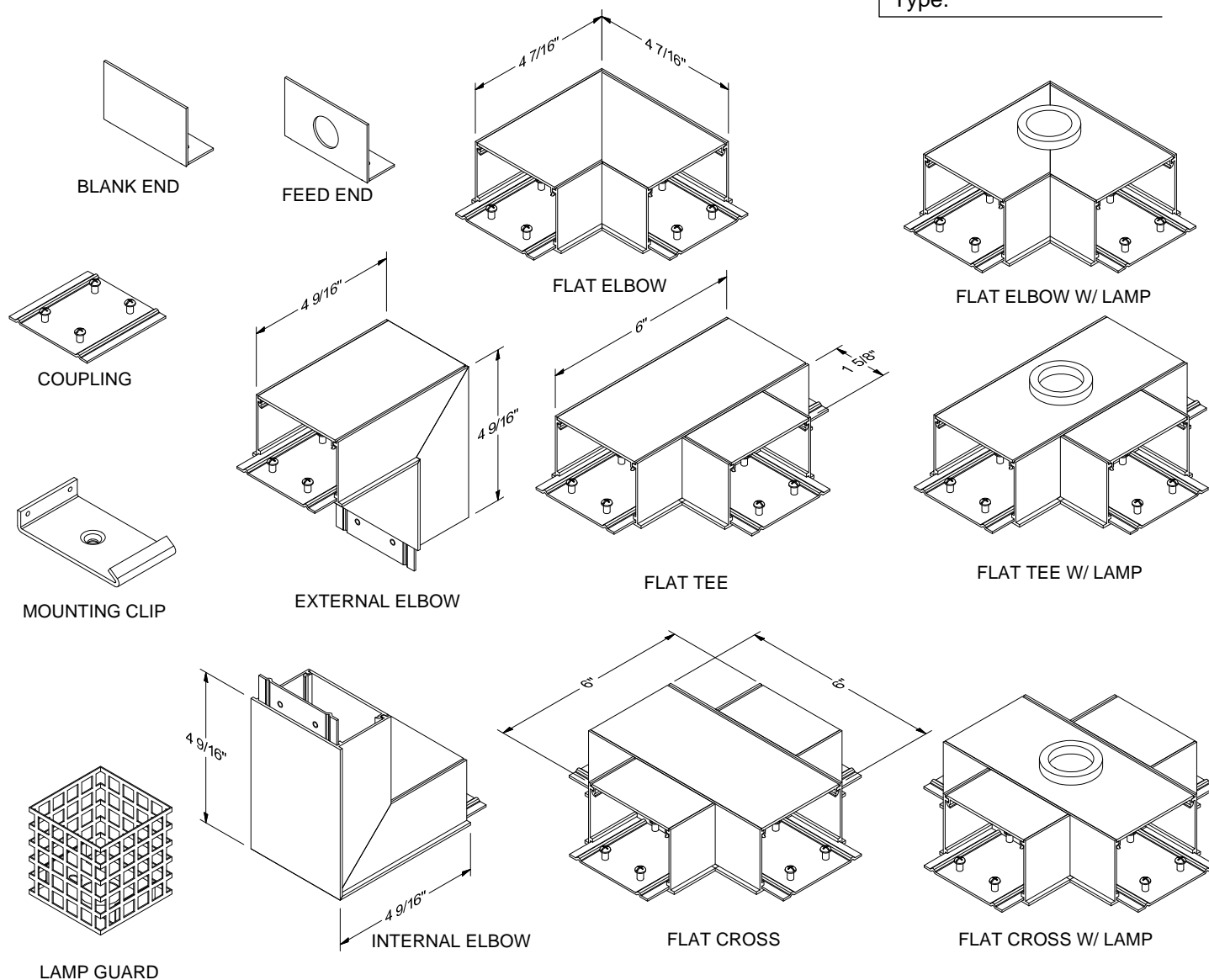

DESCRIPTION

COUPLING
BLANK END
END FITTING, 1/2" K.O.
MOUNTING CLIP
FLAT ELBOW
FLAT ELBOW W/ LAMPHOLDER
INTERNAL ELBOW
EXTERNAL ELBOW

SATIN ALUMINUM

330430
330470
330480
330490
330890
330900
330910
330920

DESCRIPTION

TEE
TEE W/ LAMPHOLDER
CROSS
CROSS W/ LAMPHOLDER
"A" TYPE LAMPGUARD
"G25" TYPE LAMPGUARD
"G40" TYPE LAMPGUARD

SATIN ALUMINUM

330930
330940
330950
330960
220001
220011
220021



AIREY-THOMPSON™
Manufacturing Quality Luminaires

INCANDESCENT SQUARE LAMP GUARDS

Type:

BACK TO
DECORATIVE
INCANDESCENT

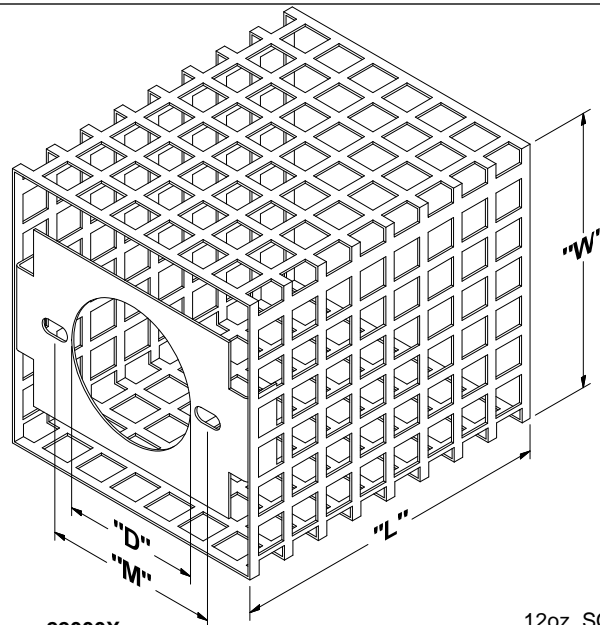

11800X
(Shown with
G16 1/2 for ref.)

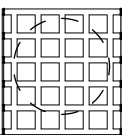

22000X
(Shown with
A19 lamp for ref.)

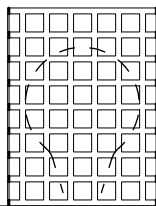

22001X
(MOST POPULAR)
(Shown with G25 for ref.)

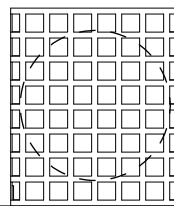

12oz. SODA CAN
(FOR SIZE REFERENCE)

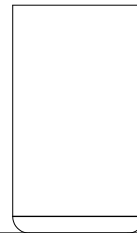

22002X
(Shown with G40 lamp for ref.)

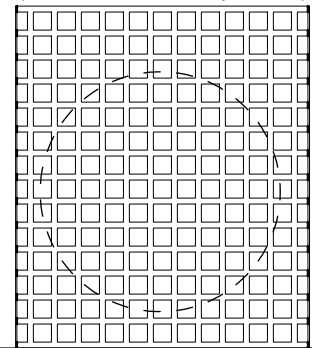

PART NO.	FINISH	DESCRIPTION	"W"	"L"	"D"	"M"
118001	Bright Nickel	Candelabra base up to G16 1/2 lamp	2 1/2"	2 5/8"	1 1/16"	1 3/4"
118002	Bright Brass	Candelabra base up to G16 1/2 lamp	2 1/2"	2 2/8"	1 1/16"	1 3/4"
220001	Bright Nickel	Medium base up to A19 lamp	3 1/8"	4 1/8"	1 3/4"	2 1/4"
220002	Bright Brass	Medium base up to A19 lamp	3 1/8"	4 1/8"	1 3/4"	2 1/4"
220011	Bright Nickel	Medium base up to G25 lamp	3 1/2"	4 1/8"	1 3/4"	2 1/4"
220012	Bright Brass	Medium base up to G25 lamp	3 1/2"	4 1/8"	1 3/4"	2 1/4"
220021	Bright Nickel	Medium base up to G40 lamp	6 1/8"	7 1/8"	1 3/4"	2 1/4"
220022	Bright Brass	Medium base up to G40 lamp	6 1/8"	7 1/8"	1 3/4"	2 1/4"

SPECIFICATIONS

- Lamp guards are available in bright nickel plating for satin aluminum and polish aluminum luminaires.
- For polished gold luminaires, lamp guards are available in bright brass plating.
- Lamp guards are available with a custom painted finish on special order.
- All lamp guards are manufactured from 3/8" square opening, 1/8" web, 22 ga. c.r.s. The 220021 and 220022 have 1/2" X 16 ga. c.r.s. stiffeners top and bottom.
- Complies with National Electrical Code (NEC) Section #520.72, which states:
All incandescent lamps in dressing rooms, where less than 8 feet (2.5 m) from floor, shall be equipped with open-end guards riveted to the outlet box cover or otherwise sealed or locked in place.
- Luminaires will be prepunched for mounting screws when ordered with lamp guards.
- Field drilling may be required if luminaires are ordered separately.

Type: _____

BACK TO
DECORATIVE
INCANDESCENT

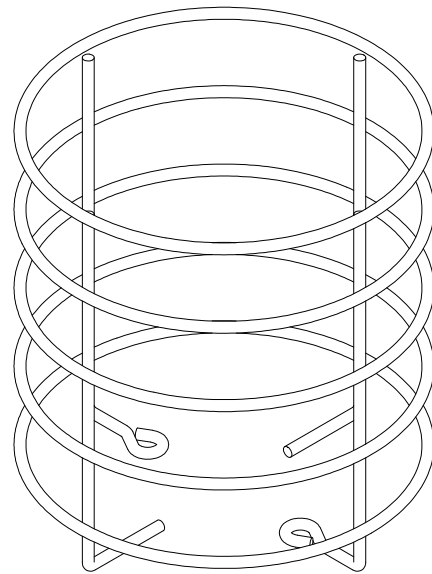
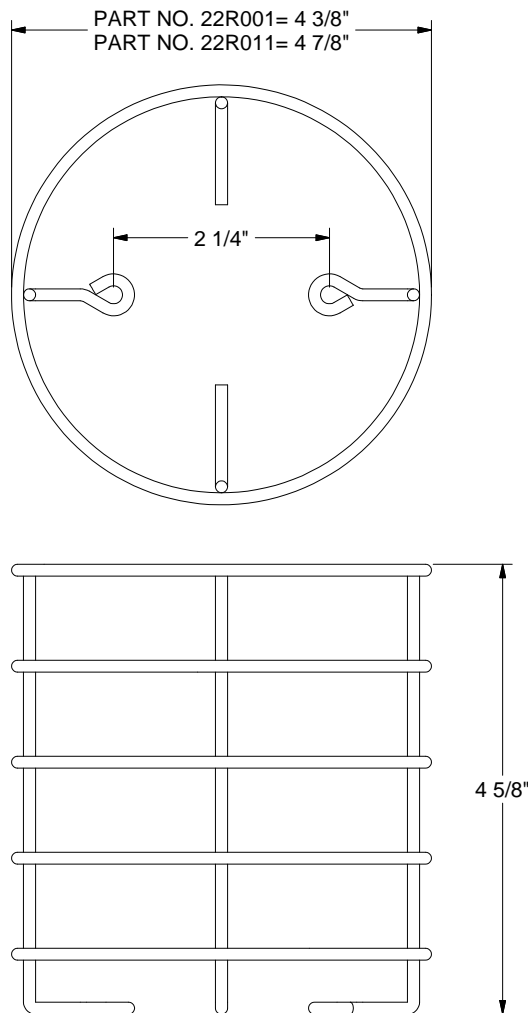

<u>PART NO.</u>	<u>FINISH</u>	<u>DESCRIPTION</u>
22R001	Bright Nickel	Medium Base up to A19 lamp
22R011	Bright Nickel	Medium Base up to G25 lamp

SPECIFICATIONS

- Lamp guards are available with a custom painted finish on special order.
- Lamp guards are manufactured from #11 ga. c.r.s. wire.
- Complies with National Electrical Code (NEC) Section #520.72, which states:
All incandescent lamps in dressing rooms, where less than 8 feet (2.5 m) from floor, shall be equipped with open-end guards riveted to the outlet box cover or otherwise sealed or locked in place.
- Luminaires will be prepunched for mounting screws when ordered with lamp guards.
- Field drilling may be required if luminaires are ordered separately.

Type:

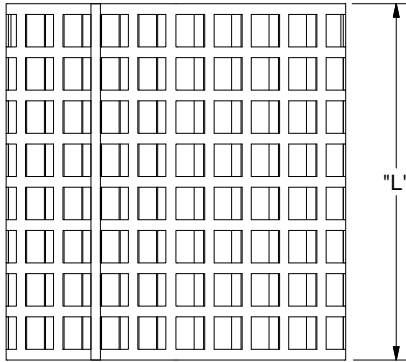

BACK TO
DECORATIVE
INCANDESCENT

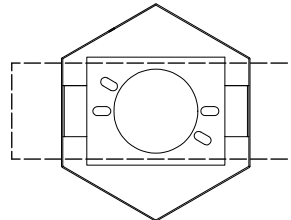
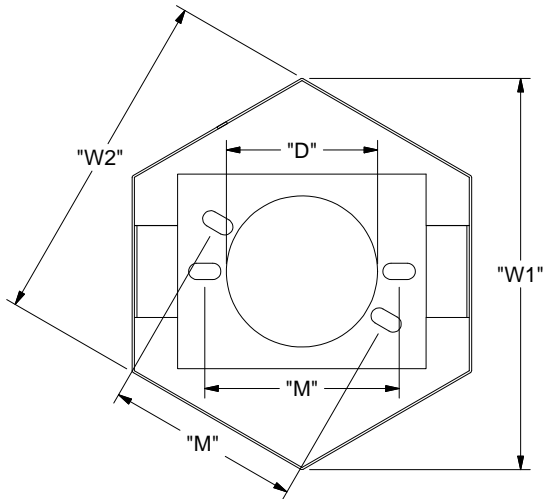
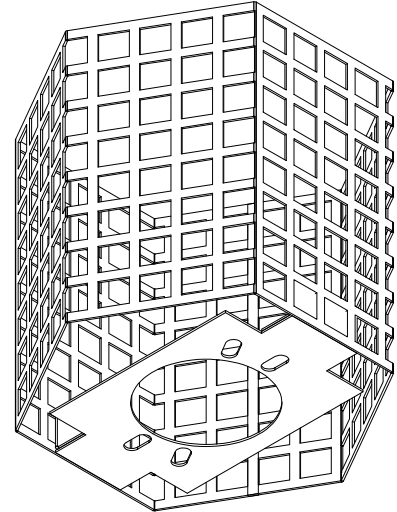

Lamp guard may be mounted
point perpendicular to extrusion.

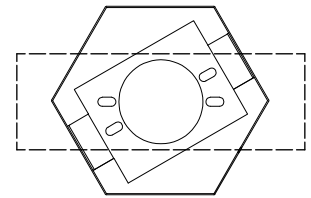

Lamp guard may also be mounted
point parallel to extrusion.

PART NO.	FINISH	DESCRIPTION	"W1"	"W2"	"L"	"D"	"M"
220031	Bright Nickel	Medium base up to A19 lamp	3 7/8"	3 3/8"	4 1/8"	1 3/4"	2 1/4"
220032	Bright Brass	Medium base up to A19 lamp	3 7/8"	3 3/8"	4 1/8"	1 3/4"	2 1/4"
220041	Bright Nickel	Medium base up to G25 lamp	4 1/2"	3 15/16"	4 1/8"	1 3/4"	2 1/4"
220042	Bright Brass	Medium base up to G25 lamp	4 1/2"	3 15/16"	4 1/8"	1 3/4"	2 1/4"

SPECIFICATIONS

- Lamp guards are available in bright nickel plating for satin aluminum and polish aluminum luminaires.
- For polished gold luminaires, lamp guards are available in bright brass plating.
- Lamp guards are available with a custom painted finish on special order.
- All lamp guards are manufactured from 3/8" square opening, 1/8" web, 22 ga. c.r.s.
- Complies with National Electrical Code (NEC) Section #520.72, which states:
All exposed incandescent lamps in dressing rooms, where less than 2.5 m (8 feet) from floor, shall be equipped with open-end guards riveted to the outlet box cover or otherwise sealed or locked in place.
- Luminaires will be prepunched for mounting screws when ordered with lamp guards.
- Field drilling may be required if luminaires are ordered separately.