

Timeline of the Settlement of De Luz, Census 1900 - 1950 and the 1976 Directory of De Luz Residents



In the vast expanse of what is now known as California, the Luiseño Native Americans roamed the land, living off the bounties of nature. But their way of life was soon to be disrupted. In 1769, Spanish explorers and settlers arrived in San Diego, laying the foundation for a new era of colonization.

As the years passed, the Spanish granted vast tracts of land to various individuals, including the Mission San Luis Rey in 1798, the Rancho Santa Margarita y Las Flores in 1841, and the Santa Rosa Rancho and Monserate Rancho in 1846. But these land grants were not without controversy.

No accurate surveys were made by the Spanish owning these lands, and a large wedge of territory from the Fallbrook district to Rainbow and De Luz was left outside of the grants. After the Mexican-American war, this area was settled mostly by homesteaders, squatters, or claim jumpers.

A Spanish vaquero named Jose De Luz had a corral for his stock near the property that Orlando Stewart homesteaded. This was probably the source of the name De Luz. Basque shepherds also grazed sheep in the area but made no permanent dwelling or claim to the land.

In 1861, a man named Mr. Spring squatted on land near Fern Creek and the warm springs. By 1881, Lemon Judson had built a four-bedroom house near the warm mineral springs. But it wasn't until the late 1800s that the area saw a surge in land applications.

In 1874, Orlando Stewart applied for land in Section 32, Township 10, Range 4. In the following years, others followed suit, including W. W. Wilmot, R. J. Wilmot, W. N. Moeller, J. R. Marsh, and Harry M. Daniels.

Rev. Henry J. Camp also applied for land in 1889, as did Charles E. Rubottom, Carr, Young, and Fumvelt. Vincent Roboni and Harry K. Day followed suit in the early 1890s, as did Mary Jane Pace, Charles A. Dicey, William H. Wisecarver, and Joseph Orvis.

Through the years, the land in and around De Luz changed hands countless times, as settlers sought to make their mark on the region. But the story of De Luz is not just one of land ownership and applications. It is a tale of the pioneers who carved out a life in this rugged corner of California, overcoming adversity and uncertainty to forge a new future for themselves and their families.

De Luz 1889

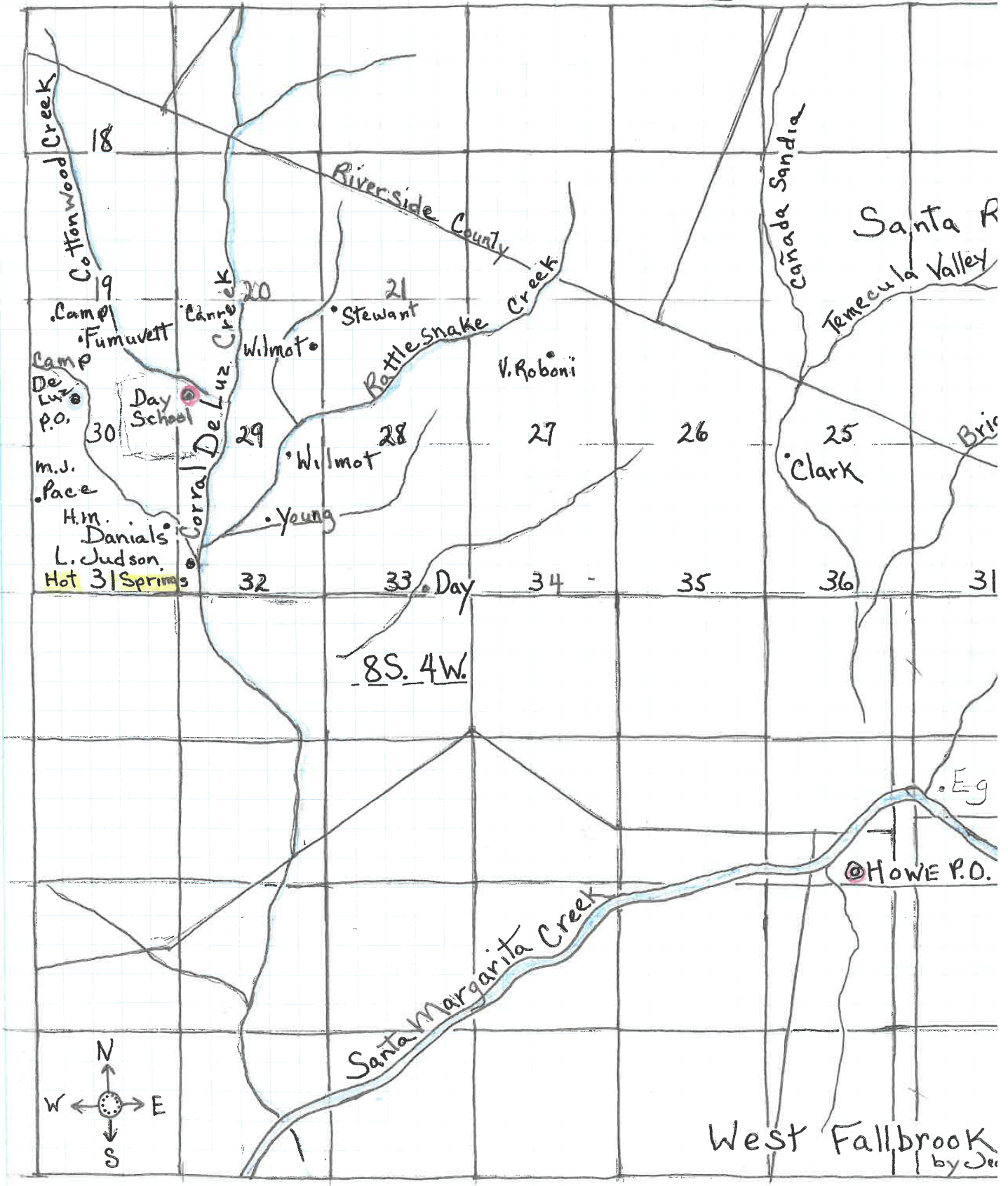

The beginning time is unknown that the Luiseño Native Americans lived in the area
 1769 Spanish explorers and settlers arrived in San Diego
 1798 Mission an Luis Rey established
 1841 Rancho Santa Margarita y Las Flores by grant of the Mexican government was for 133,441 acres north of the San Luis Rey de Francia Mission
 1846 Santa Rosa Rancho granted to Juan Moreno
 1846 Monserate Rancho granted to Ysidro Maria Alvarado, 13,322 acres lying along the San Luis Rey River
 No accurate surveys were made by the Spanish owning these lands. A large wedge of land from Fallbrook district to Rainbow and De Luz was outside of the Spanish land grants. After the Mexican-American war this area was settled mostly by homesteaders, or maybe a squatter or claim jumper. Jose De Luz a Spanish vaquero had a corral for stock, this was probably the source of the name De Luz
 Basque shepherds grazed sheep but made no permanent dwelling or claim to the land
 1861 Mr. Spring squatted on land near Fern Creek and the warm springs
 1881 Lemon Judson built a four bedroom house at the warm mineral springs
 1874 Orlando Stewart (Sec 32 T10R4) application #679
 1885 W. W. Wilmot E2, SE4, SW4 SE4, Sec 29 NW4 NE4 Sec 32 8S 4W
 1887 W. N. Moeller E2SW4, SW4, SW4 Sec 32 8S 4W
 1887 J. R. Marsh N2,NE4 Sec 20 & W2, SE4 Sec 19 8S 4W
 1888 Orlando A. Stewart SE4,SW4, Sec.29, SE4,NE4, & N2 NW4 Sec. 32, T8R4
 1888 Harry M. Daniels E2,NW4 & SW4, NE4 & NE4 &NW4, SE4 Sec 31, T8R4
 1888 R. J. Wilmot later it was the Clicks
 1888 Ross. W. Wilmot later is was the Bleeker's
 1889 Henry J. Camp W2, SE4& E2,SW4, NE4, Sec 30,T8R4
 1889 Charles E. Rubottom 80 acres near Garnsey
 1889 Carr (1889 Plat map)
 1889 Young (1889 Plat map)
 1889 Fumuvelt (1889 Plat map)
 1891 Vincent Roboni NE4, SW4 & N2, SE4,NE4 Sec 28 T8R4
 1892 Harry K. Day W2,SW4 sec 29, E2 NW4 Sec 30 T8R4
 1892 Mary Jane Pace S2,NE4 & E2 NW4 Sec 31 T8R3
 1892 Charles A. Dicey SE4,NW4 & SW4, NE4 Sec11 T8R4
 1892 William H. Wisecarver SE4,SE4 Sec 12, Lot 1 Sec 13 T9R5
 1892 Joseph Orvis Sec 5 T9R4

1900 Census

Name	Rel to head	Age	Marital status	Birthplace	Occupation
Wilmot, Welnor W	Head	44	Married	Maine	farmer
Wilmot, Sarah	Wife	43	Married	Iowa	Postmistress
Wilmot. Charles W	Son	16	Single	California,	Mail Store Driv-
er					
Wilmot. Edith	Daughter	14	Single	California,	at school
Wilmot,Guy	Son	11	Single	California,	at school
Wilmot, Rachael	Daughter	9	Single	California	at school

Wilmot, Helen	Daughter	6	Single	California	
Orvis, Joseph	Head	75	Widowed	New York	
Orvis, Fred	Son	34	Single	Iowa	mail stage driver
Lauritzen. Ernest	Head	45	Single	Denmark	farmer
Myers, Edward	Head	36	Single	Germany	farmer
Courtney John R	Head	36	Married	Kansas	farmer
Courtney, Cloe	Wife	33	Married	California	
Courtney, Millie	Daughter	9	Single	California	
Courtney, Emma	Daughter	6	Single	California	
Courtney, Mabel	Daughter	4	Single	California,	
Courtney, Johnnie	Son	3	Single	California	
Courtney. Oma	Daughter	8/12	Single	California	
Dicey, Charles A.	Head	37	S	New Hamp	farmer
Day, Erastus M.	Head	76	Married	New York	farmer
Day, Caroline V/	Wife	72	Married	New York	
Root, Harry B	Head	41	Married	Indiana	
Houghton, Warren W.	Head	62	Widowed	Vermont	farmer
Rost, Lucy A	Wife	29	Married	Illinois,	
Root, Edward L	Son	7	Single	California	
Root, Ralph W	Son	5	Single	California,	at school
Root, Earl E	Son	1	Single	California	
Day, Harry K	Head	47	Married	Pennsylvania	Landlord farmer
Day, Ida May	Wife	40	Married	Missouri,	
Day Frank	Son	22	Single	California	day laborer
Day, Jessie V	Daughter	20	Single	California,	at school
Day, Edith	Daughter	16	Single	California	at school
Boyd, Lydia A	Sister in Law	55	Widowed	Ohio, USA	
Smith, Sarah J	Head	58	Married	Indiana,	landlord
Stewart, Orlando A	Head	51	Married	Indiana,	farmer
Stewart, Florence A	Wife	44	Married	Maine,	
Lockwood, Mattie	Adopt Daught.	19	Single	Oregon	
Griffin, Lehi	Niece	9	Single	California,	
Griffin Ava	Niece	7	Single	California	at school
Wilmot, Ross J	Head	40	Married	Maine	farmer
Wilmot, Lena	Wife	35	Married	Maine	
Wilmot, Arthur	Son	17	Single	California	at school
Wilmot, Oscar	Son	14	Single	California	at school
Wilmot, John	Son	12	Single	California	at school
Wilmot, Maurice,	Son	18	Single	California	at school
Wilmot, Grace,	daughter	8	Single	California	at school
Ficher, Jessie R	Head	23	Married	Missouri	Sect foreman R. R.
Ficher Nettie	Wife	27	Married	Wisconsin	
Ficher, Virginia	daughter	.8	Single	California	At School
Ferlin, Francis F.		21	Single	California	laborer R. R. track
Fahrenkruz, John H	Head	33	Married	Germany	farmer
Fahrenkruz, Marcellena	Wife	32	Married	Spain	
Fahrenkruz. Henrietta	Daughter	4	Single	California	
Fahrenkruz, Johnny	Son	2	Single	California	

Fahrenkruz, Theodore	Son	1	Single	California	
Fahrenkruz, Theodore	Brother	26	Single	Indiana	farmer laborer
Fahrenkruz, Henrietta	Mother	59	Widowed	Germany	
Roboni, Vincent	Head		Single	Italy	farmer
Daniels, Henry M	Head	76	Married	Massachusetts	farmer
Daniels, Frances B	Wife	60	Married	Maine	
Nye, Harriet P	Step Daughter	33	Single	Illinois	
Camp, Henry J	Head	57	Widowed	Ohio	preacher
Camp, Irvine M	Head	25	Married	Ohio	farmer
Camp, Lellah	Wife	24	Married	Georgia	
Kelley, Anna M	M- in Law	49	Widowed	Georgia	
Camp, Charles H	Head	21	Single	California	day laborer
Garnsey, James L.	Head	68	Married	Missouri	farmer laborer
Garnsey, Charles A	Grandson	12	Single	California	at school
Berry, John F	Head	67	Widowed	England	farmer
Berry, John B.	Head	35	Single	England	farm laborer

1910 Census

Fallbrook Township Roblar Canyon

Last	first	Head	relation to Head	Marital status	age	Born	Occupation
Morris	George	head		wd	47	Mississippi	farmer beekeeper
	Verda E		daughter	S	18	Calif	none
	Cyril		son	S	13	Calif	none
Simmington,	Lillie		housekeeper	D	32	Indiana	housekeeper
	George		son	S	17	Indiana	none
	Lillie		daughter	S	13	Indiana	none
public road to De Luz to Fallbrook							
Wilmot,	Rosseau		head	M	52	Maine	farmer
	Lena		wife	M	47	Maine	none
	Arthur		son	S	26	Maine	none
	Maurice		son	S	20	California	none
	Grace		daughter	S	18	California	none
Roboni,	Vincent		head	S	62	Italian	farmer vineyardist Immig. to US 1874
Day,	Harry K		head	Wd	48	Pennsylvania	farmer fruit raisins
Tittle,	Jessie		daughter	M	29	California	none
Tittle,	Reece		grandson	S	8	California	none
Tittle,	Margorie		granddaughter	S	6	California	none
Tittle,	Edith		granddaughter	S	8	California	none
Regan,	Kate		head	M	48	Pennsylvania	farmer
	William H.		son	S	26	Minnesota	farmer
	Joe M.		son	S	20	Minnesota	farmer
	Margarit L.		daughter	S	18	Minnesota	none
Sidler,	Cedic ?		sister	S	58	Pennsylvania	none
	Clough, Clara		trained nurse	S	47	Vermont	private nurse to family
	Catherine		daughter	S	3	California	none
	Scannell, Joel H.		boarder	S	5 17	Illinois	none

Hunt, Clinton	head	M	24	Missouri	farmer worker hired out
Sylvia	wife	M	18	Missouri	none
Day, Frank R.	head	M	32	California	farmer
Lulu V.	wife	M	24	California	none
Dorothy	daughter	S	4	California	none
Adams, Clara	sister-in-law	S	18	California	none
Silkwood, Charles	head	M	51	Illinois	farmer
Mellissa Y	wife	M	39	Nebraska	none
Minnie A	daughter	S	15	California	none
Paul E.	son	S	9	California	none
Lydia M.	daughter	S	2	California	none
Leland, A.	son	S	3 mo.	California	none
Johnson, Thomas	head	wd	70	Missouri	farmer and beekeeper
Butsche, David	head	M 2	63	Ohio	beekeeper
Ellen	wife	M 2	53	Michigan	none
De Luz Station to Fallbrook					
Bayham, Thomas	head	wd	45	Michigan	boss on R. R.
Maganio, Julentino	head	S	22	Mex/Spanish	laborer on the R. R.
Jesus	brother	S	14	Mex/Spanish	laborer on the R. R.
Campos, Juan	Head	M	40	Mex./Spanish	none
1910 Census Temecula Canyon Road					
Clark, Arthur	head	M	45	Mass.	Farmer and beekeeper
Elizabeth	wife	M	33	California	none
Elizabeth A	daughter	S	15	California	none
Percy C	son	S	13	California	none
Lester G.	son	S	9	California	none
Carter	son	S	5	California	none
Harrison, Edward M.	head	M	53	Illinois	farmer
Elizabeth A.	wife	M	50	Mass	school teacher
Blanche	daughter	S	21	California	none
Howard V.	son	S	20	California	none
Ruth, R.	daughter	S	12	California	none
Hanson, Andrew	head	M	54	Denmark	farming and gardening
Matilda C	wife	M	48	Denmark	none
Fallbrook Station Road (public road De Luz to Fallbrook					
Musser, George	head	S	69	Pennsylvania	laborer fruit farm
Hubbard, Oliver A.	head	M	53	Wisconsin	farmer and gardener
Mary C	wife	M	51	Pennsylvania	none
Courtney, John R	head	M	48	Kansas	farmer and teacher
Chloe C.	wife	M	38	California	none
Millie C.	daughter	S	19	California	none
Emma M.	daughter	S	17	California	none
Mable M.	daughter	S	15	California	none
John O.	daughter	S	13	California	none
Ana, A	daughter	S	10	California	none
Winfred B.	daughter	S	7	California	none
Presley, A.	son	S	4	California	none
Margaret M.	daughter	S	1	California	none
Grui, Gunepi	head	M	37	Italian	laborer in fruit ranch
Victoria	wife	M	34	Italian	keeper boarder

Grigio, Antonio	boarder	S	39	Italian	laborer in fruit ranch
Ferro, Dominico	boarder	S	42	Italian	laborer in fruit ranch
Vesco, Antonio	boarder	S	36	Italian	laborer in fruit ranch
Grashde, Martino	boarder	S	28	Italian	laborer in fruit ranch
Galleto, Georgio	boarder	S	23	Italian	laborer in fruit ranch
Perona, Ancher	boarder	S	56	Italian	laborer in fruit ranch
Clemmens, Andrew	head	S	24	California	farmer
Albert	brother	S	28	California	farmer
Carla	sister	S	18	California	none
Margery	sister	S	21	California	student at school
Mary B.	mother	Wd	54	Germany	none
Pratt, Charles	head	M	60	New York	Physician and farmer
Lola	wife	M	58	New York	none
Herbert S	son	wd	32	Michigan	farmer
Florence D	daughter	S	27	Michigan	none
Anna B.	daughter	S	18	California	none
Carpenter, John W.	head	M	62	Indiana	Farmer and beekeeper
Martha Y	wife	M	62	Indiana	none
De Luz Station to Fallbrook					
Clark, Almond J.	head	M	67	Maine	Farmer, raisins teacher
Belle.	wife	M	68	Maine	none
Flora M.	daughter	S	22	California	student at school
Temecula Canyon road from Fallbrook station to Riverside county line					
Hansen, Andrew	head	M	54	Denmark	farmer
Matilda C	wife	M	48	Denmark	none
Mary	daughter	S	21	Denmark	none
Dora	daughter	S	18	California	none
Carolina	daughter	S	15	California	none
Andrew	son	S	10	California	none
Thomas	son	S	8	California	none
King, James	head	M	50	Eng;and	farmer and beekeeper
Annie A	wife	M	51	Rhode Island	none
Alice J	daughter	S	23	California	none
Arthur A	son	S	21	California	
Theodore	son	S	11	California	
George P Clark	Fat-n-l	Wd	78	Massachusetts	none
Heylmann, Otto W	head	M	57	Germany	farmer
Christina	Wife	M	69	Germany	painter odd jobs
Frank M B	son	S	33	Germany	painter
Fred W	son	M	30	Germany	none
Olive	D-in-law	M	20	California	none
Christina	granddaught	S	2	California	none
Peters, Mary L G	head	D	56	California	none
Ray G	son	S	17	California	none
William R	son	S	16	California	none
Savage, Albert A	head	Wd	54	New York	farmer
Frankie D	daughter	S	26	Pennsylvania	none
Guy W	Son	S	15	New York	
Manhill	son	S	13	Missouri	none
Ernest F	son	S	10	Iowa	none

	Earl A	4	son	S	4	Iowa	none
	Vern R		son	S	2	Iowa	none
De Luz public and private road							
	Sanchez, George F		head	M	45	California	farmer
	Christina		wife	M	41	California	none 1/8 Black
	Ora		daughter	S	15	California	none 1/8 Black
	Lena		daughter	S	14	California	none 1/8 Black
	Diego		son	S	3	California	none 1/8 Black
	Rosy		daughter	S	0	California	none 1/8 black
	Larsen, Eva		Niece	S	5	California	none
	Leslie, John T		Head	M	40	Ohio	farmer
	Margaret		wife	M	41	Missouri	private family nurse
	Elliott, Taylor D		Fat-n-l	M	74	Ohio	none
	Amanda J		M-n-law	M	74	Indiana	none
	Esther Dix		boarder	S	15	Michigan	none
Last	first	Head	relation to Head	Marital status	age	Born	Occupation
	Merritt, Joel C		head	M	50	Ohio	farmer
	Hannah C		wife	M	48	Ohio	none
	James A		son	S	18	Ohio	none
	Mary M		daughter	S	16	Ohio	none
	Helen C		daughter	S	11	Ohio	none
	Howard K		son	M	29	Ohio	farmer
	Naomi		d-in-law	M	29	Ohio	none
	Daniels, Francis B		head	Wd	68	Maine	farmer
	Orvis, Fred H		head	M	44	Iowa	farmer
	Ivy C		wife	M	34	Kansas	none
	Lester S		son	S	1	California	
	Larintzen, Ernest		head	S	56	Denmark	beekeeper
Recluse Valley private road north to Murrieta and ? trail ?? De Luz							
	Coleman, Con		head	M	42	Wisconsin	farmer and stock raiser
	Cora		wife	M	28	Ohio	none
	Rosa B		daughter	S	10	California	none
	Clara O		daughter	S	9	California	none
	Clarence E		son	S	8	California	none
	Chester T		son	S	6	California	none
	Fay O		son	S	5	California	none
	Lester A		son	S	3	California	none
	Elizabeth		head	wd	63	Wisconsin	
Lee	Thomas L		head	wd	36	Iowa	farmer
	Ina C		wife	M	39	Iowa	none
	Francis L		daughter	S	17	California	none
	Walter A		son	S	15	California	none
	Lillian M		daughter	S	12	California	none
	Leonard L		son	S	9	California	none
	Vinton H		son	S	6	California	none
	Freeman, Austin E		head	M	37	Texas	farmer
	Minerva		wife	M	25	California	none 1/8 Black
	Freddie R		son	S	9	California	none 1/8 Black
	Hazel A		daughter	S	8	California	none 1/8 Black

Carl A	son	S		4	California	none	1/8 Black
Sadie M	daughter	S		2	California	none	1/8 Black
Earl T	son	S		0	California	none	1/8 Black
Freeman, Oliver	head father	D		43	Texas	farmer	
Wesley Male	son	S		14	California	none	
Ebenezer R	Father	wd		90	Missouri	none	
Helen C	daughter	S	11	Ohio	none		
Howard K	son	M		29	Ohio	farmer	
Naomi	d-in-law	M		29	Ohio	none	
Daniels, Francis B	head	Wd		68	Maine	farmer	
Orvis, Fred H	head	M		44	Iowa	farmer	
Ivy C	wife	M		34	Kansas	none	
Lester S	son	S		1	California		
Larintzen, Ernest	head	S		56	Denmark	beekeeper	
Recluse Valley private road north to Murrieta and ? trail ?? De Luz							
Coleman, Con	head	M		42	Wisconsin	farmer and stock raiser	
Cora	wife	M		28	Ohio	none	
Rosa B	daughter	S		10	California	none	
Clara O	daughter	S		9	California	none	
Clarence E	son	S		8	California	none	
Chester T	son	S		6	California	none	
Fay O	son	S		5	California	none	
Lester A	son	S		3	California	none	
Elizabeth	head	wd		63	Wisconsin		
Lee Thomas L	head	wd		36	Iowa	farmer	
Ina C	wife	M		39	Iowa	none	
Francis L	daughter	S		17	California	none	
Walter A	son	S		15	California	none	
Lillian M	daughter	S		12	California	none	
Leonard L	son	S		9	California	none	
Vinton H	son	S		6	California	none	
Freeman, Austin E	head	M		37	Texas	farmer	
Minerva	wife	M		25	California	none	1/8 Black
Freddie R	son	S		9	California	none	1/8 Black
Hazel A	daughter	S		8	California	none	1/8 Black
Carl A	son	S		4	California	none	1/8 Black
Sadie M	daughter	S		2	California	none	1/8 Black
Earl T	son	S		0	California	none	1/8 Black
Freeman, Oliver	head father	D		43	Texas	farmer	
Wesley Male	son	S		14	California	none	
Ebenezer R	Father	wd		90	Missouri	none	

1920 Census

Last	first	Head	relation to Head	Marital status	age	Born	Occupation
Recluse Precinct							
Ortega, Frank		head		M	42	California	farmer
Amelia		wife		M	40	California	none
Frankie		son		S	18	California	laborer

Bernardo	son	S	14	California	none	
Virginia	daughter	S	10	California	none	
Myrtle	daughter	S	8	California	none	
Clifford	son	S	6	California	none	
Celestia	daughter	S	3	California	none	
Freeman, Oliver	head	M	52	Texas	farmer	
Bessie	wife	M	38	Kansas	teacher grammar sch	
Kennith	son	S	5	California	none	
Russell	son	S	3	California	none	
Freeman, Thomas A.	head	M	57	Texas	farmer	
Nolici	wife	M	44	Texas	none	
Edward	son	S	26	California	laborer working out	
Asa	son	S	20	California	farmer	
Pearl	daughter	S	17	California	laundress	
Arleen	daughter	S	6	California	none	
Pauline	daughter	S	5/12	California	none	
Wright, Louis	hired man	S	59	Indiana	herder, goats	
West Fallbrook Precinct						
Tittle, Jessie D.	head	wd	39	California	teacher grammar sch	
Reese	son	S	17	California	seaman US Navy	
Marjorie L.	daughter	S	16	California	none	
Edith E	daughter	S	11	California	none	
De Luz Precinct						
Treadwell, Ralph c.	head	M	42	Kansas	farmer	
Nettie	wife	M	37	Pennsylvania	none	
Ester, M	daughter	S	7	California	none	
Ethel L	daughter	S	1 1/2	California	none	
Peters, Herbert	head	D	60	Iowa	farmer	
Frank C.	son	S	29	California	farmer	
Everett, William W	head	M	72	Kentucky	farmer	
Martha	wife	M	69	Kentucky		
Kirkpatrick, Julius D	head	M	19	Iowa	farmer	
Lavina, R	wife	M	29	Nebraska	none	
Elizabeth	daughter	S	6	California	none	
Lavina, R	daughter	S	4 5/12	California	none	
Clara D.	daughter	S	3 4/12	California	none	
Denzil, R	son	S	1	California	none	
Brode, Edward	head	M	62	Pennsylvania	farmer	
Amy A.	wife	M	45	Iowa	none	
Last first	Head	relation to Head	age	Born	Occupation	
Samuel, E	son	S	17	Kansas	laborer	
Butts, Hazel	boarder	S	22	Kansas	teacher, grammar sch	
Herron, Harry P.	head	M	47	Iowa	farmer	
Girtha	wife	M	45	Iowa	none	
Herron Francis	adopted son	S	12	California	none	
Prahl, Charles H	head	M	51	Denmark	farmer	
Eliza	wife	M	46	Switzerland	none	

Emma	daughter	S		11	Arizona	none
Carl	son	S		9	California	none
Leona	daughter	S		7	California	none
Neeser, Gottlieb	head	S		53	Switzerland	farmer
Tiffany, Walter	head	M		55	Ohio	overseer farm
Etta, K.	wife	M		45	Pennsylvania	none
Levis	daughter	S		5	Oregon	none
Garnsey, Louis	head	M		46	California	farmer mortgaged
Felix R.	son	S		11	California	none
Nellie R.	daughter	S		9	California	none
Harry D	son	S		6	California	none
Felix R.	head	M		51	California	farmer mortgaged
Ida May	wife	M		53	Kansas	none
Shese, John	handiman	S		53	Ohio	farm laborer
Day, Harry K.	head		wd	67	Pennsylvania	farmer
Scolaro. Grace J	head		wd	27	California	farmer
Bessels	granddaughter	S		w	California	none
Wilmot, Rosseau	head	M		61	Maine	farmer
Laura	wife	M		56	Maine	none
Johnson, Charles	head	M		34	California	manager farm
Sarah, L.	wife	M		27	Colorado	none
Cecil L.	son	S		7/12	California	none
Rogers, Francis M.	head	S		74	Kentucky	truck gardener

here ends the enumeration of Los Flores Precinct

1930 Census

House #	Head	relation to Head	Marital status	age	Born	Occupation
492	Baxter, John	Head	M	41	Scotland	mail carrier
	Baxter, Chloe	wife	M	32	Utah	proprietor
486	Bisbee, Guy A.	head	M	52	Illinois	proprietor
	Bisbee, Edna	wife	M	51	Missouri	none
	Bisbee, Dorothy	daughter	S	3	Calif	none
	Phelps, W.	nephew	S	16	Calif	none
493	Blessing, James	lodger	S	61	Colorado	laborer
488	Brode, John	head	M	72	Penn	proprietor
	Brode, Amy	wife	M	56	Iowa	proprietor
	Brode, Ned	son	S	27	Kansas	laborer
	Boag, Elliott	ward	S	12	Calif	none
	Bunting, Frank	ward	S	13	Ohio	Juvenile court ward
Smith, James	ward	S	14	Calif	LA & SD	
	Boop, Elliot	ward	S	12		
	Gordon, Don	ward	S	12	Hawaii	
488	Dicey, Donald	ward	S	14	Mass.	none
	Boop, Elliot	ward	S	12		on handwritten census
	Gordon, Len	ward	S	12	Hawaii	none
	Ehardt, Billy	ward	S	11	Calif	none
	Mohrar, Wlm	ward	S	11	Penn	none

500	Click, Louis G.	head	M	30	Indiana	farmer
490	Herron, Harry	head	M	54	Iowa	proprietor
	Herron, Girtha	wife	M	57	Iowa	none
	Cary, Robert	ward	S	15	Minn	none Juvenile court ward SD
	Clark, Dan	ward	S	17	NY	none
	Elliot, Clark	ward	S	13	Montana	none
	Henry, Harvey	ward	S	9	Calif	none
	Hewitt, Ralph	ward	S	16	Calif	none
491	Garnsey, Louis J.	Head	M	56	Calif	proprietor
	Garnsey, Felix R.	son	S	20	Calif	none
	Garnsey, Ruth N.	daughter	S	19	Calif	none
	Garnsey, Harry D.	son	S	16	Calif	none
493	Garnsey, Felix R.	head	M	61	Calif	proprietor
	Garnsey, Ida May	wife	M	64	Kansas	none
	Heightower, Robert	ward	S	9	Calif	none
	Reid, E.	ward	S	12	Rhode Island	none
	Root, Louis T.	ward	S	14	Calif	none
	Verdugo, Gonzales	ward	S	10	Calif	none
504	Hanson, L.	head	S	49	Minn.	metal worker
487	Hill, Eliza E.	head	M	63	Illinois	caretaker
	Hill, Lilian E.	wife	M	62	Kansas	none
	Hill, Frankie	daughter	S	19	Calif	none
499	Kuhnis, John	b-in-law	S	20	Switzerland	proprietor
485	Nuthall, George	head	M	56	Iowa	proprietor
	Nuthall, Mabel	wife	M	46	Nevada	none
House #	Head	relation to Head	Marital status	age	Born	Occupation
506	Perkins, Henry A.	head	M	76	Illinois	none
	Perkins, Lizzie B.	wife	M	72	Ohio	none
	Williams, Francis E	lodger	S	54	So Dakota	none
		Kenneth Rosseau				
503	Price, Robert	head	M	66	Tennessee	none
	Price, Docea	wife	M	48	Georgia	none
	Douglas					
502	Royal, Merton L.	head	M	54	Iowa	proprietor
	Royal, Zana A,	wife	M	37	Wisconsin	none
	Royal, Verna	daughter	S	1	Calif	none
	Lawrence					
501	Scott, S	head	M	25	Illinois	manager
	Scott, Bertha	wife	M	21	Calif	none
	Lawrence					
	Scott. S	son	S	2	Calif	none
494	Smelser, Ofed	head	M	24	Nebraska	none
	Smelser, May	wife	M	21	Calif	none
	Smelser, Lois	daughter	S	7	Calif	none
	Smelser, Helen	daughter	S	5	Calif	none
	Smelser, Peter	son	S	2	Calif	none

505	Sorenson, Thomas	head	M	60	Denmark	manager
	Sorenson, Katherine	wife	M	54	Denmark	none
498	Stoner, Francis J	head	M	45	Nebraska	proprietor
	Stoner, Irene E.	wife	M	28	Kansas	none
	Crouse, Paul G	stepson	S	8	Calif	none
	Loefke, Carl	stepson	S	10	Michigan	none
489	Tiffany, Walter	head	wd	66	Ohio	caretaker
	Tiffany, Levis K	daughter	S	16	Oregon	none
496	Wilbur, Frank H.	head	S	48	Calif	proprietor
	Wilbur, Clara S	sister	S	53	Calif	none
	Wilbur, Abbey	sister	S	51	Calif	clerk
497	Wilmot, J	head	M	71	Maine	proprietor
	Wilmot, Lena	wife	M	68	Maine	none
	Wilmot, Arthur E.	son	S	46	Calif	laborer

1940 Census

Last	first	Head	relation to Head	Marital status	age	Born	Occupation
Fallbrook Township De Luz							
Loy, James		head		M	55	California	mechanic
	Nettie		wife	M	52	Illinois	
Galiheur, Jason		head		M	47	Missouri	mechanic
	Lillian		wife	M	45	Illinois	
	Ruth		daughter	S	17	Oklahoma	
Deanville, John		head		M	47	Oklahoma	farmer
	Susan		wife	M	47	Oklahoma	
Schultz, Nellis L		head		M	65	Illinois	farmer
	Nellie		wife	M	64	Illinois	
Clarkson, Alex M.		head		S	67	New York	farmer
Leyersdall, Carl C.		head		S	45	Montana	lather farm building work
Settle, Charles		head		S	60	California	W. P. A farm
Scott, John C.		head		M	50	California	farmer
	Virgie		wife	M	45	California	
	infant		daughter	S	1/2 yr`	California	
Montijo, Paul		head		S	42	California	farmer
	Morris		father	wd	94	California	
Kinney, Edward P		head		M	50	Colorado	farmer
	Mary		wife	M	46	No. Dakota	
McIntire, William J.		head		M	61	Colorado	farmer
	Henrietta		wife	M	46	California	
Nieden, Herbert		head		S	50	California	oil well worker
Treacy, A		head		S	47	No. Dakota	farmer
Brade, John C.		head		M	72	California	farmer
	Amy		wife	M	69	California	
Doerrer, John G		head		M	58	Illinois	farmer
	Amy		wife	M	54	Illinois	
Smith, Nellie		head		?	49	California	wood retailer
Fallbrook Township De Luz							
Stoner, Harvey M.		head		M	56	California	citrus agent

Winifred	wife	M	52	California	none
Errol	son	S	30	California	farmer
Nuthall, George	head	M	65	Iowa	road engineer
Pearl	wife	M	55	Iowa	none
Vernon	son	S	32	California	farmer
George Jr.	son	S	30	California	farmer
Everett, Rose A	head	wd	70	Missouri	
William T.	f-in-law	wd	93	Kentucky	
Baxter, John C	head	M	51	Utah	farmer
Chloe	wife	M	42	Idaho	postmistress
Wilson, Sam W.	head	M	51	California	doctor of medicine private
Hazel,	wife	M	51	California	
Herron, Girtha	head	wd	67	Iowa	
Wilkowski, Olive	lodger	S	27	Oklahoma	teacher, private school
Jave. Minna	head	wd	50	Iowa	farmer
Pyeatt, John	head	M	51	California	farmer
Mercy	wife	M	50	California	
Pyeatt, Nyler	head	M	45	California	farmer
Susie	wife	M	41	California	
Garnsey, Felix R	head	M	32	California	tractor driver, farmer
Theodora	wife	M	32	California	
Stephen	son	S	2	California	
Thockilden, Henry	head	M	59	Wisconsin	farmer
Minnie C	wife	M	51	Colorado	
Richman, Clinton	head	M	43	California	miner and farmer
Bessie	wife	M	43	Oklahoma	
Ridge, Dormilee	step-daughter	S	17	Oklahoma	
Ridge, Billy Joe	step-son	S	15	Oklahoma	
Ridge, Isabel	step-daughter	S	8	Oklahoma	
Richman, Byron	head	M	46	Utah	farmer
Lenore	wife	M	41	California	
Fuller, Irvin	step son-in-l	S	15	California	
Heistand, Ralph	head	M	49	Ohio	farmer
Laura	wife	M	27	Ohio	
Kuhnis, John	head	S	42	Switzerland	laborer farm
Poston, Albert	head	M	50	England	farmer
Elizabeth	wife	M	42	England	
Allecyn	son	S	19	California	seaman. navigation
Doris	daughter	S	6	California	
Collens, Edward	head	M	37	California	farmer
Enid	wife	M	24	England	
Edward. Jr.	son	S	6	California	
Tittle, Reese	head	M	38	California	farmer
Mary	wife	M	28	California	
Harris, Katherine	head	wd	65	Colorado	

1950 Census

Last	first	Head	relation to Head	Marital status	age	Born	Occupation
------	-------	------	------------------	----------------	-----	------	------------

Fallbrook pg48 sec. 71

Roll, Lloyd	head		M	48	Kansas	painter contractor
Maxine	wife		M	37	Wyoming	laundry clothes presser
Lois	daughter		S	17	Colorado	none
Neal	son		S	16	Colorado	none
Warren	son		S	14	Colorado	none
Richard	son		S	12	Colorado	none

Fallbrook 37-87 pg 2

Merickle, Arthur	head		M	54	Wisconsin	farming
Bagley, Floyd	head		M	29	Maine	armed forces
Beverley, V	wife		M	33	Maine	none
Beverly Ann	daughter		S	49	California	none
Ito (?), Harry Jr.	head		M	29	Japan	vegetable farming
Francis, M,N	wife		M	22	Japan	
Harrison, Howard V.	head		wd	59	California	carpenter
O'Reilly, Clay J	head		M	30	Tennessee	ranch hand
La Vera C.	wife		M	34	Nebraska	gardening
Smith Nellie C.	head		Div	55	Kansas	?
Brannon, Devis, Jackson	neighbor		S	13	Tennessee	
Flor, Ervin	head		M	43	So. Dakota	ranch
Arline	wife		M	36	Minnesota	
Harry	son		S	16		
Smith, Frank	head		Div	55	Ohio	
Amestoy, Ben	head		M	51	France	sheep herder
Dumate, Jean Pierre	head		M	20	France	sheep herder
Rivera, Julia	head		M	58	Spain	sheep herder
Snow, Glen C.	head		M	67	Wisconsin	farm
Grace C.	wife		M	59	Massachusetts	none

Fallbrook 37-38 page 3

vacant (Ferris)

non resident (Lucier)

non resident (Kendricks)

Dinisen, Adolph	head		M	59	Connecticut	gardening
Ruth, C	wife		M	54	Indiana	farm help
Hays, Joseph H.	head		M	36	California	ranching
Lydia C.	wife		M	34	California	ranch helper
Bagabal, Martin	head		S	49	France	sheep rancher
Baptist	nephew		S	20	France	sheep rancher
Ruiz, Antonio	head		S	50	Ohio	sheep rancher
Tancague, Michel	head		S	32	France	sheep herder
Erving, Cyril	head		M	50	Ohio	farming
Mildred	wife		M	41	Mississippi	
Franklin G	son		S	9	California	
Ann, Crystille M	daughter		S	3	California	
Garland M	son		S	2	Mississippi	

Fallbrook 1950 37-87- pg 4

vacant (Nelson)

Johnson, Lawrence B.	head		wd	43	California	farming
----------------------	------	--	----	----	------------	---------

vacant (Colburn)						
LeFavre, Vernon	head		M	61	Pennsylvania	guest rancher
Brazel, Donald	head		M	42	Illinois	manager guest ranch
	Marguerite	wife	M	37	Illinois	bookkeeper guest ranch
	Rita Marie	daughter	S	2	California	
vacant (Freeman)						
Black, Allen W.	head		M	41	Washington	Supt of School Fallbrook
	Elizabeth	wife	M	40	California	
	Stephen	son	S	14	California	
Black, Flora		daughter	S	12	California	
	Kenneth	son	S	9	California	
Morse, Thomas C.		head	Sep	46	California	
	Riley	son	S	18	California	
	Larry	son	S	13	California	
	Judith	daughter	S	10	California	
no one at home King 300 feet over county line						
Marchant, John W.	head		M	60	England	rancher
	Mignon C.	wife	M	55	California	
Easton, John R.	head		M	44	Alabama	ranching
	Ellen, M.	wife	M	41	Washington	
	John W.	son	S	5	California	
	Maey Ellen	daughter	S	3	California	
Schirsoner, Louis	head		M	57	West Virginia	orchid raising
	Gladys	wife	M	41	Ohio	orchid raising
pg54 1950 census pg 5						
Hansen, Alex	head		Div	61	Wisconsin	
no one at home (Doville)						
no one at home (Reis)						
vacant (Loy)						
Baxter, John, C	head		M	64	Scotland	ranching
	Chloe L	wife	M	59	Utah	postmistress
Foss, Selma	head		wd	74	New York	
	Rudolph C	son	S	53	California	
Reid, James J.	head		wd	65	New York	tractor operator
Kinney, Edward P.	head		M	60	Colorado	ranch
	Mary	wife	M	56	No Dakota	
Roberts, Thomas P.	head		M	52	Kentucky	
	Amy D.	wife	M	39	Illinois	
	Doerrer, Ana	m-in-law	wd	70	Illinois	
Thorkildsen, Kenny W.	head		M	69	Wisconsin	
Garnsey, Felix R.	head		M	40	California	rancher
	Theodora	wife	M	42	California	
	Stephen M	son	S	12	California	
	Harry D.	brother	S	30	California	
vacant (Schaffer)						
vacant (Bracket)						
no one at home (Berger) non resident (Mathews)						

Last first	Head	relation to Head	Marital status	age	Born	Occupation
Fallbrook 37-87 page 6						
vacant (Dunlap)						
Pyeatt, Mercy E.	head		S	61	Oregon	ranch
Anderson, John G	lodger		wd	49	Connecticut	thinning peaches
Berg, Carlia	head		div	67	Illinois	
Jave, Minna	head		wd	62	Iowa	ranch
Stevens, C. W.	head		M	60	Pennsylvania	ranch
	Minnie May	wife	M	66	Iowa	
Parker, Edith J	head		wd	67	Kansas	
Brain, John A.		grandson	S	15	California	
	Alan H.	grandson	S	16		
	Jeanette	granddaughter	S	6		
Stoner, Frank J	head		M	65	Nebraska	tractor work
	Janet A	wife	M	39	California	
	Kimmel, Regis J.	foster son	S	13	Michigan	
Kuhnis, John	head		S	49	Switzerland	rancher
Holworth, Alfred	head		M	44	So. Dakota	rancher
	Helen C.	wife	M	41	Alberta, Canada	
no one at home (Telor)						
Mason, Alfred	head		S	51	Michigan	farm
Bleeker, Robert B	partner		S	55	California	farm
Fallbrook 37-87 page 7						
vacant (Baker)						
Norton, Kelly	head		M	36		ranch
	Melvin	wife	M	31	Louisiana	ranch
	May Jean	daughter	S	15	Louisiana	
Moeh. Bennie R.	head		M	47	Minnesota	ranch
	Lena G	wife	M	45	Minnesota	
	William L.	son	S	23	California	
	Robert Lee	son	S	21	California	
Butler, William J	head		M	66	Ohio	producer
	Louise	wife	M	57	Ohio	
Saunder, David R.	head		M	52	Indiana	
McDowell, Homer C.	head		M	60	Pennsylvania	
	Marion J.	wife	M	59	Pennsylvania	
	Katherine	daughter	S	17		
Click, Veria V	head		S	61	Indiana	
	Elma F.	mother	wd	82		
vacant (Littlefield)						
no one home (Rezac)						
no one home (Boyer)						
no one home (Baker)						
no one home (Gill)						
no one home (Ormby)						
mo one home (Lenfer)						
1950 Census Fallbrook 37-87 pg 8						

Ito, Harry J.	head		M	29	California Japan	vegetable farming
Frances, M.N.	wife		M	22	California Japan	
Harrison, Howard V.	head		wd	59	California	carpenter
O'Reilley, Clay	head		M	30	Tennessee	ranch hand
La Vera E.	wife		M	34	Nebraska	gardening
Brannon, Devris, Jackson	nephew		S	13	Tennessee	
Flor, Ervin	head		M	43	So. Dakota	ranch
Arline	wife		M	36	Minnesota	
Harry	son		S	16	Minnesota	
Tom	son		S	15	Minnesota	
Shunk Cor. Y	head		M	48	Indiana	gas station
Janis S,	wife		M	45	Kentucky	waitress
John. E.	son		div	21	Illinois	
Gill, Robert D	head		M	33	California	ranch
Betty E.	wife		M	25	Missouri	
Lana L.	daughter		S	6	Nebraska	
Shirley, J	daughter		S	3	Nebraska	
Kirtley, Ellis, L.	head		div	53	Texas	dump truck driver
Boyer, Clara M	head		wd	72	California	
Baker, Ernest R.	head		wd	75	Michigan	ranch
Buchnew, William R	head		M	38	Nebraska	box stacker
Bulah, B,	wife		M	37	Iowa	
Lou Ann	daughter		S	15	Nebraska	
Marilyn Jo	daughter		S	13	Nebraska	
Jacqueline Lee	daughter		S	11	California	
Judith Rae	daughter		S	8	California	
Gill, Robert D	head		M	33	California	ranch
Betty E.	wife		M	25	Missouri	
Lana L.	daughter		S	6	Nebraska	
Shirley, J	daughter		S	3	Nebraska	
Kirtley, Ellis, L.	head		div	53	Texas	dump truck driver
Boyer, Clara M	head		wd	72	California	
Baker, Ernest R.	head		wd	75	Michigan	ranch
Buchner, William R	head		M	38	Nebraska	box stacker
Bulah, B,	wife		M	37	Iowa	
Lou Ann	daughter		S	15	Nebraska	
Marilyn Jo	daughter		S	13	Nebraska	
Jacqueline Lee	daughter		S	11	California	
Judith Rae	daughter		S	8	California	
1950 Census Fallbrook 37-87 Page 9						
Malone, Judge J.	head		M	57	Texas	laborer on ranch
Henrietta	wife		M	46	Texas	
Judge J. Jr.	son		S	17		
Berger. ?	head		wd	66	New York	
Elliot, L.	son		M	41	New York	

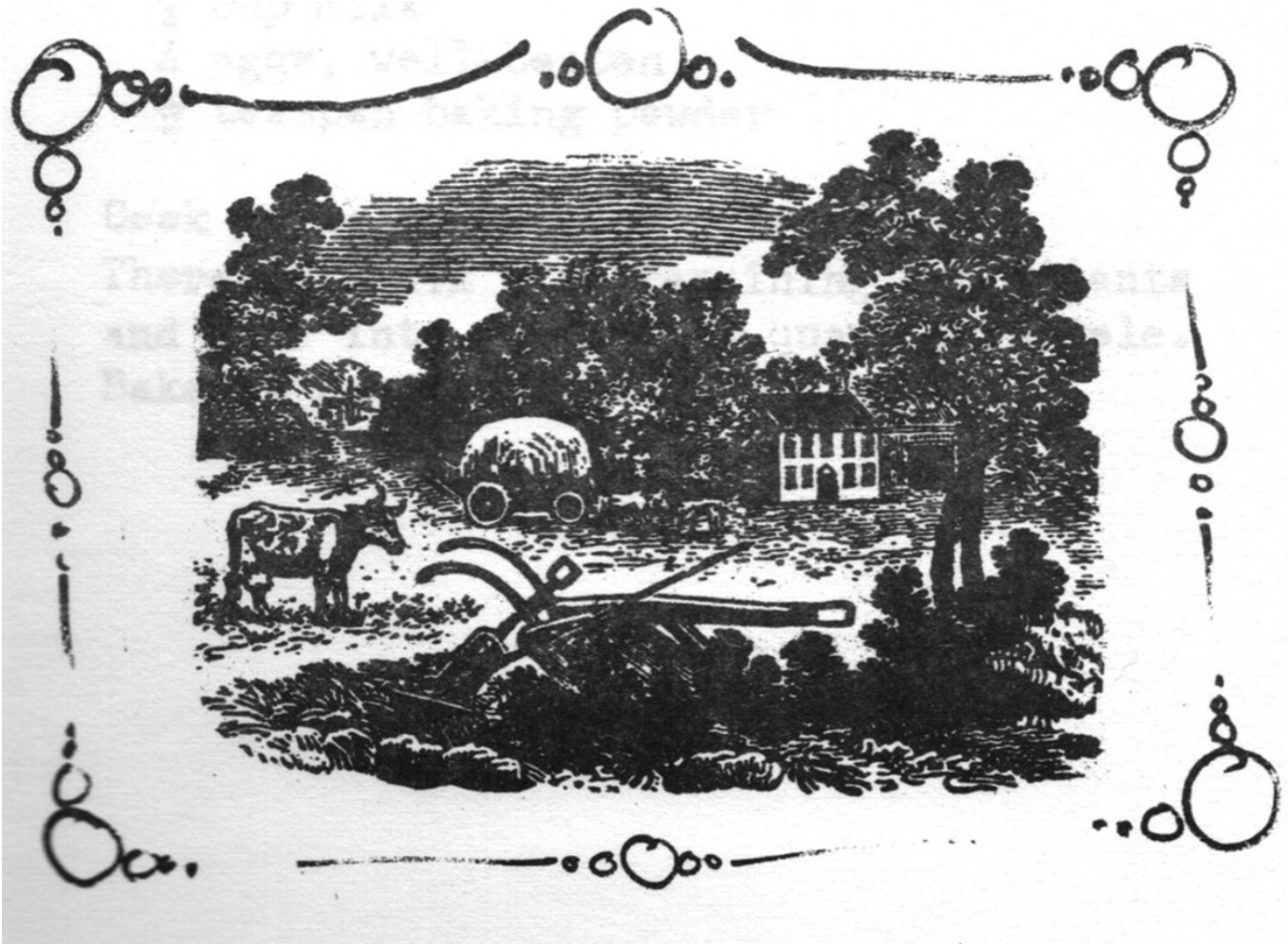

M. E. Van Amburgh Rte. 3. Box 44 B She has one of the most beautiful views in De Luz

Rae and Clara Arces Rte. 3. Box 84 De Luz Murrieta Rd

William and Roxanne Arterbury Rte. 3. Box 44 De Luz Road You'll always see a smile on Bill and Roxanne's faces. The kind of people you are glad to know. The hills are coming to life with their avocados.

John Barraclough, A.S.I.D Culver Road, Box 3 An English "transplant". A "wee bit a the ole country" accent still exists. You'll catch him on weekends tending to the new planting of avocados. During the week he toils in the city as an Interior Designer.

Spence and Jeanne Batchelor 2407 Ross Road One of retired military families.

Ed, Phil and Darlene Berg Rte. 3. Box 28 Daily Road Phil and Darlene contribute to the smooth operation of the water district. Ed has provided many trees and much real estate advice.

Walter and Edna Biewer, Riverview

B.D. and Norma Boedeker Rte. 3. Box 29P Daily Road Another of the families who are "week-ending" ranching. House is in, grove doing fine....Looks great. They are looking forward to being "full-timers".

Bill and Peg Bonner Rte. 3. Box 44A Bill and Peg have "Green Thumbs". Whatever they plan grows and grows and grows!

Ed Boulter Rte. 3. Box 60 De Luz Road

A. E. and Alice Brain Rte. 3. Box 82 De Luz Murrieta Road

John Allen Brain Rte. 3. Box 82 De Luz Murrieta Road
Alan and his sister Jan own the Blackfoot Indian shop in town
and sell jewelry and articles, custom design work and
silversmithing, crafts materials, collectors items and
original designs by Jan and Alan.

Larry Butler Rte. 3 Box 39 De Luz Road

Doug and Pat Campbell Rte. 3 Box 14 De Luz Road

One of our long-time residents.

Pat Carr Rte. 3 Box 39 Pat is one of our transplants from Ohio.

Whenever you see her, you always get a smile.

Len and Julie Chernos Silver Fox Lane

Russell Click Rte. 3 Box 72 De Luz Murrieta Road

Mr. Click, now retired, enjoys the peace and
quiet of the very old family ranch home.

Al and Ruby Cochran Rte. Daily Road

Otis and Ollie Crabtree Rte. 3 Box 29 Our school kids
think Otis and Ollie are pretty "super people".

They have pigeons for sale -squabbing breeds - and
great citrus.

Ray and Harriett Crane Rte. 3 Box 29 De Luz Road

One of our fine realtors in the area. Associated with
Village Realty.

George and Gale Cunningham Rte. 3 Box 43 De Luz Road Super tangelos and macadamias for sale. George and Gale have an antique store in Temecula. Stop by and say "hi".

Will and Lois Cunningham Rte. 3 Box 25 Give their citrus a try - it's great. They have some of the sweetest and juiciest oranges you have the opportunity to taste.

Glenn and Helen Daily Rte. 3 Box 26 Daily Road

Ross and Helen Daily Rte. 3 Daily Road The Daily's are avocado ranchers. Ross helps to keep the county officials "on their toes" and let them know we're here.

L. G. and Mid Davison

Don and Betty Day Rte. 3 Box 30 De Luz Road Don is a retired lawyer. Don and his love wife Betty have horses at their "Day Break Ranch".

Jenny Diamond De Luz Road

Mrs. A. B. Dinsen 22 De Luz Road The children that ride the school bus consider her one of their very favorite people. She waved to them every day as the school bus drove by and always had Halloween candy for them.

Don and Peggy During Rte. 3 Box 59 De Luz Road

Robert G. and Eleanor Durling Rte. 3 Box 44B De Luz Road Here in the heart of De Luz, the Durling family have a large citrus tree nursery. Naturally the trees are most healthy.

Pine and Jeanie Egan Rte. 3 Box 33 De Luz Road Jeanie drive one of the school buses that are so necessary.

Thanks Jeanie

Felix and Teddy Garnsey Rte. 3 Box 46 Stop by "the Gourd Farm" and see the marvelous things Felix and Teddy have done with gourds.

Gene and Jane Gauthier Rte. 3 Box 2468 Ross Road A dog named Jack and a cat name Zither. Gene is another of our retires military and Jane is one of the ladies all in white that holds our hands and; wipes our fevered brow in the hospital - an R.N.

Duan and Dorothy Gillett Rte. 3 Box 18 De Luz Road

Harry and Clara Gurndman Rte. 3 Daily Road

James Hammerton and wife Becky Dugger Rte. 3 Box 44C De Luz Road Give a phone call and there's eggs, oranges, avocados and kumquats close at hand. Jim is also one of our resident attorneys.

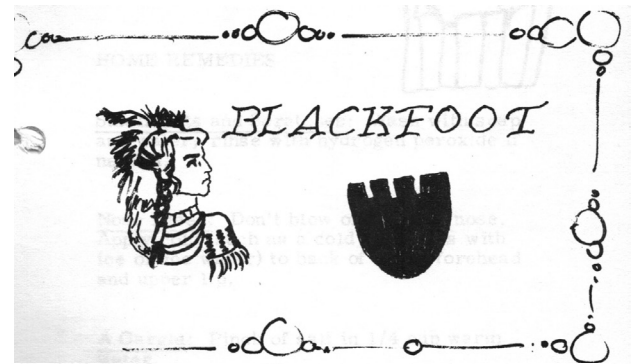

Virgil and Barbara Hardin Rte. 3 Box 2410 Ross Road Virgil is an avocado grower and does work with wood, brick or rock. Need some in this field give Virgil a call.

Wes and Betty Heald Rte. 3 Box 14A De Luz Road

Glenn and Helen Hildeman 40 De Luz Road

Wes and Virginia Jay Rte. 3 Box 13 A beautiful avocado orchard just as you enter the Canyon area.

Ole and Darlene Johnsen Rancho Ole" Rte. 3 Box 29B De Luz Road Weekend ranchers for 3 1/2 yeas or more.

They are comping at the bit to make it permanent. Son Ric is a summer resident and really getting ibto ranching operations.

Chas. and Arden Key Rte. 3 Box 32 De Luz Road Charles is an insurance man...give him a call.

Fritz Kott Rte. 3 Box 33 Fritz is a fabulous mechanic. You may have seen him on De Luz Road in one of his many antique autos.

Orlando Kott Rte. 3 Box 33 De Luz Road

Ernie and Alice Kuhn Rte. 3 Box 29C Ernie and Alice are avocado ranchers. All of the gorgeous rock work in front of the Kuhn's is Ernie's handiwork. Ernie and Alice are both teachers.

Ken Lewis 2462 Ross Road A beautiful grove. Avocados will be ready soon.

Dan and Helen Logsdon Rte. 3 Daily Road

Richard and Rosabel Matthews Rte. 3 Box 65 The Mathews have a beautiful grove at the very end of De Luz Canyon.

Barbara McManus Rte. 3 Box 41 De Luz Road

Don and Jan Metzger, son Brad Rte. 3 Box 28 C Daily Road Organic honey. Jan is a dog trainer and animal lover.

Rabbits, AKC Dachshunds, weaner pigs, Nubian goats, Cheriot and Suffolk lambs, and Aracauna chickens are available. Avocados on the way. Craft classes and Chinese Cooking instructions on request.

Ihor and Val Miro Rte. 3 Box37A De Luz Road Ihor is associated with Forest Lawn and Val with the Bank of America.

Art and Edith Mitchell Rte. 3 Box 45 Art and Edith are very special people - the kind of people that make De Luz a very special place. Art can prepare corned beef like no one else. Anyone wanting Vinca Major ground-cover for the taking, give Edith a call. this gal is a walking encyclopedia of our area flowers an birds.

Ted and Doris Nagy Rte. 3 Box, De Luz Road Some fantastic citrus - catch them on weekends.

Bill and Harriett Paine Rte. 3 Box 29L South Sore Drive Bill is in farming. Harriett, a home economist, has published a book on home canning, freezing and drying. And her recipes tell you what you can do with your preservatives!

Harold and May Raley Rte. 3 Box 54 Harold and Mary would like to be full-time residents - maybe someday. Need tangerines, oranges or avocados? Give the Raley's a call.

Stephen an Pat Raley, daughter Andrea Rte. 3 Box 68 De Luz Murrieta Road Steve is a General Contractor and all around builder. Give Steve a call - he has some great ideas, and he can build it right. Pat is an avid bicyclist and works at the Durling Nursery. And Andrea is becoming the nature specialist of the family.

Ray and Gail Raser Rte. 3 Box 42A De Luz Road

John and Sue Rock Rte. 3 Box 50A John looks forward to "retirement" in DE Lyz in the near future.

Bill and Joane Rose Rte. 3 Box Daily Road Ranching is a listed occupation but we all know Bill for his great ser vice on our volunteer fire department. Joan is always a willing had for out DLC needs.

Art and Loretta Sabo Rte. 3 Box2274 Daily Road One of our newer residents,

Don and Connie Scott Rte. 3 Box 49A Don is in the business of packaging materials.

Art and Nobuko Sederholm Rte. 3 Box 28B

Galen and Polly Shaver Rte. 3 Box 50 De Luz Road Galen is a retired dentist. He and Polly have cultivated a cute weekend home and ranch,,they call "The Old Vine yard"

Ben and Jeannie Stevens Rte. 3 Box Daily Road Ben and Jeannie have a son, Rod, who is a good motorcycle mechanic and wlll do odd jobs - watering, etc. - \$1.75 and hour. Good worker!

Chester and Elsie Sutton Rte. 3 Box 2454 Ross Road

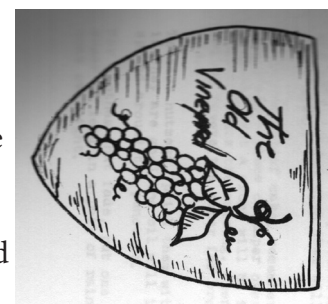

Boyd and Kathie Taylor Rte. 3 Box 29R Boyd is in construction and they're heading towards avodcao ranching and farming. Kathie is always a bubbly happy gal.

John B and Cecyle Taylor Rte. 3 Box 29R Daily Road John is an electrician. Cecyle slips her own Dresden china and creates her own colors and patterns.

Rose G. Towne Rte. 3 Box 53

Art and Edith Vail Rte. 3 Box 20 Art really does a beautiful job caning.

Carl Von Hirsch American Road Carl is in the hills doing all those fun things needed to get a grove in an avo- cado rancher in the near future.

Kendall Wagner Rte. 3 Box 29 De Luz Road

Doug and Sue Welburn Rte. 3 Box 77 Doug is a builder. The Welburn's also have alfalfa for sale. Give a call.

J. B. and Ann White Rte. 3 Box 70 De Luz Murrieta Road Jay and Ann enjoy square dancing, If you want some hybrid red worms, give a call.

Mr. and Mrs. G. Wilcox Rte. 3 Box 57 You are all sure to know the Wilcox's. They operate our convenient Camp Retreat. Haven't we all run out of something at oddball times. The store does come in handy.

W. V. Wood Rte. 3 Box' 82 De Luz Murrieta Road

Tom and Donna Woosley, Jr. Rte. 3 Box 49B Some fine Arabians available. Arabian stud service is also at the ranch.

Dick and Ruth Wright Rte. 3 Box 21 De Luz Rd The Wrights have a plant nursery. Succulents are their specialty.

