

Soil Erosion & Sedimentation Control Program

Part 91 Permit Application for Iron County, Michigan

Administered by: The Iron Baraga Conservation District - 2 South 6th Street, Suite 15 - Crystal Falls, Michigan 49920

Office Phone: (906) 875-3765 & Cell Phone: (906) 367-1203 Email: IronBaragaCD@gmail.com Website: IronBaragaCD.org

PERMITS ARE ISSUED FOR 18 MONTHS AND RENEWED ONE TIME FOR FREE UNLESS OTHERWISE NOTED

PLEASE ASK IF YOU NEED A PERMIT - AFTER THE FACT PERMITS WILL INCUR USE OF A DOUBLE FEE SCALE

ALL PERMITS WILL BE ISSUED WITHIN 30 DAYS OF A SUBMISSION OF A COMPLETE APPLICATION

YOU MAY BE REQUIRED TO SUBMIT PROOF OF ADDITIONAL EGLE/DEQ PERMITS PRIOR TO ISSUANCE

***APPROVAL OF A PERMIT MAY TAKE UP TO A MONTH, PLEASE TURN IN ALL PAPERWORK AS SOON AS POSSIBLE TO ENSURE THAT YOUR BUILDING PROJECT GOES SMOOTHLY AND ACCORDING TO PLAN.**

Submit Application To: Jennifer Ann Ricker-Feak CEA Via: Office Dropbox, Mail or Email: IronBaragaCD@gmail.com
 Questions? Call (906) 875-3765 or (906) 367-1203 Ask For: Jennifer Ann Ricker-Feak CEA
 Site Inspections Will Be Performed By: Jennifer Ann Ricker Feak CEA or Eric Zukowski CEA

Schedule of Fees for All Permit Categories

EXEMPTION: 225 SQ. FT. RULE	Earthwork Disturbing Less Than 225 Sq Feet	No Processing Fee - 3 Month	225
EXEMPTION: 24 HOUR RULE	Must Be Completed & Stabilized Within 24	No Processing Fee - 3 Month	24 hr.
SEPTIC INSTALL OR REPAIR	\$50 Flat Fee	\$50 Flat Fee	S
DRIVEWAYS & ACCESS ROADS, NON APA	\$50 Minimum - \$200 Per Mile	\$50 Minimum - \$200 Per Mile	D&R
GARAGE, SHEDS, & SAUNAS	\$100 Flat Fee - Per Parcel	\$100 Flat Fee - Per Parcel	G
LANDSCAPING, & DECKS	\$100 Per Acre - \$100 Minimum	\$100 Per Acre - \$100 Minimum	L&D
SINGLE FAMILY RESIDENTIAL FULL HOME SITE	Includes: Home, Well, Septic, Driveway ect.	\$300 Flat Fee - Per Parcel	HS
CONDOMINIUMS & APARTMENTS	\$500 Per Acre - \$500 Minimum	\$500 Per Acre - \$500 Minimum	C&A
MIXED USE	\$500 Per Acre - \$500 Minimum	\$500 Per Acre - \$500 Minimum	MU
COMMERCIAL FULL SITE BUILD	Retail, Industrial, Manufacturing, Marijuana & Cannabis Cultivation Production and Sales	\$500 Per Acre - \$500 Minimum Over 10 Acres - \$5,000 + \$400 Per +10 Over 20 Acres - \$9,000 + \$300 Per +20	CRIM
DIRECTIONAL BORING	Utility & Fiber Optic Cable	\$200 Minimum - \$200 Per Mile	BORE
INSTALL & CONNECTION SITE	By Utilities Service: Electric, Water, Sewer etc.	\$300 Flat Fee - Per Parcel	HOOK
PUBLIC UTILITIES (Non APA)	Sewer & Water, Hydro Dam, Solar Plants, Power Substations, Energy Production Plants, Linework, Natural Gas or Petroleum Pipeline Install & Repair	\$500 Per Acre - \$500 Minimum Over 10 Acres - \$5,000 + \$400 Per +10 Over 20 Acres - \$9,000 + \$300 Per +20 *If Emergency Repair & Contact Within 24	E=MC2
PUBLIC PARKS, HISTORICAL SITES, TRAILS	IBCD Scholarship Available	IBCD Scholarship Available	PUB
GRAVEL & SAND PITS FOR CONSTRUCTION AGGREGATE FOR SALE OR CONSTRUCTION USE.	*Additional State of Michigan Permits May Be Required, Contact Jen For More Information	\$500 1 - 10 Acres Add \$100 for Every Acre Beyond 10 5 Year Permit - No Free Renewal	G Pit

225 SQUARE FOOT EXEMPTION: A WAIVER WILL BE ISSUED IF LESS THAN 225 SQUARE FEET OF EARTH WILL BE DISTURBED

24 HOUR EXEMPTION: MINOR EARTH CHANGE: A CHANGE OF MINOR NATURE THAT WILL BE FINISHED OR STABILIZED WITHIN 24 HOURS

OTHER EXEMPTIONS: PLOWING OR TILLING FOR CROPS, AGRICULTURE, MINING AND LOGGING (SUPPORT FACILITY'S, SUCH AS NEW ACCESS ROADS, STAGING AREAS, PROCESSING FACILITIES, BUILDINGS AND STOCKPILES ARE NOT EXEMPT) *CONTACT OFFICE

*NONE OF THESE EXEMPTIONS APPLY IF THE ACTIVITY IS A PHASE OF SITE PREPARATION FOR ANOTHER LAND USE OR ACTIVITY THAT WOULD REQUIRE A PERMIT 10/1/2023

ALL PERMITTING FEES MUST BE PAID BEFORE PERMIT WILL BE ISSUED. ADDITIONAL FEES ARISING FROM NEGLIGENCE WILL BE BILLED SEPARATELY IF THEY OCCUR. A DOUBLE PERMIT FEE MAY BE ASSESSED IF THIS IS AN AFTER THE FACT PERMIT APPLICATION AND THE WORK DID NOT OCCUR DUE TO AN EMERGENCY DIG SITUATION, FLOOD OR NATURAL DISASTER.

IRON COUNTY SOIL AND SEDIMENTATION CEA HOLDS PART TIME, SEMI-SEASONAL HOURS. THE CEA WILL ATTEMPT TO MAKE EVERY EFFORT TO ASSIST YOU AS QUICKLY AS POSSIBLE, AND WORK WITH YOUR SCHEDULE. PLEASE UNDERSTAND DUE TO THE NATURE OF THE WORK, OUR CEA IS OFTEN IN THE FIELD DURING THE WORKING HOURS. IF YOU ARE UNABLE TO REACH THE CEA DIRECTLY, OFFICE STAFF WILL ENSURE THE CEA RETURNS YOUR CALLS AS QUICKLY AS POSSIBLE. (906) 875-3765

A SOIL EROSION CONTROL PERMIT UNDER MCL 324.9113 IS REQUIRED FOR ANY EARTH CHANGES LARGER THAN 225 SQ FEET THAT ARE LOCATED WITHIN 500 FEET OF A LAKE OR STREAM AND FOR EARTH CHANGES THAT ARE ONE ACRE (43,560 SQUARE FEET) OR MORE IN SURFACE AREA, REGARDLESS OF LOCATION.

Soil Erosion & Sedimentation Control Program of Iron County, Michigan - This Page Is Required For Permit

PROJECT ADDRESS OR FIRE #	
----------------------------------	--

CITY OR TOWNSHIP:	
--------------------------	--

PROPERTY TAX ID#		TOWNSHIP:		RANGE:		SECTION:	
-------------------------	--	------------------	--	---------------	--	-----------------	--

DIRECTIONS TO SITE OR GPS POINT IN DECIMAL DEGREES FORMAT:	
---	--

IS THERE A LOCKED GATE OR OTHER COMPLICATION FOR EASY ACCESS TO SITE?	
--	--

CLOSEST LAKE, STREAM, OR WETLAND:	
--	--

DISTANCE FROM EDGE OF DISTURBANCE AREA TO HIGH WATER MARK:	
---	--

LANDOWNER NAME(S):		PHONE #:	
---------------------------	--	-----------------	--

EMAIL ADDRESS FOR DIGITAL COPY OF PERMIT:	
--	--

MAILING ADDRESS:	
-------------------------	--

CITY:		STATE:		ZIP CODE:	
--------------	--	---------------	--	------------------	--

LANDOWNER SIGNATURE:		TODAYS DATE:	
-----------------------------	--	---------------------	--

CONTRACTOR COMPANY NAME:	
---------------------------------	--

SUPERVISOR NAME(S):		PHONE #:	
----------------------------	--	-----------------	--

EMAIL ADDRESS FOR DIGITAL COPY OF PERMIT:	
--	--

MAILING ADDRESS:	
-------------------------	--

CITY:		STATE:		ZIP CODE:	
--------------	--	---------------	--	------------------	--

CONTRACTOR SIGNATURE:		TODAYS DATE:	
------------------------------	--	---------------------	--

PERMIT FEE:	PLEASE MAKE CHECK OR MONEY ORDER PAYABLE TO: IRON BARAGA CONSERVATION DISTRICT
--------------------	---

CREDIT CARDS ARE ACCEPTED WITH AN ADDITIONAL \$5 PROCESSING FEE

CREDIT CARD NUMBER:	
----------------------------	--

EXPIRATION DATE:		3 DIGIT CODE ON BACK:	
-------------------------	--	------------------------------	--

CARDHOLDERS NAME:		ZIP CODE:	
--------------------------	--	------------------	--

PLEASE SIGN FOR PERMISSION TO CHARGE CARD:	
---	--

OFFICE USE ONLY

APPROVED BY:		APPROVAL DATE:	
---------------------	--	-----------------------	--

THIS MUST BE FILLED OUT TO ALLOW ANYONE OTHER THAN THE LANDOWNER TO PULL A PERMIT

LANDOWNER LETTER OF AUTHORIZATION

THIS FORM MAY BE SUBMITTED BY MAIL, DROPBOX, EMAIL, OR IN PERSON

PROJECT ADDRESS:

CONTRACTOR OR AGENT YOU ARE DESIGNATING:

RELATIONSHIP TO CONTRACTOR OR AGENT YOU ARE DESIGNATING:

CONTRACTOR OR AGENT ADDRESS:

CONTRACTOR OR AGENT EMAIL:

CONTRACTOR OR AGENT PHONE:

AS LANDOWNER OF THE PROJECT/PROPERTY DESCRIBED ABOVE, I AUTHORIZE THE PERSON INDICATED BELOW TO ACT ON MY BEHALF FOR THE PURPOSES OF THIS APPLICATION FOR A SOIL EROSION AND SEDIMENTATION CONTROL PERMIT PURSUANT TO PART 91, SOIL EROSION AND SEDIMENTATION CONTROL OF THE NATURAL RESOURCES AND ENVIRONMENTAL PROTECTION ACT, ACT 451 OF THE PUBLIC ACTS OF 1994 AS AMENDED. I UNDERSTAND THAT I AM RESPONSIBLE FOR ALL EARTH CHANGES RELATED TO THIS PROJECT AND UNDERSTAND THAT PART 91, ACT 451 MAY BE ENFORCED AGAINST ME IN THE EVENT OF ANY VIOLATION OF THAT ACT.

LANDOWNER NAME:

LANDOWNER SIGNATURE:

LANDOWNER EMAIL:

DATE:

LANDOWNER PHONE:

APPROVAL OF A PERMIT MAY TAKE UP TO A MONTH, PLEASE TURN IN ALL PAPERWORK AS SOON AS POSSIBLE TO ENSURE THAT YOUR BUILDING PROJECT GOES SMOOTHLY AND ACCORDING TO PLAN.

IRON COUNTY SOIL AND SEDIMENTATION CEA HOLDS PART TIME, SEMI-SEASONAL HOURS. THE CEA WILL ATTEMPT TO MAKE EVERY EFFORT TO ASSIST YOU AS QUICKLY AS POSSIBLE, AND WORK WITH YOUR SCHEDULE. PLEASE UNDERSTAND DUE TO THE NATURE OF THE WORK, OUR CEA IS OFTEN IN THE FIELD DURING THE WORKING HOURS. IF YOU ARE UNABLE TO REACH THE CEA DIRECTLY, OFFICE STAFF WILL ENSURE THE CEA RETURNS YOUR CALLS AS QUICKLY AS POSSIBLE. (906) 875-3765

PLEASE KEEP IN CONTACT, AND NOTIFY THE IRON COUNTY SOIL AND SEDIMENTATION CEA AS WORK PROGRESSES. YOU SHOULD INFORM THE CEA OF ANY ISSUES YOU EXPERIENCE, AND PROGRESS AT THE SITE. TYPICALLY THE CEA WILL INSPECT YOUR SITE AT THE START, DURING, AND AFTER COMPLETION OF WORK, HOWEVER MORE INSPECTIONS MAY OCCUR.

ALL PERMITTING FEES MUST BE PAID BEFORE PERMIT WILL BE ISSUED. ADDITIONAL FEES ARISING FROM NEGLIGENCE WILL BE BILLED SEPARATELY IF THEY OCCUR. A DOUBLE PERMIT FEE MAY BE ASSESSED IF THIS IS AN AFTER THE FACT PERMIT APPLICATION AND THE WORK DID NOT OCCUR DUE TO AN EMERGENCY DIG SITUATION, FLOOD OR NATURAL DISASTER.

A SOIL EROSION CONTROL PERMIT UNDER MCL 324.9113 IS REQUIRED FOR ANY EARTH CHANGES LARGER THAN 225 SQ FEET THAT ARE LOCATED WITHIN 500 FEET OF A LAKE OR STREAM AND FOR EARTH CHANGES THAT ARE ONE ACRE (43,560 SQUARE FEET) OR MORE IN SURFACE AREA, REGARDLESS OF LOCATION.

Soil Erosion & Sedimentation Control Program of Iron County, Michigan - This Page Is Required For Permit

PLEASE COMPLETE STEPS #1 TO #8, YOU MUST MAKE A PLAN/MAP OF THE SITE, ATTACH MORE DRAWINGS IF NEEDED

#1. PLEASE FILL IN THE APPROXIMATE STAGING DATES FOR THE PROJECT

INSTALLATION OF TEMPORARY EROSION CONTROLS _____

EXCAVATION OF SITE _____

CONSTRUCTION _____

BACKFILL & ROUGH GRADE _____

FINAL GRADE _____

ESTIMATED PERMIT CLOSEOUT (VEGETATION MUST BE REESTABLISHED) _____

YOU MAY USE A PLAT MAP, LAND SURVEY MAP OR A SATELLITE IMAGE AS WELL.

YOU MAY USE A PLAT MAP, LAND SURVEY MAP OR A SATELLITE IMAGE AS WELL.

YOU MAY USE A PLAT MAP, LAND SURVEY MAP OR A SATELLITE IMAGE AS WELL.

NORTH ↑

SOUTH

MAP LEGEND

- Existing Contour
- Proposed Contour
- Disturbance Boundary
- Berm
- Silt Fence
- Stockpile

SCALE: 1 inch = _____ feet
(no more than 100 feet for Residential & Commercial)
(no more than 200 feet if Sand & Gravel Pit)

YOU MAY USE A PLAT MAP, LAND SURVEY MAP OR A SATELLITE IMAGE AS WELL.

Soil Erosion & Sedimentation Control Program of Iron County, Michigan - This Page Is Required For Permit

NOTES:

YOU MUST MAKE A PLAN/MAP OF THE SITE, ATTACH MORE DRAWINGS IF NEEDED

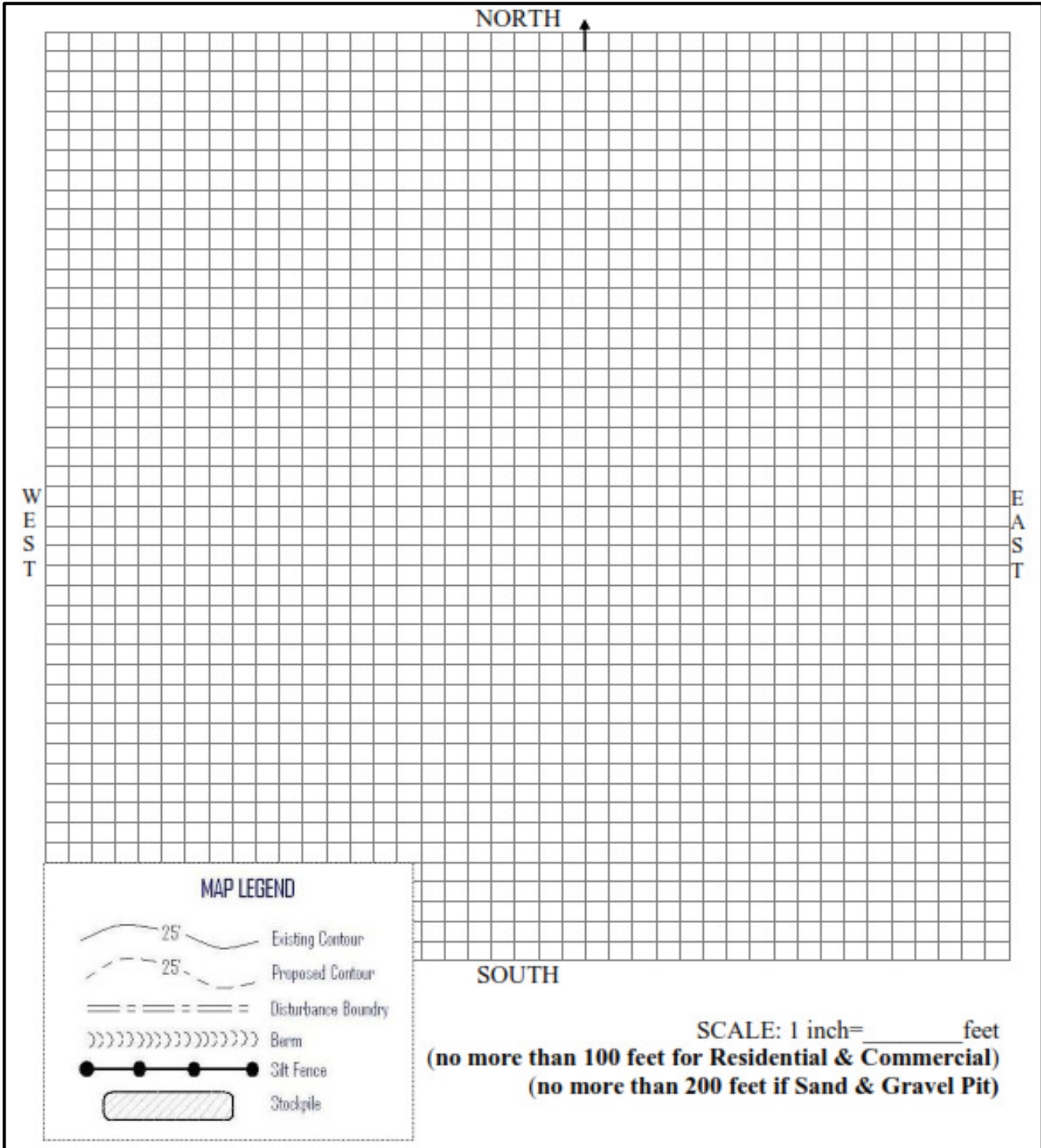

Soil Erosion & Sedimentation Control Program of Iron County, Michigan - This Page Is Required For Permit

#2. ON THE MAP, FILL IN THE SCALE (BOTTOM) AND THEN DRAW AND LABEL ALL APPLICABLE EXISTING ITEMS: STREAM, LAKE, DRIVEWAY, HOME, CAMP, LAWN AREA, GARAGE, SEPTIC SYSTEM, WELL, STORAGE BUILDING, CULVERTS, DITCHES, DRAINAGE PATHS, ETC. DRAW PROPOSED CHANGES, SILT FENCE OR CONTROL DEVICES AND ANY STOCKPILES. ALSO INCLUDE MAJOR LAND FEATURES SUCH AS A ROCK BLUFF, SWAMP, RIVER, LAKE, FOREST, ETC.

#3. PLEASE LIST ALL NEW PROPOSED EARTH DISTURBANCE ACTIVITIES (DRIVEWAY, ACCESS ROADS, HOME, CAMP, LAWN AREA, GARAGE, SEPTIC SYSTEM, ADDITION, WELL, STORAGE BUILDING, CULVERTS, DITCHES, ETC.), THE APPROXIMATE SQUARE FEET THAT WILL BE DISTURBED FOR EACH, AND THEN DRAW/LABEL EACH ON THE MAP. YOU MAY ALSO PROVIDE ONE OVERALL TOTAL AREA DISTURBED IF THIS IS EASIER.

DISTURBANCE ACTIVITY:

ESTIMATED AREA IN SQUARE FEET:

_____	_____
_____	_____
_____	_____
_____	_____
_____	_____

#4. PLEASE DRAW A HEAVY OUTLINE AROUND ALL DISTURBED AREAS FOR YOUR PROJECT.

#5. EXISTING GROUND ELEVATIONS. START AT A FLAT AREA AND LABEL THIS +100' ELEVATION. GO OUT IN ALL DIRECTIONS AND GIVE APPROXIMATE ELEVATIONS (DIFFERENCE CAN BE AT LITTLE AS ONE FOOT OR AS MUCH AS TEN) UP OR DOWN RELATIVE TO THE +100'; INCLUDE LAKE, RIVER, ROAD, AND MAJOR LAND AREAS. BE SURE TO INCLUDE ALL AREAS WHERE DISTURBANCE WILL OCCUR.

#6. PROPOSED GROUND ELEVATIONS. USING THE ALREADY LABELED EXISTING ELEVATIONS AS A REFERENCE, USE NEW NUMBERS WITH A BOX AROUND THEM TO REPRESENT THE ELEVATIONS THAT THE GROUND WILL BE WHEN YOU ARE DONE WITH YOUR PROJECT, EVEN IF IT WILL BE THE SAME. ON A SEPARATE PIECE OF PAPER, PLEASE DRAW A CROSS-SECTION FOR NEW ROADS AND AREAS OF SIGNIFICANT CUT OR FILL OF LAND.

#7. CHECK OFF THE TEMPORARY EROSION CONTROL MEASURES (AND DRAW/LABEL ON MAP) THAT YOU WILL USE DURING THE PROJECT TO PREVENT ANY SOIL FROM GETTING INTO A LAKE, STREAM, STORM DRAIN INLET, DITCH, WETLAND, OR ONTO OTHER PROPERTY:

PLACE AN X IN EACH BOX THAT INDICATES WHAT YOU WILL USE ON THE SITE

BERM	<input type="checkbox"/>	TRENCH	<input type="checkbox"/>	RIP RAP	<input type="checkbox"/>	SILT FENCE	<input type="checkbox"/>	SEDIMENT TRAP	<input type="checkbox"/>
STRAW WATTLES	<input type="checkbox"/>					EROSION CONTROL BLANKET	<input type="checkbox"/>	STRAW BALES	<input type="checkbox"/>
FILTER FABRIC OVER INLET	<input type="checkbox"/>	NONE	<input type="checkbox"/>	OTHER	<input type="checkbox"/>				

#8. CHECK OFF THE PERMANENT EROSION CONTROL MEASURES (AND DRAW/LABEL ON MAP) THAT YOU WILL USE TO RESTORE DISTURBED AREAS WHEN THE PROJECT IS COMPLETED: SEE GENERAL STANDARDS FOR RESTORATION REQUIREMENTS

PLACE AN X IN EACH BOX THAT INDICATES WHAT YOU WILL USE ON THE SITE

SOD	<input type="checkbox"/>	MULCH	<input type="checkbox"/>	WOOD	<input type="checkbox"/>	SEED & MULCH	<input type="checkbox"/>	GRAVEL	<input type="checkbox"/>
PAVEMENT	<input type="checkbox"/>					CATCH BASIN	<input type="checkbox"/>	RESERVOIR	<input type="checkbox"/>
RETENTION WALL	<input type="checkbox"/>	NONE	<input type="checkbox"/>	OTHER	<input type="checkbox"/>				

THIS IS THE END OF THE PERMIT APPLICATION - PLEASE CHECK TO MAKE SURE YOU HAVE FILLED EVERYTHING OUT